

User Manual

Based on Firmware V2.1.0



MED500X2

High Definition Multimedia Player

MEDE8AR™

INDEX

page 1	Index
page 2	Introduction
page 3	General Overview
page 4	Installing a Hard Drive
page 5	Formatting the Hard Drive
page 6	Connections
page 7	Connections continued
page 8	TV Output / Audio Settings
page 9	Remote Functionality
page10	Firmware Update / Safely Remove USB Drives
page11	Samba Network Setup
page12	Home Network Samba Server
page13	Wired Network Connection and Setup
page14	Wireless Network Setup Basic
page15	Wireless Setup
page16	Home Page
page17	Home Page Strip
page18	Media Library
page19	Media Library Continued
page20	Media Library Metadata Display
page21	Adding Custom Backdrops and Skins
page22	Movie Jukebox XML Search
page23	Movie Jukebox XML Search continued
page24	Media Library Music Player
page25	Music Jukebox
page26	Music Jukebox continued
page27	Music Jukebox continued
page28	Cover Art Preview in Media Library
page29	Play Folder / Play from Cover Art / Watched Indicator
page30	Media Scanner
page31	Folder Lock/ System Lock
page32	Favourites Manager
page33	Adding genre artwork to Favourites / Lock / Unlock Favourites
page34	Info Search / GOTO / Alpha Jump
page35	Screen Calibration / Video Zoom
page36	Subtitles / Custom Fonts
page37	Music Playlists / File Manager
page38	File Manager Continued
page39	Picture View Media Library
page40	Plasma Mode / Autoplay / Internet Streams / Web Browser
page41	NFS Setup
page42	Transmission BT Downloader
page43	Setup

Thank you for purchasing the Mede8er Multimedia Player.

The MED500X2 is the latest generation multimedia player specially developed by Sanji for today's demanding media enthusiast. The Mede8er has some very unique features so we suggest you read this guide and visit the Mede8er forum for additional help and information. The firmware is always "work in progress" so we suggest you regularly check the Mede8er forum for updated firmware releases and updated User Manuals.

Please check the Mede8er forum for the latest user guide. www.mede8erforum.com

Warranty International

Mede8er products carry a 12 month from date of purchase warranty. In the event of warranty service please provide proof of purchase. Return your product to the store that it was purchased from or return it directly to Sanji Electronics (Pty) Ltd 12, Saddle Drive Woodmead Office Park, Woodmead, Gauteng, South Africa.

Warranty & Support Europe

Mede8er products carry a 60* month from date of purchase limited warranty. In the event of warranty service or support, please contact one of the Mede8er Service Centers; www.mede8er.eu/support, support@mede8er.eu or call +31(0)10-7142861 during business hours (CET). In order to obtain the extended warranty service of in total 60* months after purchase, you need to register your product on www.mede8er.eu/register within 1 month after purchase. * *On accessories 24 months applies.*

Warranty does not cover damage by

- a) Lightning or over voltage
- b) Water damage or liquid spill
- c) Misuse or abuse
- d) User tampering
- e) Using non Mede8er approved Firmware

Sanji Electronics is not responsible for any loss of data irrespective of the cause.

Important Safety Instructions

- Read these instructions for all components before using this product.
- Do not use this apparatus near water or moisture. Do not use this product near a bathtub, washbowl, kitchen sink, laundry tub, in a wet basement, near a swimming pool, or anywhere else that water or moisture are present.
- Clean only with a soft dry cloth and as directed by the manufacturer. Unplug this product from the wall outlet before cleaning.
- Do not block any ventilation openings. Install in accordance with the manufacturer instructions. To ensure reliable operation of the product and to protect it from overheating, put the product in a position and location that will not interfere with its proper ventilation. For example, do not place the product on a bed, sofa, or similar surface that may block the ventilation openings. Do not put it in a built-in system, such as a bookcase or a cabinet that may keep air from flowing through its ventilation openings.
- Do not install near any heat sources, such as radiators, heat registers, stoves or other apparatus that produce heat.
- Protect the power cord from being walked on or pinched, particularly at plugs, convenience receptacles, and the point where they exit from the apparatus.
- Only use attachments or accessories specified by the manufacturer.
- Unplug this apparatus during lightning storms or when unused for long periods of time to prevent damage to this product.

Refer all servicing to qualified service personnel

GENERAL OVERVIEW

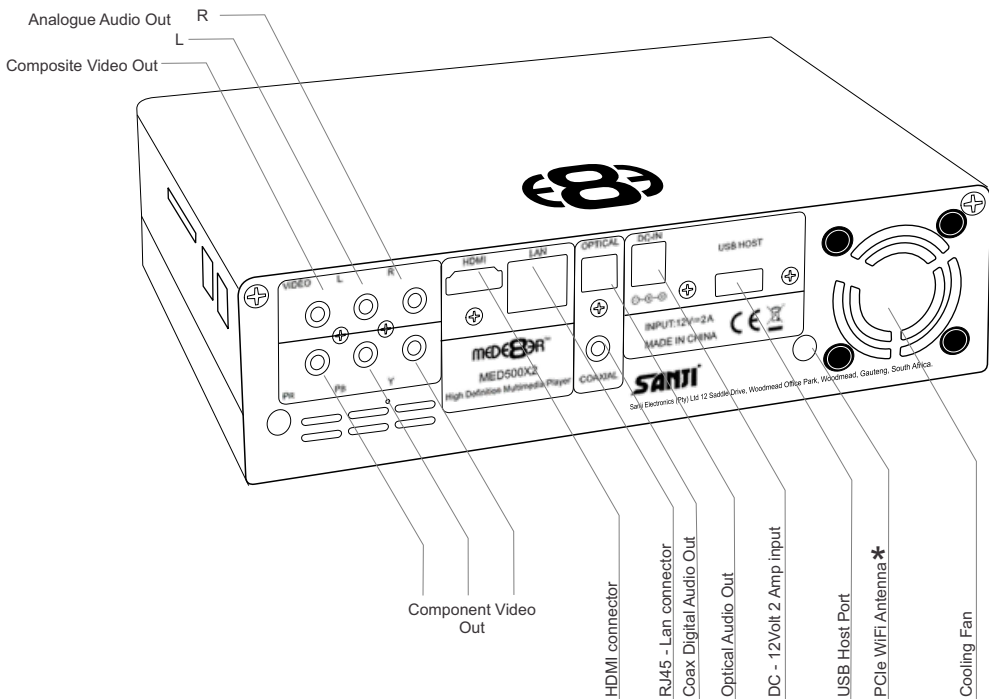
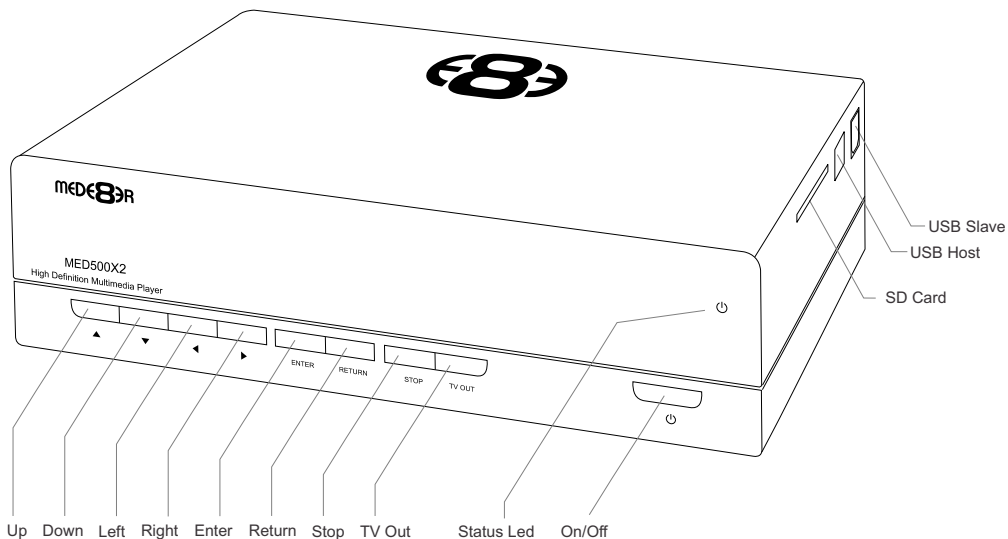

INSTALLING A HARD DRIVE

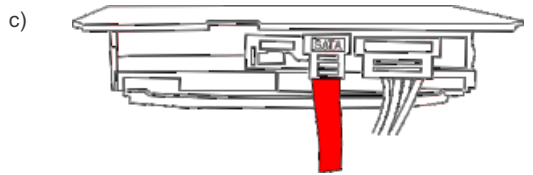
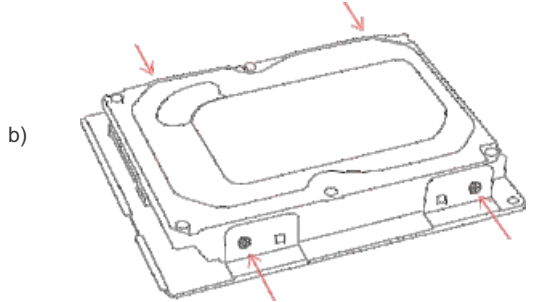
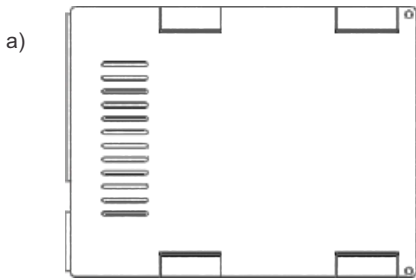
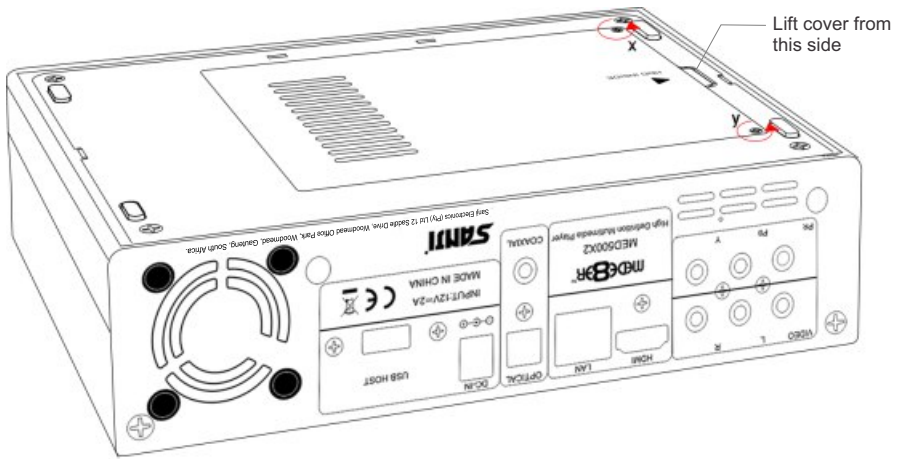

Make sure that the DC cable is unplugged. Turn the Mede8er upside down and unscrew the hard drive cover screws x and y. Lift the hard drive cover and remove it, place it on a flat surface with the mounting tabs facing upright. Fit a compatible SATA hard drive into place with the label facing upwards and the connectors facing the side with the air vents. Secure the hard drive with the four screws provided.

Check that the Hard Drive has the correct jumper setting. Connect the hard drive power connector and the red SATA data connector from the player to the hard drive diagram c. Re fit the hard drive cover into the Mede8er body and tighten the two securing screws x and y.

FORMATTING THE HARD DRIVE

The MED500X2 has a built in Hard Drive format feature that formats the hard drive with a main NTFS partition and other small internal partitions for propriety use.

The Hard Drive should be formatted in the Mede8er MED500X2 to ensure full functionality. A pre formatted Hard Drive can be used but you may not be able to use all the internal features of the MED500X2.

To Format the internal Hard Drive select SETUP menu and then HDD Format. The Hard Drive format function can be protected by the built in "Pin Code Lock" function. To enable Hard Drive Format protection just enable "Pin Protection" option in the Setup menu.

Brand new virgin Hard Drives should be Formatted twice before use.



WARNING: FORMATTING THE HARD DRIVE WILL ERASE ALL DATA

USB CONNECTION TO PC

You can transfer files to and from the Mede8er via fast USB2.0 or USB3.0 transfer. Use the included Blue USB cable to connect the Mede8er MED500X2 to your PC. After you have connected the USB cable press the on/off button on the MED500X2 front panel and the LED will go "off". The Mede8er drive Dialogue Screen will open on your PC. The Computer will automatically install the correct drivers and then you will be able to navigate the Mede8er like any normal external USB drive. **Note:** Some Computers may take up to a few minutes to install the correct USB drivers. If you cannot connect to the Mede8er than try another USB Port on your computer.

EXTERNAL USB DEVICE DRIVER NOT REQUIRED

IMPORTANT: USE THE SUPPLIED BLUE USB3.0 CABLE FOR USB CONNECTION TO YOUR PC

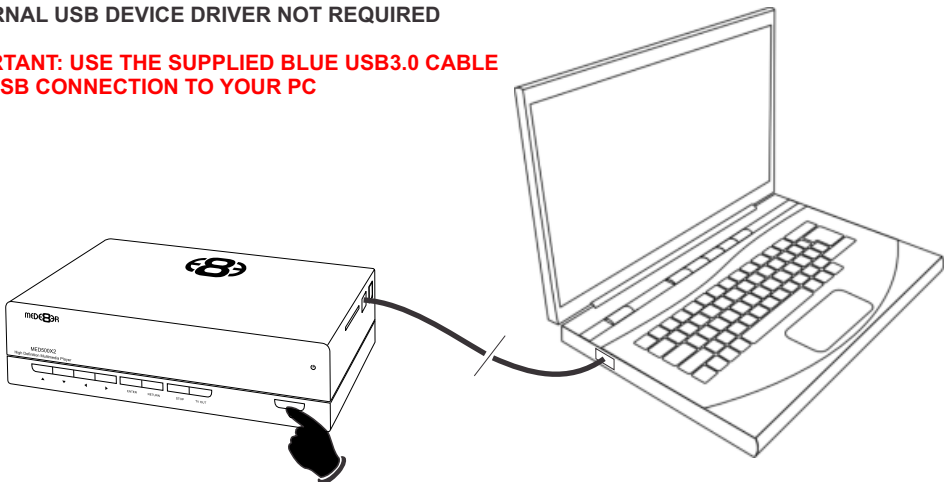

CONNECTIONS

Analogue Audio and Composite Video connection to TV.

Composite Video offers the most basic picture quality connection and should only be used if your TV does not have a HDMI or Component input. Use RCA analogue audio outputs in the absence of HDMI or Digital Audio inputs on your TV or Home Theatre system. RCA analogue outputs will output a downmix from multi-channel to stereo.

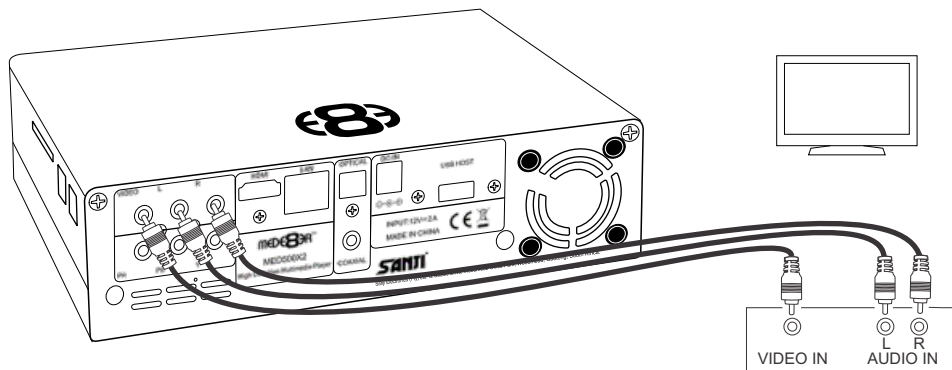

HDMI - RJ45 Network - Coax Digital - Toslink Connection to a TV or Amplifier

For digital audio connection to your Home Theatre System you can either use the TOSLINK Optical or the Co-Ax Digital output. The MED500X2 supports both Passthrough and Downmix for both Dolby Digital and DTS signals. If you want your Home Theatre Amplifier to decode the surround sound stream you should use either Digital Audio output and set the Audio Output to SPDIF Passthrough in the Setup menu.

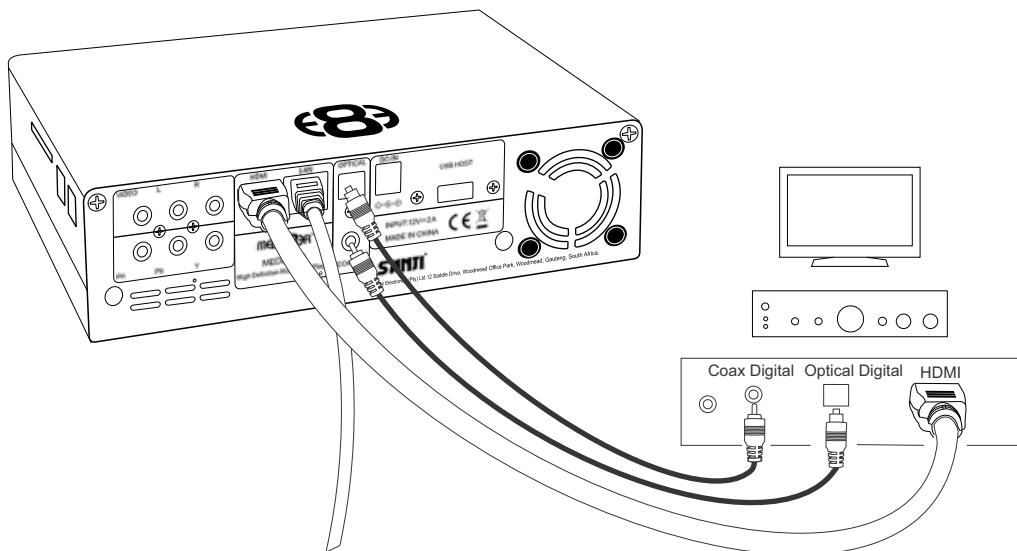

Connect LAN cable to router or switch

Component Video Connection to Amp or TV

Component Video offers the next best picture quality to HDMI so if your system does not have a HDMI input we suggest you use the Component Video Connection.

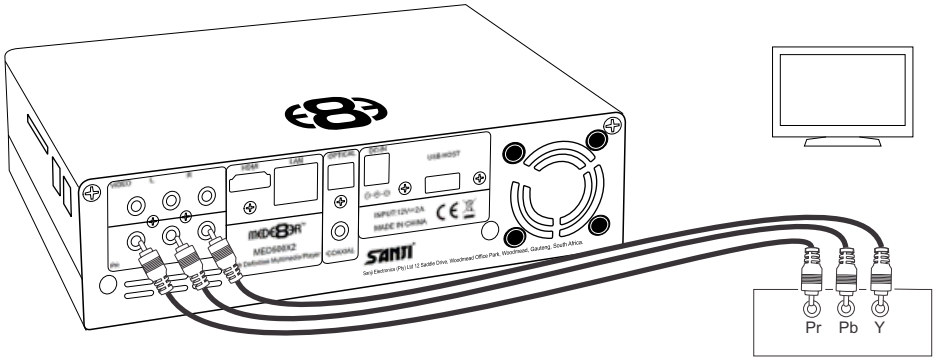

Power up and Standby

Plug the AC/DC adapter into the mains outlet and plug the DC Jack into the DC IN at the rear of the MED500X2. DO NOT USE ANY AC/DC ADAPTER AND ONLY USE THE ONE SUPPLIED otherwise you may cause damage to the unit. Press the On/Off button on the Mede8ers front panel and front facia LED will turn on Blue. You can put your Mede8er into standby by pressing the On/Off button on the remote. When in standby the front facia LED will turn Red.

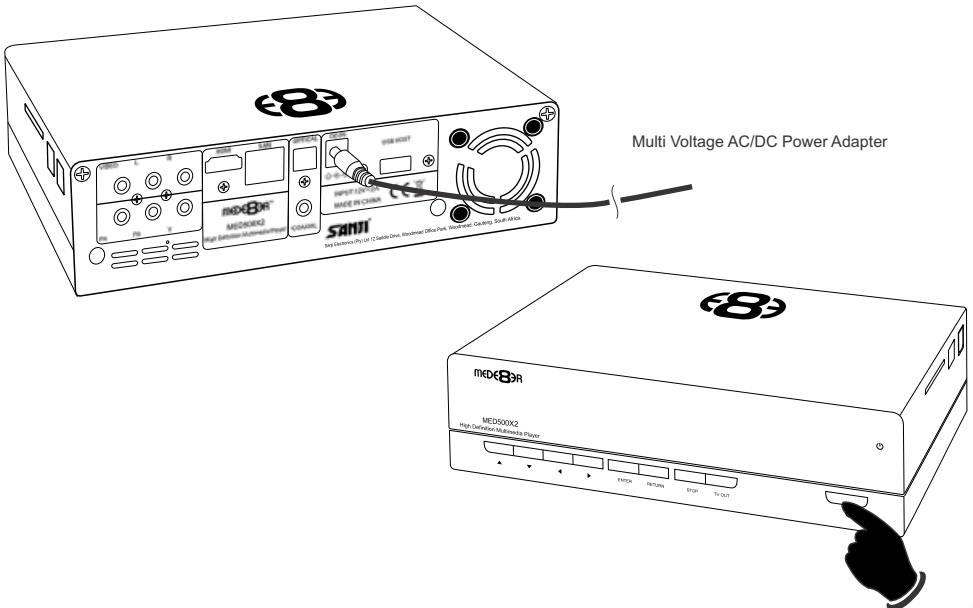

TV OUTPUT SETTINGS

Connect the Mede8er to your TV by one of the connection options as shown on page 6 & 7 and change the input option on your TV to match the option you selected. If you do not get to see the Mede8er GUI on your TV you will need to toggle the Mede8er TV output until you get a picture.

TV SYS Toggle Procedure

The Mede8er has three video output options ie Composite Video (yellow RCA connectors), Component Video (Red - Green- Blue connectors) and HDMI. Each output option also offers different screen resolution settings and these will need to be adjusted to match the type of TV used.

To change the Video Output on the Mede8er just press the TV SYS button on the remote and it will change the Video Output to the next available output option. If after pressing the TV SYS button you still do not get a picture then after a short pause press the TV SYS again until you see the Mede8er GUI on your TV. Keep repeating this procedure until you see a picture on your TV.

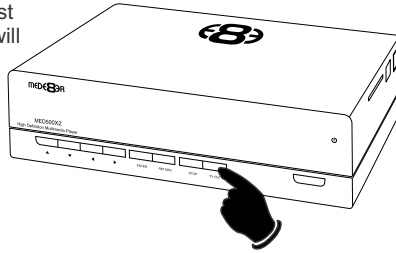

Once you see the Mede8er GUI on your TV then you must enter the Video Setup mode and adjust the Video settings to match the screen size resolution of your TV.

AUDIO SETTINGS

Surround Sound

Select "Don't Care" if you are using 2 CH stereo. If you are using SPDIF or Co-Axial Digital then select "AC3". If you are using HDMI Audio to amplifier then select "True HD"

HDMI Downmix (2 channel)

Use this setting if you are connecting the Mede8er directly to the HDMI input on your TV. The sound will be downmixed to 2 channel stereo.

HDMI Passthrough

Use this setting if you are connecting to the HDMI input of a Home Theatre Amplifier. The audio will be passed through as Bitstream or PCM and the amplifier will do the multichannel decoding.

HDMI LPCM MULTI CH

Use this setting for content that has a 6 channel AAC soundtrack.

SPDIF Downmix (2 channel)

Use this setting to connect to a Amplifier via Toslink optical cable or Co-Axial Digital RCA cable. The sound will be downmixed to 2 channel stereo.

SPDIF Passthrough

Use this setting to connect to amplifier via Toslink optical cable or Co-Axial Digital RCA cable. The sound will be passed through as Bitstream or LPCM and the amplifier will do the multichannel decoding.

FORCE DECODE AAC/MP3

Use this setting if you do not get AAC/MP3 Audio in HDMI 'Auto' or Passthrough.

REMOTE FUNCTIONALITY

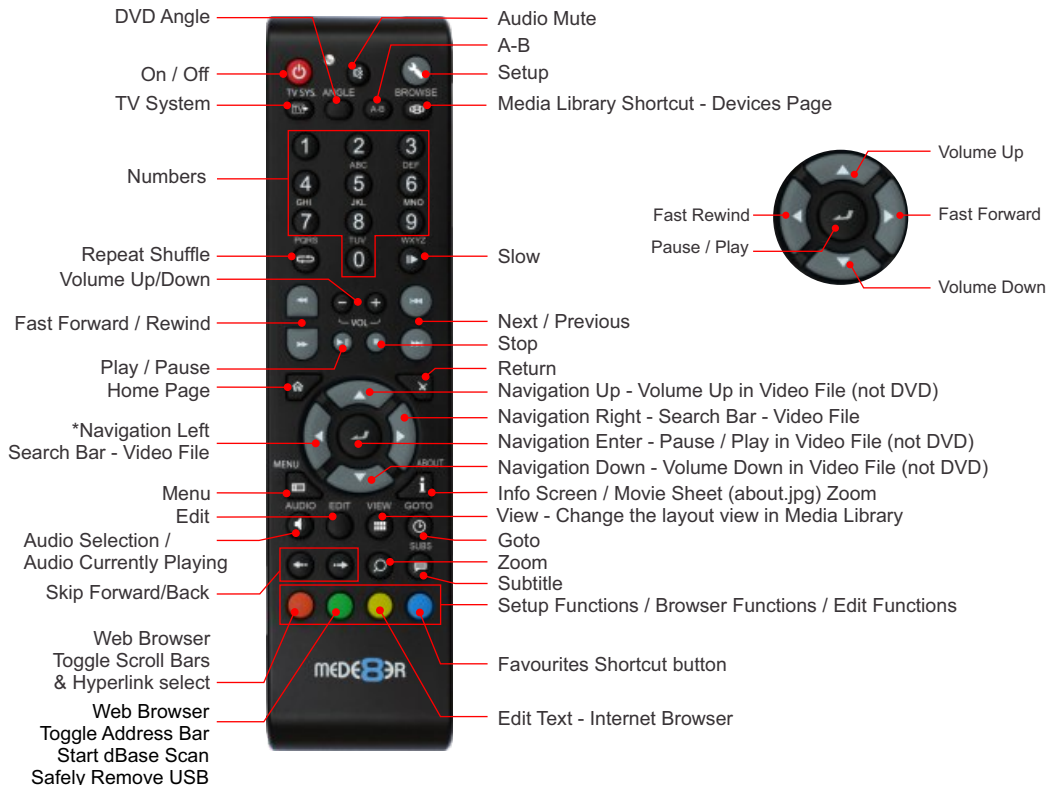

USB Keyboard Function Keys (based on MEDX2KEY)

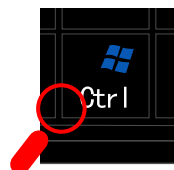

'Ctrl' - ZOOM
YouTube,
Internet Browser

ESC: RETURN SPACE: PLAY
ENTER: SELECT(ENTER)
'0': 0 '1': 1 '2': 2 '3': 3 '4': 4 '5': 5 '6': 6 '7': 7 '8': 8 '9': 9
'-': VOL_DOWN '+': VOL_UP
'P' + 'SHIFT': POWER OFF
'R(r)': REPEAT 'T(t)': SUBTITLE
'I(i)': INFO 'A(a)': AUDIO
'G(g)': GOTO 'H(h)': HOME
'Z(z)': ZOOM 'I(?)': Info / About
'Ctrl': ZOOM YouTube, Internet Browser
'<': FRWD '(>)': FFWD

'F(f)': Favourite 'E(e)': EDIT
'M(m)': MENU 'S(s)': Setup
'V(v)': View 'L(l)': AB
'\(\)': SLOW "(": STOP
'/(?)': Info / About '[(l)': Back Skip
'[()]: Forward Skip 'W(w)': Launch Web Browser
'B(b)': Browser - Devices
'Alt': Mute 'F1': Red button
'F2': Green button 'F3': Yellow button
'F4': Blue button 'F5': TV Sys
'F6': Previous Chapter 'F7': Next Chapter

FIRMWARE UPDATE

Download the latest Mede8er Firmware from www.mede8erforum.com. UnZIP or UnRAR or join with HJ Split and will find one file named install.img. Copy this file to the root directory of a Flash Drive. Plug the flash drive into the Mede8er.

DO NOT REMOVE POWER DURING THE EMERGENCY RECOVERY PROCEDURE.

Setup Menu Update with Auto Configuration Restore

Open the Setup Menu and select the "Misc" tab. Now select USB upgrade option. After +- 5 sec the screen will display the current Firmware Version and the New Firmware Version. You will have the option to select "OK" or "Cancel". Select "OK" and the Mede8er will reboot within +- 1 second and start the update process will start in +- 10 seconds. During the update process the front facia Blue LED will flash and you will see the version of the Firmware and the install progress bar on your TV screen. After the update is complete the Mede8er will reboot with the new firmware installed.

If the Mede8er does not reboot within 5 seconds (after pressing the "Enter" button) then press the "Home" button to initiate

Emergency Method (Resets Configuration to Default)

Disconnect the power jack at the rear of the Mede8er then plug it back in - Now press the on/off button and hold it pressed for 15 seconds and then release.

After approximately 15 seconds the LED on the Mede8er will flash blue and you will get a progress bar on your TV display (some TV's will not display this) wait until the Mede8er re boots itself +- 60 sec. Your Mede8er is now updated.

Power Up and hold on/off button for 10 seconds

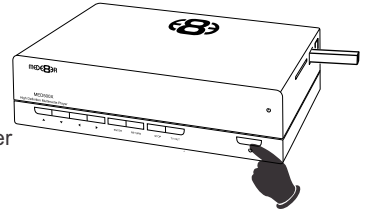

SAFELY REMOVE USB DRIVES

To use the Safely Remove USB Drives function navigate to the 'Devices' page and press the 'F2' Button on the Remote. A new page will be launched with a drop list of available USB drives that can be dismounted. Select the drive you want to dismount and press 'Enter' and X2 will then Safely remove the drive. You should remove the USB Drive without delay.



Note: USB Drives that are being read from or written to in Samba Nas mode will not be dismounted.

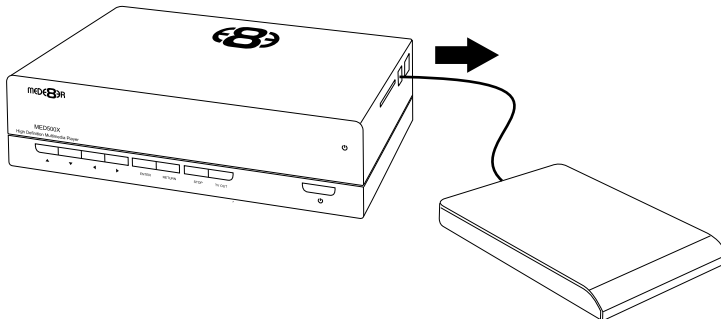

SAMBA (Network Setup)

If your PC or NAS has shares setup to specific users then you will need to setup a shortcut on the X2 to each machine and specify the IP, Username and Password

Setting up Samba shortcuts on the Mede8er

Select 'Network' and then select the 'My_Shortcuts' icon. Now press the 'Menu' button and select 'Add New Shortcut' option. Fill in the fields User Name, Password, IP Address (Host Machine), and select 'OK'

NOTE: In order to browse your secure shares you will have to enter 'My_Shortcuts' and then select the Shortcut's that you have setup.



PUBLIC SHARES

For Public Shares (shares that do not have a Username and Password) just use the name 'Guest' for username and password.

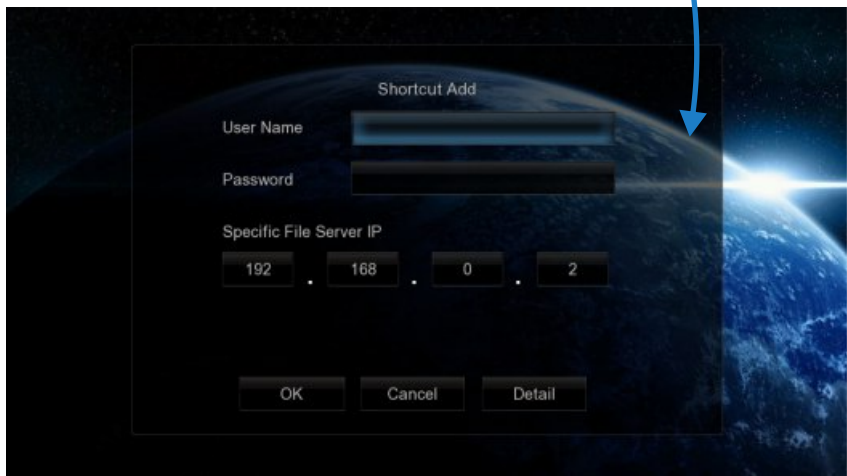
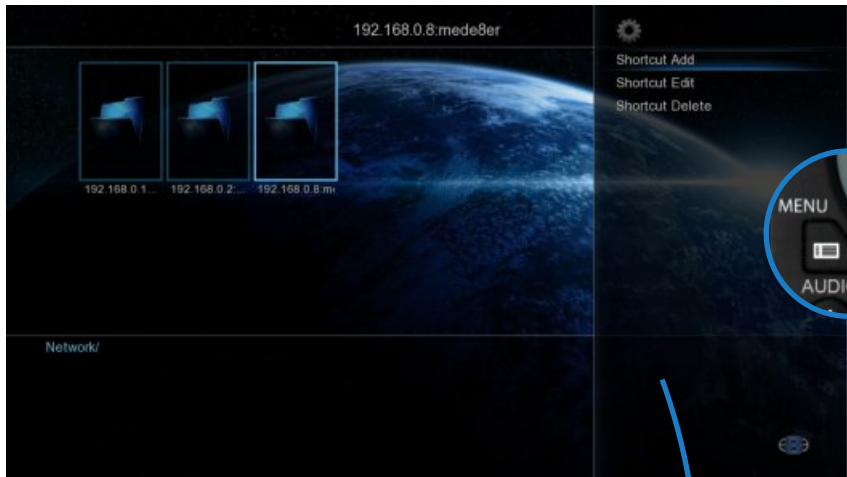

HOME NETWORK SAMBA SERVER

The Mede8er has NAS (Network Attached Storage) functionality built in. And although it is limited in transfer speed compared to standalone NAS servers it performs very well if speed is not your major requirement. You can also use the MED500X2 as a Media Server and stream content to other Mede8er's on your home network.

The Samba function is enabled or disabled in the System menu under Network. Should the Samba stop working for any reason we suggest you re-boot the Mede8er ie Disconnect the DC Jack at the rear and re connect and press the on/off button on the front panel.

You can browse your Mede8er in Windows - My Computer then My Network Places then View Workgroup Computers.

If you are using more than one Mede8er on your Network then you should change the Hostname in the Setup Menu. Each X2 should have its own unique Hostname. You must reboot the X2 after changing the Hostname.

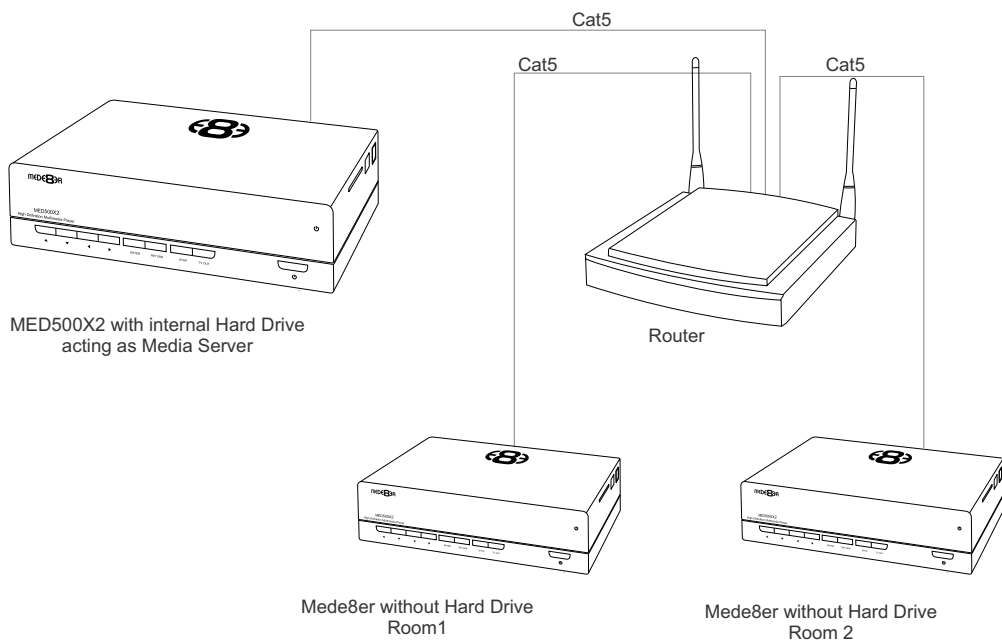
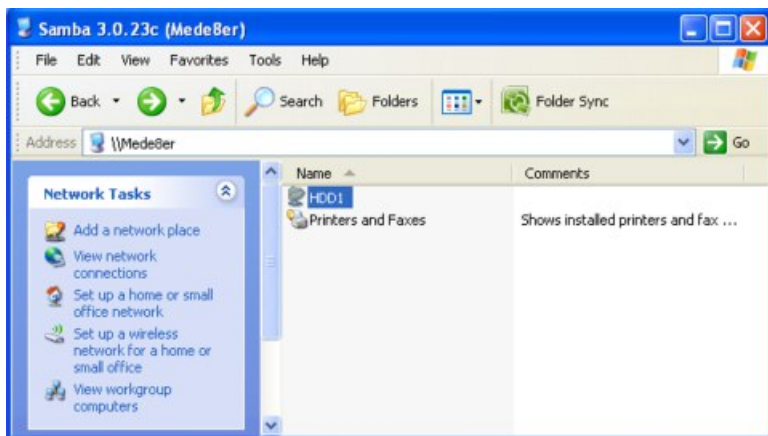

WIRED NETWORK CONNECTION AND SETUP

The Mede8er MED500X2 can be connected to your local network by means of a RJ45 CAT5 cable. The Mede8er is supplied standard with a UPnP facility, Samba Client and NFS that allows connection to your local area network via a router or switch. You can share media files from your PC and stream media content to the Mede8er and you can use the Mede8er as a Media Server to stream media content to other Mede8er's on your network.

Press the "setup" button on the Mede8er Remote or select "setup" tab on the home page. Select "Network" option in the setup window and press "OK" to confirm. Network configuration allows for either automatic or manual IP setup.

Follow the on-screen instructions to complete the network setup.

If you connect to a wired Ethernet network using DHCP, Mede8er automatically detects your network. Alternately you may have to enter your IP address, subnet mask, router, and DNS addresses manually.

DHCP IP (AUTO)

Choose this option if you want your router to assign a dynamic IP address to Mede8er. This option is easy to use and recommended for normal users.

FIX IP (MANUAL)

This option allows you to assign a static IP address to Mede8er. This option requires modifying network settings of the Mede8er and is recommended for advanced users. To set a Static IP for your Mede8er, enter the information IP Address, Subnet Mast and Gateway and DNS Server Address as relevant to your router as in the screen below.

DHCP IP Auto



Fixed IP Manual



WIRELESS NETWORK SETUP (basic)

The Mede8er MED500X2 is only compatible with the Mede8er Wireless Dongle MED10WFB USB WiFi Dongle / MED20PCle PCIe WiFi Kit. (Other brands will not work)

Refer to User Instructions supplied with the Mede8er dongle for detailed wireless connection setup.

Only use model MED10WFB WiFi Dongle as it is supplied together with the USB extension cable base.

WIRELESS NETWORK CONNECTION

Plug the MED10WFB into the USB extension base that was supplied with your Mede8er. Plug the USB cable into one of the USB host ports on the side of the Mede8er. Extend the cable and try to place the base in a position that is away from any metal object that could effect the RF signal strength. The best placement for the dongle will depend on your particular environment. In order to get the best placement you may need to extend the length with an additional USB extension cable.

The operating distance or range of your wireless connection can vary significantly based on the physical placement of the Router and the WiFi Dongle.

For best results, place your Router:

- * Near the center of the area in which your Mede8er will operate,
- * In an elevated location such as a high shelf,
- * Away from potential sources of interference, such as PCs, microwaves, and cordless phones,
- * With the Antenna screwed in tight and in the upright position,
- * Away from large metal surfaces.

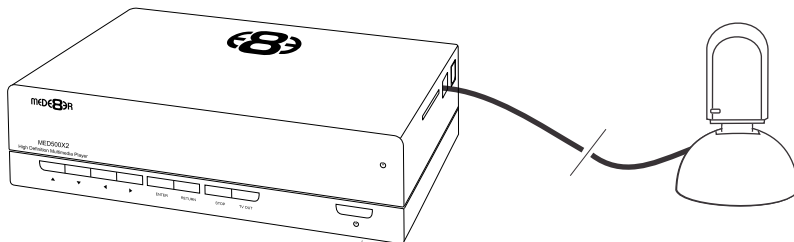

WIRELESS PCIE ANTENNA INSTALLATION (Factory Fit)

Certain models of the MED500X2 (depending on the region) may be available with a factory fitted PCIE WiFi kit. Check the packaging information to confirm if your model has the pre installed WiFi kit.

For user instructions for the installation of the Mede8er MED20PCIE WiFi Kit into the MED500X2 --

Pls check for the latest online user Guide on the Mede8er Website.

http://www.mede8er.com/mede8er_support.html

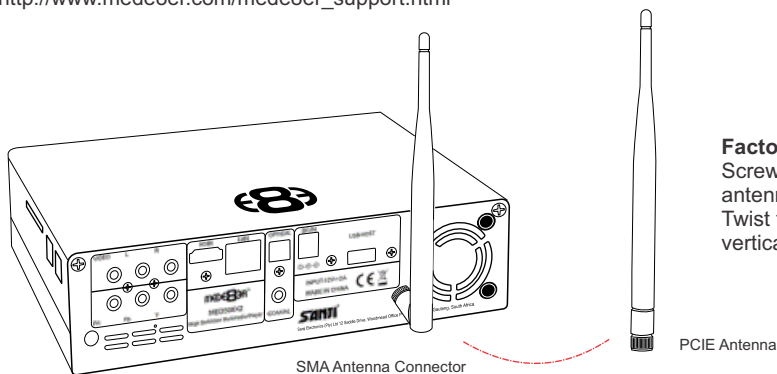

Factory Fitted PCIE Kit
Screw the antenna into the SMA antenna connector on the X2.
Twist the antenna gently into the vertical position as shown.

WIRELESS SETUP

Open Setup Menu then 'Wireless Setup' and you should see a list of available SSID's with signal strength info. Press the 'Zoom' button to refresh the list. Select the SSID you want to connect to and press 'Enter'



If the WiFi Router has password protection enabled then you will be required to enter the security key of your WiFi router. Enter the key into the virtual keyboard.



Select **DHCP IP (AUTO)** if you want your router to assign a dynamic IP address to the X2.



Select **FIX IP (MANUAL)** if you want to assign a static IP address to the X2.



If you selected Fix IP then you must enter the **IP Address**
Subnet Mask
Default Gateway
DNS Server IP

After inputting these settings press 'Enter'



The X2 will now test the connection.



If the connection was successful then the X2 will display the Net Info screen. This screen shows details of the connection.



Press 'Enter' and then you can press 'Return' to exit the WiFi Setup Page.



HOME PAGE

The Mede8er Home is the central point where you can launch all the user applications. Press the Right/Left Navigation buttons on the remote to navigate the Home Page and press "Enter" to launch the selected page.



FAVOURITES

Create, manage, apply Genre cover art to local and network folder shortcuts.



MEDIA LIBRARY

In Media Library you can browse all your media content on Internal Hard Drive, SD Card, USB Devices and Network and launch the built in File Manager to manage and transfer your content.



MOVIE DATABASE SEARCH (HDD - USB only)

The Movies Database Search page will display all information about Video Files and allow you other functionality such as search, most viewed and recently added.



MUSIC DATABASE SEARCH (HDD - USB only)

The Music Database Search page will display all information about your Mp3 Music Files and allow you other functionality such as Search and filtering options such as sort by -- Albums, Artists, Genres, Year and access to Playlists.



PICTURES DATABASE SEARCH (HDD - USB only)

The Pictures Database Search will display all information about your Pictures and Images and allow you other functionality such as Search and filtering by recently added and recently viewed.



INTERNET MEDIA

The Internet Media page contains all the Internet Media such as Web Browser, Social Media, YouTUBE, Flickr etc



SETUP

The Setup page is the area where you personalize the setup option for your needs

HOME PAGE STRIP

The Home Page can be accessed at any time by pressing the "Home Page" button on the remote. The Home Page Strip will appear at the bottom of the page and allow you to make your selection using the Left / Right Navigation buttons on the remote.

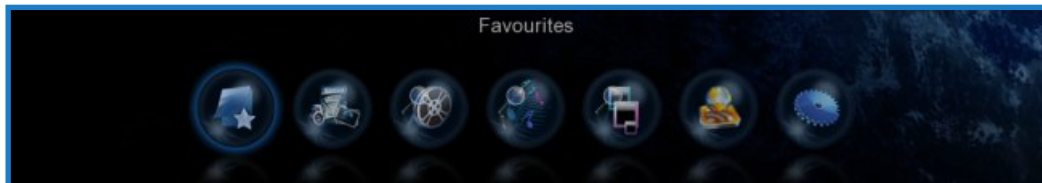

MEDIA LIBRARY

The Mede8er Media Library has five built in standard views ie Movie View, Music View, Picture View, List View, List View and Preview View. The Media Library has been designed so that the view can be easily changed on the fly. In the Media Library you have the option of changing the Views Manually or you can enable the 'Auto View' option in the Setup Menu. If the 'Auto View' option is enabled the X2 will automatically save the last used 'View' of the folder. The next time you enter the same folder it will automatically change to the saved View. Auto View mode requires that the X2 has 'write' permissions as it needs to save a xml file to each folder. Auto View is disabled in Jukebox mode.

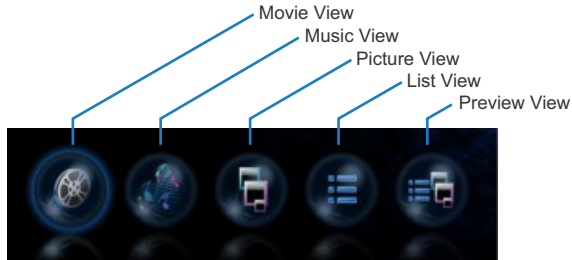

1. Media Icons 2. File Name 3. Focus Bar 4. Scroll Bar 5. Folder Path 6. Metadata Rating 7. Metadata Genre 8. Metadata Movie Length 9. Watched Indicator 10. Index 11. View Icons



Movie View



Music View



Picture View



List View



Preview View

MEDIA LIBRARY CONTINUED

To change the View of the Media Library press the "View" button on the remote and the Media Library strip will show. Press the 'View' button again and the focus will change to the next icon. Repeat pressing the 'View' button until the icon you require is selected and then wait and the X2 will automatically change the Media Library view to the icon you have selected.

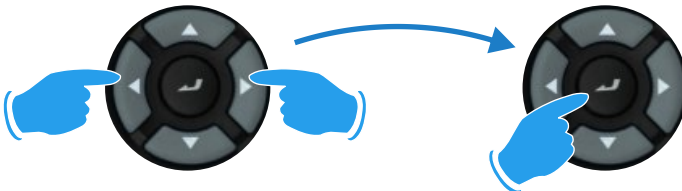
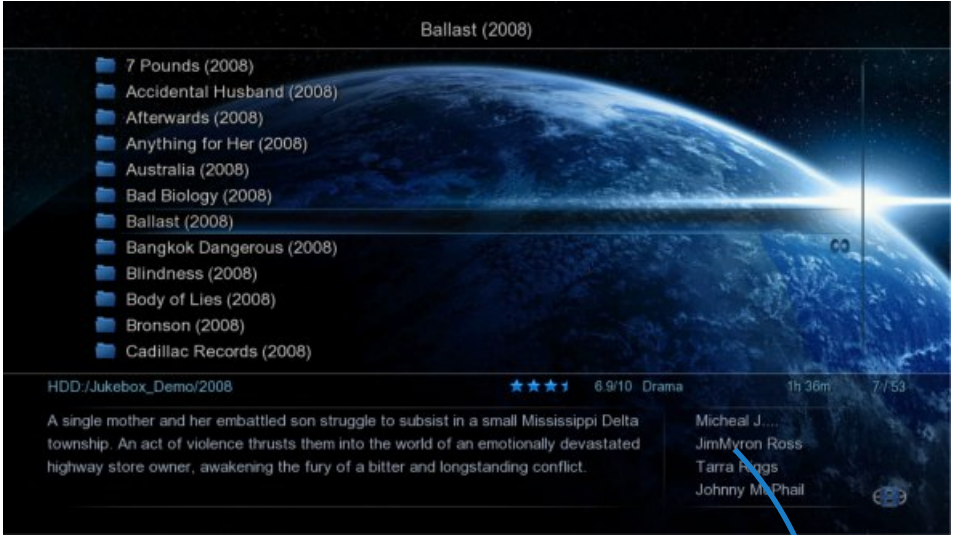

MEDIA LIBRARY METADATA DISPLAY

The Media Library will display basic Movie Metadata in all 'Views'. This unique Mede8er functionality will greatly enhance your Media Library browsing experience and make it real easy for the whole family to enjoy. In order to take advantage of the advanced functionality you will need to scan your movie collection in order to make the required xml files. To create the xml with Windows use Y2M (YAMJ to Mede8er) or Thumbgen and for Apple Mac we suggest you use DunX2Mede8er. Pls check the Mede8er Forum for more details on these PC Programs.

Movie Rating - stars out of 5, Movie rating - x out of 10 , Movie Genre, Movie Run time

Visit the Mede8er Forum for downloads and instructions on using Y2M. www.mede8erforum.com

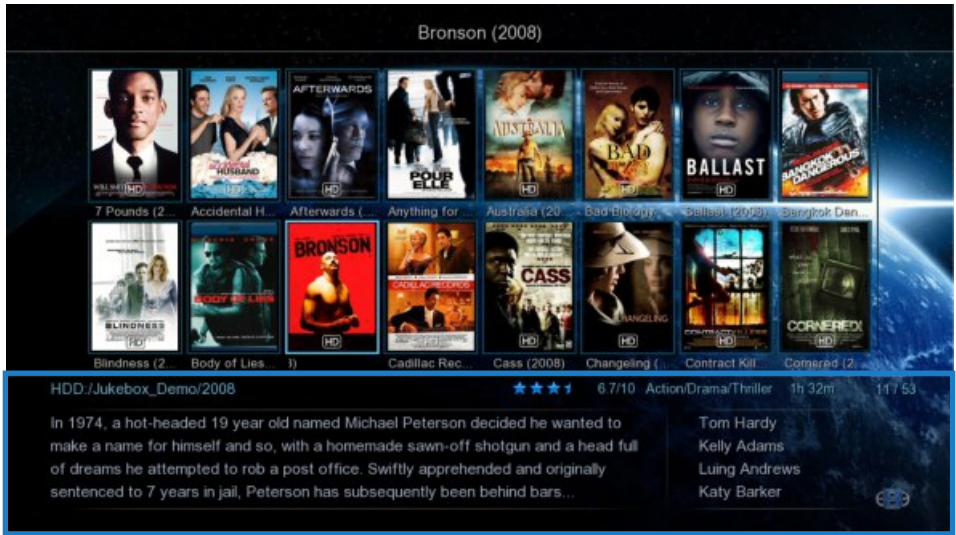

You can view the Movie Sheet that contains the full movie details at any time by pressing the "Info" About button on the remote control.

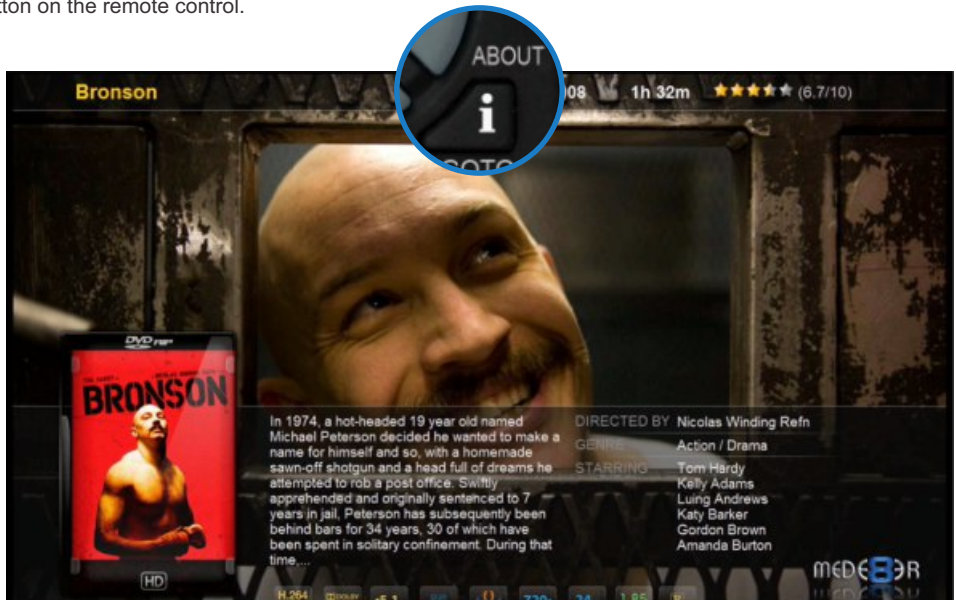

ADDING CUSTOM BACKDROPS AND SKINS

You can easily customise your X2 by adding your own backdrop image. Prepare the jpg image to size 1280 x 720 pixels with max size 500KB. In the X2 Media Library navigate to the image you require and press the 'Menu' button. Select the option 'Set to Background' and the x2 will load your new backdrop into flash memory and use it as its default. You can always revert to the Mede8er original default by selecting the option 'Restore Default Background'

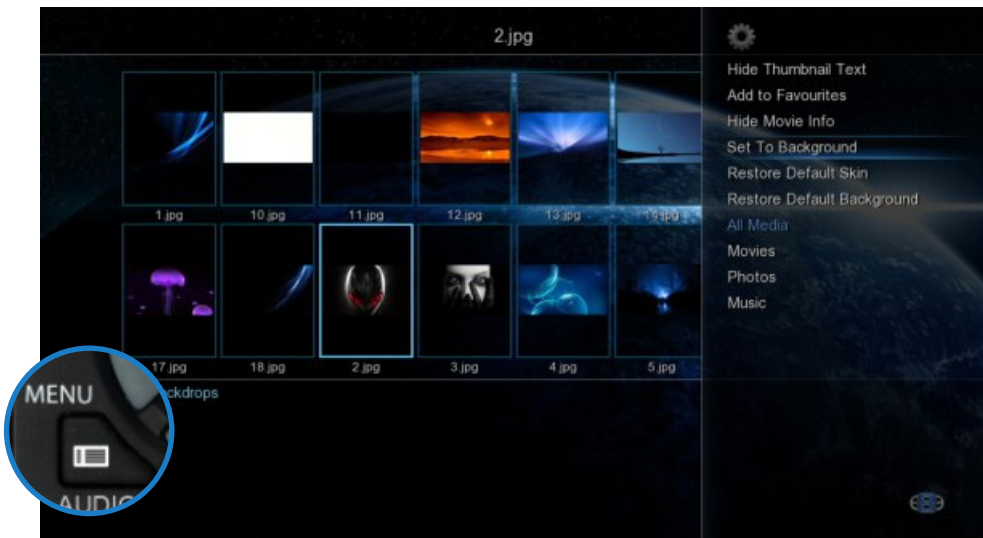

The skin option is community driven and you can find some unique designs available for download from the Mede8er Forum. To load a skin -- just download it and unzip /unrar it to a folder. In X2 navigate to this folder and press the 'Menu' button and select 'Add to Skin Option' The new Skin will be loaded into flash memory and used as the new default skin. You can revert back to the original skin at any time by selecting the option 'Restore Default Skin'



MOVIE JUKEBOX - XML SEARCH FUNCTION

The X2 has a built in XML Search facility that will allow you to sort and arrange your Movie Collection by pre defined xml filters. The XML Search can be used with content on External USB Hard Drive, Samba Network and NFS Network.

Library Preparation for XML Search operation

The Media Library must conform to the Mede8er standard with all the relevant movie file information in its own folder. A typical folder will contain - Video File - Folder.jpg - About.jpg - XML File - Subtitle file. Once you have arranged your Video Collection into individual folders you can use Windows - Y2M (YAMJ To Mede8er) or Thumbgen / Mac - DunX2Mede8er to scan the folders to make the requires images and xml files.

Scanning your Library

In order to provide XML Search functionality the X2 must scan your library and build a Database file. To scan your library you must focus on the Root Folder of your library and press the 'Menu' button and then select the 'Scan Folder' option. The X2 will start the scan process and Scan all folders and sub folders in order to build the dBase file. The Search criteria is to only include folders that have a valid Y2M/ Thumbgen / DunX2Mede8er XML inside. The folder depth level is not limited in the X2 firmware but the path of the string cannot be longer than 512 characters and the max number of sub folders cannot exceed 4096. The Database file 'Mede8er.db' will be save to the root of the folder that has been scanned. Network shares must be 'Write Enabled' for the scan process to complete. If new content is added to the root folder then the scan operation must be repeated. Scanning time is quick and it should take about 30 seconds to scan over 300 video files.

Note: The Maximum amount of Movies in one Database is currently +- 2000. If you scan a library with more movies than 2000 then the operation of the xml Search can become erratic and you may experience that the Mede8er often crashes.

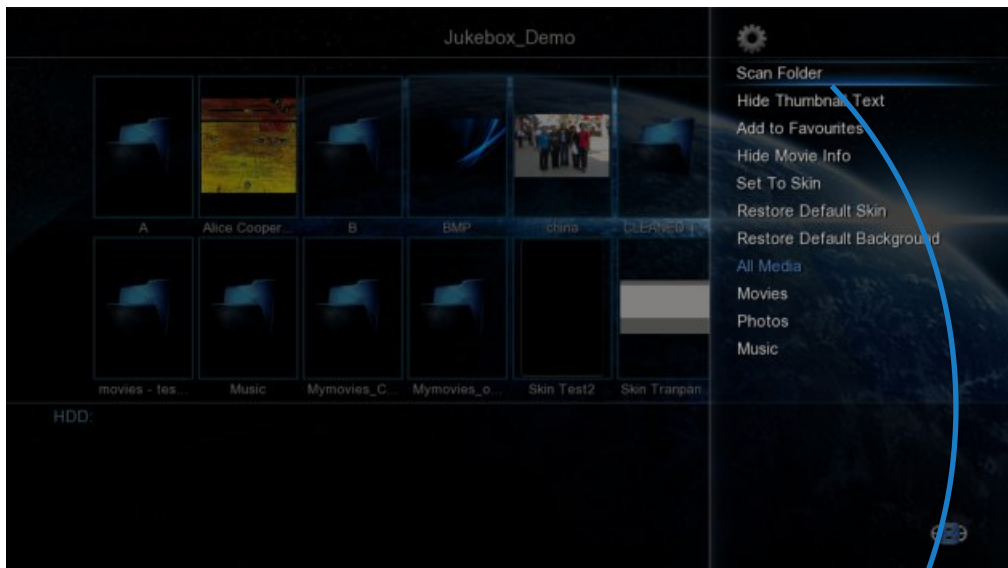

JukeBox View

In Setup under 'Misc Options' you can select JukeBox View -- on/off

JukeBox View 'off' - Favourite Links to a Jukebox will be presented in a normal structure and you can navigate the scanned Folders and Sub Folders folder as you normally would in the Media Library.

JukeBox View 'on' - Favourite Links to Jukebox will be presented in JukeBox View ie 16 Covers in a flat display. The internal folder structure of the folders will be ignored.

You can add a scanned XML Folder to Favourites in the normal way.

JukeBox View

On

Using XML Search - Media Library

To use the XML Search you must navigate to the root folder that was scanned and open it. You will see a XML Search icon on the top right of the screen.



Using XML Search - Favourite Link

If the Jukebox was launched from a Favourite link then the contents will be displayed in Jukebox Style (provided the Jukebox View is enabled in the Setup Menu).

If you see the Search Icon top right of the screen you then have Jukebox functionality. Press the Menu Button and you will have a choice of XML Search option.

Sort Search Results by Latest / Alphabetically

You have the option to have the Search results filtered by 'Latest' ie the date you added the movie to your collection or in Alphabetic order. This is a global setting and will be stored in memory. After selecting this option you must then do a XML Search.

Watched Indicator

If this option is enabled in the Setup Menu then it will then show on the XML Search Menu. You will have the option to Mark the Video as Watched / Unmark as Watched. The Video file will automatically be marked as Watched if more than 10% of the Video was watched.

Folder Lock

If enabled in the Setup Menu (Folder Protection) You will be able to lock any Movie in the Jukebox. Just focus on the Movie cover and press the Menu Button and select the 'Lock' option and the Movie will be locked. To unlock the Movie just focus on the cover and press the Menu Button and select 'Unlock' then enter your 4 digit pin code and the Movie will be unlocked. Default code is 0000

Hide Movie Info

If this option is selected the XML Movie Info will be hidden

Title Search

Select the 'Title' option to perform a Movie Name Search. Enter the 'movie name' or 'key word' into the Virtual Keyboard and the X2 will search the folder names for a match and display the results.

All - All content will be displayed by 'Latest' or in 'Alphabetic' order.

Genre - list of all the available Genres in the dBase will be displayed.

Year - This is the release date of the movie. A list of all the 'Years' ie release dates in the dBase will be displayed.

Star Rating - The star rating is the IMDB users rating for the movie.

Alpha Search - Use the Alpha buttons on the remote. An Alpha search can be conducted within a dBase XML Search.



MEDIA LIBRARY - MUSIC PLAYER

Select any supported music file and the Music Player Screen will launch. If the music file has embedded information tags and images then these will be displayed on the right hand side in the preview window area. If you do not want to use embedded mp3 art or you are using .m4a, ape or flac files you can save the Album Cover as a jpg file named 'folder.jpg' to the Music Album Folder and the X2 will use it if it does not find any embedded art in the music files. Suggested size of the embedded art is 230 x 230pixels.

The X2 also supports Music Fan Art. Make a image called 'fanart.jpg' size 1280 x 720 and save it to the Album folder.The X2 will automatically display the Fan Art background when you select any track in the Album.



Currently Playing - Music Shortcut

Press the 'Audio' button to take you back to the Currently Playing music.



Music Jukebox

Pls visit the Mede8er website for the Online Guide



Current Track Time

Total Track Time

Music Jukebox Online User Guide.

http://www.mede8er.com/mede8er_music_jukebox_user_guide.html



OFF - Repeat and Shuffle off



Repeat Track - Repeat the current track



Repeat All - Repeat all tracks in the folder. Shuffle off



Shuffle - Shuffle all tracks in the current folder



Music Repeat

or

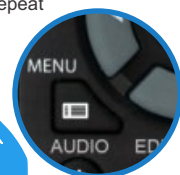

MUSIC JUKEBOX



The X2 Jukebox relies on the embedded Music files 'Tag' information and correct image sizing for its functionality, so it is critical that you spend the time to correctly Tag your music collection.

Music Jukebox Features

Direct MP3 Scan * Supports Mp3, OGG, Monkey's Audio, Flac, AAC, wma, m4a -- when scanned with Tagscanner * Works on local drives and Network shares * Displays Tag information in the Music Player Screensaver with Album Artwork * Supports .cue files play function (Album based) * QPL (Quick Play List) Function * Make and Save Mede8er m3u Playlists on the GUI * Supports Playlist Creator 3 - 'Non extended information' m3u Playlists * Search Album Year, Artist by drop list or Text input, Genre, Track Keyword * Large collections supported +- 40 000 tracks * Supports the Auto View function * Easy Drop List selection with Right / Left Nav Alpha Jump * Results filtered by Album or Title option * Easy Setup for Multiple Music Jukeboxes * iTunes DRM m4a / WMA DRM and advanced profile -- not supported

Note: The Music collection cannot be mixed with Video content.

Basic MP3 direct Scanner Operation

Navigate to the root folder of your Music Collection and press the 'Menu' button and select the option 'Add to Favourites'. Press the 'F4' button on the remote to go to the Favourite page. On the Favourite page select the Icon Shortcut of the Music Collection you just made and press the 'Menu' button and select the 'Scan Folder' Option - the firmware will automatically detect the music files and then scan all the MP3 tags and build a music.db (music database) file and save it to the root folder of your collection. All non MP3 tags will be ignored. Your Music Collection can be in a nested folder arrangement. **Approx scanning time = 48 sec /1000 tracks**

Multi Codec Scanner Operation

A free Windows PC program called Tagscanner together with a special Mede8er Script is used to scan the music collection and to export the Tag information to a file named TrackList.xml. Once you have installed Tagscanner then download the Mede8er Script and copy it to the 'Script' folder in Tagscanner ie C:\Program Files\tagscan5.1.610\scripts. **Remember you still need to install the Mede8er Script.** The script download link can be found on the Mede8er Music Online Jukebox Online User Guide.

Once you have completed using Tagscanner to tag and arrange your music collection you must export the tag information to a file called Tracklist.xml. Go to 'List Maker' page in Tagscanner and select 'ALL' the files in your scanned collection and then select the Mede8er script on the right hand side and then select 'export'. The Tracklist.xml will be saved to the root of your Music Collection.

In X2 GUI Navigate to the root folder of your Music Collection and press the 'Menu' Button and select the option 'Add to Favourites'. Press the 'F4' button on the remote to go to the Favourite page. On the Favourite page select the Icon Shortcut of the Music Collection you just made and press the 'Menu' button and select the 'Scan Folder' Option - the firmware will automatically detect the Tracklist.xml file and then scan it and build a music.db (music database) file and save it to the root folder of your collection. Your Music Collection can be in a nested folder arrangement. **Approx scanning time = 20 sec /1000 tracks**

MUSIC JUKEBOX - Continued

Root of Collection

The 'Root' of the music collection is the folder that will be scanned and linked to the Favourites Page The music collection 'Root' will contain the Tracklist.xml (if used), Music.db and m3u files eg

```
Music Collection <----- Root Folder
Music Collection/Music Folder1
Music Collection/Music Folder2
Music Collection/Music Folder3 etc
Music Collection/TrackList.xml
Music Collection/Music.db
Music Collection/Playlist1.m3u
Music Collection/Playlist2.m3u etc
```



Music Box Sets / Double Albums

For Music Box Sets or Double Albums you have two options

- Different 'Album' name for each CD (each CD in their own folder)
- Same 'Album' name for all tracks (tracks for all Albums in one folder) & insert a prefix in the 'Filename' for each CD eg 1- xxxxxx 2- xxxxx for the sorting order.

Album Artist Field

To avoid the database mixing up the same Album name by different Artists we suggest you use the 'AlbumArtist' tag Another advantage of using the 'Albumartist' tag is that the Artist will be displayed after the Album name on the 'All' page and any Album based page.

Mixed Artist in a Album

For mixed Artists in a Album you must add 'Various' (or whatever name you want) to the 'AlbumArtist' tag for each track. If you do not then each Track will become a Album

Embedded Album Art

IMPORTANT: If you are using embedded art it should be optimized otherwise the V2 GUI can be very slow.

We suggest you use Tagscanner to Batch your collection

A) Open Tagscanner Setup and Select the TAG's option and change the settings as foll

- Coverart Filename -----> folder
- Custom size of covers -----> 230 x230 Quality 85%

B) On the Tagscanner GUI select the custom image option and it will display 230x230(Custom)

C) Scan your collection with Tagscanner and select all the files and select 'Save' and Tagscanner will resize all the embedded images.

The preferred method is to use a image named folder.jpg in each folder. The folder.jpg will take priority over embedded art and will also show on the Screensaver. Ideal image size is 230 x 230 pixels at 72 dpi in jpg format saved with compression setting of 85%.

For batch processing we suggest a free program Fastone Photo Resizer and for normal image manipulation, correcting aspect ratios. cropping and resizing of the folder.jpg we suggest a free program called Photoscape

Suggested 'Filename' naming convention

We suggest you use the following 'Filename' naming convention (This is not compulsory but suggested)

- a) Normal Albums %track%-%title% b) Double Albums/Box Sets 1-%track%-%title% 2-%track%-%title%

You can use Tagscanner 'Music Renamer' function to do this. Note you must firstly make sure that all the Tag Info is updated and correct before you do the Filename renaming.

MUSIC JUKEBOX - Continued

Arranging your collection

Your collection can be located on your local Hard Drive, USB Drive or Network Share. The advantage of using a Network share is that you can access one central collection with multiple Mede8er's thus making it ideal for a Multi-Room setup.

If you have a big music collection it makes sense to split it up into main categories. This gives you the advantage of being able to better manage your collection in smaller bits as you can still scan the total collection with the added advantage of separate shortcut links on the Favourite Page

So in this example you would have a main folder with sub folders

Music Backup_all
Music Backup_all/Flac
Music Backup_all/Hits_etc
Music Backup_all/Music

You can make a Favourite shortcut link to each of these folders.

Favourite Links and Scanning

Before you can 'Scan' a folder you must add it to the Favourite Page. Navigate to the Folder in the Media Library and focus on the folder you want to add and then press the 'Menu' button on the remote and select the option 'Add to Favourites'. The Favourite link will be created and if successful a confirmation 'tick' will be displayed top left of the screen. If you get a 'x' then it means the link already exists or the link cannot be made.

Press the 'Blue' button on the remote to go to the Favourite Page. Focus on the Favourite Shortcut and press the 'menu' button and you see options

Scan Folder - Scan the folder to make a Mede8er database (Music.db).

Remove - Remove the Favourite Link. This option just removes the link and does not delete the source files.

Genre - Change the default folder image into a Genre artwork image for the Favourite Link.

Lock - Lock the Favourite Link so that it is Pin Code Protected.

Unlock - Unlock a 'Locked' Favourite Link.

If you get a warning message "Set NAS to 'off' for Scan" then you must first switch 'off' the NAS function in the Setup Menu and then scan the collection.

Using the Music Jukebox

- 1) Setup -----> Misc -----> Set 'JukeBox View' to 'on' -- AutoView - We suggest you set this to 'on'
- 2) Select a Favourite Shortcut Icon and press 'Enter' -----> the Music Database will be imported and opened.
- 3) Press the 'Menu' button and you will see the list of Search options on the Menu screen

Alpha Jump

To jump to a Alpha character in the Drop List ie - Genre - Album - Artist

- a) Use the 'ABC' buttons on the Remote
- b) Use the Left Right Navigation buttons on the Remote

Music Player Page Jump

Use the Left Right Navigation buttons to jump to the next or previous page in the Music Player

QPL - Quick Play List

The 'Quick Play List' is a easy way to group and play selected Albums or Tracks. The QPL is a one time play facility and will be automatically cancelled one you exit the Music Player. Focus on a Album or Track and press the 'F2' button on the Remote Control and the QPL icon will be added to the Album or Track. To remove a QPL just focus on the Album or Track and press the 'Green' button and the QPL icon will be removed.

Once you are happy with your QPL selection press the 'Play' button and the QPL list will be loaded and you can now select the first track you want to play and the press 'Enter'.



COVER ART PREVIEW IN MEDIA LIBRARY

The Mede8er has a built in facility to preview cover art and display it in the Thumbnail or Preview View. To use this functionality you need to arrange your collection with each video in its own folder and copy a jpeg image named 'folder.jpg' size 160 x 237 pixels to each folder. You can download Movie / DVD cover art directly from the Internet or can use a free program like YAMJ to Mede8er. Y2M will additionally make the movie sheet image named 'about.jpg' that contains the content information such as Synopsis, Cover, Rating, Year, Actors etc etc Y2M is available for download from the Mede8er Forum - www.mede8erforum.com.

IMPORTANT: We recommend that you set your screen size in the Setup Menu before viewing the Movie Sheet's in full screen.



Movie Thumbnail View



Preview View



To view the Movie Sheet in full screen press the Info button.



Press the Nav Up/Down to browse by cover art

BROWSE BY MOVIE SHEET

Press the 'Info' button to show the Movie Sheet full screen. Press the Up/Down Navigation button to browse by Movie Sheet. You can launch the movie from the movie sheet by pressing the 'Enter' button.

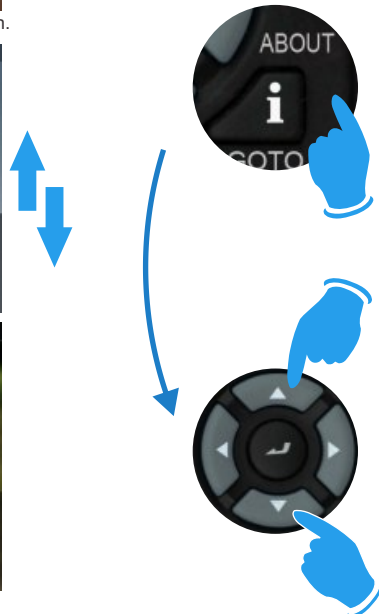

PLAY FOLDER

Mede8er allows you to play a video file within a folder without the need to open the folder. Just focus on the required folder and press the 'Play' button. The first video file found in the folder will be played. The folder play will only work with video files.

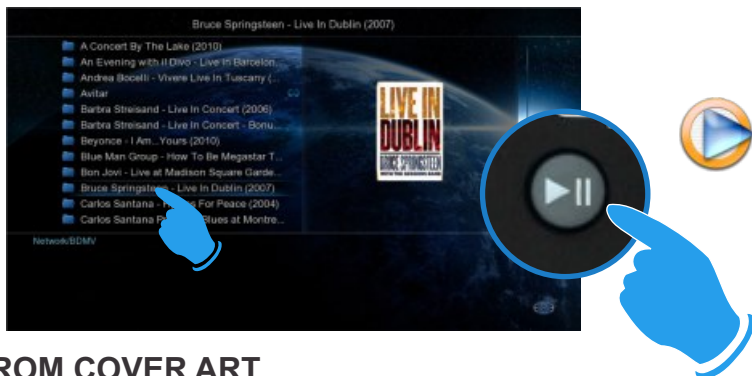

PLAY VIDEO FROM COVER ART

With Mede8er you can play the video directly from the cover art. Zoom the about.jpg by pressing the 'Info' button and then press 'Play' or 'Enter' to play the video.



WATCHED INDICATOR

Mede8er is equipped with a watched video indicator feature. To enable this function go to Setup -- Misc -- Watched Indicator and switch it 'on'. The Mede8er will mark the Video file with a eye icon once more than 10% of a video has been watched. You can also mark a video as watched or clear the watched icon manually.

Media Library - Focus on the file or folder and press the 'EDIT' button on the remote control and you will be able to add or remove the watched indicator.

Movie JukeBox - Focus on the file or folder and press the 'Menu' button on the remote control and you will be able to add or remove the watched indicator.



MEDIA SCANNER



The Mede8er has a built in Media Scanner that will scan your Media Files on your Hard Drive and USB drives and allow user functionality such as Search, Genre, Last Played etc. You can select "Auto Scan" options in the Setup menu. The Media Scanner will automatically update the database when the Mede8er is powered "on" or when an external USB Hard Drive is connected. It is important to let the scanner complete the scan if you intend to use this function. Progressive scans take less time than the original scan as only new information is added to the database. To use the Media Scanner Database information, you must select the Movies, Music or Pictures icon from the Home Page or Home Page strip and then press the "Menu" button for options. The corresponding Search Icon will be shown on the Media Library when you are in Media Search Mode. The screen layout view can be changed by selecting the 'View' button. **Note:** Only tagged mp3 music files are supported in the Media Scanner.

Movies

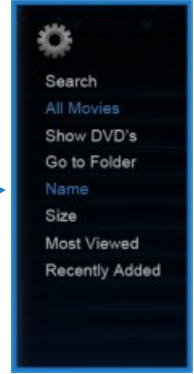

Music

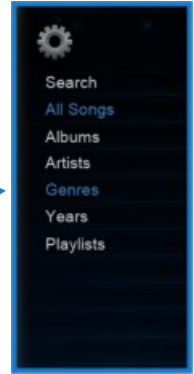

Pictures

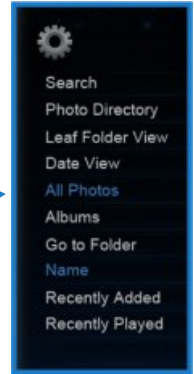

LOCK FACILITY

Mede8er has a built in Lock facility designed to restrict access.



Pin Protection - Hard Drive Format / File Manager.

Folder Protection - User Folders

You can enable or disable these options in the Setup menu

CHANGE PIN CODE - The default 4 digit Pin Code is 0000

To change the Pin Code go to Setup -- Misc -- Password -- You will be prompted to enter the existing pin code. For the first time you must enter the default factory pin '0000' and then the Pin Code change screen will open. Now enter your new personal 4 digit code by pressing the numbers on your remote. Once you have entered the code press the "ENTER" button on the remote and the new code will be saved.

PIN PROTECTION

Enable Pin Protection to protect access to the Hard Drive Format area and the File Manager functionality. Once the Pin Protection is enabled you will be prompted to enter your personal 4 digit pin code when trying to gain access to these screens.

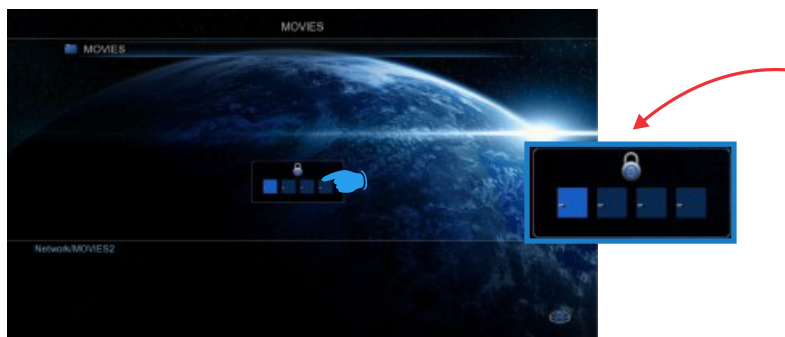

FOLDER PROTECTION

Folder protection will allow you to protect folders on a USB Drive, SD Card or Network Share (write enabled shares). To protect a folder focus on the folder and press the 'EDIT' button on the remote. Select the 'Lock' icon and the folder will be locked. To unlock a folder, focus on the folder and press the 'EDIT' button on the remote. Select the 'Unlock' icon and you will be prompted to enter your Pin Code. After the correct code is entered the folder will be Unlocked.



Lock Folder Unlock Folder

RESET PIN CODE

To reset the Pin Code re-install the latest firmware and the Pin Code will default back to '0000'

FAVOURITES MANAGER

The MED500X2 is equipped with a desktop function called Favourites. The Favourite screen is a list of 'Shortcuts' created by the users. The Favourite Link will work as a shortcut link to shared folder on your hosted USB Drive, Samba and NFS Network Share. The Mede8er Favourites screen is designed to show multiple links presented on one easy to read and manage screen. You can add or remove a Favourite Link at any time should you wish to do so.

Using the Favourites

Navigate to the file or folder that you want to add to the Favourite Screen and press the "Menu" button on the remote control. The Menu dialogue will open and you will see the option "Add to Favourites". Select this option and the folder path will be added to the Favourites screen and as a confirmation a tick icon will be shown on the top left of the screen. If the Favourite cannot be added (in the case that it already exists) you will get a failed "X" indicator on the top left of the screen.

Bootup to Favourites

You can set the X2 to Bootup to the Favourites screen. Setup ----> 'Misc' and select option 'Bootup to Favourites'

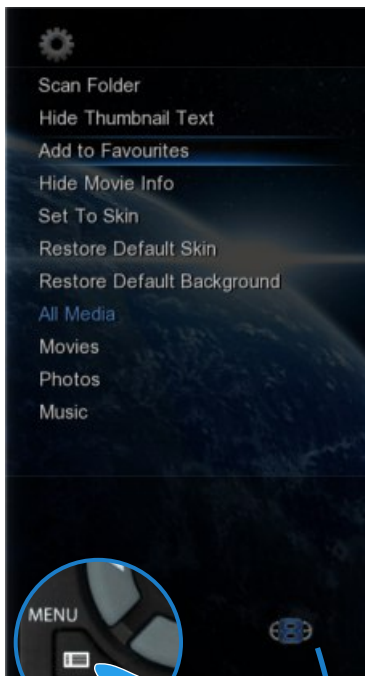

Favourite Shortcut

You can launch the Favourite screen at any time by pressing the 'Favourite' Blue button on the remote control.



ADDING GENRE ARTWORK TO FAVOURITES

You can easily add Genre artwork to each Favourite link. To add the cover artwork just focus on the Favourite thumbnail and press the "Menu" button on the remote control. The menu dialogue screen will open and now select the "Genre" option. A new screen will open with a list of cover options. Navigate to the cover you require and press the "Enter" button to make your selection. You can also use the Alpha Jump facility to jump to covers down the list. Use the same procedure to change covers.

Adding Custom Genre Art To Favourites

To add **custom Genre Covers** to flash memory.

Make a folder 'Genre' and copy up to max 50 png genre covers into this folder. 1:1 size is 117 x 172 pixels but 156 x 233 pixels work ok as well. Copy the 'Genre' folder to the Skin Folder. Focus on the Skin folder and press 'Menu' button and select 'Set to Skin' option.

Locking and Unlocking Favourites

To password protect a Favourite link press the "Menu" button on the remote control and the Menu dialogue screen will open. Select the Lock option and the link will now be Pin Code protected. To Unlock the Favourite link select the unlock option and you will be prompted to enter your 4 digit pin code and then the Link will be unlocked.

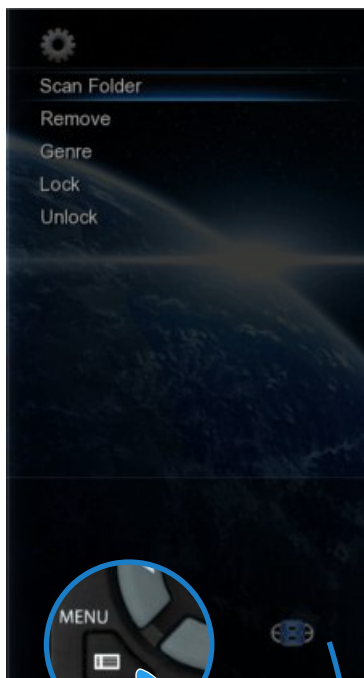

Scan XML Data

You can scan a Favourite link to build or re-build a XML Data dBase for the Movie or Music Jukebox.

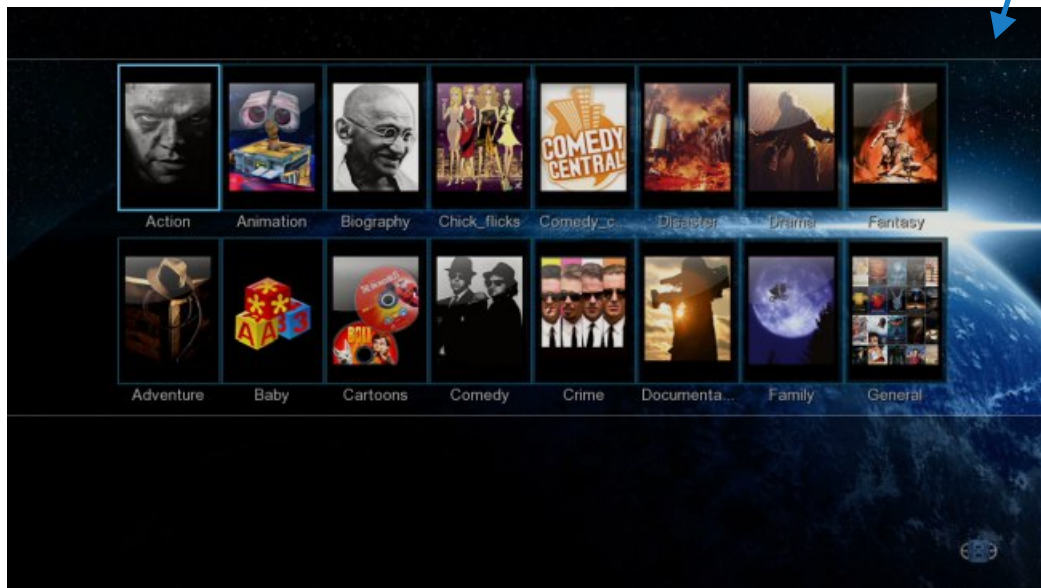

VIDEO INFO SEARCH

The Info Search allows you to easily jump to any part of the video. While viewing a Video File press the Left/Right Navigation button and the Info Screen will open on the top of the screen. Now press the Left/Right Nav and a red bar will move left or right and show the corresponding Time Position. Once you have reached the time search you require, press the "Enter" button and the Mede8er will jump to the time you selected in the Video.

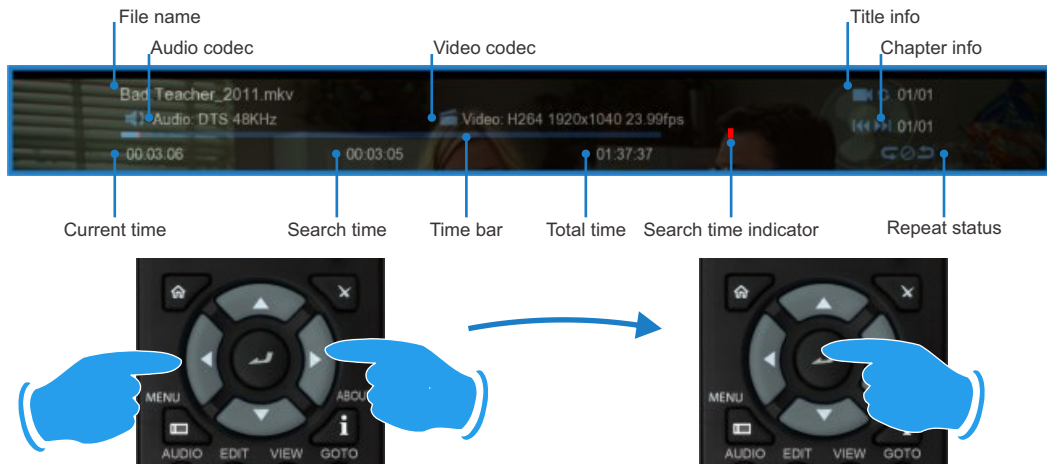

GOTO SEARCH

The GOTO Search allows you to easily jump to a specific time point or Title or Chapter in a Video file. While viewing a Video File press "Goto" button and the Goto Screen will open on the top of the screen. Now press the Left/Right Navigation button to select the function you require such as Time, Title or Chapter. Once the function is selected press the Up/Down Navigation button to select the numeric value you require and then press the "Enter" button and the Mede8er will jump to the time you selected in the Video.

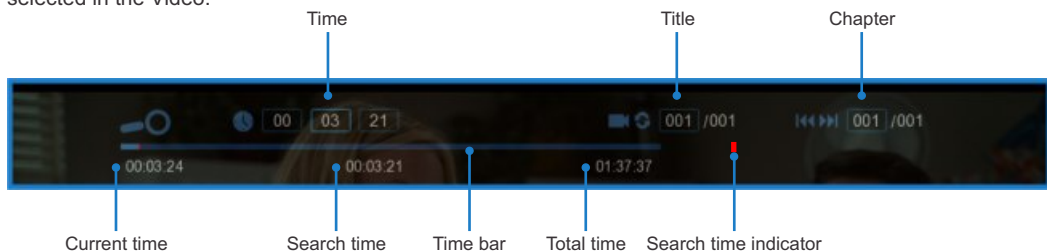

BD PLAYLIST

During BD play press the 'Menu' button and select the Playlist option. Navigate to the Playlist required and press 'Enter' button on the remote.

ALPHA JUMP

The Mede8er has a easy to use built in Alpha Jump facility. The Alpha Jump enables you to quickly jump to files and folders in your Media Library. Navigate to the Media Library and press one of the Alpha buttons on the remote control ie ABC, DEF, GHI, JKL, MNO, PQRS, TUV, WXYZ and the Alpha letter will be displayed on the top left of the screen. Press the button again and the next Alpha character will be displayed. After you have made your selection the Mede8er will jump to the first file or folder with the Alpha character you have selected.

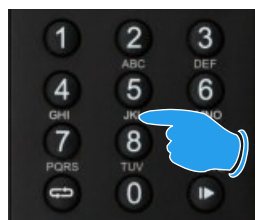

SCREEN CALIBRATION

For more accurate Zoom functionality we suggest you calibrate your TV screen. Go to System Setup then Video and select Screen Size.



Press Enter to save

Using the left, right, up and down navigation buttons you can adjust the red rectangle to fit the outer frame of your TV screen. You can then do a fine adjustment to move the red rectangle so that it is just not visible.

ZOOM

The Mede8er is equipped with advanced zoom functionality and once your screen is calibrated you can zoom intuitively to either WIDTH or HEIGHT or XY of the video.



Zoom in/out



Zoom To Height - This zoom function is designed for full screen viewing of ultra wide screen aspect videos on a 16:9 TV.



Zoom To Width - This zoom function is designed for full screen viewing of older 4:3 aspect videos on a 16:9 TV.



Zoom XY - The Zoom XY allows you to stretch the picture horizontally and vertically independent of each other. This zoom function is designed to correct videos encoded with the wrong aspect ratio. You can also use the Zoom XY to zoom to any zoom preference you may have. Once you have selected your X and Y percentage press the ENTER button on the remote to store the settings. To re-adjust the Zoom XY you need to exit and then select Zoom XY again.

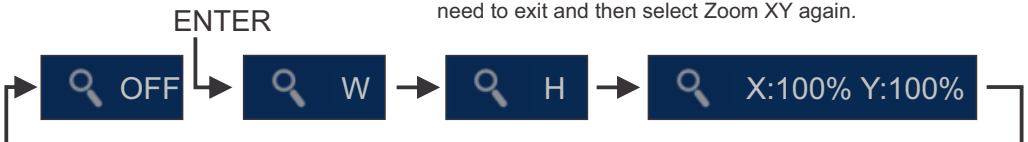

SUBTITLES

Mede8er supports various types of subtitle files. If the subtitle is embedded into the video file it will automatically be available on the Subtitle Dialogue Screen. External Subtitles must be placed into the same folder as the video file and must be named to be exactly the same name as the video file eg

Cloudy.With.A.Chance.Of.Meatballs.2009.720p.BluRay.HebDub.x264-WiKi.mkv
Cloudy.With.A.Chance.Of.Meatballs.2009.720p.BluRay.HebDub.x264-WiKi.srt

To use the Subtitle Menu you must switch 'on' Subtitle option in the Setup Menu. To access the subtitle menu press the Subtitle button on the remote during video play.

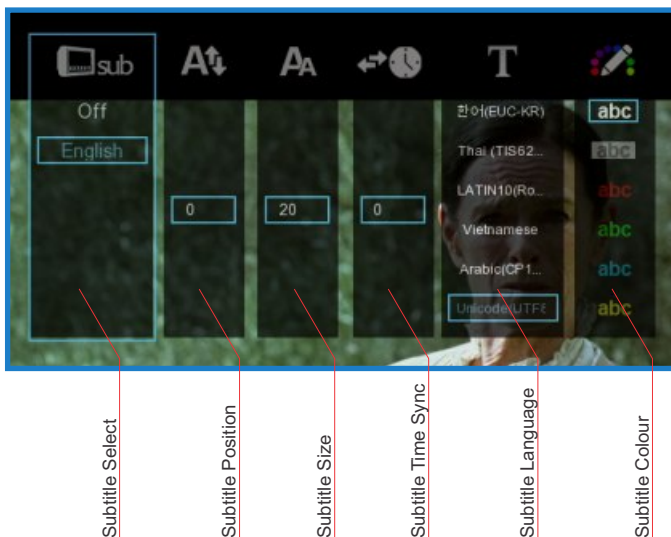

CUSTOM FONTS

You can easily customize the GUI and Subtitle fonts on the X2. Fonts must be smaller than 500KB in size. For the GUI font select a .fff font and rename it to 'gui.fff' - For the Subtitle font select a .ttf font and rename it 'Subtitle.ttf' - Copy these to the 'skin' folder if you are using a custom skin. If not you can copy these to any folder name. Navigate to this folder and press the 'Menu' button and select the 'Set to Skin' option. To reset the fonts back to the default just navigate to this folder and select the 'Restore Skin Default' option.

MUSIC PLAYLISTS

To make music .M3u playlists on your mede8er follow the steps in **FILE MANAGER - MULTIPLE FILES** section and select the playlists option.

NTFS CHECK/FIX

NTFS Check/Fix - Before you perform any File Manager functions it is suggested to use the built in NTFS check/ fix functionality. Open the 'Devices' screen and press the 'Red' button on the remote and select a Drive to check/fix. X2 will scan and fix the NTFS drive.



FILE MANAGER

The Mede8er has a built in File Manager to manage and transfer files between your media sources. The File Manager is launched by pressing the "Edit" button on the remote Control while you are Media Library.

To Copy, Delete, Move or Rename a **single file** just focus on the file (that you require to perform the action on) and press the "Edit" button on the remote control. Select the option you require and press "Enter". Follow on-screen instructions.

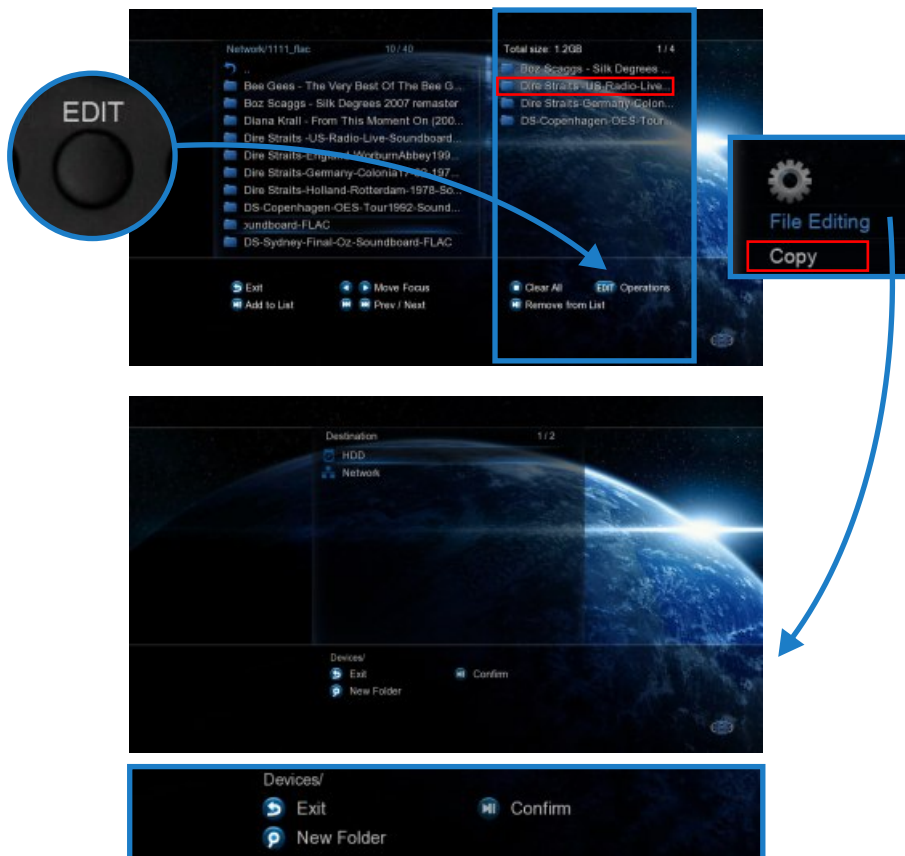

FILE MANAGER - MULTIPLE FILES

To Copy, Delete, Move or Rename multiple files just press the "Edit" button on the remote control while you are in Media Library view. Select "Multiple Select" and a new dialogue screen will open.



Navigate to the files or folders on the left screen "A" that you want to perform the action on and press the "Play/Pause" button to select and add the files to the File List "B".

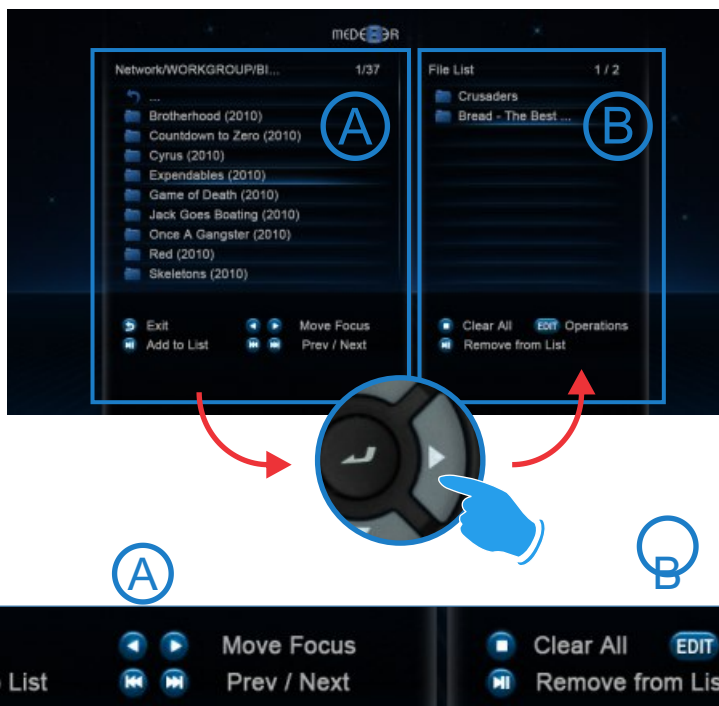

Once you have selected all the files you require then press the "Right Navigation" button. The focus will change to "B". To continue to the next step you must select the "Edit" button and then you can select one of the available options ie Copy, Delete, Move, DVD Copy, Save Playlist, Save Photo Album, Save Playlist, or Edit.

PICTURES

Press the "View" button on the remote and the View Icons will show. Press the 'View' button again to select the Picture Icon. The page will re-arrange into a image grid that is optimized for image thumbnail viewing. The X2 supports full Slideshow functions and you must enable the 'Slideshow' option in the Setup Menu. You can now navigate your pictures as normal and zoom the images to full screen by pressing the "Enter" button on the Remote Control. Once zoomed to full screen press the "Menu" button on the remote for more options.

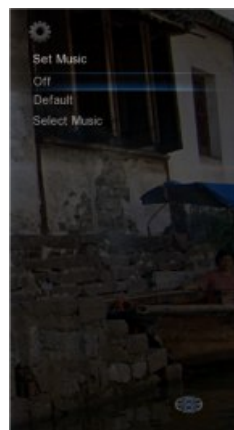
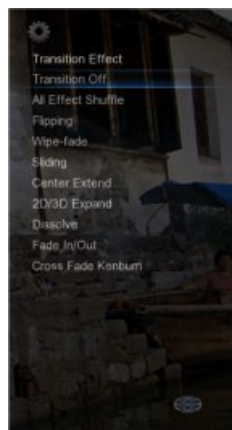
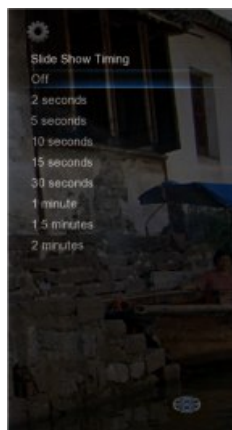
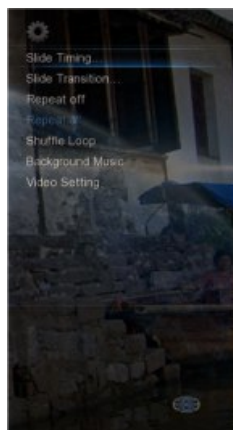

PLASMA MODE / VIDEO SCREEN TRANSPARENCY

The Plasma Mode has been designed for use with Plasma TV's that are susceptible to still image "burn in". The Plasma control will change the transparency level of the GUI screens and will not have any effect on the screens during Video Play. The Video Screen Transparency controls the transparency level of all video menus during Video Play. You have a choice of settings Off, Low or High.

AUTOPLAY

Mede8er allows for automated folder play when the Mede8er is switched on. The autoplay facility is very useful and can turn the Mede8er into a very effective low cost Digital Signage Solution.

Autoplay Function

The Autoplay files can be stored on SD Card or USB Drive.

1. Create a folder in the root of the drive named "Autoplay" (Case Sensitive)
2. Put either **Video OR Audio** files into this folder
3. If you require the files to play in order name them as following 01name - 02name - 03name - 04name - 05name - 06name - 07name - 08name - 09name - 10name - 11name up

Autoplay Operation

On power up the Mede8er will look for the "autoplay" folder and if found it will automatically play the contents of the "autoplay" folder. The contents will be played with the "Repeat All" as default. If a USB Drive is plugged into the Mede8er it will auto scan for the "Autoplay" folder and if found it will start the Autoplay function.



INTERNET MEDIA STREAMS

Internet Media consists of YouTubeXL, Picassa, Video Podcasts, Yahoo News, Shoutcast Radio, Flickr, Yahoo Finance, Facebook, Twitter, and Web Browser.

Internet Media is launched from the Home Page or Home Page strip. The Web Browser and Social Media requires a USB compatible keyboard /mouse for correct system operation. The contents of the Internet Media can change depending on legal circumstances at the time and Sanji are not responsible for external changes.

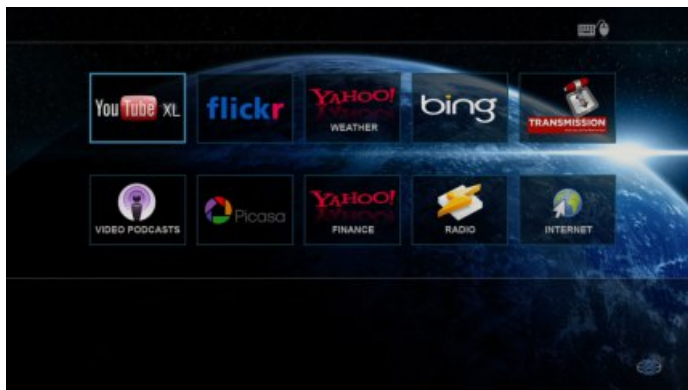

REMOTE CONTROL OVER NETWORK

The X2 supports remote control via another networked device running a DLNA Digital Media Controller. That includes Windows 7 "Play To". Please consult your own Windows Help Guide for assistance. To play media hosted on the X2 requires a UPNP Server (still in development).

Remote Control from mobile device such as a iPhone, iPad or any device that has WiFi and a built in Web Browser. Navigate to Setup Menu and enable Web Remote. Enter the Mede8er IP into your Web Browser with the correct Port number eg <http://xxx.xxx.xxx.xxx:1024> "x" is your actual IP

NFS (Network File System)

By default X2 uses Samba to stream content on a local network and this should be more than sufficient for most users. NFS can be used for higher bitrate streaming from a NAS or PC. On a Windows PC you will require a NFS client to be running on the host PC. The X2 has been tested and verified with HaneWin but other NFS Servers should work equally as well. Download HaneWin at <http://www.hanewin.net/nfs-e.htm>

NFS Mount 'Auto Scan'

X2 will Scan the NFS servers on the same IP segment, on boot up. Select the NFS tab on the Devices Page and will see all the NFS mounts that X2 located. You can make a Favourite Link from a NFS shortcut ie focus on the NFS Link and press the 'Menu' button and select option 'Add to Favourite' **Note** the NFS mount path cannot be added as a shortcut so you may need to create an extra folder as the main mount with sub folders that can be linked as X2 Shortcuts.

To "Add" "Modify" or "Delete" a NFS shortcut press the "Menu" button and the Menu screen will open. Select Add NFS Client and a "ADD NFS Dialogue" screen will open. Fill in the IP Address of the Host PC and the Share Name (Folder Path).



Recommended Settings HaneWIN
UDP NFS Server Threads : 32
Max NFS transfer size : 32768

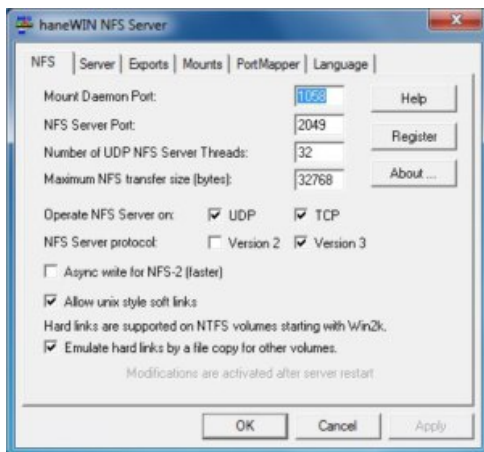

NFS (Network File System)

Additionally you can perform a manual NFS scan with 'Probe NFS' option in the NFS menu. Select this option and fill in the IP Address you require to scan and select 'Probe'. X2 will scan the IP for valid NFS mounts and then display the mounts it finds.

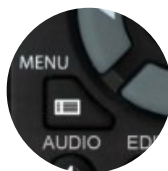
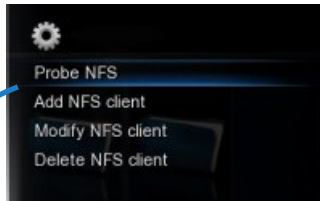
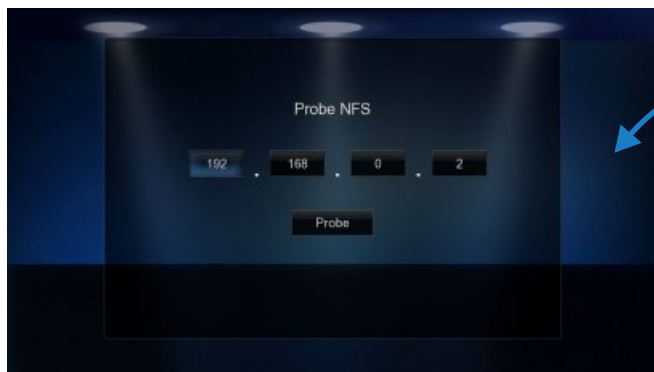

Transmission BT Downloader



WARNING: BT Downloader can use a lot of system resources we suggest you switch it off while using the Mede8er.

In order to use the Transmission BT downloader you will require as foll

- 1) Internal hard drive that have been formatted in the Mede8er.
- 2) Valid Internet Connection
- 3) PC or Mac with Wired / Wireless Network connection to the Mede8er

Navigate to the Mede8er Setup and select the "Network" tab. Now Select Transmission BT and set it to "on" Open your PC/Mac web browser and enter the URL as shown on the Transmission on/off setup screen. ie <http://xxx.xxx.xxx.xxx:9091/transmission/web/>. The xxx will be the actual IP of your Mede8er on your network. Once you enter the above into the address bar of your Browser and Enter it will open the Transmission page on the Mede8er.

a) Add Torrents

Select the "Open" Icon and screen dialogue will open. Now navigate to the torrent file on your PC and then select "Upload". The torrent file will be uploaded to the Mede8er and a progress bar will be displayed on the Transmission screen.

b) Manage Torrent Download

You can right click the download bar for available options. The main setup is located on the bottom left of the Transmission web page and here you can set options such as Download and Upload speed.

All torrent downloads will be saved to the Transmission Download folder on your Hard Drive. Note -- compressed downloads will have to be unzipped or unrared on or via your PC and only complete downloads can be played.

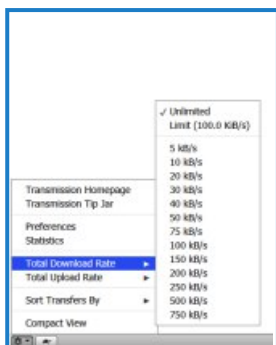
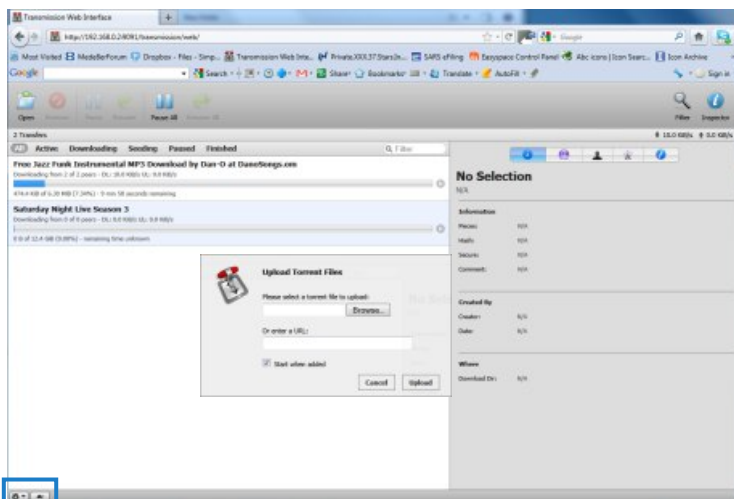

You can also open the Transmission BT page on the Mede8er's built in Web Browser **BUT THE FUNCTIONALITY WILL BE LIMITED.** You cannot add bittorrents and certain Setup setting will not work and may cause the Mede8er to crash.

Setup

Main Page

- Menu Language -- Menu Language.
- Text Encoding -- Text Encoding for Subtitles.
- Time -- Set the Time / Time Zone and daylight saving.
- DVD Auto-Play -- Option for USB DVD drive. If enabled the DVD will Auto Play when inserted.
- Screen Saver -- Set the Screen Saver time period and type of Screen Saver.
- DLNA-DMR -- Plays media from UPNP servers under the control of external devices.
- DLNA Device name -- DLNA Device name.
- MiniKBD Language -- Keyboard Language.
- Keyboard Layout -- Default US English other option for possible future update.
- Scan Storage -- Default Media Scanner for Hard Drive and USB only.
- Resume Play -- If enabled the X2 will prompt the user to continue from the last position.
- Format -- Format internal Hard Drive Option.
- BD Menu -- Switch the BD Menu option on/off -- Supported BD Profile 1.0
- Restore Default -- Reset Network and Flash memory settings.
- Auto Detect Encoding -- Auto Detect Language - Suggest to leave it off.

Audio

- Night Mode -- Dynamic Range Control limits the dynamics for night viewing.
- HDMI Output -- HDMI Output Audio output settings.
- SPDIF Output -- Optical Audio output settings.
- Surround Sound -- Settings for 7.1 or 5.1 Surround Sound.

Picture

- Aspect Ratio -- Set the Aspect Ratio size of the TV.
- TV System -- Set the Pixel Size Resolution Size of the TV.
- 1080p 24HZ -- 24HZ Frame Rate -- Enable this function if your TV supports 1080p 24HZ.
- Plasma Mode -- Changes the transparency to prevent screen burn in on Plasma TV's.
- Deep Color -- Colour Depth -- Auto - 12bit - 10bit - off.
- Screen Size -- Set the TV Screen size accurately for zooming about.jpg.

Network

- Wired Lan Setup -- Network Setup -- DHCP IP (Auto) / Fixed IP (Manual).
- Wireless Setup -- Wireless Setup -- DHCP IP (Auto) / Fixed IP (Manual).
- PCIE WiFi -- Enable or disable internal PCIE WiFi
- PPPoE Setup -- PPPoE Setup.
- Transmission BT -- Unsupported function on the MED500X2
- NAS Mode -- Enables X2 to be used as a server to other Network Connected Devices.
- UPnP Server -- If enabled other UPnP enabled devices will be able to stream content from the X2.
- Web Remote -- If enabled you can control the X2 GUI functions from a Web Browser.

Misc

- Version Info -- Information about the Firmware Version.
- Network Info -- Network connection Information.
- HDD Info -- Total size and free space on internal Hard Drive.
- USB Upgrade -- X2 firmware update from USB Flash Drive.
- Save Config -- Save your settings to USB Flash Drive before doing a firmware update.
- Restore Config -- Restore your settings from a Flash Drive after doing a firmware update.

- Folder Protection -- Protect Folders and content by means of a user pin code.
- Watched Indicator -- Eye indicator display for watched videos.
- Subtitle -- Enable or disable Subtitles
- Slideshow -- Enable or disable Slideshow functionality.

- Boot to Favourites -- If enabled the X2 will boot up the Favourites Desktop.
- JukeBox View -- If enabled the X2 will present a XML Jukebox **that is launched from Favourites** in a traditional Movie Wall View even if the content is in separate or nested folders.

- Auto View -- If enabled the X2 will remember the View of the folders you have navigated.
- Password -- Change Password



High Definition Multimedia Player

MED500X2

www.mede8erforum.com

www.mede8er.com www.mede8er.eu

For more information or support please visit
www.mede8er.eu/support/
or call +31(0)10-7142861 during business hours.



Europe: IBDL BV.

Boyleweg 10, 3208 KA Spijkenisse, Netherlands.

Tel: +31(10)7142861. Trade: sales@mede8er.eu Warranty and support: support@mede8er.eu

Sanji Electronics (Pty) Ltd

12 Saddle Drive, Woodmead Office Park, Woodmead, Gauteng, South Africa. Tel: 2711 2028160 Email sales@mede8er.com