

# ACUS-4TN PREAMP USER'S MANUAL

# Functions

## 4Band EQ with FND Tuner

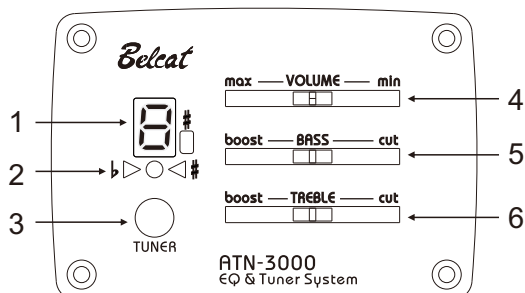

1. Tuner FND Display
2. Tuner LED Display
3. Tuner Button
4. Volume
5. Bass
6. Treble

— 1 —

### 3. Tuner Button (for Power on/off Button)

The tuner will work with or without a cable plugged into the output jack.

### 4. Volume Knob

The VOLUME controls the output volume. Turned fully counter-clockwise it is completely OFF. Turned fully clockwise it is LOUD!

### 5. Bass EQ TONE CONTROL (for bass tones)

### 6. Treble EQ TONE CONTROL (for high tones)

The BASS and TREBLE controls are a 2-band equalizer for controlling tone .  
The BASS and TREBLE tone controls are normal boost / cut shelving controls .  
The center detent on these tone controls yields a flat tone response.  
"+12" boosts the tone; "-12" cuts the tone.

### Battery

A 9-volt battery powers the ATN-3000 preamp. Before connecting the instrument to an amplifier or mixer please check that a fully charged 9-volt battery is connected.

— 2 —

## Tuner Operation

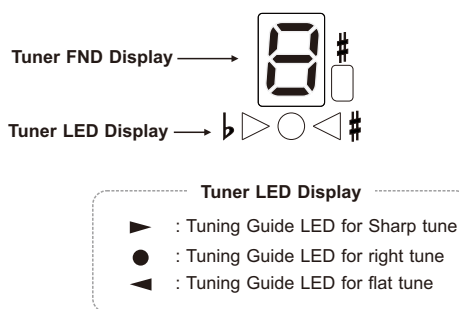

### Tuner Display

The tuner will work with or without a cable plugged into the output jack.

Pushing the tuner button turns ON the tuner. When the tuner is active the output signal is muted. No sound will go to the amplifier or mixer when the tuner is active.

Pushing the tuner button again turns the tuner OFF and the output signal will be active and sound will go to the amplifier.

If the tuner is ON and the tuner button is not pushed within 2 minutes the tuner will turn OFF automatically and sound returned to the output.

The tuner Note Readout FND Display shows the nearest note of one plucked string's sound. The Note Read Display read out shows twelve note possibilities in half steps in "sharps" (for example: A; A#; B; C; C#; D; D# and so on). For "flat" notes, for example: Bb (B flat) use A#. For Eb (E flat) use D#.

— 3 —

## Specification

### Features : 4Band EQ with FND Tuner

Input Impedance : 20MΩ

Output Impedance : 1KΩ

### Control Range :

Bass : [±12dB at 80Hz]

Middle : [±12dB at 800Hz]

Treble : [±12dB at 3KHz]

Presence : [±12dB at 15KHz]

### Tuner Function :

Auto Chromatic Tuning

### Battery Life : Pre-amp only,

Tuner off : 700Hours @ 0.7mA

Tuner on with signal : 40Hours @12mA

### Power Supply : 9V Alkaline Battery

Low Battery Check LED

Pick-up : OMEGA-II (Piezo Cable pick-up)

Dimension : W 72mm X D 50mm  
(2.8" X 1.9")

## Caution

- The jack should be plugged for proper Preamp working.  
(TUNER will works regardless plugging jack)
- There is no output sound, please check if tuner or mute is turned on.
- When LCD screen is dim or no display, please check battery life.
- To prevent battery loss, please unplug jack when preamp is not in use.
- Do not disassemble for repair.  
Return to your dealer for service or repair.
- Do not use too much force when operating the control.

**Belcat®**

BELCAT Co.,Ltd.

Tel: +86 752 355 7545

Fax: +86 752 355 2460

Email: belcat@belcat.com

Internet: www.belcat.com



— 4 —

# INSTALLATION MANUAL

## 1. Contents

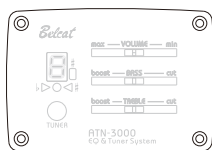

1. Preamp

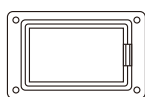

2. Battery Box

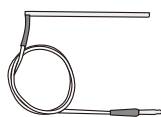

3. Pick-Up



4. Output Jack



5. Clip



6. Screw

## 2. Tool



1. Electric Drill



2. Drill Bit  
(2.3mm or 3mm)



3. Phillips Screwdriver



4. Router and Grinder  
(cutting-edge 3mm)



5. Round File



6. Masking Tape

## 1. Cut out the hole with template

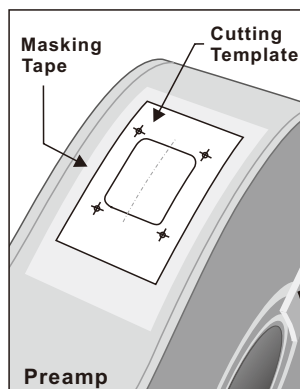

## 2. Cut out the hole with Battery Box

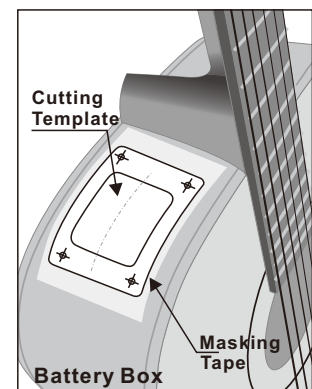

## 3. Drilling hole for Jack

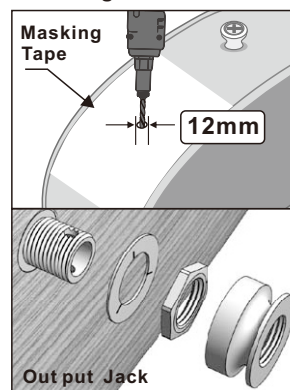

## 4. Drilling hole for pick-up

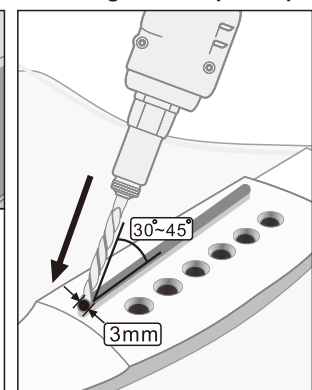

5. Insert EQ and battery box into hole of guitar.
6. Fasten screws properly.

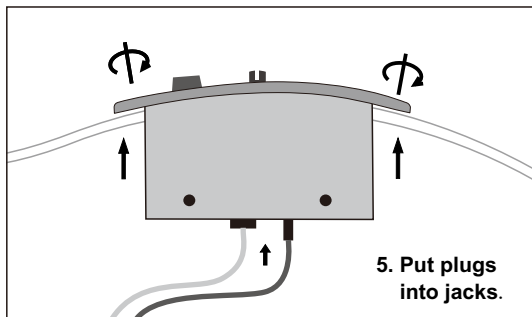

5. Put plugs  
into jacks.

## 8. Fix wire with clip.

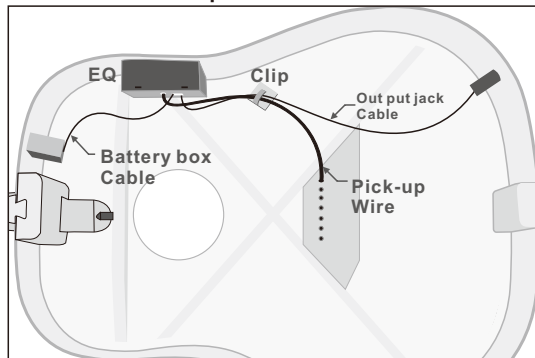

## 7. Installing the pick-up

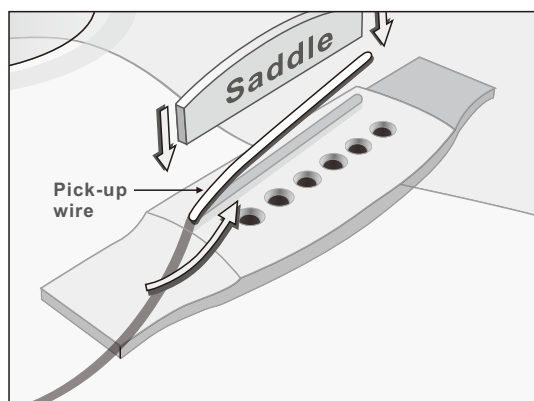

## Solution

- 1) When there is no sound or sound is stopped,
  - Check guitar cable, amp or Mixer
  - Check if there is batter or not. When it happens noise or distortion, please exchange battery.
  - Check if the pickup and battery connector is connected correctly or not.
  - Check if out put jack is connected correctly.
- 2) When there is hum-noise,
  - Check the pickup is connected well or not.
  - Check if the connectors are connected to correct position well or not.
- 3) Some causes of the balance problem
  - When the bottom of saddle or the groove of saddle is not flat.
  - When saddle is installed to the groove of saddle loosely.
  - When the connection is not good between the bottom of saddle and the groove of saddle.
  - When Saddle is very short
  - When there is grounds on the groove of saddle.
  - When Saddle is declined toward front or back.
  - When the top of guitar is bended.
  - When the pickup is installed to only a part of the groove of saddle.