

# BABY WATCH

G-BCAM-01



AUS GUTEM GRUND

**GRUNDIG**

# SAFETY AND INFORMATION

---

## Safety

- This device should not replace parental supervision of your children. It is designed to assist you as parents for supervision of your children.
- In order to avoid the risk of choking with power cable, the video camera should be installed out of reach of children.
- This video camera is not a toy; do not let the children play with it.
- This device is for transmission of image/sound signals within a house or building. Any other use is strictly prohibited.
- Protect the camera against rain, humidity (dripping or splashing) and heat (temperature, direct sunlight, etc.).
- Use the camera only under average weather conditions. Do not use the device under direct sunlight for a long time.
- Do not drop the camera.
- Never supply power to the "DIR/DO" sockets.
- Do not dismantle the camera body under any circumstances. Warranty claims are excluded for damage resulting from improper usage.
- Do not use any cleaning agent during the cleaning process as these may damage its body. Wipe the camera with a clean and dry cloth.
- Unplug the device before cleaning.
- Use the power supply delivered with the product only.

## BABYWATCH

Monitoring camera ensures you to keep an eye on your children.

For this, you need a local network access and a GRUNDIG television on which the "BABYWATCH" application is installed.

## Information about the camera

- 3 Megapixel resolution.
- Large pivot range and wide angle of inclination.
- Supports IEEE 802.3 Ethernet Standard.

### Notes:

- When the camera is used with wireless network connection, audio/video quality may be impaired.
- When the television is switched off or the BABYWATCH application has not been started in any mode yet, no sound or video image can be received from the camera.

# OVERVIEW

---



# OVERVIEW

---

- A** Camera lens and its cover.
- B** Brightness sensor determines the brightness of the location of the camera.
- C** Infrared LEDs turn on if the brightness at this location is not sufficient (Night Vision mode).
- D** Adjustment Ring is used to correct the image clarity.
- E** Microphone.
- F** LAN Indicator
  - on: it means that the LAN connection is activated;
  - flashes: it means that data transfer is in progress;
  - off: it means that the LAN connection is deactivated.
- G** Operation LED, turns on when the camera is in operating.
- H** WLAN antenna input socket.
- I** **Ethernet**, it is a socket to connect to the home network with a LAN cable.
- J** **DO ... DIR**, no function.
- K** **WPS/Reset**, is the button to record the camera to the router; (If Router WPS supports, you can make wireless connection by pressing and holding the button on the camera for 3 to 10 seconds while pressing the WPS buttons on the router concurrently).  
in order to reset the camera to its factory defaults, press and hold the button for more than 10 seconds; all settings will be deleted.
- L** **SD**, no function.
- M** **DC 12V**, is a connection socket for the power supply delivered with the device.
- N** **Audio Out**, no function.

# ASSEMBLY AND CONNECTION

You can position your GRUNDIG camera in a suitable place or mount it onto the wall. Packaging of the device contains an mounting bracket and fixing elements.

## Wall mounting

### Notes:

- Base unit should be fixed and it should draw the static load.
- For the wall superstructures, for example for the wooden or hollow walls, use appropriate plugs and screws. For suggestions, please consult your authorised dealer.
- Installation place should be near a power outlet.
- If the camera is not to be fixed, the bracket (B) and fixings are not required. Please start from step 6.

- 1 Remove the safety screw in the mounting bracket (A) and loosen the connection fittings (B).

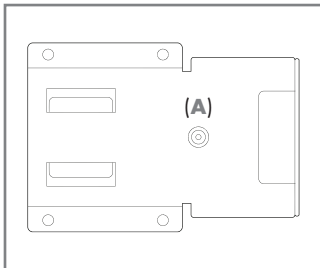

- 2 Insert the fixing (B) to the camera base and tighten it with the supplied screws (C).

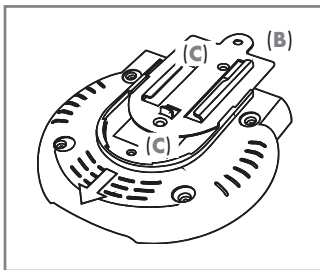

- 3 Determine the installation place of the camera and mark the places where holes will be drilled on the wall by using the mounting kit.

## ASSEMBLY AND CONNECTION

4 Drill the holes on the wall and insert the given plugs into these holes.

5 Fix the mounting bracket with the 4 supplied screws to the wall.

6 For the WLAN operation, screw the WLAN antenna onto the device;

or

for LAN operation, connect the LAN cable to the »Ethernet« socket.

### Note:

- LAN cable is supplied with the device.

7 Plug the power cable to the »DC 12V« socket.

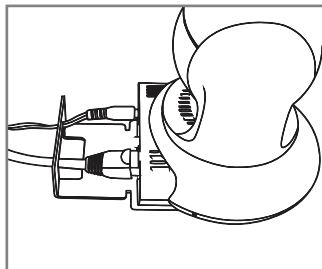

8 Adjust the camera position onto the mounting bracket and tighten the safety screw (A).

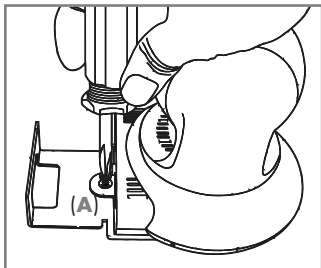

9 Plug the DC 12V adaptor to the wall socket.

- Operation LED lights up soon and the camera tests the motors automatically.

10 Connect the LAN cable to an unused socket on the modem or router.

### Warning:

- Do not connect the camera to the LAN input of the television set. Camera and television should be connected to each other over modem or router as to be on the same network.

### Notes:

- Remove the lens cover.
- Adjust the camera to the observation position by using the buttons on the remote control.
- See Adjusting Sharpness section on page 27 to adjust image sharpness.

# NETWORK INSTALLATION

## Connect the camera to the home network and sign in

In order to ensure that the camera view is displayed on your TV screen over the "BABYWATCH" application, your TV and Camera should be connected to the same network.

You can connect your camera to the home network with the cabled "LAN" or wireless "WLAN" connection.

If you are using a cabled "LAN" connection, please refer to the part titled "Connection of the camera with the LAN connection..." in this section;

If you want to use a wireless network "WLAN", follow the instructions described in the section "Operation on the Wireless Network" "WLAN".

### Warning:

- Malicious software may penetrate through your personal local network via Internet and abuse your audio-visual files. For such situations, secure your personal local network. Ensuring the security of the personal local network is under the responsibility of the user.

## Connection of the camera with a LAN connection and signing in

### Note:

- Many home networks are Dynamic Networks. If you have a dynamic network, you must use a DSL modem that supports DHCP. If the DHCP server of the modem does not work, the camera cannot receive an IP address.

- 1 Switch on your television.
- 2 Select the »Quick Apps« menu with »@«.
- 3 Select the »BabyWatch« application with »▼« or »▲« and confirm with »OK«.
  - »Help« page will be displayed soon which shows how the installation will be made.

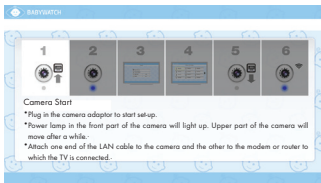

- 4 With the »←«, exit the »Help« page.
  - Settings page will be displayed.

# NETWORK INSTALLATION

---

5 Select the »Search Camera« line with »▼« or »▲« and confirm it with »OK«.

- After a while, the found camera icon and IP address will be displayed.

## Note:

- If camera search fails;  
For detailed search, press »\*« (red);  
or  
if the detailed search fails too, for Manual IP entry, press »\*\*« (green).

6 Confirm the found camera with »OK«.

- »Add Camera« menu will be displayed.

7 In order to display the on-screen keyboard, press »OK«.

## Notes for data entry:

- Data are entered with the pop-up keyboard. Select the necessary letters/numbers with »▼«, »▲«, »<« or »>« and confirm with »OK«.
- To toggle between uppercase and lowercase letters, select »Shift« and confirm with »OK«.
- Keyboard mode can be changed by pressing »\*« (red).
- You can change the language of the keyboard/key assignments with »\*\*« (green).

- Last character/number can be deleted with »●●●●« (blue).

All entries can be deleted with »●●●« (yellow).

- If the entry of the current line is completed, close the keyboard with »←«.

8 Enter and save the name of the camera according to your preference as explained in the notes about data entry.

9 Select the »Password« line with »▼« and open the pop-up keyboard with »OK«.

## Notes:

- Camera password has been set as »admin« as standard factory default.

- We recommend you to use a password belonging to you, see page 31 "Settings" section.

10 Enter and save »admin« password as explained in the notes about data entry.

11 Select the push button »OK« with »▼« and confirm with »OK«.

- "Live streaming" of the camera is shown on the screen.

## Note:

- If the modem is switched off and on, IP address of the camera may change, then repeat the steps from 5 to 11.



# NETWORK INSTALLATION

---

## Registration of the Camera via the Wireless Network "WLAN"

### Notes:

- In order to make the wireless network "WLAN" settings, first camera should be connected to the router over the cabled local area network.
- Many home networks are Dynamic Networks. If you have a dynamic network, you must use a DSL modem that supports DHCP. If the DHCP server of the modem does not work, the camera cannot receive an IP.

- 1 Switch on your television.
- 2 Select the »Quick Apps« menu with »@«.
- 3 Select the »BabyWatch« application with »▼« or »▲« and confirm with »OK«.
  - "Live streaming" of the camera is shown on the screen.
- 4 While "live streaming" is shown on the screen, select the »Settings« menu with the »●« (red).
- 5 Select the »Camera Settings« line with the »▼« or »▲« and confirm with »OK«.
  - The camera which is connected to the network via cabled "LAN" is displayed on the screen.
- 6 Enter the camera settings with »OK« and select the »Set Wireless Connection« line with the »▼« or »▲« and confirm with »OK«.
  - After a while, available wireless networks will be displayed on the screen.
- 7 Select the wireless network which the TV is connected to by using »▼«, »▲« »◀« and »▶« and confirm with »OK« button.
  - Network name and entrance menu with password will be displayed.
- 8 Select the »Password« line with the »▼« or »▲« and press »OK«. Enter by using the keyboard the wireless network password and close the keyboard with »◀«.
- 9 Select »Yes« push button with »▼« and confirm with »OK«.
- 10 To return to the »Settings« menu, press »←«.
- 11 Remove the Network cable. LAN led on the camera will flash quickly.
  - Wireless network connection is made now.
- 12 In order to view the "live streaming" of the camera on the screen, press »●« (red).

# OPERATION OF THE CAMERA

## Adjusting the Image sharpness

- 1 Adjust the image sharpness by using the adjustment ring on the camera lens.

## Selecting the viewing mode

- 1 While "live streaming" is displayed on the screen, select the »Application View Mode« menu with »@«.

- Options:



Full Screen Mode - "live streaming" is displayed as "full screen";



Widget Mode - "live streaming" is displayed as a small image in the valid television show.

Dimension and position of this small image can be selected;



Notification Mode - streaming is displayed only when a movement is made or a sound is transmitted.



My Applications - function ends and the device returns to the »Quick Apps« menu or »My Applications« page;



Close - function ends and the device returns to the current television show.

- 2 Select the desired mode with »<<« or »>>« and confirm with »OK«.

## Changing the camera angle

Camera angle can be set to the Full Screen Mode for the "Live streaming".

- 1 Select the »Application View Mode« with »@«.
- 2 Select the »Full Screen Mode« with »<<« or »>>« and confirm with »OK«.
- 3 Adjust the desired camera angle with »v«, »^«, »<<« or »>>«.

### Note:

- The camera can be reset to the starting position (90° horizontal/vertical). To do this: select the »Settings« menu with »●« (red), select the »Camera settings« row with »v« or »^« and confirm with »OK«. Press »OK« again, select the »Reset Position« row with »v« or »^« and confirm with »OK«. Close the settings menu with »<<« and switch to the "live streaming" with »●« (red).

# OPERATION OF THE CAMERA

---

## Selecting the position of the inset picture

In the Widget mode you can select the position at which the inset image is displayed on the screen.

- 1 Select the »Application View Mode« with »@«.
- 2 Select the »Widget Mode« with »<« or »>« and confirm with »OK«.
- 3 Select the desired location with »v«, »^«, »<« or »>«.

## Selecting the dimension of the inset picture

You can select the dimension of the inset image to be displayed on the screen from the Widget mode.

- 1 Select the »Application View Mode« with »@«.
- 2 Select the »Widget Mode« with »<« or »>« and confirm with »OK«.
- 3 To decrease the size of the inset image press »●« (red) and to increase its size press »●●●●« (blue).

## Turn the picture – vertically

- 1 While "live streaming" is shown on the screen, turn the picture vertically with »●« (green).

## Turn the picture – horizontally

- 1 While "live streaming" is shown on the screen, turn the picture horizontally with »●« (yellow).

## End the Babywatch function

- 1 Select the »Application View Mode« with »@«.
- 2 Select »Close« with the »<« or »>« and confirm with »OK«.

# SETTINGS

---

## Notification mode options Deactivation/Activation of the Motion Detection Function

- 1 While "live streaming" is shown on the screen, select the »Settings« menu with »●« (red).
- 2 Select the »Detection Settings« line with ▼« or »▲« and confirm with »OK«.  
– Menu is displayed.
- 3 If the notification should be made only by sound, select the »x« character in the box next to the »Enable Motion Detection« with ▼« or »▲« and delete it with »OK«.  
– Motion detection is disabled.

### Note:

- In order to restart the video monitoring, select the box with ▼« or »▲« and adjust the »x« character with »OK«.

## Motion detection settings

- 1 Select »Ambient Light« with ▼« or »▲« and select either »Lightness« or »Darkness« with »<« or »>« depending on the condition of the environment.
- 2 Select the »Movement Sensitivity (%)« line with the ▼« or »▲« button and adjust the sensitivity with »<« or »>« .

- 3 Select the »Movement Rate (%)« line with the ▼« or »▲« button and adjust the movement rate with »<« or »>«.

### Note:

- Movement rate is the proportion of the size of the moving object to the movement area. When this value is selected higher, detection will be enabled upon movement of large objects. When this value is selected lower, detection will be enabled upon movement of small objects
- 4 To adjust the area of detection, select »Movement Window« line with ▼« or »▲« button and confirm with »OK« button. By using ▼«, »▲«, »<« or »>« button, select the position of the detection window. With »●« (red), »●●« (green), »●●●« (yellow) and »●●●●« (blue) buttons adjust the dimensions of the detection window. To end the setting process, press »←« button.

# SETTINGS

---

## Deactivation/Activation of the Sound Detection

- 1 If the notification should be only made by video monitoring, select the »x« character in the box next to the »Enable Sound Detection« with »V« or »^« and delete it with »OK«.
  - Sound detection is disabled.

### Note:

- In order to restart the sound detection, select the box with »V« or »^« and adjust the »x« character with »OK«.

## Adjusting the sound sensitivity

- 1 Select the line »Sound Sensitivity« with »V« or »^«.
- 2 Select the sensitivity level with »<« or »>«.

## Setting the period of time the notification will be displayed on the screen

- 1 Select the line »Event Display Time« line with »V« or »^«.
- 2 Select the desired option with »<« or »>«.

## Saving the Settings

- 1 Select the push button »OK« with »V« or »^« and confirm with »OK«.

### Note:

- If the changes will not be saved, select the push button »CANCEL« with »V« or »^« and confirm with »OK«.

## Displaying and reporting notifications

- “Live image” is displayed subject to the selected setting and the “action” in the room being monitored. In that case, a message will be displayed:
- High sound detected.
  - Movement detected.

# SETTINGS

---

## Changing the password

- 1 While "live streaming" is shown on the screen, select the »Settings« menu with »●« (red).
- 2 Select the »Camera Settings« line with »▼« or »▲« and confirm with »OK«.
  - Connected camera is viewed.
- 3 Go to the camera settings with »OK«.
- 4 Select the »Change Password« line with »▼« or »▲« and confirm with »OK«.
- 5 Press »OK« and enter and save the current password using the keyboard.
- 6 Select the »New Password« line with »▼« or »▲« and confirm with »OK«.
- 7 Enter a new password (max. 22 characters) and confirm it.
- 8 Enter the »Retype Password« line with »▼« or »▲« and confirm with »OK«.
- 9 Enter the new password again and confirm it.
- 10 Select the push button »Change« with »▼« or »▲« and adjust it with »OK«.

## Note:

- If the new password will not be saved, select the push button »Cancel« with »▼« or »▲« and confirm with »OK«.

## Selecting the image transmission type

- 1 While "live streaming" is shown on the screen, select the »Settings« menu with »●« (red).
- 2 Select the »Video Type« line with »▼« or »▲«.
- 3 Select the desired »mjpeg« or »rtsp« image transmission type with the »◀« or »▶«.
  - »mjpeg« - Video codec with compressed image (recommended for the WLAN connected works);
  - »rtsp« - Real time transmission and minimum compression video codec (recommended for the LAN connected works).

## Note:

- If you face problems with »rtsp« on wireless connection, change your setting to »mjpeg«.

# SETTINGS

---

## Selecting the background image for the menu

- 1 While "live streaming" is shown on the screen, select the »Settings« menu with »●« (red) button.
- 2 Select the »Theme« line with »▼« or »▲«.
- 3 Select the desired background image with »◀« or »▶«.

## Searching for the other cameras in the local network

- 1 While "live streaming" is shown on the screen, select the »Settings« menu with »●« (red).
- 2 Select the »Search Camera« line with »▼« or »▲« and confirm it with »OK«.
  - After a while, icons of the found cameras and IP address will be displayed.

## Selecting other cameras in the local network

- 1 While "live streaming" is displayed on the screen, select the »Settings« menu with the »●« (red).
- 2 Select the »Camera Settings« line with »▼« or »▲«.
  - Icons of all of the cameras connected to TV and their IP addresses will be displayed.
- 3 Select the camera which you want to view with »▼«, »▲«, »◀« or »▶« and go to the camera settings with »OK«.
- 4 Select the »Start Stream« line with »▼« or »▲« and confirm with »OK«.
  - "Live streaming" of the camera is shown on the screen.

# INFORMATION

## Service notes for the authorized sellers



BabyWatch set may only be operated with the power cable/adaptor supplied with the set. This product meets the following EU requirements:

Energy consumption values and classes were determined in accordance with specifications 2009/642, 2010/1062 and also guidelines EN62087 and EN62301 pursuant to directives 2009/125/EC and 2010/30/EU from the European Union.

Grundig declares that this product complies with the EU Regulation 1999/5/EC and 2011/65/EU. Complete and accurate text of the Declaration of Conformity (DOC) can be accessed via the GRUNDIG page on [www.grundig.com/download/doc](http://www.grundig.com/download/doc).

This device can be used in the following countries without any limitations.

AT	BE	BG	CH	CY	CZ	DE	DK
EE	ES	FI	FR	GB	GR	HU	IE
IS	IT	LI	LT	LU	LV	MT	NL
NO	PL	PT	RO	SE	SI	SK	TR

This device can also be used in the countries outside Europe. Please be advised of the following limitations for the following countries:

### For the customers in France:

Outdoor use of the device is limited with 10 mW EIRP at 2454 - 2483.5 MHz frequency range. Use for the military radio positions. Re-regulation of the 2.4 GHz frequency was put into effect in recent years in order to allow the current less stringent regulation. Transition to the full implementation has been planned as 2012

### For the customers in Italy:

For the private uses apart from the personal houses, there is general approval requirement for public use.

### For the customers in Norway:

This subparagraph is not valid for the geographical area up to 20 km from the center of NyÅlesund.

### For the customers in Russia:

- FHSS modulated SRD**
  - Maximum 2.5 mW EIRP.



# INFORMATION

- Maximum 100 mW EIRP. For the collection of and compliance with the telemetry data and the calculation systems, the device is allowed to be used in the outdoors where it is located (at the same height) without any limitation. In the similar practices which are listed above, the location (height) of the device should not exceed 10 m.
- For indoors, it is maximum 100 mW EIRP.

## 2. Other broadband modulation systems such as SRD with DSSS and FHSS

- Maximum average value EIRP, signal density at 2 mW/MHz. Maximum 100 mW EIRP.
- Maximum 100 mW EIRP. For the collection of and compliance with the telemetry data and the security systems, the device is allowed to be used in the outdoors where it is located (at the same height) without any limitation.
- Maximum average value EIRP, signal density at 10 mW/MHz. Maximum 100 mW EIRP Indoors.

## For the customers in Ukraine:

EIRP  $\leq$  100 mW with integrated antenna and amplification factor up to 6 dBi

## Environmental note



This product has been made from high-quality parts and materials which can be re-used and

recycled.

Therefore, do not throw the product away with normal household waste at the end of its life. It should be disposed of in a collection point for recycling electrical and electronic devices. This information is indicated by a symbol on the product, in its user manual and on its packaging.

For information about the collection points, please refer to your municipal officials.

By recycling used devices, you make a significant contribution to the protection of our environment.

## Technical data

### Power supply:

DC 12 V, 2 A

### Dimensions and weight:

W x H x D: 105 x 123 x 107 mm

Weight: approx. 305 g

We reserve the right to make technical and optical modifications.