Built-in Conventional Oven

LAM3204



User & Installation Guide

LAMONA

Exclusive to Howdens Joinery Co.

using this manual

Thank you for choosing LAMONA Built - In Oven.

This user Manual contains important information on safety and instructions intended to assist you in the operation and maintenance of your appliance.

Please take the time to read this Owner's Manual before using your oven and keep this book for future reference.

The following symbols are used in the text of this Owner's Manual:



WARNING or CAUTION



Important



Note

safety instructions

Installation of this oven must be performed only by a licensed electrician. The installer is responsible for connecting the appliance to the mains power supply in observance of the relevant safety recommendations.

WARNING

 **WARNING: FIRE RISK** - Do not place aluminium foil, baking trays or cook on the base of this oven, doing so will cause permanent damage to your appliance and cabinetry with the potential risk of fire

This appliance is not intended for use by persons (including children) with reduced physical, sensory or mental capabilities, or lack of experience and knowledge, unless they have been given supervision or instruction concerning use of the appliance by a person responsible for their safety.

Children should be supervised to ensure that they do not play with the appliance.

DO NOT COOK DIRECTLY ON OVEN BASE
DO NOT LINE CAVITY OR COVER OVEN BASE WITH ALUMINIUM FOIL this can cause overheating and potential damage to the oven and housing.

If the supply cord is damaged, it must be replaced by the manufacturer, its service agent or similarly qualified persons in order to avoid a hazard. (power cord type model only)

Appliance should allow for electrical isolation of the appliance from the supply after installation. The disconnection may be achieved by having the switch accessible or by incorporating a switch in the fixed wiring in accordance with the wiring regulations.

During use the appliance becomes hot. Care should be taken to avoid touching heating elements inside the oven.

⚠ **WARNING:** Accessible parts may become hot during use. Young children should be kept away.

A steam cleaner is not to be used.

⚠ **WARNING:** Ensure that the appliance is switched off before replacing the lamp to avoid the possibility of an electric shock.

Do not use harsh and abrasive cleaners or sharp metal scrapers to clean the oven door glass as they can scratch the surface, which may result in the shattering of the glass.

⚠ **WARNING:** The appliance and its accessible parts become hot during use.
Care should be taken to avoid touching the heating elements.
Children under the age of 8 should be kept away from the appliance unless when continuously supervised.

This appliance can be used by children aged from 8 years and above and persons with reduced physical, sensory or mental capabilities or lack of experience and knowledge if they have been given supervision or instruction concerning use of the appliance in a safe way and understand the hazards involved. Children shall not play with the appliance. Cleaning and user maintenance shall not be made by children without supervision.

The temperature of accessible surfaces may be high when the appliance is operating.

The door or the outer surface may get hot when the appliance is operating.

Keep the appliance and its cord out of reach of children younger than 8 years of age.

Appliances are not intended to be operated by means of an external timer or separate remote-control system.

Please put the bent up frame side to the back, in order to support the reposition when cooking big loads. (Depending on model)



CAUTION

If the oven has been damaged in transit, do not connect it.

This appliance must be connected to the mains power supply only by a qualified electrician.

In the event of a fault or damage to the appliance, do not attempt to operate it.

Repairs should be performed by a qualified technician only. Improper repair may result in considerable danger to you and others. If your oven needs repair, contact a LAMONA Service Centre or your dealer.

Electrical leads and cables should not be allowed to touch the oven.

The oven should be connected to the mains power supply by means of an approved circuit breaker or fuse. Never use multiple plug adapters or extension leads.

The power supply of the appliance should be turned off when it is being repaired or cleaned.

Take care when connecting electrical appliances to sockets near the oven.

This oven has been designed for the cooking of household foods only.

During use, the oven interior surfaces become hot enough to cause burns. Do not touch the heating elements or interior surfaces of the oven until they have had time to cool.

Never store flammable materials in the oven.

The oven surfaces become significantly hot when the appliance has been operational for long periods of time at high temperatures.

When cooking, take care when opening the oven door as hot air and steam can escape rapidly.

When cooking dishes that contain alcohol, the alcohol may evaporate due to the high temperatures and the vapour can catch fire if it comes into contact with a hot part of the oven.

For your safety, do not use high-pressure water cleaners or steam jet cleaners.

Children should be kept at a safe distance when the oven is in use.

Frozen foods such as pizzas should be cooked on the Big grid. If the baking tray is used, it may become deformed due to the great variation in temperatures.

Do not pour water into the oven base when it is hot. This could cause damage to the enamel surface.

The oven door must be closed during cooking.

Do not line the oven base with aluminium foil and do not place any baking trays or tins on it. The aluminium foil blocks the heat, which may result in damage to the enamel surfaces and cause poor cooking results.

Fruit juices will leave stains, which can become indelible on the enamel surfaces of the oven.
When cooking very moist cakes, use the deep pan.

Do not rest bakeware on the open oven door.

Young children should be supervised to ensure that they do not play with the appliance.

Keep children away from the door when opening or closing it as they may collide with the door or catch their fingers in the door.

Do not step, lean, sit or place heavy material on the door.

Do not open the door with unnecessarily strong power.

 **WARNING:** Do not disconnect the appliance from the mains power supply even after the cooking process is complete.

 **WARNING:** Do not leave the door open while the oven is cooking.



CORRECT DISPOSAL OF THIS PRODUCT (WASTE ELECTRICAL & ELECTRONIC EQUIPMENT)

(Applicable in countries with separate collection systems)

This marking on the product, accessories or literature indicates that the product and its electronic accessories (e.g. charger, headset, USB cable) should not be disposed of with other household waste at the end of their working life. To prevent possible harm to the environment or human health from uncontrolled waste disposal, please separate these items from other types of waste and recycle them responsibly to promote the sustainable reuse of material resources.

Household users should contact either the retailer where they purchased this product, or their local government office, for details of where and how they can take these items for environmentally safe recycling.

Business users should contact their supplier and check the terms and conditions of the purchase contract. This product and its electronic accessories should not be mixed with other commercial wastes for disposal.

installation

Safety instructions for the installation

This oven may be installed only by a qualified electrician. The installer is responsible for connecting the appliance to the mains and observing the relevant safety regulations.

Technical specifications

Input voltage / frequency	230 V ~ 50 Hz
Volume (usable capacity)	65 l
Output rating	max. 2750 W
Housing (W x H x D)	595 x 595 x 566 mm
Oven interior (W x H x D)	440 x 365 x 405 mm

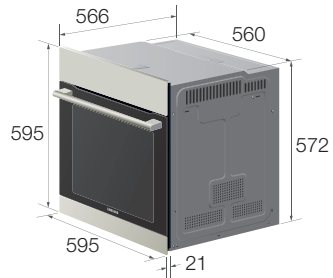

Power connection

A multi-pole isolator switch (with at least 3 mm contact spacing) must be provided in order to satisfy safety regulations. The power cable (H05 RR-F or H05 VV-F, min. 1.5 m, 1.5 ~ 2.5 mm²) must be of sufficient length to be connected to the oven, even if the oven stands on the floor in front of its built-in cabinet. Open the rear connection cover of the oven with a screwdriver and loosen the screws of the cable clamp before you connect the wires to the relevant connection terminals. The oven is earthed via the (⏏)-terminal. (The manufacturer accepts no responsibility for faults or accidents arising from a defective earth connection)

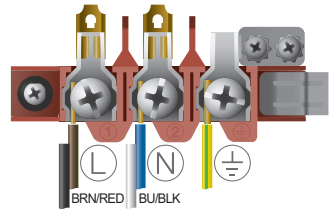

Please ensure that the power cable is not trapped between the oven and units or wall when pushing back into position. Do not route cable over any potentially hot surfaces.

Installation in the cabinet

This is a built-in oven, which needs to be installed into an upper or lower cabinet.

- Observe minimum distances.
- Fix oven on both sides using screws

After installation, remove the vinyl protective film from the door to the appliance and the protective film from the interior surfaces of the oven.

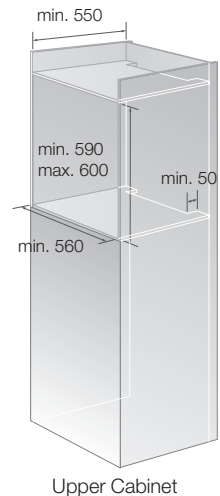
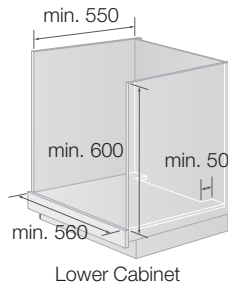
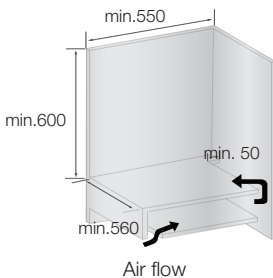

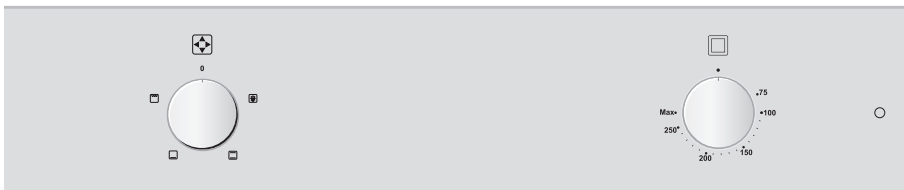

parts and features

OVEN CONTROLS



ACCESSORY

-  **CAUTION:** Be sure to insert the grill pan correctly into the side racks. Leave at least a 2 cm clearance from the bottom of the oven, otherwise the enamel surface could be damaged.
-  **WARNING:** Be very careful when removing meals and/or accessories out of the oven. Hot meals, accessories and surfaces can burn you!
-  **CAUTION:** Please ensure shelves are fully inserted before closing the oven door, failure to do so could lead to damage to the door/glass.

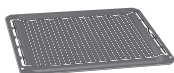

Grill pan, grid & shelf

Shelf width : 461 mm
Grid width : 422 mm
Grill pan width : 460 mm

USING THE CONTROLS

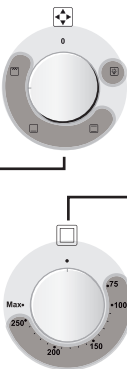

The diagram shows two views of the oven's control panel. The top view shows a circular panel with a central knob and several function buttons. A line points from the text 'Oven lamp only' to a button on the right. The bottom view shows a similar panel with a temperature dial. The dial has markings for 'Max', '250°', '200°', '150°', '100°', and '75°'. Two callouts, 'a' and 'b', are placed around the dial. 'a' is at the 'Max' position, and 'b' is between the '75°' and '250°' marks.

Set cooking mode | 01
Turn **Function Select Knob**, set desired the cooking mode.

02 | Set temperature
Select the desired temperature by turning the **Temp Control Knob**.

- a** Grill temperature
Set the temperature Max
- b** Set the temperature between 75 °C and 250 °C for all cooking other than grilling.

Oven functions



Conventional

Heat is emitted from the upper and lower heating elements. This function should be used for standard baking and roasting.
Suggested temperature: 200°C



Bottom Heat

Only bottom heat is on. Is particularly suitable for dishes, such as pizza, which are often cooked with heat from below.
Suggested temperature: 190°C



Large Grill

Heat is emitted from the large area grill. This function should be used for toasting and grilling meat.
Suggested temperature: Max

test dishes

According to standard EN 60350 and DIN44547

Baking

The recommendations for baking refer to preheated oven.

Type of Food	Dish & Notes	Shelf level	Cooking Mode	Temp. (°C)	Cooking time (min.)
Shortbread	Baking tray on shelf	3	Conventional	140-160	25-35
Small Cakes	Baking tray on shelf	3	Conventional	150-170	25-35
Fatless Sponge Cake	Springform cake tin on shelf (Dark coated, ø 26 cm)	2	Conventional	165-185	25-35
Apple Pie	Shelf + 2 Springform cake tins * (Dark coated, ø 20 cm)	1	Conventional	170-190	70-90

* Apple pie and two cakes are arranged on the shelf at the back left and at the front right.

Grilling

Use this function with the maximum temperature setting of Max.
Preheat the empty oven for 5 minutes using Large Grill function.

Type of Food	Dish & Notes	Shelf level	Cooking Mode	Temp. (°C)	Cooking time (min.)
White Bread Toast	Grill pan & grid	5	Large Grill	Max	1st 1-1.5 2nd 0.5-1
Beef Burgers (12ea)	Grill pan & grid	4	Large Grill	Max	1st 14-18 2nd 5-10

cleaning and care

CLEANING



Make sure the oven and any accessory is cool before cleaning. We recommend that you clean the oven after each use to prevent the build-up of burnt-on food and the associated smells produced.

Oven Interior

- For cleaning the interior of the oven, use a clean cloth and a mild cleaning agent or warm soapy water.
- Great care should be taken when cleaning the door seal.
- Do not use scouring pads or abrasive cleaning sponges.
- To remove stubborn soil, use a dedicated branded oven cleaner.

Oven Exterior

- For cleaning the exterior of the oven, use a clean cloth and a mild cleaning agent or warm soapy water.
- Dry with kitchen roll or a dry towel.
- Do not use scourers, caustic cleaners or abrasive products.

Stainless steel oven fronts

- Do not use steel wool, scouring pads or other abrasives. They may damage the finish.

Aluminium oven fronts

- Wipe the surface gently with a soft clean cloth or microfibre cloth and a mild window cleaning detergent.

Accessory

- Wash the grill pan and grid after every use and dry it with a kitchen towel. If necessary, leave in warm soapy water for about 30 minutes for easier cleaning.

DOOR REMOVAL

For normal use, the oven door must not be removed but if removal is necessary, for cleaning or repair, follow these instructions.

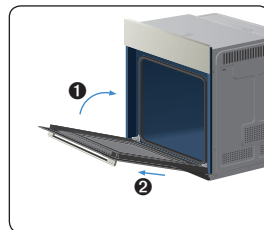
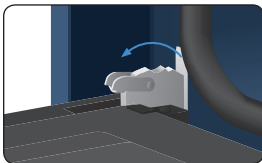

CAUTION: The oven door is heavy.

1. Ensure oven is cold. Open the door and flip open the clips at both hinges completely.
2. Close the door to approximately 70°. With both hands, grip the sides of the door centrally and pull/lift the door until the door and hinges come away from the oven.

DOOR GLASS REMOVAL

The oven door can be removed for cleaning.

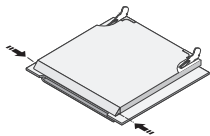

1. Press the buttons on the left and right sides of the the door together.

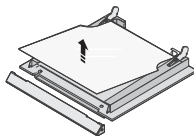

2. Detach the covering and remove glass 1 from the door.

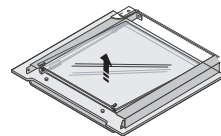

3. Lift glass 2 and Clean the sheets with warm water or washing-up liquid and polish dry them with a soft clean cloth.



The screen printed surface of the glass should be on the inside, between the glass sheets.

BULB REPLACEMENT



Danger of electric shock!

Before replacing the oven bulb:

- Switch the oven off and ensure that it is cold.
- Disconnect the oven from the mains.
- Protect the oven light bulb and the glass cap by laying a cloth on the bottom of the oven compartment.

Lamp removal

1. Remove cap by turning anticlockwise and remove the metal ring, and the sheet ring. Replace the bulb with a 25 watt, 230 V, 300 °C heat-resistant oven light bulb.
2. Clean the glass cap, the metal ring and the sheet ring if necessary.
3. Fit the metal and the sheet ring to the glass cap.
4. Locate glass cap into hole and turn it clockwise to secure.

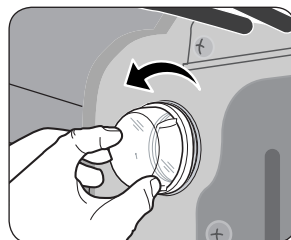

TROUBLESHOOTING

PROBLEM	SOLUTION
What should I do if the oven doesn't heat up?	<ul style="list-style-type: none">• The oven may not be switched on. Switch the oven on.• Check to see if the required settings have been applied.• A household fuse may have blown or a circuit breaker may have tripped. Replace the fuses or reset the circuit. If this happens repeatedly, call a qualified electrician.
What should I do if, even though the oven function and temperature have been set, the oven does not heat up?	<ul style="list-style-type: none">• There may be problems with the internal electrical connections. Call the help-line.
What should I do if the oven light doesn't illuminate?	<ul style="list-style-type: none">• The oven light may have failed. Replace the oven light bulb (see section "Bulb replacement").

product guarantee details (UK only)

Details of your guarantee are shown on your Howdens Proof of Purchase Document.

GUARANTEE CONDITIONS

- (a)** Any claim during the period of the guarantee **MUST BE ACCOMPANIED WITH** your Howdens Proof of Purchase Document.
- (b)** The unit must be correctly installed and operated in accordance with the manufacturer's instructions and used for normal domestic purposes.
- (c)** The guarantee does not cover accidental damage, misuse or alterations which are likely to affect the unit.
- (d)** The guarantee is invalid if the unit is tampered with, or repaired by any unauthorised person.
- (e)** The guarantee in no way affects your statutory rights.
- (f)** U.K only.

PROCEDURE WHEN REPORTING A FAULT

1. Give full name, address including post code, home telephone number and business telephone number if appropriate.
2. Quote sales receipt number, make and model number of faulty appliance.
3. Give a summary of the problem.

Model No:	
Serial No:	



memo

memo



This manual is made with 100 % recycled paper.