

Thank you for purchasing our product.
Please read this User's Manual before
using the product. Change without Notice

Intelligent Dual Light CAMERA



1. Intelligent camera supported motion detection system with white light and IR LED
2. Unlike other general IR cameras which can only present B/W image at night, exclusively design as a motion detection system to activate the white light LED within camera lens range distance in color image
3. Power saving control, also it can be an auxiliary lighting and warning purpose

CONTENT TABLE

CONTENT TABLE.....	2
SAFETY PRECAUTIONS.....	3
FUNCTION.....	4
INSTALL STEP.....	6
SPECIFICATIONS	7
DIMENSION.....	8
IR & WHITE ACTIVE.....	11
Camera Installation.....	12

SAFETY PRECAUTIONS

Please read before using



The lightning flash with arrowhead symbol, within an equilateral triangle, is intended to alert the user to the presence of insulated dangerous Voltage within the product's enclosure that may be sufficient magnitude to constitute risk of electrical shock to persons.



The exclamation point within an equilateral triangle is intended to alert the user to the presence of important operation and maintenance (servicing) instructions in the literature accompanying the appliance.

1. Please read the service manual in details before using.
2. Don't try to disassemble the chassis or the part easily, in case that touch the power by mistake, is shocked by electricity the danger or caused inside parts to be damaged.
3. This product is a **IP- 67** waterproof camera.
4. Do not attempt to service this unit yourself unless you are authorized to do so. Opening cover may exposure you to dangerous voltage or other hazards. Refer all servicing to qualified personnel only.
5. When being regular, please lock the parts firmly first to prevent the machine damage.
6. Please connect correctly in accordance with the regulation, prevent the machine from using, or striking improperly.
7. Please don't use any organic solution or the corrosively sanitizer to insert and wipe away the chassis outside. While inserting and wiping away, please turn off the power, and use the clean cloth is stained with letting a small amount of branch water, insert and wipe away appearance.
8. Please don't use the camera under the following abominable environments: Temperature is lower than -10 degrees Centigrade, or is higher than +50 degrees Centigrade.

FUNCTION

The camera includes auto white balance mode(AWB) · auto capture color temperature. The range is 2400°K~9400°K.

SENSOR : Auto Cell Device Sensor, the IR LED would on when night comes to make up lightness. IR LED would not on in the day, to reduce power consumption. Illumination is 8 LUX (LED on) / 9LUX(LED off).

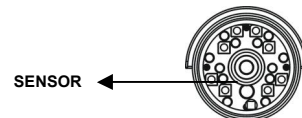

SENSOR

LENS : Super sensitivity sensor IRIS (BOARD LENS 6.0mm)

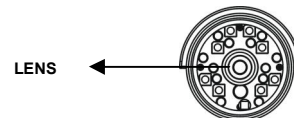

LENS

LED : IR LED x 12, angle 35° / White light LED x 8, angle 30°

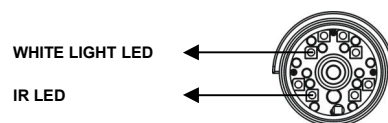

WHITE LIGHT LED

IR LED

Scaffold :
Rotate the camera angle arbitrary what ever fixed on the wall any position.



Sunshade :
To be isolated sunlight and rainfall, make camera live longer.



Power and video output JACK :
DC JACK is for the power in, it is necessary to use a constant voltage adapter , F(BNC) JACK is for video input.

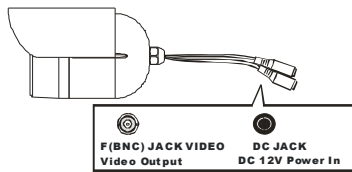

INSTALL STEPS

1. Make the camera on the bracket stable.
2. Then connect the 75Ωcoaxial cable to device video in.
3. Put the power cable on.
4. Users may adjust the camera poison and angle in different environment.

Notice : The camera lens is already make it on right focus, user can adjust it if in need.

SPECIFICATION

	TYPE A	TYPE B
IMAGE SENSOR	1/3" COLOR CCD SENSOR INTERLINE	
Total Pixels	NTSC:537(H) x 505(V) P A L :537(H) x 597(V)	NTSC:811(H) x 508(V) P A L :795(H) x 596(V)
Effective Pixels	NTSC:510(H) x 492(V) P A L :500(H) x 582(V)	NTSC:768(H) x 494(V) P A L :752(H) x 582(V)
Synchronizing system	2 : 1 Internal	
Scanning system	NTSC 525 lines / 60 fields PAL 625 lines / 50 fields	
Video Output	1.0 Vp-p / 75 Ohms composite	
Electronic Shutter	Auto Electronic Shutter (1/60~1/100000 sec) NTSC, (1/50~1/100000 sec) PAL	
Lens	Board Lens 6.0mm	
Horizontal Resolution	420 TV Lines	530 TV Lines
S/N Ration	48dB, AGC OFF	
Minimum Illumination	0.05 lux color	
Auto White Balance	2400°K~9400°K	
Weatherproof	IP67	
IR Distance	15M(12pcs IR LED)	
IR Trigger	8LUX / 9LUX IR ON / OFF	
White light Distance	<10M	
White light trigger	8LUX	
Motion detect range	Standard: 3M (Lens 6.0mm) Optional: 2~2.5M (Lens:4.3mm)	
Motion detect	Light change / picture change	
X-Y-Z Position	Adjustable Manual P-T-T (Pan-Tilt-Twist)	
Power Supply	12V DC ±10%	
Power Consumption	3.36W (Max)	
Current	280mA (Max)	
Wht	N.W./G.W.:0.33kg / 0.46kg	
Dimension	74mm x 122.5mm	
Operating Temp	-10 to 50°C (14 to 122°F)	
Storage Temp	-20 to 70°C (-4 to 158°F)	

DIMENSION

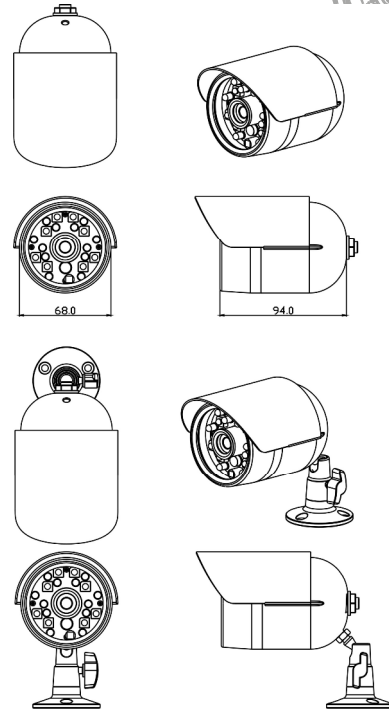

IR & White light active

IR trigger

If camera located is a un-limit condition, IR active when Lux is lower than 8
IR closed when Lux is higher than 9.

White light trigger

1. Under IR on, white light active when light change or picture change at night.
White light duration time is 15 seconds, during this time, IR is off.

2. Because unlike other general IR cameras which can only present B/W image at night, we exclusively design as a 3M range motion detection system to activate the white light LED within camera lens range distance in color image. And also normally human or animals height reason, we suggest the best camera installation height is on top 2.2M to avoid motion detect error

Motion conditions

1. Within camera lens range when Illumination dark or bright exchange
2. Within camera lens range when any moving object in 3M range includes people / animals / vehicles / plants movement by the wind / raining, etc.
3. To avoid motion detection error, the motion system is set to be trigger within 2.5M of an adult shape with minor movement, when motion is between 2.5-5M, it needs bigger movement to trigger the detection.
4. If use Lens 6.0mm, the motion detection range will be decrease 0.5~1M

White light duration time

In the night, white light is active if any moving object is under motion detect.
Duration time is 15 seconds; the duration will last 15 seconds for each motion detection and will continue until the last motion is detected

9

Camera installation

White light would be active when sudden light changes or quick movement occurs, user please install the camera at the suitable place at yourself opinion.

Suggestion of the installation field: Lights and rays are not always change.

Ex:

1. House / Office entrance
2. House / Office backdoor
3. General office
4. Building staircase

Not suggest:

Any places that lights and rays are always change, like road or street because vehicles come and go frequently and make motion system error

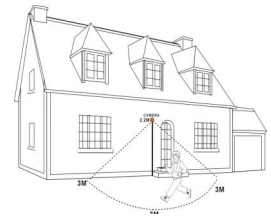

10