



RGT02AD – ROYAL COLOR VIDEO DOORPHONE USER'S MANUAL

Operating Voltage : 18-24V DC
Standby Current : 16 mA
Operating Current : 240 mA
Height : 8.5 in (215 mm)
Length : 8.5 in (215 mm)
Depth : 2.17 in (55 mm)
Weight : 32 oz (0.90 kg)
Resolution : 960 x 234 pixels
Screen : 3.5" Color TFT LCD
Approvals : CE, GOST R
Operating
Temperature: ~ 40 - 120 F (5 - 50°C)



FUNCTIONS

- Unlock door by pressing the “Open Door

- If the red LED is lit on the on doorphone, it means that the voice line (2) to the security guard station, doorman or another apartment unit is busy, so a call on the voice line (2) cannot be completed.
- If you hear a buzzing sound, please reposition the handset to the hook in order to receive the call.
- For the functions of the recording units “-R”, please refer to the on-screen or printed instructions.

EFES VIDEO DOORPHONE VERSIONS

Royal: RGT02AD, RGT02ADR, RGT02ADT, RGT02ADRT, RGD02AD, RGT10AD & RGT10ADT

DOORBELL MELODY SELECTION

There are 3 melodies: Door panel, Interior doorbell, and Security guard station (2nd voice line)

- 1- Lift and replace the handset twice to reset the system.
- 2- When the handset is on the hook (screen is not active, system in stand-by), PRESS & HOLD the “A” button and you will hear a melody. If this is the (target, e.g. interior doorbell) melody you would like to change continue with step 3, if not, repeat steps 1 and 2 until you find the doorbell melody that you would like to change.
- 3- PRESS the “B” button to switch to the next melody; you can repeat this until the desired melody is found.
- 4- PRESS & HOLD the “A” button, then repeat step 1 to reset the system with the new melody.
- 5- You can repeat these steps to change the doorbell melody of incoming calls from the different targets.

MOUNTING of VIDEO DOORPHONES

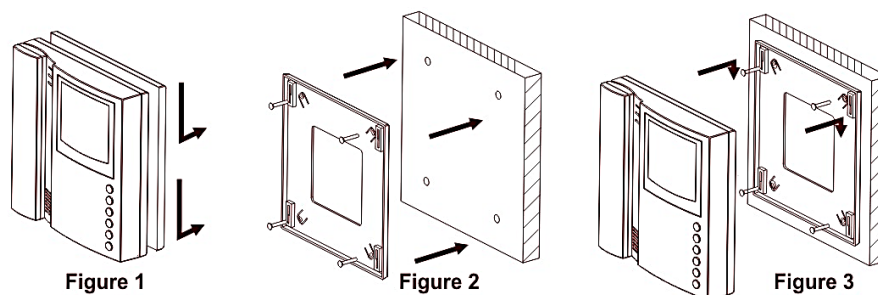

- * Remove the frame at the back **Figure 1**,
- * Mount the frame to the wall **Figure 2**,
- * Mount the video doorphone to the frame **Figure 3**.

*Suggested Video Doorphone Mounting Height: 5' - 5'2" (Screen to ground, Eye-level)

Mount video doorphones to a proper place away from hazards (water, dust, chemicals & etc.) and away from direct light sources (sun, street lights, white or transparent backgrounds & etc.).