

## SS-RC10 Installation Guide & User's Manual

**GETTING STARTED: PLEASE READ THIS MANUAL CAREFULLY BEFORE INSTALLATION**

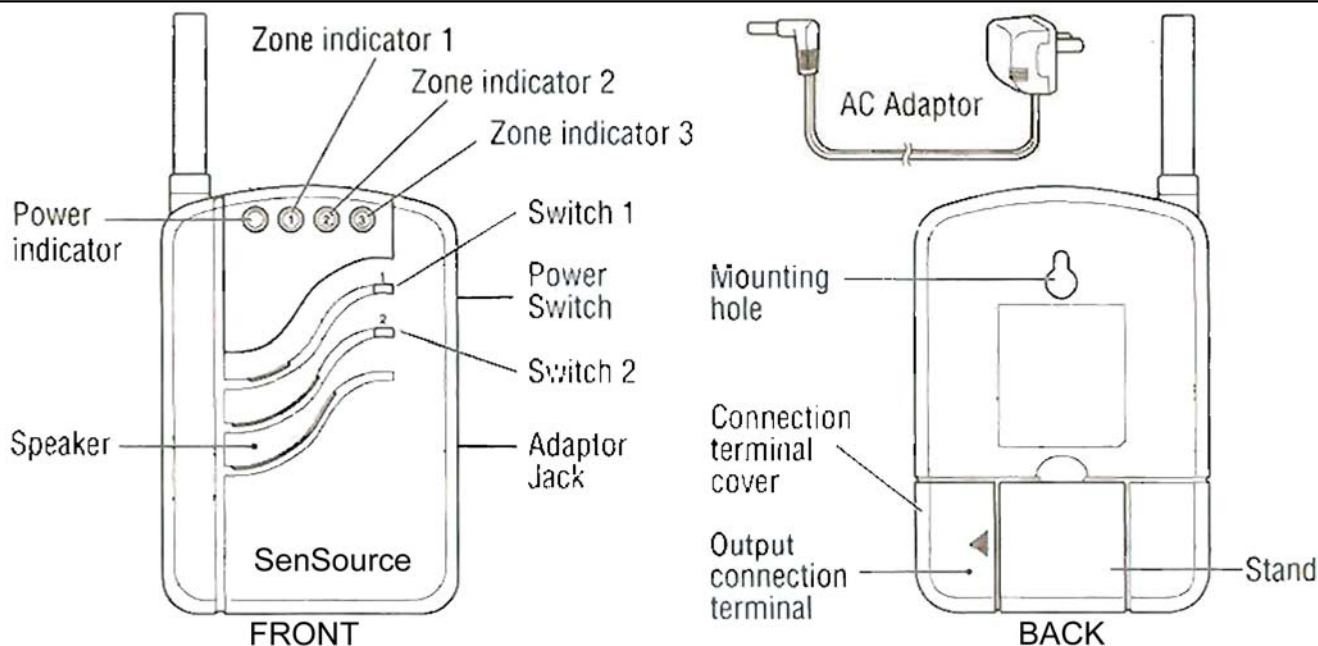

### Function:

- Switch 1 – Activating “Learn Mode” and “Output Duration Mode”
- Switch 2 – Activating “Volume Adjustment Mode” and making Selection

## INSTALLATION METHODS

**Mounting On A Wall** – Using the mounting screw, leave some length out of the wall for the mounting hole of the SS-RC10.

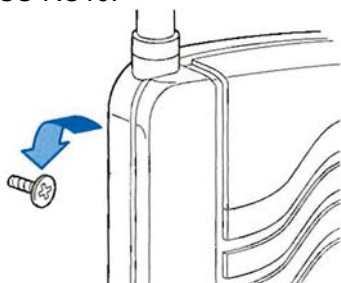

**Desk Top** – Pull out the stand on the back of the SS-RC10 and place it on any surface.

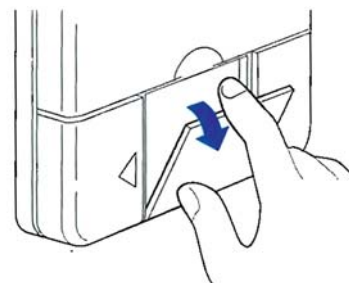

## POWER CONNECTIONS

Use only the AC power adaptor supplied with the SS-RC10.

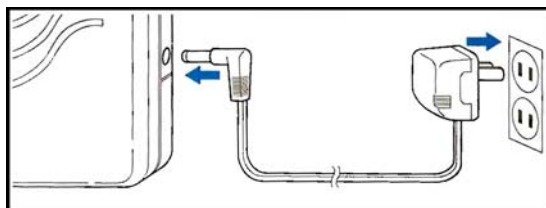

## TEACH TRANSMITTER CODES TO RECEIVER

Each transmitter has a unique transmission code which can be automatically “learned” by the SS-RC10. The SS-RC10’s zones must be taught to respond to the appropriate transmitter. Zone characteristics can be programmed as shown below.

### Regular Mode

Zone 1: Chime tone 1 (optional timed utility output)
Zone 2: Chime tone 2 (optional timed utility output)
Zone 3: Chime tone 3 (optional timed utility output)
Zone 4: Continuous tone and terminal output (latches until switch 2 is pressed to deactivate)

### Utility Output Mode

Zone 1: Chime tone 1 only
Zone 2: Chime tone 2 only
Zone 3: Timed relay output only (5 sec)
Zone 4: Continuous tone and terminal output (latches until switch 2 is pressed to deactivate)

### Activate “LEARN” Mode

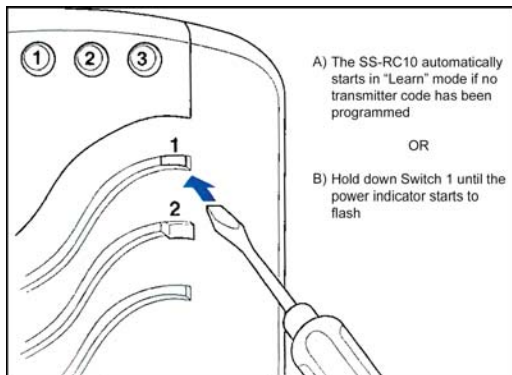

### Note:

- Return to normal operation status before use.
- Verify that each transmitter has been learned by the SS-RC10 by triggering them.
- Each zone can accept a maximum of 3 transmitters, and zone indicator shows the activated transmitter by the number of flashes. eg. (If transmitter 2 in zone 1 is activated, zone 1 indicator flashes twice)
- Single transmitter cannot be learned by multiple zones.
- Turning off the devices, or losing power, will not affect transmitter or the SS-RC10’s code memory.

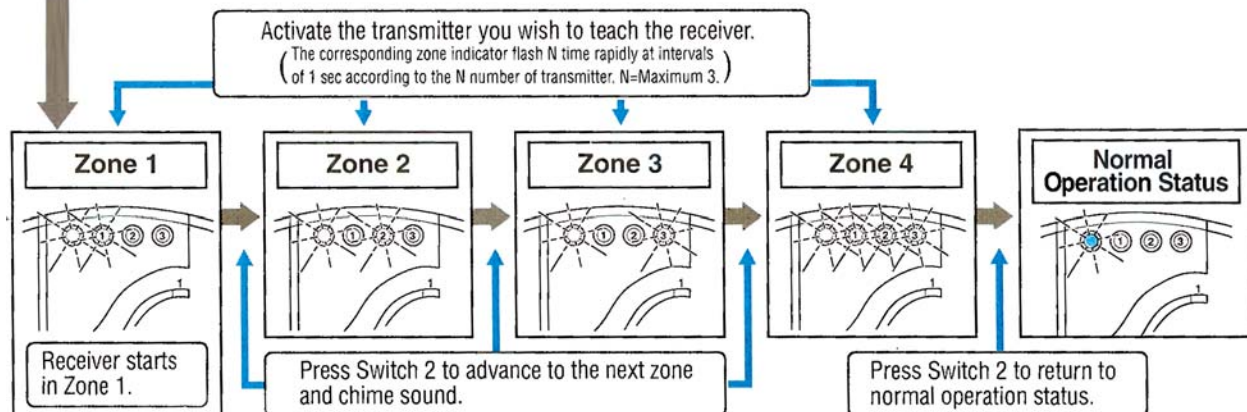

### Erasing Codes from Receiver’s Memory

1. Hold down Switch 1 until the power indicator starts to flash.
2. Press Switch 2 until appropriate zone indicator is lit.
3. Press Switch 1 to erase. Zone indicator will start to flash.  
(Note: All programming in that particular zone will be erased.)
4. Press Switch 2 a few times until the power indicator stops flashing and remains lit.

**Note:** To erase all programming and return to factory settings, turn on power while holding Switch 1.

## LOW BATTERY INDICATION

Zone indicators start flashing whenever corresponding transmitters have a low battery. The receiver will sound a chime followed by 2 beeps. Slow flashing of indicators will last until 1) batteries of transmitters are replaced or 2) Switch 2 is pressed. In this case, replace transmitter batteries even if they are less than 2 years old. You can not activate various adjustment modes in this state, unless Switch 2 is pressed (indicators stop flashing). There is no need to go through adjustments again after replacing batteries. Checking the status indicator of transmitters at that particular zone is recommended to identify the low battery transmitter.

## VOLUME ADJUSTMENT

Chime volume for zones 1–3 can only be set as a group. There are 5 volume settings.

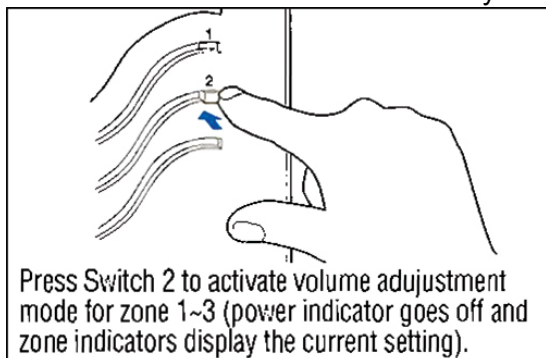

After 5 seconds, the receiver will automatically return to normal operation status (zone indicators will go off and power indicator will remain lit).

**Note:** Hold down Switch 2 five seconds for zone 4 (power indicator goes off and zone indicator displays the current setting).

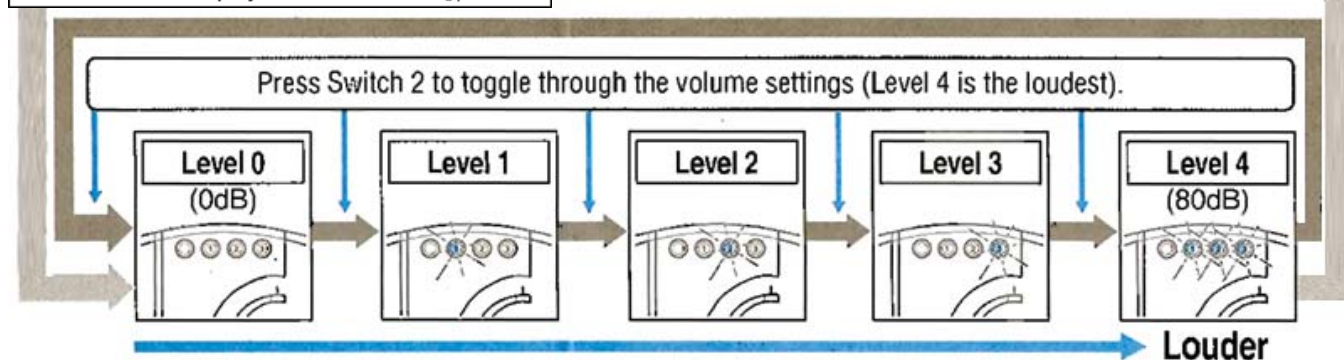

## TERMINAL CONNECTION

The terminal connection on the SS-RC10 could be used for external SenSource devices, such as the PC-DISPLAY, PCDL-1000 and PCW-PC4. If provided, use the 2-lead BLK/WHT jacketed cable to connect these devices. Connect the black lead to the **COM** terminal and the corresponding white lead to the **N.O.** terminal.

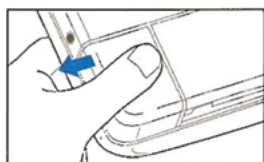

Remove the connection terminal cover

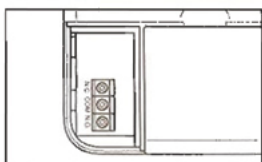

Use the terminal marked "COM-N.O." for N.O. devices and "COM-N.C." for N.C. devices.

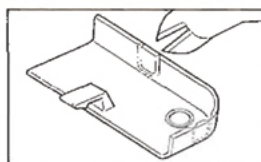

Remove knockouts according to wiring needs.

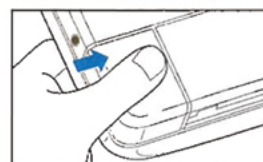

Close the connection terminal cover. The SS-RC10 may be damaged if the terminals come into contact with metal objects.

## ADJUSTING THE TERMINAL OUTPUT DURATION

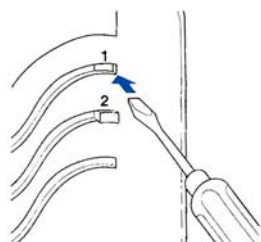

- In Regular Mode: Terminal output duration can be set for zones 1–3 only as a group. Zone 4 always latches until it is reset by pressing Switch 2.
- In Utility Output Mode: Terminal output (5 sec) is only for zone 3. Zone 1 and 2 will chime only and zone 4 will latch until it is reset by pressing Switch 2.
- Press Switch 1 twice within 2 seconds to activate terminal output duration mode (zone indicators display the current settings).
- After 5 seconds, the SS-RC10 will automatically return to normal operation status (zone indicators will go off and power indicator will remain lit).

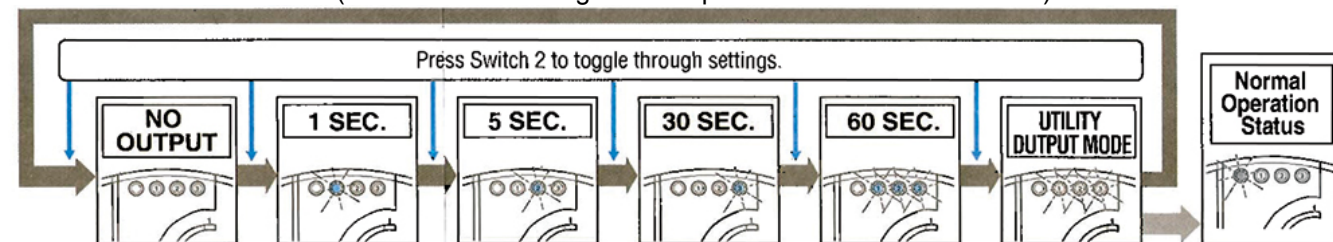

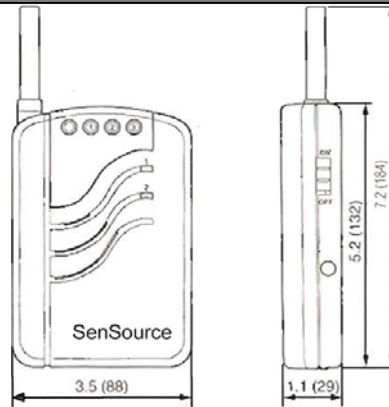
**DIMENSIONS:****UNITS – INCHES (mm)****SPECIFICATIONS**

Model	SS-RC10
Description	Wireless Receiver
Power Source	DC 9V (Exclusive AC Adaptor): Standby – 1W / Operating – 2W
Chime Tone	3 Tone & Continue Zone (Selectable)
Volume	Adjustable: 0 – 80dB/ 5 levels Maximum Volume (Continue Zone)
Status Indicator	Power Indicator: Green Zone Indicator: Red X 3
Relay Output	Form “C” MAX 1A/50VAC · DC24VAC
Output Timer	Selectable: Off/1/5/30/60sec/ Utility Output Mode
Frequency	418 MHz
Operating Temperature	15° F – 104° F (-10° C – +40° C)
Installation Location	Indoor
Accessories	Mounting Screw X 1, AC Adaptor X 1
Weight	6.0 oz (170g)

**TROUBLESHOOTING YOUR SS-RC10**

Is the power indicator of the SS-RC10 lit?	→	Is the receiver on? Check the wiring and connection.
Have all the transmitter codes been taught correctly?	→	Teach the transmitter codes correctly. The system will not operate without this process.
Is the volume setting correct?	→	Is the volume set to “0”? If so, readjust the volume.
Are there other high power appliances using the same electrical power outlet?	→	Connect the SS-RC10 to another outlet.
Is there anything blocking the SS-RC10?	→	Relocate the SS-RC10 to another location.
The zone indicator of the SS-RC10 is on, but nothing happens.	→	Check to see whether the terminal is properly connected to other devices.
Are zone indicators flashing slowly?	→	Follow directions in “Low Battery Indication.”
The SS-RC10 does not learn transmitter codes.	→	Check if the transmitter code is not already “learned” in a different zone. If it is, erase memory and teach again.
The SS-RC10 gets reception in a wrong zone.	→	Erase memory in the zone the SS-RC10 responds and teach in the correct zone.
The SS-RC10 does not respond to some of the transmitters.	→	You may have taught multiple transmitter codes in a same zone. Teach the transmitter code that has no response using an empty zone.
Certain zone seems to malfunction.	→	Check the transmitter that corresponds to that zone. This is probably caused by the transmitter.
Before contracting the supplier...	→	Go through the setups again after Turning on the power while holding down the Switch 1.
<ul style="list-style-type: none"> <li>For further help, contact SenSource at 1-800-239-1226 or at <a href="mailto:info.SenSourceInc.com">info.SenSourceInc.com</a>.</li> </ul>		