



G I N

INUIT II User manual - English



Please read this user manual carefully before you use the INUIT II.

Welcome to GIN Kiteboarding...

Thank you for choosing a GIN kite.

Our R&D team has invested a lot of time, passion and experience into creating the INUIT II.

We hope you will enjoy this kite as much as us, and we wish you many wonderful sessions with your new INUIT II!

For more information and to keep in touch with the fantastic evolution of our sport, visit our website:

www.ginkites.com

Please pass on this manual to the new owner if you ever resell your wing.

Enjoy riding GIN,

The GIN Kiteboarding Team

Information about safety

Aimed at customers with a good knowledge of kiting, this manual principally provides technical information about the INUIT II. This manual cannot replace training from an approved kite school.

Kiting is a magnificent sport, but certain rules do apply and these must never be neglected. As an "ambassador" of our sport, please respect these rules and always keep safety in mind:

Respect:

- the other riders
- the kite launch and landing zones
- the riding locations
- the rules of riding and of the air
- the public and their safety
- the natural elements

Familiarize yourself with :

- your equipment
- your safety equipment

Make sure that you have adequate personal and third party liability insurance for kiting.

The manufacturer as well as the distributors and agents of GIN Kiteboarding products cannot be held liable for death, personal injury or material damage resulting from any use of this equipment.

Table of contents

Welcome to GIN Kiteboarding...	2
Information about safety	2
Table of contents	3
Gin Kiteboarding	4
History of the INUIT II	5
For which level of rider	5
Construction	5
Description of a foil kite	6
INUIT II Control bar	7
Description of the INUIT II's bar	7
Bar	8
Main quickrelease	8
Depower line	8
Leash line connector	8
Flying lines	8
Adjustment of the bar	9
Safety system of the INUIT II	10
Main quickrelease	10
Quickrelease of the leash	11
Accessories	12
INUIT II pack	12
Flying lines	13
Looking after your kite	14
Control bar set-up and safety system	14
Warning	14
Windrange	15
GIN Kiteboarding warranty	16
Acknowledgements	17

Gin Kiteboarding

GIN Kiteboarding is a rider's company. For us, kiteboarding is a priority and a way of life. The members of GIN's Development Team have worked and ridden hard throughout the year to ensure you get the best experience possible through our products. We are stoked to introduce to you the new INUIT II.

Our philosophy is to create products of the highest quality and performance that are able to provide us with the maximum satisfaction; we are then more than happy to share these with YOU and other GIN riders worldwide. Our development is straight forwards; we focus on what is essential to the performance of our kites rather than investing in marketing features, which in reality do nothing to enhance the product.



Riders : Fabienne Kaufmann & Géraldine Fasnacht Photographer : Jean-Marc Robbiani

History of the INUIT II

People of the Canadian Far North, Alaska, Greenland and other Arctic coastal regions, INUIT (or ESKIMO) are hard experts of specific climatic conditions due to their environment; snow and wind are a constant part to their life. It is in all modesty and as a sign of admiration for these people that we have baptized our snowkite : the INUIT II. Our INUIT II is also an expert in the demanding conditions found snowkiting; it is at ease and perfectly adapted.

For which level of rider...

The INUIT II is an accessible kite for all riders who would like to ride with full safety while owning a performance kite. Its stability and smooth handling will give a maximum of trust for exploring the sports of snowkiting or mountain board riding.

With the INUIT II, the GIN Kiteboarding Development Team have created a foil kite with the following characteristics:

- smooth, stable, comfortable
- easy, light, direct handling
- controllable, effective performance

Flying the INUIT II becomes intuitive thanks to its smooth and instinctive handling. The very light bar pressure allows the rider to concentrate on his ride and on the elements around him.

Lots of low end power makes the INUIT II very easy and effective in light and medium winds. The INUIT II offers big safety margins, and will let you progress to a higher level quickly and comfortably.

The control bar system of the INUIT II was developed to obtain a 100% intuitive handling, and meets our desire for simplicity and effectiveness in design and operation.

The INUIT II is the ideal kite for snowkite and mountainboard use.

Construction

A highly skilled workforce takes extreme care during the entire manufacturing process of our kites. Every piece of fabric, reinforcement and detail has been carefully designed, refined and crafted from the most suitable, selected materials. Everything is then assembled in a finely controlled process to create this kite.

After several hours of use, you will still discover small details that simplify your kiting life as a result of the thought GIN put into the design for you.

Description of a foil kite

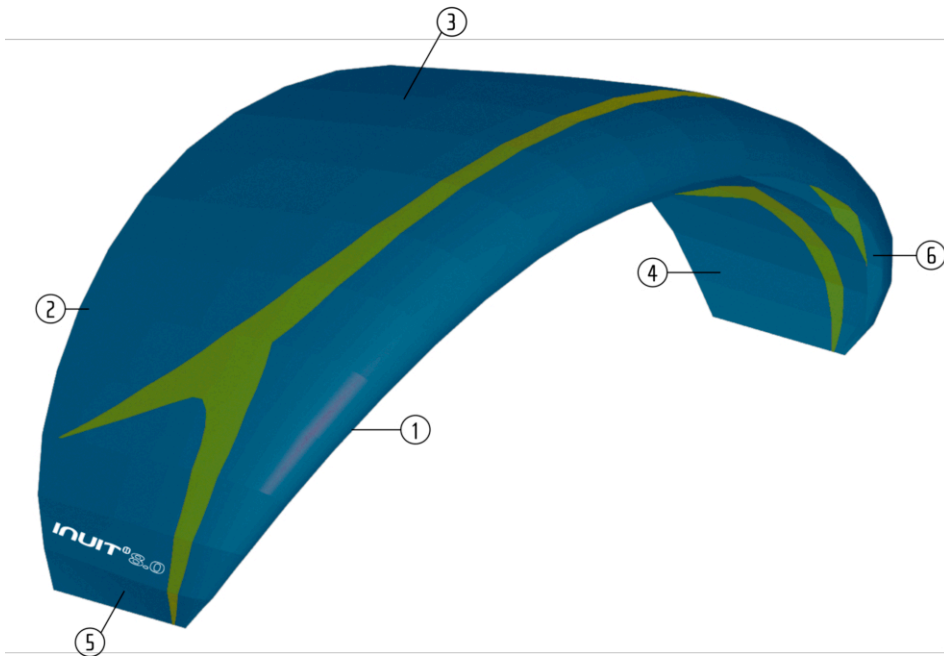

1. leading edge
2. trailing edge
3. top
4. bottom
5. wingtip
6. inlets

INUIT II Control bar

Description of the INUIT II's bar

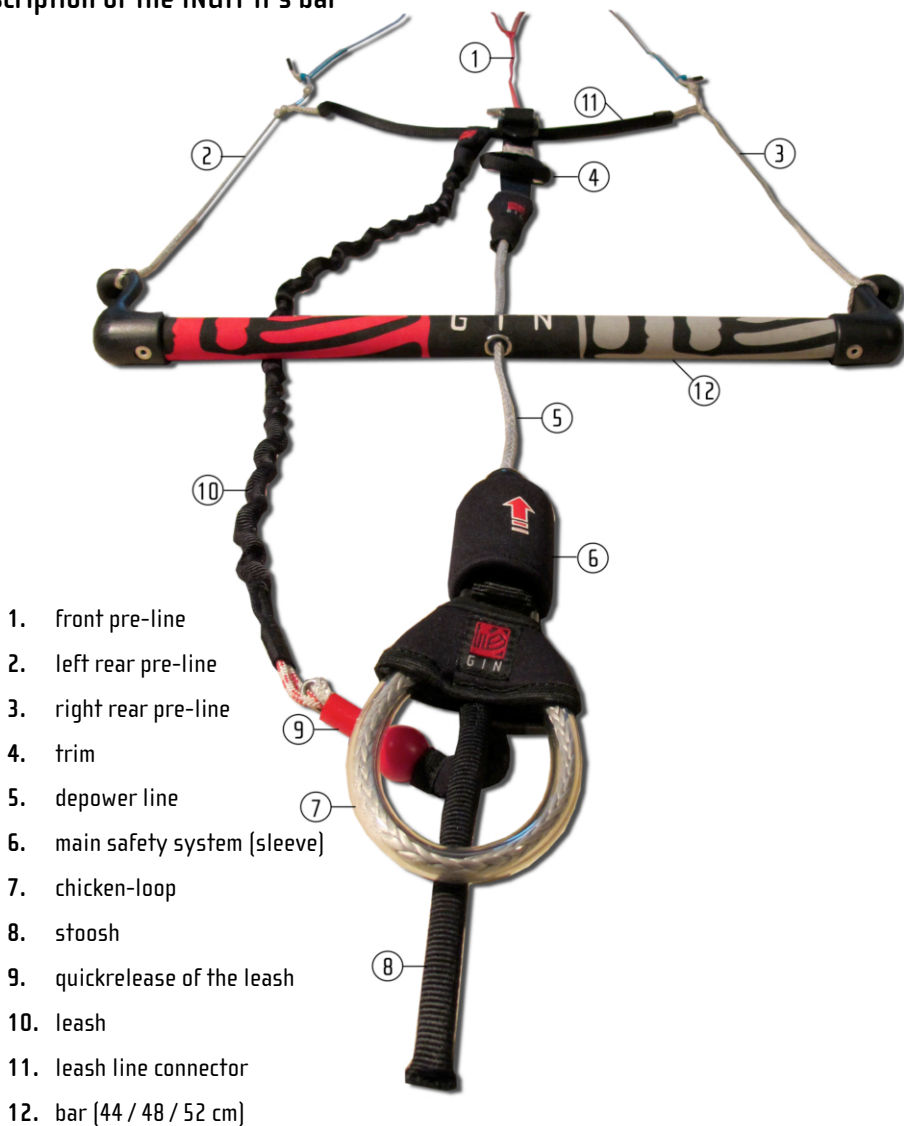

Bar

We have selected the best bar length for each size of INUIT II. The result is 3 bar lengths

INUIT II 4.5 : 44 cm bar

INUIT II 6.0 : 48 cm bar

INUIT II 8.0 : 48 cm bar

INUIT II 10.5 : 52 cm bar

Main quickrelease

The main quick release is simple but effective. Like all the GIN kites, it opens with a simple and intuitive movement. Easy to use in any situation, even with Winter gloves,

Depower line

The depower line can be changed easily without tools. The original depower line delivered with the bar is specially designed to resist wear.

Leash line connector

The leash is connected to the leash line connector. Pulling on the leash line connector makes it possible to neutralize (de-power) the kite on the ground. This action also allows a relaunch when the INUIT II is leading edge down on the ground.

Flying lines

The INUIT II is delivered with 4 23m coloured flying lines. Red, for the fronts and blue for the rear lines. The colours of the pigtailed on the kite are the same as the colours of the flying lines.

Adjustment of the bar

The neutral position of the bar allows easy adjustment of the 4 lines. The streamer must be completely released and the bar must be pushed up, away from you. Then, hold the chicken-loop and hold all 4 lines taut: the knots of the front and rear pre-lines must be at the same level. At the bar end, all 4 lines must end at the same level.

Neutral position of the bar



Safety system of the INUIT II

It is imperative that you know the correct operation and assembly of your system safety before using it. Always check your safety system before each use to make sure that it functions correctly.

Main quickrelease

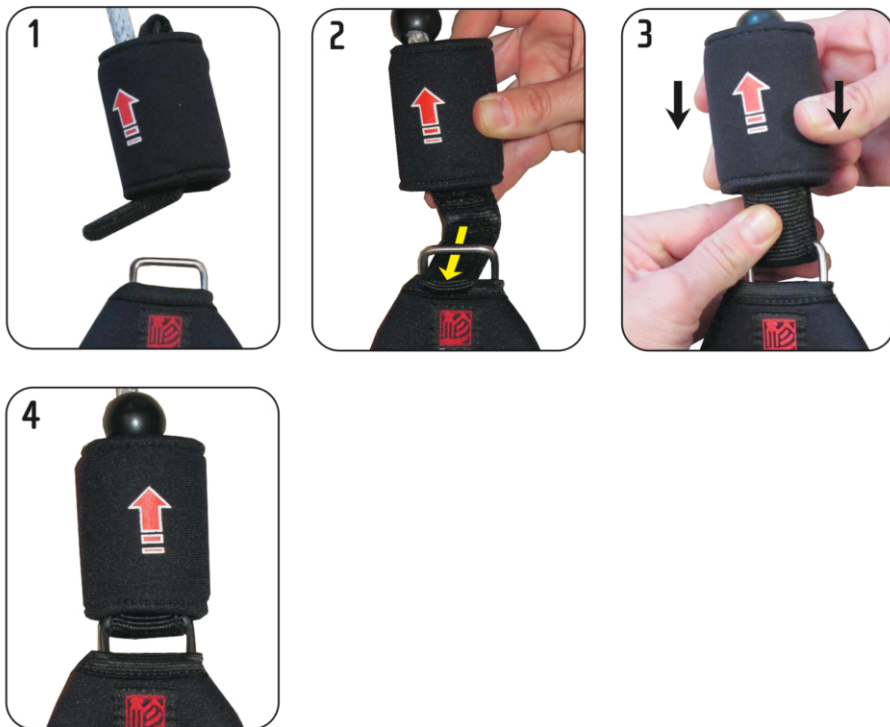

1. The solid sleeve is maintained to the quick release system with an elastic cord.
WARNING: the elastic cord of the sleeve must not be twisted around the depower line; it must be parallel to the depower line. :
2. Pass the rigid webbing of the quickrelease through the metal rectangle, in the direction of the arrow on the picture.
3. Fold the webbing up and lock the quick release by pulling down the solid sleeve against the chicken loop.
4. To release : push the quickrelease sleeve away from you, in the direction of the red arrow on the solid sleeve. You will still be connected to the kite by the safety leash.

Quickrelease of the leash

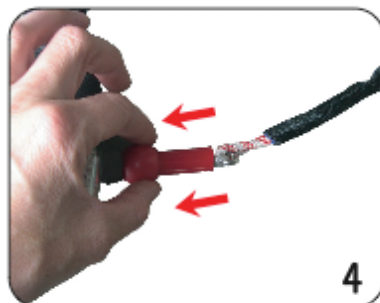

1. Hold the white and red loop at the end of the leash.
2. Pass the pin through the leash loop. Place the pin parallel to the grey line.
3. Slide the red plastic tube over the pin.
4. To release : draw the red ball in the direction of the 2 arrows in the picture.

Accessories

INUIT II pack

The INUIT II is delivered with a pack especially designed for snowkiting. The INUIT II pack is ultra smooth, without any webbing or attachment point coming out of the bag. There is a reduced risk of the kite flying catching on the bag



- inner pocket for camel bag
- waist belt strap with side pocket
- 2 side pockets
- ergonomic back with anti-perspiration surface
- volume : 25 litres. Can carry 2 INUIT II bars and 1 or 2 INUIT II kites (depending their sizes)

Also available in our accessories range : the ESKIMO pack. It benefits all the technical points of INUIT II pack, with extra features including webbing straps for carrying a snowboard, mountain board or skis and sticks.

Flying lines

The flying lines are delivered in 2 colours : red 275 kg for the front and blue 275 kg for the rear.

Fabric : Lines made of Dyneema®

Length : 23m

Strength : 275 kg, after stretching and stitching

Connect the loop with the label to the pigtails of the kite (pict 3). This label allows you to disconnect the lines more easily, even after high tension on the lines.

Always connect all the lines with lark's head knots:

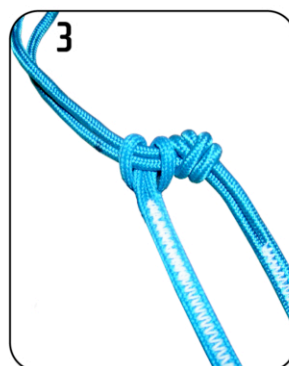
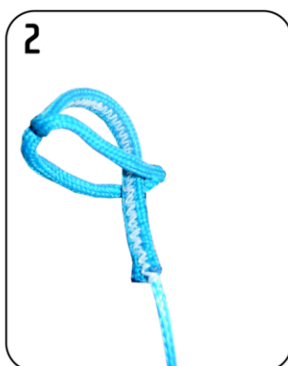
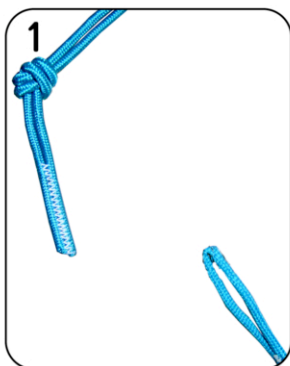

Looking after your kite

- Do not leave your kite out in the sun or flapping in the wind if you are not using it, the cloth will prematurely age.
- Never store a wet kite for a long time. Make sure it is completely dry.
- Never use any sort of chemical cleaner on your kite. Only use normal water.
- Store your kite in a dark and dry place leaving the bag open.
- Do not walk on the lines or on the kite. Check carefully all potential problems for example from skis or snowboard edges.

Control bar set-up and safety system

- Check your control bar set-up and safety system carefully before each use to make sure that it works correctly.
- Check for wear and tear on each part; also check all knots and lines, making sure that the neoprene protectors are in place where appropriate.
- Take care to clean your control bar set-up and your safety system of all sand, mud and dust, snow and ice.

Warning

- Your safety and the safety of others depend upon the correct use of this equipment. You are solely responsible for ensuring that you only use this equipment in situations and conditions suitable for your level of competence and in a way that will not endanger third parties.
- Safety does not only depend on the safety systems of the kite, it is also the result of training and of the correct evaluation of the situation and all conditions; the location, potential hazards, other people, the weather, etc
- It is extremely important to receive proper training before using this product and to fully familiarise yourself with all emergency procedures in safe conditions, before having to resort to them in an emergency. The safest place to obtain the necessary skills is from a suitably qualified and competent kite instructor or school. Do not attempt to fly this kite without the necessary skills.
- Your kite and safety systems must be regularly checked and properly maintained.
- The INUIT II is a kite adapted for riding on snow or land. Unlike a paraglider or a speedflying wing, the INUIT II is NOT designed for free flight and does NOT meet the specific safety requirements of free flight.

Windrange

Size INUIT II (m")

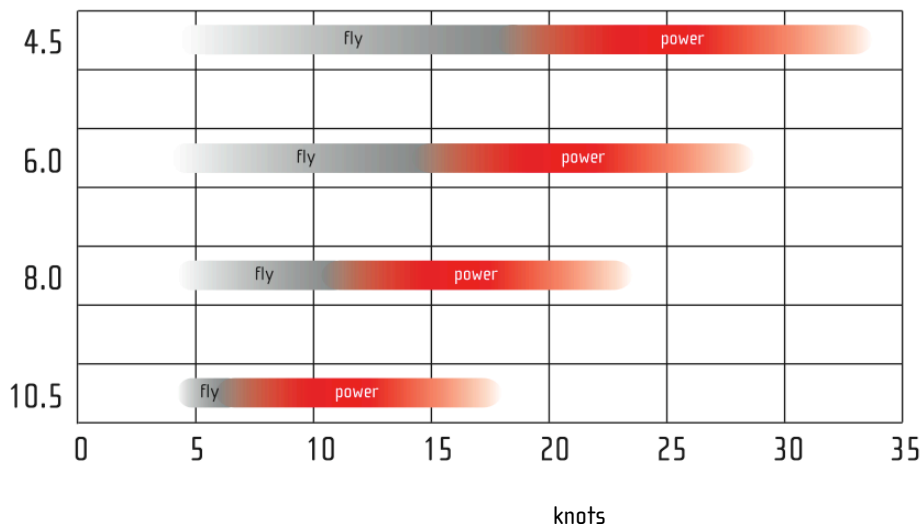

WARNING : This table should be used as an approximate guide only.

To make it accurate you would have to consider all variables that can modify the windrange, eg :

- the weight of the rider
- the level of the rider
- the performance of the snowboard or skis
- the quality of the snow
- the altitude and conditions specific to each location
- etc...

GIN Kiteboarding warranty

GIN Kiteboarding warrants your INUIT II to be free of major defects in material or workmanship to the original purchase for a period of ninety days from the date of purchase. We invite you to register your INUIT II on the website www.ginkites.com during the seven days after your purchase. We ask you to keep your original receipt.

This warranty is available under the following conditions:

- The warranty is valid only when the product is registered by the owner at www.ginkites.com within seven days of the date of purchase.
- The warranty is valid only when this product is used for normal recreational activities, and does not cover products used in rental or teaching operations.
- GIN Kiteboarding will make the final warranty determination, which may require inspection and/or photos of the product, which clearly show the defects. This information must be sent to the GIN Kiteboarding distributor in your country, postage prepaid. Products can be returned only after having received the authorization of GIN Kiteboarding.
- If Gin Kiteboarding declares that warranty is valid, the warranty will cover only the repair or replacement of the defective product. GIN Kiteboarding will not be responsible for any costs, losses or damages incurred due to shipment.
- The warranty does not cover damages caused by misuse, abuse, neglect or normal wear and tear - including but not limited to - punctures and rigging with other than GIN Kiteboarding components. All damages due to: excessive sun exposure / improper handling and storage will not be covered by the warranty.
- The warranty is not valid where any unauthorized repair, change or modification has been made to any part of the equipment.
- The warranty for any repair or replacement equipment is valid from the date of the original purchase only.
- The original purchase receipt must accompany all warranty claims. The name of the retailer and date of purchase must be clearly legible.
- There is no special, extra warranty except those laid out on this page.

Acknowledgements

GIN Kiteboarding would like to thank the riders who contributed to the development of the INUIT II. Their effectiveness, their optimism and their ideas brought much to the result that is the INUIT II.

Thank you also to all the impassioned people who have given their energy and time for the INUIT II.

Thank you to you!



Rider : Géraldine Fasnacht Photographer : Jean-Marc Robbiani