



HANDLING AND MAINTENANCE OF A MASK AND PROTECTIVE LENS

Dear Customer! Thank you for choosing FEO product. We make every effort to care about the technical, visual details, quality of our masks which means Your satisfaction.

feo phantom team

The mask can be used for recreational paintball or ASG only while maintaining the following safety rules, the proper way of using and maintenance. Failure to follow them may result in serious, even permanent injury of face and eyes (including blindness). In order to prevent accidental shots outside the game, one should always protect additionally the barrel marker with a liner or a barrel bag.

BASIC SAFETY RULES:

1. FEO masks are designed for recreational play, where specially designed paint balls or ASG are shot from the marker. Remember: markers which are used in the game have to be checked by chronograph measurement. Do not use FEO masks in the game where set markers' speed is greater than 300 fps (feet per second), which is 90 meters per second. Masks should not be used with other balls that are not designed for paintball or ASG. Pay attention so this rule is always respected by all the players on the field.

2. Never remove the mask on the battle field, in the nearby places during games or when other players markers are still in use (even if you already do not play). Remember: a stray bullet also can hit and injure you!

3. Always wear a mask that protects the eyes and the entire face and neck area. If the neck is not completely covered additionally wear e.g. a scarf. Remember: goggles only are not a sufficient protection.

4. Before each game check the condition of the mask, lens and a strap: mounting to the mask, tightening of the screws, or for any scratches or cracks.

Note: If the lens seating comes loose - tighten it. If you have been hit directly in the lens at a distance less than 10 feet (even if you do not see any damage) or if scratches/cracks appear on them - replace them with new ones.

5. FEO masks are equipped with an anti-fog lenses system. Nevertheless, we do not know how long the mask will be used in one game, what current weather conditions there will be or how your body will react during its use.

As a result of physical exercises human body warms up and also a face gives out moisture (sweat), what in spite of all can lead to moisture or fog on the lens. Note: If the mask gets wet or fogged never take it off or clean it while playing on the paintball field. Without the mask you are not protected!

6. The mounting face strap gives no protection to the back of the head and ears from hits of balls or any other.

7. The shell mask is made of resin reinforced with glass fiber but still before and after each game, check the condition. If you see any cracks or other damage discontinue its use.

8. Keep the mask and lens away from heat sources or areas with high temperatures. They can damage the structure of the mask and lenses and this may eliminate their protective properties. Do not leave them in a hot car for example, exposed directly to sunlight, etc.

9. Do not modify FEO masks on your own.

Note: If you use a mask for purposes other than their intended use as described in this manual, you expose yourself to the risk of facial lacerations.

10. To ensure full protection of your face, always use FEO original spare parts and accessories only, designed to your mask model (especially lenses).

11. Always check masks and lenses borrowed from a third party or commercial paintball fields. If you notice any scratches or damage return them to a rental, and ask for another one.

USER'S MANUAL AND MAINTENANCE OF FEO LENSES:

Lenses are made (depending on the model) of a steel mesh or polycarbonate with high impact resistance (the most durable optical material ever known which provides light transmittance up to 90%). Regardless, as a result of improper maintenance and use, their protective and visual properties may worsen and eventually disappear. Only proper handling can provide protection of eyes from injury that may occur during recreational game of paintball.

Carefully read and follow below instructions:

1. Regardless of their visible condition, the lens should be replaced with new ones at least once a year.

2. Be careful! Always before the game check your lenses. If you notice any scratches, cracks or damage, replace them with new ones. If the screws that hold the lens to mask have come loose - tighten them.

3. Always replace the lens, if you have been hit directly at a distance not less than 10 ft (3 m), even if you do not see any damage.

4. Lenses or foil covering have not been tested for various chemical reactions to anti-fog agents such as lotions or sprays.

Note: Do not use other chemicals because it can lead to damage of the original coating as a result of e.g. adverse chemical reaction.

5. Do not store the lens or mask around chemicals or their fumes. Most of them cause damage to the lenses and protective films.

Always store the mask with the lens in a dry, cool place.

6. Always wash your lenses with tap water and nothing else. Chemical agents may lead to the damage of the internal structure of plastic, from which they were produced. If the lenses have been in contact with chemicals - discard them and replace with a new model compatible with your mask.

7. Clean your lens separately from the mask to remove excess paint from balls thoroughly. Never leave your mask and lenses soiled with paint for a long time. It can damage the protective their properties of lenses.

8. Before re-assembling the mask with the lens dry each part accurately.

9. Before and after every game mask and especially lens must be cleaned to ensure maximum visibility. In order to clean it use a soft microfiber cloth a cotton cloth, attested or specially intended for cleaning eyeglass lenses cloth.

Remember: a use of hard cloth, paper towels, newspaper, etc., or cleaning chemicals may damage the coating or scratch the lens. As a result, protective properties of the lens might be lost. Gently wipe but do not polish the lenses!

10. Before each game check the condition of the screws that mount the lens to the mask. Although, the metal coating is protected, remember that long-term use and frequent exposure to water can lead to corrosion and improper holding of lenses.

USER'S MANUAL AND MAINTENANCE OF FEO MASKS:

FEO masks are made of high quality resin reinforced with glass fiber or aramid (Kevlar) which provides solid face protection against the ball that flies at the speed less than 90 m / sec.

1. Before and after each game, check the condition of shell masks, protective paddings, and straps that mount the mask to one's face. Remember: if any tears or cracks appear immediately replace them with new ones.

2. Always wash your shell masks by hands separately from the other parts, with running water and nothing else. Chemical agents may lead to a damage of the internal structure of plastics, from which it was produced. If the mask has had contact with chemicals or fumes - discard it and replace with a new one.

3. Masks are painted with non-toxic acrylic water-based paint, in addition, protected with colorless varnish. To dry the mask or wipe it, use a soft microfiber cloth or cotton. Do not polish the mask with hard materials, paper or paper towels. This may damage the outer layer of varnish.

4. Polyurethane foam in the strap which mounts the mask to face and interior padding is lined with 100% cotton (depending on the model of the mask). This prevents from possible facial abrasions, which could appear as a result of prolonged, direct contact with the foam. Washing of all the elements is recommended after each game to prevent the damage of cushioning materials from drying paint balls and for hygiene reasons. Hand wash only!

5. In order to ensure maximum comfort and fit of the mask to the individual shape of one's face, FEO masks feature inner moving parts of paddings. They can be fixed individually with Velcro, so it feels comfortably. The plush velcro part in the shell allows the use of a mask without paddings e.g. in combination with a balaclava.

6. Always before the game, make sure that the internal padding is fastened well to the shell mask. Note, that front padding left loose or too low fixing may limit the view, which significantly affects the safety of the game.



NOTE!

Before using the mask with protective lenses, read carefully the user's manual. If you have any doubts or questions how to use it and maintain, contact us!

This product is intended for persons over **18 years** of age. Minors play paintball and use masks only with the consent and under the supervision of adults.

USER'S MANUAL OF ASSEMBLY AND PUTTING ON THE MASK:

1. Assembly and disassembly of the lenses.

a) In order not to interfere with the field of vision, the inner and outer lenses are not marked in any descriptive way. It should be noted that the inner side is taped with soft anti-fog film lens, which gives more matte appearance. Therefore, the outer side, if it is not covered with a decoration foil (such as sunscreen or mirror) has the structure of a clean, shiny Plexiglas.

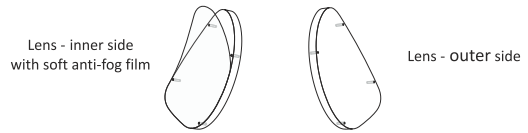

b) Once outer side has been identified, right and left lens should be adjusted accordingly to the shape of the holes in the mask (the screw holes in the lens must coincide perfectly with the holes in the rear flange of the lens, in the eye sockets of the mask).

c) After fixing the lens, they must be mounted with supplied screws and nuts with a 1.5 mm Allen wrench (not included in kit). Before each game, check the quality of tightening. They have to be tightened up, so that during the movement and vibration of the mask, nuts will not fall off and cause an eye injury.

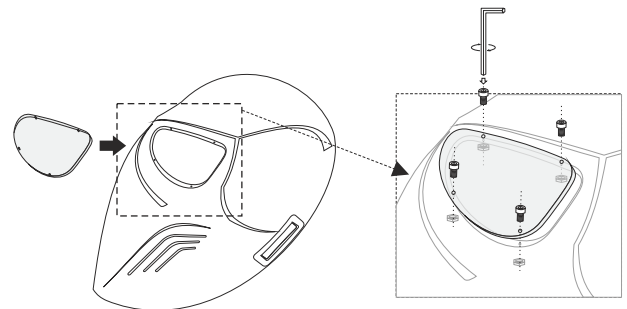

2. Adjusting the elements of the internal padding.

The interior of the mask has been equipped with moving parts that can be fastened with Velcro. Adjust the position so that the mask fits comfortably your head (forehead). Attach them carefully with Velcro (that are sewn on the foam) to the velour tape inside the mask.

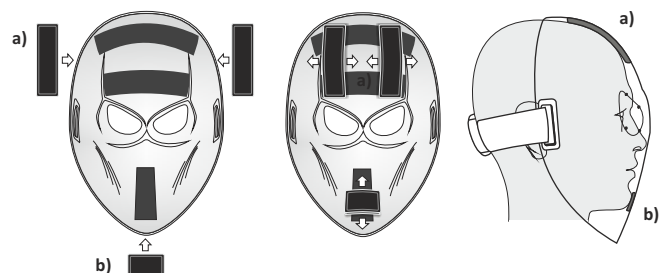

NOTE!

Adjust the alignment of the foam padding both vertically and horizontally, so the position of the mask ensures complete freedom of movement of the head. Remember! The mask cannot slide down, or move on the face during the game!

he mask can also be used without the accompanying interior padding or with a balaclava. However, that the felt impact force may be greater.

3. Putting on the mask

FEO mask design requires no fixing it by uncomfortable pressure goggles to face with rubber strips at the back of the head. FEO solution is to apply the anatomical shape of the head and move the center of gravity to the top of the mask - the front part of the mask (Fig. 1 / A). Foam padded strap is fitted with adjustable Velcro buckle on both sides of the face. The strap only helps to maintain the masks at the occiput (Fig. 1 / B). This fixing system gives comfort to your face and a sense of lightness.

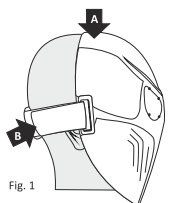
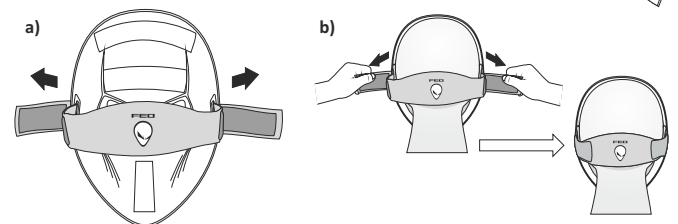

Fig. 1



a) Loosen the Velcro strap on both sides and put a mask on your head.

b) Grasp both ends of the strap together and tighten the belt and fasten with Velcro on both sides evenly.

c) If you have long hair and wear a ponytail put it above the strap.

d) Before the game, make sure that the mask does not fall or move on the face in case of rapid head movement.