

**SAMSUNG**

**3 DVD MINI  
COMPONENT SYSTEM**  
DVD/VCD/CD/MP3-CD/CD-R/RW  
PLAYBACK

THIS APPLIANCE IS MANUFACTURED BY:

MAX- DC650

**Instruction Manual**

**SAMSUNG**

**ELECTRONICS**

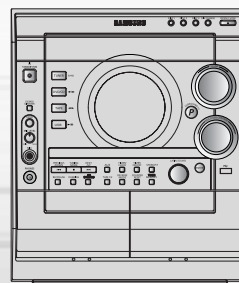

DivX

**DVD**  
VIDEO

COMPACT  
**disc**  
DIGITAL AUDIO

COMPACT  
**disc**  
DIGITAL VIDEO

**MP3**  
DIGITAL PLAYBACK

AH68-01674C



## Safety Warnings

CLASS 1 LASER PRODUCT  
 KLASSE 1 LASER PRODUKT  
 LUOKAN 1 LASER LAITE  
 KLASSE 1 LASER APPARAT  
 PRODUCTO LASER CLASE 1



**CAUTION:**  
 TO REDUCE THE RISK OF ELECTRIC SHOCK, DO NOT REMOVE REAR COVER. NO USER SERVICEABLE PARTS INSIDE. REFER SERVICING TO QUALIFIED SERVICE PERSONNEL.

### CLASS 1 LASER PRODUCT

This Compact Disc player is classified as a CLASS 1 LASER product.

Use of controls, adjustments or performance of procedures other than those specified herein may result in hazardous radiation exposure.

### CAUTION-INVISIBLE LASER RADIATION WHEN OPEN AND INTERLOCKS DEFEATED, AVOID EXPOSURE TO BEAM.



This symbol indicates that dangerous voltage which can cause electric shock is present inside this unit.



This symbol alerts you to important operating and maintenance instructions accompanying the unit.

**WARNING:** To reduce the risk of fire or electric shock, do not expose this appliance to rain or moisture.

**CAUTION:** TO PREVENT ELECTRIC SHOCK, MATCH WIDE BLADE OF PLUG TO WIDE SLOT, FULLY INSERT.

THIS APPLIANCE IS FITTED WITH 220V SASO APPROVED PLUG. THE CUSTOMER IS ENTITLED TO A FREE SASO APPROVED 127V PLUG FROM THE LOCAL DEALER.



## Precautions

PREPARATION

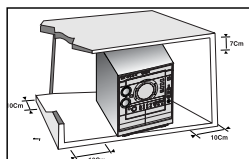

Ensure that the AC power supply in your house complies with the identification sticker located on the back of your player. Install your player horizontally, on a suitable base (furniture), with enough space around it for ventilation (3-4inches). Make sure the ventilation slots are not covered. Do not stack anything on top of the player. Do not place the player on amplifiers or other equipment which may become hot. Before moving the player, ensure the disc tray is empty. This player is designed for continuous use. Switching off the DVD player to the stand-by mode does not disconnect the electrical supply. In order to disconnect the player completely from the power supply, remove the main plug from the wall outlet, especially when left unused for a long period of time.

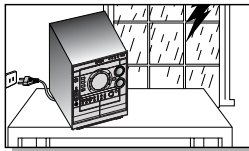
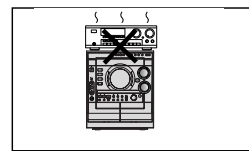

During thunderstorms, disconnect AC main plug from the wall outlet. Voltage peaks due to lightning could damage the unit.

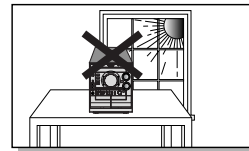

Do not expose the unit to direct sunlight or other heat sources. This could lead to overheating and malfunction of the unit.

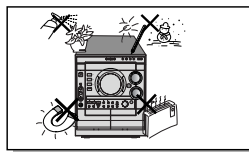

Protect the player from moisture (i.e. vases), and excess heat (e.g. fireplace) or equipment creating strong magnetic or electric fields (i.e. speakers...). Disconnect the power cable from the AC supply if the player malfunctions. Your player is not intended for industrial use. Use of this product is for personal use only. Condensation may occur if your player or disc have been stored in cold temperatures. If transporting the player during the winter, wait approximately 2 hours until the unit has reached room temperature before using.

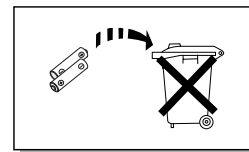

The battery used with this product contain chemicals that are harmful to the environment. Do not dispose of batteries in the general household trash.



## Features

### ● Multi-Disc Playback & AM/FM Tuner, TAPE

The MAX-DC650 combines the convenience of multi-disc playback capability, including DVD, CD, MP3-CD, CD-R, CD-RW, VCD, DivX, JPEG and DVD-R/RW, with a sophisticated AM/FM tuner, TAPE, all in a single player.

### ● TV Screen Saver Function

The MAX-DC650 automatically brightens and darkens the brightness of the TV screen after 3 minutes in the stop mode.  
The MAX-DC650 automatically switches itself into the power saving mode after 20 minutes in the screen saver mode.

### ● Power Saving Function

The MAX-DC650 automatically shuts itself off after 20 minutes in the stop mode.

### ● Customized TV Screen Display

The MAX-DC650 allows you to select your favorite image during JPEG, DVD playback and set it as your background wallpaper.



**DVD (Digital Versatile Disc)** offers fantastic audio and video, thanks to Dolby Digital surround sound and MPEG-2 video compression technology. Now you can enjoy these realistic effects in the home, as if you were in a movie theater or concert hall.



DVD players and the discs are coded by region. These regional codes must match in order for the disc to play. If the codes do not match, the disc will not play.  
The Region Number for this player is given on the rear panel of the player.  
(Your DVD player will only play DVDs that are labeled with identical region codes.)

### Copy Protection

- Many DVD discs are encoded with copy protection. Because of this, you should only connect your DVD player directly to your TV, not to a VCR. Connecting to a VCR results in a distorted picture from copy-protected DVD discs.
- This product incorporates copyright protection technology that is protected by methods claims of certain U.S. patents and other intellectual property rights owned by Macrovision Corporation and other rights owners. Use of this copyright protection technology must be authorized by Macrovision Corporation, and is intended for home and other limited viewing uses only unless otherwise authorized by Macrovision Corporation. Reverse engineering or disassembly is prohibited.



## Contents

|  |    |
|--|----|
| <b>● PREPARATION</b>                             |    |
| Safety Warnings                                  | 1  |
| Precautions                                      | 2  |
| Features   | 3  |
| Description                                      | 5  |
| <b>● CONNECTIONS</b>                             |    |
| Connecting the Speakers                          | 9  |
| Connecting to a TV                               | 10 |
| P.SCAN(Progressive Scan) Function                | 12 |
| Connecting External Components                   | 13 |
| Connecting the FM,AM(MW)and SW(option) Antennas  | 14 |
| Setting the Clock                                | 15 |
| <b>● OPERATION</b>                               |    |
| Disc Playback                                    | 16 |
| DivX Playback                                    | 17 |
| Playing Media Files using the USB feature        | 19 |
| Displaying Disc Information                      | 21 |
| Fast/Slow Playback                               | 22 |
| Skipping Scenes/Songs                            | 23 |
| Angle Function                                   | 24 |
| Repeat Playback                                  | 25 |
| A-B Repeat Playback                              | 27 |
| Zoom Function                                    | 28 |
| Selecting Audio/Subtitle Language                | 29 |
| Moving Directly to a Scene/Song                  | 30 |
| JPEG File Playback                               | 31 |
| Using Disc Menu                                  | 33 |
| Using the Title Menu                             | 34 |
| <b>● SETUP</b>                                   |    |
| Setting the Language                             | 35 |
| Language Code List                               | 36 |
| Setting TV Screen type                           | 37 |
| Setting Parental Controls (Rating Level)         | 39 |
| Setting the Password                             | 40 |
| Setting the Wallpaper                            | 41 |
| Setting the DRC (Dynamic Range Compression)      | 43 |
| AV SYNC Setup                                    | 44 |
| <b>● RADIO OPERATION</b>                         |    |
| Listening to Radio                               | 45 |
| Presetting Stations                              | 46 |
| <b>● TAPE DECK</b>                               |    |
| Listening to a Cassette                          | 47 |
| <b>● MISCELLANEOUS</b>                           |    |
| Recording a Compact Disc                         | 50 |
| Recording a Radio Program                        | 52 |
| Timer Function                                   | 53 |
| Ccanceling the Timer                             | 54 |
| P.SOUND/SURROUND/SURROUND XT/SOUND MODE Function | 55 |
| Sleep Timer Function / Mute Function             | 56 |
| DEMO Function / DIMMER Function                  | 57 |
| Connecting Headphones/Microphone(option)         | 58 |
| Cautions on Handling and Storing Discs           | 59 |
| Before Calling for Service                       | 60 |
| Notes on Discs                                   | 62 |
| Notes on Terminology                             | 63 |
| Specifications                                   | 64 |

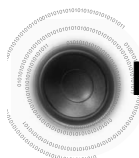

# Description

## —Front Panel—

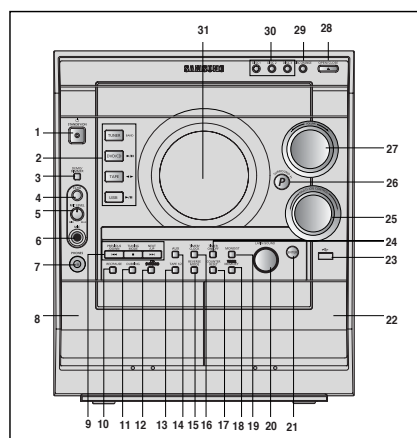

1. STANDBY/ON
2. FUNCTIONS SELECT BUTTONS
3. DEMO/DIMMER
4. ECHO
5. MIC LEVEL(Optional)
6. MIC(Optional)
7. PHONES
8. CASSETTE DECK 1
9. SEARCH FUNCTIONS BUTTONS
10. TUNING MODE OR STOP BUTTONS
11. REC/PAUSE
12. DUBBING
13. CD SYNCHRO
14. TAPE 1/2
15. AUX
16. REVERSE MODE
17. TIMER/CLOCK
18. COUNTER RESET
19. TUNER MEMORY
20. FM MONO/ST
21. LATIN SOUND
22. ENTER
23. CASSETTE DECK 2
24. USB
25. TIMER ON/OFF
26. MULTI JOG
27. POWERSOUND/SURROUNDXT/SURROUND
28. VOLUME+
29. CD Open/Close
30. DISC CHANGE
31. DISC SELECTION BUTTONS
32. WINDOW DISPLAY

## —Display Window—

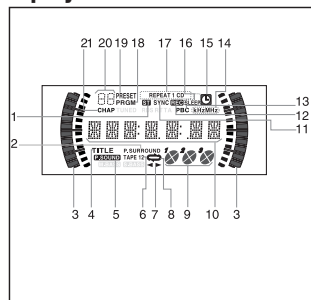

1. FM MODE (STEREO)
2. POWER SURROUND
3. Volume
4. TITLE
5. POWER SOUND
6. TAPE 1/2
7. TAPE RUNNING DIRECTOR
8. TAPE REVERSE MODE
9. PLAYING DISC NUMBER
10. MAIN DISPLAY(FUNCTION,FREQUENCY,TIME,etc.)
11. CD SYNCHRO RECORDING
12. RECORDING
13. PBC
14. TUNER FREQUENCY UNIT
15. CLOCK
16. SLEEP
17. CD PLAYING DISC MODE OR CD
18. REPEAT MODE
19. TUNER MEMORY
20. TO PROGRAM
21. TUNER PRESET
22. TUNER PRESET NUMBER
23. CHAPTER

## —Rear Panel—

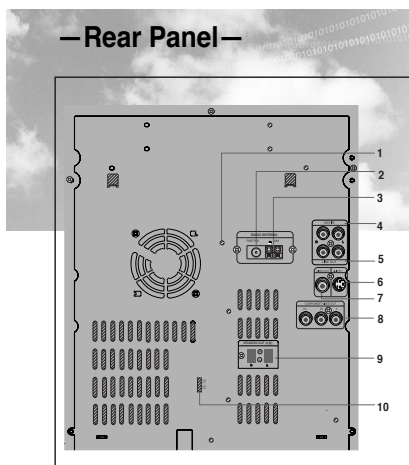

1. SW Antenna Connector (Option)
2. FM Antenna Connector
3. AM Antenna Connector
4. AUX-Input
5. LINE OUT
6. S-Video Output Connector  
If the TV is equipped with an S-Video input connector (S-VIDEO IN), connect it to the player's S-Video output jack.
7. Video Output Connector  
Connect the TV's video input jacks (VIDEO IN) to the VIDEO OUT connector.
8. Component Video Output Connectors  
Connect a TV with component video input jacks to these jacks.
9. Speaker Connector Terminals
10. Voltage Selector (Option)

## Accessories

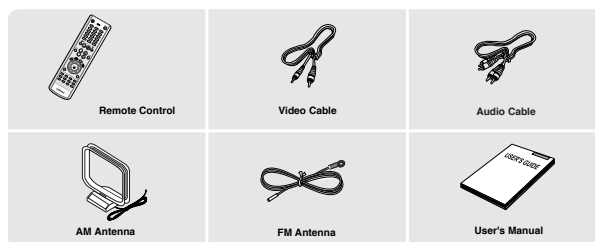





## Description

### —Remote Control—

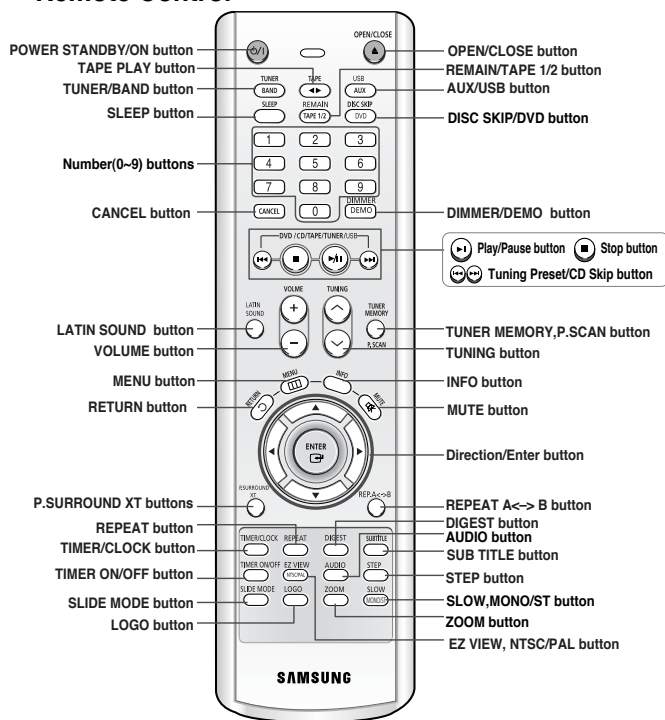

7

### PREPARATION

#### Insert Remote Batteries

**1** Remove the battery cover on the back of the remote by pressing down and sliding the cover in the direction of the arrow.



**2** Insert two 1.5V AAA batteries, paying attention to the correct polarities (+ and -).

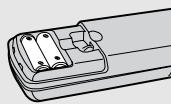

**3** Replace the battery cover.

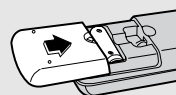

#### Caution

Follow these precautions to avoid leaking or cracking cells:

- Place batteries in the remote control so they match the polarity:(+) to (+)and (-)to (-).
- Use the correct type of batteries.Batteries that look similar may differ in voltage.
- Always replace both batteries at the same time.
- Do not expose batteries to heat or flame.

#### Range of Operation of the Remote Control

The remote control can be used up to approximately 23 feet/7 meters in a straight line. It can also be operated at a horizontal angle of up to 30° from the remote control sensor.

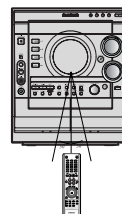

8



## Connecting the Speakers

Before moving or installing the product, be sure to turn off the power and disconnect the power cord.

Connect the connecting jacks (2) to the back of mini-compact system.

♦ Make sure the polarities (+and -) are correct.

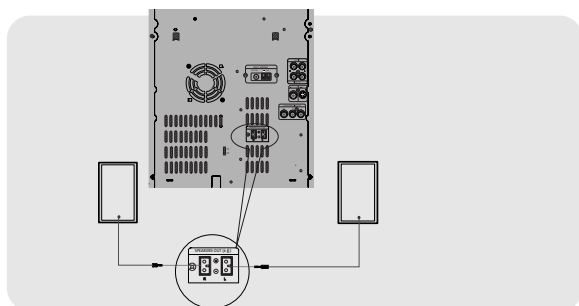

### Position of the DVD Player

- Place it on a stand or cabinet shelf, or under the TV stand.

### Speakers L R

- Place these speakers in front of your listening position, facing inwards (about 45°) toward you.
- Place the speakers so that their tweeters will be at the same height as your ear.

### Directions in Installing Speaker

- Installation in a place near heating apparatus, under direct lay of light or with high humidity may cause performance degradation of the speaker.
- Do not install on the wall or on a high place of pole or other unstable place to prevent any safety accident caused by falling of the speaker.
- Do not take the speaker near from TV or computer monitor.  
The speaker near the TV or computer monitor may influence the quality of the screen display.



## Connecting to a TV

Please be sure to turn off the power and unplug the power cord before moving or installing this unit.  
Please choose one of three video connection methods.

### Method 1 Using Video Out (Good Quality)

- Connect Video Out on the player to Video In on your TV.
- Press the TV/VIDEO button on the remote of TV control to set the TV to "VIDEO".

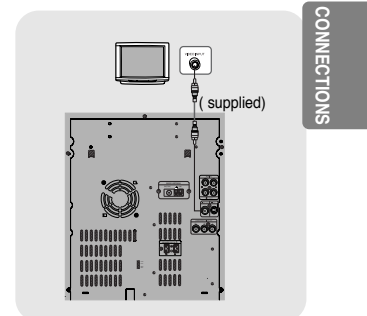

### Method 2 Using S-Video Out (Better Quality)

Use this method if your TV has an S-Video In jack.

- Connect S-Video Out to S-Video In on your TV.
- Press the TV/VIDEO button on the remote control of TV to set the TV to "S-VIDEO".

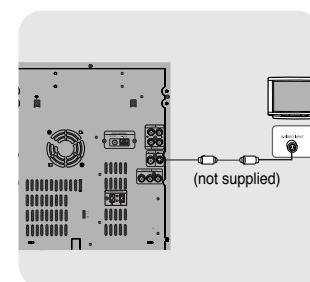

### Note

- Composite Video: A single video signal that is a composite of the black-and-white information (Y) and the color information (C).
- S-Video: A video transmission standard that provides a sharper, brighter picture than ordinary composite video by separating brightness and color signals.



## Connecting to a TV(Con't)

Please be sure to turn off the power and unplug the power cord before moving or installing this unit.  
Please choose one of three video connection methods.

### Method 3 Component Video (Best Quality)

Use this method if your TV have Pr,Pb andY jacks.

If you television is equipped with Component Video inputs,connect a component video cable from the Pr,Pb and Y jacks on the back panel of the system to the corresponding jacks on your television.

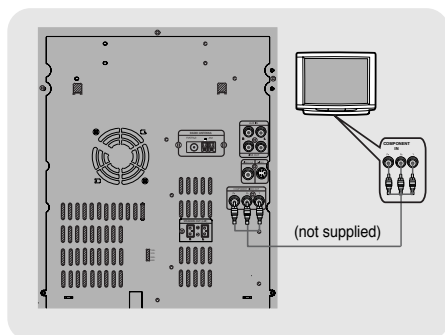



## P.SCAN (Progressive Scan) Function

Unlike regular Interlace Scan, in which two fields of picture information alternate to create the entire picture (odd scan lines, then even scan lines), Progressive Scan uses one field of information (all lines displayed in one pass) to create a clear and detailed picture without visible scan lines.

**Press and hold P.SCAN button on the remote controller for over 5 seconds in stop mode.**

- Pressing and holding the button for over 5 seconds will select "Progressive Scan" and "Interlace Scan" repetitively.

### What is Progressive (or Non-Interlaced) Scanning?

| Interlaced Scan (1 FRAME = 2 FIELDS)   | Progressive Scan (FULL FRAME)   |
|--|---|
|  <p>In interlaced-scan video, a frame consists of two interlaced fields (odd and even), where each field contains every other horizontal line in the frame. The odd field of alternating lines is displayed first, and then the even field is displayed to fill in the alternating gaps left by the odd field to form a single frame. One frame, displayed every 1/30th of a second, contains two interlaced fields, thus a total of 60 fields are displayed every 1/60th of a second. The interlaced scanning method is intended for capturing a still object.</p> |  <p>The progressive scanning method scans one full frame of video consecutively down the screen, line by line. An entire image is drawn at one time, as opposed to the interlaced scanning process by which a video image is drawn in a series of passes. The progressive scanning method is desirable for dealing with moving objects.</p> |

#### Note

- This function works only on TVs equipped with component video inputs (Y, Pr, Pb) that support Progressive Video. (It does not work on TVs with conventional component inputs, i.e., non-progressive scan TVs.)
- Depending on the brand and model of your TV, this function may not work.

### Selecting the Video Format

Turn off the main unit and then press **NTSC/PAL** on the Remote Control or **REC/PAUSE** on the Main Unit.

- By default, the video format is set to "PAL".
- Each time the button is pressed, the video format switches between "NTSC" and "PAL".
- Each country has a different video format standard.
- For normal playback, the video format of the disc must be the same as the video format of your TV.

## Connecting External Components

### Connecting an External Analog Component

Example: Analog signal components such as a VCR, Camcorder, and TV.

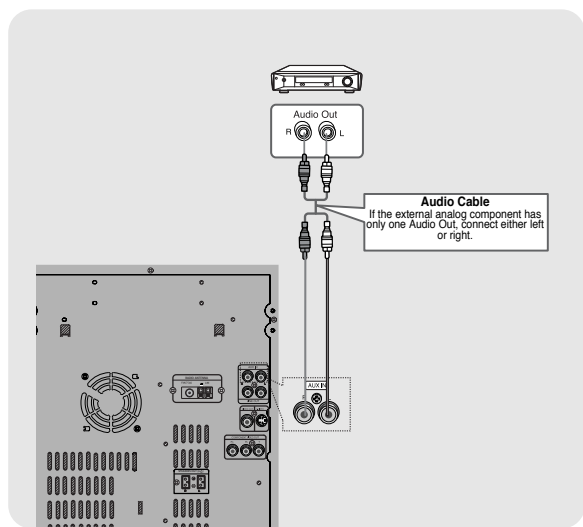

- 1 Connect Audio In on the DVD player to Audio Out on the external analog component.
  - Be sure to match connector colors.

- 2 Press **AUX** to select AUX.
  - 'AUX' appears in the display.

## Connecting the FM, AM(MW) and SW(option)Antennas

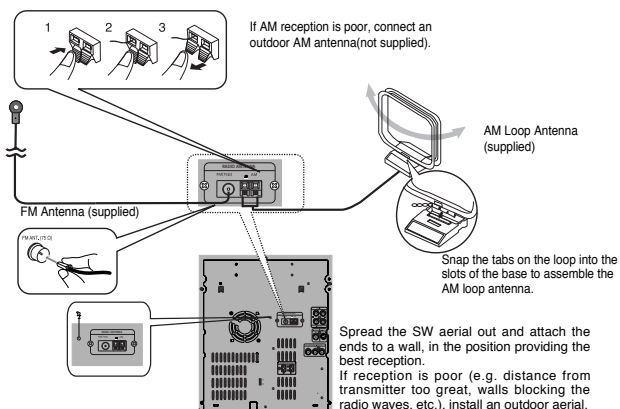

### FM antenna connection

1. Connect the FM antenna supplied to the FM 75Ω COAXIAL terminal as a temporary measure.
2. Slowly move the antenna wire around until you find a location where reception is good, then fasten it to a wall or other rigid surface.

• If reception is poor, connect an outdoor antenna. Before attaching a 75Ω coaxial cable (with a standard type connector), disconnect the supplied FM antenna.

### AM (MW) antenna connection

1. Connect the AM loop antenna supplied to the AM and MW terminals.
2. If reception is poor, connect an outdoor single vinyl-covered wire to the AM terminal. (Keep the AM loop antenna connected).



## Setting the Clock

For each step, you have a few seconds to set the required options.  
If you exceed this time, you must start again.

**1** Switch the system on by pressing **STANDBY/ON** button.

**2** Press **TIMER/CLOCK** twice.

- **CLOCK** is displayed.

**3** Press **ENTER**.  
The hour flashes.

- Increase the hours : ►
- Decrease the hours : ◄

### Note

- You can display the time, even when you are using another function, by pressing **TIMER/CLOCK** once.

**4** When the correct hour is displayed, press **ENTER**.  
The minutes flash.

- Increase the minutes : ►
- Decrease the minutes : ◄

**5** When the correct time is displayed, press **ENTER**.

- **"TIMER"** appears in the display.
- The current time is now set.

### Note

• You can also use Multi-Jog or ◄ ► buttons on the panel front instead of ◄ ► buttons in step 3,4.

## Checking the Remaining Time

Press the **REMAIN** button.

- For checking the total and remaining time of a title or chapter being played.

Each time the **REMAIN** button is pressed

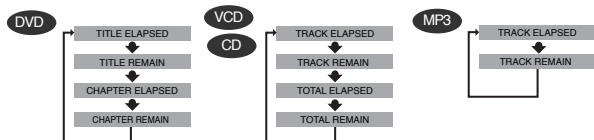

## Disc Playback

### Selecting a CD in the Disc changer

To select a specific disc, press the corresponding **DISC (1, 2, 3)** button on the front panel or **DISC SKIP** on the remote control, until the required disc indicator flashes.  
Result: All the discs will be played in turn, starting with the one selected.

- If you use the **DISC (1, 2, 3)** function when listening to the radio or to a tape, the system switches automatically to the CD mode.
- If the disc selected is not loaded, the next disc is played automatically.

PREPARATION

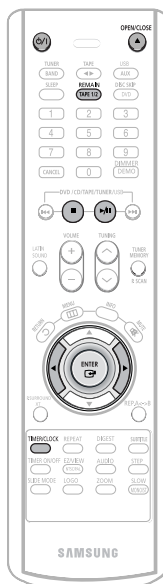

DVD VCD CD

- Playback starts automatically.

MP3 JPEG DivX

- Playback starts automatically.
- If the TV is on, a list of MP3s on the CD will appear on the TV screen.



### Note

- Depending on the content of the disc, the initial screen may appear different.
- Depending on the recording mode, some MP3-CDs cannot be played.
- Table of contents of a MP3-CD varies depending on the MP3 track format recorded on the disc.

To stop playback, press **STOP** during playback.

- If pressed once, **"PRESS PLAY"** is displayed and the stop position will be stored in memory. If **PLAY/PAUSE** (►/II) button or **ENTER** button is pressed, playback resumes from the stop position. (This function works only with DVDs.)
- If pressed twice, **"STOP"** is displayed, and if **PLAY/PAUSE** (►/II) button is pressed, playback starts from the beginning.

To temporarily pause playback, press **PLAY/PAUSE** during playback.

- To resume playback, press **PLAY/PAUSE** button again.



During playback, press the **⏮⏭** button.

-  Fast playback

Press and hold **⏮⏭** button.

- 



**1** Press **ZOOM** button.

- Each time you press the button, your selection will toggle between "ZOOM X2" and "ZOOM OFF".

**2** Press Cursor ▲, ▼, ◀, ▶ buttons to move to the area you want to enlarge.

**Note** • DivX files can be played in Zoom X2 mode only.

5 Minute Skip function

During playback, press the ◀, ▶ button.

- Go to the screen about 5 minutes after whenever you press ► button.
- Go to the screen about 5 minutes earlier whenever you press ◀ button.

 Subtitle Display

Press the **SUBTITLE** button.

- Each time you press the button, your selection will toggle between "SUBTITLE ON" and "SUBTITLE OFF".
- If the disc has only one subtitle file, it will be played automatically.
- Up to 8 subtitle languages are supported.

## DivX Feature Table

DivX Supported

**Avi files** are used to contain the audio and video data; these must be stored on CD in the ISO 9660 format.

|                     |          | SPEC                     |
|---------------------|----------|--------------------------|
| VIDEO Compatibility | DivX3.11 | Up to the latest VERSION |
|                     | WMV      | WMV V1/V2/V3/V7          |
| AUDIO Compatibility | MP3      | CBR : 80kbps~320kbps     |
|                     | AC3      | CBR : 128kbps~448kbps    |
|                     | WMA      | CBR : 56kbps~160kbps     |

MPEGs containing DivX can be divided into Video and Audio.

- **Video compatibility** : All versions of DivX later than 3.11 (including the latest 5.1) are supported. In addition, XviD is supported. For WMV, V1, V2, V3, and V7 formats are possible.
- **Audio compatibility** : MP3s encoded at bitrates from 80kbps to 320kbps, AC3s from 128kbps to 448kbps, and WMAs from 56kbps to 160kbps are supported.
- **In addition, for subtitles, this unit will support Text format (SML).**

- In addition, for subtitles, this unit will support Text format (SMI).

#### Note

- When playing the DivX disk, you can play the file with extension of AVI only.
- Among the available DivX audio formats, DTS Audio is not supported.
- WMV V8 is not supported for WMV files.
- When burning a subtitle file to a CD-ROM with your PC, be sure to burn it as an SMI file.

## CONNECTIONS



## Playing Media Files using the USB feature

You can connect and play files from external USB storage devices such as MP3 players, USB flash memory, etc. using the player's USB function.

**1** connect the USB cable.

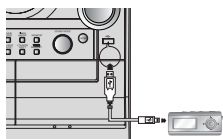

**2** Press the **USB** button on the main unit or the **AUX** button on the remote control to select the USB mode.

- "USB" appears on the display screen and then disappears.
- USB SORTING screen appears on the TV screen and the saved file is played.

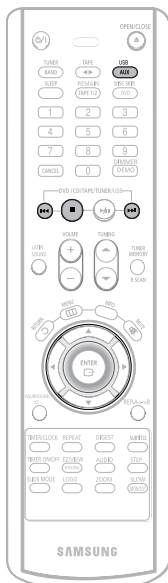

To stop playback, press the **STOP** (■) button.

- Note**
- Video files (DivX, ASF, WMV, MPEG, etc.) are not supported.
  - To prevent the loss of data saved in the USB device, please turn the unit off or switch it to another mode before disconnecting the USB cable.

To play a file in the USB menu screen,



- Music File Icon
- Image File Icon
- All File Icon
- Movie File Icon

Press the **◀ ▶ ▲ ▼** button when it is in stop status and select a desired icon from the top part of the menu.

- To play music files only, select the **MUSIC** icon.
- To view image files only, select the **IMAGE** icon.
- To select all files select the **ALL** icon.
- To view movies files only, select the **MOVIE** icon.

19

## Skip Forward/Back

During playback, press the **◀▶** button.

- When there is more than a file, when you press the **▶▶** button, the next file is selected.
- When there is more than a file, when you press the **◀◀** button, the previous file is selected.

## Fast playback

To play back the disc at a faster speed, press and hold **◀◀** or **▶▶** during playback.

- Each time you press and hold either button, the playback speed will change as follows:  
2x → 4x → 8x → 32x → Normal.

## Compatible Devices

1. USB devices that support USB Mass Storage v1.0.  
(USB devices that operate as a removable disk in Windows (2000 or later) without additional driver installation.)
2. MP3 Player: HDD and flash type MP3 player.
3. Digital camera: PTP protocol is not supported.
  - Devices which require additional program installation when you have connected it to a computer, are not supported.
4. USB HDD and USB Flash Drive: Devices that support USB2.0 or USB1.1.
  - You may experience a difference in playback quality when you connect a USB1.1 device.
  - For a USB HDD, make sure to connect an auxiliary power cord to the USB HDD for proper operation.
5. USB card Reader: One slot USB card reader and Multi slot USB card reader
  - Depending on the manufacturer, the USB card reader may not be supported.
  - If you install multiple memory devices into a multi card reader, you may experience problems.

### Supported Formats

|               | File name | File extension | Bit rate   | Version | Pixel   | Sampling Frequency |
|---------------|-----------|----------------|------------|---------|---------|--------------------|
| Still Picture | JPG       | .JPG .JPEG     | —          | —       | 640*480 | —                  |
| Music         | MP3       | .MP3           | 80~384kbps | —       | —       | 44.1kHz            |
|               | WMA       | .WMA           | 56~128kbps | V8      | —       | 44.1kHz            |

- A device using NTFS file system is not supported.  
(Only FAT file system is supported.)

20



## Displaying Disc Information

You can view playback information on the disc on the TV screen.

Press **INFO** button.

- Each time the button is pressed, the display changes as follows:

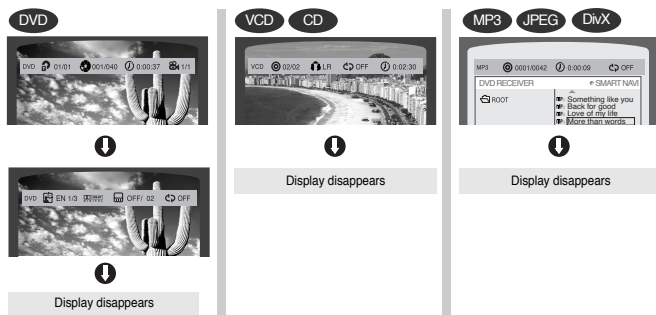

### Note

- Depending on the disc, the disc information display may appear different.
- Depending on the disc, you can also select DOLBY DIGITAL, or PRO LOGIC.

- What is a Title?**  
A movie contained in a DVD disc.
- What is a Chapter?**  
Each title on a DVD disc is divided into several smaller sections called "chapters".  
If this symbol appears on the TV screen!  
If this symbol appears on the TV screen while buttons are being operated, that operation is not possible with the disc currently being played.
- What is a Track (File)?**  
A section of video or a music file recorded on a VCD, CD, or MP3-CD.

### Screen Display

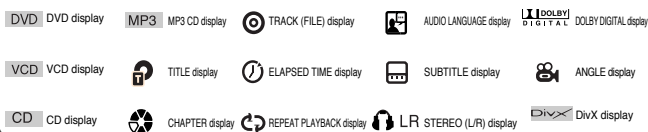

## Fast/Slow Playback

### Fast Playback DVD VCD CD MP3

Press and hold **FAST**.

- Each time the button is held down during playback, the playback speed changes as follows:

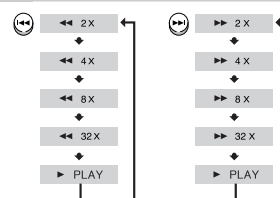

OPERATION

### Slow Playback

Press **SLOW** button.

- Each time the button is pressed during playback, the playback speed changes as follows:

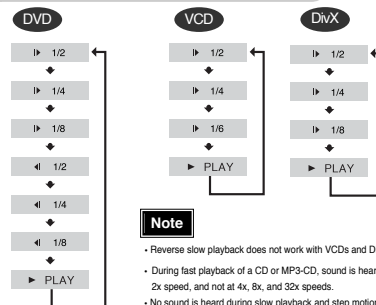





## Skipping Scenes/Songs

DVD VCD MP3

Briefly press **I◀▶I**.

- Each time the button is pressed briefly during playback, the previous or next chapter, track, or directory (file) will be played.
- But, you cannot skip chapters consecutively.

DVD



VCD



MP3



- When watching a VCD with a track longer than 15 minutes, each time **I◀▶I** is pressed, playback will skip back or forward 5 minutes.

Playing Frame by Frame **DVD**

Press **STEP** button.

- The picture moves forward one frame each time the button is pressed during playback.



## Angle Function

This function allows you to view the same scene in different angles.

DVD

**1** Press **INFO** button.



**2** Press **Cursor ▶** button to move to **ANGLE** display.



OPERATION

**3** Press **Cursor ▲, ▼** buttons or numeric buttons to select the desired angle.

- Each time the button is pressed, the angle changes as follows:

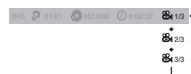

**Note** • The Angle function works only with discs on which multiple angles have been recorded.

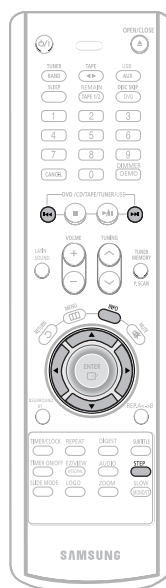



## Repeat Playback

Repeat playback allows you to repeatedly play a chapter, title, track (song), or directory (MP3 file).

DVD VCD CD MP3 JPEG

Press **REPEAT** button.

- Each time the button is pressed during playback, the repeat playback mode changes as follows:

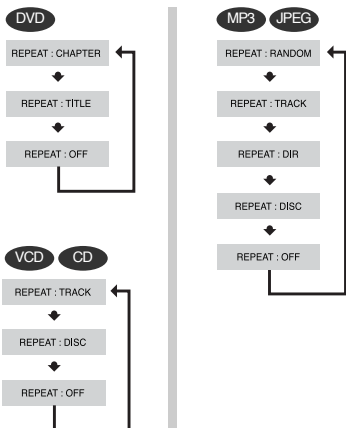

### Repeat Playback Options

- CHAPTER**  
Repeatedly plays the selected chapter.
- TITLE**  
Repeatedly plays the selected title.
- RANDOM**  
Plays tracks in random order.  
(A track that has already been played may be played again.)
- TRACK**  
Repeatedly plays the selected track.
- DIR**  
Repeatedly plays all tracks in the selected folder.
- DISC**  
Repeatedly plays the entire disc.
- OFF**  
Cancels Repeat Playback.

### Note

- Repeat playback operation is not possible with version 2.0 VCD discs if PBC is turned on.  
To use Repeat Playback on a VCD with PBC, you should set the PBC to OFF in the disc menu. (See page 33.)

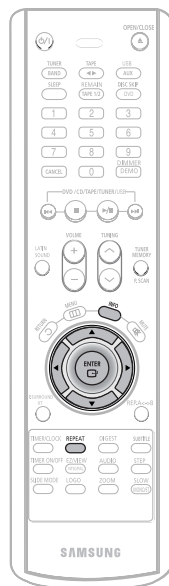

DVD VCD CD

## To Select a Repeat Playback Mode in the Disc Information Screen

**1** Press **INFO** button twice.

- For a VCD or CD, Press INFO button once.

**2** Press Cursor **▶** button to move to **REPEAT PLAYBACK** display.

**3** Press Cursor **▼** button to select the desired Repeat Playback mode.

**4** Press **ENTER** button.

### Note

- For MP3 and JPEG discs, you cannot select Repeat Play from the information display screen.



## A↔B Repeat Playback

DVD VCD CD

- 1 Press **REP. A↔B** at the beginning of the section you want to repeat.

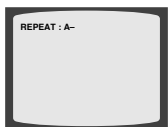

- 2 Press **REP. A↔B** at the end of the section.

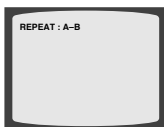

To cancel AB Repeat Playback, press **REP. A↔B** to select "REPEAT PLAYBACK: OFF".

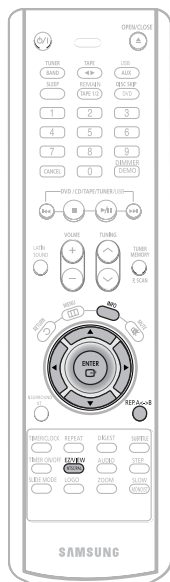
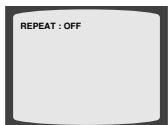

### Note

- A-B Repeat Playback does not work on MP3 and JPEG discs.
- To select AB Repeat Playback from the information display screen, press **REP. A↔B**.



## Zoom Function

This function allows you to enlarge a particular area of the displayed image.

### Zoom (Screen Enlarge) Function

DVD VCD

- 1 Press **ZOOM** button.



- 2 Press Cursor **▲, ▼, ◀, ▶** buttons to move to the area you want to enlarge.



- 3 Press **ENTER** button.

• Each time the button is pressed, the zoom level changes as follows:

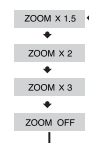

OPERATION

### Aspect Ratio

DVD

Press **EZ VIEW** button.

- Each time the button is pressed, the zoom function will switch between On and Off.
- When a movie is played in Wide screen format, black bars at the top and bottom of the TV screen can be removed by pressing the **EZ VIEW** button.



### Note

- This function will not work if the DVD is recorded with multi-camera angle format.
- Black bars may not disappear because some DVD discs have a built-in horizontal to vertical ratio.



## Selecting Audio/Subtitle Language

### Audio Language Selection Function DVD

**1** Press **INFO** button twice.

DVD EN 1/3 OFF/ 02 OFF

**2** Press Cursor **▲**, **▼** buttons or numeric buttons to select the desired audio language.

• Depending on the number of languages on a DVD disc, a different audio language (ENGLISH, SPANISH, JAPANESE, etc.) is selected each time the button is pressed.

SP 2/3  
FR 3/3

### Subtitle Language Selection Function DVD

**1** Press **INFO** button twice.

DVD EN 1/3 OFF/ 02 OFF

**2** Press Cursor **▶** button to move to **SUBTITLE** display.

DVD EN 1/3 OFF/ 02 OFF

**3** Press Cursor **▼** button or numeric buttons to select the desired subtitle.

DVD EN 1/3 OFF/ 02 OFF

SP 02/ 03  
FR 02/ 03  
OFF / 03

#### Note

- You can use the SUBTITLE button on the remote control to select a subtitle language.
- Depending on the disc, the Subtitle and Audio Language functions may not work.

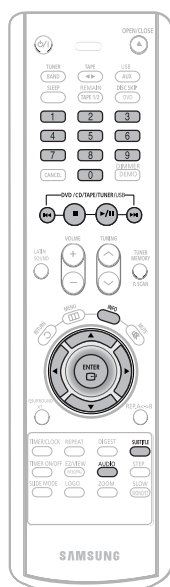

## Moving Directly to a Scene/Song

DVD VCD CD

**1** Press **INFO** button.

DVD 01:05 02:04:00 0:30:37 1/1

### Moving to a Chapter

**4** Press Cursor **▲**, **▼** buttons or numeric buttons to select the desired chapter and then press **ENTER** button.

DVD 01:05 02:04:00 0:30:37 1/1

### Moving to a Title/Track

**2** Press Cursor **▲**, **▼** buttons or numeric buttons to select the desired title/track and then press **ENTER** button.

DVD 01:05 02:04:00 0:30:37 1/1

### Moving to a Specific Time

**5** Press Cursor **◀**, **▶** buttons to move to time display.

DVD 01:05 02:04:00 0:30:37 1/1

### Moving to a Chapter

**3** Press Cursor **◀**, **▶** buttons to move to Chapter display.

DVD 01:05 02:04:00 0:30:37 1/1

### Moving to a Specific Time

**6** Press the numeric buttons to select the desired time and then press **ENTER** button.

DVD 01:05 02:04:00 0:30:37 1/1

OPERATION

MP3 JPEG

Press the numeric buttons.

- The selected file will be played.
- An MP3 or JPEG disc cannot be moved from the disc information screen.
- When playing an MP3 or JPEG disc, you cannot use **▲**, **▼** to move a folder. To move a folder, press **■** (Stop) and then press **▲**, **▼**.



#### Note

- You can press **◀◀▶▶** on the remote control to move directly to the desired title, chapter, or track.
- Depending on the disc, you may not be able to move to the selected title or time.

 Slide Mode

**3** Press **SLIDE MODE** button.

- 
- The diagram illustrates the SLIDE SHOW MODE menu structure. It consists of a vertical list of menu items, each in a grey box, connected by downward-pointing arrows. The items are: SLIDE SHOW MODE : 1, SLIDE SHOW MODE : 2, an ellipsis, SLIDE SHOW MODE : 10, SLIDE SHOW MODE : 11, SLIDE SHOW MODE : RANDOM, and SLIDE SHOW MODE : NONE. To the right of the menu, a large black arrow points downwards, indicating the flow from top to bottom. Text labels describe the functions of these modes: 'From top to bottom' for mode 1, 'From bottom to top' for mode 2, 'Rectangular shape in the center' for mode 10, 'Vertical curtain shape' for mode 11, 'Each time a new image is displayed (1-11) will be randomly and automatically selected' for mode RANDOM, and 'Cancels the slide mode.' for mode NONE.
- | SLIDE SHOW MODE          | Function  |
|--------------------------|---|
| SLIDE SHOW MODE : 1      | From top to bottom  |
| SLIDE SHOW MODE : 2      | From bottom to top  |
| ...                      |   |
| SLIDE SHOW MODE : 10     | Rectangular shape in the center   |
| SLIDE SHOW MODE : 11     | Vertical curtain shape  |
| SLIDE SHOW MODE : RANDOM | Each time a new image is displayed (1-11) will be randomly and automatically selected |
| SLIDE SHOW MODE : NONE   | Cancels the slide mode.   |

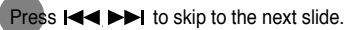

- 31

 Digest Function

- 1 Press **DIGEST** button during playback.

- 

**2** Press Cursor ▲, ▼, ◀, ▶ buttons to select the desired image and then press **ENTER** button.

- 

## OPERATION

 Rotate/Flip Function

Original Image

▲ button: Flip Vertically

▶ button: Rotate 90° Clockwise

▼ button: Flip Horizontally

◀ button: Rotate 90° Counterclockwise

32



## Using the Title Menu





## Setting the Language

OSD language is set to English by default.



## Language Code List

Enter the appropriate code number for the initial settings "Disc Audio", "Disc Subtitle" and/or "Disc Menu" (See page 33).

1 Press MENU button.



2 Press Cursor▼ button to move to 'Setup' and then press ENTER button.



3 Press ENTER button.



4 Press Cursor▲▼ button to select the desired item and then press ENTER button.



5 Press Cursor▲▼ button to select the desired language and then press ENTER button.



• Once the setup is complete, if the language was set to English, OSD will be displayed in English.

### Note

• To select other language, select OTHER and enter the language code of your country. (See 34 page for language code of countries)  
AUDIO, SUB TITLE and DISC MENU language can be selected.



Selecting the OSD Language



Selecting the Audio Language (recorded on the disc)



Selecting the Subtitle Language (recorded on the disc)

Selecting the Disc Menu Language (recorded on the disc)

\* If the language you selected is not recorded on the disc, menu language will not change even if you set it to your desired language.

| Code | Language        | Code | Language     | Code | Language         | Code | Language   |
|------|-----------------|------|--------------|------|------------------|------|------------|
| 1027 | Afar            | 1181 | Frisian      | 1334 | Latvian, Lettish | 1506 | Slovenian  |
| 1028 | Abkhazian       | 1183 | Irish        | 1345 | Malagasy         | 1507 | Samoan     |
| 1032 | Afrikaans       | 1186 | Scots Gaelic | 1347 | Maori            | 1508 | Shona      |
| 1039 | Amharic         | 1194 | Galician     | 1349 | Macedonian       | 1509 | Somali     |
| 1044 | Arabic          | 1196 | Guarani      | 1350 | Malayalam        | 1511 | Albanian   |
| 1045 | Assamese        | 1203 | Gujarati     | 1352 | Mongolian        | 1512 | Serbian    |
| 1051 | Aymara          | 1209 | Hausa        | 1353 | Moldavian        | 1513 | Siswati    |
| 1052 | Azerbaijani     | 1217 | Hindi        | 1356 | Marathi          | 1514 | Sesotho    |
| 1053 | Bashkir         | 1226 | Croatian     | 1357 | Malay            | 1515 | Sundanese  |
| 1057 | Byelorussian    | 1229 | Hungarian    | 1358 | Maltese          | 1516 | Swedish    |
| 1059 | Bulgarian       | 1233 | Armenian     | 1363 | Burmese          | 1517 | Swahili    |
| 1060 | Bihari          | 1235 | Interlingua  | 1365 | Nauru            | 1521 | Tamil      |
| 1069 | Bislama         | 1239 | Interlingue  | 1369 | Nepali           | 1525 | Tegulu     |
| 1066 | Bengali, Bangla | 1245 | Inupiak      | 1376 | Dutch            | 1527 | Tajik      |
| 1067 | Tibetan         | 1248 | Indonesian   | 1379 | Norwegian        | 1528 | Thai       |
| 1070 | Breton          | 1253 | Icelandic    | 1393 | Occitan          | 1529 | Tigrinya   |
| 1079 | Catalan         | 1254 | Italian      | 1403 | (Afan) Oromo     | 1531 | Turkmen    |
| 1093 | Corsican        | 1257 | Hebrew       | 1408 | Oriya            | 1532 | Tagalog    |
| 1097 | Czech           | 1261 | Japanese     | 1417 | Punjabi          | 1534 | Setswana   |
| 1103 | Welsh           | 1269 | Yiddish      | 1428 | Polish           | 1535 | Tonga      |
| 1105 | Danish          | 1283 | Javanese     | 1435 | Pashto, Pushto   | 1538 | Turkish    |
| 1109 | German          | 1287 | Georgian     | 1436 | Portuguese       | 1539 | Tsonga     |
| 1130 | Bhutani         | 1297 | Kazakh       | 1463 | Quechua          | 1540 | Tatar      |
| 1142 | Greek           | 1298 | Greenlandic  | 1481 | Rhaeto-Romance   | 1543 | Twi        |
| 1144 | English         | 1299 | Cambodian    | 1482 | Kirundi          | 1557 | Ukrainian  |
| 1145 | Esperanto       | 1300 | Kannada      | 1483 | Romanian         | 1564 | Urdu       |
| 1149 | Spanish         | 1301 | Korean       | 1489 | Russian          | 1572 | Uzbek      |
| 1150 | Estonian        | 1305 | Kashmiri     | 1491 | Kinyarwanda      | 1581 | Vietnamese |
| 1151 | Basque          | 1307 | Kurdish      | 1495 | Sanskrit         | 1587 | Volapuk    |
| 1157 | Persian         | 1311 | Kirghiz      | 1498 | Sindhi           | 1613 | Wolof      |
| 1165 | Finnish         | 1313 | Latin        | 1501 | Sangro           | 1632 | Xhosa      |
| 1166 | Fiji            | 1326 | Lingala      | 1502 | Serbo-Croatian   | 1665 | Yoruba     |
| 1171 | Faeroese        | 1327 | Laothian     | 1503 | Singhalese       | 1684 | Chinese    |
| 1174 | French          | 1332 | Lithuanian   | 1505 | Slovak           | 1697 | Zulu       |

SETUP



## Setting TV Screen type

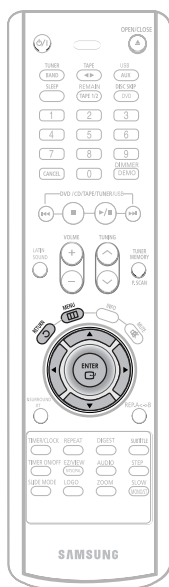

**1** Press **MENU** button.



**2** Press Cursor  $\blacktriangledown$  button to move to 'Setup' and then press **ENTER** button.



**3** Press Cursor  $\blacktriangledown$  button to move to 'TV DISPLAY' and then press **ENTER** button.



**4** Press Cursor  $\blacktriangle$ ,  $\blacktriangledown$  button to select the desired item and then press **ENTER** button.

• Once the setup is complete, you will be taken to the previous screen.



### Adjusting the TV Aspect Ratio (Screen Size)

The horizontal to vertical screen size ratio of conventional TVs is 4:3, while that of wide screen and high definition TVs is 16:9. This ratio is called the aspect ratio. When playing DVDs recorded in different screen size, you should adjust the aspect ratio to fit your TV or monitor.

★ For a standard TV, select either "4:3LB" or "4:3PS" option according to personal preference. Select "16:9" if you have a wide screen TV.

#### WIDE

: Select this to view a 16:9 picture in the full-screen mode on your wide screen TV.  
• You can enjoy the wide screen aspect.



#### 4:3LB (4:3 Letter box)

: Select this to play a 16:9 picture in the letter box mode on a conventional TV.  
• Black bars will appear at the top and bottom of the screen.



#### 4:3PS (4:3 Pan&Scan)

: Select this to play a 16:9 picture in the pan & scan mode on a conventional TV.  
• You can see the central portion of the screen only (with the sides of the 16:9 picture cut off).



#### Note

- If a DVD is in the 4:3 ratio, you cannot view it in wide screen.
- Since DVD discs are recorded in various image formats, they will look different depending on the software, the type of TV, and the TV aspect ratio setting.

SETUP

Press **RETURN** button to return to the previous level.

Press **MENU** button to exit the setup screen.





## Setting Parental Controls (Rating Level)

Use this to restrict playback of adult or violent DVDs you do not want children to view.

**1** Press **MENU** button.



**2** Press Cursor **▼** button to move to 'Setup' and then press **ENTER** button.



**3** Press Cursor **▼** button to move to 'PARENTAL' and then press **ENTER** button.



**4** Press Cursor **▲, ▼** button to select the desired rating level and then press **ENTER** button.

- If you have selected Level 6, you cannot view DVDs with Level 7 or higher.
- The higher the level, the closer the content is to violent or adult material.



**5** Enter the password and then press **ENTER** button.

- The password is set to "7890" by default.
- Once the setup is complete, you will be taken to the previous screen.



### Note

- This function works only if a DVD disc contains the rating level information.

Press **RETURN** button to return to the previous level.

Press **MENU** button to exit the setup screen.



## Setting the Password

You can set the password for the Parental (rating level) setting.

**1** Press **MENU** button.



**2** Press Cursor **▼** button to move to 'Setup' and then press **ENTER** button.



**3** Press Cursor **▼** button to move to 'PASSWORD' and then press **ENTER** button.



**4** Press **ENTER** button.



**5** Enter the password and then press **ENTER** button.

- Enter the old password, a new password, and confirm new password.
- The setting is complete.



SETUP

Press **RETURN** button to return to the previous level.

Press **CANCEL** button to cancel the error numeric when you inputting password.

Press **MENU** button to exit the setup screen.



JPEG DVD

**1** During playback, press **PLAY/PAUSE** button when the image you like comes up.

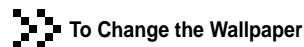

**1** Press **MENU** button.



**2** Press Cursor ▼ button to move to 'Setup' and then press **ENTER** button.

**3** Press **Cursor** ▼ button to move to 'LOGO' and then press **ENTER** button.

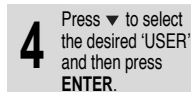

**4** Press ▼ to select the desired 'USER' and then press **ENTER**.

**5** Press **MENU** button to exit the setup screen.



- The selected wallpaper will be displayed.
- You can repeat Steps 1 and 2 to set up to 3 wallpapers.
- The power will turn off and turn on automatically and back on the display mode.



Select this to set the Samsung Logo image as your wallpaper.



Select this to set the desired image as your wallpaper.

Press **RETURN** button to return to the previous level.

Press **MENU** button to exit the setup screen.

## SETUP



## Setting the DRC (Dynamic Range Compression)

You can use this function to enjoy Dolby Digital sound when watching movies at low volume at night.

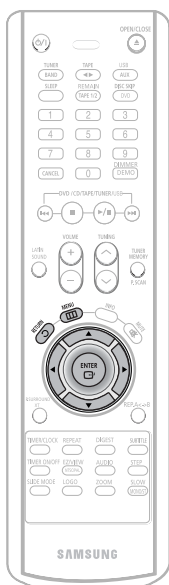

**1** Press MENU button.



**2** Press Cursor ▼ button to move to 'Audio' and then press ENTER button.



**3** If "DRC" is selected, press ENTER.



**4** Press Cursor ▲, ▼ to adjust the 'DRC'.

• The more times the Cursor ▲ button is pressed, the greater the effect, and the more times Cursor ▼ button is pressed, the smaller the effect.



Press RETURN button to return to the previous level.

Press RETURN button to return to the previous level.

Press MENU button to exit the setup screen.



## AV SYNC Setup

Video may look slower than the audio if it is connected with digital TV. In this case, adjust the delay time of audio to optimal status to fit the video.

**1** Press the MENU button.

• Setup menu appears.



**2** Press Cursor ▲, ▼ buttons to move to 'Audio' and then press ENTER button.

• 'Audio' menu appears.



**3** Press Cursor ▲, ▼ buttons to move to 'AV-SYNC' and then press ENTER button.

• AV-SYNC screen appears.

**4** Press Cursor ▲, ▼ buttons to select the Delay Time of AV-SYNC and then press the ENTER button.

• You can set the audio delay time between 0 ms and 300 ms. Set it to the optimal status.



SETUP

Press RETURN button to return to the previous level.

Press MENU button to exit the setup screen.

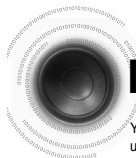

## Listening to Radio

You can listen to the chosen band (FM, MW, (SW1,2) broadcast stations) by using either the automatic or manual tuning operation.



## Presetting Stations

You can store up to:

- 15 FM stations
- 5 MW stations(or AM 15 stations)
- 5 SW1 stations (Option)
- 5 SW2 stations (Option)

### Remote Control Unit

#### 1 Press TUNER/BAND button.

- The selection toggles back and forth between "FM → MW → (SW1,2)" each time the **TUNER(BAND)** button is pressed.

#### 2 Tune in to the desired station.

- Automatic Tuning 1** Press **◀▶▶▶** button to select the preset station.
- Automatic Tuning 2** Press and hold **🔍** button to automatically search the band.
- Manual Tuning** Briefly press **🔍** button to increase or decrease the frequency incrementally.

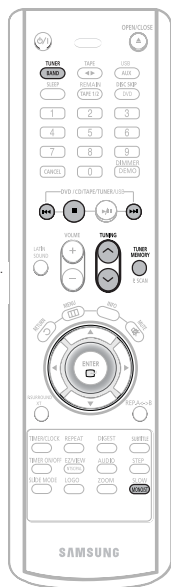

### Main Unit

#### 1 Press the Function button to select the desired band (FM, MW, (SW1,2)).

#### 2 Select a broadcast station.

- Automatic Tuning 1** Press the **STOP (■)** button to select PRESET and then press **◀▶▶▶** button or turn Multi Jog Knob to select the preset station.
- Automatic Tuning 2** Press the **STOP (■)** button to select "AUTO" and then press and hold **◀▶▶▶** button or turn Multi-Jog Knob to automatically search the band.
- Manual Tuning** Press **STOP (■)** to select MANUAL and then briefly press **◀▶▶▶** or turn Multi Jog Knob to tune in to a lower or higher frequency.

### Example: Presetting FM 89.1 in the memory

#### 1 Press the TUNER(BAND) button and select the FM band.

- Each time the button is pressed, the band switches between "FM → MW → (SW1,2)".



#### 2 Press **🔍** to select "89.10".

- Refer to Step 2 on page 41 to automatically or manually tune in to a station.

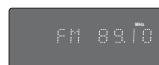

#### 3 Press the TUNER MEMORY button.

- "PROGRAM" flashes in the display.



#### 4 Press **◀▶▶▶** to select preset number.

- You can select between 1 and 15.



#### 5 Press the TUNER MEMORY button.

- Press the **TUNER MEMORY** button before "PROGRAM" disappears from the display.
- "PROGRAM" disappears from the display and the station is stored in memory.

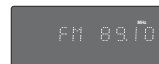

#### 6 To preset another station, repeat steps 2 to 5.

RADIO OPERATION

Press **MONO/ST** button to listen in Mono/Stereo.  
(This applies only when listening to an FM station.)

- Each time the button is pressed, the sound switches between "STEREO" and "MONO".
- In a poor reception area, select MONO for a clear, interference-free broadcast.

To tune in to a preset station, press **◀▶▶▶** on the remote control to select a channel.



## Listening to a Cassette

Always treat your cassettes with care; refer, if necessary, to the section entitled "Precautions When Using Audio Cassettes" on page 59.

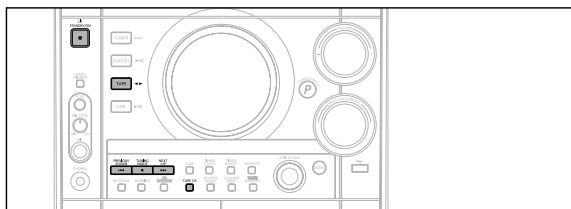

**1** Switch the system on by pressing **STANDBY ON**.

**2** Press **TAPE** on the player to select the Tape function.

**3** Press the **PUSH EJECT** (▲) of the cassette tape to open the cassette door and insert a cassette.

- Insert a cassette with the recording/playback side facing the cassette holder, and then push the cassette door shut.

**4** Press the ◀▶ button. The cassette starts playing.

- Side A : Tape (◀▶) button once.
- Side B : Tape (◀▶) button twice. (Tape 2 only)
- Press TAPE 1/2 button to select the cassette to be played.

**5** Press the ◀◀, ▶▶ button if necessary.

- Rewind the cassette ◀◀/ DOWN button.
- Fast-forward the cassette UP / ▶▶ button.

**6** When you have finished playback, press **STOP** button.

## Selecting the Cassette Playback Mode

Your micro component system has three cassette playback modes which enable you to listen to both sides of a cassette automatically. (TAPE 2 only).

Press **REVERSE MODE** until the appropriate symbol is displayed.

- ⏮ : One side of the selected cassette and then stops.
- ⏪ : One side of the cassette.  
The other side of the cassette and then stops.
- ⏻ : Both sides of the cassette indefinitely until you press stop.

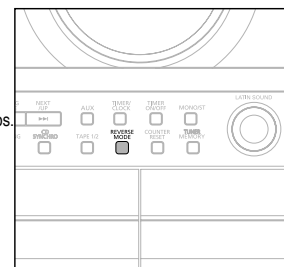

## Tape Counter

When playing a cassette in one of the cassette decks, a counter is displayed to enable you to take note of the counter value at the start of each track to start playback at the beginning of the track to which you wish to listen.

- Before starting to record a cassette for which you wish to take note of the counter values at the beginning of each track, reset the counter by pressing **COUNTER RESET**.
- Each cassette deck has a separate counter.

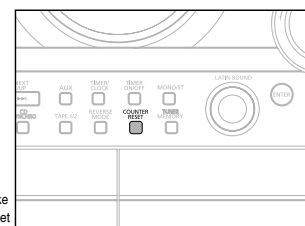

TAPE TAPE

## ❏ Copying a Cassette(Dubbing)

You can copy a cassette from Tape 1 to Tape 2.

- Normal speed dubbing in selecting Tape function mode.
- You do not need to adjust the volume, as it has no effect on the recording.
- Take care not to insert the tape to be copied in Tape 2, as it will be erased when you start recording.

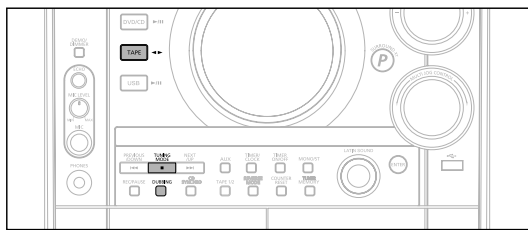

**1** Switch the system on by pressing **STANDBY/ON**.

**2** Insert a blank cassette in **Tape 2**.

**3** Insert the tape to be copied in **Tape1**.

**4** Press **DUBBING** button to copy a cassette.

**5** Press **STOP** button.

The appropriate indications are displayed and the cassette in Tape 1 is copied to the cassette in Tape 2.



## Recording a Compact Disc

You can record a compact disc on a cassette in two different ways:

### Synchronised recording

This feature enables you to synchronize the start of the recording with the start of the disc or track of your choice.

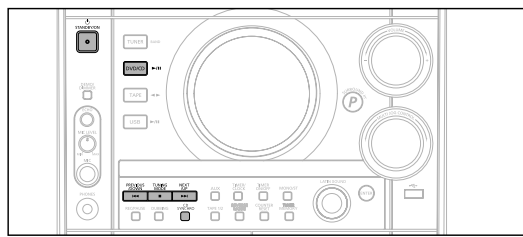

**1** Switch the system on by pressing **STANDBY/ON**.

**2** Insert a blank cassette in Tape 2.

**3** Load a compact disc.

- Press the **PUSH/EJECT** button (▲) to open the cassette door, insert a cassette, and then close the cassette door.
- Insert the cassette with the safety tabs.

- Press the **OPEN/CLOSE** button (▲) to open the CD door.
- Insert a CD and press the **OPEN/CLOSE** button (▲) to close the CD door.

**4** Press the **DVD/CD** (▶/II) button.

- Use the CD selection (◀◀, ▶▶) buttons to select the desired song.

**5** Press **CD SYNCHRO** button.

- When stopped, press the button to start the recording from the first piece of music.
- Press and hold **CD/SYNCHRO** button during the playback of CD to start the recording from the first part of the music being played.

**6** To stop recording, press ■ button.

**Note**

- You can use **CD/SYNCHRO** button only in CD Playback Mode.

MISCELLANEOUS

## Direct recording

The direct recording mode enables you to start recording with any track on the compact disc.

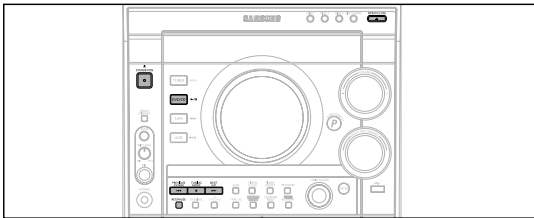

**1** Switch the system on by pressing **STANDBY/ON**.

**2** Insert a blank cassette in Tape 2.

- Press the **PUSH/EJECT** button (▲) to open the cassette door, insert a cassette, and then close the cassette door.
- Insert the cassette with the safety tabs.

**3** Load a compact disc.

- Press the **OPEN/CLOSE** button (▲) to open the CD door.
- Insert a CD and press the **OPEN/CLOSE** button (▲) to close the CD door.

**4** Press the **DVD/CD** (▶/||) button.

- Use the CD selection (◀◀, ▶▶) buttons to select the desired song.

**5** Press **REC/PAUSE** button.

- Recording will begin.
- To stop recording, press ■ button.

### Note

- The cassette tape you want to record on must have the safety tabs intact.



## Recording a Radio Program

You can record a radio program of your choice.

You do not need to adjust the volume, as it has no effect on the recording.

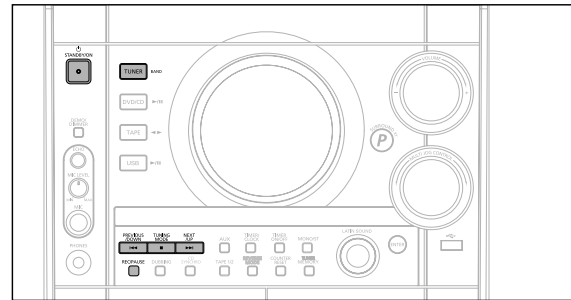

**1** Switch the system on by pressing **STANDBY/ON**.

**2** Insert a blank cassette in Tape 2.

**3** Select the **TUNER** function by pressing **TUNER/BAND**.

**4** Select the radio station that you wish to record by pressing **◀◀/DOWN** or **UP/▶▶** button.

**5** Press **(REC/PAUSE)** button.

- **REC** is displayed in red and recording starts.

**6** To stop recording, press ■ button.

MISCELLANEOUS

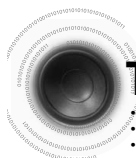

## Timer Function

- The timer enables you to switch the system on or off at specific times.
  - If you no longer want the system to be switched on or off automatically, you must cancel the timer.
  - Before setting the timer, check that the current time is correct.
  - For each step, you have a few seconds to set the required options.
- If you exceed this time, you must start again.

**Example:** You wish to wake up to music every morning.

**1** Switch the system on by pressing **STANDBY/ON**.

**2** Press **TIMER/CLOCK** until **TIMER** is displayed.

**3** Press the **ENTER** button.

- **ON TIME** is displayed (instead of the equalizer symbols) for a few seconds, followed by any switch-on time already set; you can set the timer switch-on time.

**4** Set the timer switch-on time.

- Set the hour by pressing ◀ or ▶ button.
- Press **ENTER**.
  - The minutes flash.
- Set the minutes by pressing ◀ or ▶ button.
- Press **ENTER**.
  - **OFF TIME** is displayed (instead of the equalizer symbols) for a few seconds, followed by any switch-off time already set; you can now set the timer switch-off time.

**5** Set the timer switch-off time.

- Set the hour by pressing ◀ or ▶ button.
- Press **ENTER**.
  - The minutes flash.
- Set the minutes by pressing ◀ or ▶ button.
- Press **ENTER**.
  - **VOL 10** is displayed, where 10 corresponds to the volume already set.

**6** Press ◀ or ▶ button to adjust the volume level and press **ENTER**.

- The source to be selected is displayed.

**7** Press ◀ or ▶ button to select the source to be played when the system switches on.

- **TAPE** (cassette) : Insert a cassette tape.
- **TUNER** (radio) : a Press **ENTER**.
  - Select a preset station by pressing ◀ or ▶.
- **CD** (compact disc) : Load a compact disc.

**8** Press **ENTER** to confirm the timer.

**9** Press **STANDBY/ON** to set the system to standby mode.

- ☹ is displayed to the top right of the time, indicating that the timer has been set.
- The system will switch on and off automatically at the required times.

### Note

- If the timer switch on and off times are identical, the word **ERROR** is displayed.
- You can also use Multi Jog or ◀◀▶▶ button to instead ◀, ▶ button on the remote control in step 4,5,6,7.



## Canceling the Timer

After having set the timer, it will start automatically as shown by the **TIMER** indication on the display. If you no longer wish to use the timer, you must cancel it.

To cancel the timer, press **TIMER ON/OFF** once.

- ☹ is no longer displayed.

To resume the timer, press **TIMER ON/OFF** again.

- ☹ is displayed again.

### Note

- You can cancel the timer while the power is on or while the player is in standby.

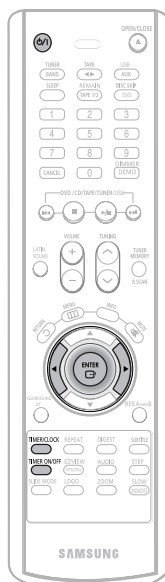





## P.SOUND/SURROUND and SOUND MODE Function

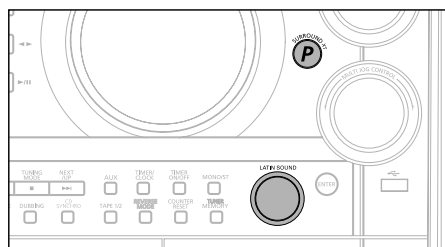

### P.SOUND/SURROUND/SORROUND XT Function

Your mini-compact system is equipped with the function of Power Sound/Power Surround/Power Surround XT. The function of Power Sound/Power Surround /Power Surround XT amplifies bass and improves high key or bass twice as much for you to appreciate powerful real sound.

Press the **SURROUND XT** button on the front panel.

Result: Press **SURROUND XT** button on the front panel, "**P.SOUND,P.SURROUND,P.SURROUNDXT, OFF**" is displayed.

To cancel this function, press **SURROUND XT** button again .

### Selecting SOUND MODE

Your mini-compact system is equipped with a preset equalizer that allows you to choose the most appropriate balance between treble and bass frequencies, according to the type of music you are listening to.

Turn **SOUND MODE** on the front panel or Press **SOUND MODE** on the remote control until the required option is selected.

| To obtain a...                     | Select... |
|------------------------------------|-----------|
| Normal balance (linear)            | PASS      |
| Balance suitable for pop music     | POP       |
| Balance suitable for rock music    | ROCK      |
| Balance suitable for classic music | CLASSIC   |
| Balance suitable for hall          | HALL      |
| Balance suitable for live          | LIVE      |
| Balance suitable for cinema        | CINEMA    |



## Sleep Timer Function / Mute Function

### Sleep Timer Function

You can set the time that the DVD player will shut itself off.

Press **SLEEP** button.

- Each time the button is pressed, the selection changes as follows:  
**90 MIN → 60 MIN → 45 MIN → 30 MIN → 15 MIN → OFF.**



To confirm the sleep timer setting, press **SLEEP** button.

- The remaining time before the DVD player will shut itself off is displayed.
- Pressing the button again changes the sleep time from what you have set earlier.

To cancel the sleep timer, press **SLEEP** button until **OFF** appears on the display.

### Mute Function

This is useful when answering a doorbell or telephone call.

Press **MUTE** button.

- '**MUTE**' appears in the display.
- To turn off mute, press the button again.



MISCELLANEOUS



## DEMO Function / DIMMER Function

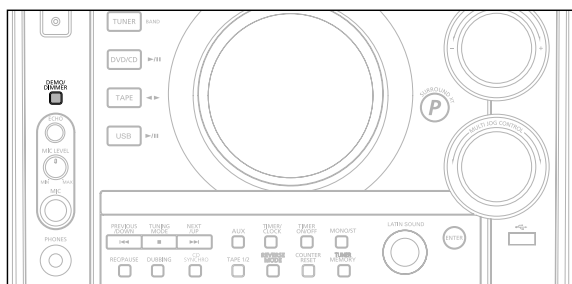

### DEMO Function

You can view the various functions available on your system.

Press **DEMO/DIMMER** button.

- The various functions available are listed in turn on the display.
- All these functions are described in detail in this booklet. For instructions on how to use them, refer to the appropriate sections.

To cancel this function, press **DEMO/DIMMER** again.



### DIMMER Function

You can adjust the brightness of the display on the main unit so it won't interfere with your movie viewing.

Press **DEMO/DIMMER** button.

- Each time the button is press, the brightness changes as follows: **DIMMER ON(Dim) → DIMMER OFF(Bright)**.



## Connecting Headphones/Microphone(option)

You can connect a set of headphones to your micro component system so that you can listen to music or radio programmers without disturbing other people in the room. The earphones must have a 3.5ø jack or an appropriate adapter.

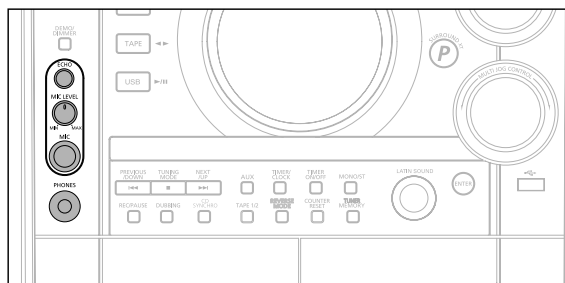

Connect the headphones to the **PHONES** jack on the front panel.

- The loudspeakers are no longer used to output the sound.

#### Note

- Prolonged use of headphones at a high volume may damage your hearing.



Plug the microphone with a 6.3ø MIC jack into microphone terminal.

- Connect the Microphone.
- Turn the **MIC LEVEL** knob to adjust the **MIC** volume.
- Press the **ECHO** button to select ECHO1, ECHO2, and ECHO OFF.
- During using the microphone, you can press the **REC/PAUSE** button to record your favorite.



## Cautions on Handling and Storing Discs

Small scratches on the disc may reduce sound and picture quality or cause breaks in playback. Be especially careful not to scratch discs when handling them.

### Handling discs



**Do not touch the playback side of the disc. Hold the disc by the edges so that fingerprints will not get on the surface.**  
**Do not stick paper or tape on the disc.**

### Handling and Storing Discs



**When you get fingerprints or dirt on the disc, clean it with a mild detergent diluted in water and wipe with a soft cloth.**

- When cleaning, wipe gently from the inside to the outside of the disc.

#### Note

- Condensation may form if warm air comes into contact with cold parts inside the player. When condensation forms inside the player, the player may not operate correctly. If this occurs, remove the disc and let the player stand for 1 or 2 hours with the power on.

### Precautions When Using Audio Cassettes

- Check that the tape in the cassette is sufficiently taut.
- To prevent erasing a cassette that you wish to keep, remove the safety tab on the upper edge of the cassette. To record a cassette, where the tab has been broken, simply cover the opening with adhesive tape.
- When you have finished playing a cassette, always put it back in its case.
- Store your cassettes in a clean place, out of direct sunlight, where they will not be exposed to high temperatures.
- Avoid using 120-minute cassettes as they place unnecessary strain on the tape mechanism.

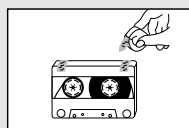
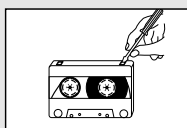
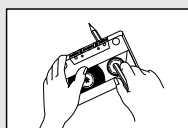

## Before Calling for Service

Refer to the chart below when this unit does not function properly. If the problem you are experiencing is not listed below or if the instruction below does not help, turn off the unit, disconnect the power cord, and contact the nearest authorized dealer or Samsung Electronics Service Center.

| Symptom   | Check/Remedy   |
|---|--|
| Disc tray does not open.  | <ul style="list-style-type: none"> <li>• Is the power cord plugged securely into the outlet?</li> <li>• Turn off the power and then turn it back on.</li> </ul>  |
| Playback does not start.  | <ul style="list-style-type: none"> <li>• Check the region number of the DVD.</li> <li>• DVD discs purchased from abroad may not be playable.</li> <li>• CD-ROMs and DVD-ROMs cannot be played on this DVD player.</li> <li>• Make sure that the rating level is correct.</li> </ul>                          |
| The remote control does not work.   | <ul style="list-style-type: none"> <li>• Is the remote control being operated within its operation range of angle and distance?</li> <li>• Are the batteries exhausted?</li> </ul>   |
| Playback does not start immediately when the Play/Pause button is pressed.  | <ul style="list-style-type: none"> <li>• Are you using a deformed disc or a disc with scratches on the surface?</li> <li>• Wipe the disc clean.</li> </ul>   |
| Sound is not produced.  | <ul style="list-style-type: none"> <li>• No sound is heard during fast playback, slow playback, and step motion playback.</li> <li>• Are the speakers connected properly? Is the speaker setup correctly customized?</li> <li>• Is the disc severely damaged?</li> </ul>                                     |
| Picture does not appear, sound is not produced, or the disc tray opens 2 to 5 seconds later.  | <ul style="list-style-type: none"> <li>• Was the DVD player suddenly moved from a cold place to a warm one? When condensation forms inside the player, remove the disc and let the player stand for 1 or 2 hours with the power on. (You can use the player again after condensation disappears.)</li> </ul> |
| <ul style="list-style-type: none"> <li>• Disc is rotating but no picture is produced.</li> <li>• Picture quality is poor and picture is shaking.</li> </ul> | <ul style="list-style-type: none"> <li>• Is the TV power on?</li> <li>• Are the video cables connected properly?</li> <li>• Is the disc dirty or damaged?</li> <li>• A poorly manufactured disc may not be playable.</li> </ul>  |



## Notes on Discs

| Symptom  | Check/Remedy   |
|--|--|
| Audio language and subtitles do not work.  | <ul style="list-style-type: none"><li>Audio language and subtitles will not work for DVDs not containing them. And depending on the disc, they may work differently.</li></ul>   |
| Menu screen does not appear even when the menu function is selected.   | <ul style="list-style-type: none"><li>Are you using a disc that does not contain menus?</li></ul>  |
| Aspect ratio cannot be changed.  | <ul style="list-style-type: none"><li>You can play 16:9 DVDs in 16:9 WIDE mode, 4:3 LETTER BOX mode, or 4:3 PAN SCAN mode, but 4:3 DVDs can be seen in 4:3 ratio only. Refer to the DVD disc jacket and then select the appropriate function.</li></ul>  |
| The tape does not start playing  | <ul style="list-style-type: none"><li>The TAPE function has not been selected.</li><li>The cassette has not been inserted correctly.</li><li>The cassette player has not been closed.</li><li>The tape is either slack or broken.</li></ul>  |
| The volume falls off<br>The cassette is not erased correctly<br>There is excessive wow and flutter   | <ul style="list-style-type: none"><li>The audio heads are dirty.</li><li>The rollers or drive capstans are dirty.</li><li>The tape is worn.</li></ul>  |
| Can't receive radio broadcast.   | <ul style="list-style-type: none"><li>Is the antenna connected properly?</li><li>If the antenna's input signal is weak, install an external FM antenna in an area with good reception.</li></ul>   |
| <ul style="list-style-type: none"><li>The main unit is not working. (Example: The power goes out or strange noise is heard.)</li><li>The DVD player is not working normally.</li></ul> | <ul style="list-style-type: none"><li>Turn off the power and hold the <b>P.Suppound/P.Sound</b> button on the main unit for longer than 5 seconds.</li></ul> <p>Using the RESET function will erase all stored settings.<br/>Do not use this unless necessary.</p>   |
| The password for rating level has been forgotten.  | <ul style="list-style-type: none"><li>While the player is in "<b>NO DISC</b>" mode, hold the main unit's <b>TUNING MODE/■</b> button for longer than 5 seconds. "INITIAL" appears on the display and all settings will return to the default values.</li><li>Press the POWER button.</li></ul> <p>Using the RESET function will erase all stored settings.<br/>Do not use this unless necessary.</p> |

### Disc Recording Format

#### CD-R Discs

- Depending on the disc recording device (CD-Recorder or PC) and the condition of the disc, some CD-R discs may not be playable.
- Use a 650MB/74 minute CD-R. Avoid CD-R media, as they may not be playable.
- If possible, do not use CD-RW (Rewritable) media, as they may not be playable.
- Only the CD-Rs that are properly "closed" can be fully played. If the session is closed but the disc is left open, you may not be able to fully play the disc.

#### CD-R MP3 Discs

- Only CD-R discs with MP3 files in ISO 9660 or Joliet format can be played.
- MP3 file names should be 8 characters or less in length and contain no blank spaces or special characters (. / = +).
- If the name of a file is in Korean, the name will be displayed on the TV screen in Korean and \* will be shown in the display of the main unit.
- Use discs recorded with a compression/decompression data rate greater than 128Kbps.
- Only files with the ".mp3" and ".MP3" extensions can be played.
- Only a consecutively written Multisession disc can be played. If there is a blank segment in the Multisession disc, the disc can be played only up to the blank segment.
- If the disc is not closed, it will take longer to begin playback and not all of the recorded files may be played.
- For files encoded in Variable Bit Rate (VBR) format, i.e. files encoded in both low bit rate and high bit rate (e.g., 32Kbps ~ 320Kbps), the sound may skip during playback.
- If more than 500 tracks are recorded on a single CD, a maximum of 500 tracks can be played.
- If more than 300 folders are recorded on a single CD, a maximum of 300 folders can be played.

#### What is MP3?

MP3 is short for MPEG-1 Audio Layer 3 and MPEG is an acronym for Moving Pictures Experts Group. MP3 is a file format with compression ratio of 1:12 (128 Kbps\*) That is, you can use MP3 format to record about 12 times the usual amount of data on a regular CD.

#### CD-R JPEG Discs

- Only files with the ".jpeg" and ".JPEG" extensions can be played.
- If the disc is not closed, it will take longer to start playing and not all of the recorded files may be played.
- Only CD-R discs with JPEG files in ISO 9660 or Joliet format can be played.
- JPEG file names should be 8 characters or less in length and contain no blank spaces or special characters (. / = +).
- Only a consecutively written multisession disc can be played. If there is a blank segment in the multisession disc, the disc can be played only up to the blank segment.
- A maximum of 9,999 images can be stored on a single CD.
- When playing a Kodak/Fuji Picture CD, only the JPEG files in the picture folder can be played.
- Picture discs other than Kodak/Fuji Picture CDs may take longer to start playing or may not play at all.

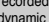

## Notes on Terminology

|   |  |
|---|--|
| <b>ANGLE</b>  | Recorded onto some DVD discs are scenes which have been simultaneously shot from a number of different angles (the same scene is shot from the front, from the left, from the right, etc.). With such discs, the Angle button can be used to change the angle of view for specific scenes.   |
| <b>CHAPTER NUMBER</b>   | These numbers are recorded on DVD discs. A Title is subdivided into many sections, each of which is numbered, and specific parts of the video can be searched quickly using these numbers.   |
| <b>DVD</b>  | A high-density optical disc on which high-quality pictures and sound have been recorded by means of digital signals. Incorporating a new video compression technology (MPEG-2) and high-density recording technology, a DVD disc comprises two 0.6 mm thick discs bonded together.   |
| <b>PCM</b>  | An acronym for Pulse Code Modulation - another name for digital audio.   |
| <b>PBC (PLAYBACK CONTROL)</b>   | This is recorded on a video CD (version 2.0). Selected scenes or information can be chosen from the menu displayed on the TV monitor.  |
| <b>REGION NUMBER</b>  | Both the DVD player and DVD discs are encoded with a region number. If the region number on the DVD disc does not correspond to the region number of the DVD player, the player cannot play the disc.  |
| <b>SUBTITLES</b>  | Translated appearing at the bottom of the screen. A DVD disc can contain up to 32 subtitle languages.  |
| <b>TITLE NUMBER</b>   | These numbers are recorded on DVD discs. When a disc contains two or more movies, these movies are numbered as Title 1, Title 2, etc.  |
| <b>TRACK NUMBER</b>   | These numbers are assigned to the tracks which are recorded on video and audio CDs. They enable specific tracks to be located quickly.   |
| <b>VIDEO CD</b>   | Contains recordings of pictures and sound whose quality is roughly comparable to that of video tape. This player also supports video CDs with playback control (version 2.0).  |
|  <b>DOLBY DIGITAL</b> | 5.1 (or 6) Channel Digital Surround sound reproduced from DVDs and LDs recorded as digital signals (with  disc marking). With better sound quality, dynamic range, and directionality than traditional Dolby surround technology, you can enjoy dynamic, realistic sound. |



## Specifications

### RADIO

#### SW(option)

Usable sensitivity 40 dB

#### AM (MW)

Signal/noise ratio 40 dB

Usable sensitivity 60 dB

Total harmonic distortion 2 %

#### FM

Signal/noise ratio 55 dB

Usable sensitivity 10 dB

Total harmonic distortion 0.6 %

### COMPACT DISC PLAYER

Capacity 3 discs

Frequency range 20 Hz - 20 KHz ( $\pm 1$  dB)

Signal/noise ratio 85 dB (at 1 KHz) with filter

Distortion 0.05 % (at 1 KHz)

Channel separation 75 dB

Disc sizes Diameter: 120 or 80 mm. Thickness: 1.2 mm

### TAPE

Frequency range 125 Hz ~ 10 KHz

Signal/noise ratio 40 dB

Channel separation 30 dB

Erasing effect 50 dB(without filter)

### AMPLIFIER

#### Output power

Speaker(6  $\Omega$ ) 80 Watts/CH RMS,IEC (total harmonic distortion: 10 %)

Channel separation 40 dB

Signal/noise ratio 75 dB

### GENERAL

Power consumption 85W

Dimensions 270 (D) x 332 (H) x 426 (W) mm