

# CONTENTS

<b>PRECAUTIONS</b> .....	2
<b>INSTALLATION</b>	
Load Cell Connections.....	2
Setting up the platform.....	3
LCD Display and function of each key.....	4
<b>FUNCTIONS</b>	
Numeric Keys and Decimal Key.....	4
ZERO.....	4
TARE.....	4
Accumulation.....	5
Accumulation Display.....	5
Clearing Accumulation.....	6
Clearing Input Value.....	6
『 + 』 .....	6
Unit Switch Key.....	7
Unit Price Memory.....	7
<b>SPECIAL OPERATION</b>	
Unit Price Memory Setting.....	8
Initial Unit Selection.....	8
Parameter Function Setting during Operation.....	9
<b>PARAMETER SETTING</b>	
Parameter Setting.....	10
Parameter Values.....	10
<b>APPENDICES</b>	
Product Type Specifications.....	11
List of Error Messages.....	11
RS232 Output.....	12

## 【PRECAUTIONS】

### DO NOT use the scale or indicator

- ◆ Please fully charge the battery after unpacking the scale.
  - ◆ Install the equipment on a level and stable surface.
  - ◆ Do not use the equipment in an environment with strong wind, vibration or electromagnetic wave (e.g. near an air conditioner outlet, fan outlet or a heavy machine).
  - ◆ Operation temperature:  $-10^{\circ}\text{C}\sim 40^{\circ}\text{C}$ , and try not to use in the environment with rapid temperature changes. Please use independent power socket to avoid interference (transformer is built-in).
  - ◆ Warm up the equipment for 15 minutes before use.
- ※ **Recharge the battery:** Please charge the battery when battery symbol appears on the LCD display, which means the battery is running out. During charging, the charge indicator will light up in red; when charging is completed, it turns green. (It takes about 8 hours to fully charge the battery.)

### Leveling Adjustment

The electric scale shall be placed on an even place. Check the level gauge of the scale to see if the scale is in a level position. If not, adjust the adjustable feet of the scale.

## 【INSTALLATION】

### Load Cell Connection

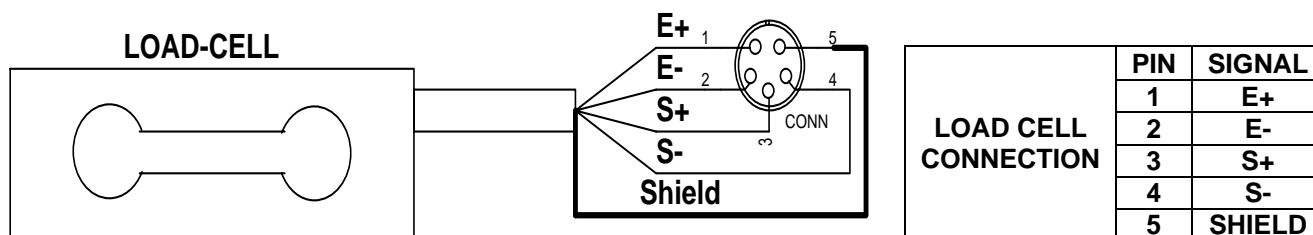

## **Setting up the platform**

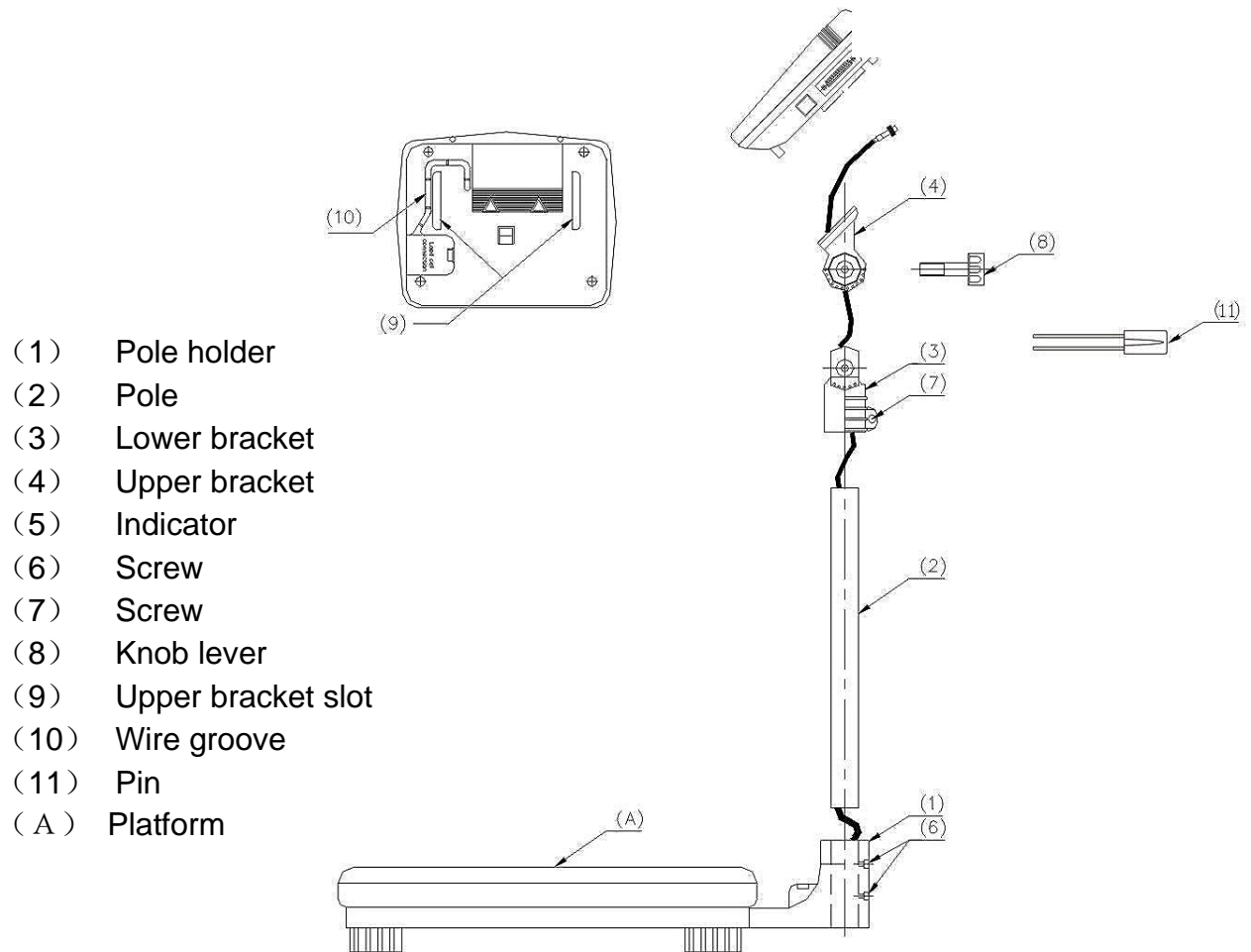

- Run the Load Cell wire on the erecting pole holder (1) through the erecting pole (2), insert the erecting pole (2) into the hole in the erecting pole holder (1), then lock the two screws (6) tight.
- Run the Load Cell wire through the lower bracket (3), and insert the lower bracket (3) into the erecting pole (2), then lock the screw (7) tight.
- Run the Load Cell wire through the upper bracket (4), and connect the display head (5), then insert the upper bracket (4) into the slot (9) till 1/2 position. [Be sure to place the wire outside the upper bracket]
- Place the Load Cell wire inside the wire groove (10), assemble the lower bracket (3) and the upper bracket (4), and then fully insert the upper bracket (4) into the slot (9), lock the upper bracket (4) and the lower bracket (3) by use of knob lever (8), and insert pin (11).
- Use the knob lever (8) to adjust the display head to the optimum position and lock tight.

## LCD Display and function of each key

LCD Display			
			
Key	Functions	Key	Functions
<b>ON/OFF</b>	To turn power on or off.	<b>ZERO</b>	Manual return to zero.
<b>0 ~ 9</b> and <b>.</b>	Numeric keys and decimal point key, used for setting unit price, pcs, etc.	<b>M+</b>	To memorize the amount of commodities weighed.
<b>UNIT</b>	To switch units.	<b>MR</b>	To display the accumulation data.
<b>PLU</b>	To memorize unit price of commodity.	<b>MC</b>	To clear the accumulation data.
<b>CE</b>	To clear the unit price data.	<b>TARE</b>	To deduct tare weight.
<b>+</b>	To add up unit prices of commodities that does not require weighing.		

## **【FUNCTIONS】**

### Numeric Keys and Decimal Key

Keys **0** ~ **9** and **.** are used to key in the show value in the **Unit Price Window** or other functions.

### ZERO

When there is residual value in the **Total Weight Window**, press **ZERO** key and the **Total Weight Window** will show **ZERO**.

### TARE

1. Place the tare object on the weighing pan.
2. Press **TARE** key.
3. Tare cancellation: Press **TARE** key to cancel.

## **Accumulation**

- a. When accumulating the prices of more than one kind of object, input the unit prices and place the objects on the weighing pan until they are stable, press **M+** key to perform accumulation, the **Total Weight Window**, **Unit Price Window** and **Total Price Window** will show **ALL.XX**, **----** and **XXXXX** in turn, which means total data, no display and total price respectively. Press any **Numeric key** to input the next unit price or press **CE** key to return to normal weighing mode.
  - b. Accumulation can only be performed in the stable mode ( $\pm 0.1\text{e}$ ).
  - c. If the total data is over 10, the **Unit Price Window** will show **ALL.00**, which means the total data is over the range. Accumulation will not be performed, and the scale will return to normal weighing mode in one second.
  - d. When the digit number of total price (incl. decimals) is beyond the display range, the **Total Weight Window** will show **over**, which means the digit number of total price is beyond the display range. Accumulation will not be performed, and the scale will return to normal weighing mode in one second.
- ※ When the price is zero, accumulation will not be performed.

## **Accumulation Display**

- a. When accumulation is performed, press **MR** key to display accumulation data, the **Total Weight Window**, **Unit Price Window** and **Total Price Window** will show **ALL.XX**, **----** and **XXXX** in turn, which means total data, no display and total price respectively. Press **MR** key once again, the **Unit Price Window** will show **ALL.XX** and **XXXXX** in turn, which mean total number of data of this count and unit price of this count. The **Total Weight Window** and **Total Price Window** will show **XXXX** and **XXX** in turn, which mean weight of this count and total price of this count.
  - b. Press any **Numeric key** to input the unit price or press **CE** key to return to normal weighing mode.
- ※ Display of a single record includes decimals, display of total price does not include decimals (rounded).

## **Clearing Accumulation**

### a. Clearing a single record

Press **MR** key till the **Unit Price Window** shows **ALL.XX**, press **MC** key to clear this record.

### b. Clearing all records

Press **MR** key till the **Total Weight Window**, **Unit Price Window** and **Total Price Window** show **ALL.XX**, **- - - -** and **XXXXXX** respectively, press **MC** key to clear all accumulation records and the scale will return to normal weighing mode automatically.

## **Clearing Input Value**

To clear the number shown in the **Unit Price Window**, press **MC** key and the **Unit Price Window** will show 0.

## **[ + ]**

### a. In the price calculation mode:

1. E.g.: the **Total Weight Window**, **Unit Price Window** and **Total Price Window** show **1.000**, **10** and **10** respectively.
2. Press **+** key, the **Total Weight Window**, **Unit Price Window** and **Total Price Window** will show **ALL**, **0** and **10** in turn.
3. Input the known price to be added (25), the **Total Weight Window**, **Unit Price Window** and **Total Price Window** will show **ALL**, **25** and **35** respectively.
4. Press **ZERO** key to return to price calculation mode.

### b. In the accumulation display mode:

1. Press **+** key, the **Total Weight Window**, **Unit Price Window** and **Total Price Window** will show **ALL**, **0** and **XXX** in turn.
2. Input the known price to be added (25), the **Total Weight Window**, **Unit Price Window** and **Total Price Window** will show **ALL**, **25** and **XXX+25** respectively.
3. Press **ZERO** key to return to accumulation display mode.

### c. In non-weighing mode:

1. The **Total Weight Window**, **Unit Price Window** and **Total Price Window** will show **XXXXXX**, **0** and **0** in turn.

2. Press **+** key, the **Total Weight Window**, **Unit Price Window** and **Total Price Window** will show **ALL**, **0** and **0** in turn.
  3. Input the known price to be added (25), the **Total Weight Window**, **Unit Price Window** and **Total Price Window** will show **ALL**, **25** and **25** respectively.
  4. Press **ZERO** key to return to non-weighing mode.
- ※ Input values repeatedly and press **+** key, the input values will be added continuously.

## **Unit Switch key**

In the normal non-weighing mode without accumulation, press **UNIT** key, the windows will show **Unit**, **SET** and **XX** in turn, which means unit, setting and corresponding number respectively. Press **Numeric key** to select the unit of corresponding number; the scale will return to normal weighing mode in one second. (The unit selection is price unit selection)

- ※ Press **ZERO** key to directly return to weighing mode without switching.

Unit Switch Table		
Numeric Key	Unit in Weight Window	Unit in Unit Price Window
1	Kg	/Kg
2	lb	/lb
3	Kg	/100g

## **Unit Price Memory**

In normal non-weighing mode with unit price memory function off, press **PLU** key, the **Unit Price Window** will show **PLU**, press **Numeric key** to select unit price memory group; when the **Unit Price Window** shows **PLU XX**, it indicates the memory group selected, and in one second, the values saved in this memory group will be displayed.

- ※ In normal non-weighing mode with unit price memory function on, press **Numeric key** to switch memory groups and press **CE** key to exit.
- ※ This function shall be effective after saving unit prices.

## 【SPECIAL OPERATION】

### Unit Price Memory Setting

- Hold down any **Numeric key** to turn power on: the **Total Weight Window**, **Unit Price Window** and **Total Price Window** will show **PLU**, **UP** and **5EE** in turn.
  - Press **Numeric key** to select unit price memory group, the **Total Weight Window**, **Unit Price Window** and **Total Price Window** will show **PLU**, **XXXXX** and **XX** in turn, which indicates unit price memory setting, unit price to be memorized and memory group respectively.
  - Press **Numeric keys** and **•** key to input unit price to be memorized.
  - Press **PLU** key to confirm, the **Total Weight Window**, **Unit Price Window** and **Total Price Window** will show **PLU**, **UP** and **5EE** in turn.
- ※ Repeat steps b and c until setting is completed.
- After setting is completed, press **ZERO** key to return to normal weighing mode.

### Initial Unit Selection

- Power on while holding down **MC** key: the **Total Weight Window**, **Unit Price Window** and **Total Price Window** will show **5EE**, **0** and **0** in turn.
- After pressing **1 1 3 2** keys: the **Total Weight Window**, **Unit Price Window** and **Total Price Window** will show **5EE**, **1132** and **0** in turn.
- After pressing **MC** key: the **Total Weight Window**, **Unit Price Window** and **Total Price Window** will show **Unit**, **5EE** and **XX** in turn.
- Press **1** key to switch units (the unit selection is price unit selection): Depending on the region:
 

Model for the Mainland: kg 500g 100g

Model for export: kg lb 100g

Model for Taiwan: kg tg 100g

Model for Hong Kong: kg lb 100g hkj
- After pressing **MC** key: the **Total Weight Window**, **Unit Price Window** and **Total Price Window** will show **5EE**, **0** and **0** in turn.



- f. Press **ZERO** key to return to normal weighing mode.

## **Parameter Function Setting during Operation**

- a. In normal weighing mode, hold down **MC** key for 3 seconds to enter into parameter setting; the **Total Weight Window**, **Unit Price Window** and **Total Price Window** will show **SEL**, **SCALE** and **FunL** in turn.
- b. Press **0** key: LCD will show **SELO**, **LOH** and **onoFF** in turn. Backlight function setting: on / oFF / onoFF, press **0** key to set. on: backlight on / oFF: backlight off / onoFF: auto backlight.
- c. Press **3** key: the **Total Weight Window**, **Unit Price Window** and **Total Price Window** will show **SEL3**, **off** and **off** respectively. Auto power-off time setting: off / 5 / 10 / 30 / 60, press **3** key to set. off: cancel auto power-off /auto power-off in 5 minutes / auto power-off in 10 minutes /auto power-off in 30 minutes/auto power-off in 60 minutes
- d. Press **ZERO** key to return to normal weighing mode.

## **【PARAMETER SETTING】**

### **Parameter Setting**

Turn power on by holding down **ZERO** key to enter into parameter setting; the **Total Weight Window**, **Unit Price Window** and **Total Price Window** will show **SEL**, **SCALE** and **FunL** in turn. Press **ZERO** key to return to normal weighing mode.

### **Parameter Values**

Function	Display	Operating Instructions
Backlight	on / oFF / onoFF	Press <b>0</b> key: the <b>Total Weight Window</b> , <b>Unit Price Window</b> and <b>Total Price Window</b> will show <b>SELO</b> , <b>LOH</b> and <b>onoFF</b> in turn; press <b>0</b> key to set.
Filter	1 / 2 / 4 / 8	Press <b>2</b> key: the <b>Total Weight Window</b> , <b>Unit Price Window</b> and <b>Total Price Window</b> will show <b>SEL2</b> , <b>FILE</b> and <b>1</b> in turn; press <b>2</b> key to set. ※ The bigger the number is, the higher filter performance is and the slower the display speed is.
Auto	off / 5 / 10 / 30 / 60	Press <b>3</b> key: the <b>Total Weight Window</b> , <b>Unit Price Window</b> and <b>Total Price Window</b>

power-off		Window will show <b>5.5.5</b> , <b>off</b> and <b>off</b> in turn; press <b>3</b> key to set.
Baud rate	2400bps / 4800bps / 9600bps	Press <b>5</b> key: the <b>Total Weight Window</b> , <b>Unit Price Window</b> and <b>Total Price Window</b> will show <b>5.5.5</b> , <b>baud</b> and <b>9600</b> in turn; press <b>5</b> key to set.
Data output mode	Co / St	Press <b>9</b> key: the <b>Total Weight Window</b> , <b>Unit Price Window</b> and <b>Total Price Window</b> will show <b>5.5.5</b> , <b>Prt. 5.5</b> and <b>PT</b> in turn; press <b>9</b> key to set. ※ When output mode is St, input unit price before placing weight and the price will then be output normally; when output mode is Co, the display speed is slower.

## 【APPENDICES】

### Product Type Specifications

Max. Cap / Resolution	Model							
	JPP-3K		JPP-6K		JPP-15K		JPP-30K	
	3kg	3kg	6kg	6kg	15kg	15kg	30kg	30kg
DIV.(kg)	0.0005	0.001	0.001	0.002	0.002	0.005	0.005	0.010
DIV.(lb)	0.001	0.002	0.002	0.005	0.005	0.010	0.01	0.02
DIV.(tg, tl)	0.00.01	0.00.02	00.00.1	00.00.1	00.00.1	00.00.2	00.00.2	00.00.2
DIV.(hkj, hkl)	0.00.01	0.00.02	00.00.1	00.00.1	00.00.1	00.00.2	00.00.2	00.00.2
Max. Cap / Resolution	Model							
	JPP-60K		JPP-150K		JPP-300K		JPP-600K	
	60K	60K	150K	150K	300K	300K	600K	600K
DIV.(kg)	0.010	0.020	0.02	0.05	0.05	0.10	0.10	0.20
DIV.(lb)	0.02lb	0.05lb	0.05lb	0.10lb	0.10lb	0.20lb	0.2lb	0.5lb
DIV. (tg, tl)	00.01	00.01	00.01	00.01	00.02	00.02		
DIV.( tg)							0. 2	0.5
DIV. (hkj, hkl)	00.01	00.01	00.01	00.01	00.02	00.02		
DIV.( hkj)							0.2	0.5
Internal Resolution	Over 60000 (SPAN)							
Display Spec.	LCD module requires backlight, 5, 5, 5 Digits. (EL)							
Dimensions (mm)	666 x 430 x 910							
Power Supply	AC110V/220V incl. 6V4A lead-acid battery							
Resolution	1/6000, 1/3000, 1/7500							
Weighing Unit	Kg, Lb, tg, hkj							
Operating Temperature	-10°C~40°C							
Option	RS232							

### List of Error Messages

In case of	Error Message	Troubleshooting
Power on	Err2,	Initial zero point over 30%.
Power on	Err3,	Check if there is A/D malfunction or LOAD CELL malfunction.
Power on	Err4,	Switch power off and power on again; if the error message appears again, switch power off and perform calibration again.

Power on	Battery symbol shown	Charge the battery.
Normal weighing mode	Err5	Checking if the weighing object is over the max. capacity +9e.

Error Message	Problem
Err2	Check if there is any object on weighing pan, which may cause interference.
Err3	Over or below A/D resolution range
Err4	EEPROM Chksum error
Err5	Overload (max. capacity +9e)
ACC.ov	Accumulation over 10 data
over	Display value over display range
Battery symbol	Low battery

## RS232 Output

### RS232 Output Format

RS232 transmission format parameters are as follows:

Baud Rate: 2400bps / 4800bps / 9600bps

Data Bit: 8

Stop Bit: 1

Parity: NONE

Code: ASCII

Bit Format :

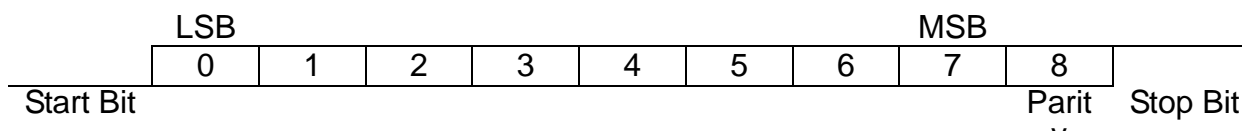

### Data Format

1. kg

G/N	.	W	.	:							k	g		CR	LF
-----	---	---	---	---	--	--	--	--	--	--	---	---	--	----	----

Weight

U	.	P	.	:							\$	/	k	g					CR	LF
---	---	---	---	---	--	--	--	--	--	--	----	---	---	---	--	--	--	--	----	----

Unit price

P	r	i	c	e	:							\$								CR	LF
---	---	---	---	---	---	--	--	--	--	--	--	----	--	--	--	--	--	--	--	----	----

Price

Example:

G.W.:5.000 kg

N.W.:4.000 kg

U.P.:100 \$/kg

Price:400 \$

2. lb

G/N	.	W	.	:								I	b		CR	LF
-----	---	---	---	---	--	--	--	--	--	--	--	---	---	--	----	----

Weight

U	.	P	:						\$	/	l	b					CR	LF
---	---	---	---	--	--	--	--	--	----	---	---	---	--	--	--	--	----	----

Unit price

P	r	i	c	e	:						\$								C	R	L	F
---	---	---	---	---	---	--	--	--	--	--	----	--	--	--	--	--	--	--	---	---	---	---

## Price

3. tg

G/N	.	W	.	:									G	-	t	l	.	T	CR	LF
-----	---	---	---	---	--	--	--	--	--	--	--	--	---	---	---	---	---	---	----	----

Weight

U	.	P	:						\$	/	G	-	t	I	.	T	CR	LF
---	---	---	---	--	--	--	--	--	----	---	---	---	---	---	---	---	----	----

Unit price

[illegible]

Price

4. hkj

G/N	.	W	:									G	-	t	I	.	H	C	R	L	F
-----	---	---	---	--	--	--	--	--	--	--	--	---	---	---	---	---	---	---	---	---	---

Weight

U	.	P	:						\$	/	G	-	t	I	.	H	C	R	L	F
---	---	---	---	--	--	--	--	--	----	---	---	---	---	---	---	---	---	---	---	---

Unit price

[illegible]

Price

5. 100g

G/N	.	W	.	:							k	g		CR	LF
-----	---	---	---	---	--	--	--	--	--	--	---	---	--	----	----

Weight

U	.	P	:						\$ / 100 g			CR LF
---	---	---	---	--	--	--	--	--	------------	--	--	-------

Unit price

P	r	i	c	e	:						\$								CRLF
---	---	---	---	---	---	--	--	--	--	--	----	--	--	--	--	--	--	--	------

Price

6. 500g

G/N	.	W	.	:								k	g		CR	LF
-----	---	---	---	---	--	--	--	--	--	--	--	---	---	--	----	----

Weight

U	.	P	:					\$ / 5 0 0 g			CR LF
---	---	---	---	--	--	--	--	--------------	--	--	-------

Unit price

P	r	i	c	e	:					\$								CR LF
---	---	---	---	---	---	--	--	--	--	----	--	--	--	--	--	--	--	-------

Price