

# SpeedPower Tuningbox

## User Manual and Installation Guide

Common rail / Pumpe Düse / Petrol



MADE IN GERMANY



## SpeedPower - Chip Tuningbox

### User Manual and Installation Guide

Dear Customer,

Congratulation for the purchase of your new, high quality SpeedPower product! Our company continuously strives to meet the highest quality requirements which the CE and (E13) certificate and mark also prove. Our devices manufactured by the highest engine protection process and these units never interfere with the car's original "Failure Detection System" and always run by the factory engine control signals.

The SpeedPower Tuningboxes and Ecobox Fuel Savers are always external devices which connect to the car's injection system with factory connectors which making the installation very easy without leaving any trace on the original system. The devices disengage that approximate 30% of power reserves which usually left in the cars by the car manufacturers which makes the car more powerful using less fuel. Depending on the car we can count with around 15-25% power and 20-25% torque increase and approximate 1 liter / 100 km fuel saving using SpeedPower in good condition cars. Practical experiences prove that after engine optimization, the pollutant level is decreasing, so even the lifetime of the DPF can be increase.

The German-made digital devices completely cooperate with the car's Engine Control Unit. Owing to SpeedPower's Digital Rotary Control Switches the performance and fuel saving can be fine-tune and with computer it is possible to reprogram the devices to fit perfectly with the car.

Save More!

#### Use quality fuel

Although the better quality fuel is more expensive, using it can improve the performance of the engine which can reduce the fuel consumption. For using a SpeedPower Optimizing Box, we recommend to tank better quality fuel.

#### Checking the Tire Pressure

Check the tire pressure regularly (i.e. once a month). Correct pressure saves fuel and could significantly lengthen the lifespan of your tires as well.

#### Replacing the Air Filters

Replace the filter regularly. A dirty filter's efficiency decreases and it makes the engine run too "rich", thus increasing the fuel consumption.

#### The Air Conditioner

Use the air conditioner only when necessary, especially in traffic. At highway speeds, however, the air conditioner may be more efficient then the windows rolled down.

#### Warming up

Numerous experts recommend idling your car for only about a minute and then driving it slowly for a few minutes. This will greatly improve gas mileage and also lubricate the engine better.

#### Rack on top

Transporting bicycles, packages, and other stuff on the top rack of your car is increasing the aerodynamic drag coefficient significantly, thus causing an increment in fuel consumption.

## Contents of the kit

(The pictures are only illustrations, the parts can be different)



**Adjustable, digital central unit**  
1 piece in the set



**User manual and installation guide**  
1 piece in the set



**Check Plug with LED (Pumpe Düse type does not contain)**  
1 piece in the set



**Cable harness with factory type connectors (different types)**  
1 piece in the set



**Cable ties**  
More in the set

## Important information before the installation

### IMPORTANT INFORMATION!



We recommend performing the installation by a car mechanic. If you do not have a contact to a car mechanic, or if you choose to install the product by you own or if there is any question, please do not hesitate to contact with our Customer Service:

#### POWERTUNING Customer Service

Telephone: +36 62 202 303  
Mobile: +36 30 852 5460  
E-mail: [info@powertuning.hu](mailto:info@powertuning.hu)  
Homepage: <http://www.powertuning.hu>

Please read this installation guide carefully before you start the installation! The distributor/installer shall not be held responsible for any injuries that could occur due to improper installation or usage of the product, and it will cause the loss of warranty.

## Basic steps of the installation

(It may differ depending on the type of the car or product.)

- Before the installation remove the ignition key from the ignition switch, open the bonnet and close the doors.
- Wait for approximately 5 minutes while the car's "Failure Detection System" finishes with the checking and the car goes into standby mode.
- Remove the engine covers so you can approach the needed electronic parts easily.
- Using the installation manual, connect the Optimizing Box to the vehicle's original injection system.
- In case you install a Common Rail or Petrol type Optimizing Box, you need to connect the Check Plug to the cable harness after you plug it to the original injection system. Switch ON the ignition and check the LED inside the Check Plug. If it is glows then the cable harness and the connections are good, if it does not glow then DO NOT start the engine, make contact with the POWERTUNING Customer Service. In case you install Pumpe Düse type Optimizing Box you do not need and cannot use the Check Plug.
- If the LED glowing properly in the Check Plug, switch OFF the ignition and wait until the LED also goes off, then you can remove the Check Plug and connect the Optimizing Central Unit.
- Fix the device's central unit to a place where water or high temperature cannot damage it. Never wash the device with high pressure carwash, because water can get inside the box and this will cause the loss of warranty! When fixing the wiring harness of the product avoid hot or moving parts, and make sure the wires cannot move, resonate or brake.
- After the successful installation, make some road test with the car in most of the possible driving conditions to find out if everything set properly. If there is any problem appears, decrease the tuning value according the user manual's further instructions.
- To reach the maximum performance we suggest using quality fuel.

## SpeedPower Tuningbox (Common Rail System)

(The pictures are only for illustration, the installation steps may differ depending on the type of the car or product)

1

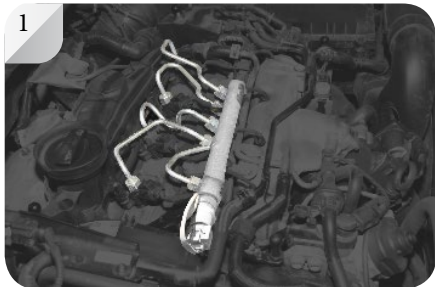

Remove the ignition key from the ignition switch, open the bonnet and close the doors. Wait for approximately 5 minutes while the car's "Failure Detection System" finishes with the checking and the car goes into standby mode.

Remove the engine covers so you can approach the common rail pressure sensor.

2



On the common rail tube you can find a Pressure Sensor (with 3 or 6 wires) and a Pressure Regulator (with 2 wires). You need to connect the Optimizing Device to the Pressure Sensor not to the Pressure Regulator.

Disconnect the original connector from the Common Rail Pressure Sensor.

3



Connect the Optimizing Box's one connector to the Pressure Sensor and the other to the original harness's connector coming from the car's ECU. Make sure that you hear a clear "click" sound when you connect the cables.

Finish the installation according to the basic steps.

## SpeedPower Tuninbox (Pumpe Düse System – PD TDi)

(The pictures are only for illustration, the installation steps may differ depending on the type of the car or product)

1



Remove the ignition key from the ignition switch, open the bonnet and close the doors. Wait for approximately 5 minutes while the car's "Failure Detection System" finishes with the checking and the car goes into standby mode.

Remove the engine covers so you can approach the engine. On the right side or the back side of the engine you can find a round shape connector where you need to connect the Optimizing Device.

2

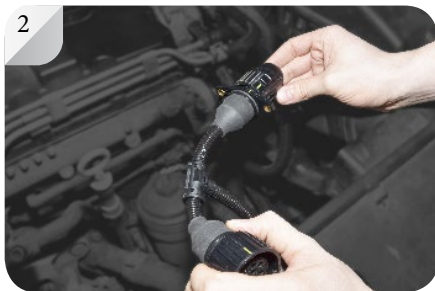

After releasing the fixing pin you can disconnect the connector by a twisting motion.

Connect the Optimizing Box's one connector to the engine and the other to the original harness's connector coming from the car's ECU. Make sure that the fixing pin snaps into its right position.

3



Connect the red (positive +) wire to the battery's positive pole, and the black wire (negative -) to the negative pole of the battery. If you remove the fuse from the red cable, the car will run with the original settings without any modification from the optimizing box.

Finish the installation according to the basic steps.

## SpeedPower Tuninbox (Turbo Petrol Engines)

(The pictures are only for illustration, the installation steps may differ depending on the type of the car or product)

1



Remove the ignition key from the ignition switch, open the bonnet and close the doors. Wait for approximately 5 minutes while the car's "Failure Detection System" finishes with the checking and the car goes into standby mode.

Remove the engine covers so you can approach the connectors of the engine's electronic components. Find the MAP sensor(s).

2

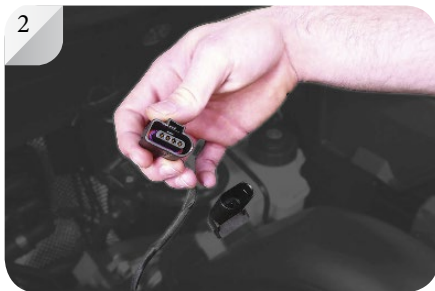

It is possible that you need to connect the Optimizing Box to more electronic components. In this case you have got more connectors with the Optimizing Box and you need to connect to all the original connectors of the components.

Disconnect the connectors from the electronic components.

3



Connect the Optimizing Box's one connector to the electronic component and the other to the original harness's connector coming from the car's ECU.

If there is more component with the same connector type then there is no relevance which connector pair goes to which component.

Finish the installation according to the basic steps.

## Setting the SpeedPower

The SpeedPower Tuningbox basically delivered with an adjustment appropriate for your vehicle's optimal performance and fuel saving. However due to the digitally adjustable system, you can fine-tune your optimizing box for your custom needs. Anyway we do not suggest changing the settings.



The Digital Rotary Control Switches for fine-tuning the device are settled inside the housing which can open with the 2 pieces of T10 Torx screws at the connector side of the box. After removing the screws the housing can slide apart.

**⚠ Warning!** The Digital Rotary Control Switch values from the lowest to the highest are the following:

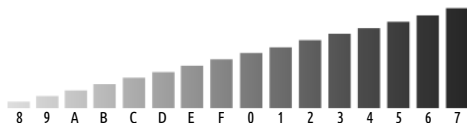

Differ from the original settings means approximately 1,5% change.

Common Rail



Pumpe Düse



Petrol



### Tuning Value Rotary Control Switch <sup>①</sup> (in Common Rail and Petrol boxes)

With this Control Switch you can increase the power (at the expense of fuel saving) or decrease the additional power of the box. Decreasing the power may be needed if the car's Failure Detection System shows an error using the Tuningbox. In this case you need to decrease the power value until the fault is gone! At PD boxes there is no Tuning Value Switch.

### Tuning Phase Rotary Control Switch <sup>②</sup> (in Common Rail and Petrol boxes)

With this Control Switch you can set the RPM range of the tuning. We never recommend changing this setting from the original, unless our customer service asks you to change it! If you are not satisfied with the power increase, you need to change only the Tuning Value Switch. At PD boxes there is no Tuning Phase Switch.

### Tuning Value Jumper <sup>③</sup> (only in PD boxes)

After removing the housing from the PD box, rotate the PCB in front of you until you can see the jumper in the bottom-right corner. Changing the place of the jumper to the right side increases the value (by approximately 2%), changing the place to the left side decreases the tuning value. You can find a similar jumper on the Common Rail and Petrol Boxes, but there is no function there.



## Troubleshooting

### The cable harness does not match with the vehicle?

⚠ The Common Rail type Optimizing Box's connectors have 3 or 6 wires and you need to connect them to the common rail tube's Pressure Sensor. You can also find a Pressure Regulator on the tube which is usually with 2 wires, but you do not need to connect to this. At PD engines the round shaped connector is on the left- or backside of the engine, at Petrol cars the MAP sensor can be found on the intake tubes. If you do not find the proper connector in the car which matches with the box, please call our customer service for more information.

### The LED in the Check Plug does not glow after switching the ignition ON?

⚠ Do not start the engine, otherwise the car or the Optimizing Box could be damaged! Recheck the connections and be aware that there are some connector types where you can also connect the connector rotated by 180°. Make sure you hear the "click" sound while you are connecting the plugs to each other. If the LED still not glowing, please make contact with our customer service for more help.

### The improved performance cannot feel?

⚠ Check the connections again and use the Check LED to make sure the connection is still good. If there is no problem with the connection you can fine-tune the settings of the box with the Digital Rotary Control Switches or Jumpers. According to the user manual you should try to increase the tuning value! At Petrol cars it is possible that the improved performance cannot feel, because of the too high tuning value (and the car's original Error Check System cannot recognize that). At petrol cars decrease the tuning value by 2 steps and make road tests again.

### After installing the box, the engine not works properly?

⚠ Decrease the tuning value gradually until the problem is gone. If the problem still consists please make contact with our customer service for more help.

### After installing the box, the car cannot start?

⚠ Most of this problem caused by wrong installation. Check the connections and the type of the ordered box again. If you ordered the right box and the problem still consists please make contact with our customer service for more help.

### An error message appears on the display of the dashboard?

⚠ Check the connections again and use the Check Plug. If everything is right with the installation it is possible that the tuning value is too high for the car. According to the user manual you need to decrease the tuning value using the Digital Rotary Control Switch or Jumper. If the problem still consists despite setting the lowest value, please make contact with our customer service for more help.

## Customer Service

POWERTUNING - Euro Noliker Kft.

Landline phone number: +36 62 202 - 303

Mobile phone number: +36 30 852 - 5460

Fax number: +36 62 542 - 933

E-mail: [info@powertuning.hu](mailto:info@powertuning.hu)

Homepage: [www.powertuning.hu](http://www.powertuning.hu)

MADE IN GERMANY

