

NOTICE D'UTILISATION

1. DESIGNATION : PACK 56CN

- ✦ Tension : 220/250 V – 50/60 Hz.
- ✦ Lampe : PAR 56 – 230 V/300W maxi.
- ✦ Livré sans lampe. (300 heures)
- ✦ Poids : 1.400 kg
- ✦ Fonction : Permet un éclairage d'animation très directif.

Pack comprenant :

- ✦ 1 projecteur
- ✦ 1 lampe PAR 56 – 230V/300W
- ✦ 4 feuilles de gélatine couleur
- ✦ 1 crochet
- ✦ 1 élingue de sécurité

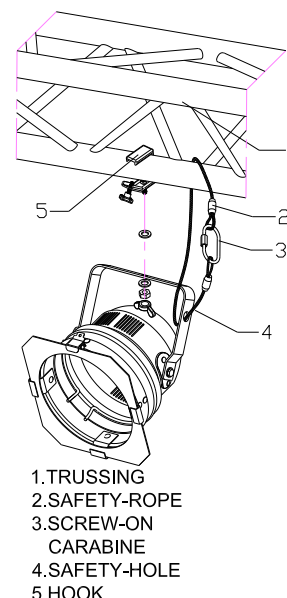

CONSIGNES GENERALES

Lire attentivement les consignes ci-après. Elles contiennent des informations importantes sur la sécurité de l'installation ainsi que sur l'utilisation et la maintenance de l'équipement.

- ✦ Conservez le présent manuel avec l'équipement pour référence ultérieure. En cas de vente de l'équipement à un autre utilisateur, il est important que le présent manuel soit joint à l'équipement afin que le nouvel utilisateur dispose des informations nécessaires à son utilisation et puisse prendre connaissance des mises en garde relatives à la sécurité.
- ✦ Avant le démarrage initial, déballiez et vérifiez soigneusement tous les éléments pour s'assurer qu'ils n'ont subi aucune détérioration pendant le transport.
- ✦ Choisir un emplacement bien ventilé pour l'installation du dispositif.
- ✦ Vérifiez que la zone alentour ne contient ni liquides inflammables, ni eau, ni objets métalliques susceptibles de pénétrer dans l'appareil. En cas de pénétration de corps étrangers, débranchez immédiatement l'alimentation secteur. Placez l'appareil dans une pièce bien ventilée à environ 50 cm des murs.
- ✦ Respectez l'environnement. Jetez les cartons d'emballage dans un endroit approprié.
- ✦ Les travaux d'électricité nécessaires à l'installation doivent impérativement être effectués par du personnel qualifié.
- ✦ En cas de graves problèmes de fonctionnement, cessez d'utiliser l'appareil immédiatement. Ne jamais tenter de le réparer soi-même. Les réparations effectuées par du personnel non qualifié peuvent entraîner de graves détériorations ou défauts de fonctionnement. Contactez le service après-vente le plus proche. Toujours utiliser des pièces de rechange d'origine.

PACK 56 CN

- ✦ Mettre l'appareil hors tension à intervalles réguliers afin de lui assurer une durée de vie maximale.
- ✦ Toujours débrancher l'appareil du secteur avant de procéder à son entretien.
- ✦ Ne jamais ouvrir l'appareil. Il ne contient aucune pièce nécessitant un entretien.
- ✦ La haute tension présente des risques d'électrocution. Ne jamais toucher les fils pendant l'utilisation.
- ✦ Attention, et appareil dégage une forte chaleur.

2. MISE EN FONCTION:

Attention toute intervention sur l'appareil doit s'effectuer secteur débranché.

Cet appareil est équipé d'un cordon dénudé 2 pôles + terre.

Vous pouvez régler l'orientation du spot afin de l'ajuster à la zone à éclairer.

Il est possible d'utiliser le projecteur posé sur un socle ou fixé au mur ou au plafond. Dans ces deux derniers cas, le support utilisé doit être suffisamment résistant pour supporter cette contrainte de charge.

Pour monter ou changer la lampe, ôtez la bague de fixation de la lampe, emboîtez la lampe dans la douille, encastrez la dans le projecteur, bloquez la avec la bague, et inversement pour la démonter.

Toute utilisation en hauteur nécessite l'installation d'une élingue stop-chute.

USER MANUAL

For your own safety, please read this user manual carefully before you start-up and operating it.

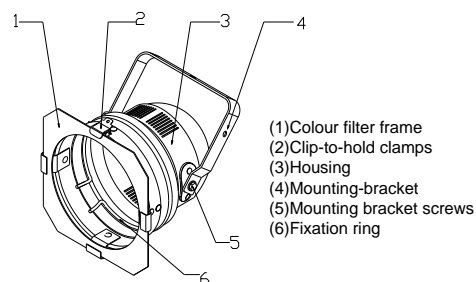

SAFETY INSTRUCTIONS

- ◆ **CAUTION!** Keep this device away from rain and moisture!
- ◆ **CAUTION!** Be careful with your operations. With a dangerous voltage you can suffer a dangerous electric shock when touching the wires!
- ◆ Keep away from heaters and other heating sources!
- ◆ If the device has been exposed to drastic temperature fluctuation (e.g. After transportation), do not switch it on immediately. The arising condensation water might damage your device. Leave the device switched off until it has reached room temperature.
- ◆ This device falls under protection-class I, therefore it is essential that the yellow/green conductor gets connected to earth.
- ◆ Make sure that the power-cord is never crimped or damaged by sharp edges. Check the device and the power-cord from time to time.
- ◆ If the external flexible cable or cord of this luminaire is damaged, it shall be exclusively replaced by the manufacturer or his service agent or a similar qualified person in order to avoid a hazard.
- ◆ Shields, lenses or ultraviolet screens shall be changed if they have become visibly damaged to such an extent that their effectiveness is impaired, for example by cracks or deep scratches.
- ◆ Never let the power-cord come into contact with other cables! Handle the power-cord and all connections with the mains with particular caution!
- ◆ Make sure that the available voltage is not higher than stated in this manual.
- ◆ Always disconnect from the mains, when the device is not in use or before cleaning it. Only handle the power-cord by the plug. Never pull out the plug by tugging the power-cord.
- ◆ During the initial start-up some smoke or smell may arise. This is a normal process and does not necessarily mean that the device is defective.
- ◆ **DANGER OF BURNING!** Never touch the device during the operation! The housing heats up to the housing temperature T_{SURFACE} .
- ◆ Don't switch the device on and off in short intervals as this would reduce the lamp's life.
- ◆ **HEALTH HAZARD!** Never look directly into the light source, as sensitive persons may suffer an epileptic shock (especially meant for epileptics)!
- ◆ Please note that damages caused by manual modifications on the device or unauthorized operation by unqualified persons are not subject to warranty.
- ◆ Keep away children and amateurs from the device!
- ◆ There are no serviceable parts inside the device. Maintenance and service operations are only to be carried out by authorized dealers.

OPERATING DETERMINATIONS

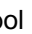
- ◆ This device is a spot designed for professional use on stages, in discotheques, theatres etc. this fixture is only allowed to be operated with an alternation current of max. 230V/50Hz 300W and was designed for indoor use only.
- ◆ Lighting effects are not designed for permanent operation. Consistent operation breaks will ensure that the device will serve you for a long time without defects.
- ◆ Do not shake the device. Avoid brute force when installing or operation the device.
- ◆ When choosing the installation-spot, please make sure that the device is not exposed to extreme heat, moisture or dust. There should not be any cables lying around. You endanger your own and the safety of others!
- ◆ The symbol  determines the minimum distance from lighted objects. The minimum distance between light-output and the illuminated surface must be more than 2 meter.
- ◆ Make sure that the area below the installation place is blocked when rigging, derigging or servicing the fixture.
- ◆ Always fix the fixture with an appropriate safety-rope.
- ◆ The maximum ambient temperature T_a must never be exceeded.
- ◆ Please consider that unauthorized modifications on the device are forbidden due to safety reasons!
- ◆ If this device will be operated in any way different to the one described in this manual, the product may suffer damages. Furthermore, any other operation may lead to dangers like short-circuit, burns, electric shock, lamp explosion, crash etc.

PACK 56 CN

INSTALLATION

Installing/Replacing the lamp

- ♦ **DANGER TO LIFE!** Only install the lamp with the device switched off! Unplug from mains before!
- ♦ **CAUTION!** The lamp has to be replaced when it is damaged or thermally deformed due to the heat!
- ♦ Before replacing the lamp, unplug mains lead and let the lamp cool down (approx. 5 minutes).
- ♦ During the installation do not touch the glass-bulbs bare-handed! Please follow the lamp manufacturer's notes!
- ♦ Do not install lamps with a higher wattage! Lamps with a higher wattage generate temperatures the device was not designed for. Damages caused by non-observance are not subject to warranty.
- ♦ For the installation, you need one 230V PAR56 lamp with up to max. 300W
- ♦ Procedure:
 - Step 1: Move the color filter frame on the front of the housing by pushing the clip-to-hold dampers.
 - Step 2: If replacing the lamp, Remove the fixation ring by pressing it together. Turn the housing side down, then the lamp falls out. Remove the old lamp from the lamp socket by pulling them.
 - Step 3: Insert the new 230V/300W PAR56 lamp into the spot.
 - Step 4: Replace the color filter trammel onto the front of the housing.

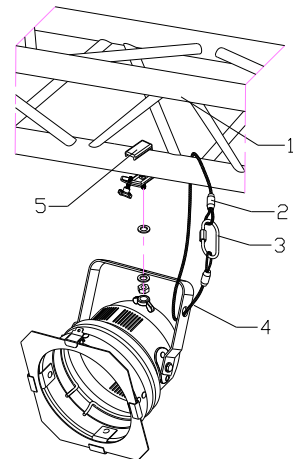

1. TRUSSING
2. SAFETY-ROPE
3. SCREW-ON CARABINE
4. SAFETY-HOLE
5. HOOK

Installing/Rigging

- ♦ The installation of the projector has to be built and constructed in a way that it can hold 10 times the weight for 1 hour without any harming deformation.
- ♦ The installation must always be secured with a secondary safety attachment, e.g. an appropriate catch net. This secondary safety attachment must be constructed in a way that no part of the installation can fall down if the main attachment fails.
- ♦ When rigging, derigging or servicing the fixture staying in the area below the installation place, on bridges, under high working places and other endangered areas is forbidden.

Installing/Procedure:

- ♦ The projector should be installed outside areas where persons may walk by or be seated.
- ♦ **IMPORTANT!** OVERHEAD RIGGING REQUIRES EXTENSIVE EXPERIENCE, including (but not limited to) calculation working load limits, installation material being used, and periodic safety inspection of all installation material and the projector. If you lack these qualifications, do not attempt the installation yourself, but instead use a professional structural rigger. Improper installation can result in bodily injury or damage to property.
- ♦ The projector has to be installed out of the reach of people.
- ♦ If the projector shall be lowered from the ceiling or high joists, professional trussing systems have to be used. The projector must never be fixed swinging freely in the room.
- ♦ Caution: Projectors may cause severe injuries when crashing down! If you have doubts concerning the safety of a possible installation, do NOT install the projector!
- ♦ Before rigging make sure that the installation area can hold a minimum point load of 10 times the projector's weight.
- ♦ **DANGER OF FIRE!** When installing the device, make sure there is no highly inflammable material (decoration articles, etc.) within a distance of min. 0.5 M.
- ♦ Mount the projector with the mounting-bracket to your trussing system using an appropriate clamp. The hole in the mounting bracket has a diameter of 10 mm.
- ♦ For overhead use, always install a safety-rope that can hold at least 10 times the weight of the fixture. You must only use safety-ropes with screw-on carabine. Pull the safety-rope through the hole in the mounting-bracket and over the trussing system etc. Insert the end in the carabine and tighten the safety screw.
- ♦ Adjust the desired inclination-angle via the mounting-bracket and fix the fixation screws.
- ♦ **DANGER TO LIFE!** Before taking into operation for the first time, the installation has to be approved by an expert!

Installing /Connection with the mains

- ♦ **DANGER TO LIFE!** The electric connection must only be carried out by a qualified electrician!
- ♦ In order to connect the device to the mains, you have to install a power-plug.
- ♦ The occupation of the connection-cables is as follows:

Cable	Pin	International
Brown	Live	L
Blue	Neutral	N
Yellow/Green	Earth	

- ♦ The earth has to be connected!
- ♦ Connect the device to the mains with the power-plug.

PACK 56 CN

- ♦ If the device will be directly connected with the local power supply network, a disconnection switch with a minimum opening of 3 mm at every pole has to be included in the permanent electrical installation.
- ♦ In general, lighting effects should not be connected to dimming-packs.
- ♦ **DANGER TO LIFE!** Before taking into operation for the first time, the installation has to be approved by an expert!

OPERATION:

- ♦ After you connected the spot to the mains, you can control the spot via your lighting controller.

CLEANING AND MAINTENANCE

- ♦ The operator has to make sure that safety-relating and machine-technical installations are inspected by an expert after every four years in the course of an acceptance test.
- ♦ The operator has to make sure that safety-relating and machine-technical installations are inspected by a skilled person once a year.
- ♦ The following points have to be considered during the inspection:
 - 1) All screws used for installing the devices or parts of the device have to be tightly connected and must not be corroded.
 - 2) There must not be any deformations on housings, fixations and installation spots (ceiling, suspension, trussing).
 - 3) The electric power supply cables must not show any damages, material fatigue (e.g. porous cables) or sediments.Further instructions depending on the installation spot and usage have to be adhered by a skilled installer and any safety problems have to be removed.
- ♦ **DANGER TO LIFE!** Disconnect from mains before starting maintenance operation!
- ♦ We recommend a frequent cleaning of the device. Please use a moist, lint-free cloth. Never use alcohol or solvents!
- ♦ The interior of the device should be cleaned at least annually using a vacuum-cleaner or an air-jet.
- ♦ There are no serviceable parts inside the device except for the lamp. Maintenance and service operations are only to be carried out by authorized dealers.
- ♦ Please refer to the instructions under "Installing/Replacing the lamp".
- ♦ Should you need any spare parts, please use genuine parts.
- ♦ If the power supply cable of this device becomes damaged, it has to be replaced by authorized dealers only in order to avoid hazards.
- ♦ Should you have further questions, please contact your dealer.

TECHNICAL SPECIFICATIONS

Power supply:	Max.230-240V/AC, 50Hz
Power consumption,	Max.300W
Dimensions (L x W x H);	205 x 205 x 250mm
Weight:	1.0 kg
Fitting lamp	Max.230-240V/300W PAR56 Base: DX16d
Maximum ambient temperature T _a :	25°C
Maximum housing temperature T _s :	140°C
Minimum distance:	2m

Made in China

