

ORIGINAL INSTRUCTION MANUAL

PETROL LAWNMOWERS

LK 41 B&S

LK 41 SP B&S

LK 46 B&S

LK 46 SP B&S

LK 51 SP HW SM B&S

LK 51 SP HW SM 173 cc OHV

LK 41 139 cc OHV

LK 41 139 cc OHV RALLY

(mod.: DG41PB-BS450E-405 / DG41SB-BS450E-405 / DG46PB-BS450E / DG46SB-BS450E /

DG51SF-BS625E / DG51SF-173 / DG41PB-139-405 / DG41PB-139-405)

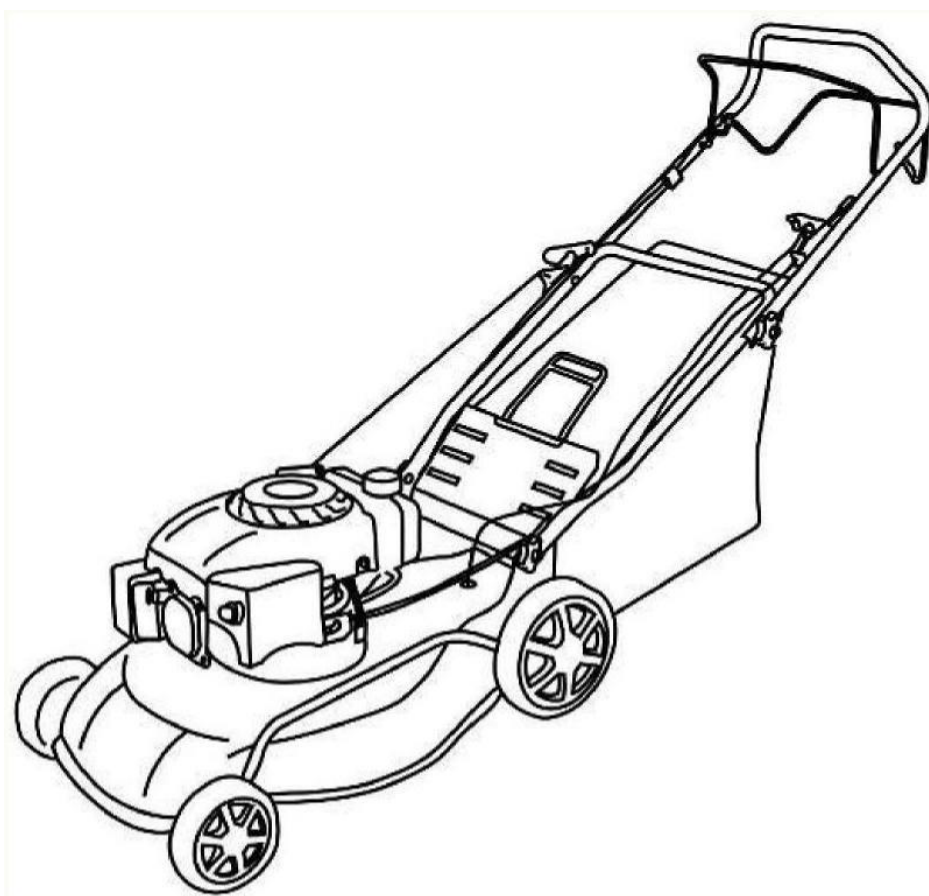

READ THIS MANUAL CAREFULLY BEFORE OPERATING THE MACHINE
KEEP THIS MANUAL FOR FUTURE REFERENCE
WARNING THIS SYMBOL INDICATES IMPORTANT SAFETY FEATURES

Serial number:



CONTENT

Introduction	3
Safety instructions	4
Training	
Preparation	
Operation	
Maintenance and storage	
Product specifications	7
Definition of symbols	8
Description of components	9
Unpacking and set up instructions	10
Removal from the carton	
Disconnect the spark plug	
Items required for assembly	
Assembly of the handle	
Cutting height adjustment	
Operating	12
Grass box assembly	
Grass box removal	
How to fix the mulching plug ?	
Operating without a grass collecting box	
Side discharge	
Starting and stopping	14
Starting a cold engine	
Starting a warmed up engine	
Stop engine and blade	
Self propelled mower	
Maintenance	16
Oil service	
Spark plug Air	
cleaner Engine	
cleaning	
Deck housing	
Off season storage	
Conditions of warranty	17
EC declaration of conformity	18

INTRODUCTION

Dear Customer, thank you for purchasing our petrol lawnmower .

This manual explains how to use the machine correctly.

Before using it, please read this operator's manual carefully, to ensure correct and safe operation.

Due to ongoing changes of specification, all the details of your machine may not agree with this manual.

Your lawnmower is designed solely for grass cutting and collecting It should not be used for any other purpose and extreme caution should be exercised at all times.

A lawnmower motor is a machine designed to cut and collect (depending on equipment) grass from private ornamental gardens.

Any other use not expressly permitted in these instructions may result in damage and may pose a serious hazard to the user and is not permitted.

This machine must **NEVER** be used :

- Intensively
- For professional use (including rental) or agriculture
- For public parks or forest maintenance
- On a rainy day or in a humid environment
- By children under 16 years and unaccompanied minors

**READ THIS MANUAL CAREFULLY BEFORE
OPERATING THE MACHINE**

KEEP THIS MANUAL FOR FUTURE USES

SAFETY INSTRUCTIONS

TRAINING

- Read the instructions carefully in its entirety before assembling this machine. Read, understand and follow all instructions on the machine and in the manual before the first operation. Be completely familiar with the controls and the proper use of the equipment.
- Keep this manual in a safe place for future and regular reference and for ordering replacement parts.
- Never allow children under 16 years old or people unfamiliar with these instructions to use the lawn mower. Local regulations can restrict the age of the operator.
Children 16 years old and over should only operate a petrol mower under parental supervision; ensuring only responsible individuals who are familiar with these rules of safe operation should be allowed to use your mower.
- Never mow while people, especially children, or pets are nearby;
- If a situation occurs that is not covered in this user manual, use care and common sense and contact your dealer for assistance.

PREPARATION

- Keep the work area clear of all persons, particularly small children and pets. Stop engine when they are in the vicinity of your lawnmower to help prevent any blade contact or any injuries from thrown objects. Although the work area should be completely cleared of foreign objects, an object may have been overlooked and could be accidentally thrown by the lawnmower in any direction and cause serious personal injury to the operator or any others in the vicinity.
- Thoroughly inspect the area where the lawnmower is to be used and ensure removal of all stones, sticks, wire, bones, toys and other foreign objects which could be picked up by the lawnmower and thrown in any direction and cause a serious injury to the operator or others in the vicinity.
- The use of safety goggles or glasses is imperative during operation or while performing an adjustment or repair to the machine to protect eyes from foreign objects that could be thrown from the machine in any direction
- Also, wear steel-toe capped safety shoes, long trousers and long sleeved shirts when operating the machine. Do not wear loose fitting clothes or jewellery as these can be caught in mowing parts. Never operate a lawnmower in bare feet, open sandals, slippery or light weight (canvas) shoes.
- Do not put hands or feet near or underneath rotating parts on the lawnmower and keep well clear of the discharge opening at the rear of the machine at all times as the rotating blade can cause serious injury
- Ensure you have a firm footing when holding the machine as many injuries occur as a result of the lawnmower being pulled over a foot during a fall. If you feel unsteady at all, release the handle of the mower immediately. This will ensure stopping of the engine before any injuries can occur.
- Never pull the mower towards you while you are walking. If you must back the lawnmower away from an obstruction follow these step :
 - Look down and behind where you are standing
 - Step back from the lawnmower and extend your arms
 - Ensure you are balanced with solid footings
 - Pull the lawnmower back slowly, no more than half way towards you
 - Repeat these steps when necessary
- Plan your cutting pattern to avoid discharge of foreign objects towards roads, footpaths or bystanders. To help avoid injuries from thrown foreign objects, keep children, bystanders and aids at least 50 meters away from the lawnmower while it is in operation and keep in mind that the user is responsible for hazards and accidents occurring to others and their property
- While mowing, always wear substantial footwear and long trousers. Do not operate the equipment when barefoot or wearing open sandals;



- Thoroughly inspect the area where the equipment is to be used and remove all objects which can be thrown by the machine;

WARNING ! DANGER !

Petrol is highly flammable !!

- Store fuel only in containers specifically designed and approved for this purpose ;
- Refuel outdoors only with the engine stopped and do not smoke while refueling ;
- Add fuel before starting the engine. Never remove the cap of the fuel tank or add petrol while the engine is running or when the engine is hot ; allow the engine at least 2 minutes to cool before refuelling.
- If petrol is spilled, do not attempt to start the engine but move the machine away from the area of spillage and avoid creating any source of ignition until petrol vapours have dissipated. Clean up before starting the engine. Do not overfill !
- Replace all fuel tank and container caps securely before starting the engine ;
- Replace faulty silencers;
- Before each use, always visually inspect to see that the blades, blade bolts and cutter assembly are not worn or damaged, but secure and that the machine is in a safe working condition. Replace worn or damaged blades and bolts in sets to preserve balance;
- Before each use inspect the cutting blade for any bends, cracks or worn and replace when required with a replacement blade that needs the original specification as listed in this manual
- Grass collector parts are subject to wear, damage or deterioration this could expose moving parts and allow foreign objects to be thrown from the machine. For safety, check all components frequently and replace worn or damaged parts where necessary
- USE ORIGINAL SPARE PART. Parts not produced by manufacturer may cause poor fit and possible injury
- Do not change the engine governor setting or the speed of the engine, as excessive engine speeds are dangerous. Do not adjust the throttle while the engine is running.
- Do not smoke near the machine. All cigarettes and other sources of ignition must be removed from the area

OPERATION



WARNING ! DANGER !

Do not operate the engine in a confined space where dangerous carbon monoxide fumes can collect.

- Do not operate the lawnmower whilst under the influence of drugs or alcohol
- Do not hold self drive in position while starting the engine. This must not be completed until the engine is running
- Mow only in daylight or in good artificial light ;
- Always be sure of your footing on slopes as a slip and fall can cause serious personal injury ;
- If you feel you are losing your footing always release the OPC/Operators Presence Control handle immediately and the blade with stop rotating within a few seconds ;
- The Operators Presence Control (OPC) handle is a safety device. NEVER attempt to bypass its operation as this makes the safety device inoperative and can result in injuries through contact with the cutting blade. The OPC handle must operate freely in both directions and release automatically to the disengaged position when let go.
- Walk, never run. Hold the handles firmly
- Avoid operating the equipment in wet grass, where possible
- Do not operate the lawnmower whilst under the influence of Drugs or alcohol
- Do not hold self drive in position while starting the engine. This must not be completed until the engine is running
- When using wheeled or rotary machines, mow across the face of slopes, never up and down. A slope gauge must be used and if the slope is greater than 20 degrees you must not operate the lawnmower on the area or it may result in serious injury
- Exercise extreme caution when changing direction on slopes;
- Do not mow excessively steep slopes;
- Use extreme caution when reversing or pulling the lawn mower towards you;
- Stop the blade(s) if the lawn mower has to be tilted for transportation when crossing surfaces other than

- grass, and when transporting the lawn mower to and from the area to be mowed;
- Never operate the lawn mower with defective guards, or without safety devices, for example deflectors and/or grass catchers, in place;
- Disengage all blade and drive clutches before starting the engine;
- Start the engine carefully according to instructions and with feet well away from the blade(s);
- Do not tilt the lawn mower when starting the engine;
- Do not start the engine when standing in front of the discharge chute;
- Do not put hands or feet near or under rotating parts. Do not touch rotating blade.
- Keep clear of the discharge opening at all times;
- Never pick up or carry a lawn mower while the engine is running;
- If the machine should start vibrating abnormally, stop the engine and visually inspect the cutting mechanism to ensure it is in good condition. Vibration is usually a warning sign for trouble. A damaged cutting blade must be replaced immediately with a new replacement blade
- The engine and exhaust of the lawnmower become hot while running and can cause a burn. Ensure these are not touched.

Stop the engine and disconnect the spark plug wire, make sure that all moving parts have come to a complete stop and, where a key is fitted remove the key:

- Before clearing blockages or unclogging chute;
- Before checking, cleaning or working on the lawn mower;
- After striking a foreign object. Inspect the lawnmower for damage and make repairs before restarting and operating the lawn mower;
- If lawn mower starts to vibrate abnormally (check immediately);

Stop the engine and disconnect the spark plug wire, make sure that all moving parts have come to a complete stop and, where a key is fitted remove the key:

- Whenever you leave the lawn mower;
- Before refueling;
- Reduce the throttle setting during engine shut down and, if the engine is provided with a shut-off valve, turn the fuel off at the conclusion of mowing ;
- Go slow when using a trailing seat ;

MAINTENANCE AND STORAGE

- Keep all nuts, bolts and screws tight to be sure the equipment is in safe working condition;
- Never store the equipment with petrol in the tank inside a building where fumes can reach an open flame or spark;
- Allow the engine to cool before storing in any enclosure;
- To reduce the fire hazard, keep the engine, silencer, exhaust, battery compartment and petrol storage area free of grass, leaves, or excessive grease;
- Check the grass catcher frequently for wear or deterioration;
- Replace worn or damaged parts for safety; Only use original spare parts
- Blade sharpening and balancing including relative dismantling and re-assembly are complicated operations which involves specific competence as well as special equipment. For safety reasons, these operations must be carried out by a specialized technical assistance center. The same procedure applies for blade replacement.
- The cutting edges of the mower blade are sharp and can lacerate (cut) skin tissue. Care should be taken when doing any repair work on or around the mower blade.
- If the fuel tank has to be drained, this should be done outdoors.

PRODUCT SPECIFICATIONS

Model	LK 41 B&S	LK 41 SP B&S	LK 46 B&S	LK46 SP B&S
Factory model	DG41PB-BS450E-405	DG41SB-BS450E-405	DG46PB-BS450E	DG46SB-BS450E
GARDIF model	TOT911305	TOT911307	TOT911308	TOT911309
Drive	Hand propelled	Self-propelled	Hand propelled	Self-propelled
Engine	B&S 450E Series	B&S 450E Series	B&S 450E Series	B&S 450E Series
Nominal Power	1.7kW	1.7kW	1.7kW	1.7kW
Rated Engine Speed	2800 rpm	2800 rpm	2800 rpm	2800 rpm
Displacement	125 cm ³	125 cm ³	125 cm ³	125 cm ³
Height Adjustments	Central adjustment	Central adjustment	Central adjustment	Central adjustment
Cutting Heights	25-70mm (7 stages)	25-70mm (7 stages)	25-70mm (7 stages)	25-70mm (7 stages)
Grass collector	Rear bag	Rear bag	Rear bag	Rear bag
Grass collector volume	45 litres	45 litres	50 litres	50 litres
Cutting width	41 cm / 16"	41 cm / 16"	46 cm / 18"	46 cm / 18"
Deck material	steel	steel	steel	steel
Net weight	19.5 kg	24 kg	22.5 kg	27 kg
Sound pressure level LPA at operator's working place (as per ISO 5395-1:2013, Annex F)	81.5 dB(A)	81.5 dB(A)	81.5 dB(A)	81.5 dB(A)
Incertainity of Measurement	K=3 dB(A)	K=3 dB(A)	K=3 dB(A)	K=3 dB(A)
Measured sound power level LWA(EN836)	93.2 dB(A)	93.2 dB(A)	93.2 dB(A)	93.2 dB(A)
Incertainity of Measurement	K=1.85 dB(A)	K=1.85 dB(A)	K=1.85 dB(A)	K=1.85 dB(A)
Guaranteed sound power level LWA(2000/14/EC)	96 dB(A)	96 dB(A)	96 dB(A)	96 dB(A)
Vibrations level hand/arm (as per ISO 5395- 1:2013, Annex G)	Max. 6.01 m/s ²	Max. 6.01 m/s ²	Max. 6.01 m/s ²	Max. 6.01 m/s ²
Uncertainty of declared values	K=1.5 m/s ²	K=1.5 m/s ²	K=1.5 m/s ²	K=1.5 m/s ²
Blade type	CLD21080152	CLD21080152	CLD21080012	CLD21080012
Spark plug type	QC12YC	QC12YC	QC12YC	QC12YC
Tank capacity (fuel)	0.75 L	0.75 L	0.75 L	0.75 L
Tank capacity (oil)	0.47L	0.47L	0.47L	0.47L

Model	LK 51 SP HW SM B&S	LK 51 SP HW SM 173 cc OHV	LK 41 139 cc OHV	LK 41 139 cc OHV RALLY
Factory model	DG51SF-BS625E	DG51SF-173	DG41PB-139-405	DG41PB-139-405
GARDIF model	TOT911310	TOT911314	TOT911306	TOT911337
Drive	Self propelled	Self propelled	Hand propelled	Hand propelled
Engine	B&S 625E Series	DG1P70F Rally	DG1P65F - Rally	DG1P65F - Rally
Nominal Power	2.2 kW	2.5 kW	2.0 kW	2.0 kW
Rated Engine Speed	2800 rpm	2800 rpm	2800 rpm	2800 rpm
Displacement	150 cm ³	173 cm ³	139 cm ³	139 cm ³
Height Adjustments	Central adjustment	Central adjustment	Central adjustment	Central adjustment
Cutting Heights	25 – 75 mm (7 stages)	25–75mm (7 stages)	25–75mm (7 stages)	25–75mm (7 stages)
Grass collector	Rear bag	Rear bag	Rear bag	Rear bag
Grass collector volume	60 litres	60 litres	45 litres	45 litres
Cutting width	51 cm / 20"	51 cm / 20"	41 cm / 16"	41 cm / 16"
Deck material	steel	steel	steel	steel
Net weight	29 kg	35 kg	23.5 kg	23.5 kg
Sound pressure level LPA at operator's working place (as per ISO 5395-1:2013, Annex F)	84.3 dB(A)	86.6 dB(A)	80.1 dB(A)	80.1 dB(A)
Incertainty of Measurement	K=3 dB(A)	K=3 dB(A)	K=3 dB(A)	K=3 dB(A)
Measured sound power level LWA(EN836)	96.4 dB(A)	96 .3dB(A)	91.4 dB(A)	91.4 dB(A)
Incertainty of Measurement	K=1.83 dB(A)	K=1.89 dB(A)	K=1.91 dB(A)	K=1.91 dB(A)
Guaranteed sound power level LWA(2000/14/EC)	98 dB(A)	98 dB(A)	96 dB(A)	96 dB(A)
Vibrations level hand/arm (as per ISO 5395- 1:2013, Annex G)	Max. 8.16 m/s ²	Max. 4.0 m/s ²	Max. 2.76 m/s ²	Max. 2.76 m/s ²
Uncertainty of declared values	K=1.5 m/s ²	K=1.5 m/s ²	K=1.5 m/s ²	K=1.5 m/s ²
Blade type	CLD21080022	CLD21080022	CLD21080152	CLD21080152
Spark plug type	XC92YC	TORCH F7RTC	TORCH F6RTC	TORCH F6RTC
Tank capacity (fuel)	0.8 L	1.5 L	1.5 L	1.5 L
Tank capacity (oil)	0.47 L	0.6 L	0.6 L	0.6 L

DEFINITION OF SYMBOLS

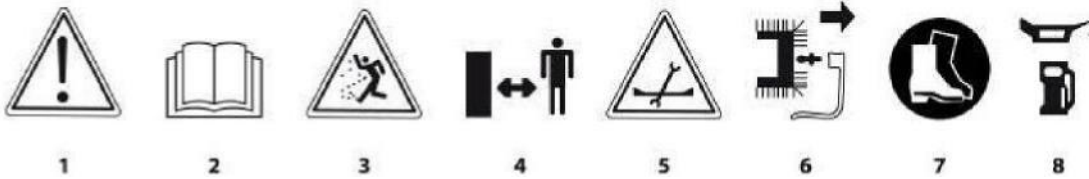

1 : DANGER ! WARNING ! ATTENTION

2 : Read the operating and service instruction manual carefully. Be thoroughly familiar with the controls and the proper use of the lawnmower.

3 : Projection hazard. Beware of thrown objects.

4 : Never mow while people, especially children or pets, are nearby.

5 & 6 : When cleaning, repairing or inspecting, make certain the blade and all mowing parts have stopped. Disconnect the spark plug cap and keep the cap away from the plug to prevent accidental starting

7 : Wear steel-toe capped safety shoes, long trousers and long sleeved shirts when operating the machine

8 : WARNING !

Oil tank and fuel tank are clearly separated.

This lawnmower is sold without fuel and oil. Ensure machine is oiled and fuelled before starting the engine.



9 : Moving blades !! Do not put hands or feet near the blades.

10 : The blade continues to rotate for a few seconds after stopping the mower.

11 : When mowing, wear safety glasses and ear plugs to protect yourself

12 : High risk of explosion. Do not fill the fuel tank whilst the engine is running

13 : Emission of toxic gas, do not use the lawnmower in doors or a non ventilated area

14 : Caution : hot surfaces

15 : LwA (ISO 19884)

16 : WARNING: Keep hands and feet away from the blades!

DESCRIPTION OF COMPONENTS

- 1 : Fly brake lever or Operators Presence Control (OPC)
- 2 : Upper handle
- 3 : Traction lever (not valid for LK41/LK46)
- 4 : Throttle control
- 5 : Accelerator (speed) cable
- 6 : Bolts
- 7 : Lower handle
- 8 : Grass collecting box
- 9 : Self propelling cable (not valid for LK41/LK46)
- 10 : Back wheel
- 11 : Cutting deck
- 12 : Heights adjustment arm
- 13 : Front wheel
- 14 : Air filter
- 15 : Primer
- 16 : Spark plug and cap
- 17 : Silencer (exhaust)
- 18 : Engine
- 19 : Fuel tank
- 20 : Rear flap / deflector
- 21 : Metal frame of the grass collecting box
- 22 : Recoil starter
- 23 : Shutter for side discharge (only for LK 51 SP HW SM)
- 24 : Oil tank
- 25 : Oil lever
- 26 : Central heights adjustment lever
- 27 : Recoil starter

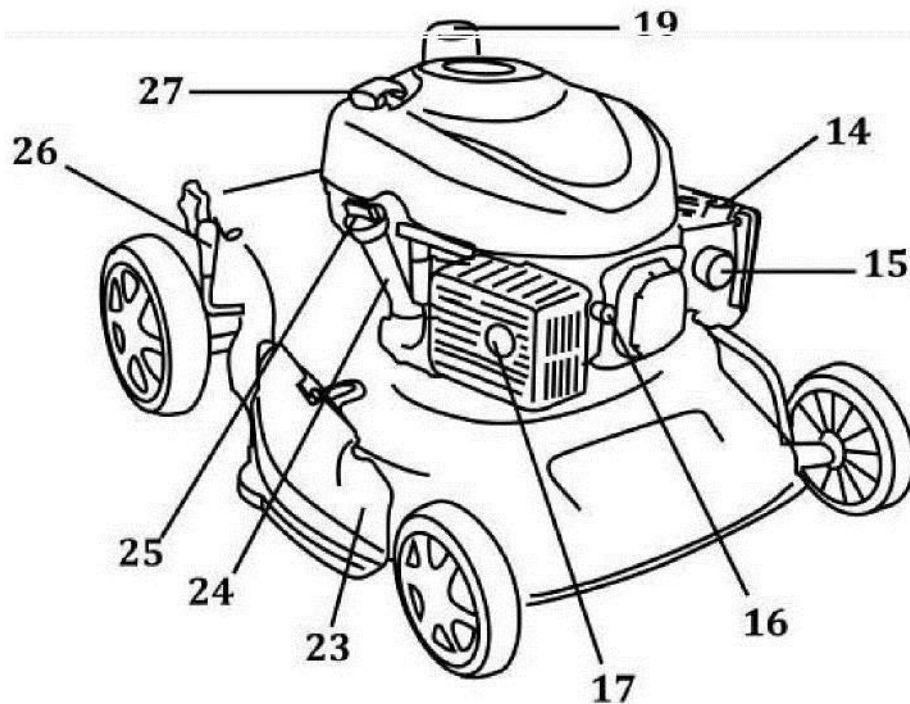
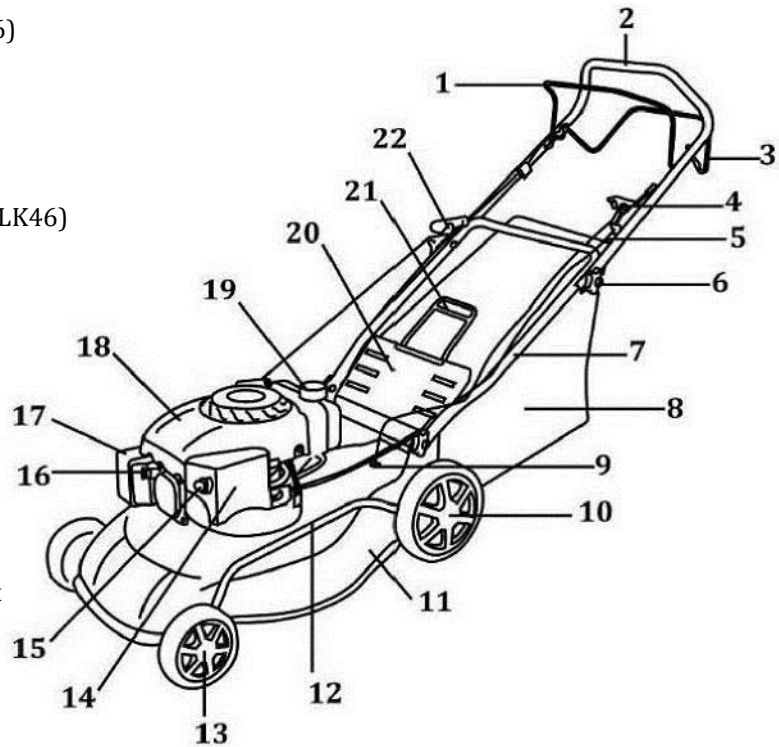

UNPACKING & SET UP INSTRUCTIONS



Use of safety gloves is imperative while performing adjustment or repair of the machine

A- Removal from the carton

- **WARNING** – Unpacking and completing the assembly should be done on a flat, stable surface with enough space for machine handling and its packaging. Packaging must be disposed of in accordance with the local regulations.
- Remove the staples, break the glue on the top box flaps or cut the tape at the carton end and peel along the top flat to open the carton.
- Remove any loose parts included with the lawnmower e.g. grassbox and including the instruction manuals and tools where applicable and store safely for future reference.
- Cut along the corners of the carton and lay flat.
- Remove any packing material and roll or slide the lawnmower out of the carton checking the empty carton for loose parts.

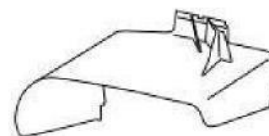
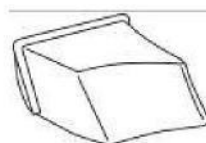
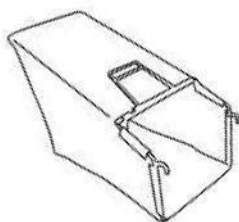

1

2

3

4

5

- 1 : Spark plug wrench
2 : Cable clips
3 : Grass catch bag and its metal frame
4 : Mulching plug (only on LK 51 SP HW SM)
5 : Side discharge deflector (only on LK 51 SP HW SM)

B- Disconnect the spark plug

- Before assembling your lawnmower, disconnect the spark plug wire from the spark plug and ground it to the engine by attaching the rubber boot or metal clip to the grounding post on the engine.

C- Items required for assembly

- Pliers (may be useful)
- 0.6 Litre SAE 30 Oil
- Fresh Petrol



IMPORTANT – This lawnmower is shipped without fuel and oil. Ensure machine is oiled and fuelled as detailed in this manual before starting the engine.

NOTE – Reference to right hand or left hand side of the mower is observed from the rear of the machine (operating position)

D- Assembly of the handle

- Nip together the lower handle against the mounting bracket (using pliers).
- Connect the lower handle, right bracket and left bracket with two knob nuts and two square neck bolts.
- Lift the upper handle and align it with the lower handle. Tighten knob nuts or the quick lock handle to the upper handle.
- Raise the complete handlebar whilst depressing both levers to release the starter handle, taking care not to crease the control cables at the pivot point.
- Attach the control cables to the handle with cable ties and attach the recoil starter to the rope guide on the upper handle

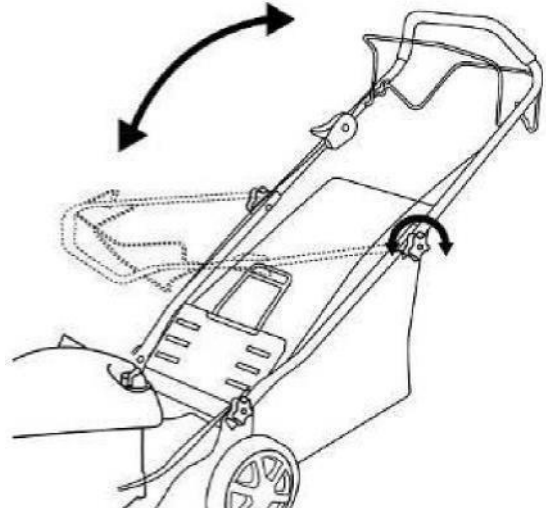
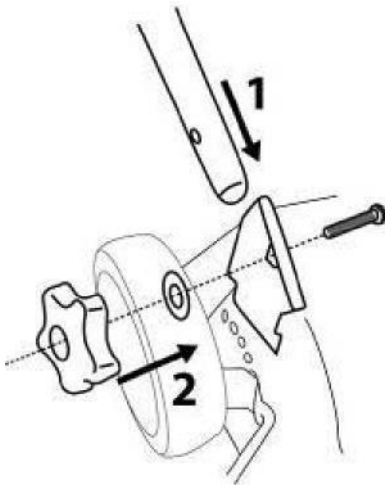

E- Cutting height Adjustment

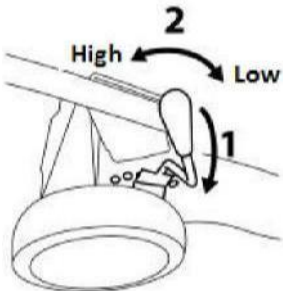

The cutting height adjustment lever is situated above the right rear wheel.

To adjust the cutting height, pull the height adjustment lever out and away from the lawnmower and move forward or backwards into another slot depending whether you want it to cut shorter (low) or longer (high).

NOTE

For rough and uneven lawns, move the height adjuster to a higher position as this will stop scalping.



KEEP HANDS AND FEET AWAY FROM THE REAR DISCHARGE ON THE CUTTING DECK

A- Grass box assembly

Put the metal frame inside the grass collector. Fix the bag onto the frame securely. Lift the rear flap / deflector and attach the grass collector in place, on rear of the mower.

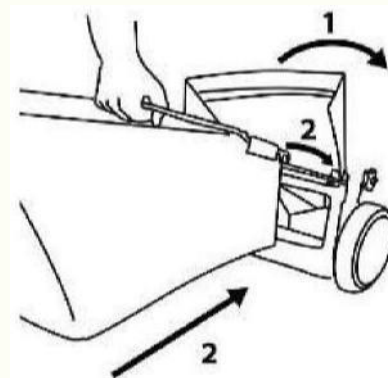

B- Grass box removal

Release the OPC/Operators Presence Control handle and wait for the blade to stop rotating. Lift the rear flap / deflector and remove the grass collector from its in place. Release the rear flap / deflector. Empty the clippings

C- How to fix the mulching plug (only for model LK 51 SP HW SM)

- STOP the engine before fixing the mulching plug or before removing it.
- Remove the collection bag.
- Lift the rear flap and insert the mulching plug in the grass evacuation channel (picture A)..
- As soon as properly fixed, release the rear flap on the mulching plug (picture B)
- To remove the mulching plug, lift the rear flap, remove the plug, fix the collection bag et release the flap on the bag.

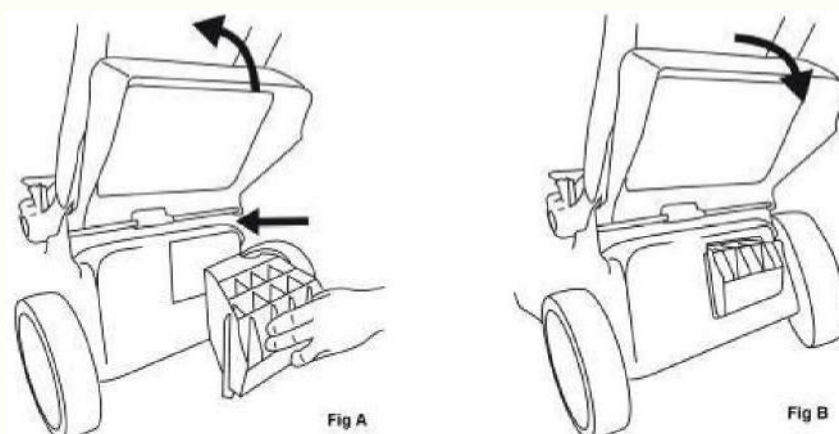

D- Operating without a grass collecting box

You can operate the lawnmower without grass collecting box nor mulching plug. You must nevertheless always ensure that the rear flap / deflector is always folded against the deck.

E- Side discharge (only for model LK 51 SP HW SM)

Lift the side discharge shutter on the cutting deck

Attach the side discharge shutter in place, in the hooks provided for this purpose.

Release the shutter so it also compresses the deflector against the deck

Caution: Leave the mulch plug in place to use the mower with the side discharge function.

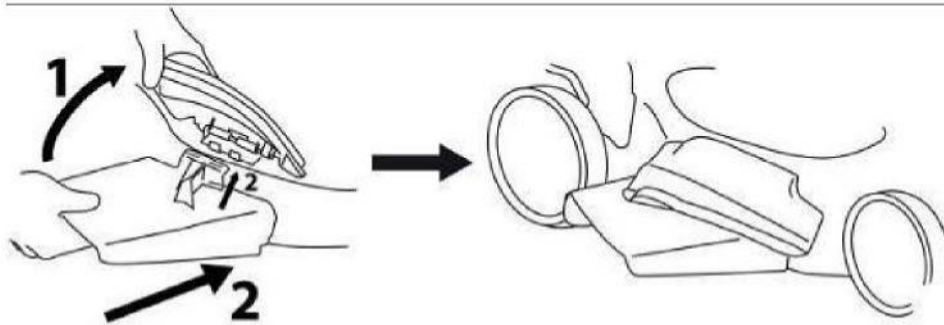

STARTING AND STOPPING



WARNING !

This lawnmower is sold without fuel and oil.

Ensure machine is oiled and fuelled before starting the engine

Do not overfill



Never fill a fuel tank in a confined area, indoors or when the engine is running.

Allow to cool for at least two minutes before refuelling

A- Starting a cold engine

1. The throttle control, located on the right hand side of the upper handle, is used to regulate the engine speed. Move the throttle on « STARTER MAX » position.
2. Press 3 times in hot weather or 5/6 times a very cold time the red primer on the front left side of the air filter.

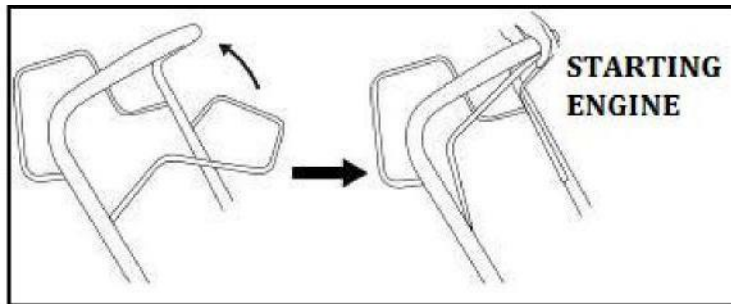

3. Attach the spark plug ensuring the metal cap is fastened securely to the metal tip on the spark plug.
4. The flywheel brake lever / operators presence control / OPC handle is located in the upper handle of the lawnmower. The handle must be depressed to allow the ignition and held against the upper handle.
5. The recoil starter handle is attached to the upper handle on the right hand side. When starting, always stand behind the lawnmower in the operating position. Pull the recoil starter handle until the engine runs.
6. Once started, allow 2 / 3 minutes for the engine to warm up before mowing.

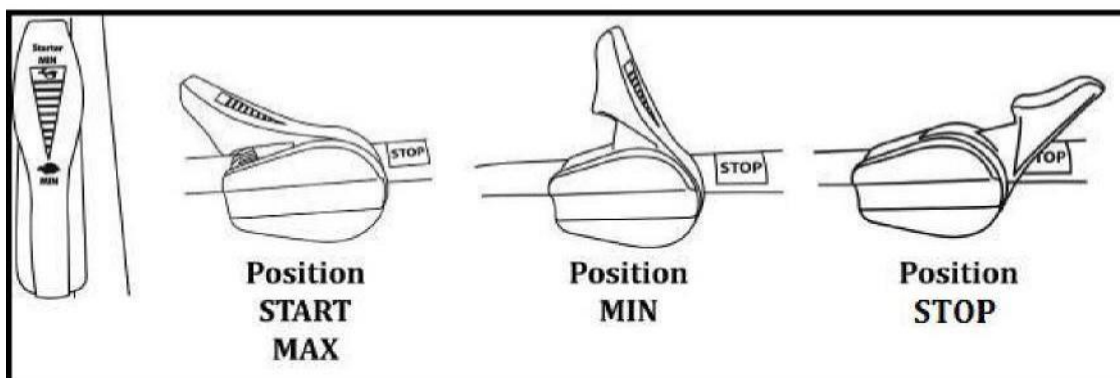

The blade starts to rotate after the engine is switched on.



B- Starting a warmed up engine

Move the throttle on «MIN» position

Depress the OPC handle to allow the ignition and held against the upper handle.

Pull the recoil starter handle until the engine runs.

C- Stop engine and blade

Move the throttle control onto « STOP » position

Release the Operators Presence Control (OPC) handle to stop the engine and blade.

WARNING !!

The blade continues to rotate after the engine is switched off.

WARNING !!

The OPC handle is a safety device.

Never attempt to bypass its operations. The blade will be rotating when the engine is running

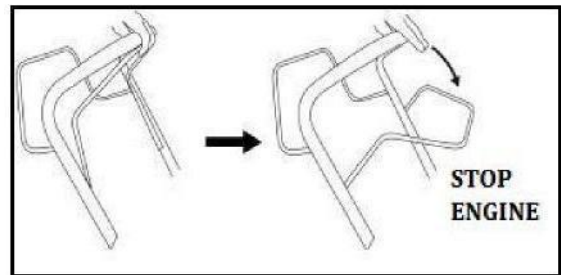

D- Self propelled mower (not for mod. LK 41R and mod. LK 46R)

Once engine has been started, push the traction lever up against the upper handle and keep it in this position. The mower now starts to move.

To stop the mower, release the lever.

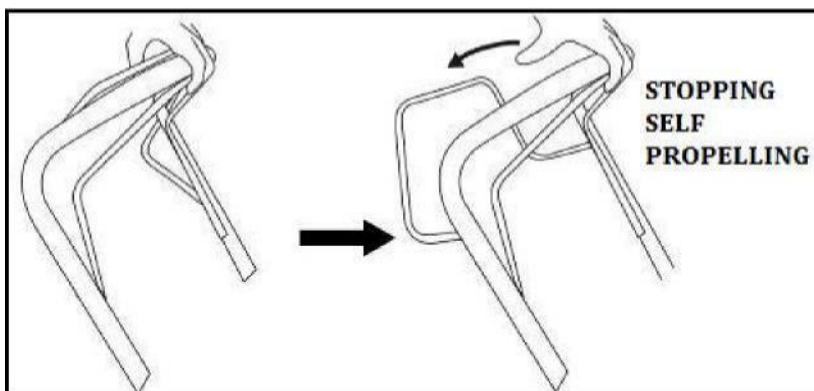
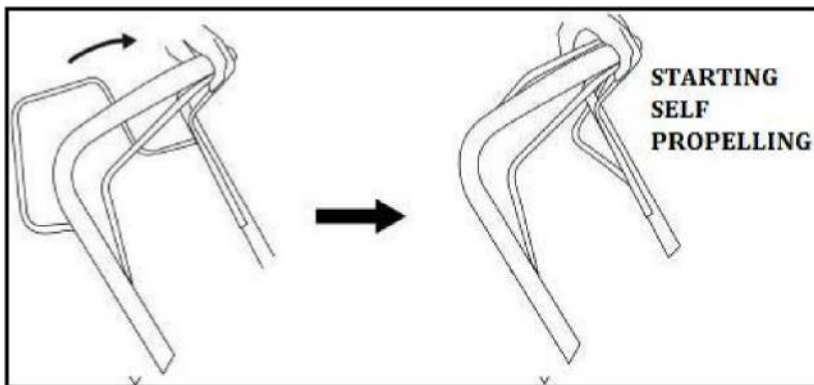

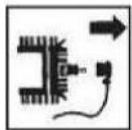

Stop the engine and disconnect and earth the spark plug before any repairing or maintenance operations.



Use of safety gloves is imperative while performing adjustment or repair of the machine

Only use original spare parts (see Trenchex Power Products Ltd. website).



Complicated operations -not listed here below- must be carried out by a specialized technical assistance centre.

Regular and careful maintenance is essential for keeping the safety level and original performance of the machine unchanged in time.



When tipping the lawnmower for access to carryout repairs, empty the fuel tank. Never tip the lawnmower more than 90degrees in any direction and never leave the mower tipped for any length of time as oil can drip into the air cleaner of the engine, thus causing a starting problem.

A- Oil service

Check the oil level daily before starting the engine and ensure the correct oil level is maintained. Change the engine oil after 8 hrs of operation and then every 50 hrs or every season depending on usage.

B- Spark plug

The spark plug should be changed every 100 hours or every season depending on use. Check the plug before each use and plug gap reset once a season. Refer to the engine manual for the correct plug type and gap specifications.

C- Air cleaner

The air cleaner must be changed. Clean every few hours under extremely dry and dusty conditions as poor performance and flooding usually indicate the air cleaner should be cleaned / changed.

D- Engine cleaning

Clean the engine regularly with a dry brush or cloth. Ensure you keep the blower housing area free from debris, grass and dust to allow proper air circulation when is essential for engine performance. Also ensure you remove all grass, dirt and debris from the muffler area. .

1. Remove the oil dipstick
2. Remove the pater air filter to avoid it seaking up petrol.

E- Deck housing

Remove all grass debris from the underside of the cutting deck immediately after each use. If allowed to accumulate, it will cause rust and corrosion and may prevent proper collection.

Fertilisers and top dressings are extremely corrosive.

Thoroughly clean the cutting deck immediately after use on treated grass and store them well away from corrosive materials.

F- Off season storage

It is good practise to prepare your lawnmower for storage when not in use.

Clean and lubricate the lawnmower thoroughly • Refer to the engine manual for correct engine storage instructions •

Coat the cutting blade with grease to prevent any corrosion when not in use

Store the mower in a clean dry area away from corrosive materials like fertilisers

When storing your lawnmower or any other type of power equipment in a poorly ventilated or metal storage unit, it is vital that you rust proof the equipment using a light oil silicone, especially cables and all moving parts.

CONDITIONS OF WARRANTY

The manufacturer warrants the product against faulty materials and workmanship for a period of 2 years from the date of first purchase.

The warranty is only valid when the product is used in domestic situations, any machine used for commercial or professional use involving financial gain or hire is subject to a 90 day warranty (unless otherwise specified by the manufacturer)

Warranty does not extend to failure due to fair wear and tear.

The manufacturer undertakes to replace their expense, any parts that are classified as defective by them or authorised stockist.

The machine must be reasonably kept and only used for the operation it was designed and manufactured for.

WARRANTY DOES NOT COVER

- Use outside of the machines intended design and operation
- Accidental damage
- Insufficient maintenance
- Incorrect fuel mixture or fuel that is stale
- Incorrect assembly, adjustment or operation of the product
- Spare parts that are subject to normal wear and tear e.g. blades, nylon heads, bearings, cables, guards, deflectors
- spark plugs, air filters etc.
- Freight and packing costs.
- Use of non-genuine spare parts i.e. those from another manufacturer
- Use of the machine for any other purpose than that for which it was designed.

**READ THIS MANUAL CAREFULLY BEFORE OPERATING THE MACHINE
KEEP THIS MANUAL FOR FUTURE USES**

Retain the receipt of purchase without which no warranty can be offered.

EC DECLARATION OF CONFORMITY

Serial number : pls see front page

We Company,

GARDIF SAS
ZA de l'Europe
60, Avenue de Bruxelles
77310 St FARGEAU
PONTIERRY FRANCE

The undersigner, Bruno VAN ELSLANDE, Managing Director and the person authorized to compile the technical file : Yuxi WANG, quality engineer

Declare that petrol mowers branded: **LAWN KING / TROJAN** models

LK 41 B&S equipped with engines Briggs & Stratton 450E series 125 cc

Factory models: DG41PB-BS450E-405 References: TOT911305 Cutting: 410 mm

LK 41 SP B&S equipped with engines Briggs & Stratton 450E series 125 cc

Factory models: DG41SB-BS450E-405 References: TOT911307 Cutting: 410 mm

LK 46 B&S equipped with engines Briggs & Stratton 450 series 148 cc

Factory models: DG46PB-BS450E References: TOT911308 Cutting: 460 mm

LK 46 SP B&S equipped with engines Briggs & Stratton 450 series 148 cc

Factory models: DG46SB-BS450E References: TOT911309 Cutting: 460 mm

LK 51 SP HW SM B&S equipped with engines Briggs & Stratton 625E series 150 cc

Factory models: DG51SF-BS625E References: TOT911310 Cutting: 510 mm

LK 51 SP HW SM 173 cc OHV equipped with engines 139 cc

Factory models: DG51SF-173 References: TOT911314 Cutting: 510 mm

LK 41 139 cc OHV equipped with engines 139 cc

Factory models: DG41PB-139-405 References: TOT911306 Cutting: 410mm

LK 41 139 cc OHV RALLY equipped with engines 139 cc

Factory models: DG41PB-139-405 References: TOT911337 Cutting: 410mm

(Lawn mower motor is a machine designed to cut and collect (depending on equipment) grass from private ornamental garden)

- are complying with Machine Directive 2006/42/EC

and with :

- EMC Directive 2004/108/EC
- Noise Directive 2000/14/EC (amended by 2005/88/EC)
- Emissions Directive 97/68/EC, amended by Directive 2002/88/EC, Directive 2004/26/EC and Directive 2010/26/EU

Evaluated conformity as per Directive 2000/14/EC, Annexe VI and Directive 2005/88/EC.

Notified body: 0036 TUV SUD Industrie Service GmbH
Westendstrasse 199 • 80686 München • Deutschland

For models LK 41 B&S (DG41PB-BS450E-405)

Measured noise power level

Guaranteed noise power level

LWA m : 93.2 dB(A)

LWA g : 96 dB(A)

For models LK 41 SP B&S (DG41SB-BS450E-405)

Measured noise power level

Guaranteed noise power level

LWA m : 93.2 dB(A)

LWA g : 96 dB(A)

For model LK 46 B&S (DG46PB-BS450E)

Measured noise power level

Guaranteed noise power level

LWA m : 93.2 dB(A)

LWA g : 96 dB(A)

For model LK 46 SP B&S (DG46SB-BS450E)

Measured noise power level

Guaranteed noise power level

LWA m : 93.2 dB(A)

LWA g : 96 dB(A)

For model LK 51 SP HW SM B&S (DG51SF-BS625E)

Measured noise power level

Guaranteed noise power level

LWA m : 96.4 dB(A)

LWA g : 98 dB(A)

For model LK 51 SP HW SM 173 cc OHV (DG51SF-173)

Measured noise power level

Guaranteed noise power level

LWA m : 96.3 dB(A)

LWA g : 98 dB(A)

For model LK 41 139 cc OHV (DG41PB-139-405)

Measured noise power level

Guaranteed noise power level

LWA m : 91.4 dB(A)

LWA g : 96 dB(A)

For model LK 41 139 cc OHV RALLY (DG41PB-139-405)

Measured noise power level

Guaranteed noise power level

LWA m : 91.4 dB(A)

LWA g : 96 dB(A)

Made in Ponthierry, 11.09.2014

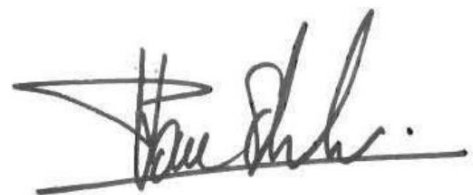

Bruno VAN ELSLANDE, Managing Director