

Honeywell

**Electronic Programmable
Thermostat
Owner's Manual**

® U.S. Registered Trademark
© 2004 Honeywell International Inc.
All Rights Reserved



69-0862—4

Table of Contents

Programming Your Thermostat	3
Program Schedule	5
Set Current Time/Day	6
Heating Program	6
Cooling Program.....	7
Operating Your Thermostat	7
Using Programming Features.....	7
Setting Fan Switch.....	8
Setting System Switch.....	9
Maintaining Your Thermostat	9
Installing Batteries	9
Troubleshooting Guide	12
Limited One-Year Warranty	17

Programming Your Thermostat

When batteries are installed, your thermostat can be programmed in your hand before it is installed or after it is mounted on the wall. For instructions on installing or replacing the batteries, refer to Maintaining Your Thermostat section.

Refer to the Program Schedule section to program your time and temperature settings for various times of the day.

Four time periods are available during workdays: WAKE, LEAVE, RETURN, and SLEEP. During weekends, only the WAKE and SLEEP time periods are available. View these periods individually on the display when you press the **Set Schedule** key.

WAKE is the time the thermostat turns on the heating/cooling equipment after an energy saving period. When deciding what time to set for your WAKE period, include extra lead time, depending on the outside temperature and your furnace response time, to give the furnace a head start to heat the house before you get up. (This will be a higher temperature during heating season, and a lower temperature during cooling season.)

LEAVE is the time period you can set for an energy-saving temperature while you are away at work or school. (This will be a lower temperature during heating season, and a higher temperature during cooling season.)

RETURN is the time the thermostat turns on the heating/cooling equipment after an energy saving period. When deciding what time to set for your RETURN period, include extra lead time, depending on the outside temper-

ature and your furnace response time, to give the furnace a head start to heat the house before you arrive home.

SLEEP is the time period you can set for an energy-saving temperature while you are sleeping. (For more comfortable sleeping, some people choose not to raise the cool temperature during the night.)

You will set one schedule for weekdays and another for weekends because your requirements will probably be different for each.

Fill in the times and temperatures you desire for weekdays and weekends. If you decide not to program the thermostat, it automatically controls heating at 68°F (20°C) and cooling at 78°F (20°C), 24 hours a day. Also, you do not need to enter a time and temperature program for all periods if your schedule does not require

it. For example, a house that is occupied during weekdays would only require programs for WAKE and SLEEP.

When pressing the keys, use the ball of your finger or a soft pencil eraser.

NOTE: Use of sharp fingernails or pencil points can damage the keypad.

If you make an error at any time during programming, just press the **Run Program** key, and continue again at the last step.

Program Schedule

Heating Program Schedule

Weekdays	Start Time	Heating Temperature^b	Cooling Temperature^b
WAKE ^a			
LEAVE			
RETURN ^a			
SLEEP			
Weekends			
WAKE ^a			
SLEEP			

^a WAKE and RETURN start times should include extra lead time, based on outside temperature and furnace response time, to give your furnace a head start to heat the house.

^b The temperatures cannot be set higher than 88°F (26°C) or lower than 45°F (7°C).

NOTE: If you decide not to program the thermostat, it will automatically control heating at 68°F (20°C), and cooling at 78°F (26°C), 24 hours a day. This guide can be used for programming your new thermostat.

IMPORTANT

Batteries are required for operation and programming. When inserting batteries, set the System switch to Off. Remove the battery door (on the thermostat left side) using a coin at the bottom. See Maintaining Your Thermostat section.

Set Current Time/Day

To set time, press and release **Set Clock/Day** key once. Press **Time** keys until current time shows.

To set the day, press and release the **Set Clock/Day** key again. Press **Time** keys until current day shows. Press **Run Program** key.

Heating Program

With the System switch set to Heat, press and release the **Set Schedule** key once. WAKE, Mon-Fri, and SET appear on the display.

Use **Time** keys to program WAKE time and **Temp** keys to program WAKE temperature for Mon-Fri. Repeat sequence for LEAVE, RETURN, and SLEEP.

Press **Set Schedule** key until WAKE, SA SU and SET appear on the display. Use **Time** keys to program WAKE time and **Temp** keys to program WAKE temperature for Sat-Sun. Repeat the sequence for SLEEP.

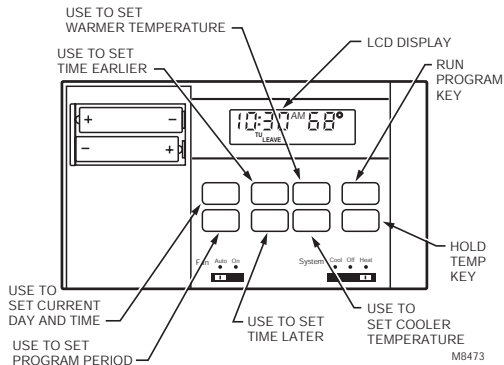

Cooling Program

With System switch at Cool, follow the same instructions as for the Heating Program.

After programming, adjust the Fan and System switches, as desired. Press and release **Run Program** key to start the program.

Operating Your Thermostat

Using Programming Features

Temporarily Change temperature for current period only—

Press **Temp** keys to set desired temperature. The change cancels itself at the next scheduled program change; to cancel sooner, press **Run Program** key.

Hold a temperature indefinitely—Press **Hold Temp** key once. Press **Temp** keys until display shows desired temperature. Press **Run Program** key once to return to the program.

Check Current Temperature Setting—Press **Run Program** key once. If using Temporary Change or Hold features, pressing this key cancels your change.

Check Programs—Press **Set Schedule** key repeatedly to see each time and temperature. Press **Run Program** key once to return to the program.

Cancel a program—Press **Set Schedule** key until the program to cancel shows. Pressing the two **Time** keys together cancels the program.

Permanently Change a program—Repeat the steps in the Heating Program or Cooling Program sections, as applicable.

Return to the normal program or the starting program—Press **Run Program** key once.

Setting Fan Switch

Fan switching positions are:

Auto: Normal setting for most homes. A single-speed fan turns on automatically with the air conditioner or furnace. A two-speed fan usually runs on high with the air conditioner and runs on low with the furnace.

On: Fan runs continuously. Use for improved air circulation during special occasions or for more efficient electronic air cleaning.

Setting System Switch

System switching positions control thermostat operation:

Cool: Thermostat controls air conditioning system.

Off: Both heating and air conditioning systems are off.

Heat: Thermostat controls heating system.

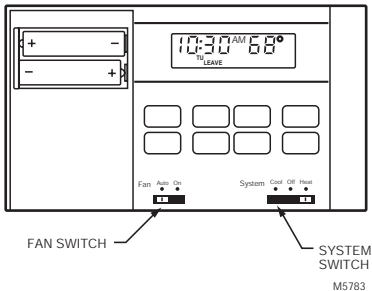

M5783

Maintaining Your Thermostat

Installing Batteries

IMPORTANT

Batteries must be installed for programming and operation of the thermostat and heating/cooling system.

1. Purchase two AA alkaline batteries; non-alkaline batteries do not last as long and can leak, causing damage to the thermostat or wall surface.
2. Make sure the thermostat is set in the Off position.
3. Use a coin to remove the battery door.
4. Install the fresh batteries, making sure the positive and negative terminals are oriented correctly.

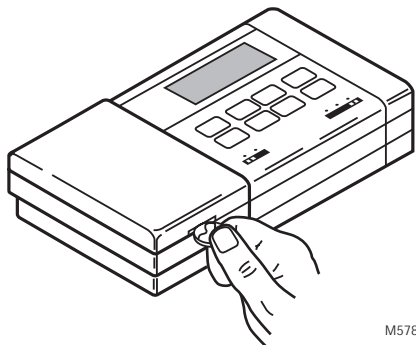

M5781

5. Replace the battery door.

As batteries are running low, bATLo indicator flashes for one to two months before batteries run out completely. Replace batteries as soon as possible after indicator starts flashing.

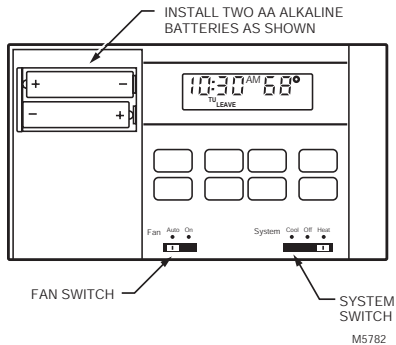

M5782

After batteries are completely dead, bATLo indicator disappears, leaving the display completely blank and the heating and/or cooling system not operating.

To remove batteries, press down on the left ends. If the new batteries are installed within 20 to 30 seconds of removing the old ones, the thermostat does not have to be reprogrammed.

If the display is blank, the batteries are dead or incorrectly installed and the thermostat has to be reprogrammed. See Programming Your Thermostat section for instructions.

Troubleshooting Guide

If...	Then...
Display does not come on.	<ul style="list-style-type: none">• Set the System switch to Off. Remove batteries. Insert backward for at least five seconds to reset thermostat. Correctly replace batteries. Display should come on.• Make sure batteries are fresh and installed correctly.• Gently clean battery contacts using a soft pencil eraser. Do not use anything abrasive on the clips.
Temperature display does not go lower than 45°F (7°C) or higher than 88°F (31°C) during programming.	<ul style="list-style-type: none">• The temperature setting limit is reached. The setting range is 45 to 88°F (7 to 31°C).
Temperature change occurs at the wrong times.	<ul style="list-style-type: none">• Check program times for the period in question. Be sure that AM and PM indications are correct. Make sure the current day and time are correct. Reprogram, if necessary.

If...	Then...
Heating does not come on.	<ul style="list-style-type: none"> • Check that System switch on thermostat is set to Heat. Allow a minimum of five minutes for time-guard protection to expire. • Check the system fuse or circuit breaker and replace or reset, if necessary. • If display is blank or displays bAtLo, install fresh batteries. • If temperature setting is higher than current temperature, and System On indicator is lit, contact your local dealer.
Cooling does not come on.	<ul style="list-style-type: none"> • Check that System switch on thermostat is set to Cool. Allow a minimum of five minutes for time-guard protection to expire. • Check the system fuse or circuit breaker and replace or reset, if necessary. • If display is blank or displays bAtLo, install fresh batteries.

If...	Then...
Cooling does not come on (Cont)	<ul style="list-style-type: none">• The thermostat has a built-in time delay on cooling. Allow at least five minutes after changing the setting before the air conditioner starts.• Make sure outdoor disconnect is engaged (on).• If temperature setting is lower than current temperature, and System On indicator is lit, move System switch from Cool to Off for ten minutes. After ten minutes, return switch to the Cool position. If the air conditioner comes on, the compressor could have reached its high-limit temperature protection and shut down. If air conditioner does not come on after ten minutes and the System On indicator is lit, contact your local dealer.• If two- or four-wire installation, verify that R-Rc jumper is installed.

If...	Then...
Too warm or too cool.	<ul style="list-style-type: none"> • Press Run Program key to check the current temperature setting. • If desired, change the temperature setting. See Programming Your Thermostat section.
System On indicator is lit, but no heat is coming from the registers.	<ul style="list-style-type: none"> • Allow time for the furnace to heat up and the fan to come on before checking for heat at the register.
Thermostat current temperature setting does not match the display temperature to within +/- 1°.	<ul style="list-style-type: none"> • Check that the wiring hole in the wall behind the wallplate was plugged with insulation to prevent drafts that could adversely affect thermostat operation. • Be aware that it is normal for the current setting and display temperature to differ occasionally. • During recovery from setback or setup, setting and display temperature can differ for up to 30 minutes after the recovery period.
Incorrect temperature showing on thermostat display.	<ul style="list-style-type: none"> • The thermostat is factory-calibrated and cannot be adjusted.

If...	Then...
bAtLo remains on display after fresh batteries are installed.	<ul style="list-style-type: none">• Remove the batteries. Wait one hour. Install fresh alkaline batteries.

NOTICE

This equipment is a Class B digital apparatus, which complies with Canadian Radio Interference Regulations, CRC c.1374.

Limited One-Year Warranty

Honeywell warrants this product to be free from defects in the workmanship or materials, under normal use and service, for a period of one (1) year from the date of purchase by the consumer. If, at any time during the warranty period, the product is defective or malfunctions, Honeywell shall repair or replace it (at Honeywell's option) within a reasonable period of time.

If the product is defective,

(i) return it, with a bill of sale or other dated proof-of-purchase, to the dealer or contractor where you purchased it, or

(ii) package it carefully, along with proof-of-purchase (including date of purchase) and a short description of the malfunction, and mail it, postage prepaid, to the following address:

In the U.S:

Honeywell Return Goods, Dock 4, MN 10-3860,
1985 Douglas Drive, Golden Valley, MN 55422.

In Canada:

Honeywell Limited/Honeywell Limitée
35 Dynamic Drive, Scarborough, Ontario M1V 4Z9

This warranty does not cover removal or reinstallation costs. This warranty shall not apply if it is shown by Honeywell that the defect or malfunction was caused by damage which occurred while the product was in the possession of a consumer.

Honeywell's sole responsibility shall be to repair or replace the product within the terms stated above. HONEYWELL SHALL NOT BE LIABLE FOR ANY LOSS OR DAMAGE OF ANY KIND, INCLUDING ANY INCIDENTAL OR CONSEQUENTIAL DAMAGES RESULTING, DIRECTLY OR INDIRECTLY, FROM ANY BREACH OF ANY WARRANTY, EXPRESS OR IMPLIED, OR ANY OTHER FAILURE OF THIS PRODUCT. Some states do not allow the exclusion or limitation of incidental or consequential damages, so this limitation may not apply to you.

THIS WARRANTY IS THE ONLY EXPRESS WARRANTY HONEYWELL MAKES ON THIS PRODUCT. THE DURATION OF ANY IMPLIED WARRANTIES, INCLUDING THE WARRANTIES OF MERCHANTABILITY AND FITNESS FOR A PARTICULAR PURPOSE, IS HEREBY LIMITED TO THE TWO-YEAR DURATION OF THIS WARRANTY. Some states do not allow limitations on how long an implied warranty lasts, so the above limitation may not apply to you.

This warranty gives you specific legal rights; you may have other rights that vary from state to state.

If you have any questions concerning this warranty, please write Honeywell Customer Care, 1985 Douglas Drive North, Golden Valley, MN 55422 or call 1-800-468-1502.

Honeywell

Automation and Control Solutions

Honeywell International Inc.	Honeywell Limited-Honeywell Limitée
1985 Douglas Drive North	35 Dynamic Drive
Golden Valley, MN 55422	Scarborough, Ontario
	M1V 4Z9

69-0862—4 J.S. Rev. 10-04



Printed in U.S.A. on recycled paper containing at least 10% post-consumer paper fibers.

www.honeywell.com/yourhome