



User Manual

A01-A60 LED Lamp

LED + Wi-Fi REPEATER

Features

- Install like any other light bulb. Easy to setup and enjoy the extended Wi-Fi signal coverage evenly.
- Supports two Wi-Fi network mode: Access Point (AP) / Repeater
- Two build-in antennas for high throughput data exchange rate of maximum 300Mbps
- Compatible with most smart phones, tablets and computers that support Wi-Fi IEEE 802.11b/g/n standard at 2.4GHz.
- Remote LED lights ON/OFF and dimming control individually or by group
- Download the free Boost Android or iOS App to explore even greater functionality

Box Contents

- One A01-A60 Bulb
- User Manual
- Limited Written Express Warranty

Product Specifications

- Power Supply: 100~230V AC, 50/60Hz
- Lamp Socket: E27
- Power Consumption: 7.4W (LED + Wi-Fi Repeater), Peak 9W
- Operating Temperature: -20° C ~ +40° C
- Store Temperature: -40° C ~ +70° C

- Operating Humidity: $10\% \leq RH \leq 95\%$, Non condensation
- Atmospheric Pressure: 86kPa ~ 106kPa
- Colour: Neutral White
- Dimensions: 120mm (H) x Φ 60mm (Dia.)
- Weight: 290g (approx.)

LED Lights

- Power: 6 Watts
- Luminance: 470 lumens
- Light Beam Angle: 240 degrees
- Colour Temperature: 3000K - Warm White
- CRI: 80
- Dimming: Yes (Do not use with external or outside dimmers)

Wi-Fi Repeater

- Wi-Fi Standard: IEEE 802.11b/g/n
- Wi-Fi Transmitter Frequency Range: 2.412 - 2.484 GHz
- Power: 1.8 Watts (Standby), 2.8 Watts (Full load)
- 2T2R MIMO wireless technology
- Security Mode: 64/128 bit WPA-PSK/WPA2-PSK, WPA/WPA2
- Encryption Type: WEP64/WEP128/TKIP/AES
- Wi-Fi Transmitter power:
 - @ 802.11b: +20dBm (Max.)
 - @ 802.11g: +18dBm (Max.)
 - @ 802.11n: +15dBm (Max.)
- Wi-Fi Receiver power:
 - @ 802.11b: -89dBm
 - @ 802.11g: -81dBm
 - @ 802.11n: -71dBm
- Distance Range between Router and A01-PAR38 Bulb: 115 feet (near line of sight)

INSTALLATION INSTRUCTIONS

WARNING - TO REDUCE THE RISK OF ELECTRIC SHOCK, DO NOT REMOVE THE BACK COVER OR TAKE APART. THERE ARE NO SERVICEABLE PARTS INSIDE.

1. Before installing the Boost into an E27 light bulb socket, turn the light switch to the OFF position. (DO NOT USE WITH EXTERNAL OR OUTSIDE DIMMERS).
2. Screw the bulb into an E27 socket and turn the power on.
3. On the portable smart device (e.g. smartphone or tablet), make sure WLAN is turned on and has been connected to the wireless router with a proper passport.
4. Search for the “boost by Sengled” for corresponding operating system, download and install it on a portable smart device:
Get App from Google Play Store for Android Devices;



5. Launch the boost by Sengled application, and a 'Welcome' page appears. At the beginning, press the "network" tab to initialize boost A01-PAR38 bulb's configuration. After that, click the “START” button to enter the configuration and control interface of the bulb/s.

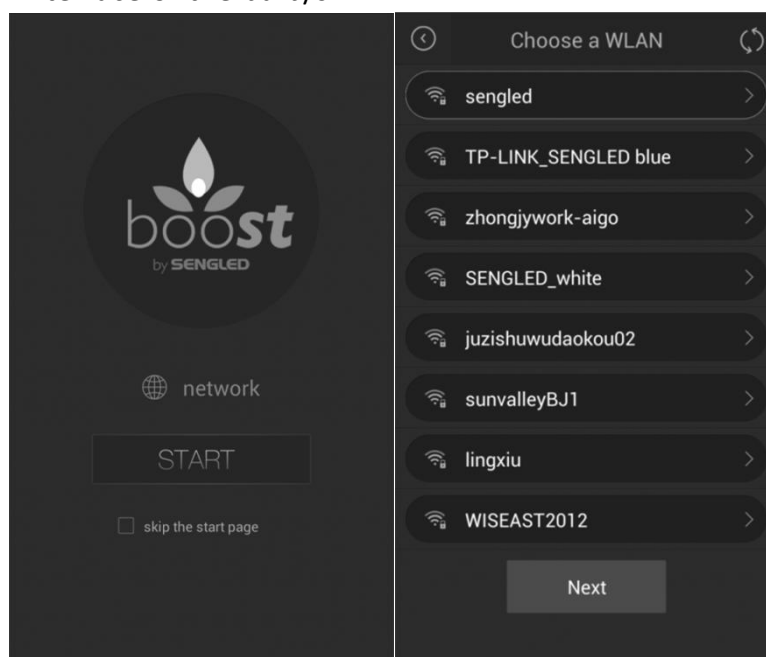

6. The App will search and list out nearby available wireless router/s automatically. Choose one of the routers as the root router. Type in the Access Password and press “Next” to move forward.

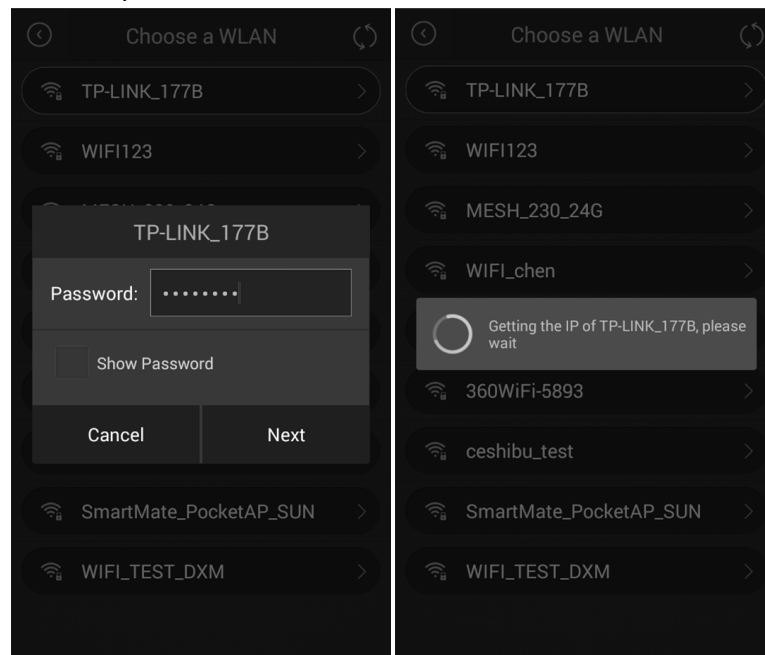

7. Input the access password which is as the router Wi-Fi router, click “Next” to enter the Next step. At this point, APP will send multicast to make the lamp of the Factory Settings is connected to the root router, and the program will search out these lamps. The names of these lamps apply their MAC address the name of the last two as a suffix, and display them on the interface for users to choose whether to access the network.

If there is no any equipment, please check if the lamp is powered on, and click the refresh button to try again.

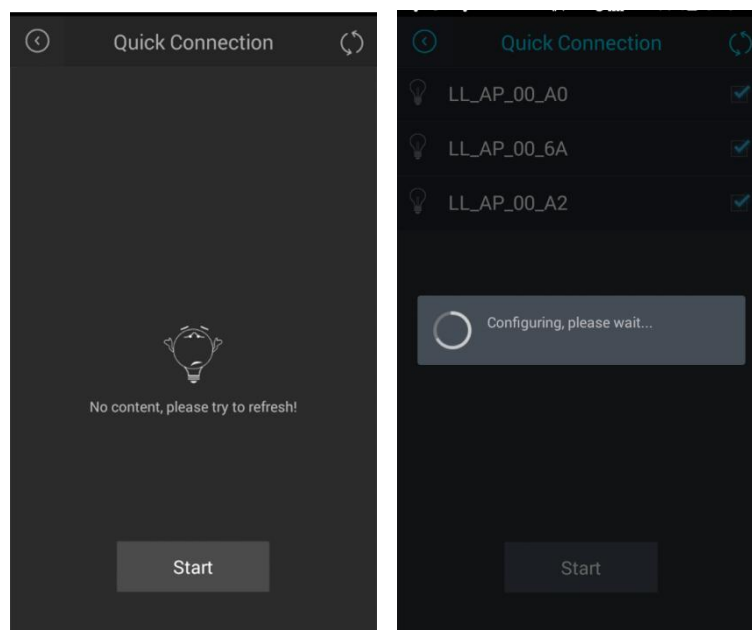

8. The App will also search and list out nearby available boost A01-PAR38 bulb/s. The default SSID of the bulb is "SENGLED_AP". (ATTENTION: Figure shows below, SSID Name of "LL_AP_00_**" only for engineering samples demo).

Press the "Start" tab for configuring all chosen boost A01-PAR38 bulbs. And the lamps which are not chosen restore to the initial state of factory Settings. If the root router is encrypted, the initialized bulb is also encrypted with a default password of "12345678". Input the bulb password and wait for the configuration process complete.

9. After the process of bulb network configuration has been succeeded, boost A01-PAR38 bulb/s will reboot (THIS PROCESS MAY TAKE FEW MINUTES, PLEASE BE PATIENCE). Press "Done" and return to the home page. If the configuration failed, refresh the configuration to networking again.
10. The App begins to search the configured online LED bulb/s. (SINCE THE BULB REBOOT PROCESS MAY TAKES FEW MINUTES, PLEASE BE PATIENCE AND REFRESH THE LIST FROM TIME TO TIME). After searching out all configured bulbs, the interface shows a Main Control Page. This can be used to control the overall LED light dimming and ON/OFF.

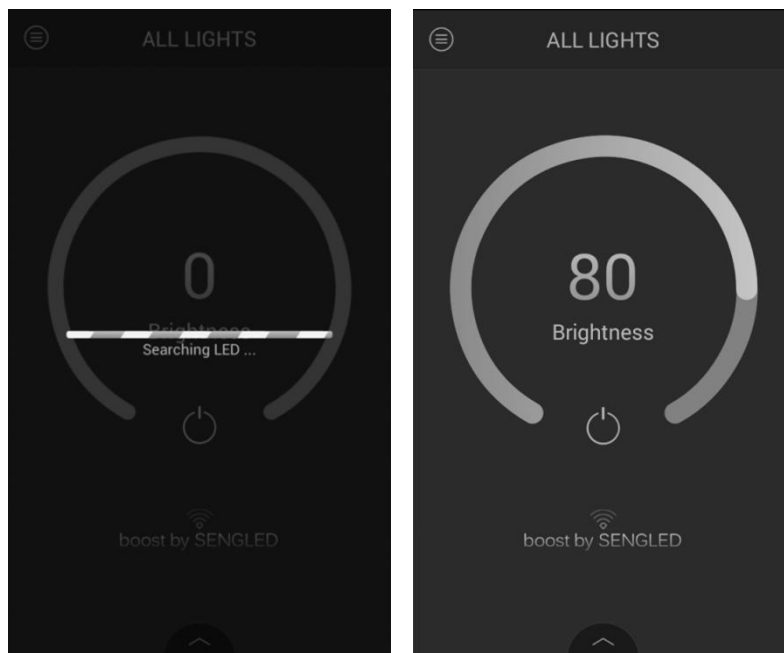

11. To control the LED bulb individually, pull up the bulb list at the bottom, each bulb can be dimmed separately. Click the arrow on the right, and it goes to the bulb wireless network configuration page. Main page shows that adjust total brightness. The list displays the brightness

of each lamp. The actual brightness is the brightness of each lamp multiplied by the percentage of the total brightness.

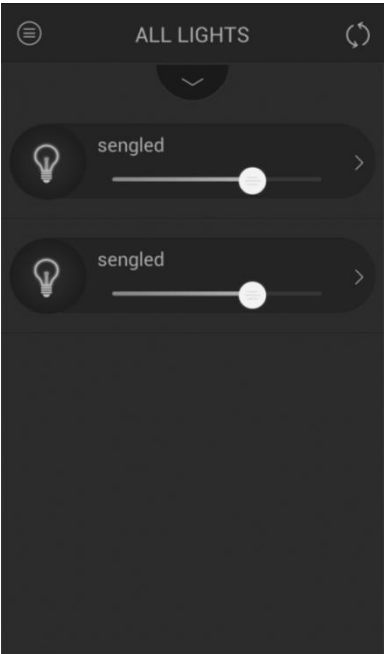

12. Lamp configuration page is read-only mode by default as shown in the following figure. If need editing the lamp information, click the edit button at top right corner, and enter the lamp password to edit mode.

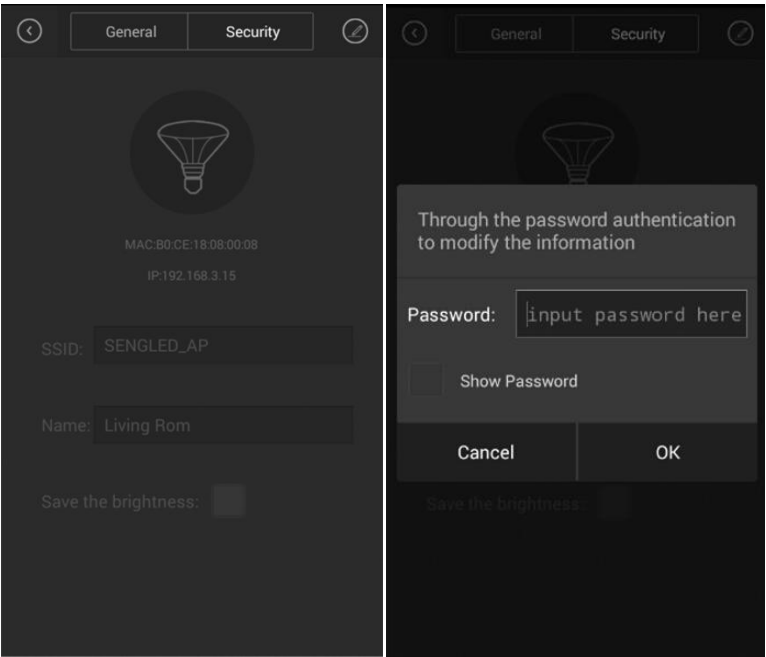

Enter the edit mode, basic setup can modify the SSID, the Name of the light, and set the brightness which the lamp is in power memory last time, so as to recover after the next to electricity save.

Security Settings change the lamp encrypted and password. Security Settings page has a button "Removed from the network" which is used to light restore to

factory Settings and removed from the network. Users can use this button to restore the default lights to networking again.

Under the 'General' tab, the wireless network parameters of the bulb are listed (such as MAC address). User can change bulb's SSID (listed on the WLAN table, visible name to public), or Name (listed on the boost by Sengled App) to a more meaningful name, such as "Living Room AP" or "Living Room Wi-Fi". Press "Apply" to active such changes.

Under the 'Security' tab, user can change the Encryption Mode, or change the bulb access Password. Press "Apply" to active such changes.

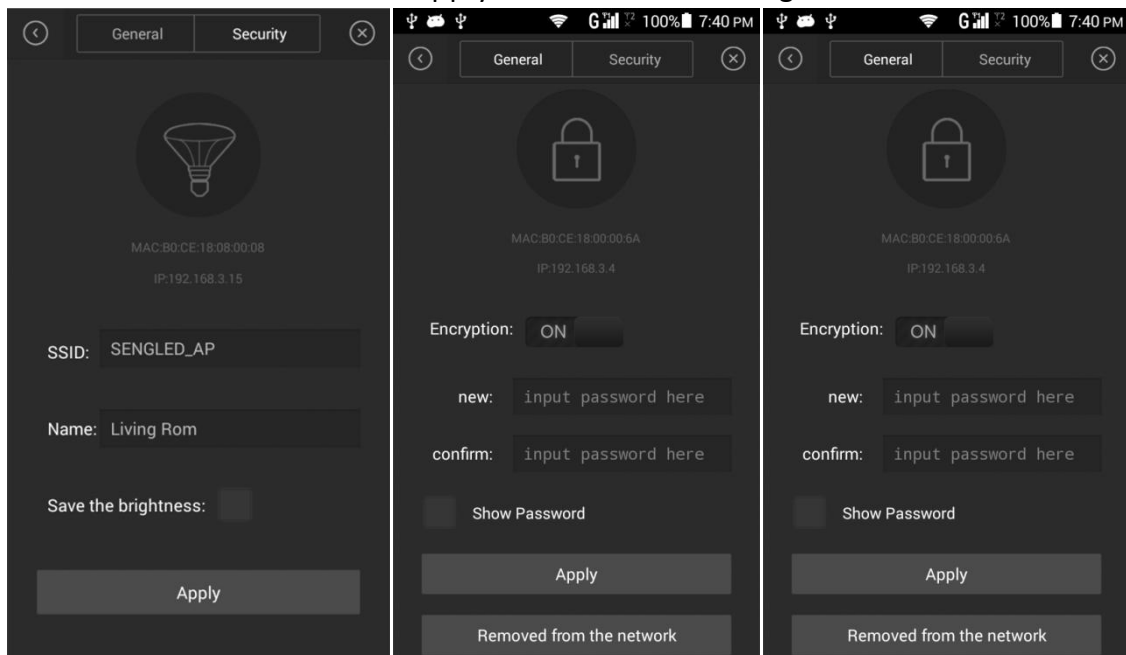

13. If re-configuration of the wireless network is needed, press the Setting Menu button on the Main Control Page and click the "Network" tab. Re-initialize all bulbs on the network and start setup wizard again.

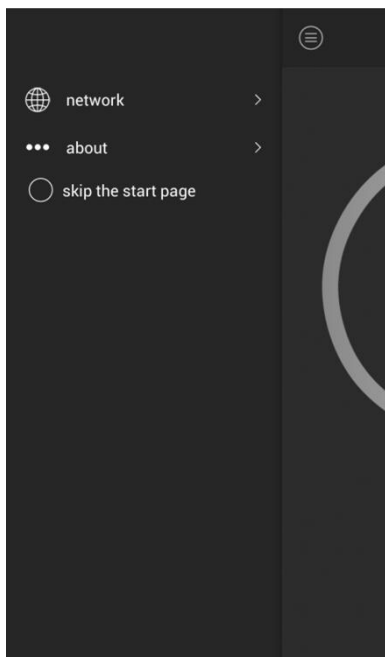

14. If the bulb cannot be detected by the portable smart devices or App in any ways, user can press the physical RESET button to reset the configuration of the bulb (in the middle of the LED lens), as shown below.

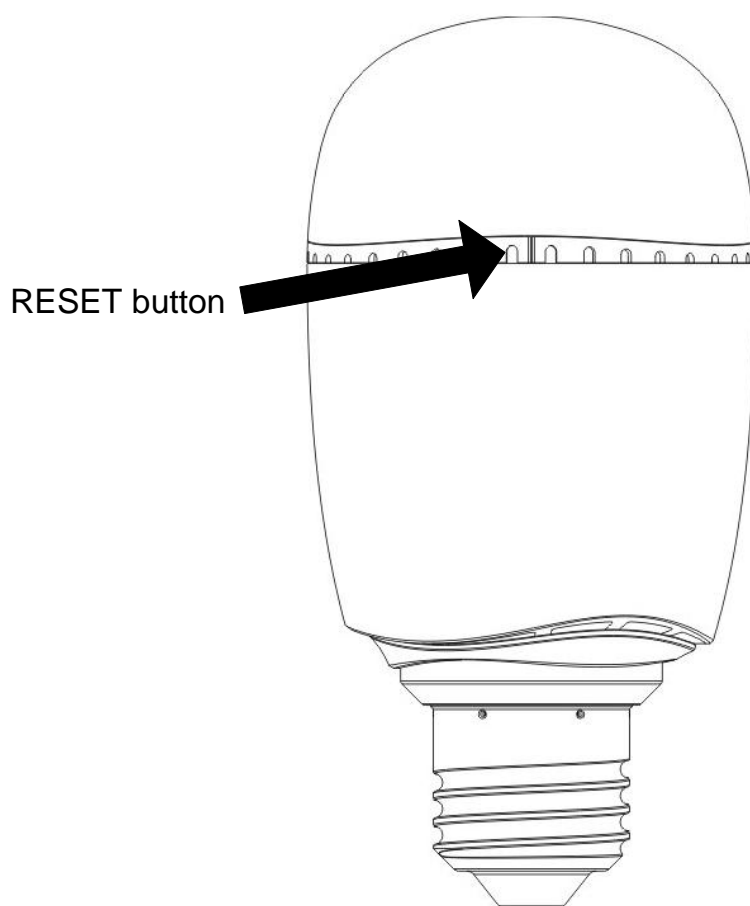

IMPORTANT SAFETY INSTRUCTIONS



- Read and keep these safety instructions.
- Heed all warnings contained within these instructions.
- Please follow all user manual instructions when installing the product.
- Clean SENGLED product only with a dry towel.
- This Product is intended for indoor use only.
- Do NOT use this product outdoors.
- Do NOT get this product wet and do NOT use near any water source.
- The product should not be exposed to dripping or splashing liquids of any kind.
- Do not install the product near any heat sources, such as heater, radiators, stove, heat registers or other apparatus that produce heat.
- Ensure that the product is stable and secured in place during installation. If the product is dropped or falls out of the light socket, it may cause bodily harm.
- If the product is dropped or falls out of the light socket, it may be damaged. Please check the product for any visible damage.
- To reduce the risk of electric shock, do NOT remove the back cover or take apart. There are no serviceable parts inside.
- To prevent product failure, the bulb should only be installed in operating environments.
- Do not block any ventilation openings on the product.
- Never push any objects into the openings or slots on the product. Doing so may create an electric shock or fire hazard.
- Maintain sufficient distance around your product for sufficient ventilation, do not put anything within at least 6 inches of lightbulb socket.
- For best protection against lightning, unplug the product from its power source during a storm.
- Only use accessories specifically recommended by the manufacturer.
- Refer all servicing to qualified SENGLED service technician.
- Servicing is required when the product:
 - 1) has been damaged in any way;
 - 2) liquid has been spilled on the product;
 - 3) objects have fallen into the product;
 - 4) the product has been exposed to rain or moisture,
 - 5) the product does not operate normally, or has been dropped.
- Repairs must be performed by a qualified SENGLED technician.
- For bulb with a weight significantly higher than that of the bulbs for which they

are a replacement, the increased weight may reduce the mechanical stability of certain luminaires and bulb holders and may impair contact making and bulb retention. Check that all sockets and bulb holders frequently and make sure they are secure and stable.

- The bulb can be hot and should not be touched without taking care.

CAUTION: NOT FOR USE IN EMERGENCY LIGHTING.

SUITABLE FOR DAMP LOCATIONS.

ENSURE FIXTURE CAN SUPPORT ADDED WEIGHT OF BULB.

FCC STATEMENT FOR USERS

This device complies with part 15 of the FCC Rules. Operation is subject to the following two conditions:

- (1) This device may not cause harmful interference, and
- (2) this device must accept any interference received, including interference that may cause undesired operation.

SECTION 15.21

The user's manual or instruction manual for an intentional or unintentional radiator shall caution the user that changes or modifications not expressly approved by the party responsible for compliance could void the user's authority to operate the equipment. In cases where the manual is provided only in a form other than paper, such as on a computer disk or over the Internet, the information required by this section may be included in the manual in that alternative form, provided the user can reasonably be expected to have the capability to access information in that form.

FEDERAL COMMUNICATION COMMISSION INTERFERENCE STATEMENT, SECTION 15.105(b)

This equipment has been tested and found to comply with the limits for a class B digital device, pursuant to part 15 of the FCC Rules. These limits are designed to provide reasonable protection against harmful interference in a residential installation. This equipment generates, uses and can radiate radio frequency energy and, if not installed and used in accordance with the instructions, may cause harmful interference to radio communications. However, there is no guarantee that interference will not occur in a particular installation. If this equipment does cause harmful interference to radio or television reception, which can be determined by turning the equipment off and on, the user is encouraged to try to correct the interference by one or more of the following measures:

- Reorient or relocate the receiving antenna.
- Increase the separation between the equipment and receiver.
- Connect the equipment into an outlet on a circuit different from that to which the receiver is connected.
- Consult the dealer or an experienced radio/TV technician for help.

RF RADIATION EXPOSURE WARNING

This equipment must be installed and operated in accordance with provided instructions and the antenna(s) used for this transmitter must be installed to provide a separation distance of at least 20 cm from all persons and must not be co-located or operated in conjunction with any other antenna or transmitter. End-users and installers must be provided with antenna installation instructions and transmitter operating conditions to satisfy RF exposure compliance.