



VAPORIZER INSTRUCTION MANUAL

WARNINGS

- This item gets hot! Exercise caution when operating. Keep out of reach of children.
- Do not operate the PUFFIT™ with heating chamber empty!
- Do not operate the PUFFIT™ with heating chamber cap removed!
- Always allow the PUFFIT™ to cool before putting it away!
- Do not use Liquids, gels or concentrates in the PUFFIT™
- Do not clean with sharp or hard objects!
- Only charge the PUFFIT™ with an approved USB supply (5V 500mA DC)
- Do not submerge or clean the PUFFIT™ with running water!
- Do not leave the PUFFIT™ "On" for prolonged periods (mouthpiece cap removed). Doing so can damage the battery and void your Warranty. Always replace the mouthpiece cap after use!

WARRANTY

Your PUFFIT™ is covered by a limited replacement warranty against manufacturing defects for a period of 1 year from date of purchase. The battery is covered for a period of 90 days from date of purchase. Consumers are required to register their purchase of a PUFFIT™ with Lilly Rucky Ltd after purchase, please see contact information below. For warranty replacement please return your PUFFIT™ to point of purchase. Lilly Rucky Ltd. reserves the right to final determination of validity of all warranty claims.

The PUFFIT™ Vaporizer Package Contents

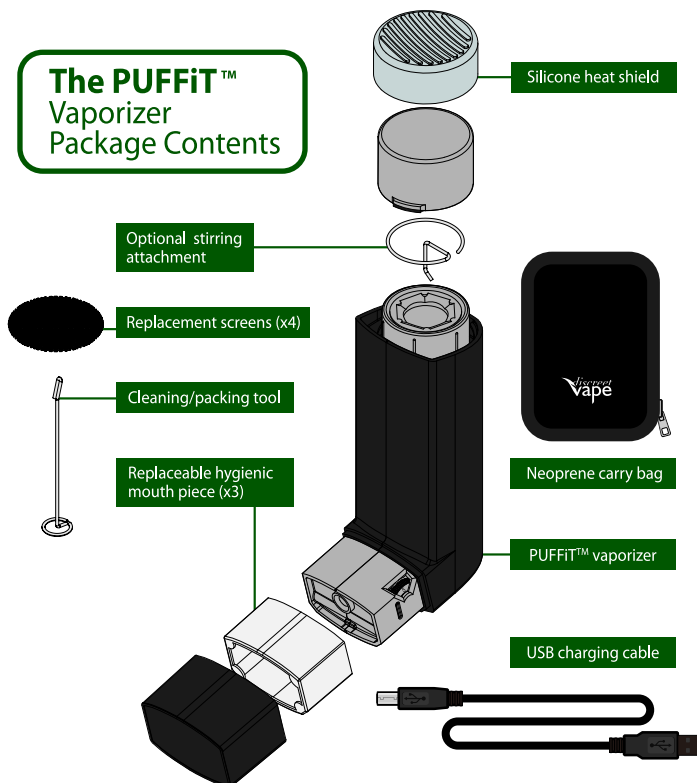

TERMS OF USE

The PUFFIT™ is not a medical device; Lilly Rucky Ltd. makes no claims as to the therapeutic value of its use. Lilly Rucky Ltd. assumes no responsibility for personal harm or property damage resulting from the improper or illegal use of this device, nor can we recommend its use with materials other than harmless dried herbs and flowers.

FCC WARNING

This device complies with part 15 of the FCC Rules. Operation is subject to the following two conditions:
1. This device may not cause harmful interference, and 2. This device must accept any interference received, including interference that may cause undesired operation.

This equipment has been tested and found to comply with the limits for a Class B digital device, pursuant to Part 15 of the FCC Rules. These limits are designed to provide reasonable protection against harmful interference in a residential installation. This equipment generates, uses and can radiate radio frequency energy and, if not installed and used in accordance with the instructions, may cause harmful interference to radio communications. However, there is no guarantee that interference will not occur in a particular installation. If this equipment does cause harmful interference to radio or television reception, which can be determined by turning the equipment off and on, the user is encouraged to try to correct the interference by one or more of the following measures:

- Reorient or relocate the receiving antenna.
- Increase the separation between the equipment and the receiver.
- Connect the equipment into an outlet different from that to which the receiver is connected.

CONTACT

Lilly Rucky Ltd.
Suite 805, 50 Hoi Yuen Road
Kwun Tong, Kowloon
Hong Kong
Phn: 852-5633-3003
info@discreetvape.com

ATTENTION !

THE PUFFIT™ IS NOT A MEDICAL DEVICE!

IT IS NOT INTENDED TO DIAGNOSE, TREAT, CURE OR PREVENT ANY AILMENTS, DISEASES OR OTHER CONDITIONS. IF YOU HAVE ANY HEALTH PROBLEMS CONSULT A HEALTH CARE PROFESSIONAL BEFORE USING. THE PUFFIT™ IS NOT INTENDED TO ADMINISTER CONTROLLED MEDICINAL OR ILLEGAL PRODUCTS OF ANY KIND AND IS NOT INTENDED FOR USE WITH ANY SUBSTANCE THAT MAY AFFECT THE STRUCTURE OR ANY FUNCTION OF THE BODY.

www.discreetvape.com

Copyright © Lilly Rucky Ltd. All rights reserved 2012





VAPORIZER INSTRUCTION MANUAL

USE

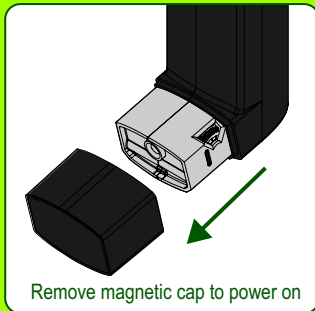

Remove magnetic cap to power on

Tips! Always replace the mouthpiece cap after use!

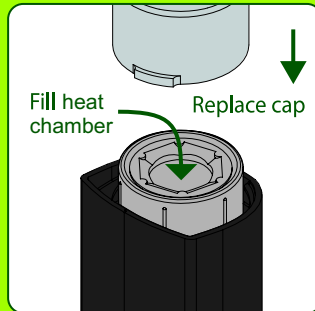

Fill heat chamber Replace cap

Tips! For best results use only finely ground dry blend, firmly packed.

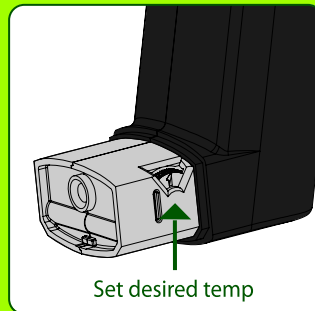

Set desired temp

Tips! If you are unsure of your blend's vapor temperature start on a low setting.

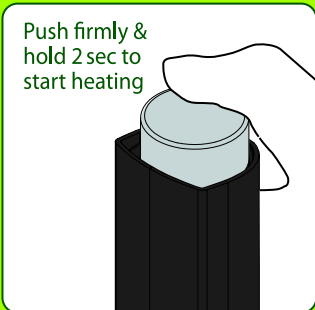

Push firmly & hold 2 sec to start heating

Tips! Be sure to keep the area around the heating chamber clean and free of debris.

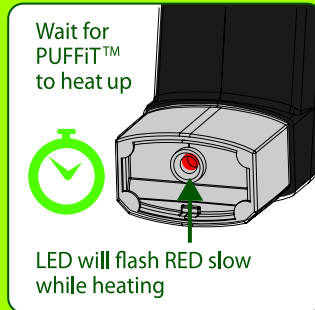

Wait for PUFFIT™ to heat up

LED will flash RED slow while heating

Tips! When the LED turns GREEN your PUFFIT™ is up to temperature.



Enjoy your vapor

Tips! Draw slowly for best flavor. Do not inhale! The PUFFIT™ will return to standby mode after 15 seconds.

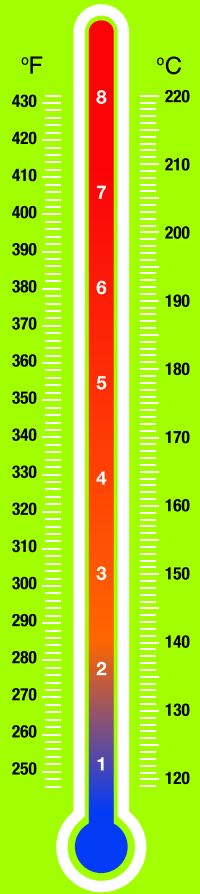

LED INDICATOR CYCLE

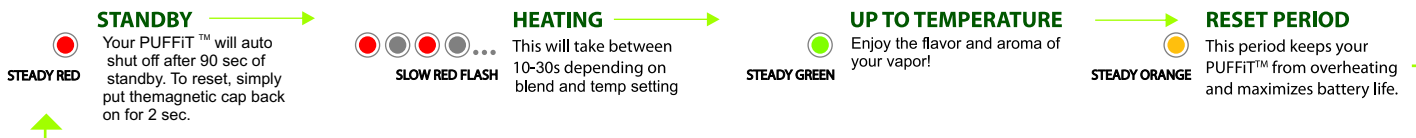

LED TROUBLESHOOTING

- HERB CHAMBER CAP SWITCH IS STUCK**
RAPID RED/GREEN FLASH Make sure there is no debris caught under the cap It should move freely, and make a slight "Click" sound when pushed.
- LOW BATTERY**
RAPID RED FLASH Connect your PUFFIT™ to a USB source for charging.
- ERROR**
RAPID ORANGE FLASH Please contact customer service.

CHARGING

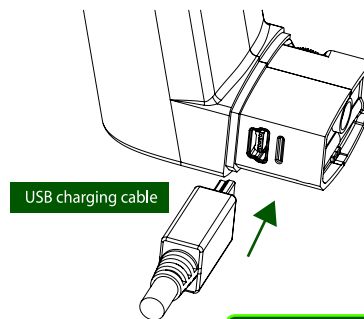

To recharge your PUFFIT™ simply plug It into a standard USB source. The LED will blink slowly green while charging and will go out when finished.

Tips! Anytime you're not using your PUFFIT™ then plug It In! This will maximize your battery's life.

Tips! After charging your PUFFIT™ will go into low power mode. To reset, simply put the magnetic cap back on for 2 sec.

Tips! Charge Level Indicator:
To get an approximate indication of battery level, click the Aluminum top cap 3 times. The LED will go out for 1 sec and then indicate approx. level ● ~ 80% ● ~ 60% ● < 30%

For more hints and tips, including cleaning instructions look for us on:



ATTENTION !

THE PUFFIT™ IS NOT A MEDICAL DEVICE!
IT IS NOT INTENDED TO DIAGNOSE, TREAT, CURE OR PREVENT ANY AILMENTS, DISEASES OR OTHER CONDITIONS. IF YOU HAVE ANY HEALTH PROBLEMS CONSULT A HEALTH CARE PROFESSIONAL BEFORE USING. THE PUFFIT™ IS NOT INTENDED TO ADMINISTER CONTROLLED MEDICINAL OR ILLEGAL PRODUCTS OF ANY KIND AND IS NOT INTENDED FOR USE WITH ANY SUBSTANCE THAT MAY AFFECT THE STRUCTURE OR ANY FUNCTION OF THE BODY.

www.discreetvape.com

Copyright © Lilly Rucky Ltd. All rights reserved 2012

