



DAELIM TRADING CO., LTD.

www.dobidos.co.kr

Warranty Included

DOBIDOS
DAELIM
DB-3001/3002/3003

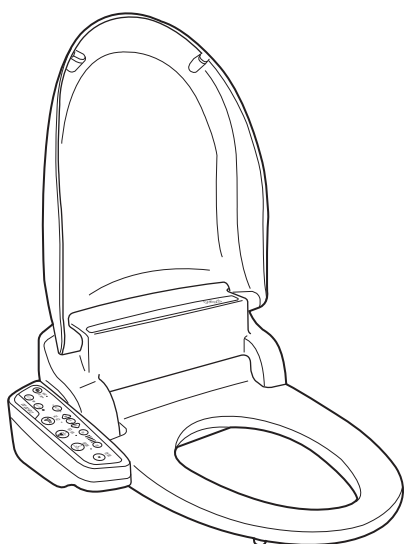

Make sure to follow the cautions of installation and use manual.
We recommend you taking enough care, as we may not be responsible for the accidents caused from inadequate uses. Please, keep this manual in a proper place, as the manual includes Warranty.

DOBIDOS

DAELIM

Installation and Use Manual

- Thank you very much for purchasing Daelim Bidet DOBIDOS.
Please read through the manual for appropriate use of the product.
- After you read through the manual, keep it in a proper place for the users.

1	Cautions for Safety	7
2	Cautions for Usage	11
3	Names of Parts	12

4	Preparations and Confirmations before Installation	13
	● Precautions	13
	● Components	13
	● Procedure of Product Installation	14
	Preparation before Product Installation	14
	Installing Kohler type toilet bowl	15
	Connecting Water Hose	15
	Trial and Confirmation	16

5	Preparations and Confirmations before Use	17
6	Operating Method	18
	● Wash, Bidet, and Stop Function	18
	● Water Temp, Seat Temp, ECONO	19
	● Water Pressure/Dry Temp	20
	● Drying and Seat Sensor	21
	● Nozzle Adjustment and Massage	21

7	Cleaning Procedure	22
	● Cleaning the Product	22
8	If the Product is not Used for a Long Time	23
9	Self Diagnosis and Trouble shooting	24
10	Specifications	25
	● Warranty	

WARNING :

TO REDUCE THE RISK OF FIRE OR ELECTRIC SHOCK, DO NOT EXPOSE THIS PRODUCT TO RAIN OR MOISTURE. DO NOT INSERT ANY METALLIC OBJECT THROUGH VENTILATION GRILLS.

CAUTION :

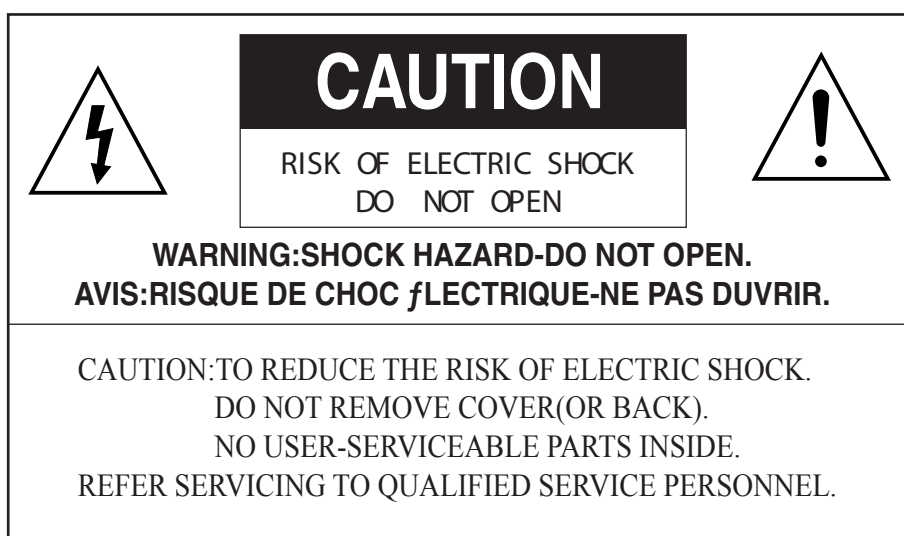

Explanation of Graphical Symbols

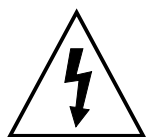

The lightning flash with arrowhead symbol, within an equilateral triangle, is intended to alert the user to the presence of uninsulated “dangerous voltage” within the product's enclosure that may be of sufficient magnitude to constitute a risk of electric shock to persons.



The exclamation point within an equilateral triangle is intended to alert the user to the presence of important operating and maintenance (servicing) instructions in the literature accompanying the product.

IMPORTANT SAFEGUARDS

■ READ ALL INSTRUCTIONS BEFORE USING

DANGER

To reduce the risk of electrocution:

- 1) Always unplug this product immediately after using.
- 2) Do not use while bathing.
- 3) Do not place or store product where it can fall or be pulled into a tub or sink.
- 4) Do not place in or drop into water or other liquid.
- 5) Do not reach for a product that has fallen into water. Unplug immediately

WARNING

To reduce the risk of burns, electrocution, fire, or injury to persons.

- 1) Close supervision is necessary when this product is used by, on, or near children or invalids.
- 2) Use this product only for its intended use as described in this manual.
Do not use attachments not recommended by the manufacturer.
- 3) Never operate this product if it has a damaged cord or plug, if it is not working properly, if it has been dropped or damaged, or dropped into water.
Return the product to a service center for examination and repair.
- 4) Keep the cord away from heated surfaces.
- 5) Never block the air openings of the product or place it on a soft surface, such as a bed or couch, where the air openings may be blocked.
Keep the air openings free of lint, hair, and the like.
- 6) Never use while sleeping or drowsy.
- 7) Never drop or insert any object into any opening or hose.
- 8) Do not use outdoors or operate where aerosol (spray) products are being used or where oxygen is being administered.
- 9) Unplug this product before filling. Fill (reservoir) with only unless otherwise specified by manufacturer.
Do not overfill (or specify filling instructions)

SAVE THESE INSTRUCTIONS

USER INSTRUCTION

- 1) Instruction and caution statements for cleaning, user maintenance, operations recommended by the manufacturer, such as lubrication or nonlubrication, and a warning to the user that any other servicing should be performed by authorized service representative or that the product has no user serviceable parts. The manual or other literature packaged with shall also indicate the product is for household use.
- 2) In the case of a product intended to be used with water, additives, conditioners, or other solutions with or without water, or a product that relies on the conductivity of water for normal operation (electrode type product), and for which the use of baking soda, salt, or other substances to improve the conductivity of the water is stipulated, specific instructions on the proper liquid or additive to use and the exact amount to be used in conjunction with the product.

GROUNDING INSTRUCTION

- 1) This product should be grounded. In the event of an electrical short circuit, grounding reduce the risk of electric shock by providing an escape wire for the electric current. This product is equipped with a cord having a grounding wire with a grounding plug.
The plug must be plugged into an outlet that is properly installed and grounded.

Danger - Improper use of the grounding plug can result in a risk of electric shock.

If repair or replacement of the cord or plug is necessary, do not connect the grounding wire to either flar blade terminal. The wire with insulation having an outer surface that is green with or without yellow stripes is the grounding wire.

Check with a quslified electrician or serviceman if the grounding instructions are not completely understood, or if in doubt as to whether the product is properly grounded.

- 2) This product is for use on a nominal 120 V circuit, and has a grounding plug that looks like the plug illustrated in sketch A in Figure 1. A temporary adapter, which looks like the adapter illustrated in sketches B and C, may be used to connect this plug to a 2-pole receptacle as shown in sketch B if a properly gorunded outlet is no available.
The temporary adapter should be used only until a properly grounded outlet (sketch A) can be installed by a qualified dectrician. The green colored rigid ear, lug, and the like extending from the adapter must be connected to a permanent ground such as a properly grounded outlet box cover. Whenever the adapter is used, it must be held in place by the screw.
- 3) If it is necessary to use and extension cord, use only a three wire extension cord that has a three-blade grounding plug. and a three-slot receptacle that will accept the plug on the product. Replace or repair a damaged cord.

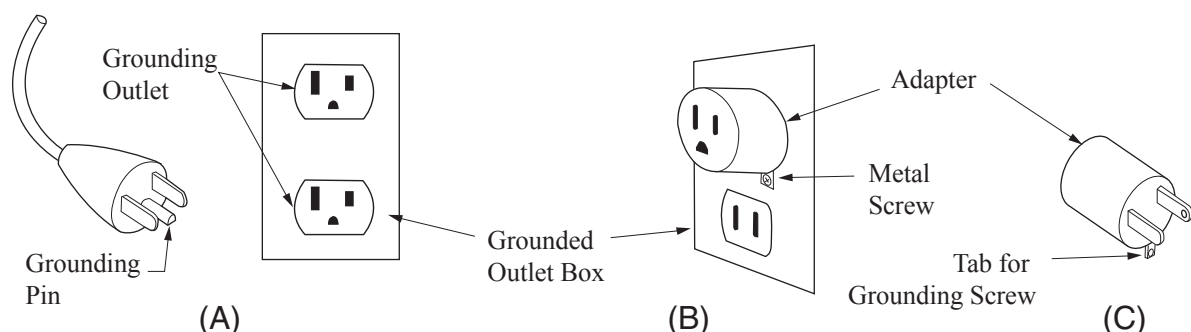

FCC COMPLIANCE STATEMENT

INFORMATION TO THE USER : THIS EQUIPMENT HAS BEEN TESTED AND FOUND TO COMPLY WITH THE LIMITS FOR A CLASS B DIGITAL DEVICE, PURSUANT TO PART 15 OF THE FCC RULES. THESE LIMITS ARE DESIGNED TO PROVIDE REASONABLE PROTECTION AGAINST HARMFUL INTERFERENCE IN A RESIDENTIAL INSTALLATION. THIS EQUIPMENT GENERATES, USES AND CAN RADIATE RADIO FREQUENCY ENERGY AND, IF NOT INSTALLED AND USED IN ACCORDANCE WITH THE INSTRUCTIONS MAY CAUSE HARMFUL INTERFERENCE TO RADIO COMMUNICATIONS. HOWEVER, THERE IS NO GUARANTEE THAT INTERFERENCE WILL NOT OCCUR IN A PARTICULAR INSTALLATION. IF THIS EQUIPMENT DOES CAUSE HARMFUL INTERFERENCE TO RADIO OR TELEVISION RECEPTION, WHICH CAN BE DETERMINED BY TURNING THE EQUIPMENT OFF AND ON, THE USER IS ENCOURAGED TO TRY TO CORRECT THE INTERFERENCE BY ONE OR MORE OF THE FOLLOWING MEASURES :

- REORIENT OR RELOCATE THE RECEIVING ANTENNA
- INCREASE THE SEPARATION BETWEEN THE EQUIPMENT AND RECEIVER
- CONNECT THE EQUIPMENT INTO AN OUTLET ON A CIRCUIT DIFFERENT FROM THAT TO WHICH THE RECEIVER IS CONNECTED
- CONSULT THE DEALER OR AN EXPERIENCED RADIO/TV TECHNICIAN FOR HELP



CAUTION : CHANGES OR MODIFICATIONS NOT EXPRESSLY APPROVED BY THE MANUFACTURER COULD VOID THE USER'S AUTHORITY TO OPERATE THE EQUIPMENT.

THIS CLASS B DIGITAL APPARATUS MEETS ALL REQUIREMENTS OF THE CANADIAN INTERFERENCE-CAUSING EQUIPMENT REGULATIONS.



CET APPAREIL NUMÉRIQUE DE LA CLASSE B RESPECTE TOUTES LES EXIGENCES DU RÈGLEMENT SUR LE MATÉRIEL BROUILLER DU CANADA.

Use the product correctly, after you read through the cautions for safety. Positively abide by the cautions shown below, as they are important points related to safety.

- The marks and their meanings are shown below.

 Warning	<p>If this mark is ignored and the product is wrongfully used, a serious injury or death of the user may occur.</p>
 Caution	<p>If this mark is ignored and the product is wrongfully used, an injury or property damage of the user may occur.</p>

- The contents, which you are requested to follow, are classified with illustrated mark and explained as below.

Example of illustrated mark Description	Example of illustrated mark Description
 Disassembly Prohibited	<p>Indicated 'prohibition mark'. The figure shown to the left signifies 'Disassembly prohibited'</p>
 Compulsory Instruction	<p>Indicated 'compulsory mark'. The figure shown to the left signifies 'Compulsory instruction'</p>



Warning

Do not install in a damp place.

- That might cause a fire or an electric shock.



Water Splash Prohibited

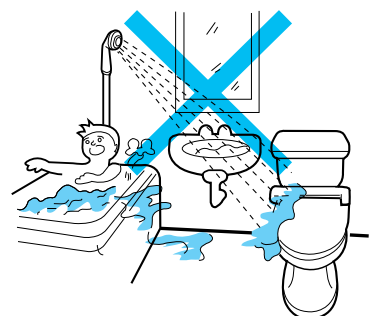



Warning

For protection against low temperature burn

- When the following person uses the warm seat or warm air dry, please make sure to configure the seat temperature to "room temperature" and drying air temperature to "low."



Compulsory Instruction

- Children, elderly or others, who are unable to adjust the temperature by themselves
- Patients, physically disabled persons or others, who cannot freely move themselves
- Persons who took medicines that cause sleep (sleeping pills, cold tablets, etc.), persons who had excessive drink, tired persons or others who may fall asleep.

- When sitting on the seat for a long time, set the seat temperature to 'room temperature' before use.

※ About Low Temperature Burns

A burn occurs when the skin has been exposed to high temperatures. However, a low temperature burn may occur when the skin has been in contact with an object at relatively low temperature (about 104°F [40°C]) (Susceptibility to burns also depends on an individual's skin sensitivity and other factors).

Check if the type-3 ground construction is implemented to the ground line.

- If the ground construction is not implemented, it might cause a breakdown or power leakage, followed by an electric shock. For the ground construction, contact the nearest electronic shop.



Earth Grounding



Remove dust and others from the power plug, and insert the power plug completely into the outlet.

- Pull out the power plug and clean it with a dry cloth.



Compulsory Instruction

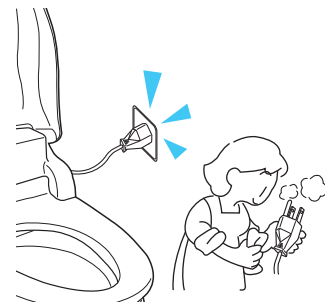

In case of exchanging the power cord, follow:

- If the power cord is damaged, contact the retail shop where you purchased the product, or the customer service center of the neighboring area.
- Only the manufacturer's sales agent and authorized technicians should replace the power cord.



Compulsory Instruction

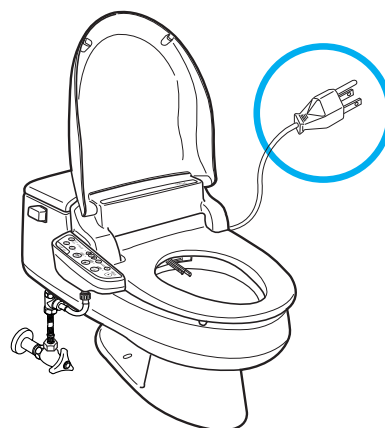

Only use on AC120V, 60Hz. Never put too much loads on one electrical outlet.

- That might cause a fire or overheat



Prohibited

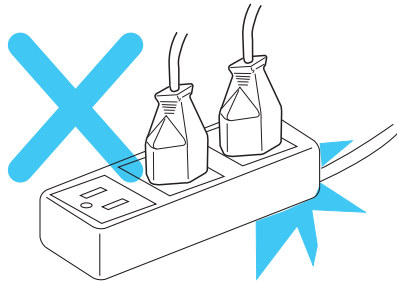

Do not use loose outlets.

- That might cause a fire or an electric shock.



Prohibited

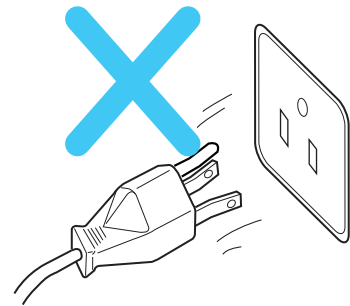

Do not use wet hands to insert/remove the power plug.

- That might cause an electric shock.



Wet Hands Prohibited

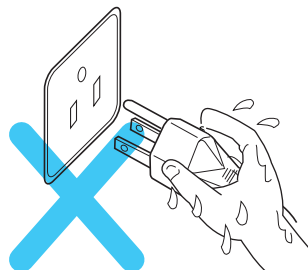

Make sure not to wet the power plug with water, detergent or urine.

- That might cause a fire or an electric shock.



Watering Prohibited

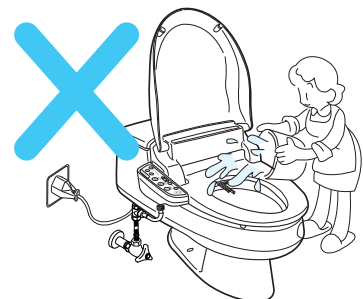

Do not handle the power plug/power cord roughly.

- That might cause a fire or an electric shock.



Prohibited

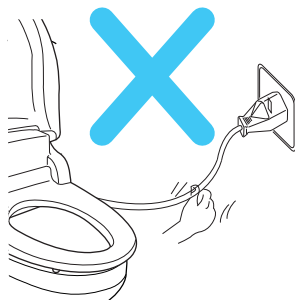

Make sure not to use industrial water for water supply.

- That might cause contamination to the skin.



Prohibited

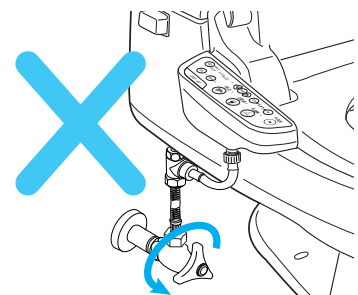

Do not disassemble, repair, and remodel the product.

- That might cause a fire or an electric shock.



Disassembling Prohibited



Pull out the power plug when cleaning the product.

- That might cause an electric shock.



Always Pull Out the Plug

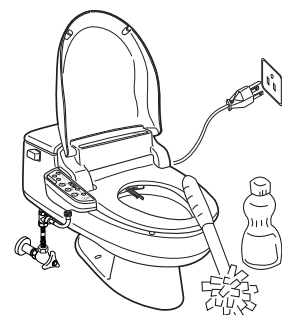



Caution

Do not place a stove/a cigarette close to the product.

- That might cause fire.



Inflammable
Products Prohibited

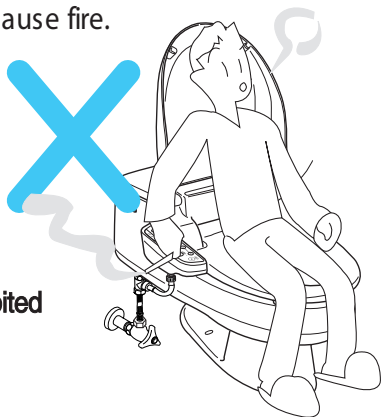

Do not bend or distort the hose line.

- That might cause water leakage.



Prohibited



Do not leave a heavy item on top of the seat, or the seat cover.

- That might cause injury due to dilapidation of product.



Prohibited

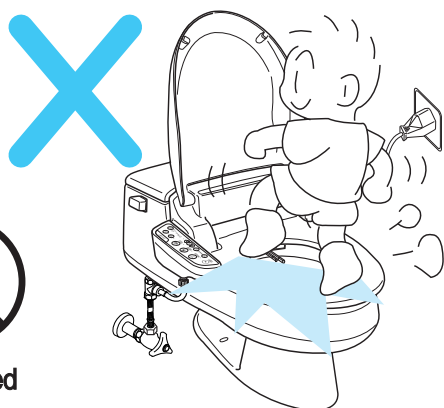

When cleaning the product use diluted kitchen detergent. Do not use the following

[detergent, benzene, painting thinner, cleaning power, nylon scrubbing brush, etc.]

- That might break the product, and cause injury due to the dilapidated plastic.



Prohibited

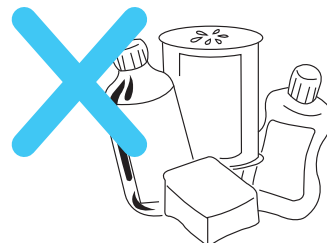

Do not insert fingers or others inside the warm air outlet.

- That might cause a burn or an electric shock.



Prohibited



Do not turn the product upside down.

- That might cause the product damaged.



Prohibited

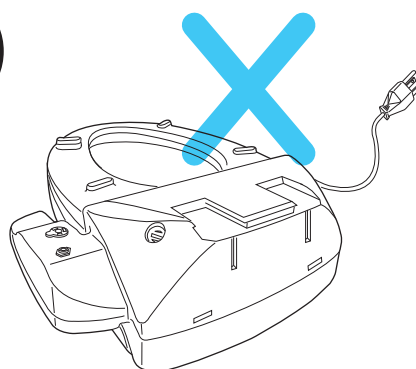

2

Cautions for Usage

Follow the next instructions

Do not expose the product in a direct sunlight.

- That might cause discoloration and make the temperature of the warm seat uneven.



Use products such as radios away from the DOBIDOS.

- That might cause interference to the radio.

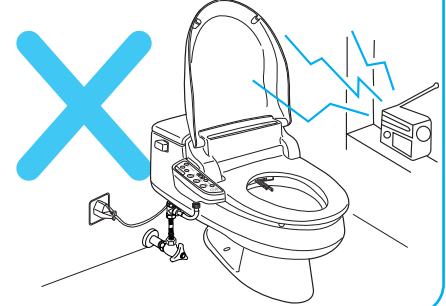

Drain existing water and pull out the power plug when not used for a long time.

- That might cause the water contaminated and skin inflammation.

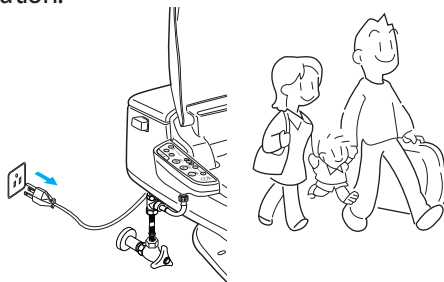

The temperature of the washroom should be above the freezing point.

- That might freeze the product. Warm up the washroom through heating or other ways.

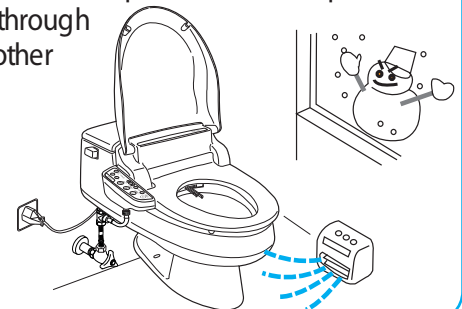

Do not lean against the cover during use.

- That might break/crack the seat cover.

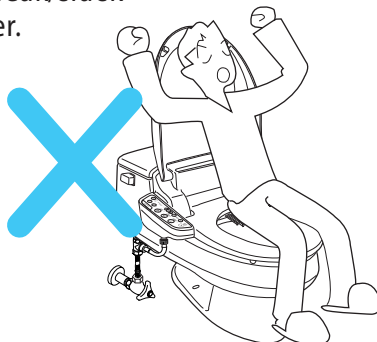

Do not use on a direct current or AC220V.

- That might cause a fire, short circuit and failure or damage.

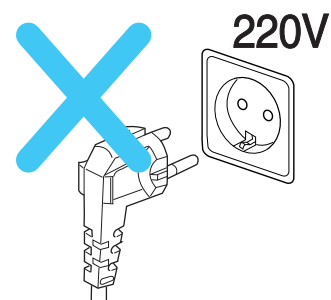

Pull out the power plug when thunder occurs.

- That might cause failure or damage.

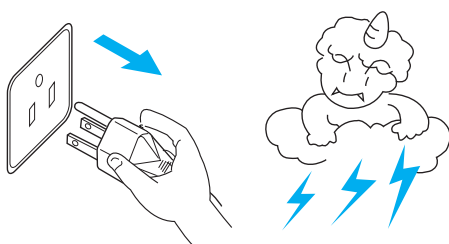

Do not urinate on the nozzle.

- That might cause failure or damage.

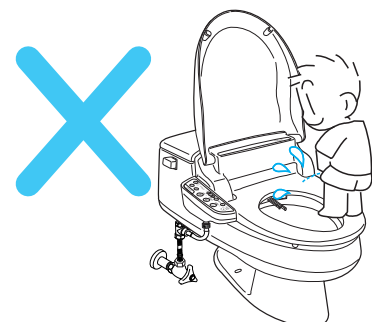

3 Names of Parts

Names of Parts

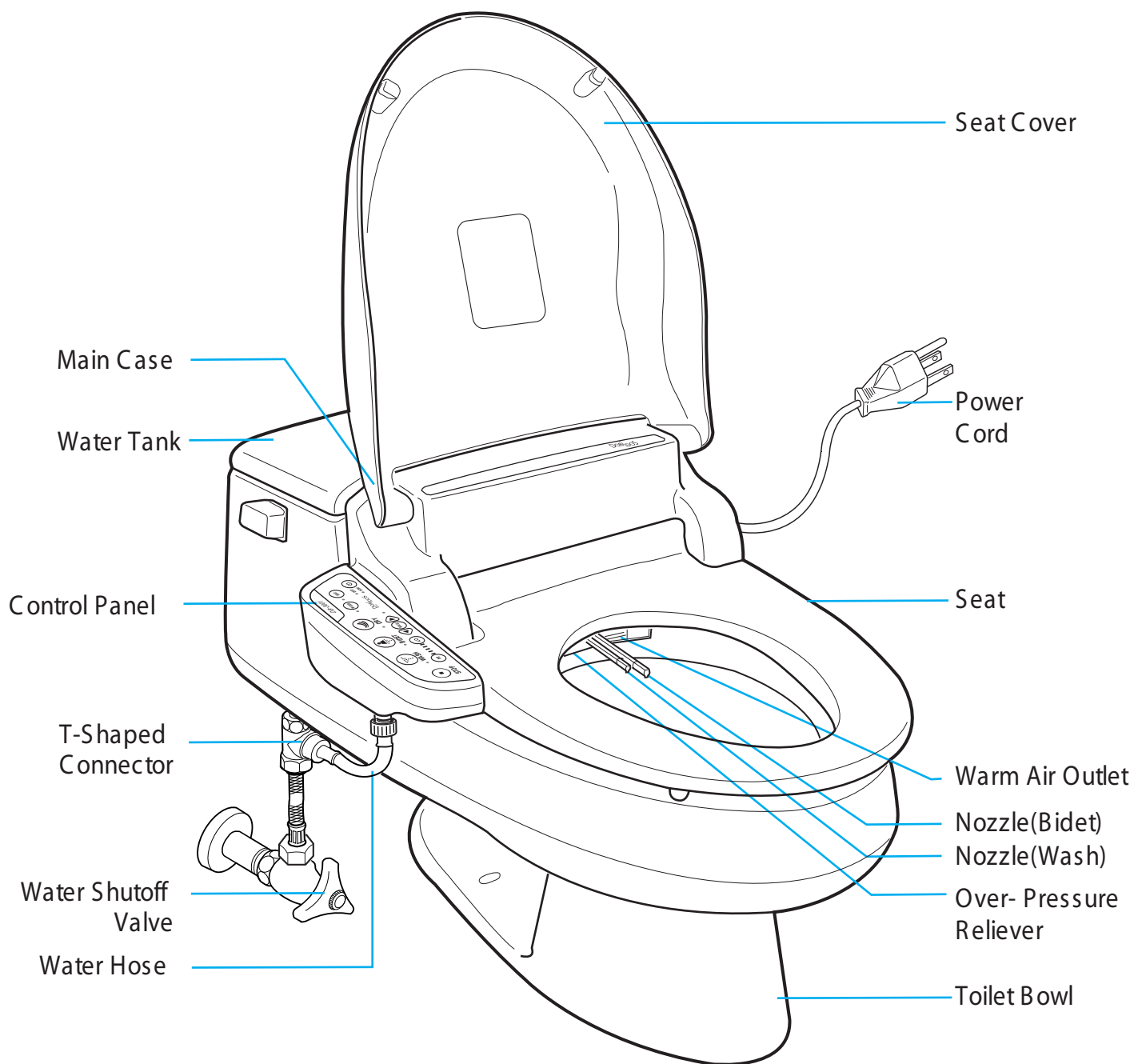

Model No. \ Funtion	BIDET/ WASH	Water Presure/ Dry Temp	Self Cleaner	Warm Seat	Massage	Nozzle Adjustment	Slow Down	Antibiotic Plastics to Nozzle	Seat Sensor	Power / Econo	Dry Funtion	Deo Funtion
DB-3001	⊙	⊙	⊙	⊙	⊙	⊙	⊙	⊙	⊙	⊙	⊙	⊙
DB-3002	⊙	⊙	⊙	⊙	⊙	⊙	⊙	⊙	⊙	⊙	⊙	
DB-3003	⊙	⊙	⊙	⊙	⊙	⊙	⊙	⊙	⊙	⊙		

4

Preparations before Installation

Please make sure you read the instructions carefully and install it properly.

Toilet dimensions

The toilet dimensions must be within those shown below. Do not install the DOBIDOS on a toilet that does not meet these dimensional requirements.

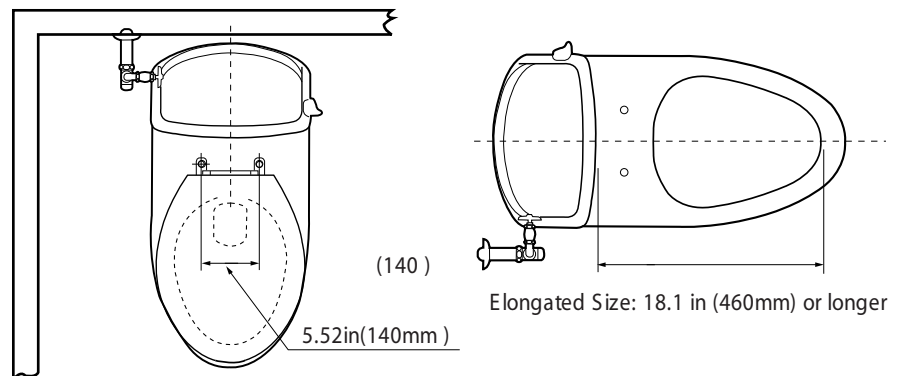

Precautions

1. The AC voltage is 120V (60Hz) and the consumption of electricity rate is 555W. Connect this product only to power sources specified in the instructions.
2. The length of the power cord is 47in (1.2m). The outlet should be near where the DOBIDOS can be installed and dismantled.
3. The water pressure limit is from 10 to 106.7 PSI (0.7 to 7.5 kgf/cm²). Please use as instructed.
4. The temperature of the water is from 37.4°F to 95°F (3°C to 35°C). Please use as instructed.
5. The length of the coupling pipe is 23.6in (0.6m). The water shutoff valve should be near where the DOBIDOS can be installed and dismantled.
6. After the product is installed, connect the AC power cord and supply the water.

Components

1. DOBIDOS

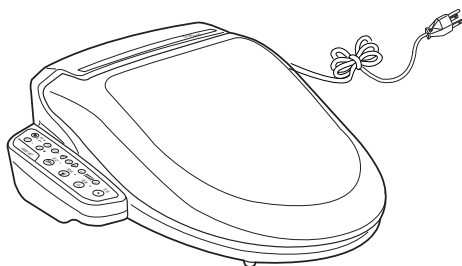

2. Fixing Components

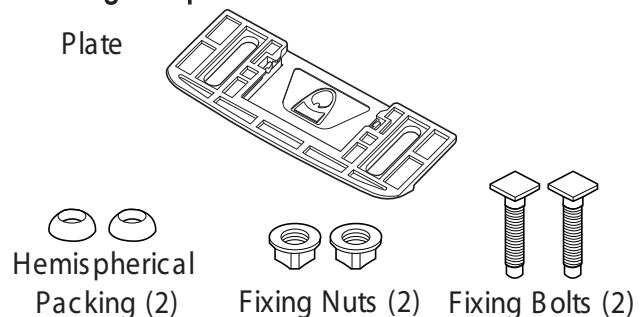

3. Installation Tool

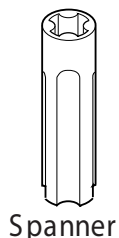

4. T-Shaped Connector

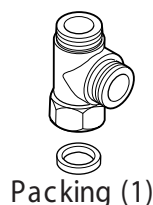

5. Water Hose (Including Packing)

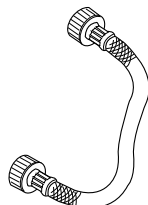

6. Installation and Use Manual (Including Warranty)



7. Optional Accessory (For Kohler-type bowl only)



※Contact the Customer Service Team or the dealer when installing the unit on the Kohler-type bowl

Procedure of Product Installation

Preparation before Installation

1. Remove the existing seat and seat cover.

Unfasten the two nuts that are holding the seat and seat cover to remove them.



2. Insert fixing bolts into the plate

Insert the fixing bolts into the plate as shown in the figure.

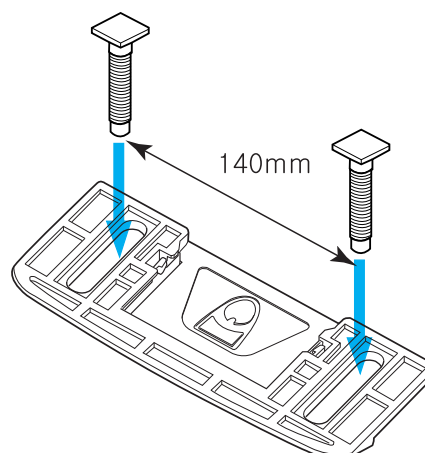

※ It can be installed to the bowl of which installation range of fixing bolt is at least 140mm

3. Fix the plate on the toilet bowl

Fasten the plate to the toilet bowl with the fixing bolts.

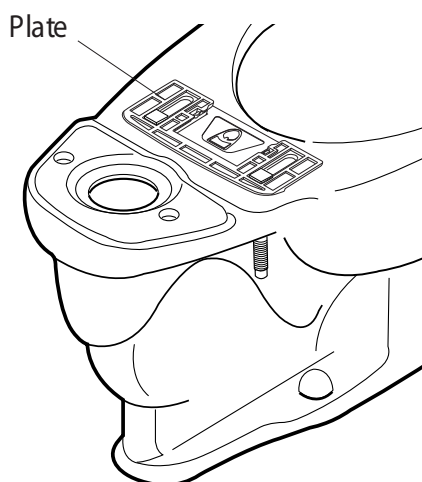

4. Mount the product

Mount the product on the plate and push it along the groove.

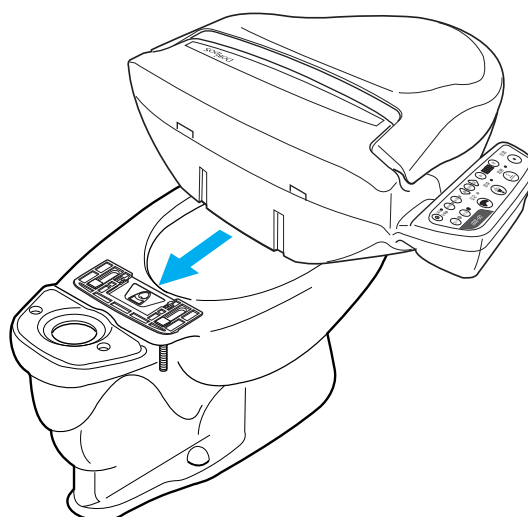

Prohibition

Do not lift the product with the seat cover and seat open.
(That might cause a mechanical trouble)



Prohibition

If there is a cut in the power cord and power plug or the outlet is loose, do not use the product.
(That might cause an electric shock or a fire.)

5. Installation place adjustment

Place the product on the toilet bowl and move it back and forth so that the front part of the seat extends beyond the front end of the toilet.

※ The fixing plate can slide forward/backward for about 45mm.

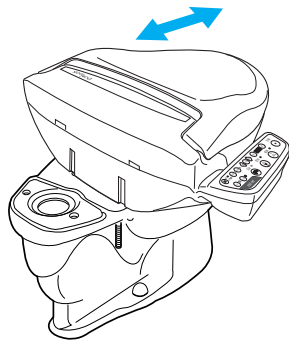

6. Fastening the product

After adjusting the product in the proper place, fasten it not to be tilted and moved.

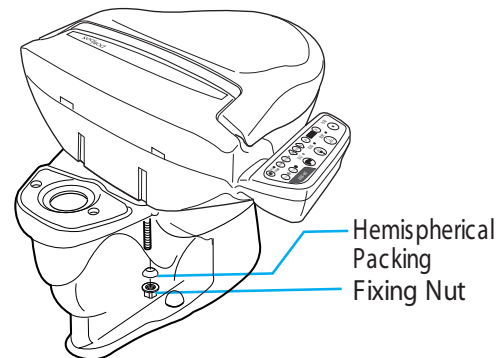

Installing Kohler type toilet bowl

1. Fix the plate on the toilet bowl

Fasten the plate to the toilet bowl with a sliding plate and fixing bolts.

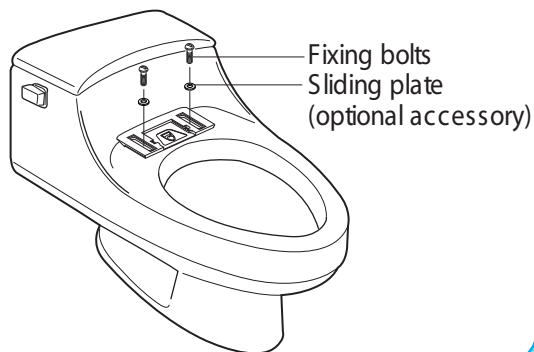

2. Mount the product

Mount the product on the plate and push it along the groove.

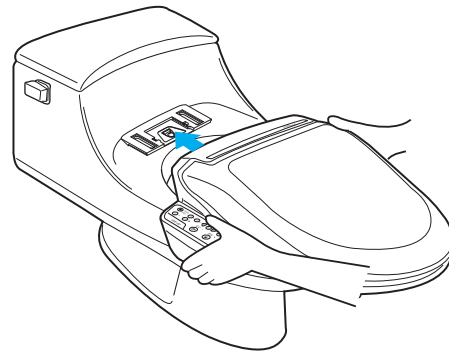

Connecting water Hose

Close the water shutoff valve and detach the toilet tank connection hose from the toilet tank. Connect the t-shaped connector to the toilet tank. Make sure that rubber packing is inserted in between.

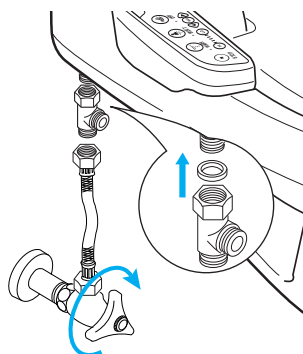

Connect the t-shaped connector linked to the toilet tank and the existing water hose.

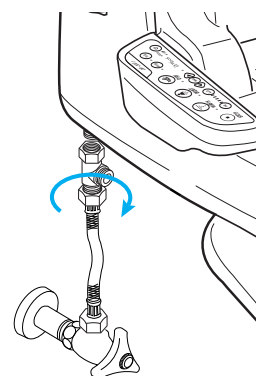

Connect the t-shaped connector and the water shutoff unit with connection hose.

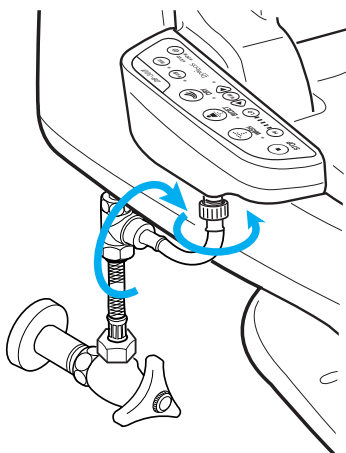

Open the water shutoff valve to check if there is any leakage.

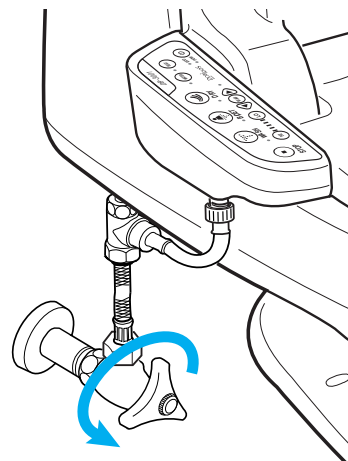

Trial and confirmation

1. Checking the voltage

- Insert the plug in a 120V receptacle.
- The SEAT lamp becomes on in green, and the WASH lamp flickers in red.

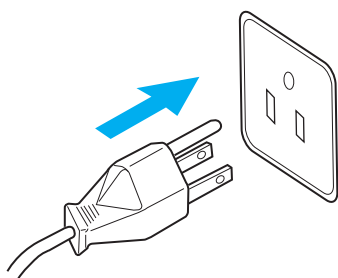

2. Filling up the water tank

- Warm water tank starts to fill up when you press the WASH button.
- When the tank is filled up with water, the process ends with a "beep".



3. Checking WASH / BIDET

- Press the WASH or BIDET button to check if cleaning water comes out.
- Press the WASH / BIDET button while pressing the seat switch as shown in the figure.

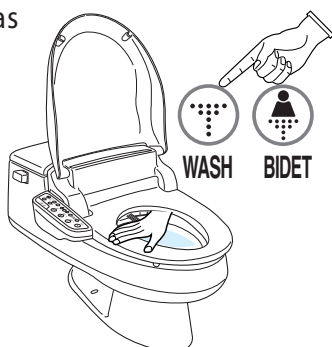

4. Checking DRY function (For DB-3001/DB-3002)

- Press the DRY button and check if warm air comes out.
- Press the button while holding down the seat switch as shown in the figure.



5

Preparations and Confirmations before Use

DOBIDOS the power after installation.

Connect the power plug in the outlet

1. Place the 120V (over 10A) outlet 19.7in (50cm) above the ground.
2. Place it where the water does not splash.
3. Use an outlet connected to a ground line.

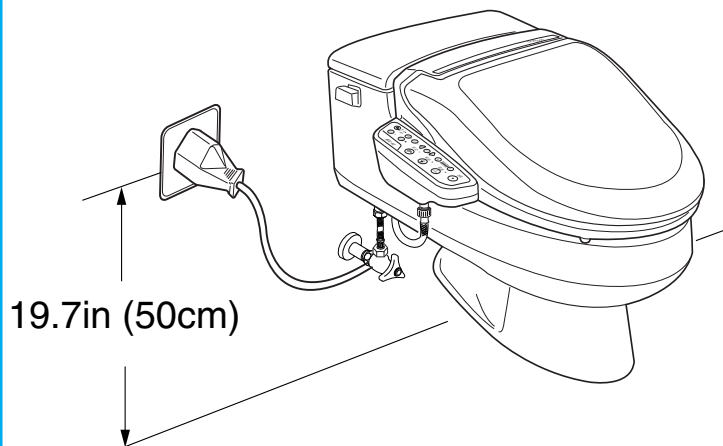
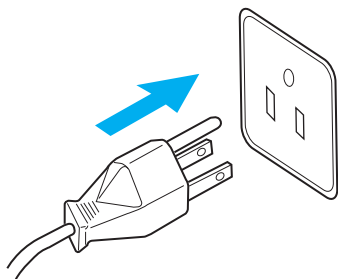

Check if the water shutoff valve is open.

Turn the water shutoff valve to the left to supply the water tank.

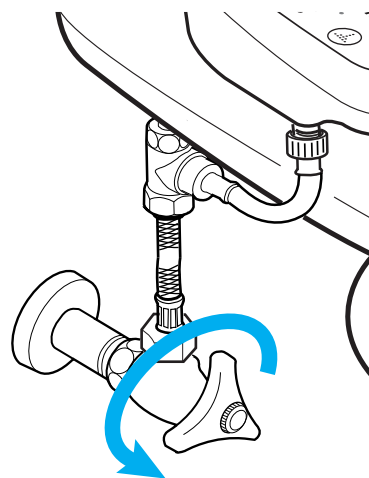

Warning

Plug it to an outlet that is connected to a ground line.

※In case of a breakdown or power leakage, there could be an electric shock.



Earth Grounding

※Please contact an electronic shop if the outlet does not have a ground line.



Caution

Use only AC120V.

※If not, that might cause an electric shock or a fire.



Prohibition

6 Operating Method

(Check the followings before use.)

Configure the following before using the DOBIDOS to use it more pleasantly.

BIDET function

Press the BIDET button in case of female use.

- Bidet indicator lamp turns on and cleaning water sprays.
- Automatically stops after 1.5mins.
- To use it for a longer period of time, press the BIDET button again.
- Water pressure can be set to four levels.

WASH function

Press the WASH button in case of personal area cleaning.

- Wash indicator lamp turns on and cleaning water sprays.
- Automatically stops after 1.5mins.
- To use it for a longer period of time, press the WASH button again.
- Water pressure can be set to four levels.

※ The overpressure reliever may drain water during wash or bidet action. This function is not a defect but for safety of the tank.

STOP

Press the STOP button to complete any operation in process.

- The operation automatically terminates after 1.5mins for WASH / BIDET function, and 3mins in case of drying. It also stops when the user stands up.

WATER PRESSURE/DRY TEMP

Water Pressure/ Dry Temp

- Use it to adjust the water pressure for WASH / BIDET function
- When drying use it for the adjustment of the temperature of the air. (For DB-3001/3002)

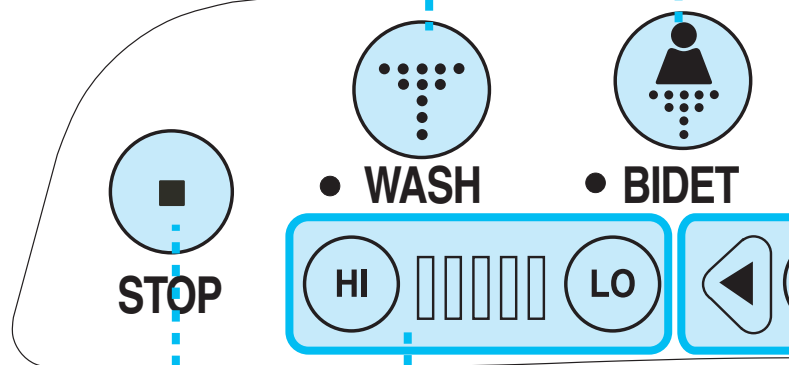

■ DRY Function

(For DB-3001/DB-3002)

To dry the wet part after wash, press the **DRY** button.

- Dry lamp turns on and drying starts.
- Automatically turns off after 3 mins.
- Press the **DRY** button again for more use.
- The air temperature can be set to five levels.
- Use toilet paper to soak some of the water left so as to quicken the dry process.

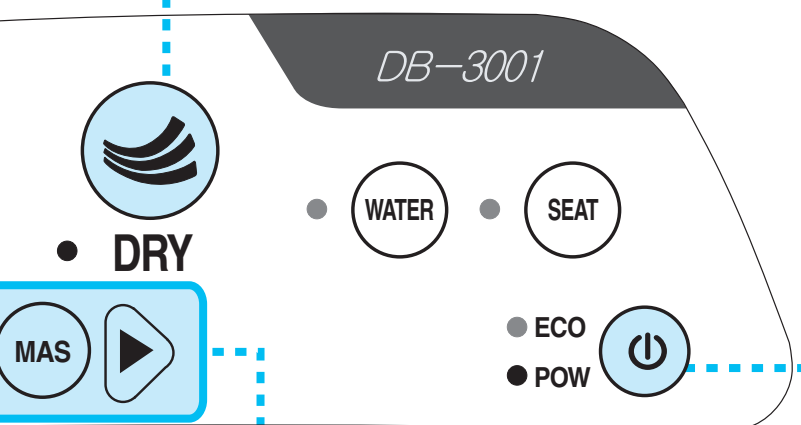

■ Nozzle Adjustment and Massage

- The nozzle can be adjusted using the ◀ / ▶ button to preferred position.
- Pressing the (MAS) button will automatically let the nozzle move back and forth giving a massage effect.
- Only works on **WASH / BIDET** mode.
- Press the (MAS) button to extend the time of use after the **WASH / BIDET** button.
- To stop the massage function, press the (MAS) button again.

⚠ Caution

- For elders and those who have a dull skin sense, set the product to "low" level.

* High level of drying can be a cause of burn.

■ POWER / ECONO

If the product is left unused for a long time, turn off the power.

- Press and hold the **POWER / ECONO** button for 3 seconds to turn off the power.
- Press the **POWER / ECONO** button to turn on the power.

Adjust seat and water temperature with the **POWER / ECONO** button to reduce power consumption.

- Press the **POWER / ECONO** button as the power is on.
- The Econo lamp is on in green.
- In the Econo mode, water temperature and seat temperature are maintained at the lowest.
- The Econo mode is disabled when you sit on the seat.
- Then water and seat are heated to the designated temperature
- Press the **POWER / ECONO** button again to disable the Econo mode

Warning

Be careful of low-temperature burn.

When the following person uses the warm seat or warm air dry, please make sure to configure the seat temperature to "room temperature" and drying air temperature to "low".

- Children, elderly or others, who are unable to adjust the temperature by themselves
- Patients, physically disabled persons or others, who cannot freely move themselves
- Persons who took medicines that cause sleep (sleeping pills, cold tablets, etc.), persons who had excessive drink, tired persons or others who may fall asleep



Compulsory Instruction

■ Default lamp status

WATER TEMP -Green(Low)
SEAT TEMP -Green(Low)
ECO -OFF
DEO -OFF(For DB-3001)

Additional Functions

Water overheating prevention function

- When the water is overheated it starts to beep and WASH and BIDET function do not operate. In this case, unplug the power plug and leave the product unused for more than three hours to lower the temperature of the water.
- If the same problem repeats itself, please contact the retail shop or the after-sales service center.

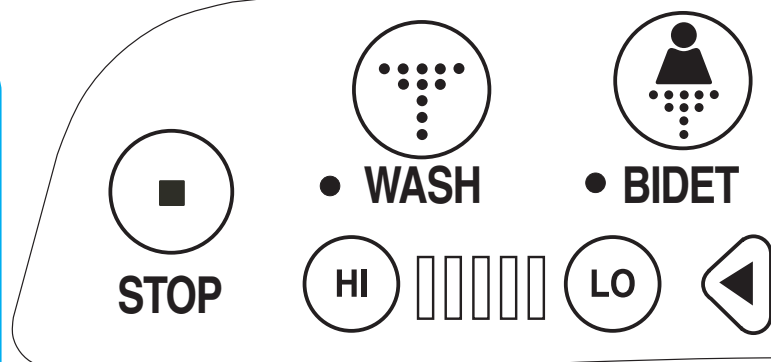

How to activate/deactivate the forced seat function

- With the forced seat function, you can use the Wash, Bidet and Dry function without actually taking the seat.
The forced seat function is deactivated in default.
Read the following instruction to activate or deactivate the forced seat function.
- How to activate the forced seat function
Press the Wash button and the Bidet button at the same time, and hold the buttons for 5 seconds.
The forced seat function is activated with "beep".
- How to deactivate the forced seat function
Press the Wash button and the Bidet button at the same time, and hold the buttons for 5 seconds.
The forced seat function is deactivated with "beep".
※ If the forced seat function is activated, no "beep" is sounded when you take the seat.

WATER TEMP

Water temperature

- The temperature of the water can be adjusted from 91.4°F to 104°F (33°C to 40°C) by the user by pressing the WATER TEMP button.
- When all of temperature indicator lamps are off the temperature is on room temperature.
- If you press the WATER TEMP button, the lamp changes as "Low → Mid → High → Normal" in sequence.

SEAT TEMP

Seat temperature

- Seat temperature can be adjusted from 86°F to 104°F (30°C to 40°C) by pressing the Temperature button
- When the Temperature indicator lamps are off, the temperature is on room temperature.
- If you press the SEAT TEMP button, the lamp changes as "Low → Mid → High → Normal" in sequence.

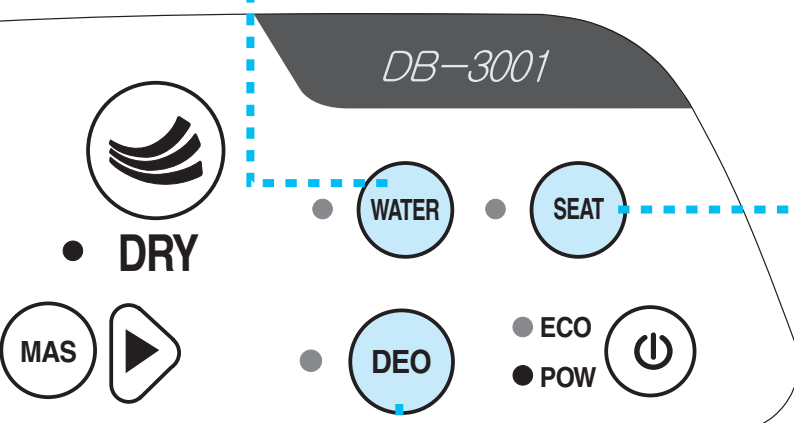
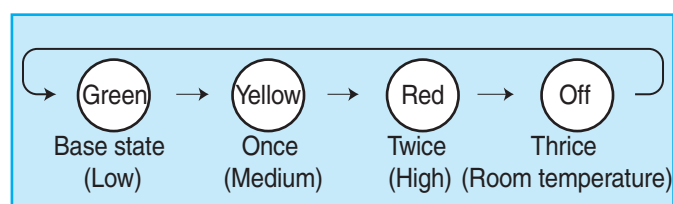
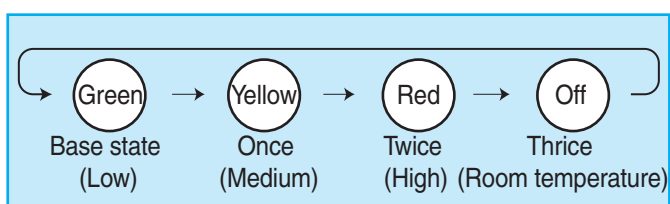

Deodorize (For DB-3001)

- If you sit on the seat the Deodorize function starts operation.
 - Daelim Cleanlet has the deodorizer built-in.
- If you press WASH, BIDET or DRY, the deodorize function is stopped. If you stop WASH, BIDET or DRY, the function is activated.
- If you rise from the seat, the function stops.
- You can turn off the deodorize function.

Seat Sensor

- Only works when the user is seated.
- Automatically stops working when the user stands up.

Cleaning the Product

- 1. Be sure to pull the power plug out before cleaning the product.**

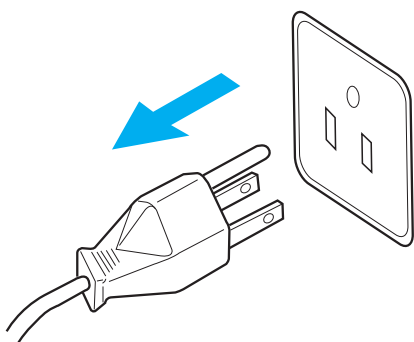

- 2. Cleaning the exterior part of the product.**

Use a smooth sponge or a cloth with neutralized detergent to clean the product. Do not use hydrochloric detergent, paint thinner, benzene, sandpaper, polisher, fragrance, pesticide, and others.

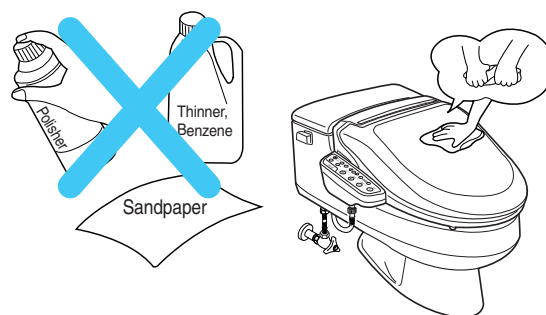

- 3. Cleaning of the nozzle.**

Pull the nozzle gently and use kitchen detergent with a smooth cloth, a sponge or a toothbrush to rub the nozzle with.

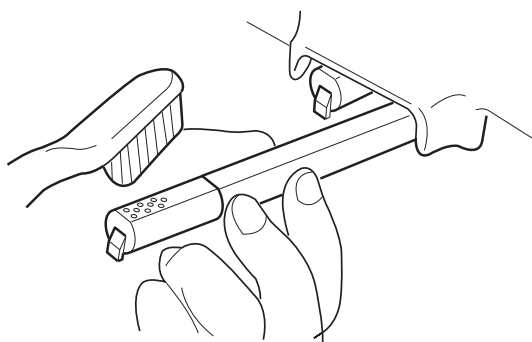

- 4. Cleaning of the filter net**
(If water does not come out)

Clean both sides of the filter net using a brush. Separate the hose thoroughly while cleaning.

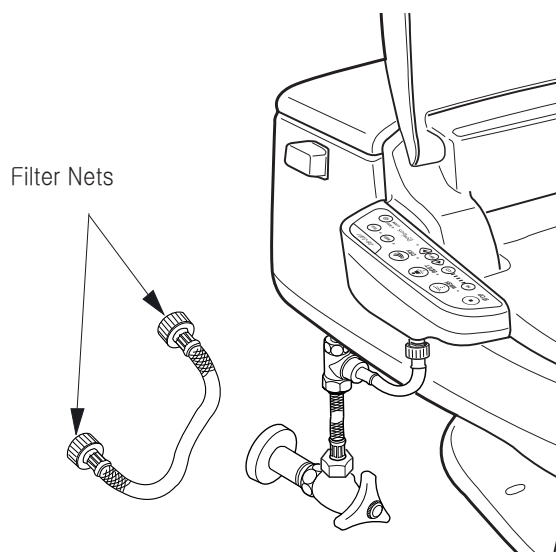

If The Product is not Used for a Long Time

Water must be drained off in the following cases

- If the unit is left unused for a long time. (Stained water may block the nozzle.)
- When the unit is installed in a villa. (Low temperature may freeze the unit.)

How to drain water and cut off power

1. Unplug the power cord before draining off water.

2. Close the water valve to stop water supply to the tank.

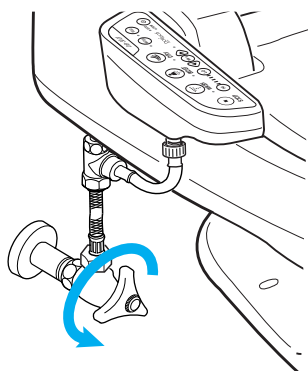

3. Detatch the water hose from the T-shaped connector to remove water from the hose.

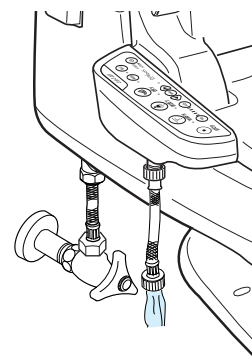

4. Open the drain plug to drain water from the tank.

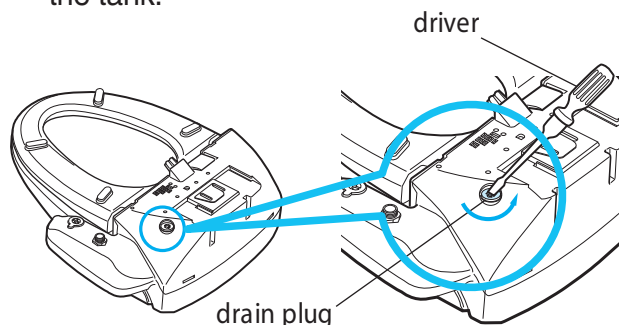

5. Replace the drain plug and pull out the power plug.

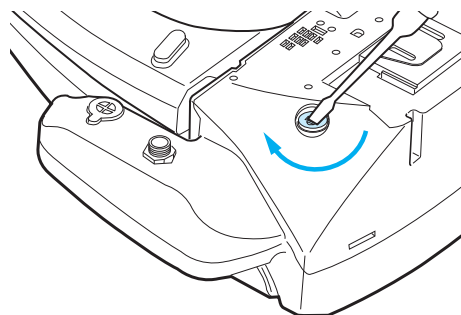

6. To use the unit again, trial operating and confirmation. (See pages16, 17)



Caution

Make sure to close the water valve when you remove water from the tank through the drain plug.

Make sure to replace the drain plug after removing water.

※ Failure to replace the drain plug may cause leakage of water.



Compulsory Instruction

Product maintenance in winter

1. Keep the power on even though it is temporarily not used.
2. Slightly raise the temperature of the water.
3. The temperature of the water can prevent the warm water tank from freezing.

9

Self Diagnosis and Trouble shooting

Check the followings before asking for service.

Self Diagnosis Display

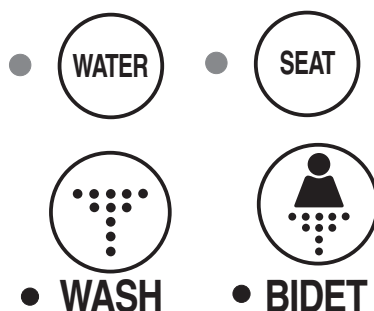

Trouble shooting

Display	Cause	Solution
The WASH lamp blinks in red	No water in the water tank	1. Press the WASH button to supply water
		2. If the Wash lamp still blinks 1 min after pressing the WASH button, check if the water valve is open.
		3. If water is not supplied while the water valve is open, unplug the power cord, and contact the Customer Service Center or the retail shop.

● In the following cases, unplug the power cord, and contact the Customer Service Center.

Display	Cause	Solution
The WATER TEMP lamp blinks in red with beep.	Water tank is overheated	Contact the Customer Service Center or the retail shop.
The WATER TEMP lamp blinks in green.	Water temperature sensor is defective.	
The SEAT lamp blinks in red.	Seat is overheated	
The SEAT lamp blinks in green.	Seat temperature sensor is defective.	



Warning

Do not disassemble, repair or remodel the unit.

※ That might cause electric shock, fire or malfunction.



Disassembling Prohibited

10 Specifications

Index			Description
Model No			DB-3001/DB-3002/DB-3003
Rated Voltage			AC 120V / 60Hz
Power Consumption			Maximum 555 W
Power Code			47.2 inch (1.2 M)
Wash	Water Flow	Wash	1.2 ℓ (1200cc)/min
		Bidet	1.3 ℓ (1300cc)/min
	Temperature Control		Room Temperature, 67.6°F~104°F(31 ~ 40℃) (4 Steps)
	Heater Capacity		500W
	Safety Protection		Temperature sensor, Float switch, Thermostat temperature fuse
	Protecting Back Current		Protector, vaccum breaker
Warm Air Drying (For DB-3001/ DB-3002)	Dry Temp		Room Temperature, 86°F~122°F(30 ~ 50℃) (5 Steps)
	Air Flow		0.36 m³/min
	Heater Capacity		300W
	Safety Protection		Temperature fuse
Warm Seat	Surface Temp		Max 105.8°F(41℃)
	Heater Capacity		55W
	Safety Protection		Temperature sensor, temperature fuse
Deodonization (For DB-3001)			Ceramic Filter
Supplying Water System			Direct connection to water supply pipe
Available Water Pressure			10~106 PSI(0.7~7.5kgf/cm²)
Water Supply Temperature			37.4°F~95°F(3~35℃)
Nomal Temp Range Light Work			37.4°F~104°F(3~40℃)
Dimension			W475 × D300 × H195 mm
Weight			About 6kg
Other Functions			<ul style="list-style-type: none">• Seat sensor• Slow down seat and seat lid• Applying antibiotic plastics to nozzle• Protection of low temp burn• Hand operate cleaning nozzle• Self cleaner• Power saving

■ This product is subject to change, due to the construction environment and technical supplementation.

■ Available water pressure is 10~106PSI (0.7 ~ 7.5kgf/cm²). However, water pressure on the nozzle may be weakened in 10~19.9 PSI (0.7 ~1.4kgf/cm²) of the water pressure.

MEMO

Warranty

We will offer you free repairs based on the information on this Warranty.

If failure or damage occurs during the warranty period upon the date of purchase, contact the retail shop with this warranty for the repair.

Customer	Name
	Address
Retail shop	Name
	Tel No.
Date of Purchase	(Mon), (Date), (Year)

Model Name	DB-3001/DB-3002/DB-3003
Warranty Period	1 Year from the date of purchase

★ To our consumers:

Please make sure that the date of purchase, the name of the retail shop, and the seller is recorded on this warranty when receiving this product.

This warranty cannot be reissued. Keep it in a proper place.

<Regulations for free repairs>

1. If failure or damage occurs on the conditions of normal use followed by the installation and use manual, sticker attached on the product, and attention notes, free repairs will be done.
2. If failure or damage occurs during the warranty period, contact the retail shop or Daelim Trading's after-sales service center. In this case, please show this warranty.
3. If a move have been made or this product has been given as a present and the above record is not filled out, request Daelim Trading's after-sales service center.
4. Repair will be made on a chargeable basis in the following cases even within the warranty period.
 - Failure or damage due to user's responsibility, improper repairs and remodeling of the product.
 - Failure or damage due to removal of the product after installation.
 - Failure or damage due to natural disasters such as fire, earthquake, flood damage and lightning or by environmental pollution, gas and abnormal voltage.
 - If not used for household (Such as use for business affairs, vehicles, or ships)
 - Failure or damage due to sand, junk or expendable supplies such as packing.
 - If this warranty is not presented.
 - If the name of customer, name of retail shop and date of purchase is not recorded, or if alteration on this warranty is found.
5. As this warranty cannot be reissued, keep it in a proper place. We will provide you with free repair service based on the information on this warranty. For other inquiries such as the repair after the warranty period, contact the retail shop where you purchased this product.

DAELIM Trading Co., Ltd.

87-9, Yeonhui-dong, Seodaemun-gu Seoul 404-180 Korea

Tel : 82-2-723-8202



To request after service:

1. Please recheck the user's manual.
2. If failure or damage occurs after consulting the manual, stop using the product and contact the retail shop.



DAELIM TRADING CO., LTD.

87-9, Yeonhui-dong, Seodaemun-gu Seoul 404-180 Korea
Tel : 82-2-723-8202

www.dobidos.co.kr