

Disney

User's Manual



**DISCOVER & LEARN
BIG BOOK OF BOO-BOOS**



**2-5
Years**

vtech®

© Disney
Visit DisneyJunior.com

© 2014 VTech
Printed in China
91-002930-001 US

Dear Parent,

At **VTech**[®], we know how important the first day of school is for your child. To help prepare preschoolers for this important event, **VTech**[®] has developed the **Preschool Learning**[™] series of interactive toys.

Preschool Learning[™] features fun characters and inviting school themes that use technology to capture a child's attention and teach important preschool skills like spelling, counting and the alphabet. These vital skills are taught in a way that's both fun and highly engaging to maintain a child's interest. Children will also be introduced to fun school subjects such as art class, music class and even recess! With **Preschool Learning**[™], learning is fun from day one!

At **VTech**[®], we know that a child has the ability to do great things. That's why all of our electronic learning products are uniquely designed to develop a child's mind and allow them to learn to the best of their ability. We thank you for trusting **VTech**[®] with the important job of helping your child learn and grow!

Sincerely,

Your friends at **VTech**[®]

To learn more about **Preschool Learning**[™] series and other **VTech**[®] toys, visit www.vtechkids.com

INTRODUCTION

Thank you for purchasing the **VTech® Discover & Learn Big Book of Boo-Boos**. The Doc is in, so let's get learning! Touch the interactive pages to learn words, beginning letters, health tips and listen to music and sounds with Doc and her friends.

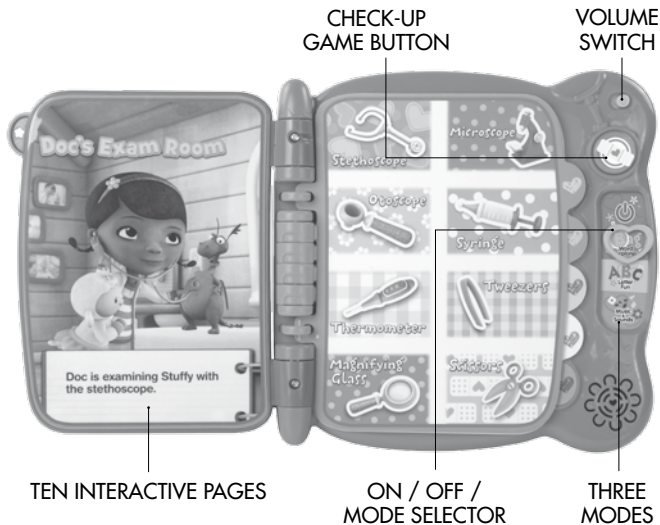

INCLUDED IN THIS PACKAGE

- One VTech® Discover & Learn Big Book of Boo-Boos
- One user's manual

WARNING:

All packing materials, such as tape, plastic sheets, packaging locks and tags are not part of this toy, and should be discarded for your child's safety.

ATTENTION

Pour la sécurité de votre enfant, débarrassez-vous de tous les produits d'emballage tels que rubans adhésifs, feuilles de plastique, attaches et étiquettes. Ils ne font pas partie du jouet.

NOTE: Please keep the user's manual as it contains important information.

Unlock the packaging locks:

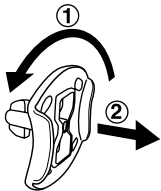

- ① Rotate the packaging locks 90 degrees counter-clockwise.
- ② Pull out the packaging locks.

GETTING STARTED

BATTERY INSTALLATION

1. Make sure the unit is turned **OFF**.
2. Locate the battery cover on the bottom of the unit. Use a screwdriver or coin to loosen the screw.
3. Install 2 new AA size (AM-3/LR6) batteries following the diagram inside the battery box. (The use of new alkaline batteries is recommended for maximum performance.)
4. Replace the battery cover and tighten the screw to secure.

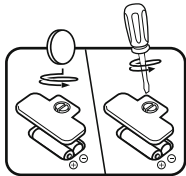

BATTERY NOTICE

- Use new alkaline batteries for maximum performance.
- Use only batteries of the same or equivalent type as recommended.
- Do not mix different types of batteries: alkaline, standard (carbon-zinc) or rechargeable (Ni-Cd, Ni-MH), or new and used batteries.
- Do not use damaged batteries.
- Insert batteries with the correct polarity.
- Do not short-circuit the battery terminals.
- Remove exhausted batteries from the toy.
- Remove batteries during long periods of non-use.
- Do not dispose of batteries in fire.
- Do not charge non-rechargeable batteries.
- Remove rechargeable batteries from the toy before charging (if removable).
- Rechargeable batteries are only to be charged under adult supervision.

PRODUCT FEATURES

1. ON / OFF / MODE SELECTOR

Slide the **MODE SELECTOR** to one of the activity icons to turn the unit **ON**. Slide the **MODE SELECTOR** to the top of the mode selector panel to turn the unit **OFF**.

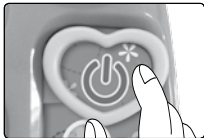

2. THREE MODES

Slide the **MODE SELECTOR** to choose one of the **THREE MODES**. Your child can explore words, letters and music!



3. TEN INTERACTIVE PAGES

Turn to any of the **TEN INTERACTIVE PAGES** and touch the surface to explore and learn.

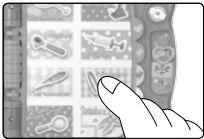

4. CHECK-UP GAME BUTTON

Press the **CHECK-UP GAME BUTTON** to play a finding game. The light flashes when a question is given or when the player gives a correct answer.



5. VOLUME SWITCH

Slide the **VOLUME SWITCH** to select a high or low volume setting.

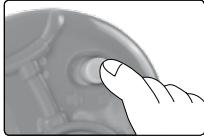

6. AUTOMATIC SHUT-OFF

To preserve battery life, the **VTech® Discover & Learn Big Book of Boo-Boos** will automatically turn off after a few minutes without input. The unit can be turned on again by sliding the **MODE SELECTOR** or pressing the **CHECK-UP GAME BUTTON**.

HOW TO PLAY

To get the most from your **Discover & Learn Big Book of Boo-Boos**, follow these simple instructions:

1. When playing, make sure the book is fully open. The pages should lay flat against the front and back panels of the book.
2. For optimal performance, use one finger when touching the pages.
3. For optimal performance, use one finger to touch the center of the text or picture.

INCORRECT OPERATION

To ensure proper touch responses, avoid the following actions when playing with your **Discover & Learn Big Book of Boo-Boos**.

1. Do not touch a picture if the pages are not laying down flat.
2. Do not touch more than one picture at a time.
3. Do not use more than one finger to touch a picture on the page. Avoid resting your hand on the page.



ACTIVITIES

1. Word Explorer

Touch the pictures to learn about words and objects related to Doc's exam room, Doc's waiting room, Doc's bedroom, Doc's house and Doc's backyard.

Touch the story sensors on the left page to hear fun responses and health tips.



2. Letter Fun

Touch the pictures to learn beginning letters.

Touch the story sensors on the left page to hear fun responses and health tips.



3. Music & Sounds

Touch the story sensors on the left page to choose a melody. Touch the words to add some fun sounds while the melody is playing.



4. Check-up

Press the stethoscope button to play a finding game. Listen to the questions and touch the pictures to answer.



CARE & MAINTENANCE

1. Keep the unit clean by wiping it with a slightly damp cloth.
2. Keep the unit out of direct sunlight and away from any direct heat source.
3. Remove the batteries when the unit is not in use for an extended period of time.
4. Do not drop the unit on hard surfaces and do not expose the unit to moisture or water.

TROUBLESHOOTING

If for some reason the unit stops working or malfunctions, please follow these steps:

1. Turn the unit **OFF**.
2. Interrupt the power supply by removing the batteries.
3. Let the unit stand for a few minutes, then replace the batteries.
4. Turn the unit **ON**. The unit will now be ready to play again.
5. If the product still does not work, replace with a new set of batteries.

If the problem persists, please call our Consumer Services Department at 1-800-521-2010 in the U.S. or 1-877-352-8697 in Canada, and a service representative will be happy to help you.

For information on this product warranty, please call **VTech**[®] at 1-800-521-2010 in the U.S. or 1-877-352-8697 in Canada.

Note:

This equipment has been tested and found to comply with the limits for a Class B digital device, pursuant to Part 15 of the FCC Rules. These limits are designed to provide reasonable protection against harmful interference in a residential installation. This equipment generates, uses and can radiate radio frequency energy and, if not installed and used in accordance with the instructions, may cause harmful interference to radio communications. However, there is no guarantee that interference will not occur in a particular installation. If this equipment does cause harmful interference to radio or television reception, which can be determined by turning the equipment off and on, the user is encouraged to try to correct the interference by one or more of the following measures:

- Reorient or relocate the receiving antenna.
- Increase the separation between the equipment and receiver.
- Connect the equipment into an outlet on a circuit different from that to which the receiver is connected.
- Consult the dealer or an experienced radio/TV technician for help.

Caution: changes or modifications not expressly approved by the party responsible for compliance could void the user's authority to operate the equipment.

COPYRIGHT NOTICES:

Copyright ©2014 **VTech**[®] Electronics North America, L.L.C. All Rights Reserved. **VTech**[®] and the **VTech**[®] logo are registered trademarks of **VTech**[®] Electronics North America, L.L.C. All other trademarks are property of their respective owners.

IMPORTANT NOTE:

Creating and developing **VTech® Preschool Learning** products is accompanied by a responsibility that we at **VTech®** take very seriously. We make every effort to ensure the accuracy of the information, which forms the value of our products. However, errors sometimes can occur. It is important for you to know that we stand behind our products and encourage you to call our Consumer Services Department at 1-800-521-2010 in the U.S., or 1-877-352-8697 in Canada, with any problems and/or suggestions that you might have. A service representative will be happy to help you.