

# ProCONNECT

Professional Connecting Panels

## PROCONNECT GAS SHOCK SERIES USER MANUAL PC300, PC400, Dual Power (PCDP) & Quad Power (PCQP) Series

Thank you for purchasing our professional connecting panel

### CAUTION

- Only connect the power connection to a voltage feed of 240 Volt, 50Hz, single-phase with protective earth. NOTE: Maximum total load is 10A (2400W) across the entire unit.
- There is a 10A fuse built-in to the IEC-60320 rubber connector, which may not be replaced by a fuse with a higher ampere value. A spare fuse can be found in the fuse drawer of the IEC-Plug.
- Do not wet the unit, and keep in a dry, well-ventilated area.
- On units with a supply lead, if the supply cord is damaged, it shall be replaced by the manufacturer or its service agent or similarly qualified person, in order to avoid a hazard.

### INSTALLATION

- The ProCONNECT should be installed by a professional technician.
- Please check and confirm the supplied template with the size of the unit. avEFEKTs or its registered dealer cannot be held responsible for damages due to incorrect cut-outs.
- Define the point of installation accurately and mark out the area to be cut with the template, or attach the template directly onto the table / surface.
- The area to be cut should be made with the appropriate tools, depending on the material of the surface. Make the cut-out.
- Insert the ProCONNECT through the opening and position correctly.
- Attach the fasteners to the appropriate notches underneath the unit. The area with the insert nut must be parallel to the plate, and the screw-head must point away from the plate. Adjust the unit to the desired position, and tighten with screws.
- Mount the cables using appropriate mounting material. Make sure that the cables will not get broken, jammed or distended when the unit is opened or closed. The centerpiece must be able to move freely, and the cables must have sufficient slack for when the unit is opened.
- Connect the Audio Visual cable-ends to the respective cables / sockets. Please also connect the 240V Power to a Wall Plug.
- Ensure that the power outlet and the signal connectors are only being used with the maximum allowable voltage and current. NOTE: Maximum total load is 10A (2400W) across the entire unit.

### INSTRUCTIONS FOR USE

- Open: Press on the centerpiece of the lid until the latch audibly disengages. Release, and the lid will pop open, showing the available connections.
- Close: Press down on the centre of the lid until the latch audibly engages. Release, and the lid will be closed.
- Cleaning: Switch off the system or pull the plug before cleaning. DO NOT use any cleaning agents or water on the unit. Only use a soft and lightly moisturized cloth.

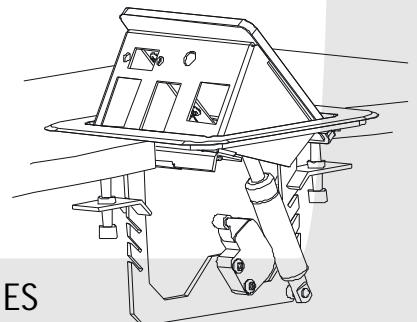

1 YEAR WARRANTY ON ALL PROCONNECT SERIES