

**CEH50 User Manual**

Suitable For Use With Phones Including Mobile Phones With a 2.5mm Headset Socket

Please Read Before Use &amp; Retain For Future Reference!

**1****Identifying the Parts**

We have referred to Cordless Digital Phones (DECT) throughout this manual. If you are connecting to a mobile phone please also follow these instructions as they will be broadly similar. Refer to your phone manual and also be sure to test using a low volume setting.

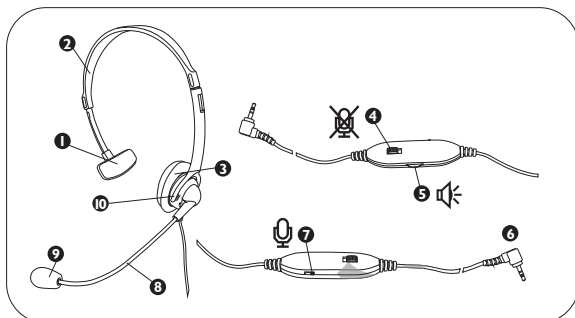

- |                           |                               |
|---------------------------|-------------------------------|
| 1. Headrest with foam     | 6. 2.5mm jack plug            |
| 2. Extendable headband    | 7. Microphone gain setting    |
| 3. Speaker chamber        | 8. Flexible microphone boom   |
| 4. Mute switch            | 9. Microphone with windscreen |
| 5. Speaker volume control | 10. Speaker adjusting arm     |

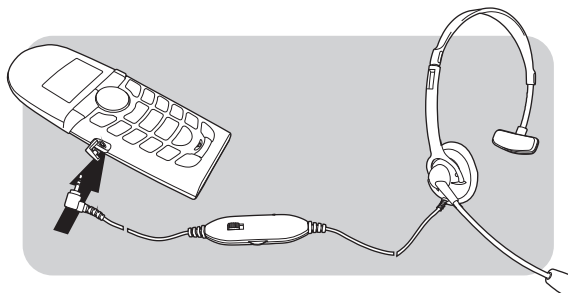
**4****Connecting the Headset to your Phone**

Almost all DECT cordless phones with a headset socket use a 2.5mm Jack. (However, not all DECT phones have a headset port, please check the user manual for your phone to see if this feature is available).

Locate the headset socket on your phone, if in doubt please refer to your phone manual. Simply insert the 2.5mm plug into the socket to complete connection.

**2****Headset Wearing Method**

- By gently pulling the headband out, you can extend the headset to fit most head sizes.
- The microphone boom can rotate up to 270°, offering both left and right ear wearing options.
- The adjusting arm holds onto the axis of the speaker chamber allowing vertical adjustment.
- The microphone arm is flexible so you can easily adjust the distance between the microphone and your mouth.

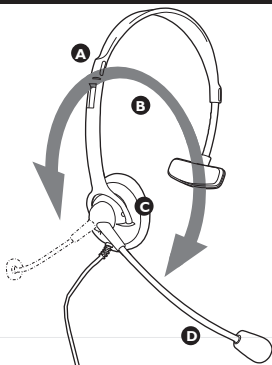
**Detailed Technical Specifications****General Characteristics**

Type	Monaural Over-the-Head
Speaker	ø27mm
Microphone	ø6 x 2.7mm
Cord Length	1.2 meters w/ volume control
Plug	2.5mm golden plug

**Speaker Characteristics**

Type	Receiver
Rated Impedance	32 ±20% (@ 1V, 1kHz)
Rated Power Input	10mW
Max. Power Input	30mW
Frequency Range	300 ~ 4,000Hz
Sensitivity	112dB ± 3dB

**Microphone Characteristics**

Type	Electret Condenser (ECM)
Impedance	1,000W
Sensitivity	-60dB ± 4dB/μBar
Directivity	Noise-cancelling
Operation Voltage	1.5 ~ 10V (DC)
Current Consumption	<500mA

**Inline Volume Control Features**

Radiation Reduction Technology (RRT)	Helps to reduce radiation generated by a DECT phone reaching the wearer
Muting	ON/OFF selector for microphone muting
Reception Level	Rotatable potentiometer for speaker volume adjustment
Transmission Level	3 position for microphone volume adjustment

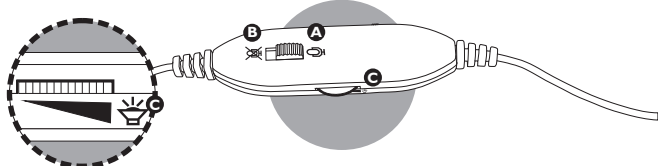
**3****Inline Controller****Speaker Volume Control**

The Speaker Volume Control (C) dial on the side of the inline controller allows you to adjust the incoming volume. Increase volume by turning the dial towards the speaker icon, and vice versa to decrease volume.

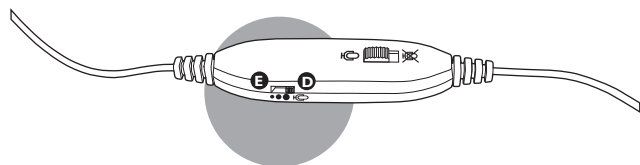
**Microphone Mute Switch**

The inline controller includes various switches. The Microphone Mute Switch offers quick privacy by muting the microphone. Slide the switch to position (A) for muting and back to position (B) to go back to normal speaking mode.

**Microphone Gain Switch**

The Microphone Gain Switch (D) acts as a microphone pairing between the headset and your phone. It is not designed to be a volume control, hence you should only be required to make this setting once.



**Caution:** Make sure you switch to the left most position (E) before you adjust this setting, because different phones have very different microphone sensitivity, if the microphone gain is set too high, the headset speaker may SQUEAL, which can cause damage to the user's ear and the headset.

Notice the three positions marked by different sizes of circle, the left most and smallest circle indicates lowest microphone gain. Starting with the left most position, place a call and ask the person who is helping you which position offers the optimum level.

**Warnings**

- Listening with device at high volume may damage your hearing.
- Adjusting the volume for microphone or the speaker at a high setting may cause squealing (feedback sound) and can cause damage to your hearing.
- Do not use or store near fire, places with extended exposure to direct sunlight or magnetic fields, excessive dust, or moisture.
- Do not use in rain, or in areas of excessive electromagnetic radiation.
- Do not drop this device or subject it to external shock which may cause a malfunction.
- Do not disassemble or attempt to open up the casing under any circumstances.
- Do not use liquid cleanser or aerosol cleansers as they may damage the headset.
- Use a dry cloth only to clean the external portions of the product.

**Recycling**

This headset is WEEE compliant and must be recycled or disposed of properly. Please contact your local recycling centre for further information.

**Warranty**

Do not remove or alter any serial number or sticker on any part of the device, as this will automatically void the product's warranty.

**Support Information****Having difficulty using or setting up your product?**

Please follow our simple setup instructions enclosed

Online support: [www.ConnectedEssentials.co.uk](http://www.ConnectedEssentials.co.uk)

Email support: [support@connectedessentials.co.uk](mailto:support@connectedessentials.co.uk)

Product support tel: 0871 200 2276

Lines are open 09.00 am to 5.30pm (Monday to Friday except public Holidays)  
Calls from BT Landlines charged at 10p per minute other service providers may vary.

**Looking for Spares & Accessories?**

For a wide range of spares and accessories for your product purchase please visit:

[www.ConnectedEssentials.co.uk/Spares](http://www.ConnectedEssentials.co.uk/Spares)

