

AUTOMATIC DRUM WASHING MACHINE

USER MANUAL

HW-F1481

HW-F1481 ME

HW-F1281

HW-F1281 ME

HW-F1081

HW-F1081 ME

HW-F881

HW-F881 ME

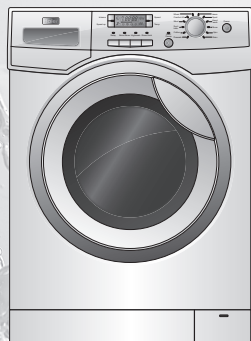

**Haier**

## TABLE OF CONTENTS

### BEFORE USE

>COMPONENTS.....	03
>PREPARATION.....	04
>SAFETY INSTRUCTIONS.....	05
>INSTALLATION.....	06
>CONTROL PANEL.....	08

### USING THE APPLIANCE

>PROGRAM SELECTION.....	10
>CONSUMPTION AND TECHNICAL DATA.....	11
>WASHING METHODS.....	12

### MAINTENANCE

>CLEANING & CARE.....	16
>DISPLAY CODES.....	18
>TROUBLESHOOTING.....	19

## LEGEND



For your safety, any instructions in this manual with this "Warning" sign must be followed strictly.

## DISPOSAL



Do not dispose of electrical appliances as unsorted municipal waste, use separate collection facilities. Contact your local government for information regarding the collection systems available. If electrical appliances are disposed of in landfills or dumps, hazardous substances can leak into the groundwater and get into the food chain, damaging your health and well-being.

When replacing old appliances with new ones, the retailer is legally obligated to take back your old appliance for disposals at least free of charge.

## COMPONENTS

### THANKS FOR PURCHASING A HAIER PRODUCT

Please read these instructions carefully before using this appliance. The instructions contain important information which will help you get the best out of the appliance and ensure safe and proper installation, use and maintenance.

Keep this manual in a convenient place so you can always refer to it for the safe and proper use of the appliance.

If you sell the appliance, give it away, or leave it behind when you move house, make sure you also pass on this manual so that the new owner can become familiar with the appliance and safety warnings.

### ACCESSORIES

Check the accessories and literature

1x Inlet hose assembly

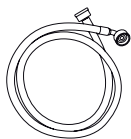

1x Bottom cover



1x User manual



1x Drain hose bracket

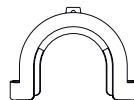

1x Warranty card (optional)



3x Blanking plugs



**PREPARATION**PREPARING THE MACHINE

Remove all the packing materials to prevent unsteadiness, including the polystyrene base. Upon opening the package, water drops may be seen on the plastic bag and the porthole. This is normal phenomenon resulting from water tests in the factory.

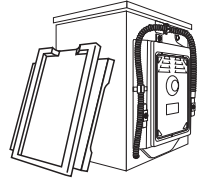
DESCRIPTION

This diagram may be slightly different from the layout of the washing machine you have just purchased due to technical improvements.

Power switch

Door handle

Work Top

Washer door

Control Panel

Detergent distribution drawer

Bottom trim



Drain hose

Water inlet valve

Power cord

Back cover

Back cover screws

Transportation bolts

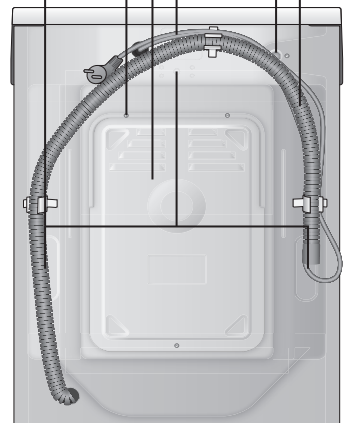

## SAFETY INSTRUCTIONS

BEFORE SWITCHING THE APPLIANCE ON FOR THE FIRST TIME

DO ...

- ... Use a separate earthed socket for the power supply.
- ... Make sure that the plug is accessible.
- ... Hold the plug and not the electric cable when unplugging the power supply.
- ... Make sure that the fuses in the power circuit are rated for 15A.
- ... Keep away from heat sources and direct sun light to prevent plastic and rubber components from aging.
- ... Make sure that the power cord is not caught under or in the appliance and avoid damage to the power cable.
- ... Check that hose joints and connections are firm and no water can leak. If joints are loose or there is leakage, turn off the water supply and repair. Do not use the washing machine until the hoses are properly fixed.

DURING DAILY USE OF THE APPLIANCE

DO ...

- ... Pull up zips and fix loose threads to prevent the items from being entangled. If necessary, put small items into a net bag or pillow.
- ... Turn off the machine after each wash program and switch it off at the mains to save electricity and for safety. Wipe clean the lower part of the porthole.
- ... Keep the door slightly open when the washing machine is not in use to prevent formation of odours.
- ... Let the power cord be replaced by the manufacturer, his service agent or other accordingly qualified persons, in case it is damaged.
- ... Ensure that the appliance is not used by persons with reduced physical, sensory or mental capabilities, lack of experience and knowledge without supervision or instruction by a person responsible for their safety.
- ... Supervise children to ensure that they do not play with the appliance.

DO NOT ...

- ... Touch or use the appliance when barefoot or with wet or damp hands or feet.
- ... Use flammable detergent or dry cleaning agent.
- ... Use any flammable sprays in close vicinity to the appliance.
- ... Remove or insert the plug in the presence of flammable gas.
- ... Allow children or infirm persons to play with the appliance or packing materials.
- ... Install the appliance outdoors in a damp place, or in an area which may be prone to water leaks such as under or near a sink unit. In the event of a water leak allow the machine to dry naturally.
- ... Place the washing machine directly on a carpet, or close to a wall or furniture.

DO NOT ...

- ... Touch the washer door during the washing process - it gets hot!
- ... Place heavy objects or sources of heat or damp on top of the appliance.
- ... Hot wash foam rubber or sponge-like materials.
- ... Open the detergent distribution drawer during the wash cycle.
- ... Force the washer door open. The door is fitted with a self-lock device and will open shortly after the washing procedure is ended.
- ... Open the washer door if the water level is visibly over the porthole.
- ... Cover the washing machine with plastic cover so that inside dampness cannot be kept in.

## INSTALLATION

### ADJUSTING THE BOTTOM COVER

Before removing the transportation bolts, please fix the bottom cover to the bottom of the washing machine. Lay down the machine (fig. 1.), screw off the feet and adjust the bottom cover with the four holes corresponding the screw holes of the feet. Then screw the feet back on through the cover and fix it thus securely to the bottom of the machine (fig. 2.).

It keeps out the dampness and reduces the noise.

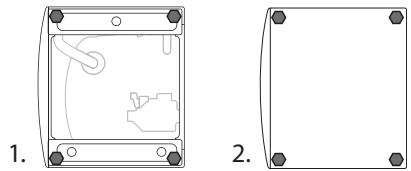

### DISMANTLE THE TRANSPORTATION BOLTS

The transportation bolts are designed for clamping anti-vibration components inside of the washing machine during the transportation process.

1. Remove the back cover.
2. Remove the three bolts on the rear side and take out the synthetic stabilisers from within the machine.
3. Replace the back cover.
4. Fill the holes left by the bolts with blanking plugs.

Note: Keep the transportation bolts and synthetic stabilisers in a safe place for later use.

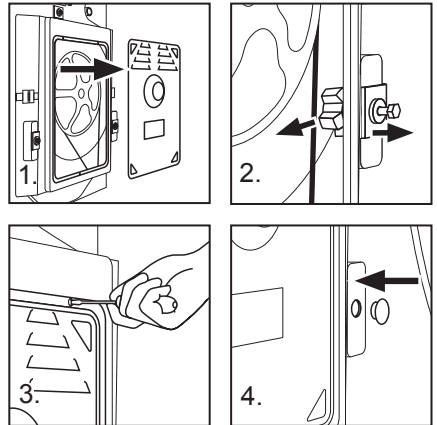

### ADJUSTING THE WASHING MACHINE

There are adjustable feet under the bottom of the washing machine. Before use, they should be adjusted so that the machine is level. This will minimise vibrations and thus noise during use. It will also reduce wear and tear. We recommend using a spirit level to level

the appliance.

### INLET HOSE

1. Connect the nut on the inlet hose to the connector on the water valve.
2. Apply inlet hose to a water tap with cold, fresh water.

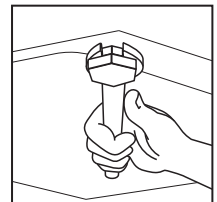

Note: Use the hose-set supplied with the appliance. Old hose-sets should not be reused.

### DRAIN HOSE

1. Use the drain hose bracket to keep the end of the drain hose retained and prevent the outflow of water. Don't extend the length of the drain hose; if an extended hose is required, please consult a serviceman.

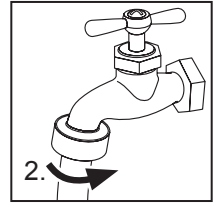
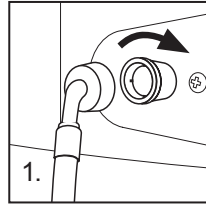

2. The height of the drainage outlet must be 80-100 cm. Fix the drain hose to the clip at the back of the washing machine to prevent it from dropping off.

Note: The drain hose should not be submerged in water and should be securely fixed and leak-free. If the drain hose is placed on the ground or if the pipe is at a height of less than 80cm, the washing machine will continuously drain while being filled (self-siphoning).

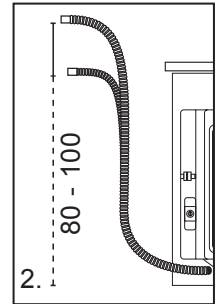
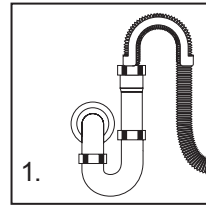

### CONNECTING TO THE POWER SUPPLY

Before connecting to the power supply, check:

→ The socket is adequate for the maximum power of the washing machine

(For safety, fuses in the power circuit should be rated for no less than 15A).

→ The voltage should meet the requirement.

→ The power outlet should be capable of accepting the washing machine plug.

→ Connect the machine to an earthed socket outlet.

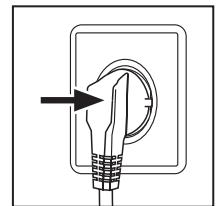

## CONTROL PANEL

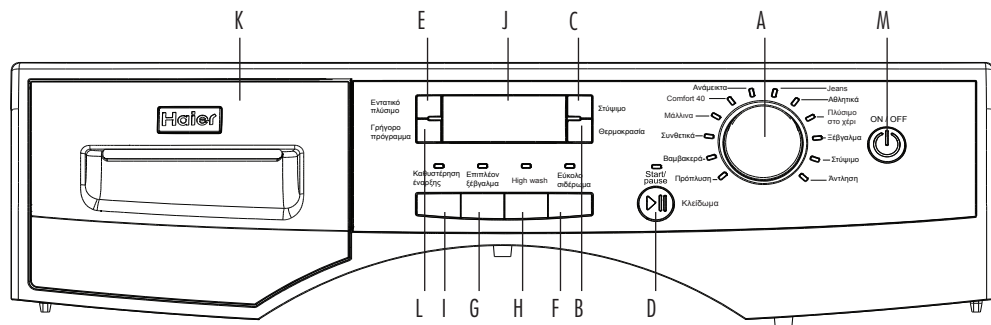

A	Program knob	F	Rinse hold button	K	Detergent distribution drawer
B	Temperature button	G	Extra rinse button	L	Speed-up button
C	Speed button	H	High wash	M	Power button
D	Start/pause button	I	Delay button		
E	Intense button	J	Display		

## OPERATIONAL FUNCTIONS

A	→ Program knob	_ Select program by turning the knob (See "program modes" on page 8).
B	→ Temperature button	_ Select the desired washing temperature (-,30,40,50, 60,90°C ) by pressing and holding down this button. When selected, the temperature is shown on the display. Cold wash is selected when the symbol "--" is displayed.
C	→ Speed button	_ Select the desired spin speed (0, 400, 600, 800, 1000, 1200, 1400 rpm) by pressing and holding down this button. When selected, the speed value is shown on the display. The washing machine does not spin when "0" is displayed. The washing machine spins at 1200 rpm when "1200" is displayed.
D	→ Start/pause button	_ If you press this button, ":" will be displayed and operation will start. If you press this button during a wash cycle, the ":" sign will start blinking and operation will pause. Press it again to resume operation. Note: After operation is suspended, the washing temperature, spinning speed and other functions can not be reset.  _ Press this button for 2 seconds to unlock the door if the status allows the door to open (water level lower than porthole, water temperature lower than 50°C, stopped motor).
E	→ Intense button	_ If the laundry is heavily soiled, press this button before starting the program. When the button is pressed, the washing time increases.
F	→ Rinse hold button	_ If you press this button, the washing machine will not drain the water after the last rinsing operation, but start a soaking cycle. The indicator light goes on. To spin the laundry, press this button again. The indicator light turns off and the program continues to the end. Note: Press only when "Prewash", "Cotton", "Synthetics" or "Rinse" is selected.

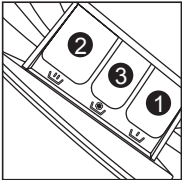

G	→ Extra rinse button	_ Press this button, the washing machine will perform additional rinses. Press the button once to select one additional rinse. The display will show "P-1". Press the button repeatedly and the screen will display "P-2" or "P-3", indicating two or three additional selected rinses. The "extra rinse light" is activated and flashes during the performance. "P-1/2/3" is displayed alternating with the remaining time. The light turns off and the display disappears when the extra rinse ends.
H	→ High wash	_ For heavily soiled laundry. Press the button before starting the program to increase the amount of water used. The "high wash" light is on during the performance.
I	→ Delay button	_ Press the button repeatedly before starting the program to enter the time you want the machine to be finished in, the start will delay from 0.5 to 24 hours in 30-minute intervals. This also includes the length of the program itself, so the delay time must be longer than the program length selected. This function can not be selected in the " Rinse", "Spin" and "Drain" program.
J	→ Display	_ The display shows the washing time remaining, the selected temperature and speed, the options, the alarm warning, etc. (see "Display codes" on page 12).
K	→ Detergent distribution drawer	<p>_ Instructions are printed on the handle of the drawer.</p> <p>Open the drawer, three compartments can be seen:</p> <p>Compartment 1: Pre-wash detergent</p> <p>Compartment 2: Detergent for programs 1 to 9</p> <p>Compartment 3: Softener, conditioning agent, perfume, and other additives.</p>
		
D+I	→ Combined buttons for button lock	_ By pressing the "Delay" and "Start/Pause" buttons for 3 seconds after having started a program, the button lock is activated. The display shows ☺ . In order to cancel the button lock, press the two buttons again for 3 seconds, and the display will disappear. Caution: the button lock needs to be cancelled actively, it will not disappear automatically after the washing cycle.
L	→ Speed-up button	_ Press this button before starting the program to reduce the washing time and temperature. The speed-up light will be on until the program ends.
M	→ Power button	_ Press this button to turn the machine on and off. It will turn off automatically after five minutes without activity.

## PROGRAM SELECTION

## PROGRAM MODES

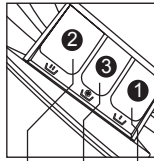

- 1 Detergent compartment for prewash mode
- 2 Detergent compartment
- 3 Compartment for softener and other additives

Program	Temperature Maximum	Preset	2	3	1	Recommended Laundry	MAX. LOAD	Preset spin speed	
1	→ Prewash	-to 90 °C	40 °C	<input checked="" type="checkbox"/>	<input type="checkbox"/>	<input checked="" type="checkbox"/>	Cotton fabrics	8 kg	1000 rpm
2	→ Cotton	-to 90 °C	40 °C	<input checked="" type="checkbox"/>	<input type="checkbox"/>	<input checked="" type="checkbox"/>	Cotton fabrics	8 kg	1000 rpm
3	→ Synthetics	0 ° to 60 °C	40 °C	<input checked="" type="checkbox"/>	<input type="checkbox"/>	<input checked="" type="checkbox"/>	Fast colours / Medium soiled	4 kg	1000 rpm
4	→ Wool	0 ° to 40 °C	30 °C	<input checked="" type="checkbox"/>	<input type="checkbox"/>	<input checked="" type="checkbox"/>	Wool fabrics	3 kg	600 rpm
5	→ Comfort 40	0 ° to 40 °C	40 °C	<input checked="" type="checkbox"/>	<input type="checkbox"/>	<input checked="" type="checkbox"/>	Cotton or synthetic	4 kg	1000 rpm
6	→ Mixed	0 ° to 40 °C	40 °C	<input checked="" type="checkbox"/>	<input type="checkbox"/>	<input checked="" type="checkbox"/>	Different materials	4 kg	1000 rpm
7	→ Jeans	0 ° to 90 °C	40 °C	<input checked="" type="checkbox"/>	<input type="checkbox"/>	<input checked="" type="checkbox"/>	/	4 kg	1000 rpm
8	→ Sport	0 ° to 40 °C	30 °C	<input checked="" type="checkbox"/>	<input type="checkbox"/>	<input checked="" type="checkbox"/>	Sports wear	4 kg	800 rpm
9	→ Hand wash	0 ° to 40 °C	30 °C	<input checked="" type="checkbox"/>	<input type="checkbox"/>	<input checked="" type="checkbox"/>	/	4 kg	400 rpm
10	→ Rinse	/	/	<input checked="" type="checkbox"/>	<input type="checkbox"/>	<input checked="" type="checkbox"/>	/	8 kg	400 rpm
11	→ Spin	/	/	<input checked="" type="checkbox"/>	<input checked="" type="checkbox"/>	<input checked="" type="checkbox"/>	/	8 kg	1000 rpm
12	→ Drain	/	/	<input checked="" type="checkbox"/>	<input checked="" type="checkbox"/>	<input checked="" type="checkbox"/>	/	8 kg	/



## CONSUMPTION AND TECHNICAL DATA

### CONSUMPTION TABLE

The wash cycle times are intended as a guide only. The actual time used may vary due to different water pressure, initial water temperature, etc.

PROGRAM	MAX. LOAD	ENERGY CONSUMPTION	WATER CONSUMPTION	WASHING TIME
→ Prewash	8 kg	0.663 kWh	105L	2:15 h
→ Cotton 60 °C <sup>*)</sup>	8 kg	1.326 kWh	62.8 L	2:55 h
→ Synthetics	4 kg	0.481 kWh	43.6L	1:16 h
→ Wool	3 kg	0.197 kWh	49.6 L	1:04 h
→ Comfort 40	4 kg	0.466 kWh	43.6L	0:44 h
→ Mixed	4 kg	0.527 kWh	52.3 L	1:24 h
→ Jeans	4 kg	0.527 kWh	70.2 L	1:48 h
→ Sport	4 kg	0.179 kWh	37.4L	0:28 h
→ Hand wash	4 kg	0.147 kWh	41.8 L	0:57 h

<sup>\*)</sup> EN 60456 test program / Energy label program with Intense and 1400 rpm spin speed.

### TECHNICAL DATA

	HW-F 1481/ME	HW-F 1281/ME	HW-F 1081/ME	HW-F 881/ME
Power source	220 - 240 V / 50 Hz	220 - 240 V / 50 Hz	220 - 240 V / 50 Hz	220 - 240 V / 50 Hz
Max. working current (A)	10	10	10	10
Water pressure (MPa)	$0.03 \leq P \leq 1$	$0.03 \leq P \leq 1$	$0.03 \leq P \leq 1$	$0.03 \leq P \leq 1$
Nominal load (kg)	8	8	8	8
Spinning speed (r/min)	1400	1200	1000	800
Washing programs	12	12	12	12
Max. power (W)	2000	2000	2000	2000
Dimensions (HxDxW mm)	850 x 650 x 595	850 x 650 x 595	850 x 650 x 595	850 x 650 x 595
Net weight (kg)	86	86	86	86

## WASHING METHODS

### PLEASE NOTE

This washing machine is for domestic use only. Do not use it for purposes other than that for which it was designed. Follow the instructions given on the label of each garment and wash only machine-washable garments.



### POWER SUPPLY

Connect the washing machine to the power supply (220V to 240V~/50Hz).

### WATER CONNECTION

Turn on the tap. The water must be clean and clear.

Note: Before use, check for leakage in the joints between the tap and the inlet hose by turning on the tap.

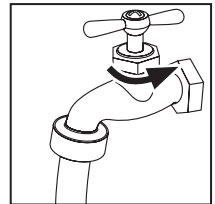
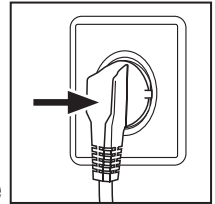

### PREPARING THE LAUNDRY

- Sort out clothes according to fabric (cotton, synthetics, wool or silk) and to how dirty they are.
- Separate white clothes from coloured ones. Wash them first by hand to check if they fade or run.
- Empty pockets (keys, coins, etc.) and remove the harder decorative objects (e.g. brooches).
- Garments without hems, underwear, finely woven textile such as fine curtains are to be put into wash bag (it is better not to wash them in a washing machine).
- Close zippers and hooks, make sure the buttons are sewn on tightly and place small items such as socks, belts, bras, etc. in the wash bag.
- Unfold large pieces of fabric such as bed sheets, bedspreads, etc.
- Turn shirts inside out.

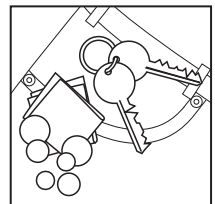
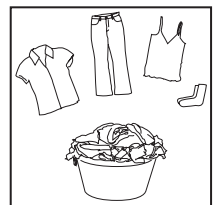

## LOADING THE MACHINE

Open the washer door, put in the laundry piece by piece. Close the door tightly.

- When first using the washing machine, let it run unloaded for one program to prevent the laundry from being tainted by oil or dirty water from the washing machine.
- Do not overload the washing machine.

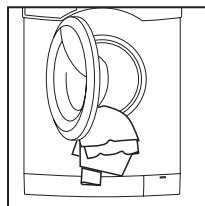

## SELECTING DETERGENT

The washing efficiency and the performance is determined by the quality of detergent used. Special non-foaming detergent produces good washing results. Use specific detergents for synthetic and woollen goods. Do not use dry cleaning agents such as trichloroethylene and similar products.

Note: Do not add more detergent than needed. Please follow the dosage recommendation on the detergent package.

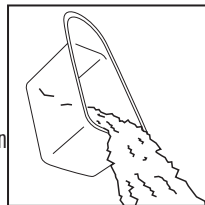

## ADDING DETERGENT

Slide out the detergent drawer and put the required detergent and softening agent into the corresponding compartments. Push back the drawer gently. (Refer to the instructions on the drawer)

Caution:

- For pre-washing program, detergent should be added to both compartments 1 and 2. For other programs, do not add detergent to compartment 1.
- Use liquid detergent according to the instructions on its package. Do not use liquid detergent if the pre-wash mode or "Start delay" is selected.
- Do not overuse softener; otherwise, it will damage the artificial fibers.

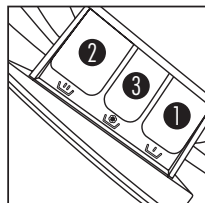

## SELECTING PROGRAM

To get the best washing results, an appropriate washing program should be selected according to the laundry type. There are instructions on the handle of the detergent distribution drawer. Please turn the program knob clockwise to select the right program.

## SELECTING FUNCTIONAL

Select the required options. (Refer to the "Control panel" pages 08 and 09)

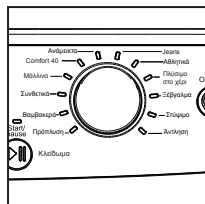

### SETTING WASHING TEMPERATURE

Press and hold down the temperature button until the desired temperature is selected or the symbol "—" for no water heating.

### SETTING SPIN SPEED

Press and hold down the speed button until the desired speed is selected or the symbol "0" is selected for no spin. See "Operational functions" on the "Control panel" pages (08 and 09) for selecting temperature and spin speed. It is advisable to select the recommended value.

### WASHING

Press the Start/Pause button. The washing machine will operate according to the pre-set programs. The washing machine will stop operation automatically when a washing cycle ends. The "End" sign will appear on the display. Open the washer door and take out the laundry.

### AFTER WASHING



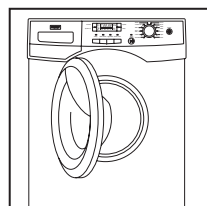
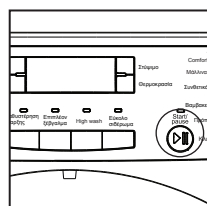

























Turn off the water supply and unplug the power cord. Open the washer door to prevent formation of moisture and odours. Let the door open while not used.



### TIPS FOR SAVING ENERGY

1. Collect clothes for one full wash load.
2. Avoid overloading the washing machine.
3. Pre-wash only heavily soiled clothes.
4. Reduce the amount of detergent or choose the speed up wash programs for slightly soiled clothes.
5. Choose a proper washing temperature. Modern detergents can wash with very good result already in lower temperature than 60°C. Only use higher temperature than 60°C for heavily soiled laundry.
6. Follow the dosage recommendation on the detergent package to avoid using too much detergent.
7. Softening agent makes clothes feel softer and easier to iron.
8. Adding fabric conditioner will also get rid of static condensation to make ironing easier.

## CARE CHART

	Resistant material		Bleachable in cold water		Don't dry clean	
	Delicate fabric		Do not bleach		Dry flat	
		Washable at 95 °C		Iron at 200 °C		Hung to dry
		Washable at 60 °C		Iron at 150 °C		Dry on clothes hanger
		Washable at 40 °C		Iron at 100 °C		Tumble dry, normal heat
		Washable at 30 °C		Don't iron		Tumble dry, reduced heat
	Hand wash		Dry cleaning with any solvent		Don't tumble dry	
	Dry clean only		Dry cleaning with perichloride			
	Wool Seal		Dry cleaning with aviation fuel			

## LOAD REFERENCE

Bed sheet (single)	Cotton	Approximately 800g
Blanket	Wool	Approximately 3000g
Blended fabric clothes	/	Approximately 800g
Jackets	Cotton	Approximately 800g
Jeans	/	Approximately 800g
Overalls	Cotton	Approximately 950g
Ladies Pyjamas	/	Approximately 200g
Shirts	/	Approximately 300g
Socks	Blended fabrics	Approximately 50g
T-Shirts	Cotton	Approximately 300g
Underwear	Blended fabrics	Approximately 70g