

User manual

mezzo vario

EN



Please read this user manual carefully prior to installation, use and maintenance for your own safety and in order to avoid damages on your system.

Konformitätserklärung

Declaration of conformity

Wir erklären in alleiniger Verantwortung für alle unsere Systeme, dass diese mit den folgenden Normen oder normativen Dokumenten übereinstimmen.

We declare under our sole responsibility that the systems, which have been brought into the market by us, meet the requirements of the following directives.

mezzo vario

**Richtlinie 93/42/EWG
des Rates vom 14. Juni 1993 über Medizinprodukte
Risikoklasse I nach Anhang IX Regel 12
CE Konformität nach Anhang VII
und
RoHS II (EG Richtlinie 2011/65/EU)**

***Council directive 93/42/EEC
of 14th June 1993 concerning medical devices
risk class I according to Annex IX standard 12
CE conformity of Annex VII
and
RoHS II (Council directive 2011/65/EEC)***

Die CE– Kennzeichnung auf dem Gerät dokumentiert diese Übereinstimmung.
The CE mark on the system points out this accordance.

Alsbach-Hähnlein,

08.10.2015

.....
Ort und Datum der Ausstellung
Place and date of issue

M. Reinecker Geschäftsführer
M. Reinecker General Manager

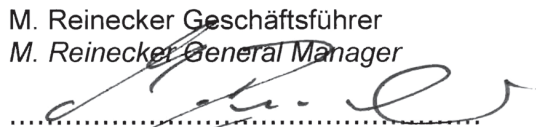
.....
Name und Unterschrift des Befugten
Name and signature of the authorized person

Contents

I. General information	6
Notes on the electromagnetic compatibility (EMC)	6
Storage of the user manual	6
Product description	6
Medical device	7
Purpose	7
Life span of product	7
Safety advice	7
Combination with other products	7
Precautions by alteration of the performance of the system	7
Reinstatement and installation	7
Cleaning of the system	8
Special advice for transport and storage	8
Disposal of the unit according to EU directive 2002/96/EEC	8
Power supply	8
Safety instructions	9
II. Instructions for the reading system mezzo vario	10
Delivery content	10
Optionally available accessories	10
Installation of the system	10
Connection of the unit	11
Alignment of monitor	12
Description of the control elements	13
Control panel base plate	13
ON/OFF (power switch)	13
Light ON/OFF/Dimm	13
Indicator for rechargeable battery	13
Control panel monitor	14
Left button:	14
Colour mode selection	14
Menu selection ON/OFF	14
Central button:	14
Adjustment of enlargement	14
Autofocus ON/OFF	15
Overview mode	15
Right button:	15
Automatic colour saturation	15
Contrast/Brightness	15
Windowing and line marker	15

Start-up mezzo vario	16
Mains operation	16
Power ON	16
Power OFF	16
Automatic save regulation for the device set-up	16
Replacement of lighting	16
Mobility pack/Use of battery	17
Operation of rechargeable battery	17
Replace the rechargeable battery	17
Use of battery	17
Battery charging	18
Operating time once the battery had been fully charged	18
Liability for defects on the battery	18
Description of the menu settings	18
Menu selection	18
Adjust menu settings	19
Explanation of the menu content	19
Menu settings	19
Check list: in case problems occur	23
Technical characteristics	24
Warranty Information	25
Notes	26

I. General information

Important notes on the operation of the reading system mezzo vario!

Please read them carefully prior to the operation of the reading system!

Notes on the electromagnetic compatibility (EMC)

This reading system is suited for use in all set-ups including the domicile that are connected directly to a public power supply for buildings with residential purposes.

This reading system is designed for the use in the indicated electromagnetic environment. The user should ensure the use in the indicated environment.

This reading system operates on HF-Energy exclusively for its own function.

Therefore the emitted interference of high frequency disturbances is very low and the interference with other appliances operated close-by is improbable. When operating the reading system simultaneously with other systems, however, the possibility of disturbances of the system or other systems should not be neglected.

For this reason it should be ensured that the system is not placed directly beside or on top of another system. If the set-up of this system in the proximity of medical, measuring devices cannot be avoided, the operator of these devices has to be informed that it is necessary to observe the performance of the system to control the conventional use of the system in the chosen set-up.

Electronic devices are sensitive towards electric discharge and towards high frequency electromagnetic fields.

Attention: In order to avoid high frequency disturbances the operator should respect a minimum distance of one meter to portable and mobile HF-telecommunication devices.

The device may not be used in the patients environment.

Storage of the user manual

The user manual is an essential part of your reading system. Please keep the booklet in a safe place for future reference.

Product description

mezzo vario is an opto-electronic reading system, which magnifies text and pictures. It may be used permanently for private and professional appliance. The text or pictures are being captured by the integrated camera and then displayed on the monitor.

- The transportable and compact reading system mezzo vario convinces by pin sharp pictures in HD+quality (1366 x 768 pixels).
- The Vario camera offers a magnification range from approx. 1x to 100x by offering reduced noise and almost no reflections even when reading glossy papers.
- Thanks to the easy movement of the monitor into three directions, the user will always read in the most ergonomic position.

Medical device

This reading system is classified as a Medical Device, class I according to 93/42/EEC, Annexe IX, standard 12. For the distribution to countries outside the EU the respective country-specific guidelines have to be regarded.

Purpose

This opto-electronic reading system is a medical device to assist with the reading and magnifying of printed text and pictures. Visually impaired people can compensate for their loss of visual acuity by using this device.

Life span of product

Seven years from the date of invoice (ex Reinecker). According to EEC the supplier of medical devices is obliged to define the life span of a product.

Note: The mentioned life span does not reflect the complete life span of the mezzo vario. It is rather an indication on when the product might be obsolete and substitution might be recommended due to new product developments.

Safety advice

mezzo vario has to be installed in closed and dry rooms only. Do not plug mezzo vario into an electrical circuit that is also being used for any life sustaining or support systems. The device may not be used in the patients environment.

This device should not be operated in explosion-endangered environments. This opto-electronic device should only be installed in conjunction with modern electrical circuitry. It is a device of protection class II. The openings in the casing ensure optimum cooling and must not be covered.

Combination with other products

Warning: This reading system must not be located directly beside, next or on top of another medical device. If the device is used near another electrical device, monitor the other device to ensure that it is working properly. In case of doubt please contact Reinecker Vision GmbH or any licensed distribution partner.

Precautions by alteration of the performance of the system

Stop using the reading device if technical features or performances should change. Switch the device off and disconnect the power supply from the mains wall socket. Refer directly to your authorized dealer or to Reinecker Vision GmbH Service Center.

Reinstatement and installation

This device may be technically maintained and reconditioned by Reinecker Vision GmbH only or by an authorized technician. Reinstatement may only take place after the system has been cleaned and safety checked.

Cleaning of the system

- mezzo vario has to be disconnected from the power supply before cleaning.
- The monitor and the system has to be cleaned with a glass cleaner.
- Interior of device must NOT come in contact with liquids.

Special advice for transport and storage

For reasons of safety, the unit must only be transported and stored in the original packing. The unit must be stored in dry and closed rooms in the original packing.

The following conditions for transport and storage have to be respected:

- Air pressure 700 - 1000 hPa
- Temperature range +5° to + 50°
- Relative air humidity 30% to 80%

Disposal of the unit according to EU directive 2002/96/EEC

mezzo vario contains of electronic components. In order to avoid damage to the environment, the country-specific rules have to be respected.

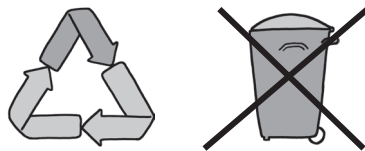

Power supply

Only use the original power supply which is included in the delivery by Reinecker Vision GmbH.

Caution: The use of any other equipment might lead to an increased electromagnetic emission and to a product damage.

Safety instructions

Please respect the following safety instructions:

1. Do not plug the AC adapter into a faulty electrical outlet. Doing so may cause electrical shock or fire.
2. Do not touch the AC adapter with wet hands.
3. Only use the original power supply which is included in the delivery by Reinecker Vision GmbH. The use of any other equipment might lead to a product damage.
4. Only use the original battery which is included in the delivery by Reinecker Vision GmbH. The use of any other equipment might lead to a product damage.
5. Do not expose the system to direct sunlight or to very hot or cold environment, as this would harm the picture quality.
6. Do not use this device below +5°C or above +40°C.
7. No liquids must reach the interior of the system. Only use the device in a dry environment.
8. The device may not be used next to medical devices (patients environment).
9. Do not lean on the screen, touch the screen with any object or lay heavy objects on the device. This may cause damage to the device.
10. Do not try to repair or to dismantle the system by your own. This would automatically void the warranty. If you need any technical assistance please get in contact with the local distributor or with Reinecker Vision GmbH.
11. Always switch OFF the system and disconnect it from the power supply before cleaning it. Only use a soft and slightly damped cloth. Only use a mild household detergent. Do not use alcohol containing or strong detergents.

II. Instructions for the reading system mezzo vario

Delivery content

- Reading system mezzo vario
- Power adapter 12V DC / 5000mA
- Adapter cable (country-specific)
- User manual
- Information sheet for repair cases

Optionally available accessories

- Mobility pack (battery and carrying case)
- xy-table

Installation of the system

Your reading system will normally be unpacked and set up by the supplier's representative. If you have not purchased an optionally available stand that fits to the product you must provide a solid surface for the system with sufficient surface area.

Set up your mezzo vario as described below:

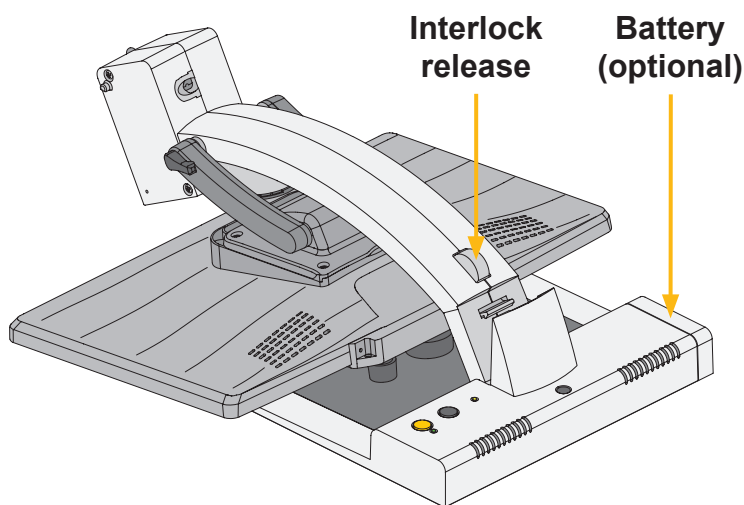

- Folded mezzo for transport

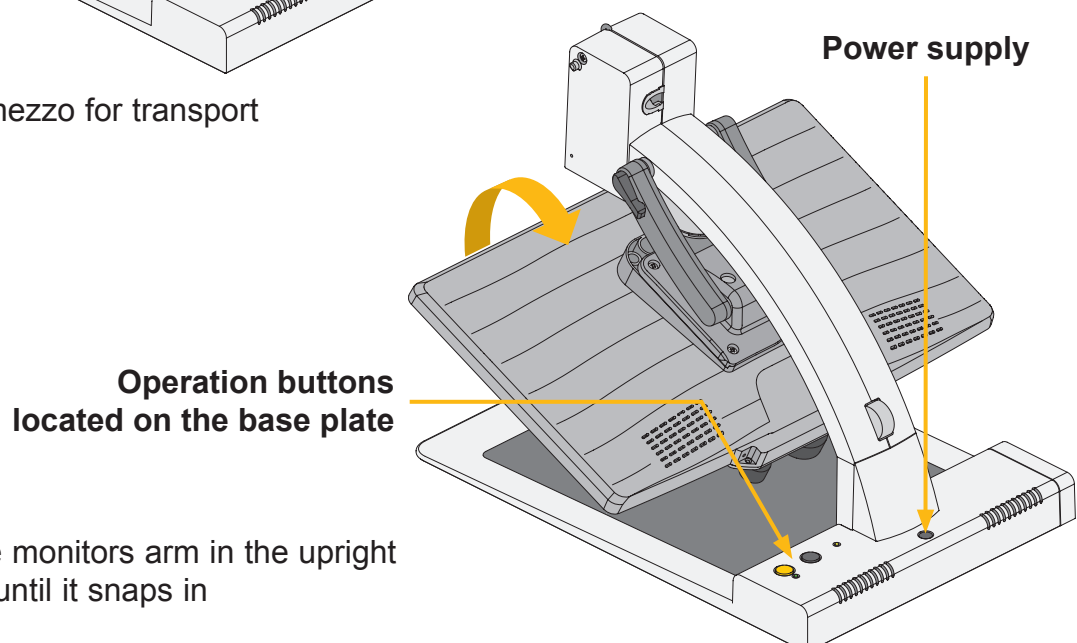

- Bring the monitors arm in the upright position until it snaps in

- Release the locking lever in order to move the monitor into the upright position. Use the integrated grip to do so.

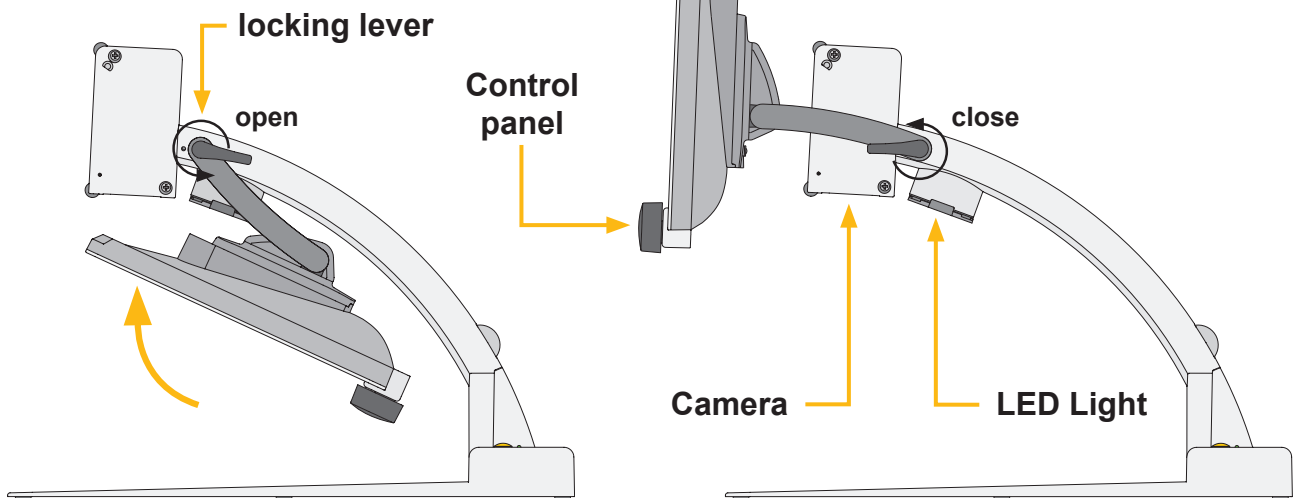

- The locking lever can be brought into the desired position, by pulling it out.

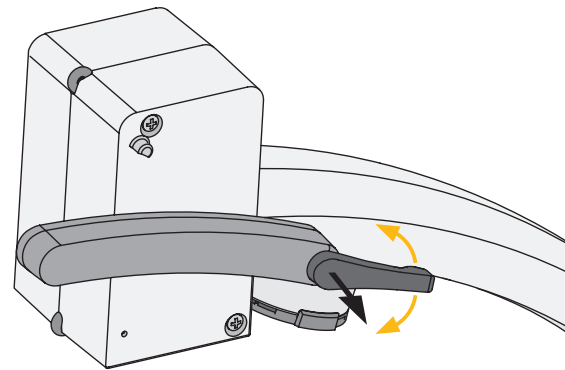

Connection of the unit

Connect the power supply to a mains wall socket and plug the adapter end of the cord into the DC12V power supply socket located on the base plate of the mezzo vario.

Note: The delivered power cable is to be used exclusively in connection with the mezzo vario.

Once the device is plugged in, it is ready to use.

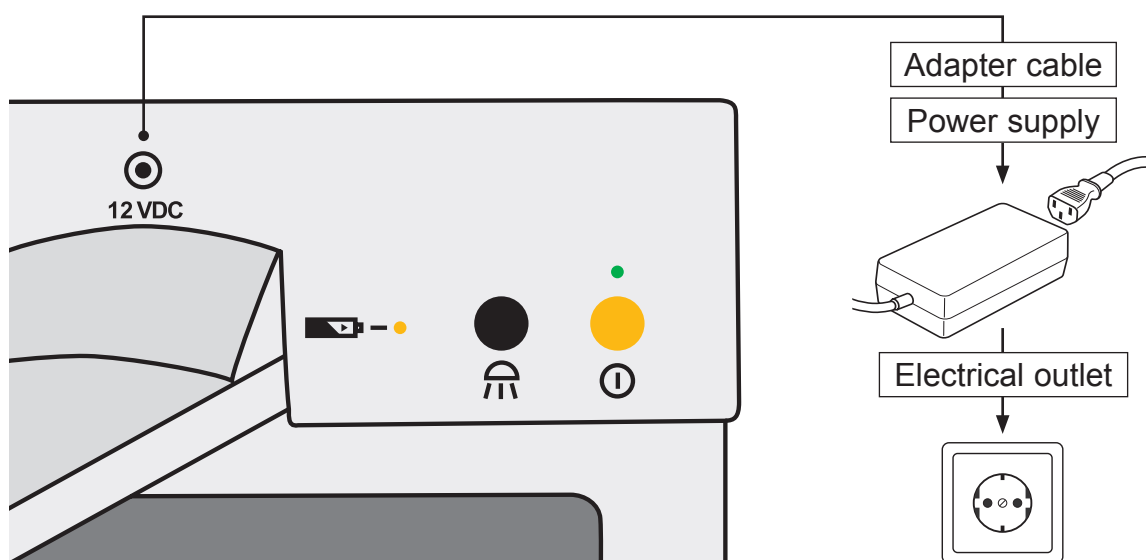

Alignment of monitor

Due to the monitor's technology contrast and brightness change depending on the angle of view.

The highly flexible three-dimensional monitor arm enables the user to adjust the monitors height and angle according to their best ergonomic position.

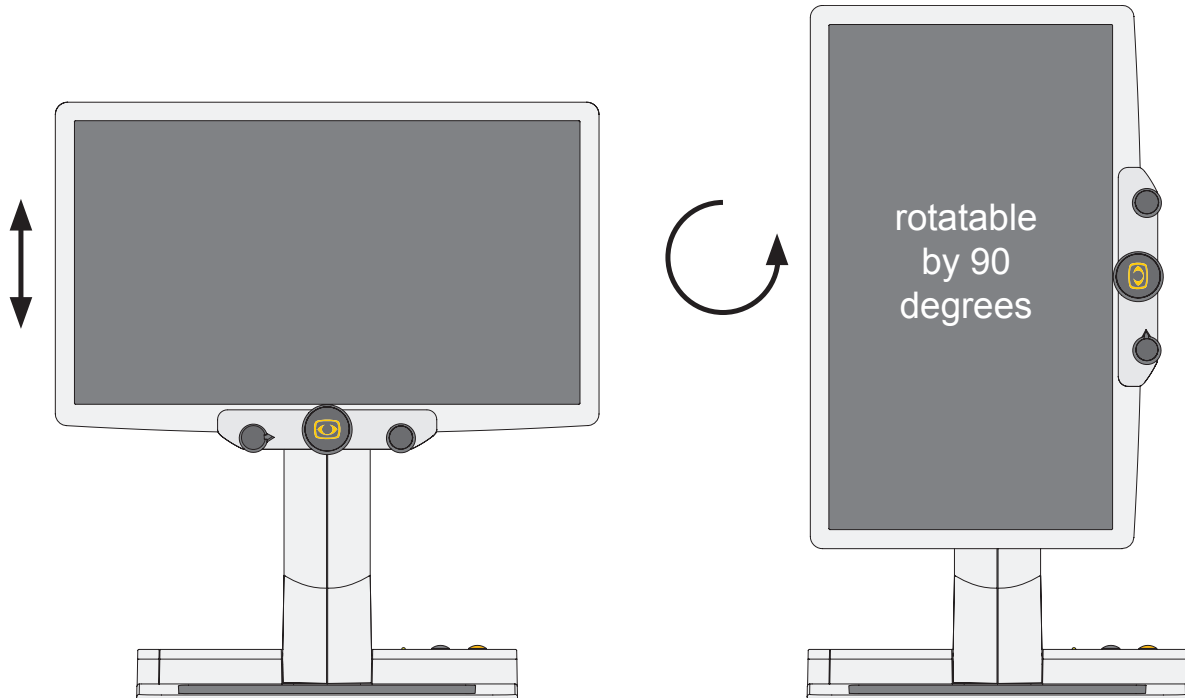

- The monitor can be moved vertically up and down.
- The monitor can be rotated anticlockwise by 90 degrees in order to make column reading easier. The image will adapt automatically to the monitors position.

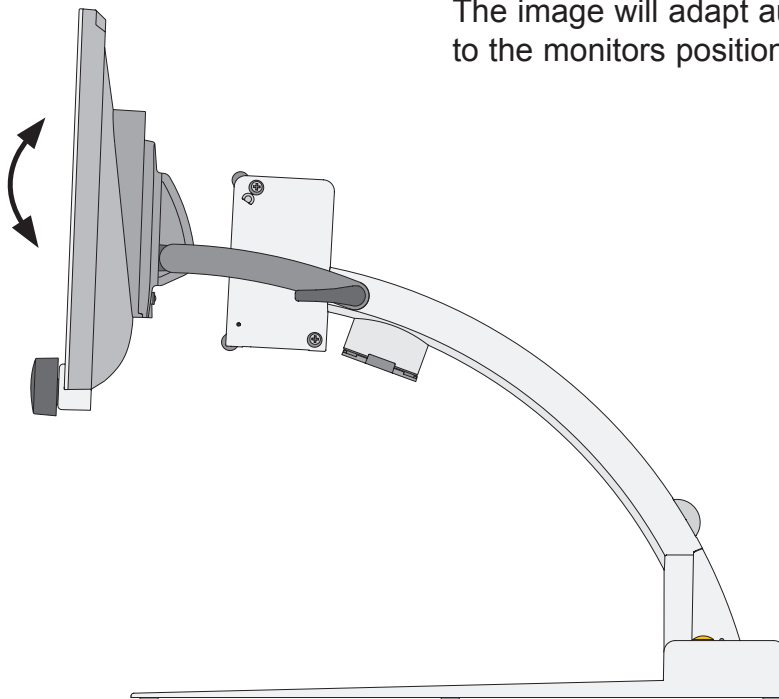

- The monitor can be tilted up or down.

Description of the control elements

Control panel base plate

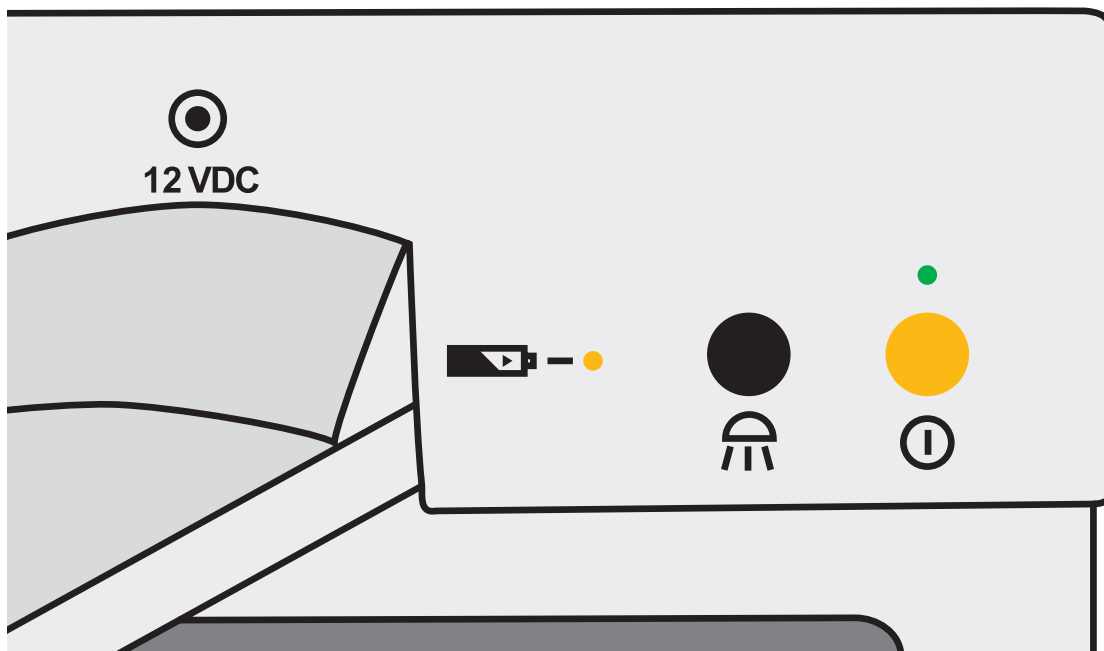

ON/OFF (power switch)



By pressing the power switch on the right side of the base plate the electronic magnifier is switched on.



Attention: If there is no light after the unit has been turned ON, press the “light” button (see Light ON/OFF/Dimm). If there is still no light, double check if the power cable has been connected correctly and if there comes electricity from the wall socket.

Light ON/OFF/Dimm



- Switch between full light and dimmed light, by pressing the black button briefly.



- Turn OFF the light by pressing and holding the black button for some seconds.

- Turn ON the light again by pressing the black button briefly.

Note: Whenever the mezzo vario will be turned ON, the maximum light will be activated.

Indicator for rechargeable battery



Only operates with built-in battery, see page 17 (mobility pack/ use of battery).

Control panel monitor

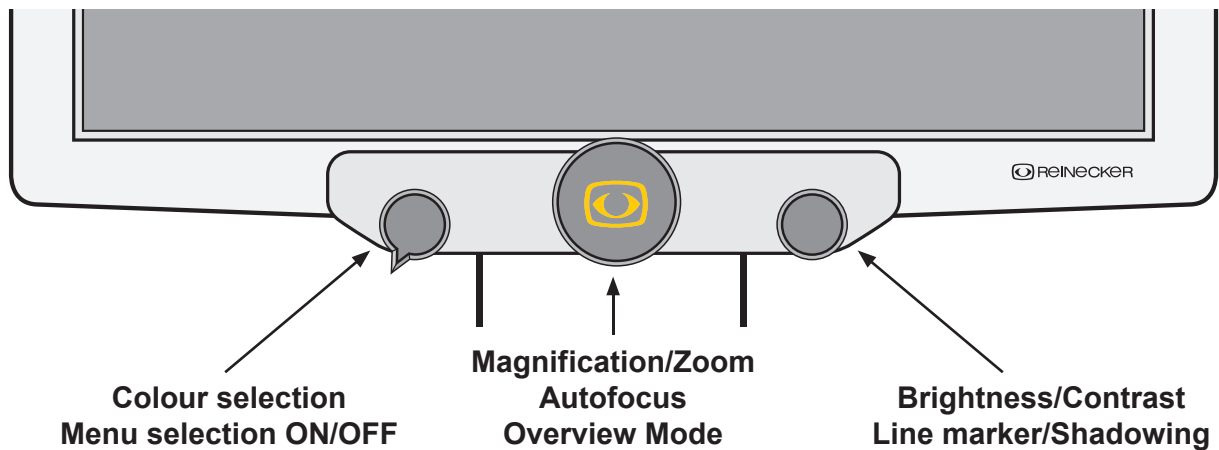

Left button:

Colour mode selection

By turning the colour mode selection-button from the left to the right the following colour modes can be selected:



- Position 1: full colour display
- Position 2: black font, white background
- Position 3: white font, black background
- Position 4: green font, black background
- Position 5: yellow font, black background
- Position 6: yellow font, blue background

The chosen colour mode appears temporarily on the lower side of the screen (when activated).

Note: The above mentioned colour combinations correspond to the factory settings. However, the user can reduce those colour combinations in the user menu. When reducing the colour combinations, the colour selection button split the remaining colour combinations evenly.

Menu selection ON/OFF

When pushing the left button for approx. 2 seconds the internal menu will be shown on the screen. Press and hold it again for approx. 2 seconds, until the internal menu will disappear.

Central button:

Adjustment of enlargement

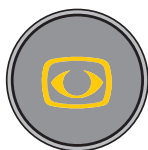

By turning the central button (from left to right) text and pictures can be zoomed in and out continuously.

Magnification range is from approx. 1x to 100x, however, it's dependent from the distance between the camera and the object to be displayed.

The last magnification set will be memorised and displayed when turning mezzo vario ON again.

The current magnification will be displayed briefly at the downside of the screen (this display can be deactivated in the user menu).

Note: The camera is equipped with an autofocus. When turning the central button to the maximum magnification, objects of a height of approx. 7cm shall be displayed sharply. Sharpness can be enhanced in the internal menu or when switching to artificial colour mode.

Autofocus ON/OFF

By briefly pressing and releasing the central (“zoom”) button you can activate/deactivate the automatic focus. By having the autofocus activated the camera adjusts the picture sharpness automatically.

Overview mode

When you are reading at a higher magnification level and want to find out which part of the page you have reached this function helps you to get the overview.

Press the central („zoom“) button for approximately 2 seconds until the overview mode is activated. The image on the screen will minimise and you will see an overview of the whole document/image/printed text. A faded cross will appear and indicate the area that is currently being magnified. Once the central button is released it will return back to the reading mode and selected magnification level.

Right button:

Automatic colour saturation

Brightness and colour saturation are automatically adjusted, colours are displayed true to original.

Contrast/Brightness



By turning the button on the right, contrast and brightness can be adjusted.

Windowing and line marker

By pressing and turning this button, Windowing and line marker will be activated. To deactivate those functions, press the button again.

Start-up mezzo vario

Mains operation

Check if the power adapter is connected with the mains and the power supply socket (12 VDC) of the mezzo vario.

Power ON

Press the ON/OFF button to switch on the device. When the mezzo vario and the base plate is illuminated, you can put a page or an object onto the table.

All the optional settings – for example zoom, colour or brightness- can be adjusted individually.

Power OFF

Switch off the device by pressing the ON/OFF button.

Automatic save regulation for the device set-up

When you reset the device all settings used before will be activated again.

Replacement of lighting

The electronic magnifier is equipped with a high power LED Illumination. If replacement of the lamp is required it should only be done by a specialist or by Reinecker Vision GmbH.

Important note:

Please only use the power supply included in the delivery. Use of any other power supply will void the warranty.

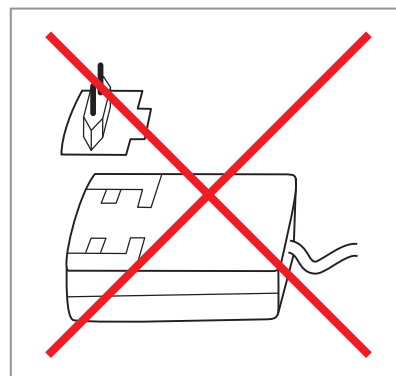
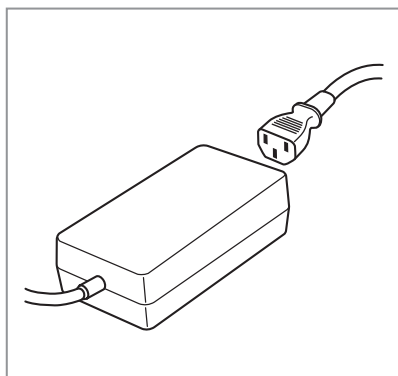

Mobility pack/Use of battery

A mobility pack (battery and carrying case incl. shoulder strap) can be ordered optionally.

Operation of rechargeable battery

Attention: In order to assure a long life span of the rechargeable battery you must follow the instructions for charging and operating the battery:

- The battery is only fully charged once the yellow charging light turns off.
- If mezzo vario will not be used for a long time, please charge the battery completely. Even if switched off, mezzo vario may discharge. Total discharge might damage the battery.

Replace the rechargeable battery

- You must only use the original rechargeable battery.
- Replacement batteries can be ordered through Reinecker Vision GmbH.
Article number: (MEZVARAK)
- The use of other rechargeable batteries will damage the system.
All warranties for mezzo vario will then be voided.
- To change the battery, please take it out first by pulling it out and put the new battery in until you recognize it locks.
- optionally the battery pack can be covered by a panel.

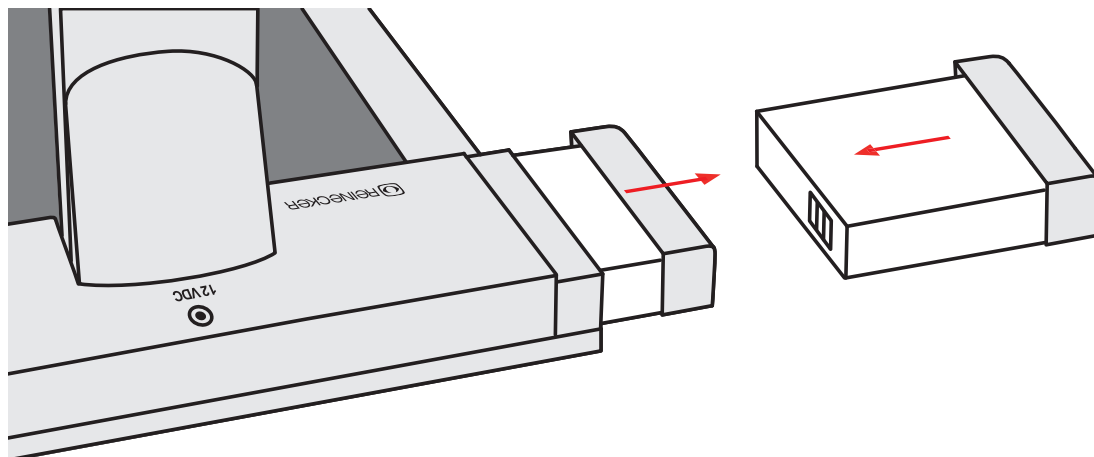

Use of battery

- plug-in power supply is not connected
- keep pressing the ON/OFF button for approx. 1 second; device is ready to be used
- after switching on the system, the battery indicator is shown on the display for approx. 6 seconds
- flashing of the battery indicator: battery is empty and has to be re-charged.
There is a remaining time of a few minutes before the electronic magnifier switches itself off
- Make sure the battery will be charged before use

Battery charging

- when the battery indicator flashes or the electronic magnifier has turned itself off
- connect plug-in-power supply
- battery is being charged; the yellow LED lights up
- when fully charged, the yellow LED disappears
- mezzo vario can be used again in battery mode
- mezzo vario can be used and operated whilst it is being charged

Operating time once the battery had been fully charged

- With a 16" class monitor: approx. 2,5 hours, depending on illumination used
- With a 19" class monitor, approx. 2 hours (depending on the illumination used)
- Charging time is approx. 3,5 hours, when the unit is turned OFF

Liability for defects on the battery

Batteries are subject to wear and tear and are thus excluded from liability.

Description of the menu settings

Menu selection



Press the colour selection button for approx. 2 secs until the menu appears on the screen.

Main Menu	
Brightness	+10
Contrast	+50
Color Saturation	- 30
Ruler / Mask	Aus
Ruler / Mask Settings...	
AF Mode	Continuous/Zoom
Reset to Factory Settings	
Recall User Settings...	
Advanced Settings...	
Exit	

Adjust menu settings

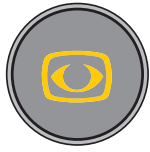

Turn the central zoom button in order to navigate through the menu.

Press the central zoom button in order to open the menu selection.

Turn the central zoom button in order to change menu settings.

Press the central zoom button in order to confirm menu settings.

Navigate to “exit menu” in order to quit OR keep the colour selection button pressed for approx. 2 secs until the menu will disappear from screen.

Explanation of the menu content

The image shows in detail how the menu is structured.

Main Menu	← Menu level 1
Advanced Settings	← Menu level 2
Special Settings	← Menu level 3
Customize Buttons	← Menu level 4
Function	adjustment range explication

Menu settings

Main Menu	
Brightness	adjustment range from -50 to +50
Contrast	adjustment range from -50 to +50
Color Saturation	adjustment range from -50 to +50
Ruler / Mask	OFF deactivate line marker and shadowing Ruler activate line marker Mask activate shadowing

Main Menu	
Ruler / Mask Settings	
Ruler / Mask	OFF deactivate line marker and shadowing Ruler activate line marker Mask activate shadowing
Ruler Position	0 to 100 adjust line marker position
Mask Position	0 to 100 adjust shadowing
Ruler Mode	Horizontal align line marker horizontally Vertical align line marker vertically
Mask Mode	Left/Right Shadowing left/right; shadowing up to 50% Top/Bottom Shadowing top/bottom; shadowing up to 50% Left/Right FS Shadowing left/right; shadowing up to 90% Top/Bottom FS Shadowing top/bottom; shadowing up to 90% Full-Screen Shadowing covers whole screen
Mask Transparency	50% 25% 0%
Main Menu	
Ruler / Mask Settings	
Ruler Color	
Red	adjustment range from 0 to 31
Green	adjustment range from 0 to 31
Blue	adjustment range from 0 to 31
Return	
Main Menu	
AF Mode	Continuous Semi-Autom. + Zoom Continuous / Zoom
Reset to Factory Settings	Return to factory settings
Recall User Settings	Return to customer selected settings
Advanced Settings	(see overview)
Exit	

Overview:	Advanced Settings	
	Color Combination Setup	
	Anti Reflection Mode	Auto (5)
	Monitor Brightness	100
	Language	English
	Perform White Balance	
	White Balance Mode	Auto
	Sharpness Settings	
	OSD Messages	OFF
	Special Settings	
	Return	

Main Menu	
Advanced Settings	
Color Combination Setup	
Color Combination 1-6	
Mode	Disabled Full Color Grayscale False Color
Foreground	Black Red Green Blue Yellow Magenta Cyan White User 1 User 2
Background	Black Red Green Blue Yellow Magenta Cyan White User 1 User 2
Swap Fore-/ Background	invert foreground and background colours
Return	

Main Menu	
Advanced Settings	
Color Combination Setup	
User colors	
User color 1 - Red	adjustment range from 0 to 31
User color 1 - Green	adjustment range from 0 to 31
User color 1 - Blue	adjustment range from 0 to 31
User color 2 - Red	adjustment range from 0 to 31
User color 2 - Green	adjustment range from 0 to 31
User color 2 - Blue	adjustment range from 0 to 31
Return	

Main Menu	
Advanced Settings	
Anti Reflection Mode	OFF ON Auto (0-9) adjust default value
Monitor Brightness	adjustment range from 37 to 100
Language	English German French Norwegian
Perform White Balance	execute white balance
White Balance Mode	Auto One-Push

Main Menu	
Advanced Settings	
Sharpness Settings	
Real Color Sharpness	adjustment range from 0 to 24
False Color Sharpness	adjustment range from 0 to 24
Return	

Main Menu	
Advanced Settings	
OSD Messages	ON OFF
Special Settings	<i>(see overview)</i>
Return	

Overview:	Special Settings
	Zoom Extension ON
	Max. Digital Zoom 3.5x
	Customize Buttons
	Store User Settings
	Recall User Settings
	Reset to Factory Settings
	Expert Settings
	Monitor size 19"
	Return

Main Menu	
Advanced Settings	
Special Settings	
Zoom Extension	ON OFF
Max. Digital Zoom	OFF adjustment range from 1,5x to 15x

Main Menu	
Advanced Settings	
Special Settings	
Store User Settings	Confirm selection to the user setting to save
Recall User Settings	Confirm selection to the user setting restore
Reset to Factory Settings	Confirm to the factory setting restore
Expert Settings	Access - only by authorized service
Monitor size	16" class 19" class
Return	

Check list: in case problems occur

Problem	Solution
Dark image No display of the image	Have the lights turned OFF? Have the lights switched ON? If not: What is the charging status of the battery? Is the power supply connected? If so: Check the correct settings of the image (brightness, contrast)
Missing colour	Is the reading material you want to see displayed in colour? Make sure you are in colour mode.
Battery does not charge The yellow LED does not light up	Check if the power supply is properly connected to the socket and the adapter is correctly contacted.

Technical characteristics

- **LED flat screen monitor:** 19" class (48cm) or alternatively 16" class (41cm), height adjustable, vertically inclinable, rotatable
- **camera:** magnification range from approx. 1x - 100x
- **System resolution:** 1366 x 768 pixels
- **Battery** lithium polymer battery, replaceable
- **Operating time of battery:** approx. 2 hours with a 19" class monitor (depending on the illumination used)
approx 2,5 hours with a 16" class monitor (depending on the illumination used)
- **Charging time of battery:** approx. 3,5 hours
- **Autofocus:** can be switched OFF
- **Colour modes:** True colours, preset and individually adjustable artificial colour modes
- **Weight:** approx. 6,2kg (19" class monitor)
approx. 5,3kg (16" class monitor)
- **Measurements (WxHxL):** erected: approx. 45x50x52cm
folded: approx. 45x18x52cm
(with a 19" class monitor)
erected: approx. 39x49x49cm
folded: approx. 39x18x49cm
(with a 16" class monitor)

Warranty Information

1. Reinecker Vision GmbH grants a warranty of 24 months (warranty period only valid within the European Union) against defects in manufacture counted from date of invoice ex Reinecker Vision GmbH.
2. All parts that have been replaced when repairing the unit will automatically become property of Reinecker Vision GmbH.
3. Damage caused by improper use or by non-compliance with the operating instructions will result in the invalidation of the warranty.
4. Interventions from persons other than Reinecker Vision GmbH authorised specialists may lead to invalidity of warranty.
5. Not included in this warranty are light sources serving to illuminate the reading object, batteries and other parts subject to wear and tear.
6. If a warranty claim is necessary, the system has to be returned to the manufacturer in Alsbach-Hähnlein or to your authorised dealer in the original packaging including all components. The manufacturer does not carry the cost for transport, packaging and insurance.

Phone number: +49 (0) 625793110

View our General Terms and Conditions.

Your authorized distributor:

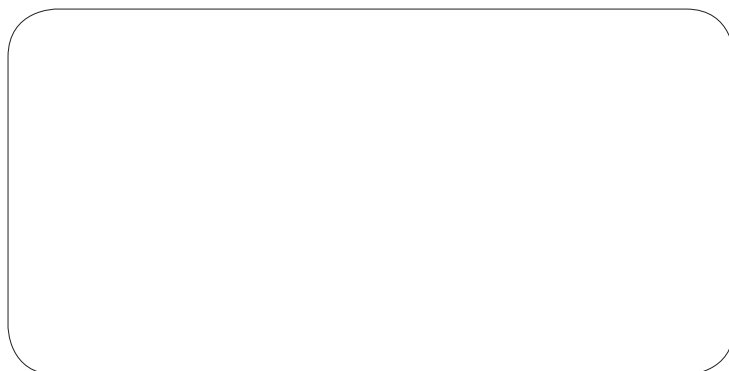

Notes

[illegible]

Type: mezzo vario

Serial-Number:

Manufacturer: Reinecker Vision GmbH

Final examination:

Power supply: 100 - 240VAC 50/60 Hz

over plug- in power supply: 12V DC / 5000mA Type: WTI205000

Power consumption: max. 80 Watt

**Reinecker Vision GmbH
International Contact**

sales department, customer relations:

Sandwiesenstraße 19
DE-64665 Alsbach-Hähnlein

customer service:

Erlenweg 3
DE-64665 Alsbach-Hähnlein

Tel.: +49 62 57-93 11-0

Fax: +49 62 57-93 11-8230

Email: info@reineckervision.com

www.reineckervision.com



In case service is necessary, please
contact your authorized distributor.

**Reinecker Vision GmbH
Zentrale Deutschland und Export**

Vertrieb, Kundenberatung:

Sandwiesenstraße 19
64665 Alsbach-Hähnlein

Kundendienst:

Erlenweg 3
64665 Alsbach-Hähnlein

Tel.: 0 18 05-54 56 65*

Fax: 0 62 57-93 11-8008

Email: info@reineckervision.de

www.reineckervision.de

*Festnetzpreis 14 ct/min, Mobilfunkpreis max. 42 ct/min

Bitte wenden Sie sich bei Fragen
oder einem Servicefall direkt an unser
Hauptwerk in Alsbach-Hähnlein oder
an eine unserer Niederlassungen.

Bei im Ausland erworbenen Produkten
kontaktieren Sie im Servicefall bitte
Ihren dort ansässigen Händler.