



USER'S MANUAL
version 1.1

English



HDR-105 HALOGEN DIMMER/SWITCH WITH TRANSFORMER

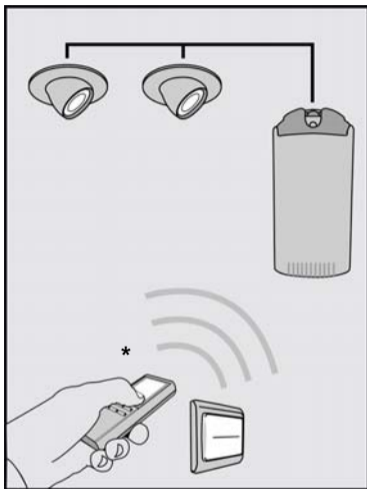

* Control your halogen lighting with one of the many COCO transmitters (not included)

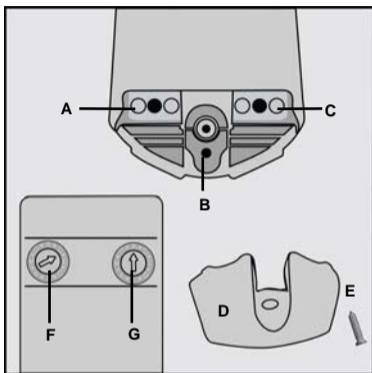

Front

- A:** Connection lamps
B: Wall mount
C: Mains connection
D: Protection cover
E: Mounting screw

Rear

- F:** House code selector
G: Number code selector

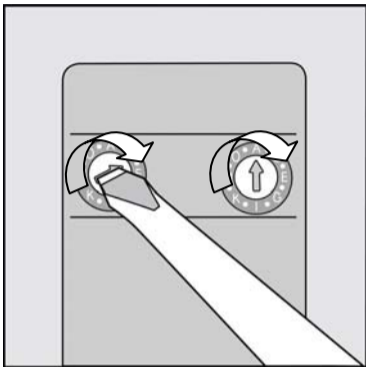

[1] Turn the code selectors to the desired letter and number combination.

⚠ *The COCO transmitter (e.g. remote control) must be set to the same letter/number combination (see the manual for the transmitter)!*

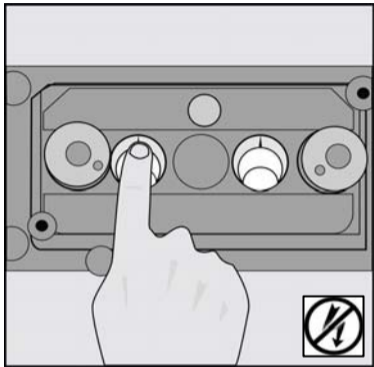

[2] Switch off the mains power (in the meter cupboard) before you begin to install or remove this product.

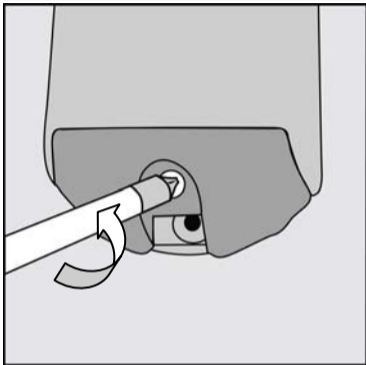

[3] Loosen the screw of the protection cover.

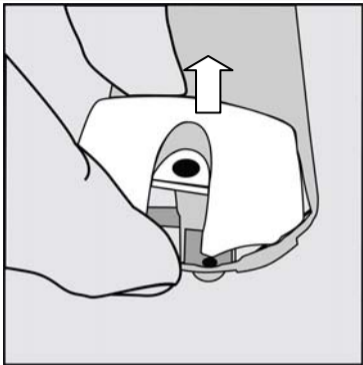

[4] Remove the protection cover from the housing by pulling the cover directly upwards.

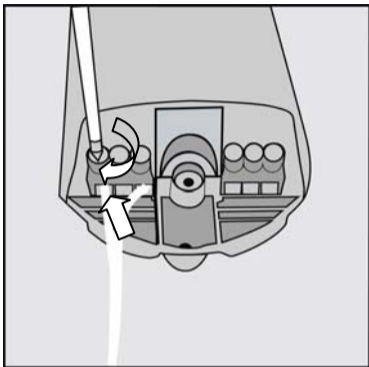

[5] Connect the lamps to the outermost two openings of the left terminal block ("SEC") as shown in the diagram in **[5a]** and tighten the screws.

⚠ The lamp leads must have a length of at least 30 cm and not more than 2 m!

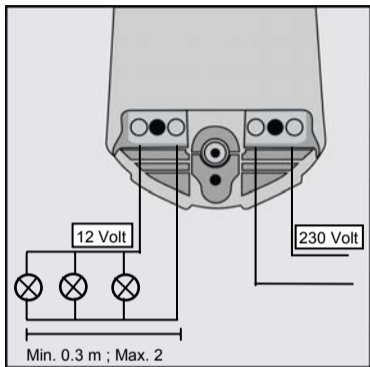

[5a] Connect the halogen lamps in parallel.

⚠ Never connect multiple lamps in series. Consult your installer in case of doubt!

⚠ Connect at least 35 Watts!

⚠ Connect a maximum load of 105 Watts!

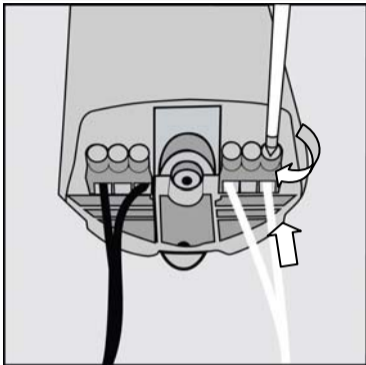

[6] Connect the blue and black mains wires to the outermost two openings of the terminal block on the right ("PRI"). Now tighten the screws.

⚠ *Your wire colours may be different. If in doubt, ask your installer!*

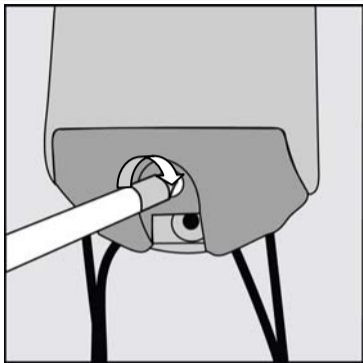

[7] Place the protection cover back on the housing and tighten the screw.

⚠ *Always install the protection cover before you switch on the mains power!*

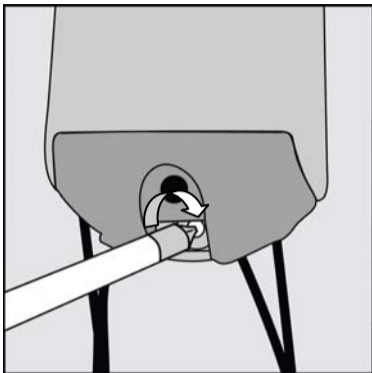

[8] Mount the product at the desired location.

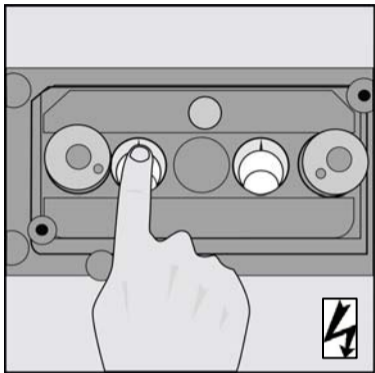

[9] Switch on the mains power again.

 *This product becomes warm during use. Install the product in a well ventilated area. The ambient temperature may not exceed 75 °C!*

Remarks **Reminders**

- This product must be used in combination with at least one COCO transmitter.
- This product is a combination of a transformer and a dimmer/receiver. Transformer: converts the 230 Volt alternating current to 12 Volt direct current for halogen lamps. Dimmer/receiver: controls the halogen lamps remotely, without complicated wiring.
- To prevent interference between devices, avoid placing multiple products close to each other. The minimum distance between units should be approx. 50 cm.
- The wireless system can be indefinitely expanded with other COCO remote controls and/or receivers.
- If the product does not work:
 - Make sure the set code is the same as the "house code" of the COCO transmitter **[1]**.
 - Make sure the product is connected correctly (repeat **[2 – 9]**).

 **Dimmer function**

- Dimming: Press the 'on' button of a remote control 3 times: (1) Press one time: The dimmer switches on. (2) Press again: The light intensity changes continuously. (3) Press a third time as soon as the desired light intensity is reached.
- When the dimmer is switched off, it will remember the most recently selected light intensity for the next time it is switched on.
- Never program dimmer receivers and on/off receivers together on the same button of the remote control.
- Do not program multiple dimmer receivers on the same button of the remote control; use separate buttons.

 **Safety instructions**

- Always switch off the mains power before installation or removal. Switch on the power again when you are completely finished with the installation or removal.
- Never install this product near fluorescent lighting.
- Do not run any wires for the lamps or mains power across the product.

- Do not place the product directly on the lamps.
- Always mount the protection cover [7] before use to prevent the wires from being pulled loose.
- The mains power must not exceed 230 Volts, 50 Hertz.
- Do not connect lamps that draw less than 35 Watts. In other words, one lamp of at least 35 Watts or multiple lamps totalling at least 35 Watts.
- The total load of the lamps must not exceed 105 Watts. For example, 1 lamp of 100 Watts, 2 lamps of 50 Watts, or 3 lamps of 35 Watts.
- Only use installation hardware that is approved and intended for the installation of halogen lighting.
- Do not attempt to repair this product. If the product is damaged or if you are in doubt about the proper operation, take the product back to the place of purchase.
- Never use COCO products for life support systems or other applications in which equipment malfunctions can have life-threatening consequences.
- Do not use the product in damp areas. Clean the device with a dry cloth.

Wireless

- This product works using a radio signal that passes through walls, windows and doors. The range is maximum 75 metres in the open air. The range indoors is strongly influenced by local conditions such as concrete, glass and metals. On average, the indoor range is approximately 30 metres.
- New double glass often includes a thin metallic layer. This type of glazing (“HR glass”) allows most visible light to pass through but has a negative impact on radio signals. If there is HR glass between the transmitter and receiver, you should expect a significant reduction of the range of the wireless signal.
- This product operates at a frequency of 433.92 MHz. It complies with the essential requirements and other conditions of R&TTE Directive 1999/5/EC and can be used in all EU countries.
- There may be restrictions on the use of this device outside the EU. If this device is used outside the EU, check whether the device complies with the local directives.



This product complies with the essential requirements and other relevant provisions of the applicable European directives. The Declaration of Conformity (DoC) is available at www.coco-technology.com.



If possible, submit this product for recycling after use. Do not dispose of the product with household trash.

Warranty and copyright

This device is covered by a 2-year warranty that begins on the day of purchase. Visit www.coco-technology.com/warranty for additional information. Reprinting of (portions of) this manual without permission from Pan-Trade International B.V. is expressly prohibited.



PAN-TRADE INTERNATIONAL B.V.

P.O. BOX 126
4760 AC ZEVENBERGEN
THE NETHERLANDS
www.coco-technology.com



Declaration of Conformity

Pan-Trade International BV declares that the COCO product, model:

type designation HDR-105 HALOGEN DIMMER/SWITCH WITH TRANSFORMER
item number 74022

is in compliance with the essential requirements and other relevant provisions of directives R&TTE 1999/5/EC, EMC 2004/108/EC and LVD 2006/95/EC and is compatible with the standards EN 300 220-1/3, EN 55015 and EN 301 489-1/3.

Manufacturer / Authorised representative,



M.A. Hoekstra, managing director
Zevenbergen, 2008-01-30