

**Valent V2**

THIS INTERFACE IS COMPATIBLE WITH:

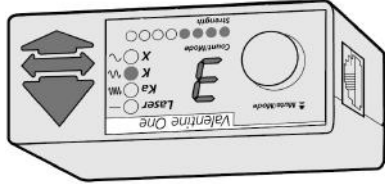

**Valentine One + Remote Display**

**INTERFACE**



## 1. Pack Contents

- 1 x In-line fuse unit (3 Amp)
- 1 x POWERSENSEnode engine running sensor
- 1 x Power cable
- 1 x RADARnode wireless transmitter
- 1 x RDI software card for the V1 (inserted in RADARnode)
- 1 x Radarnode connector cable
- 1 x Cheetah V1 remote adapter
- 1 x Cheetah connector cable for the V1
- 1 x User manual

Cheetah parts are pre-connected for your convenience. Our 2-pin mini connectors push-fit together and lock securely. To unclip, press the lever down and gently pull them apart.

**The RADARnode** is a wireless transmitter (433 Mhz) that connects up to your radar detector's power supply socket. When your radar detector gives an alert, the RADARnode digitally analyzes the alert data and transmits a radio code to your helmet display.

The small flying lead with half a bullet connector at the end (plastic sheathed) is an over-ride cable for connecting to a Cheetah Laser Jammer Interface in motorcycle installations.

**The POWERSENSEnode** is a clever "engine running" sensor that turns on power when you start up your motorcycle and turns it off when you stop the engine. It's an instant, "ignition-switched" supply that makes it quick and easy for anyone to create a safe power supply directly from the battery terminals. It eliminates the need for direct wiring into your bike's electrical system.

## The RADARnode Transmitter

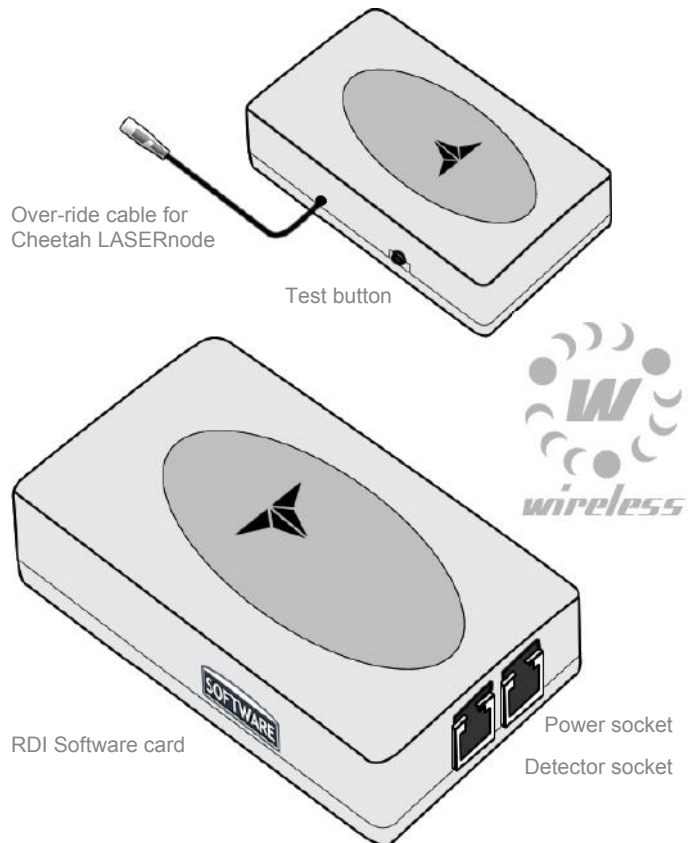

© 2009 Cheetah Advanced Technologies Ltd, Scotland. All rights reserved.  
 This device complies with Part 15 of the FCC Rules. Operation is subject to the following two conditions: (1) this device may not cause harmful interference, and (2) this device must accept any interference received, including interference that may cause undesired operation.  
 Cheetah Advanced Technologies Ltd. declares that this product is in compliance with the essential requirements and other relevant provisions of Directive 1999/5/EC.



If any problems persist, or to arrange a product return, please email [support@SpeedCheetah.com](mailto:support@SpeedCheetah.com)

Europe & Rest of World - visit [www.SpeedCheetah.com](http://www.SpeedCheetah.com)

USA & Canada - visit [www.GPSdetector.com](http://www.GPSdetector.com)

If for any reason your Cheetah product develops a fault, please check our Customer Service page on:

**Service & Support**

[www.SpeedCheetah.com](http://www.SpeedCheetah.com)

Cheetah Advanced Technologies Ltd. warrant our products against all defects in materials and workmanship for a period of **one year** from the date of the original purchase. Full warranty terms and conditions available online at:

**Limited Warranty**

Register online at [www.SpeedCheetah.com](http://www.SpeedCheetah.com)

**Warranty Registration**

**Warranty & Support**

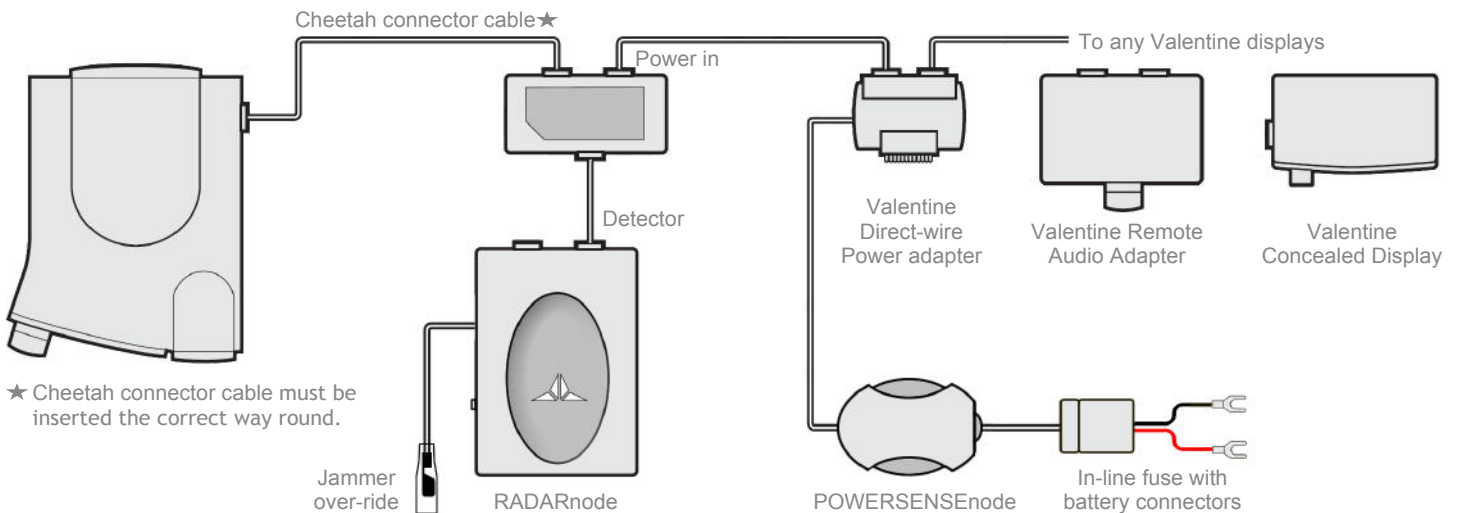

## 2. Installing the RADARnode

Instal the RADARnode according to the diagram above. Please note that the RADARnode transmitter is **not water-proof** so should always be positioned in the seat cavity.

**2.1** The Cheetah connector cable for the V1 must be installed the correct way round. Each end of the cable is labeled. **If the cable is inserted the wrong way round it will not work.** Plug the end labelled "V1" into your Valentine detector.

**2.2** Safely route the Cheetah connector cable from your V1 to the cavity underneath the motorcycle seat. Secure the cable to the bike wherever possible, avoiding contact with any high temperature engine components or exhaust system.

**2.3** Plug the RDI connector cable into the Cheetah V1 Remote Adapter, and then connect this to the DETECTOR socket of the RADARnode transmitter.

**2.4** Double check that the RDI software card and connector cable are specific to your radar detector. The RDI software card is pre-installed in the side of the RADARnode transmitter. **Always ensure that the power is OFF before removing or inserting your RDI software card.**

**2.5** Connect the Cheetah V1 Remote Adapter to the Valentine direct wire power adapter. Then use the Accessory socket of the direct wire adapter to connect up the Valentine Concealed Display or the Valentine Remote Audio Adapter (or both of them together.)

**2.6** To power the system, connect the Valentine direct-wire adapter to the POWERSENSEnode. The fuse pack can then be connected directly to the battery terminals. RED is positive, BLACK is negative. There is no need to remove the leads from the battery. Just loosen the nut on the clamp, slide in the spade terminal, and re-tighten the nut.

**2.7 OPTIONAL** - laser jammer installations only. Connect the small flying lead with the bullet connector to the similar over-ride cable on the Cheetah LASERnode.

## 3. Setting up your Valentine 1

V1 menu items can be set according to personal preference.

## 4. Using your VizAlert & Valentine 1

### 4.1 Starting up your system

The radar detector and VizAlert display work independently.

The POWERnode attached to the battery will automatically turn on the power to the RADARnode transmitter and radar detector when you start your motorcycle's engine. It will remain on for as long as the engine is running.

The VizAlert's battery pack has a sliding ON/OFF switch. All 6 LEDs will flash once, at the same time, to confirm it is switched on. When you power up your detector, the transmitter will begin to transmit to the VizAlert helmet receiver. The VizAlert LED's will flash in a circular sequence when the wireless link has been established.

### 4.2 Testing your system

Press and release the test button on the side of the RADARnode. The VizAlert will flash each LED in sequence. Remember, your engine must be running for the transmitter and detector to be powered up.

### 4.3 Alerts

Please refer to the VizAlert manual for interpreting alerts.

**Ku band users in Europe** - If Ku band is enabled, please note the V1 uses the same audio tone for K and Ku bands. The RADARnode will copy this and transmit a K band warning for both K and Ku alerts so the VizAlert will flash white for both K and Ku bands.

### 4.4 Switching off your system.

When you switch off your engine, power to the RADARnode transmitter and radar detector is automatically switched off.

The VizAlert is motion sensitive and switches off after 10 minutes of no movement.

The VizAlert V2's battery pack has a sliding ON/OFF switch and an automatic shut off, if you leave it on by accident.

## 5. Troubleshooting

### Constant KU Band radar alert

RDI software card is not correctly installed. It must be fully inserted into the slot on the side of the RADARnode. Switch off power, then remove the card and re-insert flush. **Always ensure that the power is OFF before removing or inserting your RDI software card.**