



User's Manual

SOLAR DECORATION LAMP

Dragonfly
Model no.: MS-7408



Butterfly
Model no.: MS-7409



Bee
Model no.: MS-7410

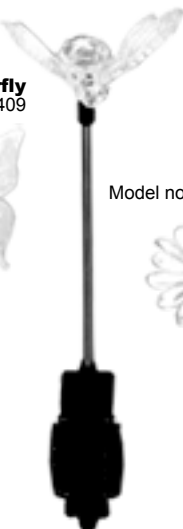

Flower
Model no.: MS-7411



Ball
Model no.: MS-7412



Star
Model no.: MS-7413



info@misssolar.com
made in China

User's Manual

LOCATION OF THE SOLAR LAMP

- 1) The solar lamp must be located in a position where it can get direct sunlight on the solar panel, and generally, free from cover and shade. (As shown in figure 1).
- 2) Make sure that the solar panel is not going to be affected by any other light source at night. Otherwise, the light may not illuminate at night.
- 3) The Solar lamp can be used immediately upon purchase by turning the switch to ON



ASSEMBLY INSTRUCTIONS

Ground Mounting

- 1) Carefully remove the solar lamp and all the fittings from the box.
- 2) Move the switch to the ON position. (As shown in figure 3) The lamp will automatically turn ON during the night time.
- 3) Assemble the mounting poles ②③ together.
- 4) Push the stake directly into the ground (DO NOT hammer the light or the stakes) (as shown in figure 2)
- 5) Install the lamp head on the top of the mounting poles carefully.

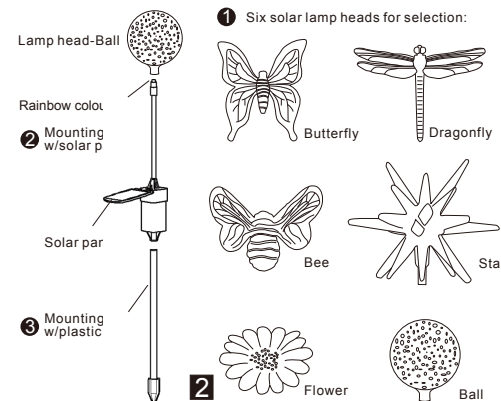

OPERATION

- 1) For daily/normal operation, move the switch to the ON position. (As shown in figure 3) The lamp will automatically turn ON during the night time.
- 2) The operating hours of the solar lamp during the night can vary from a few hours to throughout the night depending on the number of hours of sunlight received during the day.

REPLACING THE BATTERIES

For best results, replace the battery every 6-12 months.

- 1) Pull and separate plastic case ② from ①. (As shown in figure 3)
- 2) Remove the old battery, and replace it with 1 AA new rechargeable NiMH battery (not rechargeable alkaline battery) in the correct polar positions.
- 3) Turn the switch to ON position.
- 4) Reassemble plastic case ② back to ①

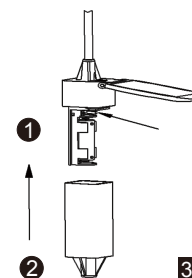

MAINTENANCE

Clean the solar panel regularly with a damp cloth to guarantee optimum performance of the solar panel. If any deposit on the solar panel, please clean it with alcohol liquid softly (do not use any other type of solvents) Otherwise, the solar panel performance will be affected. Please also be careful not to apply too much pressure on the panel while cleaning.

Important Notice To Users

The operating hours of the solar lamp during the night depends on the solar charge received during the day.

On a bright sunny day, the solar lamp may operate for more than 8 hours during the night, whereas on a cloudy day, it may operate for a few hours only. During winter, and especially when there is hardly any sunshine, the solar lamp may not operate at all.

We recommend that the battery in the solar lamp be taken out for charging electrically by the NiMH (not RAM) charger for use during winter. When the lamp is not being used for more than a month, remove the battery and store them separately.

Note: Please make sure to charge the new battery at least 6 hours continually under the direct sunlight for the first use.

