

RANGE HOOD

USER'S MANUAL

PHILCO



Famous for Quality the World Over

PEI 9703

PEI 9704

**Dear customer,
Thank you for buying a PHILCO brand product. So that your appliance serves you well, please read all the instructions in this user's manual.**

CONTENTS

PART 1: IMPORTANT SAFETY INSTRUCTIONS.....	2
PART 2: DESCRIPTION OF THE APPLIANCE	4
PART 3: INSTALLATION	5
Unpacking.....	5
Dimensions of the appliance.....	5
Placement.....	6
Assembly and installation of the appliance.....	6
Carbon filter.....	12
Ventilation.....	12
PART 4: OPERATION	13
Models with digital controls – 3 speeds.....	13
Models with digital controls – 5 speeds.....	13
Models with an LCD display – 5 speeds	14
Operating tips.....	15
PART 5: MAINTENANCE AND CLEANING.....	16
Changing a light bulb.....	16
Cleaning.....	17
PART 6: BEFORE YOU CALL THE SERVICE CENTRE	19
PART 7: TECHNICAL SPECIFICATIONS.....	20

PART 1: IMPORTANT SAFETY INSTRUCTIONS

Recommendation:

Carefully read these instructions before installing and operating this range hood.

Write down the serial number found on the rating label of the range hood in the space below. It is essential that you store this user's manual in a safe place so that you can use it in the future. If you intend to sell the appliance, give it to another owner, or if you move, always make sure that the user's manual is attached to the appliance, so that the new owner can also learn about the operation of the appliance and the relevant warnings.

SERIAL NUMBER:

Important safety instructions

- This appliance is designed for household use only.
- Before connecting the power cord plug, make sure the voltage stated on the rating label of the appliance corresponds to the voltage in your wall socket. Connect the power cord plug to a power socket with a voltage of 220 – 240 V ~ 50 Hz.
- Only use a properly grounded power socket. The appliance may only be connected to a properly grounded power socket.
- All electrical connections must be performed by a qualified electrician.
- Installation performed by an unqualified person may cause incorrect operation, damage to the appliance, create a fire hazard or cause injury to persons.
- Neither the manufacturer nor the vendor take responsibility for damages caused by incorrect or unprofessional installation, connection or operation. Tampering with the appliance by an unqualified person will void the customer's right to a warranty repair.
- Do not expose the power cord to excessive pressure or loads, do not place heavy objects on it, it must not be tangled and it must not be stepped on. Do not locate the power cord in or on heat sources such as stoves, heating or other generators of heat. Otherwise this may damage the power cord or create a fire hazard.
- Only connect the power cord plug to a power socket after the entire installation is completed.
- The power plug serves as a disconnection device and for this reason the power socket must remain easily accessible for the event of a dangerous situation, unless it is connected into a terminal box.
- Do not touch the lights if the appliance has been running for some time. Lights heat up during operation and may cause burns.
- This appliance is designed for fume extraction during standard domestic use. Do not use the appliance for purposes other than those for which it was designed. Otherwise you expose yourself to the risk of a dangerous situation and voiding the warranty.
- Follow the instructions for installation and ventilation (with the exception of when a fire stove is used).
- Do not use the flambé cooking method under the range hood.
- Regularly replace the filters in the range hood. Otherwise this presents a fire hazard.
- Only use filters suitable for use with the range hood. The manufacturer or distributor will recommend the suitable filter type.
- Do not use the appliance without the aluminium filter inserted. Do not take out the filters while the appliance is on.
- Regularly clean the appliance to prevent a dangerous situation from occurring.
- Before cleaning, replacing filters, moving or any other maintenance, turn off the appliance and pull out the power plug from the power socket, or turn off the respective circuit breaker.
- If you are using another gas or natural gas appliance in the room at the same time, the fumes from this appliance must be spatially isolated.

- If a chimney is connected to the exhaust of the range hood, use pipes with a diameter of 150 or 120 mm. The pipe connection should be as short as possible.
- Keep packaging materials out of children's reach. They could suffer injury or suffocation.
- Children must be supervised to ensure that they do not play with the appliance. If the power cord is damaged stop using the appliance. Have the power cord replaced at an authorised service centre or by another qualified person. Under no circumstances should you replace the power cord yourself.

To ensure safety, use a fuse with a maximum rating of 6 A.



WARNING!

This appliance must not be used by persons (including children) with physical or mental impairments or by inexperienced persons, unless properly trained or schooled in the safe use of the appliance, or unless they have been properly supervised by a qualified person who will be responsible for their safety.

Attention when transporting or carrying

The packaging materials are from recyclable materials, so dispose of them in an environmentally conscientious manner according to regulations in force.

During transport adhere to the symbols of the cardboard box.

When carrying the appliance, hold it by the respective handles.

NOTE:

We recommend that you keep the original packaging at least for the duration of the warranty period for the event of repair or refund and transport to the authorised service centre. Adhere to the symbols on the cardboard box.

If you do not have the original cardboard box, adhere to the following instructions:

- a) Do not place any items on the appliance that could damage the appliance during transport.***
- b) Protect the appliance against impacts, falls, etc.***
- c) Wrap the appliance, e.g. in bubble wrap which will protect the appliance from damage.***

NOTE:

The carbon filter is not included.

NOTE:

If the building is equipped with a heat recovery system system, it is necessary to setup the appliance for internal air circulation (without an exhaust). In that case, it is necessary to purchase the carbon filter.

PART 2: DESCRIPTION OF THE APPLIANCE

PEI 9703



1. Outer chimney
2. Inner chimney
3. Tempered glass
4. Lighting
5. Aluminium filter
6. Control panel

PEI 9704



1. Outer chimney
2. Inner chimney
3. Lighting
4. Aluminium filter
5. Control panel

Remote control (Optional accessory)

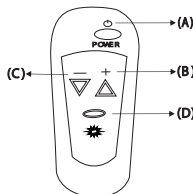

- A. Turn the appliance on / off
- B. Increase the exhaust power
- C. Decrease the exhaust power
- D. Turn the lights on / off

PART 3: INSTALLATION

Unpacking

- After unpacking remove all packaging and advertising labels from the appliance.
- Check that the appliance has not been damaged and that the package includes all the items described in this user's manual.
- If the appliance was damaged during transport, contact authorised service centre.
- Do not use a damaged appliance under any circumstances.

IMPORTANT:

Ensure that children do not play with the packaging material.

Dimensions of the appliance

PEI 9703

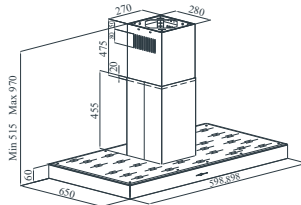

PEI 9704

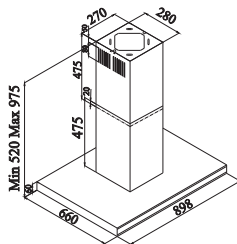

Supplied accessories (depending on the model)

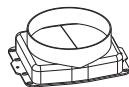

A non-return exhaust flap must be installed into the air outlet of the range hood (unless one is already factory installed).

Placement

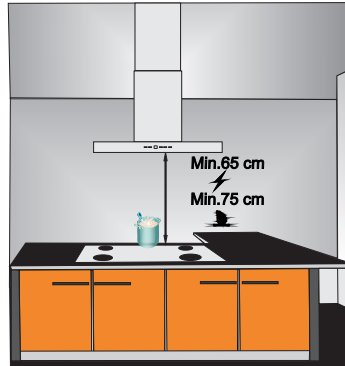

Install the range hood at a height of at least 65 cm above an electric cooktop or at a height of 75 cm above a gas cooktop.

Assembly and installation of the appliance

Before assembling and installing the appliance carefully read these instructions and adhere to them.

NOTE:

Dowels, screws and the hanging plate are supplied together with the range hood.

IMPORTANT:

Before installing or using the appliance, please first read all instructions and check that the voltage and frequency values on the rating label correspond to the voltage and frequency in your electricity grid.

We recommend that the appliance be connected by a service technician or another qualified person in compliance with local codes and regulations.

Before starting the installation

- Check that the purchased appliance has the correct dimensions corresponding to the chosen installation location. Furthermore ensure that there is an electrical power socket available that will remain accessible even after the range hood is installed.
- Before installing the range hood, check that all necessary masonry work is complete.
- Have all electrical connections performed by a qualified person.
- We recommend that you remove the aluminium filters before installing the range hood.
- Check that there are no packaging materials or other materials, e.g. user's manual, warranty card or bags with screws, inside the appliance. These need to be taken out and kept for possible use in the future.
- We recommend that you disconnect and move to the side freely standing or built in stoves so that you have easier access to the rear wall or ceiling. If this is not possible place protective material on to the work area, cooktop or stove. This will prevent damaging these surfaces.
- Select an even surface for the necessary assembly of the range hood. Cover the surface with a protective material and place all parts of the range hood and fastening elements on to it.
- It is necessary that a qualified technician inspects the suitability of the supplied fastening material and other components for the specific wall / ceiling type. The wall / ceiling must be sufficiently strong to hold the weight of the range hood.

- Do not attach this range hood to a wall or cabinet furniture by tiling, plastering and do not glue it on using silicone glue. The appliance is designed to only be installed on a wall / ceiling.
- We recommend that always two people perform the installation of the appliance.

If your range hood is designed to be mounted to the ceiling, adhere to the following instructions.

- The range hood must only be suspended on ceiling beams or on load bearing ceiling beam connections.
- **Do not suspend** the range hood on false ceilings.
- The ceiling **must** have a load bearing capacity of at least 40 kg.
- The ceiling thickness **must** be at least 30 mm.

IMPORTANT:

THE RANGE HOOD MAY ONLY BE CONNECTED TO THE ELECTRICAL GRID AFTER THE ENTIRE INSTALLATION IS COMPLETE.

1) Installation of the hanging plate

Place the hanging plate on the ceiling and mark the points for drilling holes for the screws. Check that the front part of the hanging plate (labelled "FRONT") is facing in the same direction as the control panel.

- Into the designated locations A, B, C, D drill 10mm holes for screws. Depending on the surface of the ceiling use an appropriate drill bit size.
- Insert dowels into the drilled holes A, B, C, D. Check that the dowels are properly inserted.
- Use screws (5.5 x 45) to attach the hanging plate to the ceiling. Check that the hanging plate is firmly and properly attached.

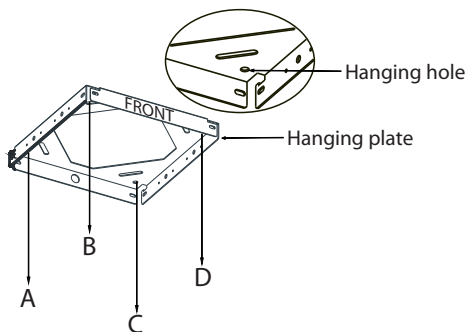

2) Installation of the angle sections

The front angle sections must be installed in the left-right direction and the rear angle sections the other way round.

Attach the angle section to the motor base according to the illustration. You can then set the height of the range hood by setting various positions of the angle sections relative to the motor unit. Check that all angle sections are installed at the same height and that the front part of the motor unit is facing in the same direction as the front part of the hanging plate and control panel.

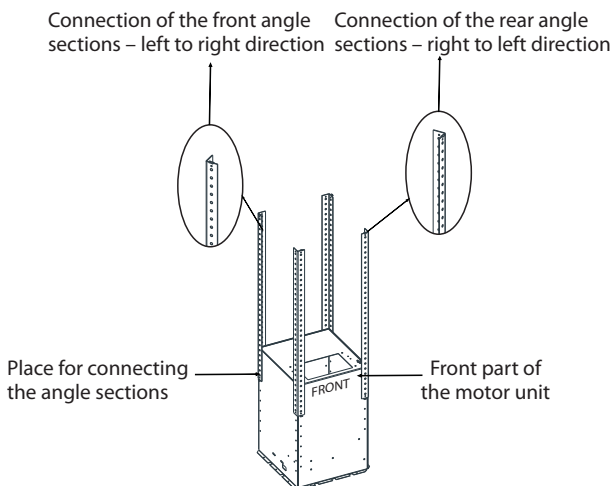

3) Installing the chimney to the motor unit

Insert the inner chimney into the outer chimney. To temporarily join the chimney use the screws from the motor unit. The chimney will then not fall during the installation to the hanging plate. The screw holes of the inner chimney should fit with the motor unit.

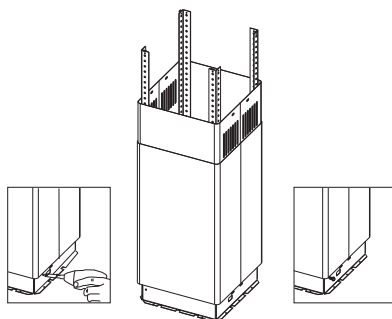

4) Attaching the motor unit to the hanging plate

Lift the motor unit and align the free ends of the angle sections with the corners on the hanging plate (see illustration below). Ensure that the front part of the hanging plate is facing the same direction as the front part of the motor unit and also as the control panel.

Use screws (3.5 x 9.5) to connect the ends of the angle sections to the corners of the hanging plate.

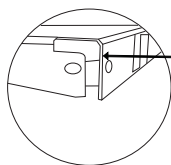
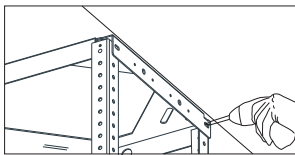

Place for connecting
to the hanging plate

5) Installation of the aluminium exhaust tube

Attach one end of the aluminium tube to the range hood flange and the other end to the air outlet. Check that both ends are firmly attached and secured in place.

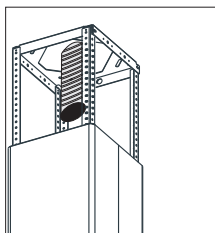

6) Attaching the inner chimney

Pull out the inner chimney in the upwards direction. Level with the hanging plate and attach using screws (3.5 x 9.5).

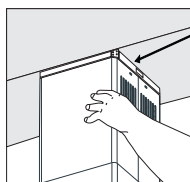

Place for connecting
the inner chimney

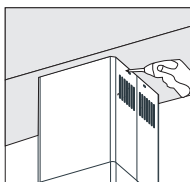

7) Removing the separation plate

To remove the separation plate hold the plate in the appropriate points on the left and right and pull downwards.

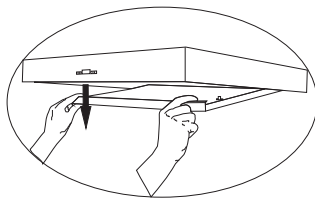

8) Connecting the control unit to the motor unit

Align the hanging hooks on the control unit with the appropriate holes for the hanging hooks on the motor unit and join together using screws (3.5 x 9.5)

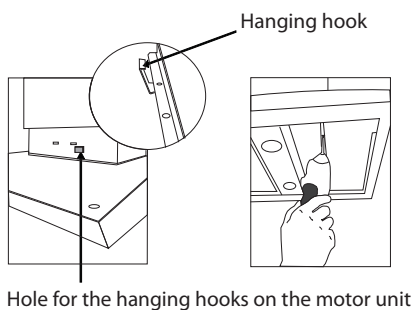

9) Wiring connection

Connect the 220 V socket for the power cord with an appropriate motor socket. Insert the aluminium filters when the connection is performed.

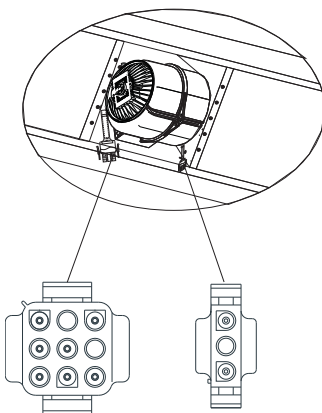

During installation perform the connection, as shown in the illustration below, to activate the use of the control panel. To connect, first bend the tabs outwards. They will connect after the connection is made.

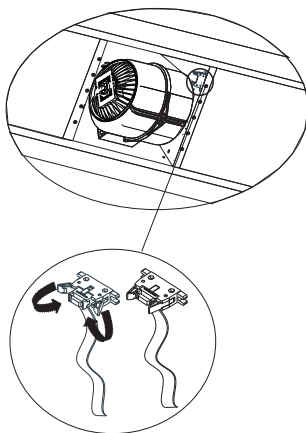

Carbon filter

If you are using the range hood without an air exhaust, it is necessary to use a carbon filter. The carbon filter is not included. Contact your vendor or an authorised service centre to purchase this filter.

- Before installing or replacing the carbon filter, check that the appliance is turned off and disconnected from the power socket or that the respective circuit breaker is turned off.
- It is necessary to replace the carbon filter regularly every 3 – 5 months depending on how much the appliance is used.
- Never wash the carbon filter in water unless the manufacturer states otherwise.
- Aluminium filters must always be installed even when the carbon filter is not installed. Do not use the appliance without the aluminium filter installed.

Replacing the carbon filter

1. For the correct operation of the appliance it is necessary to install a carbon filter. The number and type depends on the model.
2. Place the carbon filter on the motor outlets and turn it in the clockwise direction.
3. To remove the carbon filter turn it in the anticlockwise direction.

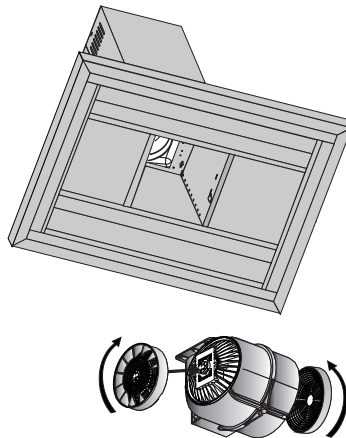

Ventilation

To ensure proper ventilation, leave windows closed while the appliance is turned on.



WARNING!

Pay increased attention if you are using the appliance together with another appliance that uses air or fuel for its operation (e.g. heating fan, fan, etc.) or that uses gas, coal or wood, as its operation may negatively affect the performance of the range hood because it expels air out of the room.

This warning does not apply if you installed the appliance without an exhaust out of the room.

PART 4: OPERATION

Remove the protective foil from the control panel.

Models with digital controls – 3 speeds

Exhaust power selection

This range hood is equipped with 3 levels of exhaust power. Select the power level based on the use of the stove and the amount steam that the pots emit.

Press the respective button on the control panel.

I – lowest exhaust power

II – medium exhaust power

III – highest exhaust power



Automatic timer (TIMER)

All models with a remote control are equipped with an automatic timer.

Press and hold the respective button for the exhaust power level for at least 2 seconds and the automatic timer function will be turned on for a period of 15 minutes. When the function is turned on, the respective symbol will appear on the display and the motor will turn off automatically after 15 minutes.

NOTE:

Use the range hood together with the stove. This will ensure the correct air exhaust. We recommend to leave the range hood running a few minutes longer than the stove to ensure that all odours are extracted.

Lighting

The range hood is equipped with lighting. Press the button with the light symbol to turn on the lights. Press the button again to turn the lights off.

Models with digital controls – 5 speeds

Exhaust power selection

This range hood is equipped with 5 levels of exhaust power. Select the power level based on the use of the stove and the amount steam that the pots emit.

To turn on the motor press the  button and to set the exhaust power level press the + or – button. Press the + button to increase the exhaust power and the – button to reduce the exhaust power.



Automatic timer (TIMER)

All models with a remote control are equipped with an automatic timer.

Press and hold the  button at the set exhaust power level for at least 2 seconds and the automatic timer function will be turned on for a period of 15 minutes. When the function is turned on, the respective symbol will appear on the display and the motor will turn off automatically after 15 minutes.

NOTE:

Use the range hood together with the stove. This will ensure the correct air exhaust. We recommend to leave the range hood running a few minutes longer than the stove to ensure that all odours are extracted.

Lighting

The range hood is equipped with lighting. Press the button with the light symbol to turn on the lights. Press the button again to turn the lights off.

Models with an LCD display – 5 speeds

This range hood is equipped with 5 levels of exhaust power. Select the power level based on the use of the stove and the amount steam that the pots emit.

On / Off button * – Press the button once to turn on the range hood. The initial exhaust power level is 2. Press again to turn the range hood off.

Setting the exhaust power level – To set the exhaust power level press the + or – button. Press the + button to increase the exhaust power and the – button to reduce the exhaust power. If you press and hold down the +/- button for at least 2 seconds, the exhaust power levels will increase / decrease in half-second intervals. If you set the exhaust power level to maximum (5), the appliance will work at the maximum exhaust power level for 15 minutes and then continue at the exhaust power level of 2. The maximum exhaust power level is called "turbo speed".

Timer

TIMER button – ⏻: Set the operating time of the appliance with a countdown feature during operation. Each time it is pressed the power level will decrease by 1 level. If you press and hold down this button for at least 2 seconds, the power level will decline faster.

TIMER button – ⏩: Set the operating time of the appliance with a count-up feature during operation. Each time it is pressed the power level will increase by 1 level. If you press and hold down this button for at least 2 seconds, the power level will increase faster.

Timer functions:

- Turn off the range hood** – If you set the timer while the range hood is running, the range hood will stop running, lights will turn off and a warning sound will be emitted for 5 seconds after the timer duration comes to an end.
- Alarm** – If you set the timer while the range hood is not running, then an alarm will be set. As soon as the set time of the timer comes to an end, a sound will be emitted for 15 seconds. The range hood will not stop and the lights will stay on, if the alarm timer turns off.

If a timer is not set, the clock is displayed.

Clock

The clock on the display shows the current time. If the clock is set, the colon between the hours and minutes will flash once a second.





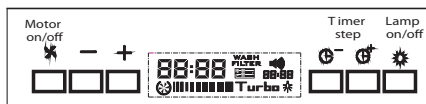



Setting the time

- Press the ⏻ and ⏩ buttons at the same time.
 - The hours and minutes will start to flash for 5 seconds.
 - In this time press the ⏻ or ⏩ button to set the hours or minutes.
- If a power outage occurs, it will be necessary to set the time again.



Additional functions

Additional functions may be set only when the motor and the lights are off.

- Setting the backlight brightness** – Press and hold the  button – after about 5 seconds the blue colour intensity in percent will appear (e.g. b00). Press the  button – once and the colour of the display colour will change to red (e.g. r100), press the  button – once more and the display colour to green (e.g. g10). After selecting the colour, use the  /  buttons to set the brightness of the respective display colour (e.g. 0 – 100). To confirm the setting press and hold the  button – for approx. 5 seconds. A sound will be made.
If you do not wish to save the setting, press the  button or the button for the light.
- Backlight** – The display backlight is always on. Press and hold the  button for approx. 5 seconds. A sound will be made. Now you can turn off the backlight. If you wish to again turn on the display backlight, press and hold down the  button for approx. 5 seconds.

Blue (%)	Red (%)	Green (%)	Colour
100	100	100	Turquoise
0	100	100	Light green
0	0	100	Green
100	0	0	Blue
50	100	0	Violet
0	100	0	Red
0	0	0	Colourless display
0	100	10	Orange

Operating tips

- Regularly clean the aluminium filters and regularly replace the carbon filters.
- Use the medium exhaust power level. Only use the highest power level when necessary.
- To ensure proper ventilation, leave windows closed while the appliance is turned on.

PART 5: MAINTENANCE AND CLEANING



WARNING!

Before cleaning, regular or other maintenance, installation or removal, check that the appliance is turned off and disconnected from the power socket or that the respective circuit breaker is turned off.

Changing a light bulb

- Turn off the appliance.
- Take out the aluminium filter.
- If the light bulb broke during operation wait until it cools down.

Models with a 50 W halogen light bulb

- To remove the halogen light bulb (50 W), press the light bulb holder downwards and gently turn it anticlockwise. Remove the light bulb.
- Install a light bulb with the same parameters in reverse sequence.

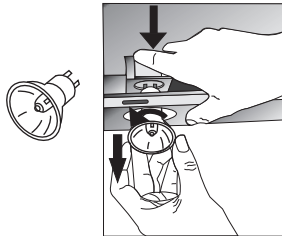

Models with a 20 W light bulb

- To remove the halogen light bulb (20 W), first remove the glass cover using a thin screwdriver. Be careful not to scratch the appliance. Remove a faulty light bulb by pulling downwards and insert a new working light bulb.
- Use a light bulb with the same parameters.

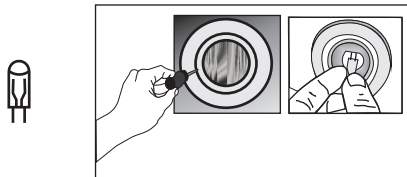

NOTE:

Do not hold the light bulb with your bare hands. Dirt or sweat from the hand may shorten their lifetime.

Cleaning

- Aluminium filters capture dust and fat from the extracted air.
- It is necessary to regularly wash these filters, ideally once a month, depending on the level of use. Wash the filters in water with dishwashing detergent, or you may place the filters in a dishwasher and wash them using a gentle program (max. 60 °C).
- Take out the aluminium filters by pressing the clip.
- After cleaning allow the aluminium filters to dry thoroughly before reinstalling them.
- Wipe the outer surface of the range hood with a clean damp wiping cloth lightly dipped in water with a small amount of dishwashing detergent. Then wipe dry.
- Avoid electrical parts coming into contact with water or another liquid.

Cleaning the aluminium filters

Models with digital controls – 3 speeds

Aluminium filters need to be cleaned when "C" (depending on the model) appears on the display, e.g. every 2 – 3 weeks (depending on the level of use).

Clean the filters according to the above mentioned instructions and after reinstalling them press and hold down the fan  button for 3 seconds until the "C" symbol (depending on the model) disappears from the display.

The symbol "E" (depending on the model) will appear on the display, which means that the appliance is ready for operation.

If you wish to use the appliance without clearing the "C" symbol (depending on the model), press the  button to start extraction for 1 second, then the "C" symbol (depending on the model) will appear again and the motor will continue running.

Models with digital controls – 5 speeds

The aluminium filters need to be cleaned when "C" appears on the display (depending on the model).

Clean the filters according to the above mentioned instructions and after reinstalling them press and hold down the fan button for 3 seconds until the "C" symbol (depending on the model) disappears from the display. The symbol "E" (depending on the model) will appear on the display, which means that the appliance is ready for operation.

If you wish to use the appliance without clearing the "C" symbol (depending on the model), press the fan button to start extraction for 1 second, then the "C" symbol (depending on the model) will appear again and the motor will continue running.

NOTE:

The "C" symbol (depending on the model) appears on the display after approximately 60 hours of operation.

Models with an LCD display – 5 speeds

The aluminium filters need to be cleaned when  appears on the display.

Clean the filters according to the above mentioned instructions and after reinstalling them press and hold down the fan button for 3 seconds until the  symbol (depending on the model) disappears from the display.

NOTE:

The  symbol (depending on the model) appears on the display after approximately 60 hours of operation.

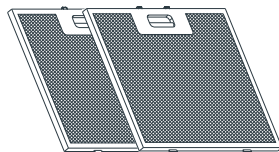
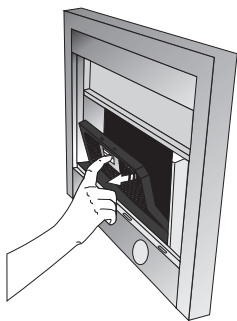
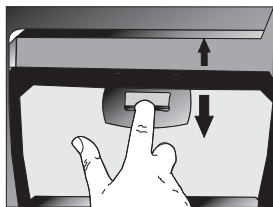

WARNING!

For cleaning do not use petrol, benzene, thinners or any other solvents, coarse cleaning agents, steel wool or any sponges with steel wool.



WARNING!

You may put the aluminium filters in a dishwasher. The colour of the aluminium filters may change after several washes. This is normal.

PART 6: BEFORE YOU CALL THE SERVICE CENTRE

If the appliance is not working as it should check the following recommendations for resolving the most common problems.

If the problem persists or it is not included in the table below, turn off the appliance and disconnect it from the power socket and contact an authorised service centre.

Problem	Solution
The range hood is not working.	Check that the power plug is properly inserted in a properly grounded power socket with the parameters 220 – 240 V ~ 50 Hz.
	Check that the motor power switch is in the "On" position.
The lights are not working.	Check that the power plug is properly inserted in a properly grounded power socket with the parameters 220 – 240 V ~ 50 Hz.
	Check that the motor power switch is in the "On" position.
	Check whether the light bulb or fluorescent tube is broken.
Exhaust power is weak.	Check whether the aluminium filters are dirty.
	Check the air outlet, it should be open.
	Check whether the carbon filter is not too dirty.
The range hood does not extract the air directly out (for models without an exhaust).	Check whether the aluminium filters are dirty.
	Check whether the carbon filter is not too dirty.

ATTENTION:

Use the range hood together with the stove. This will ensure the correct air exhaust. We recommend to leave the range hood running a few minutes longer than the stove to ensure that all odours are extracted.

PART 7: TECHNICAL SPECIFICATIONS

	PEW		PEI	PEC 6405 - PEC 9405	PEC 5507 - PEC 6507	PEB 6408	PEC 5406 - PEC 6406	PEB 6708
SPEED 1	Voltage (A)	0,5	0,6	0,5	1	0,6	0,6	0,5
	Power (W)	105	90	70	135	80	80	110
	Air flow (m ³ /h)	180	230	190	250	190	155	210
	Pressure (mmH2O)	130	155	170	160	160	180	155
	Noise level (dB)	36	35	39,7	40	45	44	34,5
	Voltage (A)	0,6	0,9	0,6	1,2	0,9	0,6	0,6
SPEED 2	Power (W)	125	120	130	170	110	95	125
	Air flow (m ³ /h)	260	310	265	310	400	175	290
	Pressure (mmH2O)	200	205	230	180	190	205	235
	Noise level (dB)	43	42	43,6	48	54	50	43
SPEED 3	Voltage (A)	0,7	1,5	0,7	1,6		0,9	0,7
	Power (W)	145	185	150	220		110	150
	Air flow (m ³ /h)	335	500	360	500		400	375
	Pressure (mmH2O)	265	245	290	200		225	285
	Noise level (dB)	48	52	49	55		53	49
	Voltage (A)	0,8		0,8				0,8
SPEED 4	Power (W)	170		175				175
	Air flow (m ³ /h)	450		455				470
	Pressure (mmH2O)	310		325				320
	Noise level (dB)	53		53,4				53,5
SPEED 5	Voltage (A)	1		1				1
	Power (W)	210		210				210
	Air flow (m ³ /h)	750		750				750
	Pressure (mmH2O)	350		365				380
	Noise level (dB)	61		60,2				61
	Input voltage	220 - 240 V ~ 50 Hz	220 - 240 V ~ 50 Hz	220 - 240 V ~ 50 Hz	220 - 240 V ~ 50 Hz	220 - 240 V ~ 50 Hz	220 - 240 V ~ 50 Hz	220 - 240 V ~ 50 Hz
Air outlet diameter	150 mm	150 mm	150 mm	120 mm	120 mm	120 mm	120 mm	120 mm

NOTE: All the here mentioned data is subject to change.

INSTRUCTIONS AND INFORMATION REGARDING THE DISPOSAL OF USED PACKAGING MATERIALS

Dispose of packaging material at a public waste disposal site.

DISPOSAL OF USED ELECTRICAL AND ELECTRONIC APPLIANCES



The meaning of the symbol on the product, its accessory or packaging indicates that this product shall not be treated as household waste. Please, dispose of this product at your applicable collection point for the recycling of electrical & electronic equipment waste. Alternatively in some states of the European Union or other European states you may return your products to your local retailer when buying an equivalent new product. The correct disposal of this product will help save valuable natural resources and help in preventing the potential negative impact on the environment and human health, which could be caused as a result of improper liquidation of waste. Please ask your local authorities or the nearest waste collection centre for further details. The improper disposal of this type of waste may fall subject to national regulations for fines.

For business entities in the European Union

If you wish to dispose of an electrical or electronic device, request the necessary information from your seller or supplier.

Disposal in other countries outside the European Union

If you wish to dispose of this product, request the necessary information about the correct disposal method from local government departments or from your seller.



This product meets all the basic EU regulation requirements that relate to it.

Changes to the text, design and technical specifications may occur without prior notice and we reserve the right to make these changes.