



ELEX ECO CONVECTIVE PANEL HEATER

USER MANUAL

Models:

ELEX ECO 2400

ELEX ECO 2000

ELEX ECO 1500

ELEX ECO 1000

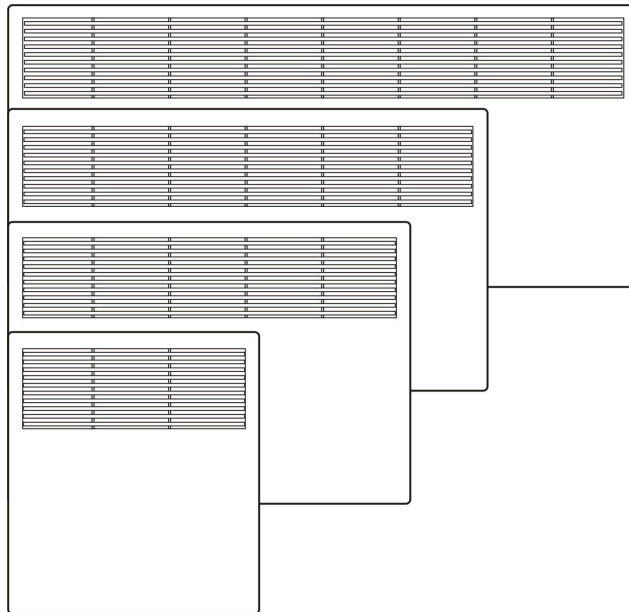

TABLE OF CONTENTS

1. Important Safety Instructions
2. Specification Data
3. Operating Instructions
 - 3.1 Control Panel Guide
 - 3.2 Switching on the Unit
 - 3.3 Preset Temperature
 - 3.4 Setting the 30min / 60min / 90min Timer
 - 3.4.1 Setting the 30min Push Button Timer Programme
 - 3.4.2 Setting the 60min Push Button Timer Programme
 - 3.4.3 Setting the 90min Push Button Timer Programme
 - 3.4.4 Changing to another Timer Setting in Mid Programme
 - 3.5 Locking the Control Panel
 - 3.6 Unlocking the Control Panel
 - 3.7 Safety Notes
 - 3.8 Maintenance
4. Installation Instructions
 - 4.1 Installation Location
 - 4.2 Wall Mounting Bracket
 - 4.3 Castor Wheel Set
 - 4.4 Electrical Connection
 - 4.5 Safety Notes
5. Warranty



I. Important Safety Instructions

- **Prior to installing and operating the heater, read these instructions carefully and retain for future reference.**
- Indoor use only.
- Ensure the rated voltage is **230-240V**.
- Do not install the heater directly below a socket.
- Always operate heater in an upright position with the control panel at the top. If using castor wheel set, heater should be positioned on a flat horizontal surface.
- Arrange cord away from traffic areas so that it will not be tripped over.
- Do not place the cable under carpets /rugs.
- Do not remove plug from power socket by pulling the supply cord. Always grip plug.
- Do not operate this appliance if the cable or plug becomes damaged.
- In case of heater fault or damaged supply lead, the appliance should be returned to the distributor / manufacturer for repair.
- Ensure the appliance is switched OFF before connecting to the mains power supply.
- Do not cover or restrict airflow to the inlet or outlet grills in any manner, as the appliance may overheat and become a fire risk.
- Do not insert or allow foreign objects or metal utensils to enter any grill opening, as this may cause an electric shock or fire damage to the appliance.
- Do not operate in areas where gasoline, paint or other flammable liquids are used or stored.
- Switch off the power supply and unplug from the mains socket when not in use, before cleaning or changing accessories.
- To prevent overload and blown fuses, do not plug other appliances into the same power outlet (receptacle).
- Do not immerse in liquid or allow liquid into the interior of the appliance, as this could create an electric shock hazard.
- Do not reach for an appliance that has fallen into water. Switch off at supply and unplug immediately.
- Do not operate appliance with wet hands. Always ensure that hands are dry before operating or adjusting any switch on the product or touching the plug and mains supply connections.
- Never leave the appliance unattended when connected to the mains power supply.
- Do not cover. NEVER use the heater to dry clothes or similar articles.
- Do not position the appliances close to curtains or other combustible materials. Keep combustible material such as furniture, cushions, bedding, paper, clothes, curtains etc. at least 1.0m away from the heater.
- The most common cause of overheating is deposits of dust or fluff in the appliance. Ensure these deposits are removed regularly by unplugging the appliance and vacuum cleaning air vents and grilles.
- This appliance heats up when in use. To avoid burns, do not let bare skin touch hot surface. Switch off and let cool down before moving. Store the heater in a cool, dry location when not in use.
- Do not use this appliance with a programmer, timer or any other devices that switches the appliances on automatically.
- Do not use an extension cable with this appliance.
- Do not use the appliance in rooms less than 4m² area.
- This appliance is not intended for use by persons (including children) with reduced physical, sensory or mental capabilities, or lack of experience and knowledge, unless they have been given supervision or instruction concerning use of the appliance by a person responsible for their safety.



2. Specification Data

Model	ELEX ECO 1000	ELEX ECO 1500	ELEX ECO 2000	ELEX ECO 2400
Power (W)	1000W	1500W	2000W	2400W
Voltage (V)	240V~50Hz	240V~50Hz	240V~50Hz	240V~50Hz
Dimension (mm)	420 x 440 x 105	580 x 440 x 105	740 x 440 x 105	1000 x 440 x 105

3. Operating Instructions

The control panel features a 30min / 60min / 90min push button timer with digital countdown timer display. This heater is designed to heat at an economical preset temperature of 21°C for the chosen time of 30min, 60min or 90min.

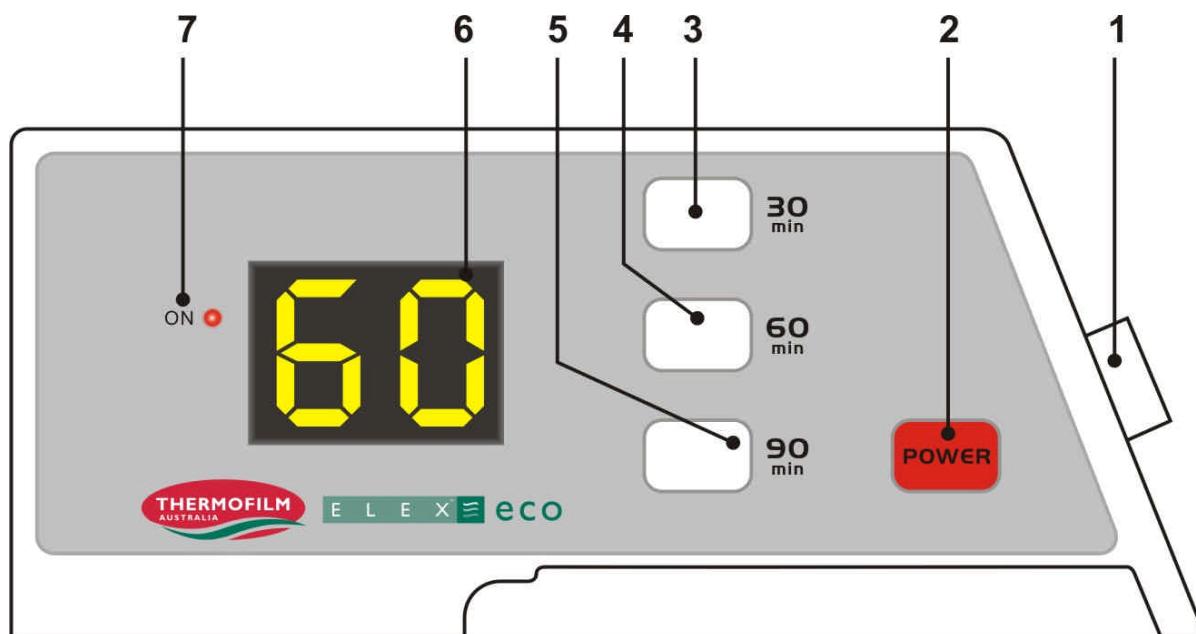

3.1 Control Panel Guide

- 1 - Main Power Switch (I/ 0 – ON / OFF)
- 2 - Unit Power button (ON / OFF)
- 3 - 30 minute push button timer
- 4 - 60 minute push button timer
- 5 - 90 minute push button timer
- 6 - LED screen
- 7 - Power On light

3.2 Switching on the Unit

Press the main power switch (1) on the right hand side of panel. Press the POWER button (2) on the control panel. This turns the unit ON, and the LCD screen (6) will illuminate displaying 00.

Note: The red “ON” indicator light (7) illuminates when the heating element is operating.

Upon first use, the heater may give off some fumes (this is normal).

Ensure that the room is ventilated (for example, open a window).

3.3 Preset Temperature

The preset temperature setting for the ELEX ECO heater is 21°C, and this cannot be altered.





3.4 Setting the 30min / 60min / 90min Push Button Timer

Note:

The 30min, 60min or 90 min programme may be terminated at any time by pressing the  button and the heater will turn off.



To modify a selected programme, see “3.4.4. Changing to another Timer Setting in Mid Programme”. To ensure a selected programme is not modified, see “3.5 Locking the Control Panel”.

3.4.1 Setting the 30min Push Button Timer Programme

Press the  button, the display will be . The red “ON” indicator light illuminates, the heater starts working and produces heat at the 21°C preset temperature for 30 minutes. The digital display will countdown the time remaining from 30 minutes to 00 minutes.



Once the digital display reaches , the heater will turn off.

3.4.2 Setting the 60min Push Button Timer Programme

Press the  button, the display will be . The red “ON” indicator light illuminates, the heater starts working and produces heat at the 21°C preset temperature for 60 minutes. The digital display will countdown the time remaining from 60 minutes to 00 minutes.

Once the digital display reaches , the heater will turn off.

3.4.3 Setting the 90min Push Button Timer Programme



Press the  button the display will be . The red “ON” indicator light illuminates, the heater starts working and produces heat at the 21°C preset temperature for 90 minutes. The digital display will countdown the time remaining from 90 minutes to 00 minutes.

Once the digital display reaches , the heater will turn off.

3.4.4 Changing to another Timer Setting in Mid Programme

The ELEX ECO heater can reset and begin another timer setting at any point during the countdown time of a selected 30min, 60min or 90min programme.



For example:

You have previously selected the 30 minute programme; the digital display shows , and you have 2 minutes remaining. Press the  button, the display will reset to . The heater will continue working for 30 minutes. The digital display will countdown the time remaining from 30 minutes to 00 minutes.

Once the digital display reaches , the heater will turn off.

3.5 Locking the Control Panel

To ensure that the selected 30min, 60min or 90min programme is not reset to another programme, you can lock the control panel after a programme has been selected.

To lock the control panel, press the  button and the  button simultaneously for around **three (3)** seconds. The heater will beep 3 times, indicating the control panel is locked.

The selected programme will countdown until the digital display reaches , and the heater will turn off.



Note: No other buttons (including the **POWER** button) will function when the control panel is locked. If any button is pressed, the digital display will flash 3 times and the heater will beep three times to indicate the control panel is locked.

3.6. Unlocking the Control Panel

To unlock the control panel, press the **30** button and the **60** button simultaneously for around **three (3)** seconds. The heater will beep 3 times, indicating the control panel is unlocked.

3.7 Safety Notes

The air outlet must not be obstructed. For safety reasons the upper and lower air grilles must never be covered with items such as washing nor obstructed by items in close proximity (see figure to right). Objects should not be leant against the unit nor placed between the unit and the wall.

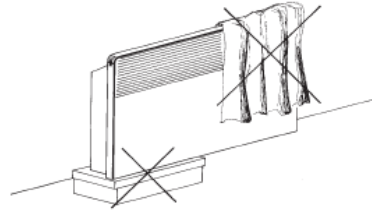

Never leave combustible materials, such as wood, paper, textiles or flammable items such as wax, petrol, aerosol cans etc. in the vicinity of the warm air outlet. As with all similar heaters, the flow of rising air may cause discoloration of the wall.

The appliance must not be operated:

- In areas which are subject to the risk of fire or explosion due to chemicals, dust, gases or vapors;
- In the immediate vicinity of pipes or containers which carry or contain combustible or potentially explosive substances.

For this reason, the minimum clearance intervals must not be undercut.

In workshops or other areas in which the odor of waste gases, oil, petrol, etc. might occur, or in which work is carried out involving solvents and chemicals, there is a risk of sustained odor burdens being engendered, and possibly of dirt contamination occurring.

Before using any materials which produce flammable gases or vapors, e. g. laying or sealing parquet or PVC flooring, or when using spray polishes, spirits and similar materials, ensure the heater is switched off.

3.8 Maintenance

Do not use abrasive or aggressive cleansers to clean the heater. Use a vacuum cleaner regularly to clean the upper and lower air grids.

4. Installation instructions

The ELEX ECO convective panel heaters are electric heaters designed to be mounted on the wall or freestanding using the supplied castor wheel set. These units are suitable for heating enclosed indoor rooms such as bedrooms, studies, offices, living areas and bathrooms.

ATTENTION!

The installation, electrical connection and first operation of this appliance should be carried out by a qualified installer. The company does not accept liability for failure of any goods supplied which have not been installed and operated in accordance with the manufacturer's instructions.

These installation instructions belong with the heater and must be handed on to the purchaser if the heater is sold.



4.1 Installation Location

The ELEX ECO convective panel heater was designed to be installed in a residence. Please ask your distributor before using it for any other purpose.

The ELEX ECO convective panel heater should be installed according to normal trade practice and in compliance with legislation in relevant country.

The panel convector is **CLASS I** and is protected against splashed water (IP24). Therefore it can be installed outside the shaded area shown in the bathroom area

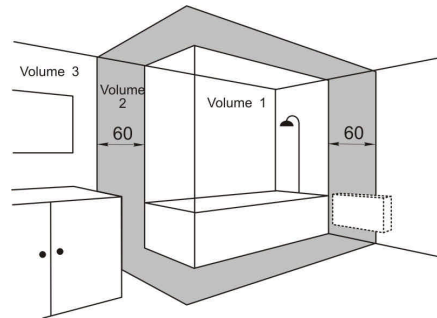

Ensure the safety zones (mm) in diagram (left hand side) are kept free.

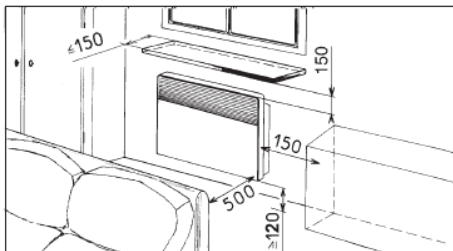

If the wall covering is laid on foam, a spacer the same thickness as the foam must be placed under the panel heater's support. This ensures there is free space behind the panel heater to make sure its control settings are not adversely affected.

The ELEX ECO convective panel heater must not be installed immediately below a wall socket. The heater must be connected to a socket outlet or permanent terminal box at least 10cm to one side of the heater. If the heater is installed in the Bathroom or in humid area, the socket outlet or permanent terminal box must conform to the IP24 requirement.

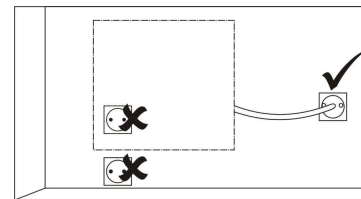

The ELEX ECO convective panel heater must not be installed in a draught likely to affect the control settings (under a ventilating fan, etc.)

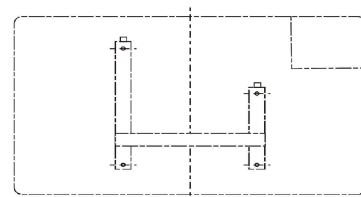

4.2 Wall Mounting Bracket

The wall mounting bracket is oriented centrally (See RHS diagram).

Step 1: Loosen the locking plate screw and rotate the locking plate out of the fixing slot (See RHS images).

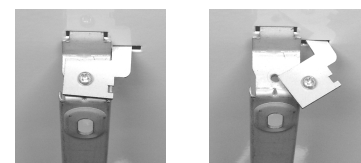

Then remove the mounting bracket from the heater.

Step 2: Use the wall-mounting bracket as a template for marking the fixing holes. Position the mounting bracket in the correct position on the wall and mark the screw-holes through the 4 mounting holes (See RHS diagram).

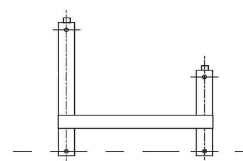

Step 3: Install the 4 fixing devices in the wall, ensuring they are more than adequate to safely fix the heater to the wall. (ST4 expansion screws are suggested).





Step 4: Fix the bracket firmly to the wall using all 4 mounting locations.

Step 5: Mount the heater on the bracket so the bracket protrusions fix into the 4 slots on the back of the heater. (See RHS diagram). Rotate the locking plate into the fixing slot and tighten the screw

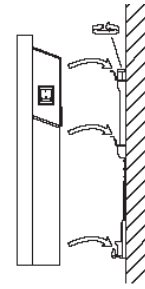

To remove the heater, reverse the above operation.

4.3 Castor Wheel Set

Part list

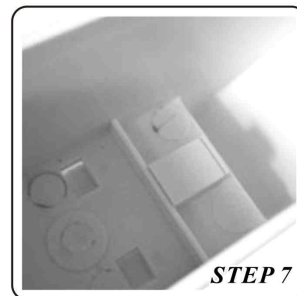
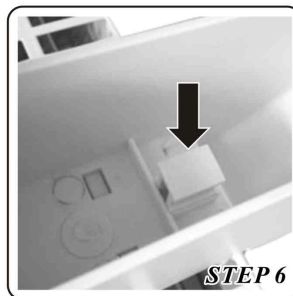
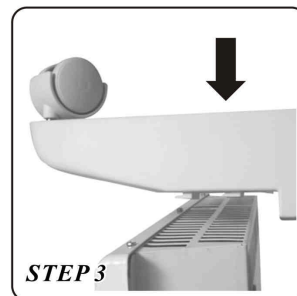
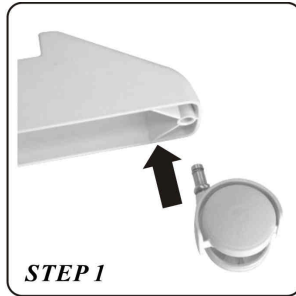
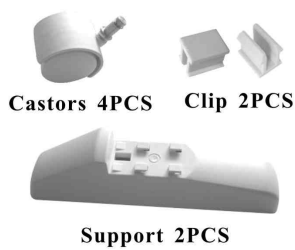

4.4 Electrical connection

This heater is suitable for 230-240V.

Please observe national standards, the regulations of your local electricity supply company as well as data on the rating label.

Electrical safety!

The ELEX ECO convective panel heaters are IP24 protected against splashing water. In humid areas such as bathrooms, the power socket must be installed at least 25cm above floor level.

Note the details on the rating plate!

The voltage supply must match the requirements on the rating plate. The supply cable must be correctly sized. The heater must be connected to a socket outlet or permanent terminal box at least 10 cm to one side of the heater.

Please note in general:

Where the ELEX ECO convective panel heater is fitted in a room with a bath or shower, ensure the safety zone defined in IEE Regulations is applied in accordance with the details on the rating plate.

To avoid hazards, if the power cord of the appliance exhibits visible damage it must be replaced by the manufacturer or his service agent or a qualified electrician.

4.5 Safety Notes

The ELEX ECO convective panel heater is equipped with a safety cut-out that switches the heater off if it overheats.



Once the heater has switched off due to overheating, remove the cause of the fault, e. g. blocked air grids. When the heater has cooled down for several minutes it will restart automatically. If the heater then cuts off again, switch off the heater and call an authorized serviceman.

5. Warranty

ELEX ECO heaters have a SEVEN (7) YEAR FULL REPLACEMENT WARRANTY*.

To claim for Warranty, please retain your receipt as proof of purchase and return the faulty heater to the place you purchased it.

Warranty does not apply to heaters which have been misused or used in conditions other than those for which they were intended for. Nor will it apply in the event of damage or accident resulting from negligence, lack of care or maintenance, or if the heater has been modified in any way.

Thermofilm Australia Pty Ltd reserve the right to reject any Warranty claim deemed to be false.

Retailers must have Warranty claims authorised by Thermofilm Australia. Ph 03 9562 3455

* Conditions apply. Please refer the Thermofilm standard terms of sale and warranty for details.