

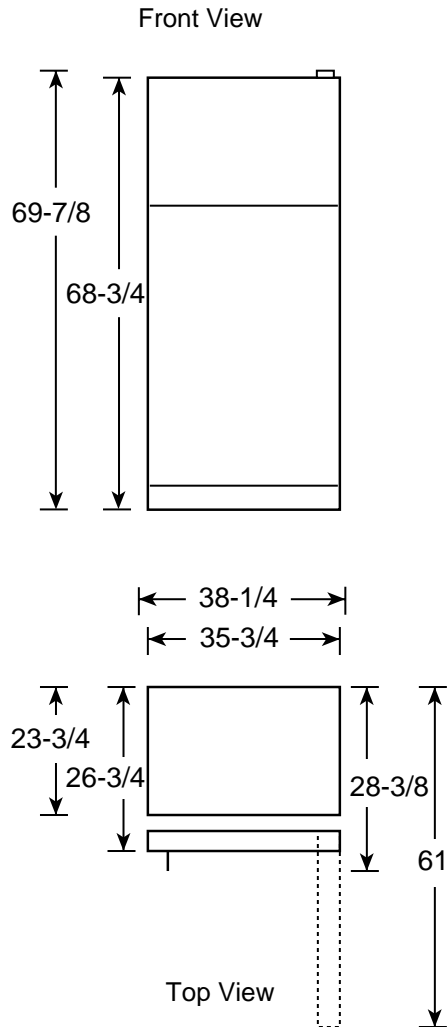

Profile™

PTC22MBM – GE Profile™ 21.9 Cu. Ft. CustomStyle™ Top-Freezer Refrigerator

Case Dimensions (in inches/cm.)



Rough-In Dimensions (in inches/cm.)

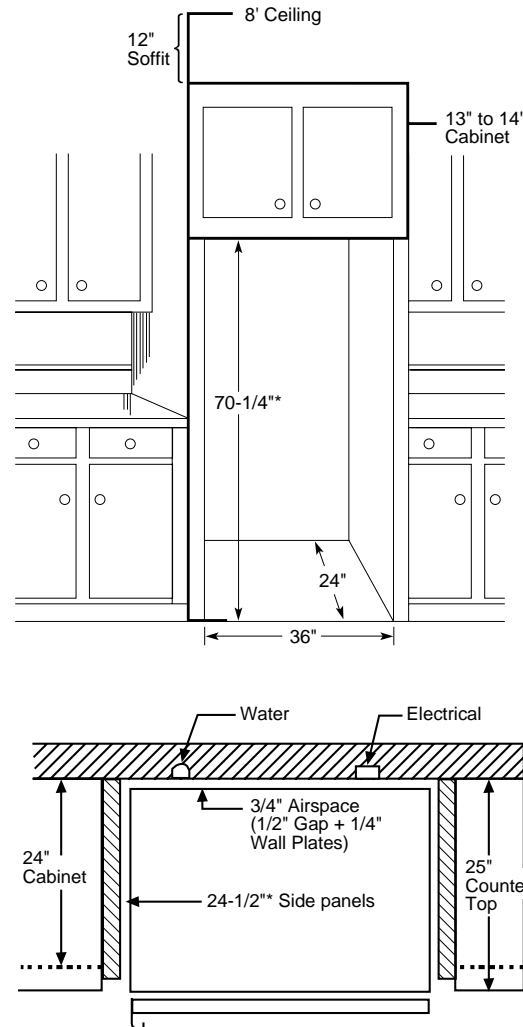

Standard, New Construction and Replacement Installation

Installation Tips to Maximize the Built-In Look

- All wall/floor moulding should be removed prior to installation.
- Water recess on rear wall recommended to prevent water line damage. 48" minimum length 1/4" diameter water line tubing recommended.
- When possible, recess both copper water line and electrical outlet. (See local codes)
- Front and rear leveling legs are adjustable for the built-in look. (See owner's manual)

Handle Side Clearance

- At least 2" (51 mm) on the handle side for fingertip clearances.

Top and Bottom Clearance

- At least 3/16" (4.75 mm) at the top and bottom edges to allow for trim flange.

Hinge Side Clearance

- The installation of 3/4" (19 mm) thick side panels requires less clearance because the space between the door and adjacent countertop is wider.
- To avoid door contact to countertop consider:
 - Miter the corner of the adjacent countertops 45°, or pull the refrigerator forward enough to avoid contact.

IMPORTANT:

Before finalizing specifications for your GE Profile Performance™ CustomStyle™ Refrigerator, Please NOTE:

- A minimum of 36" is required for refrigerator installation
- Be sure to allow for 1/2" or 3/4" side panels in addition to the 36" minimum



Total volume and shelf area are calculated by the Association of Home Appliance Manufacturers' standards.



Listed by Underwriters Laboratories

For answers to your Monogram®, GE Profile™ or GE appliance questions, visit our website at GEAppliances.com or call GE Answer Center® service, 800.626.2000.



Profile™

PTC22MBM – GE Profile™ 21.9 Cu. Ft. CustomStyle™ Top-Freezer Refrigerator

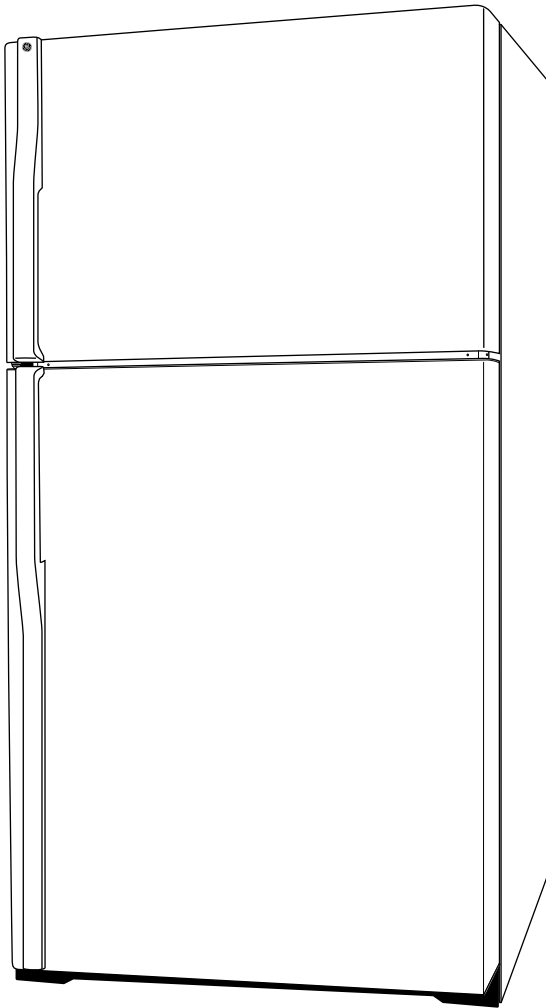

Features and Benefits

- 21.9 cu ft Capacity (Fresh Food 15.4 cu. ft./Freezer 6.5 cu. ft.)
- 2 Adjustable Humidity Vegetable/Fruit Crispers with Spill-Proof Crisper Cover
- Adjustable Temperature Meat Pan
- Slide-Out, Slide-Over Pans
- 4 Adjustable, Split Glass Fresh Food Cabinet Shelves (3 Slide-Out, Spill Proof)
- 3 Adjustable ClearLook™ Modular Door Bins with Gallon Storage
- 1 Fixed Fresh Food Door Bin with Tall Bottle Storage
- QuickSpace™ Shelf
- Beverage Rack
- Dairy Compartment
- 2 Adjustable, Split Wire Everwhite Freezer Compartment Shelves
- 3 Freezer Door Bins (2 Adjustable; 1 Full-Width Fixed)
- 4 Ice 'N Easy Trays with Ice Storage Bin
- Deluxe Quiet Design
- Color-Matched Premium Deluxe Door Handles
- Model PTC22MBMWW – White on white
- Model PTC22MBMBB – Black on black
- Model PTC22MBMCC – Bisque