

Electrolux HD-Line

Dual refrig./freezers 1400 lt digital

The Electrolux HD-Line offers one of the most comprehensive choices of refrigerated storage cabinets available. Manufactured internally and externally in 304 AISI stainless steel, operating over refrigeration or freezer temperature ranges, with solid or glass doors, and in a choice of either 650 litres or 1400 litres capacity. The 2 dual refrigerator/freezer models detailed on this leaflet have a capacity of 1400 litres.



728429

EASY TO INSTALL

- Mounted on adjustable stainless steel legs, with castors as an option.
- Choice of doors to suit varying kitchen requirements.
- Refrigeration operating temperatures that can be adjusted from $-2\text{ }^{\circ}\text{C}$ to $+10\text{ }^{\circ}\text{C}$ to suit both meat and dairy storage requirements. Freezer temperature can be adjusted from $-15\text{ }^{\circ}\text{C}$ to $-24\text{ }^{\circ}\text{C}$.
- Suitable for ambient temperatures up to $+43\text{ }^{\circ}\text{C}$.

EASY TO CLEAN

- Constructed from the highest quality AISI 304 stainless steel with radiused corners to the interior base which is pressed from a single sheet.

- Sides and back are formed from just 2 sheets of stainless steel with a single joint to avoid dirt traps.
- Evaporator unit is inset into the top of the refrigerated chamber to provide an obstruction free interior.

EASY TO USE

- Forced air circulation for rapid cool down and even temperature uniformity.
- Accommodates GN 2/1 containers or shelves on anti-tilt runners.
- External digital temperature display.
- Interior light and lockable door.
- Refrigerators feature automatic defrost and are fitted with a defrost outlet pipe.

EASY TO MAINTAIN

- Heavy-duty construction that avoids use of any plastic parts.
- Two refrigeration units (compressor, condenser and evaporator) that can be removed in a single piece from either the top or back.
- Evaporator cover is easily removable for maintenance.

EASY ON THE ENVIRONMENT

- 20% reduction in energy consumption compared to previous models.
- Cabinet fitted with up to 75 mm thickness of cyclopentane insulation for best insulating performance with 100% environmental.
- Refrigerants type: R134a and R404a.



Electrolux

**Electrolux HD-Line
Dual refrig./freezers 1400 lt digital**

	RH14DFD2 728429
TECHNICAL DATA	
Operating temperature	
first compartment - min/max °C	-2 / 10
second compartment - min/max °C	-24 / -15
Operating mode	Ventilated
External material	
panels	304 AISI
Gross capacity (D.I.N. 8952) - l.	640, 640
Cooling unit	Built-In
Control type	Digital
External dimensions - mm	
width	1500
depth/with open doors	810, 1463
height	2050
Min/Max internal humidity - %	75/90; ---
N° and type of door	2
Door hinges	1 Left+1 Right
N° and type of grids (included)	8, GN 2/1
Compressor power - HP	1/4
Second Unit - Compressor power -HP	1/2
N° defrost in 24 hrs.	4/20'
Second Unit - N° defrost in 24 hrs.	4/30'
Refrigerant type	R134a
Second Unit - Refrigerant type	R404a
Refrigerant quantity - g.	240, 270
Refrigeration power - W	378
Second Unit - Refrigerant power - W	780
Refrigerant power	
at evaporation temperature - °C	-10
Power - kW	
installed-electric	0.985
Net weight - kg.	283
INCLUDED ACCESSORIES	
2 S/S RUNNERS FOR 600-650/1300-1400L.REF	8
2/1 GN GREY "RILSAN" GRID	8
ACCESSORIES	
1/1 GN RILSAN STEEL WIRE BASKET H=150 MM	881043
2 S/S RUNNERS FOR 600-650/1300-1400L.REF	881456
2/1 GN AISI 304 S/S GRID	881067
2/1 GN CHROME BASKET+2 RUNNERS H200	881468
2/1 GN GREY "RILSAN" GRID	880720
2/1 GN GREY RILSAN GRID W/ 2 RUNNERS	881454
2/1 GN PVC CONTAINER W/LID AND 2 RUNNERS	881462
3 GREY RILSAN CENTRAL GRIDS FOR 1400 L	881452
4 SWIVELLING WHEELS (2 W/ BRAKE)	880178
GN 1/1 PLASTIC CONTAINER+FALSE BOTTOM	880705
GN 2/1 WIRE BASKET-H-150 MM+SIDE RUNNERS	881467
HACCP ADV.CONN.10 UNITS-DIG.REF.(ID9XX)	880119
HACCP ADV.CONN.80 UNITS-DIG.REF.(ID9XX)	880132
HACCP ADV.CONN.PER UNIT-DIG.REF.(ID9XX)	880133
KIT HACCP EKIS	922166
KIT PLINTH TO INSTALL HD REF. 1200/1400	880207
KIT TO FIT 11 PASTRY TRAYS (400X600 MM)	881031
MEAT RAIL FOR 650-1400 L REFRIGERATORS	881451
PEDAL OPENING FOR 1200/1400 L REFRIGER.	881459
PERFORATED SHELF GN 2/1	881042
PRINTER FOR HACCP BASIC VERSION REFRIG.	881457
SET OF 8-1/1 GN PVC CONTAINERS FOR FISH	881461

HAB060

2009-10-20

Subject to change without notice

**Electrolux HD-Line
Dual refrig./freezers 1400 lt digital**

728429

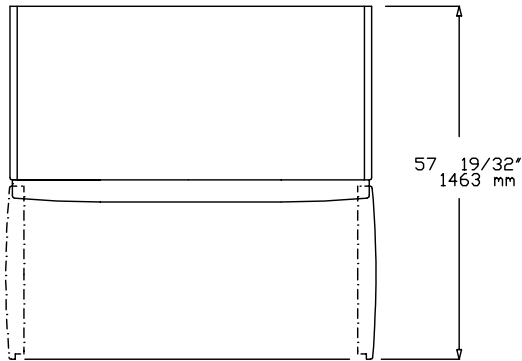
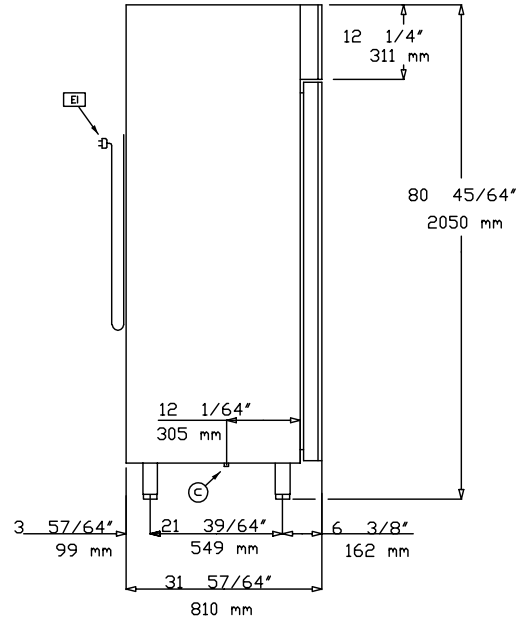
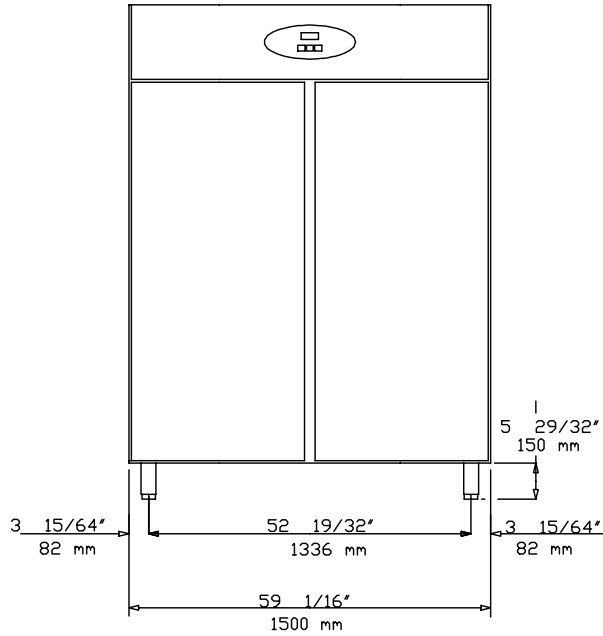

589729000

LEGEND D - Water drain EI - Electrical connection	RH14DFD2 728429
	1/2"
	230 V, 1N, 50

HAB060

2009-10-20

Subject to change without notice