

Electrolux HD-Line

Digital refrigerators 1400 lt

The Electrolux HD-Line offers one of the most comprehensive choices of refrigerated storage cabinets available. Constructed internally and externally in stainless steel, operating over refrigeration or freezer temperature ranges, with solid or glass doors, and in a choice of either 650 or 1400 liter capacity. The refrigerator models detailed on this sheet have a capacity of 1400 liters.



728420



728423

EASY TO INSTALL

- Mounted on adjustable stainless steel feet, with castors as an option.
- Choice of doors to suit varying kitchen requirements.
- Refrigerator models have operating temperatures that can be adjusted from $-2\text{ }^{\circ}\text{C}$ to $+10\text{ }^{\circ}\text{C}$ to suit both meat and dairy storage requirements.
- Suitable for ambient temperatures of up to $+43\text{ }^{\circ}\text{C}$ in case of full door or up to $+32\text{ }^{\circ}\text{C}$ in case of glass door models.

EASY TO CLEAN

- Forced air circulation for rapid cool down and even temperature uniformity.
- Constructed from the highest quality AISI 304 stainless steel with radiused corners to the interior base, which is pressed from a single sheet.
- Evaporator unit is inset into the top of the refrigerated chamber to provide an obstruction free interior.
- Refrigerators are fitted with defrost outlet pipe.

EASY TO USE

- Accommodates GN 2/1 containers or shelves on anti-tilt runners.
- External digital temperature display.
- Interior light and lockable door.
- Refrigerator with automatic defrost.



Electrolux

**Electrolux HD-Line
Digital refrigerators 1400 lt**

EASY TO MAINTAIN

- Heavy-duty construction that avoids use of any plastic parts.
- Single refrigeration unit (compressor, condenser and evaporator) that can be removed in a single piece from either the top or back.
- Evaporator cover is easily removable for maintenance.

EASY ON THE ENVIRONMENT

- 20% reduction in energy consumption compared to previous models.
- Cabinet fitted with up to 75 mm thickness of cyclopentane insulation for best insulating performance with 100% environmental protection.

- Refrigerant type: R134a.
- CFC and HCFC free.
- All models comply with the standards required by the main international approval bodies and are H marked.

	RH14RD2F 728420	RH14RD2FR 728422	RH14RD4F 728423	RH14RD2G 728424	RH14RD2F6 728444
TECHNICAL DATA					
Operating temperature - min/max °C	-2/10	-2/10	-2/10	0/10	-2/10
Operating mode	Ventilated	Ventilated	Ventilated	Ventilated	Ventilated
External material					
panels	304 AISI	304 AISI	304 AISI	304 AISI	304 AISI
Gross capacity (D.I.N. 8952) - l.	1400	1400	1400	1400	1400
Cooling unit	Built-In	Remote	Built-In	Built-In	Built-In
Control type	Digital	Digital	Digital	Digital	Digital
External dimensions - mm					
width	1500	1500	1500	1500	1500
depth/with open doors	810, 1463	810, 1463	810, 1463	810, 1474	810, 1463
height	2050	2050	2050	2050	2050
Min/Max internal humidity - %	75/90	75/90	75/90	65/85	75/90
N° and type of door	2	2	4x1/2	2	2
Door hinges	1 Left+1 Right	1 Left+1 Right	2 Left+2 Right	1 Left+1 Right	1 Left+1 Right
N° and type of grids (included)	8, GN 2/1	8, GN 2/1	8, GN 2/1	8, GN 2/1	8, GN 2/1
Compressor power - HP	3/8		3/8	3/8	
N° defrost in 24 hrs.	4/28'	4/28'	4/28'	4/28'	4/28'
Refrigerant type	R134a	R134a	R134a	R134a	R134a
Refrigerant quantity - g.	360		360	380	360
Refrigeration power - W	512		512	640	
Refrigerant power					
at evaporation temperature - °C	-10	-10	-10	-10	-10
Power - kW					
installed-electric	0.513	0.07	0.513	0.538	0.52
Net weight - kg.	248	223	252	266	252

**Electrolux HD-Line
Digital refrigerators 1400 lt**

	RH14RD2F 728420	RH14RD2FR 728422	RH14RD4F 728423	RH14RD2G 728424	RH14RD2F6 728444
INCLUDED ACCESSORIES					
2 S/S RUNNERS FOR 600-650/1300-1400L.REF	8	8	8	8	8
2/1 GN GREY "RILSAN" GRID	8	8	8	8	8
ACCESSORIES					
1/1 GN RILSAN STEEL WIRE BASKET H=150 MM	881043	881043	881043	881043	881043
2 S/S RUNNERS FOR 600-650/1300-1400L.REF	881456	881456	881456	881456	881456
2/1 GN AISI 304 S/S GRID	881067	881067	881067	881067	881067
2/1 GN CHROME BASKET+2 RUNNERS H200	881468	881468	881468	881468	881468
2/1 GN GREY "RILSAN" GRID	880720	880720	880720	880720	880720
2/1 GN GREY RILSAN GRID W/ 2 RUNNERS	881454	881454	881454	881454	881454
2/1 GN PVC CONTAINER W/LID AND 2 RUNNERS	881462	881462	881462	881462	881462
3 GREY RILSAN CENTRAL GRIDS FOR 1400 L	881452	881452	881452		881452
304 AISI S/S GRID GN 2/1 WITH 2 RUNNERS				880185	
4 SWIVELLING WHEELS (2 W/ BRAKE)	880178	880178	880178	880178	880178
ENERGY FREE ALARM DEVICE	881089	881089	881089	881089	881089
GN 1/1 PLASTIC CONTAINER+FALSE BOTTOM	880705	880705	880705	880705	880705
GN 2/1 WIRE BASKET-H-150 MM+SIDE RUNNERS	881467	881467	881467	881467	881467
HACCP ADV.CONN.10 UNITS-DIG.REF.(ID9XX)	880119	880119	880119	880119	880119
HACCP ADV.CONN.80 UNITS-DIG.REF.(ID9XX)	880132	880132	880132	880132	880132
HACCP ADV.CONN.PER UNIT-DIG.REF.(ID9XX)	880133	880133	880133	880133	880133
KIT HACCP EKIS	922166	922166	922166	922166	
KIT PLINTH TO INSTALL HD REF. 1200/1400	880207	880207	880207	880207	880207
KIT TO FIT 11 PASTRY TRAYS (400X600 MM)	881031	881031	881031	881031	881031
MEAT RAIL FOR 650-1400 L REFRIGERATORS	881451	881451	881451	881451	881451
PEDAL OPENING FOR 1200/1400 L REFRIGER.	881459	881459		881459	
PERFORATED SHELF GN 2/1	881042	881042	881042	881042	881042
PRINTER FOR HACCP BASIC VERSION REFRIG.	881457	881457	881457	881457	881457
SET OF 8-1/1 GN PVC CONTAINERS FOR FISH		881461	881461	881461	881461

HAB040

2009-10-30

Subject to change without notice

**Electrolux HD-Line
Digital refrigerators 1400 lt**

728420, 728423, 728422

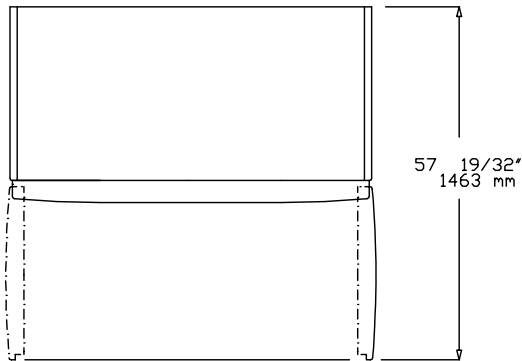
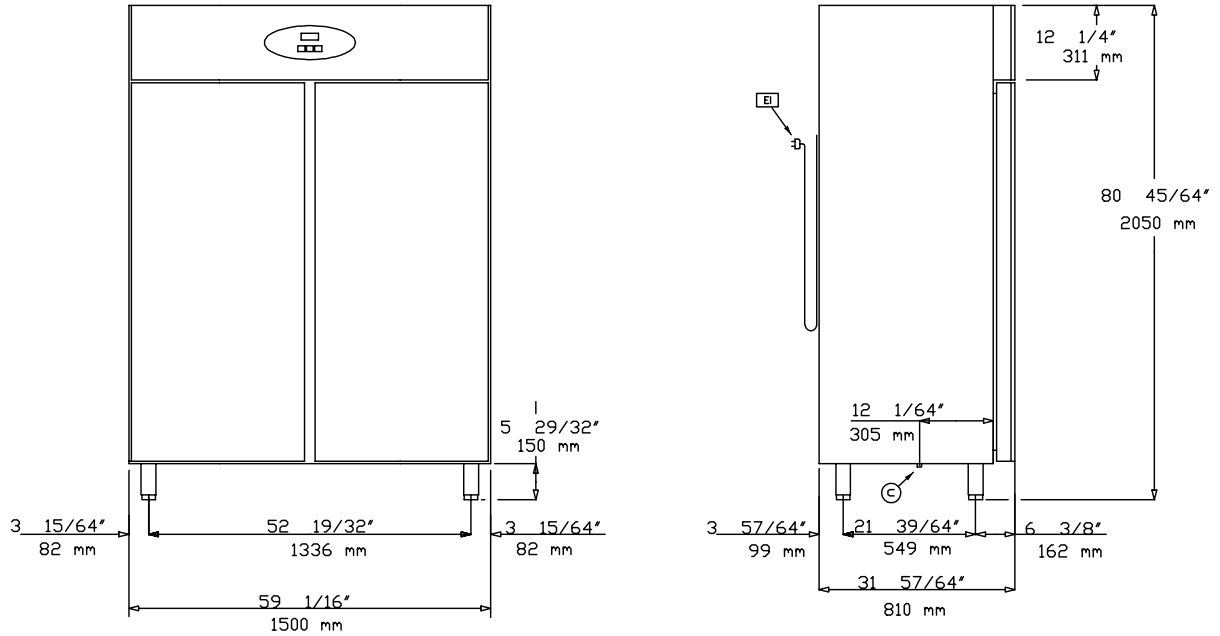

589729000

HAB040

2009-10-30

LEGEND	RH14RD2F 728420	RH14RD2FR 728422	RH14RD4F 728423
	D - Water drain	1/2"	1/2"
ED - Remote electrical connection		●	
EI - Electrical connection	230 V, 1N, 50	230 V, 1N, 50	230 V, 1N, 50
RI - Remote refrigeration connection		●	

Subject to change without notice

Electrolux HD-Line
Digital refrigerators 1400 lt

728424

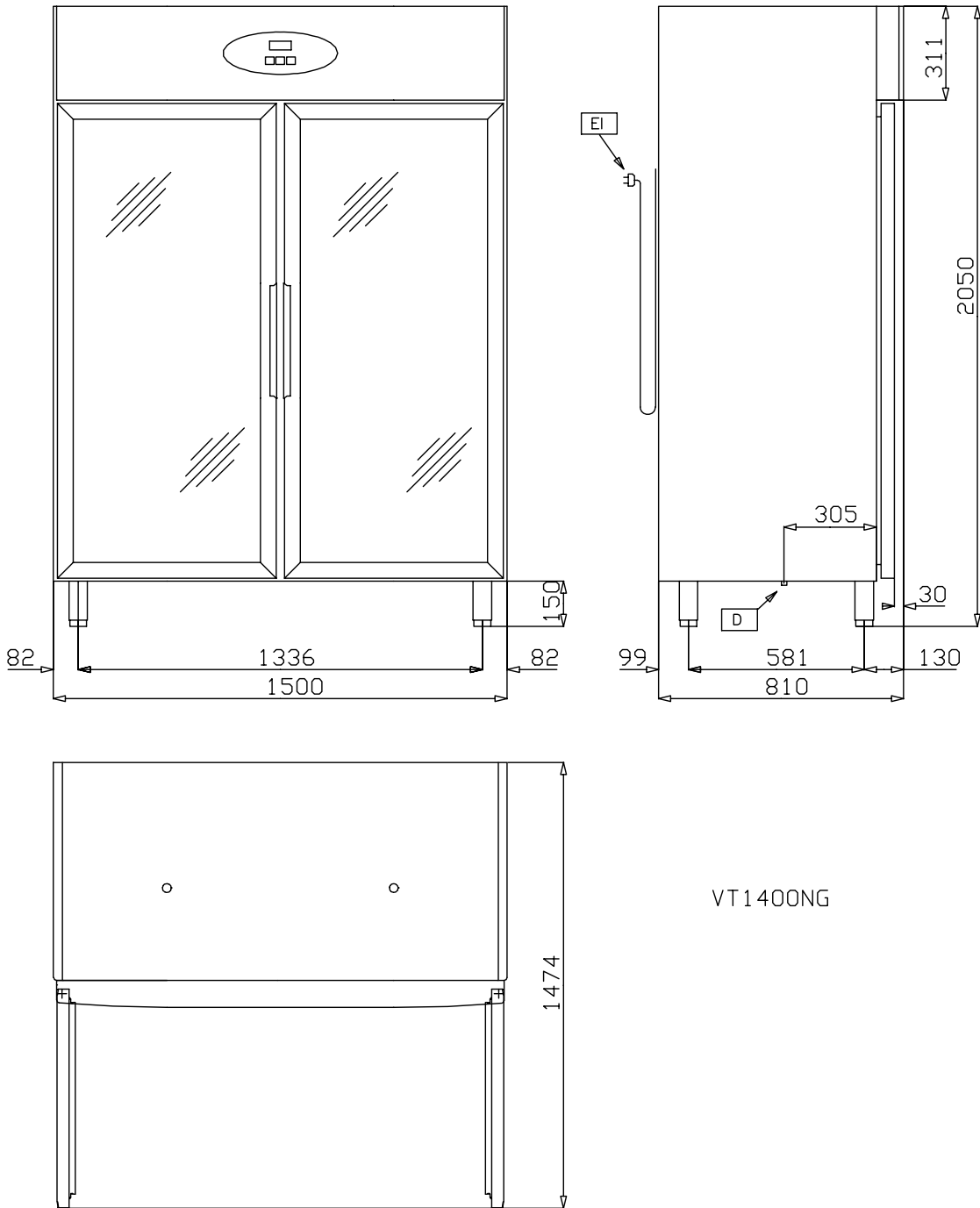

LEGEND D - Water drain EI - Electrical connection	RH14RD2G 728424
	1/2"
	230 V, 1N, 50

HAB040

2009-10-30

Subject to change without notice

Electrolux HD-Line
Digital refrigerators 1400 lt

728444

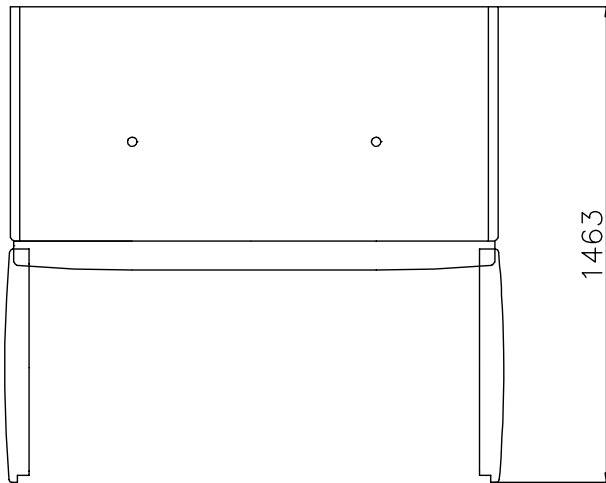
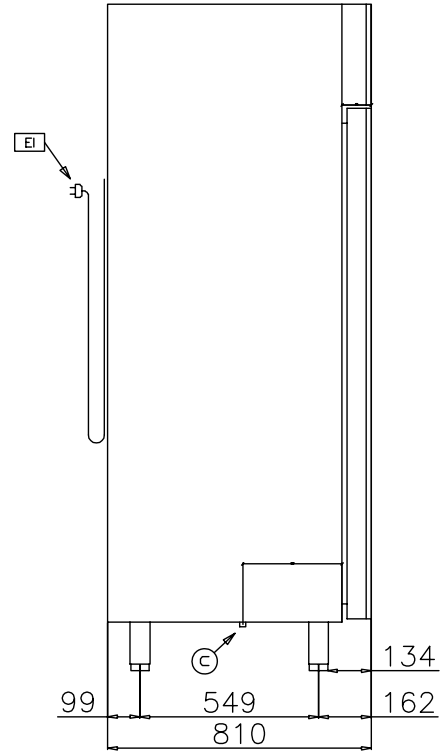
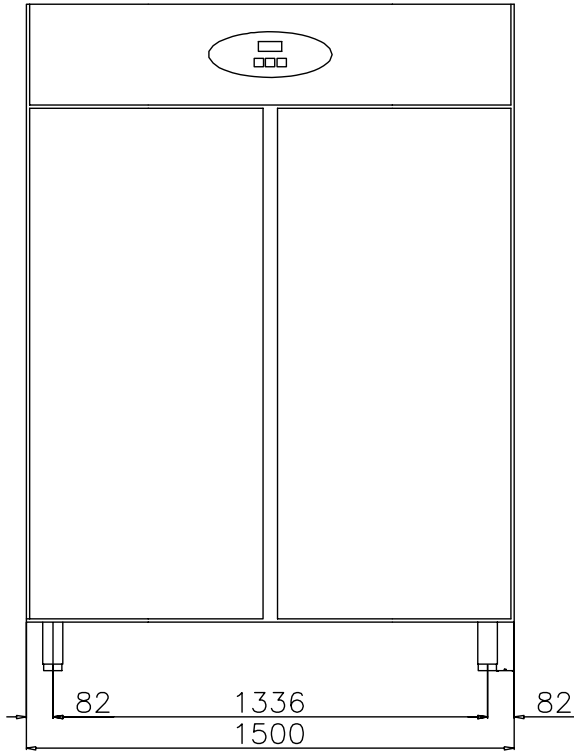

VT1400NF

HAB040

2009-10-30

Subject to change without notice

LEGEND D - Water drain EI - Electrical connection	RH14RD2F6 728444
	1/2"
	220 V, 1N, 60