



ERW23900X
ERW23910X
Wine refrigerator

We were thinking of you
when we made this product

Welcome to the world of Electrolux

You've chosen a first class product from Electrolux, which hopefully will provide you with lots of pleasure in the future. Electrolux ambition is to offer a wide variety of quality products that would make your life even more comfortable. You can look at some examples on the cover in this manual. But now it's time to study this manual and start using and enjoying the benefits from your new machine. We promise that it'll make your life a little easier. Good luck!

The following symbols are used in this manual:



Important information concerning your personal safety and information on how to avoid damaging the appliance.



General information and tips



Environmental information



The symbol  on the product or on its packaging indicates that this product may not be treated as household waste. Instead it shall be handed over to the applicable collection point for the recycling of electrical and electronic equipment. By ensuring this product is disposed of correctly, you will help prevent potential negative consequences for the environment and human health, which could otherwise be caused by inappropriate waste handling of this product. For more detailed information about recycling of this product, please contact your local city office, your household waste disposal service or the shop where you purchased the product.

CONTENTS

Safety information

General Safety 6

Service/Repair 6

Use 7

Installation 7

Environment Protection 8

Use

Cleaning the interior 9

Control panel 9

Display 10

Operation 11

Wine arrangement 11

Switching off 12

Acoustic alarm with door open 12

Button and light indicator 12

Inside accessories 13

Maintenance

Defrosting 14

Cleaning 14

Lamp replacement safety instructions 15

Lighting lamps 15

Something not

working 16

Technical

Specifications 17

Customer Service and

Spare parts 17

Electrical

Connections 18

Installation 19

Assembly of the handle 21

EUROPEAN GUARANTEE 22

www.electrolux.com 23

SAFETY INFORMATION

It is most important that this instruction book should be retained with the appliance for future reference.

Should the appliance be sold or transferred to another owner, or should you move house and leave the appliance, always ensure that the book is supplied with the appliance in order that the new owner can be acquainted with the functioning of the appliance and the relevant warnings.

If this appliance featuring magnetic door seals is to replace an older appliance having a spring lock (latch) on the door or lid, be sure to make that spring lock unusable before you discard the old appliance. This will prevent it from becoming a death-trap for a child.

These warnings are provided in the interest of safety. You must read them carefully before installing or using the appliance.

General Safety

- This appliance is designed to be operated by adults. Children should not be allowed to tamper with the controls or play with the product.
- It is dangerous to alter the specifications or modify this product in any way.
- Before any cleaning or maintenance work is carried out, be sure to switch off and unplug the appliance.
- This appliance is heavy. Care should be taken when moving it.

- Ice lollies can cause frost burns if consumed straight from the appliance.
- Take utmost care when handling your appliance so as not to cause any damages to the cooling unit with consequent possible fluid leakages.
- The appliance must not be located close to radiators or gas cookers.
- Avoid prolonged exposure of the appliance to direct sunlight.
- There must be adequate ventilation round the back of the appliance and any damage to the refrigerant circuit must be avoided.
- For freezers only (except built-in models): an ideal location is the cellar or basement.
- Do not use other electrical appliances (such as ice cream makers) inside of refrigerating appliances.

Service/Repair

- Any electrical work required to install this appliance should be carried out by a qualified electrician or competent person
- This product should be serviced by an authorized Service Centre, and only genuine spare parts should be used.
- Under no circumstances should you attempt to repair the appliance yourself. Repairs carried out by inexperienced persons may cause injury or more serious malfunctioning. Refer to your local Service Centre, and always insist on genuine spare parts.

- This appliance contains hydrocarbons in its cooling unit; maintenance and recharging must therefore only be carried out by authorized technicians.

Use

- The domestic refrigerators and freezers are designed to be used specifically for the storage of edible foodstuffs only.
- Best performance is obtained with ambient temperature between +18°C and +43°C (class T); +18°C and +38°C (class ST); +16°C and +32°C (class N); +10°C and +32°C (class SN). The class of your appliance is shown on its rating plate.

Warning: when the ambient temperature is not included within the range indicated for the class of this appliance, the following instructions must be observed: when the ambient temperature drops below the minimum level, the storage temperature in the freezer compartment cannot be guaranteed; therefore it is advisable to use the food stored as soon as possible.

- Frozen food must not be re-frozen once it has been thawed out.
- Manufacturers' storage recommendations should be strictly adhered to. Refer to relevant instructions.

- The inner lining of the appliance consists of channels through which the refrigerant passes. If these should be punctured this would damage the appliance beyond repair and cause food loss. **DO NOT USE SHARP INSTRUMENTS** to scrape off frost or ice. Frost may be removed by using the scraper provided. Under no circumstances should solid ice be forced off the liner. Solid ice should be allowed to thaw when defrosting the appliance.
- Do not place carbonated or fizzy drinks in the freezer as it creates pressure on the container, which may cause it to explode, resulting in damage to the appliance. Do not use a mechanical device or any artificial means to speed up the thawing process other than those recommended by the manufacturer. Never use metal objects for cleaning your appliance as it may get damaged.

Installation

- During normal operation, the condenser and compressor at the back of the appliance heat up considerably. For safety reasons, minimum ventilation must be as shown in the instructions.

Attention: keep ventilation openings clear of obstruction.

- Care must be taken to ensure that the appliance does not stand on the electrical supply cable.

Important: if the supply cord is damaged, it must be replaced by a special cord or assembly available from the manufacturer or its service agent.

- If the appliance is transported horizontally, it is possible that the oil contained in the compressor flows in the refrigerant circuit. It is advisable to wait at least two hours before connecting the appliance to allow the oil to flow back in the compressor.
- There are working parts in this product which heat up. Always ensure that there is adequate ventilation as a failure to do this will result in component failure and possible food loss. See installation instructions.
- Parts which heat up should not be exposed. Wherever possible the back of the product should be against a wall.



Environment Protection

This appliance does not contain gasses which could damage the ozone layer, in either its refrigerant circuit or insulation materials. The appliance shall not be discarded together with the urban refuse and rubbish. Avoid damaging the cooling unit, especially at the rear near the heat exchanger. Information on your local disposal sites may be obtained from municipal authorities. The materials used on this appliance marked by the symbol  are recyclable.

USE

Cleaning the interior

Before using the appliance for the first time, wash the interior and all internal accessories with luke-warm water and some neutral soap so as to remove the typical smell of a brand-new product, then dry thoroughly.

 **Do not use detergents or abrasive powders, as these will damage the finish.**

Control panel

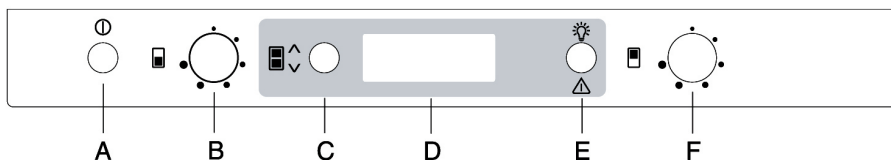

- A - Appliance On/Off key
- B - Bottom compartment temperature adjustment knob
- C - Compartment selection key
- D - Temperature display

- E - Door open alarm reset and light switching on key (symbols if provided for)
- F - Top compartment temperature adjustment knob

Display

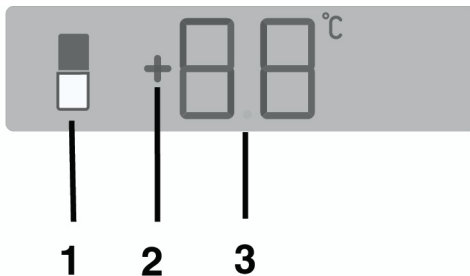

1. Selected compartment indicator
2. Positive temperature indicator
3. Temperature indicator

Operation

After inserting the plug in the socket, if the display is not lit press the appliance On key (A).

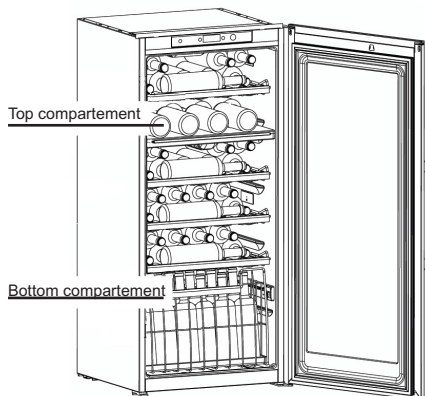

Use

The wine refrigerator is divided into two compartments with differentiated temperatures.

Wine arrangement

Top Compartment:

the temperature can be adjusted between $+6$ and $+12^{\circ}\text{C}$. This compartment is ideal for wines, especially new reds and whites, to be consumed immediately.

Bottom Compartment:

the temperature can be adjusted between $+12$ and $+18^{\circ}\text{C}$. This compartment is ideal for storing and refining red or white wines for long periods.

The temperatures of this compartment are suitable for storing aged and full-bodied wines.

Lay the bottles down in such a way that the corks do not dry.

Keep the wine in the dark. The oven door is in anti-UV darkened double glass to protect the wine from the light in case the refrigerator is located in a well-lit place.

Avoid switching the appliance light on too often or for too long. Wine keeps better in the dark.

Handle the bottles with care, to avoid agitating the wine.

Follow the recommendations and advice received at the time of purchase or given in the technical documentation regarding the quality, duration and optimum storage temperature of the wine.

Storage advice

The storage time for wine depends on ageing, the type of grapes, alcoholic content and level of fructose and tannin contained in it. At the time of purchase, check if the wine is already aged or if it will improve over time.

Recommended storage temperatures:

- for champagne and sparkling wines, between 6 and 8°C
- for white wines, between 10 and 12°C
- for rose' and light red wines, between 12 and 16°C
- aged red wines, 14 -1 6°C

When placing various bottles on top of each other, make sure they do not touch the refrigerator cooling plate.

Temperature regulation

Select the compartment by pressing the key (C)

Set the temperature by turning the knob (B or F depending on the compartment to be adjusted).

The correct position must in any case be determined bearing in mind that the inside temperature depends on these factors:

- Room temperature
- How often the doors are opened
- The quantity of bottles stored
- The position of the appliance

Switching off

Press the key (A) for more than 1 second to switch the appliance off. A temperature countdown of -3 -2 -1 will then be signalled.

When the appliance is switched off, also the display (D) goes off.

Acoustic alarm with door open

An acoustic alarm sounds when the door remains open for about 5 minutes.

Door open alarm status is indicated by:

- the symbol (1) flashing;
- the display lighting up red;
- the buzzer sounding.

To stop the acoustic alarm, press the key (E).

The acoustic signal goes off - when normal conditions are restored (door closed).

Button “Light On” and light indicator

In the case you want to maintain the light on with the door closed, it is sufficient to open and close the door and the light will remain ON automatically for 10 minutes.

If you want to switch off the light before the automatic turn off time, open the door and push the switch button (E). The light has no negative effect on the quality on the wine.

Inside accessories

Shelves

The shelves can be removed for cleaning.

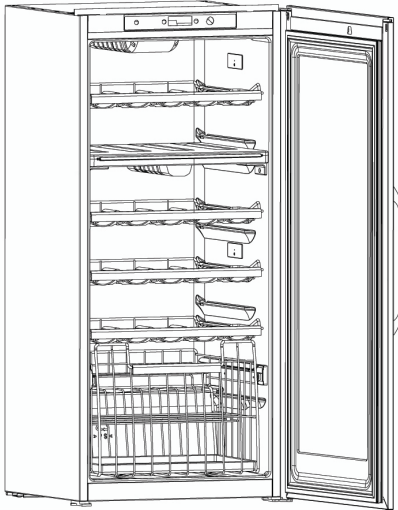

The shelf can be arranged between guides 100 mm apart to favour display of the bottles.

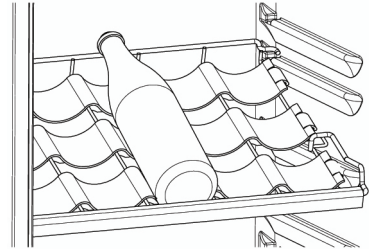

The bottom compartment is arranged with a sliding drawer to be used for placing the bottles upright.

The drawer has two dividers that adapt to bottles of different diameters.

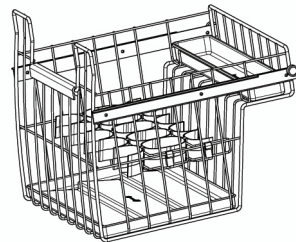

Bottle holder

Remove the shelf and insert it between the two guides

The maximum possible weight on the bottle shelves is 30 kg.

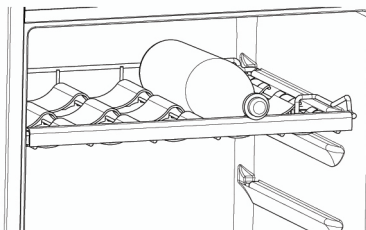

Air circulation

The refrigerator compartment has a special AIRLIGHT fan which is automatically activated in function of the appliance thermostat setting and ambient conditions.

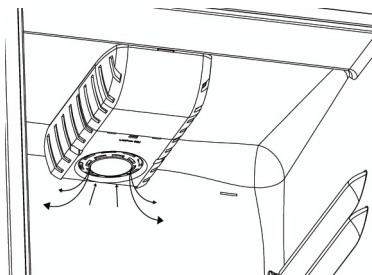

MAINTENANCE



Important:

Unplug the appliance before carrying out any operation.



Important

This appliance contains hydrocarbons in the refrigerant circuit; therefore maintenance and recharging must only be carried out by personnel authorised by the manufacturer.

Defrosting

Defrosting in the refrigerator compartment occurs automatically. The defrost water is run into a bowl located at the back of the appliance, above the compressor, where it evaporates. Make sure to periodically clean the defrost water drain hole, using the special "cleaner".

Cleaning

Clean the inside, removing the shelves and bottle holders, with lukewarm water and a mild detergent. Periodically clean the defrost water drain hole, using the special "cleaner". Periodically clean the condenser and motor compressor with a brush or vacuum cleaner. This operation will improve operation, with consequent energy saving. During periods when the appliance is not being used, take the following precautions:

- unplug the appliance;
- defrost and clean the inside and all the accessories;
- leave the door ajar to prevent the formation of unpleasant odours.



Important:

Never use metal objects to clean the appliance.

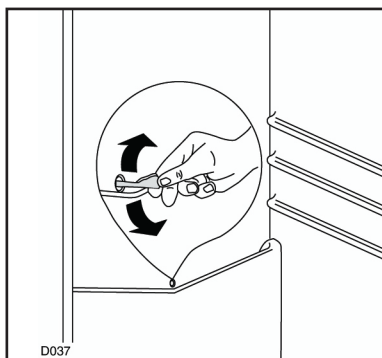

Lamp replacement safety instructions

For safety reasons this appliance is provided with special lamps specifically tested and certified for the foreseen use.

They can only be replaced with lamps of the same type and having the same characteristics.

Replacement lamps must be requested only from the manufacturer or its authorised customer service.

Do not use non-certified normal lamps.

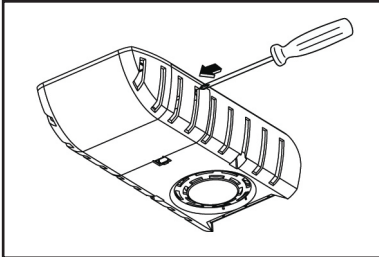

Lighting lamps

To replace the top lamp, remove the transparent cover by pressing it inwards with a tool (e.g. screwdriver) to free the rear side hookings. At the same time, free the middle hook and slide off the cover in the direction of the arrows.

To replace the bottom lamp, remove the transparent cover by pressing the front hooking with a tool (e.g. screwdriver) and at the same time pull in the direction of the arrow.

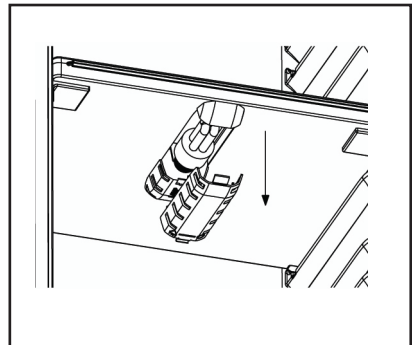
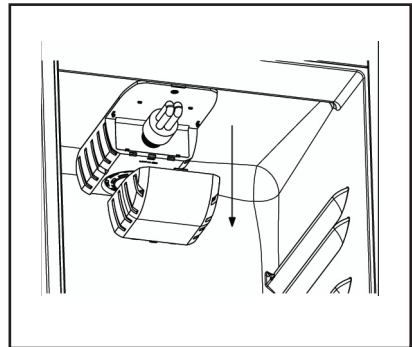

SOMETHING NOT WORKING

Important: If you call out an engineer to a fault listed below, or to repair a fault caused by incorrect use or installation a charge will be made, even if the appliance is under guarantee.

Before contacting your local Service Force Centre, check the following points:

Symptom	Solution
No power to the appliance	Check there is power at the socket. Check there is not a power cut by checking the household lights. Check the fuse has not blown.
The light does not come on	Ensure that the bulb is correctly fitted. Replace the bulb if it has blown. Check the door light switch is not jammed.
The temperature in the fridge	Check the electronic control in the fridge is in the correct setting relative to ambient conditions. Check the ambient temperature is within the appliance's operating limits, please refer to the installation section in this instruction book. Relocate the appliance if necessary.
The compressor runs continuously	Check if the electronic control knob gives the correct temperature control. See "Setting the temperature". Check that the door is closed. Large quantities of food have recently been placed in the cabinet and/or door is frequently opened. Check that air ventilation is not obstructed.
Noise	Refer to normal operating sounds.
Water under the salad crispers	Check the drain hole is not blocked. (see Maintenance and Cleaning).

If, after the above checks, there is still a fault, call your local Service Force Centre. In guarantee customers should ensure that the above checks have been made as the engineer will make a charge if the fault is not a mechanical or electrical breakdown. Please note that proof of purchase is required for any inguarantee service calls.

TECHNICAL SPECIFICATIONS

Net Fridge Capacity lt.	218
Bottle capacity	64
Energy Consumption kWh/24h	0,619
Energy Consumption kWh/year	226
Power supply voltage and frequency	230-240 V / 50 Hz
High (mm)	1225
Width (mm)	560
Depth (mm)	550

The technical information are situated in the rating plate on the internal left side of the appliance.

CUSTOMER SERVICE AND SPARE PARTS

If the appliance is not functioning properly, check that:

- the plug is firmly in the wall socket and the mains power switch is on;
- there is an electricity supply (find out by plugging in another appliance);
- If there are water drops on the bottom of the cabinet, check that the defrost water drain opening is not obstructed (see “Defrosting” section).

- If your appliance is still not working properly after making the above checks, contact the nearest service centre.
- If the power cable is damaged, it must be replaced with a special cable or assembly available from the manufacturer or the technical assistance service.

To obtain fast service, it is essential that when you apply for it you specify the model and serial number of your appliance which can be found on the guarantee certificate or on the rating plate located inside the appliance, on the bottom left-hand side.

Electrical connections

Any electrical work required to install this appliance should be carried out by a qualified electrician or competent person.

WARNING: THIS APPLIANCE MUST BE EARTHED.

The manufacturer declines any liability should this safety measure not be observed.

If the plug that is fitted to your appliance is not suitable for your socket outlet, it must be cut off and the appropriate plug fitted.

Remove the fuse from the cut off plug. The cut off plug should then be disposed of to prevent the hazard of shocks in case it should be plugged into a 13amp socket in another part of your home.

Important

The wires in the mains lead are coloured in accordance with the following code:

Green and Yellow	- Earth
Blue	- Neutral
Brown	- Live

 If you fit your own plug, the colours of the wires in the mains lead of your appliance may not correspond with the markings identifying the terminals in your plug, proceed as follows:

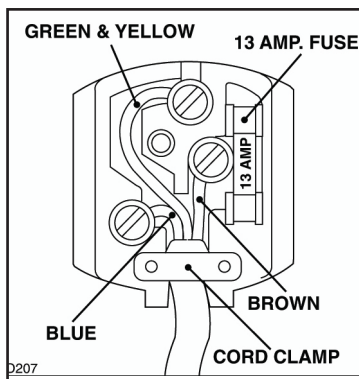

Connect the Green and Yellow (earth) wire to the terminal in the plug which is marked with the letter «E» or the earth symbol  or coloured green and yellow.

Connect the blue (neutral) wire to the terminal in the plug which is marked with the letter «N» or coloured black.

Connect the brown (live) wire to the terminal in the plug which is marked with the letter «L» or coloured red.

The plug moulded onto the lead incorporates a fuse. For replacement, use a 13amp BSI362 fuse. Only ASTA or BSI approved fuses should be used.

The plug must not be used if the fuse cover/carrier is lost. The cover/carrier is indicated by the coloured insert at the base of the plug.

A replacement cover/carrier must be obtained from your local Electrolux Service Force Centre.

This appliance complies with the E.E.C. Directive No. 87/308 of 2.6.87 relative to radio interference suppression.

C E This appliance complies with the following E.E.C. Directives:

- **73/23 EEC of 19.2.73** (Low Voltage-Directive) and subsequent modifications;

- **89/336 EEC of 3.5.89** (Electromagnetic Compatibility Directive) and subsequent modifications.

Please ensure that when the appliance is installed it is easily accessible for the engineer in the event of a breakdown.

Installation

Dimensions of the recess

Height of housing	mm	1225
Depth of housing	mm	550
Width of housing	mm	560

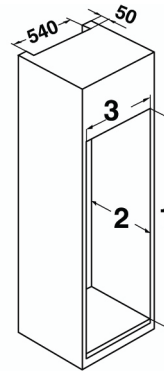

PR01

It is necessary that the cabinet has a ventilation recess with the following dimensions:

Depth	50 mm
Width	540 mm

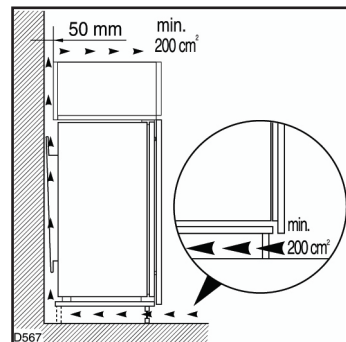

D567

Press in the joint covers as indicated in the figure

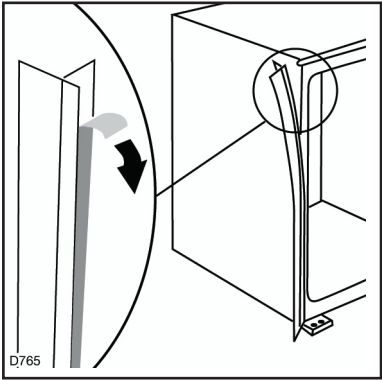

Fix the appliance with the screw

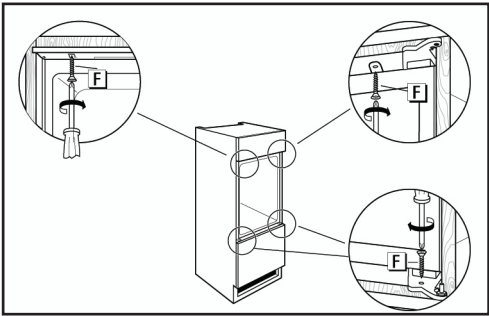

Appliance insert

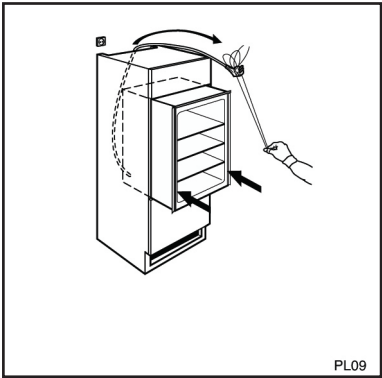

Fix the covers on the screws

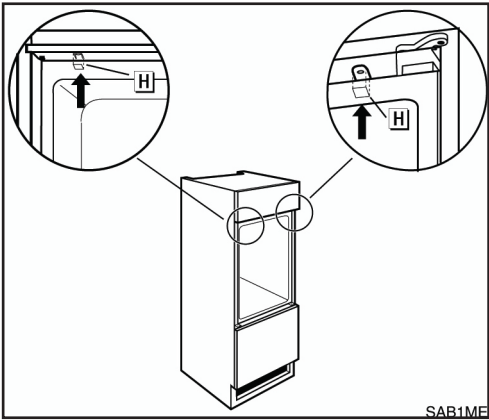

Assembly of the handle

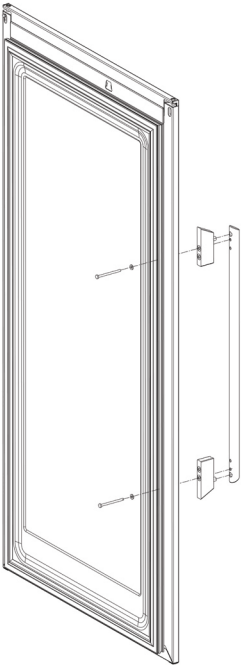

EUROPEAN GUARANTEE

This appliance is guaranteed by Electrolux in each of the countries listed at the back of this user manual, for the period specified in the appliance guarantee or otherwise by law. If you move from one of these countries to another of the countries listed, the appliance guarantee will move with you subject to the following qualifications:

- The appliance guarantee starts from the date you first purchased the appliance which will be evidenced by production of a valid purchase document issued by the seller of the appliance.
- The appliance guarantee is for the same period and to the same extent for labour and parts as exists in your new country of residence for this particular model or range of appliances.
- The appliance guarantee is personal to the original purchaser of the appliance and cannot be transferred to another user.
- The appliance is installed and used in accordance with instructions issued by Electrolux and is only used within the home, i.e. is not used for commercial purposes.
- The appliance is installed in accordance with all relevant regulations in force within your new country of residence. The provisions of this European Guarantee do not affect any of the rights granted to you by law.

Albania	+35 5 4 261 450	Rr. Pjeter Bogdani Nr. 7 Tirane
Belgique/België/Belgien	+32 2 363 04 44	Bergensesteenweg 719, 1502 Lembeek
Česká republika	+420 2 61 12 61 12	Budějovická 3, Praha 4, 140 21
Danmark	+45 70 11 74 00	Sjællandsgade 2, 7000 Fredericia
Deutschland	+49 180 32 26 622	Muggenhofer Str. 135, 90429 Nürnberg
Eesti	+37 2 66 50 030	Mustamäe tee 24, 10621 Tallinn
España	+34 902 11 63 88	Carretera M-300,Km.29,900 Alcalá de Henares Madrid
France	www.electrolux.fr	
Great Britain	+44 8705 929 929	Addington Way, Luton, Bedfordshire LU4 9QQ
Hellas	+30 23 10 56 19 70	4, Limnou Str., 54627 Thessaloniki
Hrvatska	+385 1 63 23 338	Slavonska avenija 3, 10000 Zagreb
Ireland	+353 1 40 90 753	Long Mile Road Dublin 12
Italia	+39 (0) 434 558500	C.so Lino Zanussi, 26 - 33080 Porcia (PN)
Latvija	+37 17 84 59 34	Kr. Barona iela 130/2, LV-1012, Riga
Lietuva	+370 5 2780609	Verkių 29, LT-09108 Vilnius
Luxembourg	+35 2 42 43 13 01	Rue de Bitbourg, 7, L-1273 Hamm
Magyarország	+36 1 252 1773	H-1142 Budapest XIV, Erzsébet királyné útja 87
Nederland	+31 17 24 68 300	Vennootsweg 1, 2404 CG - Alphen aan den Rijn
Norge	+47 81 5 30 222	Risløkkvn. 2 , 0508 Oslo
Österreich	+43 18 66 400	Herziggasse 9, 1230 Wien
Polska	+48 22 43 47 300	ul. Kolejowa 5/7, Warsaw
Portugal	+35 12 14 40 39 39	Quinta da Fonte-Edifício Gonçalves Zarco-Q.35-2774-518 Paço de Arcos
Romania	+40 21 451 20 30	Str. Garii Progresului 2, S4, 040671 RO
Schweiz-Suisse-Svizzera	+41 62 88 99 111	Industriestrasse 10, CH-5506 Mägenwil
Slovenija	+38 61 24 25 731	Electrolux Ljubljana d.o.o., Gerbičeva 98, 1000 Ljubljana
Slovensko	+421 2 43 33 43 22	Electrolux Slovakia s.r.o., Electrolux Domáce spotrebiče SK, Seberínho 1, 821 03 Bratislava
Suomi	www.electrolux.fi	
Sverige	+46 (0)771 76 76 76	Electrolux Service, S:t Göransgatan 143, S-105 45 Stockholm
Türkiye	+90 21 22 93 10 25	Tarlabası caddesi no : 35 Taksim İstanbul
Россия	+7 095 937 7837	129090 Москва, Олимпийский проспект, 16, БЦ "Олимпик"

