

Electrolux benefit counters

415 liter

The Electrolux range of benefit counters combines the convenience of worktop space with cold storage located. The models detailed on this sheet are 415 liter counters with built-in refrigerating unit and available with various combinations of doors and drawers.



726188

CONSTRUCTION

- Internal and external door panels, front and side panels and 50 mm thick removable worktop (except for model without top) in 304 AISI stainless steel (excluding model RCSN3M34).
- Back in galvanized steel.
- Insulation guaranteed by high density expanded cyclopentane 50 mm in thickness.
- Legs (150 mm high) in 304 AISI stainless steel with plastic interior and adjustable in height.
- The door self-closes when opened less than at a 90° angle and is equipped with a door seal to guarantee perfect closure.
- CFC and HCFC free.
- All models comply with the standards required by the main international approval bodies and

are H marked.

PERFORMANCES

- Digital control panel allowing the easy and precise setting and control of the internal temperature.
- Completely automatic defrosting and automatic evaporation of defrost water by hot gas.
- Forced air cooling system guaranteeing great uniformity of the temperature in the counter and excellent conservation of the food quality.

- Operating temperature: -2/+10°C.
- Refrigerant gas R404a.
- Possibility to install on socket.
- Kit with 1/2 sized drawers available as accessories.
- The refrigeration unit can operate in tropical climates (+43°C ambient temperature).
- High standards of hygiene and ease of cleaning are guaranteed by the rounded internal corners of the cabinet and easily removable runners and grids.



Electrolux

**Electrolux benefit counters
415 liter**

	RCSN3M3 726141	RCSN3M3T 726669	RCSN3M22 726145	RCSN3M14 726146	RCSN3M3U 726188	RCSN3M34 727007	RCSN3M06 727180
TECHNICAL DATA							
Operating temperature - min/max °C	-2/10	-2/10	-2/10	-2/10	-2/10	-2/10	-2/10
Operating mode	Ventilated	Ventilated	Ventilated	Ventilated	Ventilated	Ventilated	Ventilated
Type of stainless steel							
external	304 AISI	304 AISI	304 AISI	304 AISI	304 AISI	Stainless Steel	304 AISI
internal	304 AISI	304 AISI	304 AISI	304 AISI	304 AISI	Stainless Steel	304 AISI
Gross capacity (D.I.N. 8952) - l.	415	415	415	415	415	415	415
Cooling unit	Built-In	Built-In	Built-In	Built-In	Built-In	Built-In	Built-In
Control type	Digital	Digital	Digital	Digital	Digital	Digital	Digital
External dimensions - mm							
width	1718	1718	1718	1718	1721	1718	1718
depth/with open doors	700, 1102	700, 1102	700, 1102	700, 1102	700, 1102	700, 1102	700, 1102
height	850	800	850	850	950	850	850
Internal dimensions - mm							
width	365	365		365	365	365	365
depth	580	580	580	580	580	580	580
height	543	543	543	543	543	543	543
Upstand					●		
Without worktop		●					
Min/Max internal humidity - %	50	50	50	50	50	50	50
N° of drawers			2x1/2	4x1/2			6x1/2
N° of doors	3	3	2	1	3	3	
Door hinges	1 Left+2 Right	1 Left+2 Right	1 Left+1 Right	Left	1 Left+2 Right	1 Left+2 Right	
Compressor power - HP	1/4	1/4	1/4	1/4	1/4	1/4	1/4
N° defrost in 24 hrs.	every 6 hours	every 6 hours	every 6 hours	every 6 hours	every 6 hours	every 6 hours	every 6 hours
Refrigerant type	R404a	R404a	R404a	R404a	R404a	R404a	R404a
Refrigerant quantity - g.	150	150	150	150	150	150	150
Refrigeration power - W	343	343	343	343	343	343	343
Power - kW							
installed-electric	0.335	0.335	0.335	0.335	0.335	0.335	0.335
Noise level - dBA	58.5	58.5	58.5	58.5	58.5	58.5	58.5
Net weight - kg.	142	137	150	158	143	142	154
Power supply - V, phases, Hz	230 V, 1N, 50	230 V, 1N, 50	230 V, 1N, 50	230 V, 1N, 50	230 V, 1N, 50	230 V, 1N, 50	230 V, 1N, 50
INCLUDED ACCESSORIES							
1/1 GN GREY "RILSAN" GRID	3	3	2	1	3	3	
ACCESSORIES							
1/1 GN GREY "RILSAN" GRID						881435	
KIT 2 S/S GRIDS GN1/1 FOR REFRIG.TABLES	880139		880139	880139	880139	880139	
KIT 4 WHEELS (2 W/BRAKE)+4 (40MM)SPACERS	880025	880025	880025	880025	880025	880025	880025
KIT DOOR REVERSIBILITY FOR REF.TABLES	880046	880046	880046	880046	880046	880046	
KIT HACCP EKIS	922166	922166	922166	922166	922166	922166	922166
KIT INTEGRATED HACCP-DIG. REFR. (IR33)	880205	880205	880205	880205	880205	880205	880205
LOCK KIT	880024	880024	880024	880024	880024	880024	880024
PLASTIC CONTAINER GN 1/1 H=150 MM	881040	881040	881040	881040	881040	881040	
PLASTIC CONTAINER GN 1/1 H=65 MM	881038	881038	881038	881038	881038	881038	
PRINTER FOR HACCP BASIC VERSION REFRIG.	881457	881457	881457	881457	881457	881457	881457
S/S STRUCTURE TO SUPPORT 6 GRIDS (R+L)	880140			880140	880140	880140	
STRUCTURE TO SUPPORT 3 GRIDS(RIGHT+LEFT)	880047	880047	880047	880047	880047	880047	
TWO ½ DRAWER KIT	880023	880023	880023	880023	880023	880023	

HBAD030

2009-10-06

Subject to change without notice

**Electrolux benefit counters
415 liter**

726669

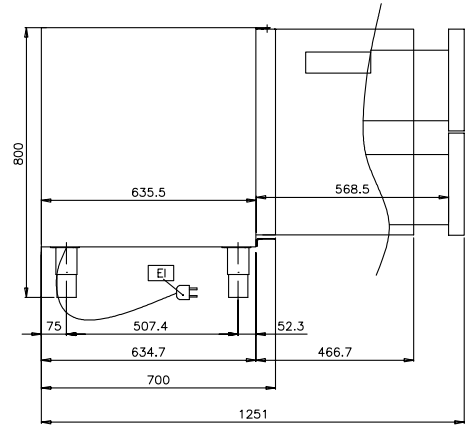
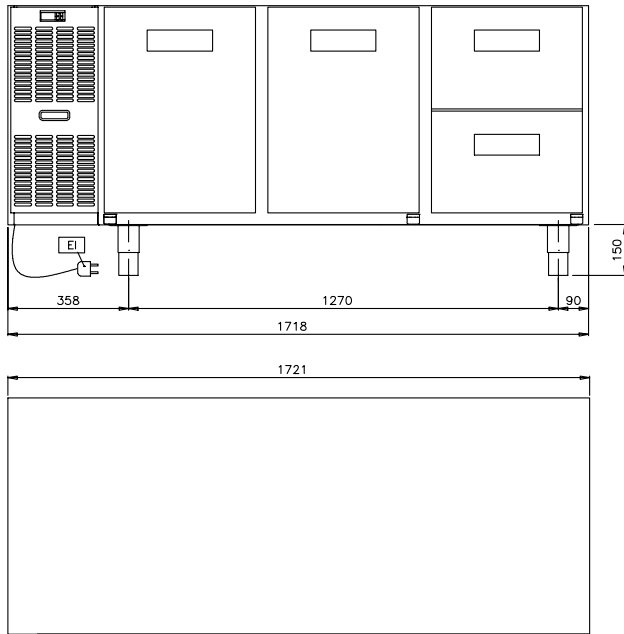

LEGEND EI - Electrical connection	RCSN3M3T 726669
	230 V, 1N, 50

HBAD030

2009-10-06

Subject to change without notice