

KENWOOD

MICRO HI-FI COMPONENT SYSTEM

HM-233

INSTRUCTION MANUAL

KENWOOD CORPORATION

Thank you for purchasing this KENWOOD product.
To obtain the best performance from this product, please
read this manual carefully. It will guide you in operating your
KENWOOD product.

HM-233 Micro HI-FI Component System consisting of RD-M23
(main unit) and LS-M23 (speaker system).

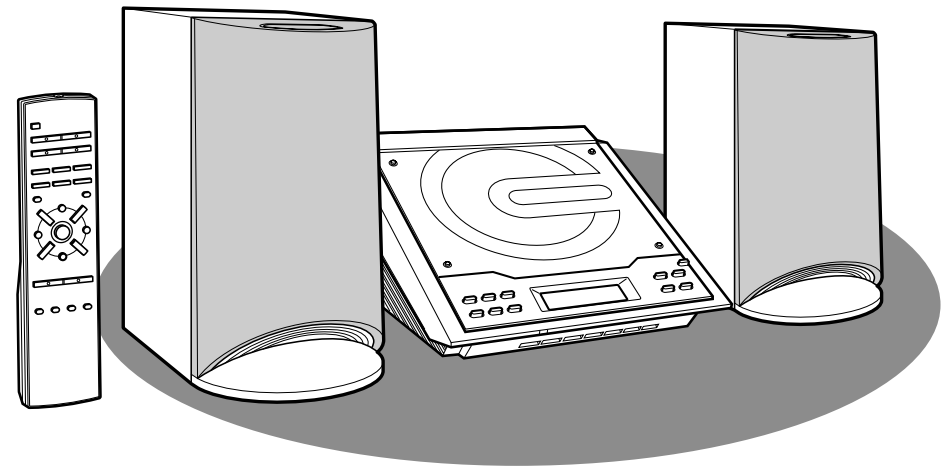

COMPACT
disc
DIGITAL AUDIO

B60-5125-08 00 (CH) (T) 0105

Important Safeguards

Please read all of the safety and operating instructions before operating this appliance. Adhere to all warnings on the appliance and in the instruction manual. Follow all the safety and operating instructions. These safety and operating instructions should be retained for future reference.

1. **Power sources** - The appliance should be connected to a power supply only of the type described in the instruction manual or as marked on the appliance. If you are not sure of the type of power supply to your home, consult your appliance dealer or local power company. For appliances intended to operate from battery power, or other sources, refer to the instruction manual.
2. **Power-cord protection** - Power-supply cords should be routed so that they are not likely to be walked on or pinched by items placed upon or against them, pay particular attention to cords at plugs, convenience receptacles, and the point where they exit from the appliance.
3. **CAUTION - Polarization** - This appliance may be equipped with a polarized alternating-current line plug (a plug having one blade wider than the other). This plug will fit into the power outlet only one way. This is a safety feature. If you are unable to insert the plug fully into the outlet, try reversing the plug. If the plug should still fail to fit, contact your electrician to replace your obsolete outlet. Do not defeat the safety purpose of the polarized plug.
4. **Ventilation** - Slots and openings in the cabinet are provided for ventilation and to ensure reliable operation of the appliance and to protect it from overheating, and these openings must not be blocked or covered. The appliance should be situated so that its location or position does not interfere with its proper ventilation. To maintain good ventilation, do not put records or a tablecloth on the appliance. Place the appliance at least 10 cm away from walls. Do not use the appliance on a bed, sofa, rug or similar surface that may block the ventilation openings. This appliance should not be placed in a built-in installation such as a bookcase or rack unless proper ventilation is provided or the manufacturer's instructions have been adhered to.
5. **Water and moisture** - The appliance should not be used near water - for example, near a bathtub, washbowl, kitchen sink, laundry tub, in a wet basement, or near a swimming pool, etc.
6. **Temperature** - The appliance may not function properly if used at extremely low, or freezing temperatures. The ideal ambient temperature is above +5°C (41°F).
7. **Heat** - The appliance should be situated away from heat sources such as radiators, heat registers, stoves, or other appliances (including amplifiers) that produce heat.
8. **Electric shock** - Care should be taken so that objects do not fall and liquid is not spilled into the enclosure through openings. If a metal objects, such as a hair pin or a needle, comes into contact with the inside of this appliance, a dangerous electric shock may result. For families with children, never permit children to put anything, especially metal, inside this appliance.
9. **Enclosure removal** - Never remove the enclosure. If the internal parts are touched accidentally, a serious electric shock might occur.
10. **Cleaning** - Unplug this appliance from the wall outlet before cleaning. Do not use volatile solvents such as alcohol, paint thinner, gasoline, or benzine, etc. to clean the cabinet. Use a clean dry cloth.
11. **Lightning** - For added protection for this appliance during a lightning storm, or when it is left unattended and unused for long periods of time, unplug it from the wall outlet and disconnect the antenna or cable system. This will prevent damage to the appliance due to lightning and power-line surges.
12. **Abnormal smell** - If an abnormal smell or smoke is detected, immediately turn the power OFF and unplug the appliance from the wall outlet. Contact your dealer or nearest service center.
13. **Damage requiring service** - The appliance should be serviced by qualified service personnel when:
 - A. The power-supply cord or the plug has been damaged.
 - B. Objects have fallen, or liquid has been spilled into the appliance.
 - C. The appliance has been exposed to rain or water.
 - D. The appliance does not appear to operate normally by following the instruction manual. Adjust only those controls that are covered by the instruction manual as an improper adjustment of other controls may result in damage and will often require extensive work by a qualified technician to restore the appliance to its normal operation.
 - E. The appliance has been dropped, or the enclosure damaged.
 - F. The appliance exhibits a marked change in performance.
14. **Servicing** - The user should not attempt to service the appliance beyond that described in the instruction manual. All other servicing should be referred to qualified service personnel.
15. **Power lines** - An outside antenna system should not be located in the vicinity of overhead power lines or other electric light or power circuits, or where it can fall into such power lines or circuits. When installing an outside antenna system, extreme care should be taken to keep from touching such power lines or circuits as contact with them might be fatal.
16. **AC outlets** - Do not connect other audio equipment with a power consumption larger than that specified to the AC outlet on the rear panel. Never connect other electrical appliances, such as an iron or toaster, to it to prevent fire or electric shock.
17. **Overloading** - Do not overload wall outlets, extension cords, or integral convenience receptacles as this can result in a risk of fire or electric shock.
18. **Attachment** - Do not use attachments not recommended by the appliance manufacturer as they may cause hazards.
19. **Replacement parts** - When replacement parts are required, be sure the service technician has used replacement parts specified by the manufacturer or have the same characteristics as the original parts. Unauthorized substitutions may result in fire, electric shock, or other hazards.
20. **Safety check** - Upon completion of any service or repairs to this appliance, ask the service technician to perform safety checks to determine that the appliance is in proper operating condition.

Special Notes

WARNINGS

- When the ON/STANDBY button is set at STANDBY position, mains voltage is still present inside the unit. When the ON/STANDBY button is set at STANDBY position, the unit may be brought into operation by the timer mode or remote control.
- This unit contains no user serviceable parts. Never remove covers unless qualified to do so. This unit contains dangerous voltages, always remove mains plug from the socket before any service operation and when not in use for a long period.
- To prevent fire or shock hazard, do not expose this appliance to dripping or splashing. No objects filled with liquids, such as vases, shall be placed on the apparatus.

CAUTION

- Use of controls, adjustments or performance of procedures other than those specified herein may result in hazardous radiation exposure.
- As the laser beam used in this compact disc player is harmful to the eyes, do not attempt to disassemble the cabinet. Refer servicing to qualified personnel only.

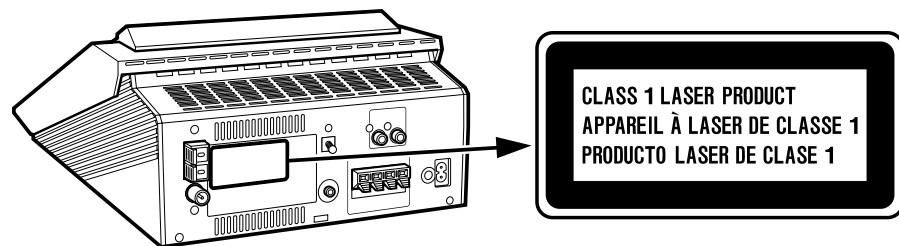

NOTE

This equipment complies with the requirements of Directives 89/336/EEC and 73/23/EEC as amended by 93/68/EEC.

Contents

	Page
■ General Information	
Precautions	4, 5
Accessories	5
Controls and Indicators	6 - 9
■ Preparation for Use	
System Connections	10, 11
Remote Control	12
■ Basic Operation	
General Control	13
Sound Control	14
Setting the Clock	15
■ CD Playback	
Listening to a CD	16, 17
Repeat or Random Play	18
Programmed Play	19
■ Radio	
Listening to the Radio	20
Listening to the memorised station	21
■ Advanced Features	
Timer and Sleep Operation	22, 23
Enhancing Your System	24
■ References	
Troubleshooting Chart	25, 26
Maintenance	26
Specifications	27

Precautions

■ General

- Please ensure that the equipment is positioned in a well-ventilated area and that there is at least 10 cm (4") of free space along the sides and back. There must also be a minimum of 30 cm (12") of free space on the top of the unit.

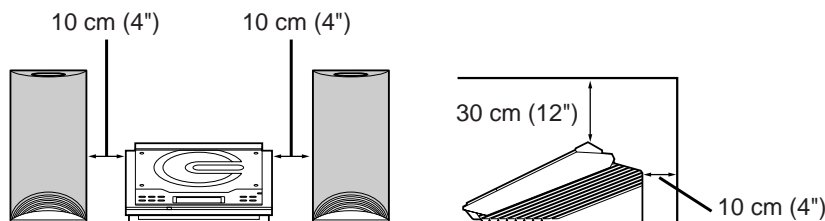

- Use the unit on a firm, level surface free from vibration.

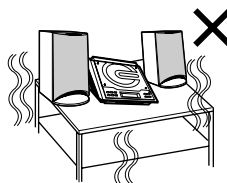

- Keep the unit away from direct sunlight, strong magnetic fields, excessive dust, humidity and electronic/electrical equipment (home computers, facsimiles, etc.) which generates electrical noise.

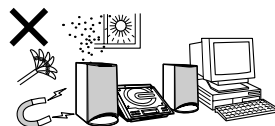

- Do not place anything on top of the unit.
- Do not expose the unit to moisture, to temperatures higher than 60°C (140°F) or to extremely low temperatures.
- If your system does not work properly, disconnect the AC power lead from the wall socket. Plug the AC power lead back in, and then turn on your system.
- In case of an electrical storm, unplug the unit for safety.

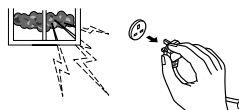

- Hold the AC power plug by the head when removing it from the wall socket, as pulling the lead can damage internal wires.

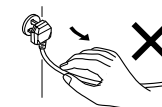

- Do not remove the outer cover, as this may result in electric shock. Refer internal service to your local KENWOOD service facility.

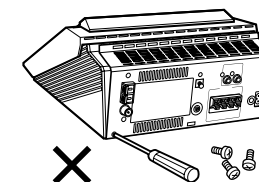

- The ventilation should not be impeded by covering the ventilation openings with items, such as newspapers, tablecloths, curtains, etc.

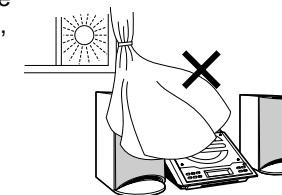

- No naked flame sources, such as lighted candles, should be placed on the apparatus.
- Attention should be drawn to the environmental aspects of battery disposal.
- The apparatus is designed for use in moderate climate.
- This unit should only be used within the range of 5°C - 35°C (41°F - 95°F).

Warnings:

- The voltage used must be the same as that specified on this unit. Using this product with a higher voltage other than that which is specified is dangerous and may result in a fire or other type of accident causing damage. KENWOOD will not be held responsible for any damage resulting from use of this unit with a voltage other than that which is specified.
- **CD players use a laser pickup which can damage the eyes if viewed directly. Do not look at the pickup, and do not touch the pickup directly.**

■ Volume control

The sound level at a given volume setting depends on speaker efficiency, location, and various other factors. It is advisable to avoid exposure to high volume levels, which occurs whilst turning the unit on with the volume control setting up high, or whilst continually listening at high volumes.

■ Care of compact discs

Compact discs are fairly resistant to damage, however mistracking can occur due to an accumulation of dirt on the disc surface. Follow the guidelines below for maximum enjoyment from your CD collection and player.

- Do not write on either side of the disc, particularly the non-label side from which signals are read. Do not mark this surface.
- Keep your discs away from direct sunlight, heat, and excessive moisture.
- Always hold the CDs by the edges. Fingerprints, dirt, or water on the CDs can cause noise or mistracking. If a CD is dirty or does not play properly, clean it with a soft, dry cloth, wiping straight out from the centre, along the radius.

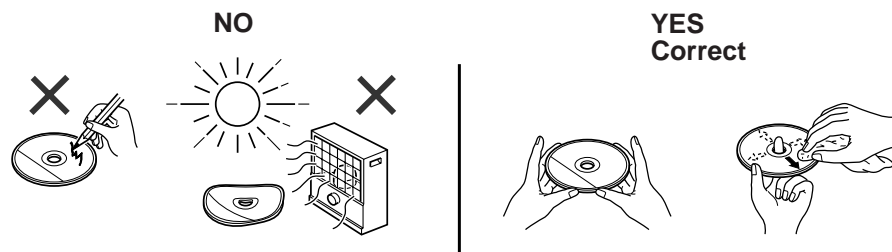

Accessories

Please confirm that the following accessories are included.

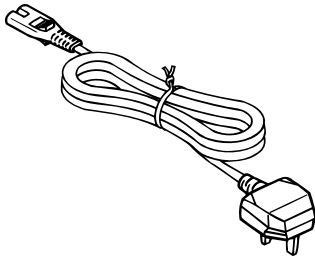
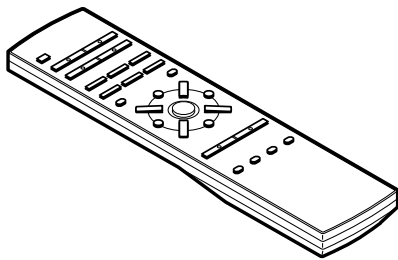
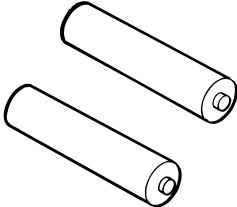
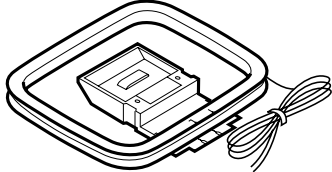
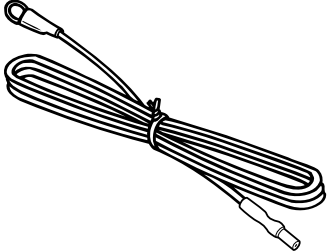
 <p>AC power lead × 1</p>	 <p>Remote control × 1</p>
 <p>"AAA" size battery (UM-4, R03, HP-16 or similar) × 2</p>	 <p>AM loop aerial × 1</p>
 <p>FM aerial × 1</p>	

Note:
Only the above accessories are included.

Controls and Indicators

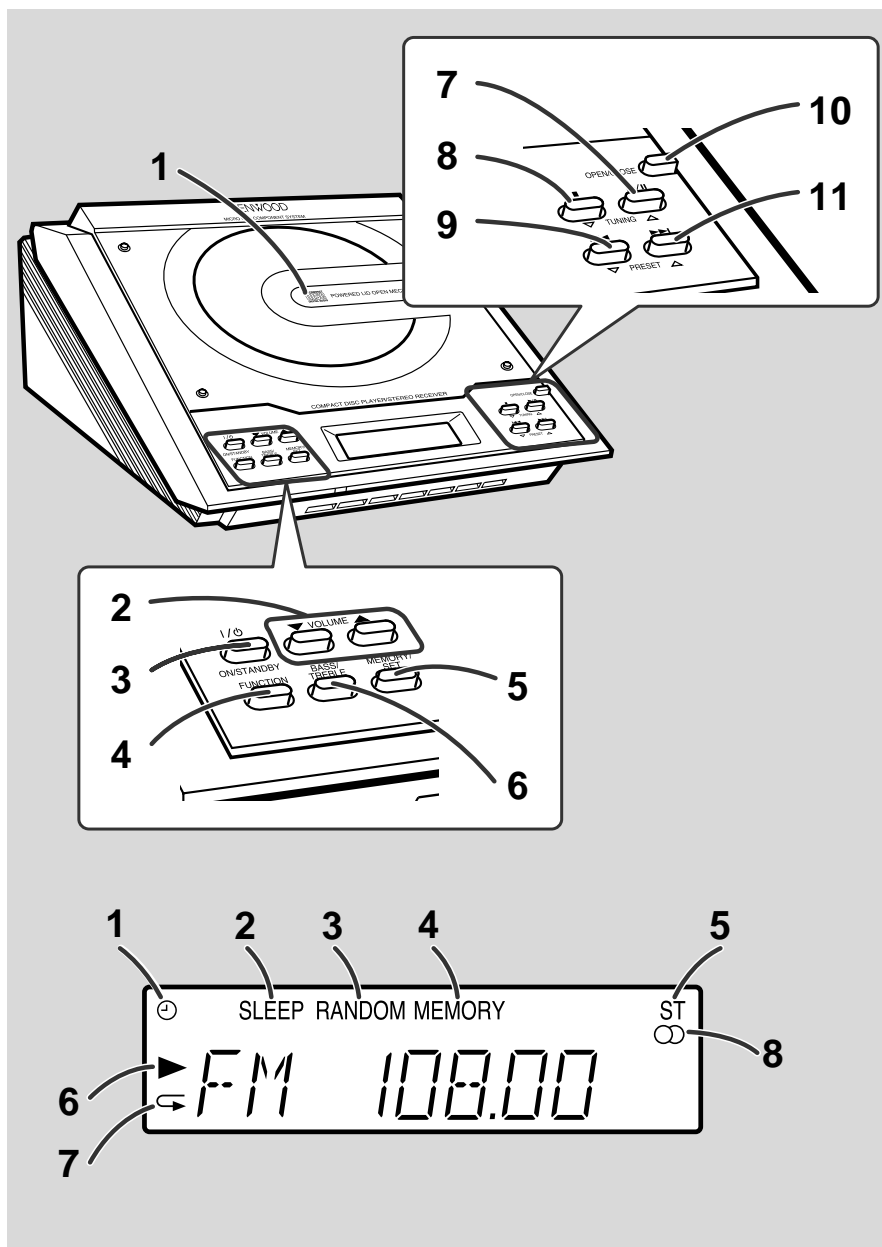

■ Front panel

	Reference page
1. CD Compartment	13
2. Volume Up and Down Buttons	14
3. On/Stand-by Button	13
4. Function Selector Button	16, 20
5. Memory/Set Button	19, 21
6. Bass/Treble Selector Button	14
7. CD Play or Pause, Tuning Up Button	16, 20
8. CD Stop, Tuning Down Button	16, 20
9. CD Track Down or Fast Reverse, Tuner Preset Down Button	17, 21
10. CD Open/Close Button	13
11. CD Track Up or Fast Forward, Tuner Preset Up Button	17, 21

■ Display

1. Timer Play Indicator
2. Sleep Indicator
3. CD Random Play Indicator
4. Memory Indicator
5. FM Stereo Mode Indicator
6. CD Play Indicator
7. CD Repeat Play Indicator
8. FM Stereo Receiving Indicator

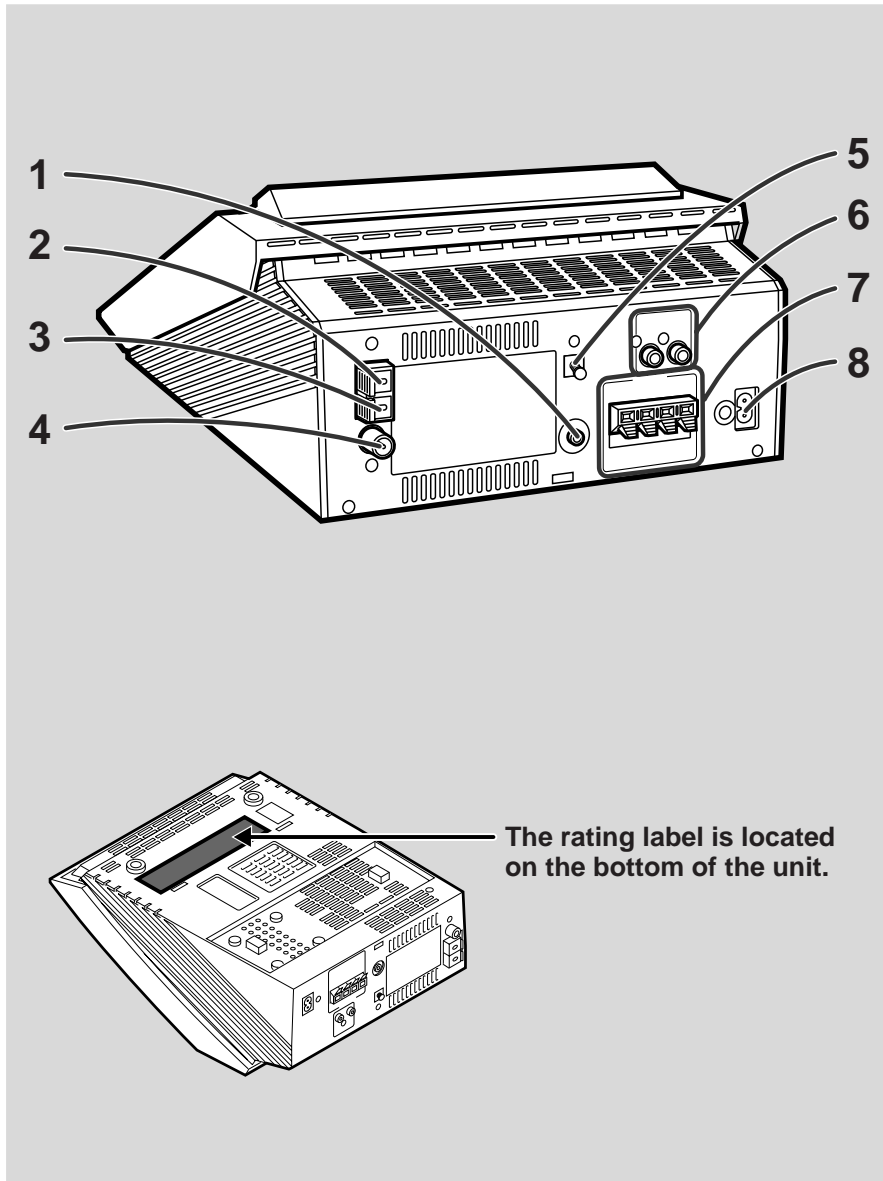

■ Rear panel

	Reference page
1. Headphone Socket	24
2. AM Aerial Terminal	10, 11
3. Aerial Earth Terminal	10, 11
4. FM 75 Ohms Aerial Socket	10, 11
5. CD Digital Output Socket	24
6. Video/Auxiliary (Audio Signal) Input Sockets	24
7. Speaker Terminals	10, 11
8. AC Power Input Socket	10, 11

Controls and Indicators (continued)

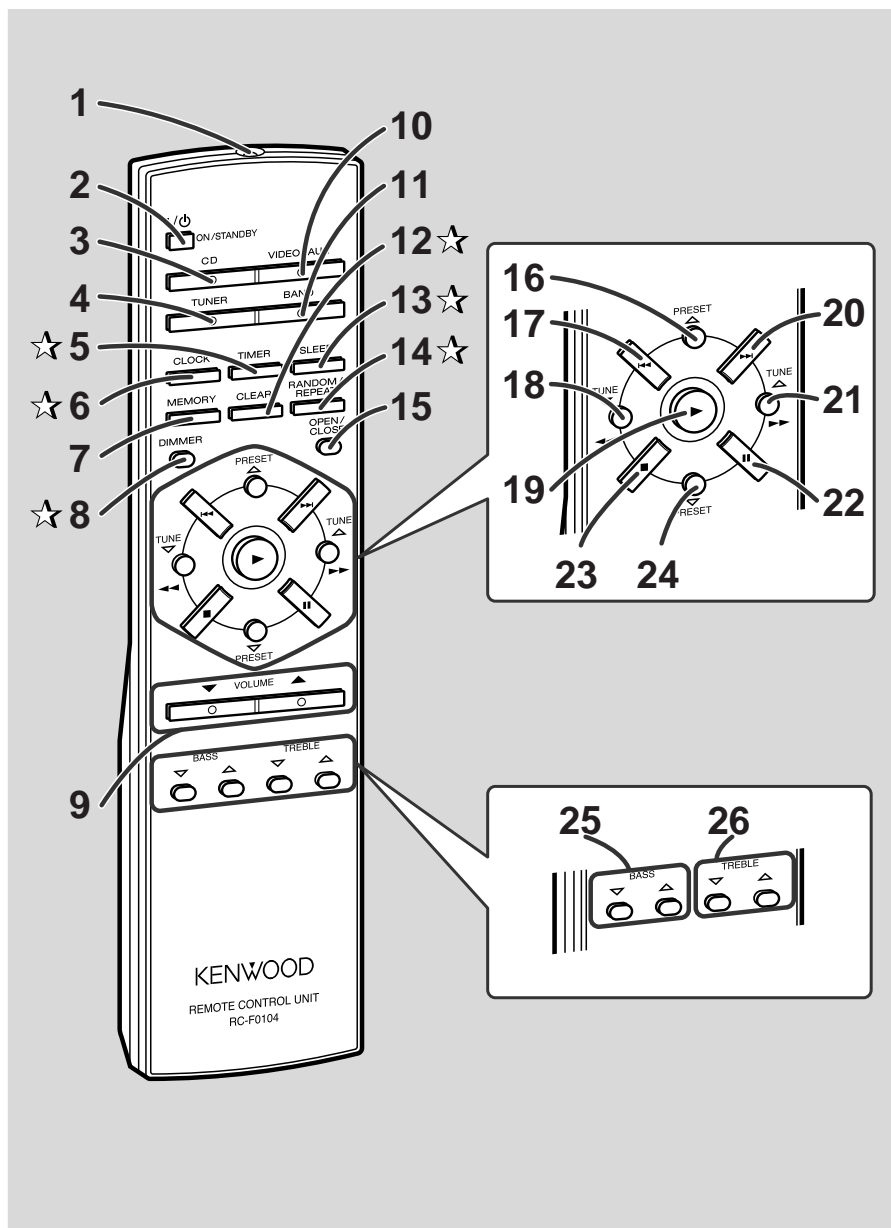

Remote control

	Reference page
1. Remote Control Transmitter	12
2. On/Stand-by Button	12
3. CD Button	16
4. Tuner Button	20
5. Timer Button	22
6. Clock Button	15
7. Memory Button	15, 19, 21
8. Dimmer Button	13
9. Volume Up and Down Buttons	14
10. Video/Auxiliary Button	24
11. Band Selector Button	20
12. Clear Button	19
13. Sleep Button	23
14. Random/Repeat Button	18
15. CD Open/Close Button	13
16. Tuner Preset Up Button	21
17. CD Track Down Button	17
18. CD Fast Reverse, Tuning Down Button	17, 20
19. CD Play Button	16
20. CD Track Up Button	17
21. CD Fast Forward, Tuning Up Button	17, 20
22. CD Pause Button	16
23. CD Stop Button	16
24. Tuner Preset Down Button	21
25. Bass Up and Down Buttons	14
26. Treble Up and Down Buttons	14

Buttons with "☆" mark in the illustration can be operated on the remote control only.
Other buttons can be operated both on the main unit and the remote control.

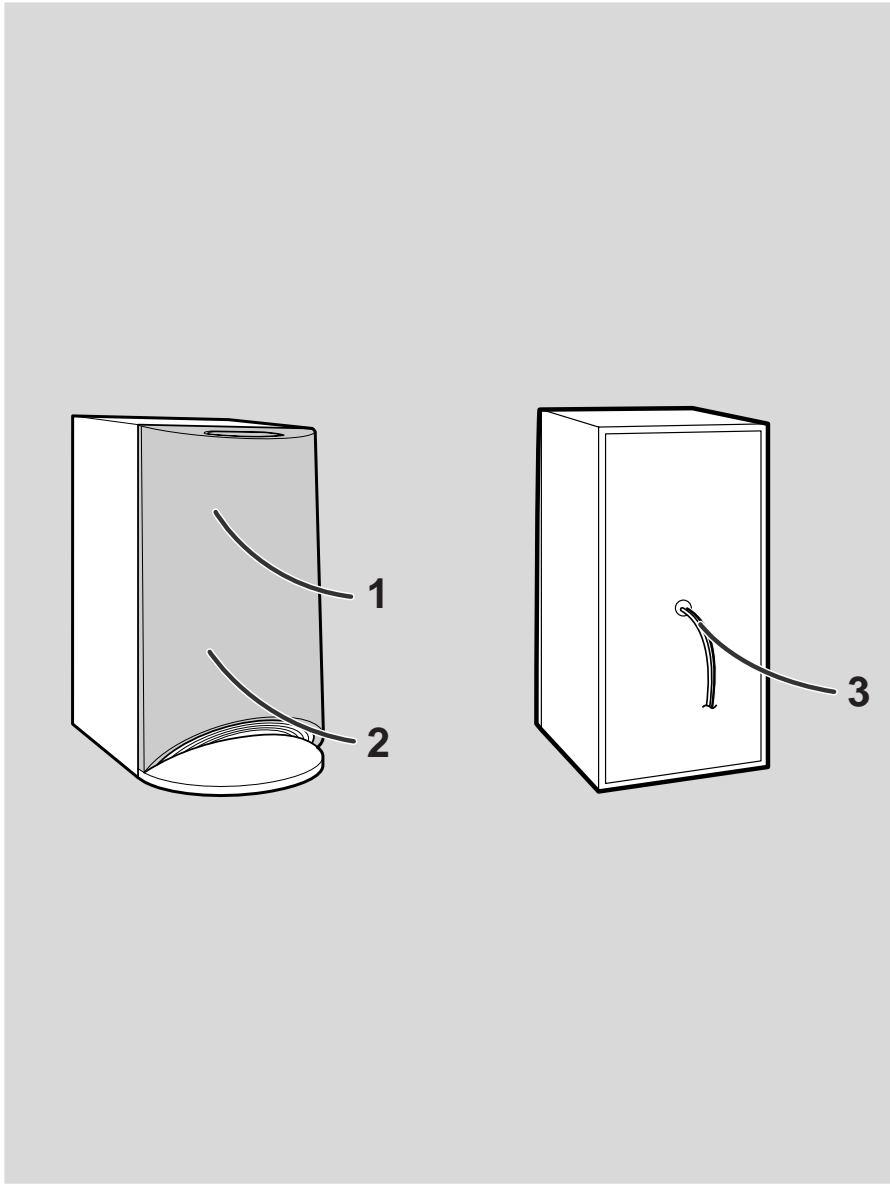

■ Speaker system

- 1. Tweeter
- 2. Woofer
- 3. Speaker Wire

■ Placing the speaker system

There is no distinction between the right and the left speakers.

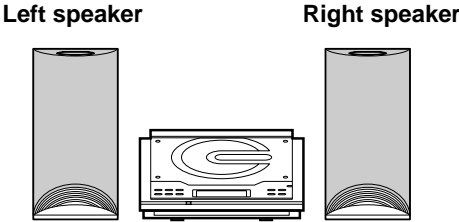

Note:
The speaker grille is not removable.

System Connections

Preparation for Use
- System Connections -

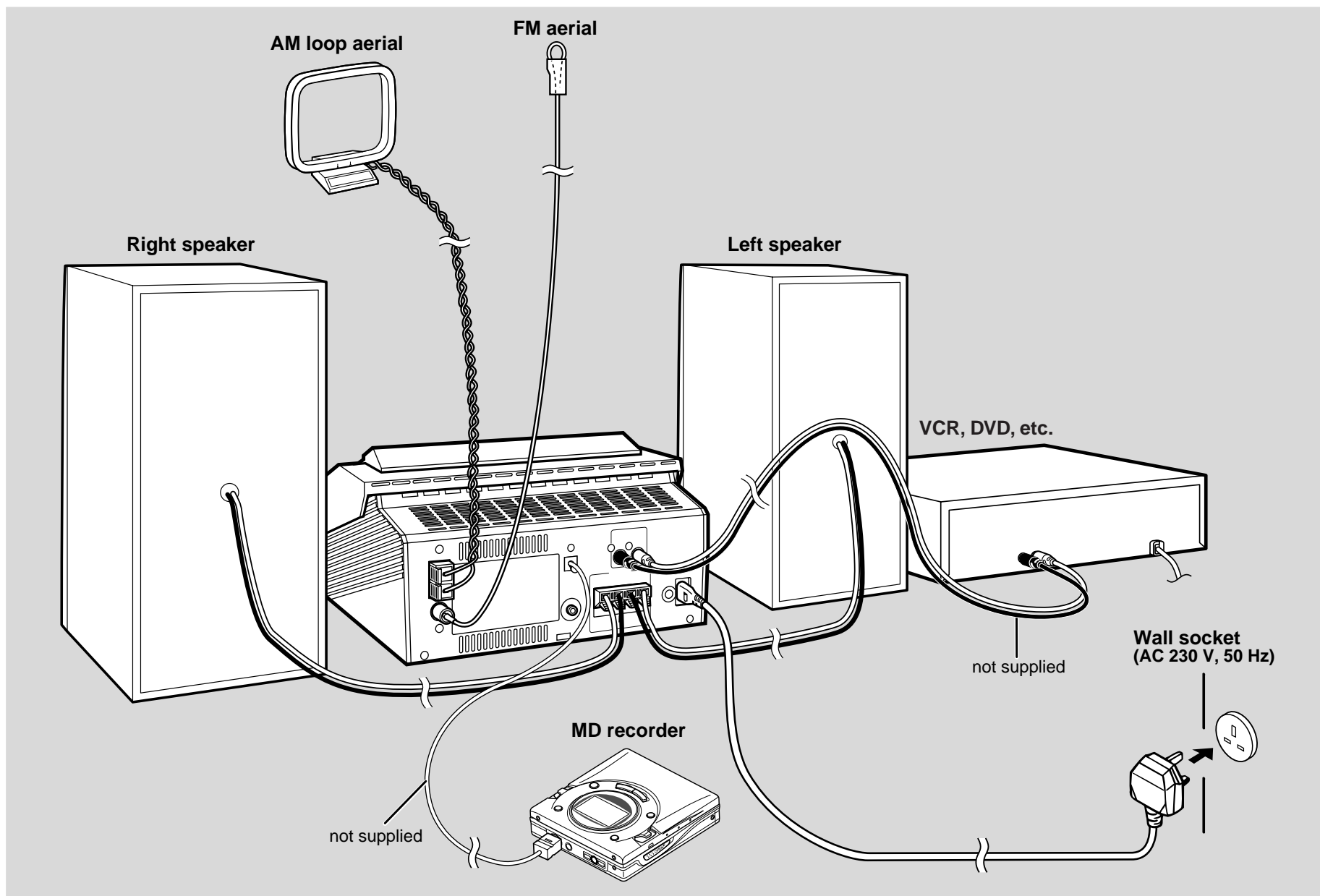

■ Aerial connection

Supplied FM aerial:

Connect the FM aerial wire to the FM 75 OHMS socket and position the FM aerial wire in the direction where the strongest signal can be received.

Supplied AM loop aerial:

Connect the AM loop aerial wire to the AM and GND terminals. Position the AM loop aerial for optimum reception. Place the AM loop aerial on a shelf, etc., or attach it to a stand or a wall with screws (not supplied).

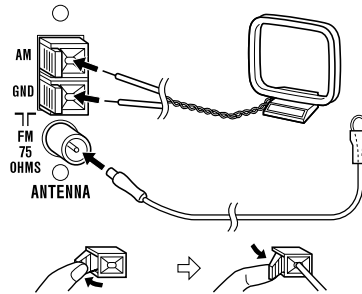

Notes:

- Placing the aerial on the unit or near the AC power lead may cause noise pickup. Place the aerial away from the unit for better reception.
- When static is still heard even after adjusting the position of the AM loop aerial, try reversing the wire connections.

Installing the AM loop aerial:

< Assembling >

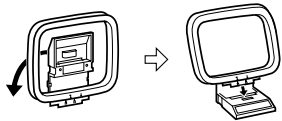

< Attaching to the wall >

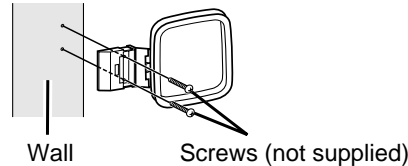

External FM or AM aerial:

Use an external FM or AM aerial if you require better reception. Consult your dealer.

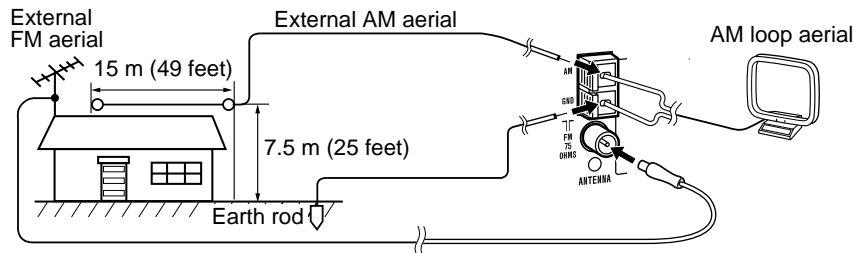

Notes:

- When an external FM aerial is used, disconnect the supplied FM aerial wire from the FM 75 OHMS socket.
- When using an external AM aerial, be sure to keep the wire of the AM loop aerial connected.

■ Speaker connection

Connect the black wire to the minus (-) terminal, and the red wire to the plus (+) terminal.

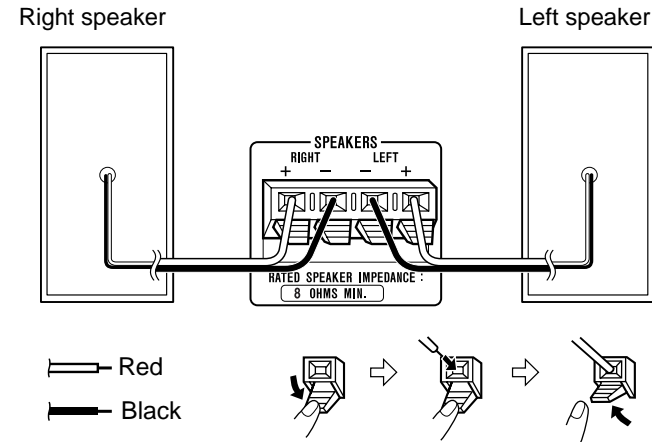

Caution:

- Use speakers with an impedance of 8 ohms or more, as lower impedance speakers can damage the unit.
- Do not mistake the right and the left channels. The right speaker is the one on the right side when you face the unit.
- **Do not let the bare speaker wires touch each other.**

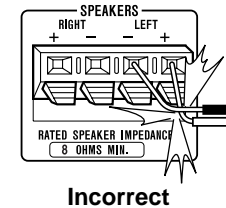

■ Connecting the AC power lead

After checking all the connections have been made correctly, connect the AC power lead to the AC power input socket, then plug the AC power lead of this unit into the wall socket.

Notes:

- Unplug the unit if it will not be used for a prolonged period of time.
- Never use a power lead other than the one supplied. Otherwise, a malfunction or an accident may occur.

Remote Control

■ Battery installation

- 1 Remove the battery cover.
- 2 Insert the batteries according to the direction indicated in the battery compartment.
When inserting or removing the batteries, push them towards the ⊖ battery terminals.
- 3 Replace the cover.

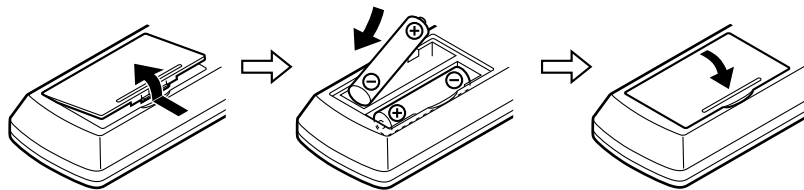

Precautions for battery use:

- Replace all old batteries with new ones at the same time.
- Do not mix old and new batteries.
- Remove the batteries if the unit will not be used for long periods of time. This will prevent potential damage due to battery leakage.

Caution:

- Do not use rechargeable batteries (nickel-cadmium battery, etc.).
- Installing the batteries incorrectly may cause the unit to malfunction.

Notes concerning use:

- Replace the batteries if the operating distance is reduced or if the operation becomes erratic. Purchase 2 "AAA" size batteries (UM-4, R03, HP-16 or similar).
- Periodically clean the transmitter on the remote control and the sensor on the unit with a soft cloth.
- Exposing the sensor on the unit to strong light may interfere with operation. Change the lighting or the direction of the unit.
- Keep the remote control away from moisture, heat, shock, and vibrations.

■ Test of the remote control

Face the remote control directly to the remote sensor on the unit.

The remote control can be used within the range shown below:

Press the ON/STANDBY button. Does the power turn on? Now, you can enjoy the music.

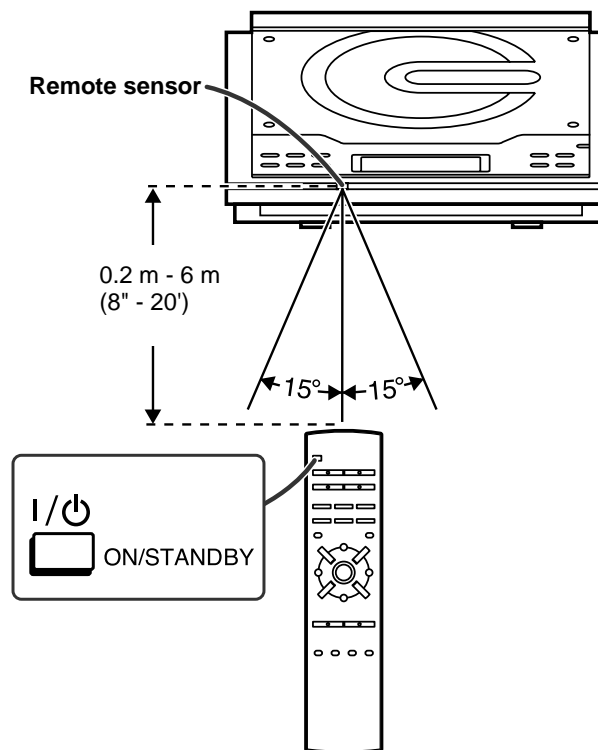

General Control

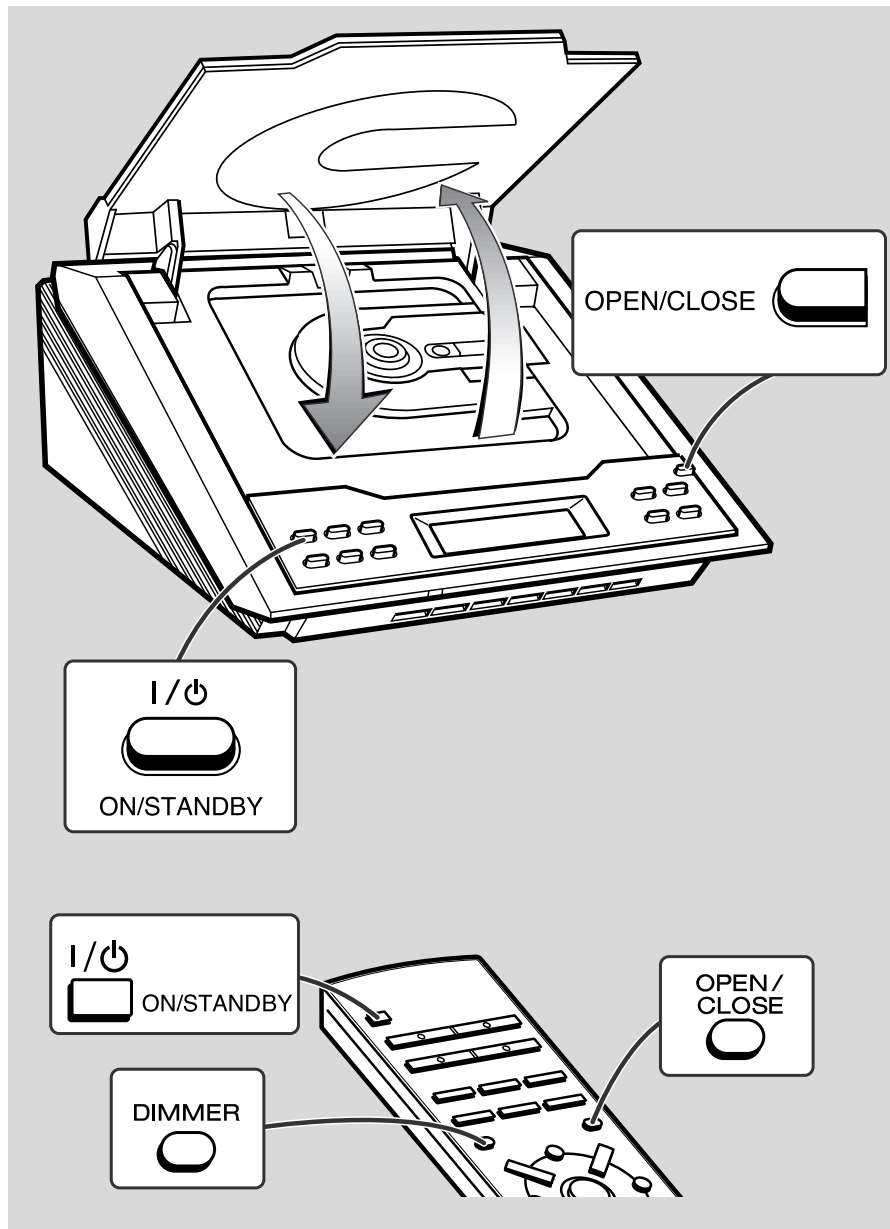

■ To turn the power on

Press the ON/STANDBY button to turn the power on.

To set the unit to stand-by mode:

Press the ON/STANDBY button again.

■ To change the display brightness (2 levels)

You can switch the display brightness by pressing the DIMMER button on the remote control.

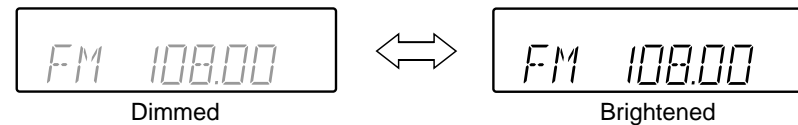

■ Opening and closing the CD compartment

The CD compartment cover is motorised.

When the power is turned on, you can open or close the CD compartment cover by pressing the OPEN/CLOSE button.

Caution:

- Do not stop or move the CD compartment cover manually. It may cause malfunctions to the unit.
- Be careful not to jam your fingers in the CD compartment cover.

Sound Control

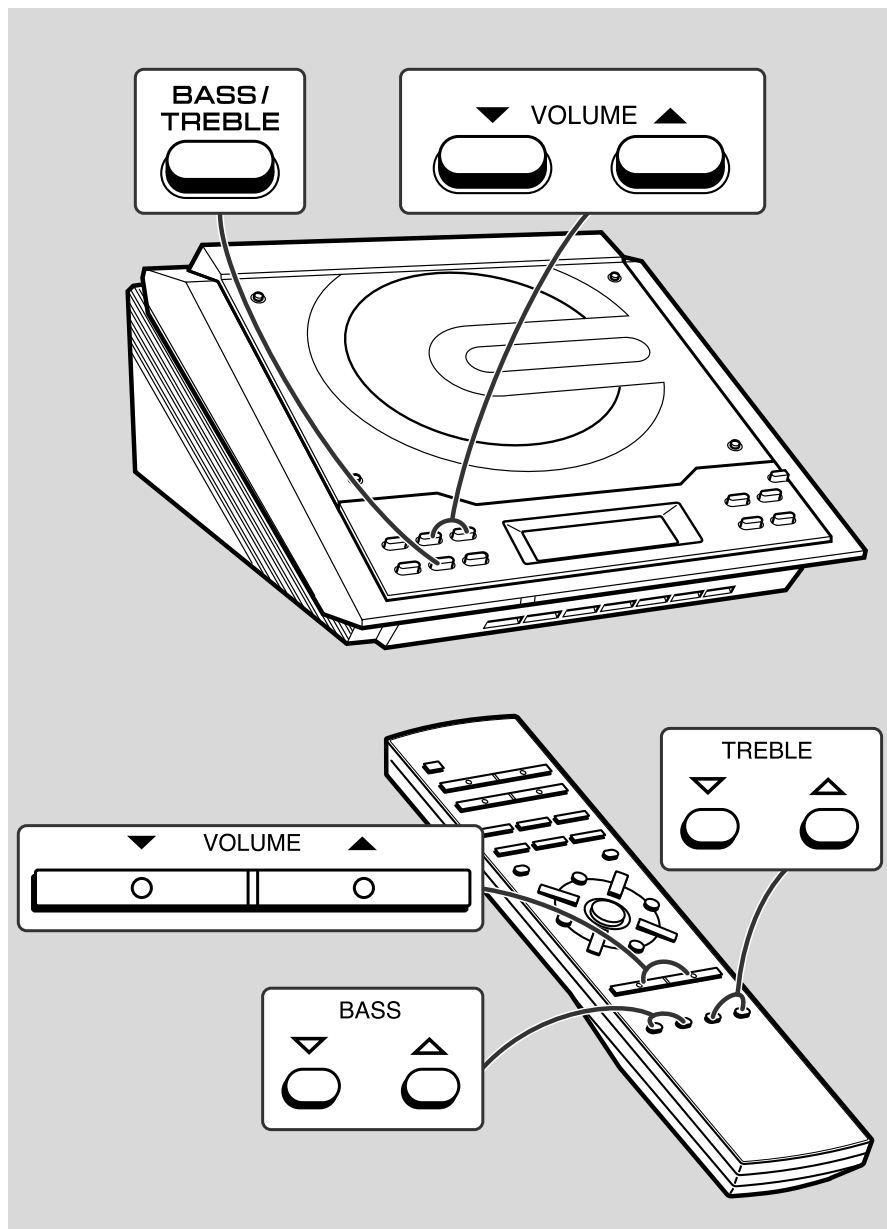

■ Adjusting the volume

Press the VOLUME ▲ button to increase the volume and the VOLUME ▼ button for decreasing.

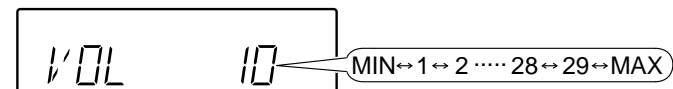

■ Adjusting the bass

Main unit operation:

- 1 Press the BASS/TREBLE button until "BASS" appears on the display.
- 2 Within 5 seconds, press the VOLUME (▼ or ▲) button to adjust the bass.

Remote control operation:

Press the BASS (▼ or ▲) button to adjust the bass.

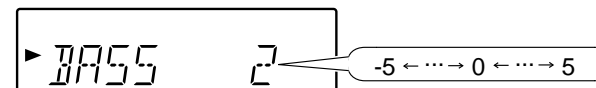

■ Adjusting the treble

Main unit operation:

- 1 Press the BASS/TREBLE button until "TRE" appears on the display.
- 2 Within 5 seconds, press the VOLUME (▼ or ▲) button to adjust the treble.

Remote control operation:

Press the TREBLE (▼ or ▲) button to adjust the treble.

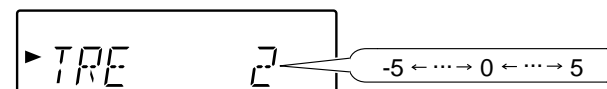

Setting the Clock

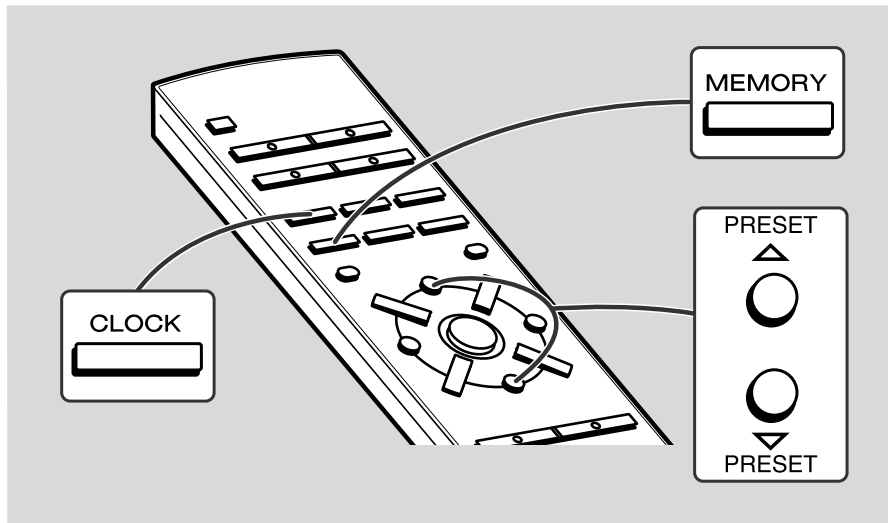

This may be operated only with the remote control.
In this example, the clock is set for the 24-hour (0:00) display.

1 Press the CLOCK button and within 3 seconds, press the MEMORY button.

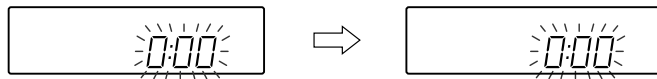

2 Within 1 minute, press the PRESET (▽ or △) button to select 24-hour or 12-hour display and then press the MEMORY button.

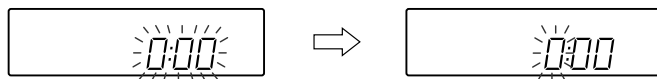

"0:00" → The 24-hour display will appear.
(0:00 - 23:59)

"AM 12:00" → The 12-hour display will appear.
(AM 12:00 - PM 11:59)

Note that this can only be set when the unit is first installed or it has been reset.
(Refer to step 3 under "If trouble occurs" on page 26.)

3 Within 1 minute, press the PRESET (▽ or △) button to adjust the hour and then press the MEMORY button.

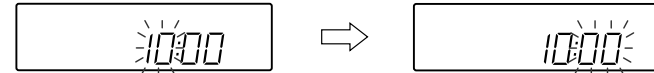

- When the 12-hour display is selected, "AM" will change automatically to "PM".

4 Within 1 minute, press the PRESET (▽ or △) button to adjust the minutes and then press the MEMORY button.

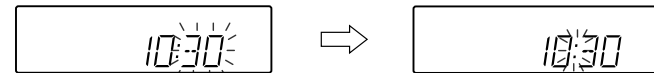

- The hour will not advance even if minutes advance from "59" to "00".
- The clock starts from "0" second. (Seconds are not displayed.)

To confirm the time display when the power is on:

Press the CLOCK button.
The time display will appear for about 5 seconds.

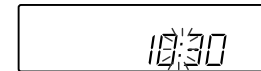

Note:

The time will flash at the push of the CLOCK button when the AC power supply is restored after a power failure or unplugging the unit.
Readjust the clock as follows.

To readjust the clock:

Perform "Setting the Clock" from the beginning.

To change the 24-hour or 12-hour display:

- 1 Clear all the programmed contents. [Perform to step 3 under "If trouble occurs" on page 26 for details.]
- 2 Perform "Setting the Clock" from the beginning.

Listening to a CD

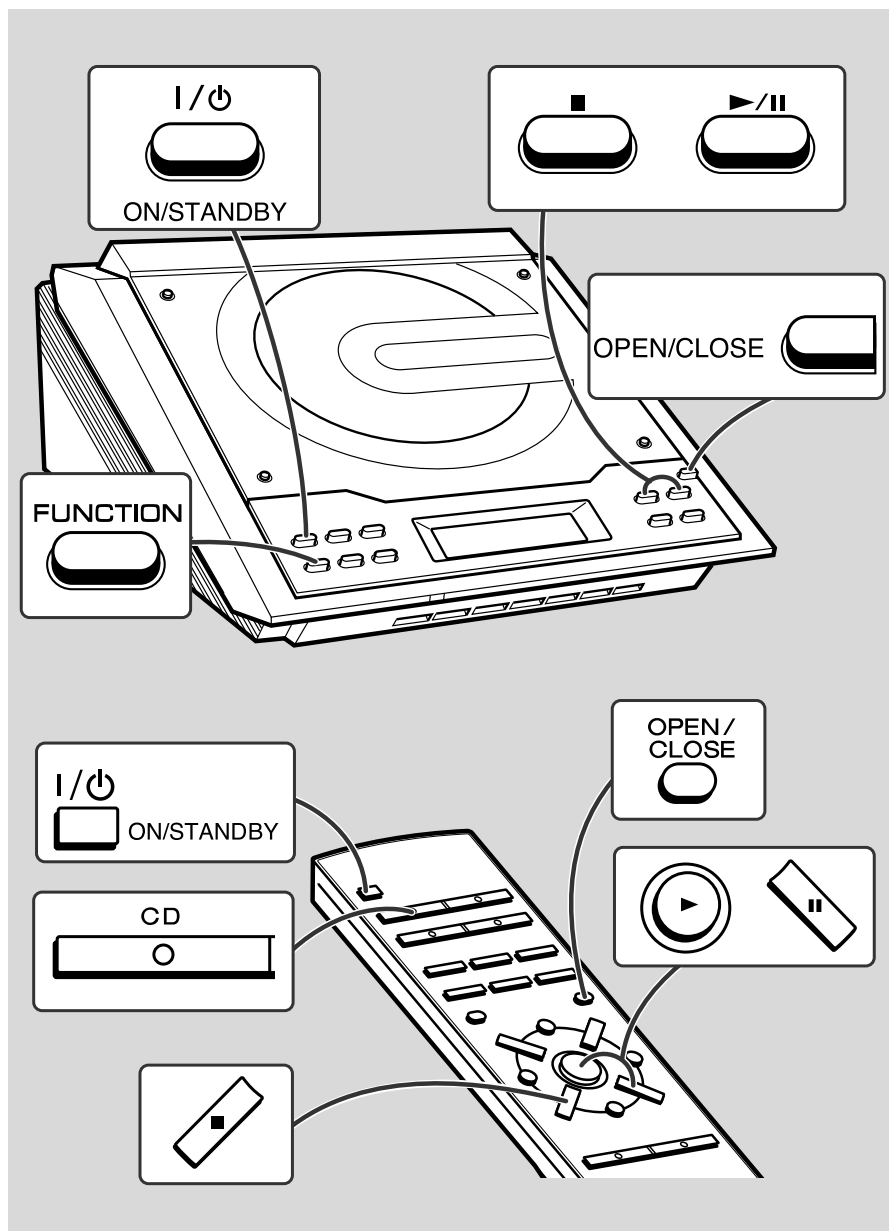

- 1** Press the ON/STANDBY button to turn the power on.
- 2** Press the FUNCTION button until "CD STOP" or "NO DISC" appears on the display.
When operating with the remote control, press the CD button.
- 3** Press the OPEN/CLOSE button to open the CD compartment.
- 4** Place a CD on the spindle, label side up.
Be sure to place 8 cm (3") disc in the middle of a disc holder.

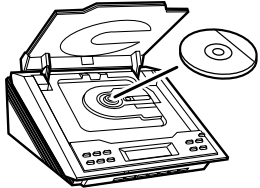

12 cm (5")

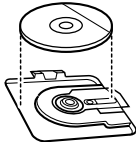

8 cm (3")

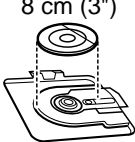
- 5** Press the OPEN/CLOSE button to close the CD compartment.

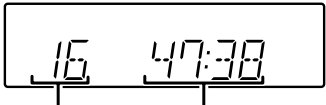

Total number of tracks Total playing time
- 6** Press the ► / || (►) button to start playback from track 1.

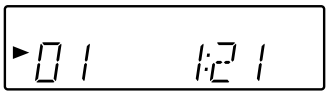

When the last track on the disc has finished playing, the CD player will stop automatically.

To interrupt playback:

Main unit operation:

Press the ► / || button.

To resume playback from the same point, press the ► / || button again.

Remote control operation:

Press the || button.

To resume playback from the same point, press the ► button.

To stop playback:

Press the ■ button.

To remove the CD:

Whilst in the stop mode, press the OPEN/CLOSE button. Press the CD eject button and remove the CD.

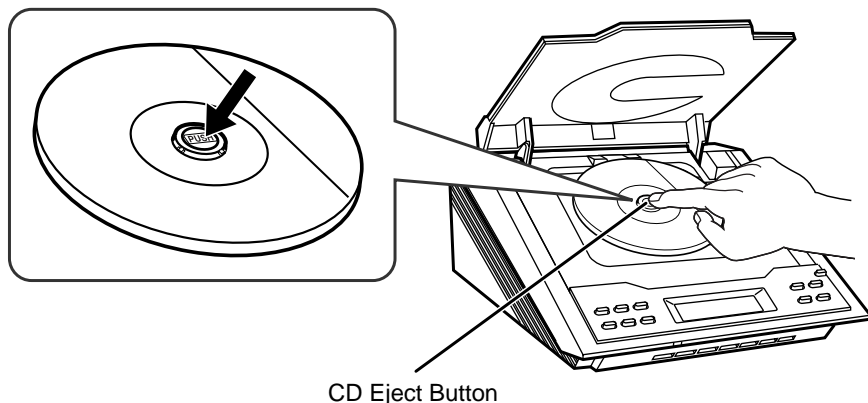

Notes:

- After removing the CD, make sure to press the OPEN/CLOSE button and close the CD compartment.
- When the unit enters the stand-by mode, the opened CD compartment cover will be closed automatically.

After use:

Press the ON/STANDBY button to enter the power stand-by mode.

Caution:

- **Do not stop or move the CD compartment cover manually. It may cause malfunctions to the unit.**
- **Be careful not to jam your fingers in the CD compartment cover.**
- If the power fails whilst the compartment is open, wait until the power is restored.
- If a disc is damaged, dirty, or loaded upside down, "NO DISC" or "READ ERR" will appear on the display.
- Keep foreign objects out of the CD compartment.
- Subjecting the unit to shock or vibration may cause mistracking.
- When the unit is not being used, be sure to close the CD compartment. If it is left open, the lens may be covered with dust and the unit may not operate properly.
- If TV or radio interference occurs during CD operation, move the unit away from the TV or radio.

■ To locate the beginning of a track

To move to the beginning of the next track:

Press the ►► button for less than 0.5 seconds during playback.



- You can skip to any track by pressing the ►► button repeatedly until the desired track number appears.

To restart the track being played:

Press the ◀◀ button for less than 0.5 seconds during playback.



- You can skip to any track by pressing the ◀◀ button repeatedly until the desired track number appears.

■ To locate the desired portion

For audible fast forward:

Press and hold down the ►► button during playback.



For audible fast reverse:

Press and hold down the ◀◀ button during playback.



Notes:

- Normal playback will resume when the ◀◀ or ►► button is released.
- When the end of the last track is reached during fast forward, "END" will appear on the display and CD operation will be paused. When the beginning of the first track is reached during fast reverse, playback will start when you release the ◀◀ button.
- The ◀◀ or ►► button on the remote control allows you to locate the desired portion.

Repeat or Random Play

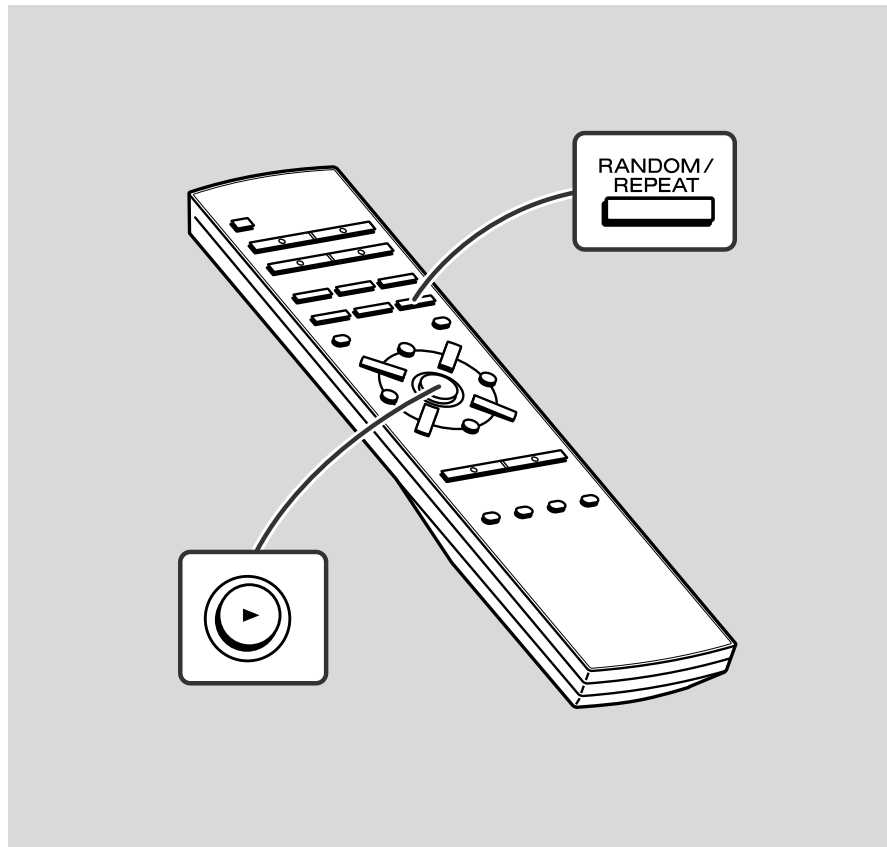

You can select one of the CD playback mode; "Repeat play", "Random play" and "Normal play".

1 When in the CD mode, press the RANDOM/REPEAT button on the remote control repeatedly to select the playback mode.

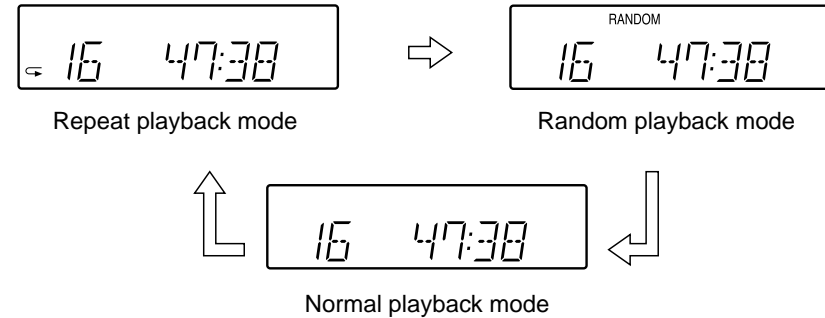

2 Press the ► button to start playback.

To repeat a programmed sequence:

Perform steps 1 - 5 in the "Programmed Play" section and then select the repeat playback.

Notes:

- In random play, the CD player will select and play tracks automatically. (You cannot select the order of the tracks.)
- If you press the ►► button during random play, you can move to the track selected next by the random operation. On the other hand, the ◀◀ button does not allow you to move to the previous track. The beginning of the track being played will be located.

Caution:

After performing repeat or random play, be sure to press the ■ button. Otherwise, the disc will play continuously.

To cancel repeat or random play:

Press the RANDOM/REPEAT button on the remote control repeatedly to select the normal playback mode.

Programmed Play

By specifying tracks from 1 to 99, you can choose up to 20 selections for playback in the order you like.

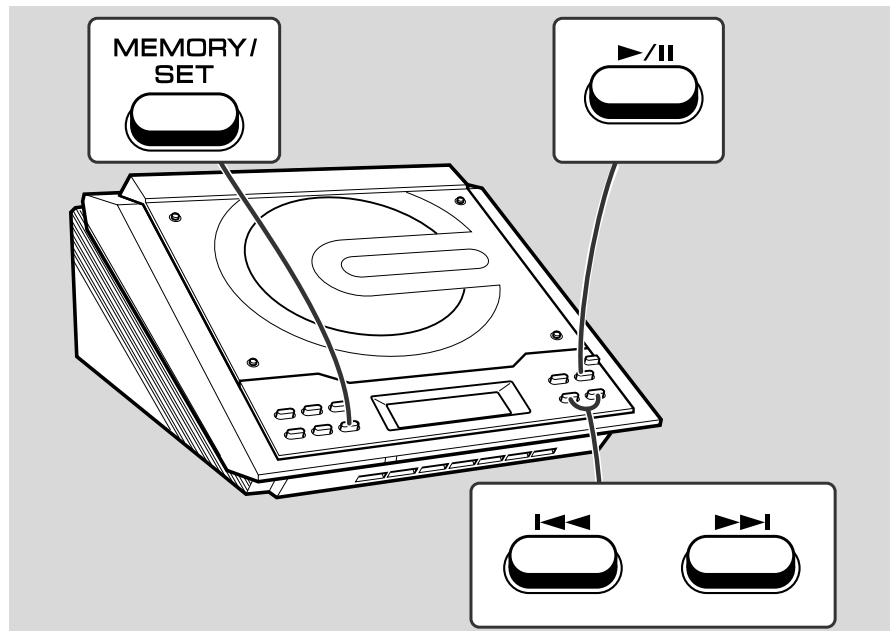

1 Whilst in the stop mode, press the MEMORY/SET (MEMORY) button to enter the programming save mode.

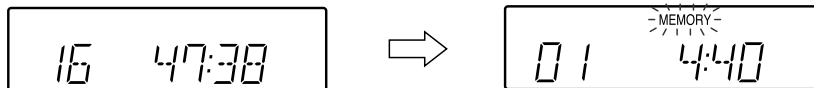

2 Within 30 seconds, press the <<< or >>> button to select the desired track.

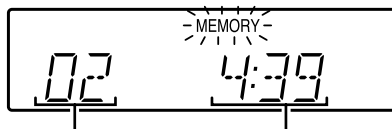

Selected track number

Playback time

3 Press the MEMORY/SET (MEMORY) button to save the track number.

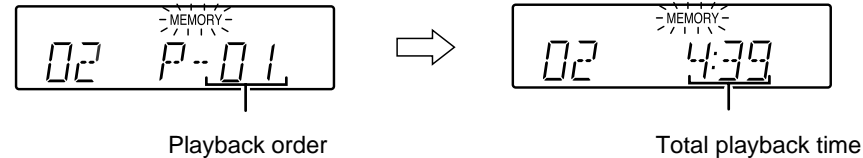

Playback order

Total playback time

4 Repeat steps 2 - 3 for other tracks. Up to 20 tracks can be programmed.

5 Press the > / || (>) button to start playback.

To clear the programmed selections:

Press the CLEAR button on the remote control whilst the "MEMORY" indicator is flashing. Each time the button is pressed, one track will be cleared, beginning with the last track programmed.

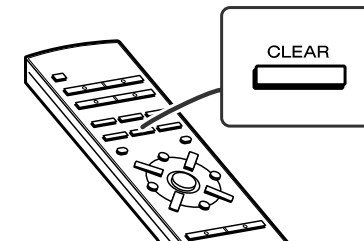

To cancel the programmed play mode:

Whilst in the stop mode and the "MEMORY" indicator is lit, press the CLEAR button on the remote control. The "MEMORY" indicator will disappear and all the programmed contents will be cleared.

Adding tracks to the programme:

If a programme has been previously stored, the "MEMORY" indicator will be displayed. Then follow steps 1 - 3 to add tracks. The new tracks will be stored after the last track of the original programme.

Notes:

- Opening the CD compartment automatically cancels the programmed sequence.
- Even if you press the ON/STANDBY button to enter the stand-by mode or the function is changed from CD to some other function, the programmed selections will not be cleared.
- During programme operation, random play is not possible.

Listening to the Radio

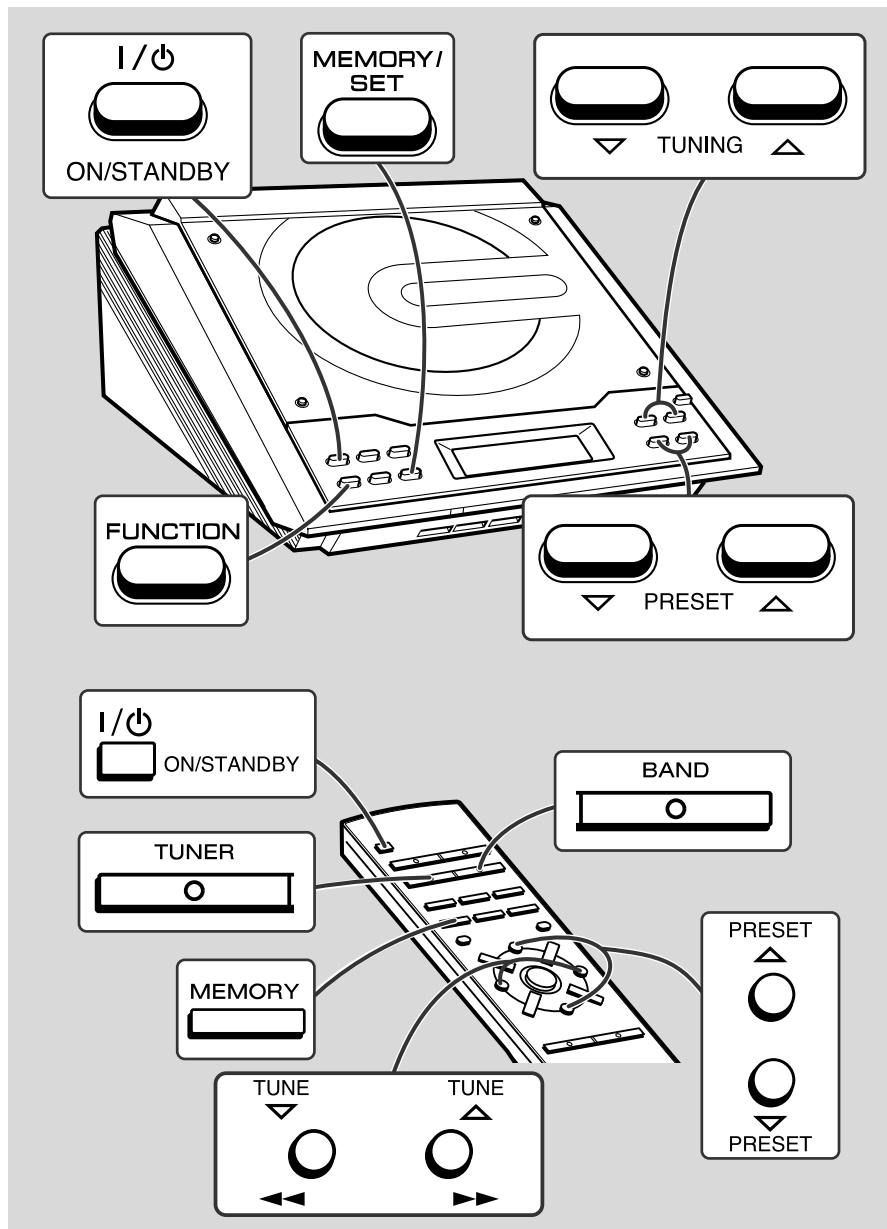

1 Press the **ON/STANDBY** button to turn the power on.

2 Press the **FUNCTION** button until "FM" or "AM" appears on the display.

When operating with the remote control, press the TUNER button, and then the BAND button to select "FM" or "AM".

3 Press the **TUNING** (∇ or Δ) button to tune in to the desired station.

Manual tuning:

Press the TUNING button as many times as required to tune in to the desired station.

Auto tuning:

When the TUNING button is pressed for more than 0.5 seconds, scanning will start automatically and the tuner will stop at the first receivable broadcast station.

Notes:

- This can be operated by pressing the TUNE (∇ or Δ) button on the remote control.
- When radio interference occurs, auto scan tuning may stop automatically at that point.
- Auto scan tuning will skip weak signal stations.
- To stop the auto tuning, press the TUNING button again.

To receive an FM stereo transmission:

Press the **FUNCTION** (BAND) button to display the "ST" indicator.

- "∞" will appear when an FM broadcast is in stereo.

FM stereo mode indicator

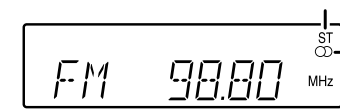

FM stereo receiving indicator

- If the FM reception is weak, press the **FUNCTION** (BAND) button to extinguish the "ST" indicator. The reception changes to monaural, and the sound becomes clearer.

After use:

Press the **ON/STANDBY** button to enter the power stand-by mode.

Listening to the memorised station

■ Memorising a station

You can store 30 AM and FM stations in memory and recall them at the push of a button. (Preset tuning)

1 Perform the steps 1 - 3 in "Listening to the Radio" on page 20.

2 Press the MEMORY/SET (MEMORY) button to enter the preset tuning saving mode.

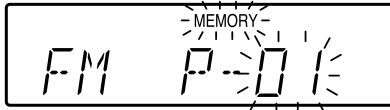

3 Within 5 seconds, press the PRESET (▽ or △) button to select the preset channel number.

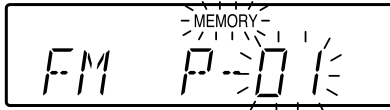

Store the stations in memory, in order, starting with preset channel 1.

4 Within 5 seconds, press the MEMORY/SET (MEMORY) button to store that station in memory.

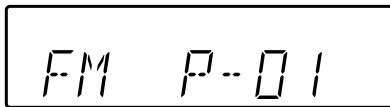

If the "MEMORY" and preset number indicators go out before the station is memorised, repeat the operation from step 2.

5 Repeat steps 1 - 4 to set other stations, or to change a preset station.

When a new station is stored in memory, the station previously memorised will be erased.

Note:

The backup function protects the memorised stations for a few hours should there be a power failure or the AC power lead disconnection.

■ To recall a memorised station

Press the PRESET (▽ or △) button for less than 0.5 seconds to select the desired station.

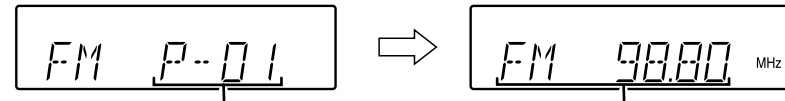

Preset channel

Frequency and frequency band

■ To scan the preset stations

The stations saved in memory can be scanned automatically. (Preset memory scan)

1 Press the PRESET (▽ or △) button for more than 0.5 seconds.

The preset number will flash and the programmed stations will be tuned in sequentially, for 5 seconds each.

2 Press the PRESET (▽ or △) button again when the desired station is located.

■ To clear a memorised station

- 1 Recall the memorised station.
- 2 Whilst it is displayed, press the MEMORY/SET (MEMORY) button.
- 3 Within 5 seconds, press the CLEAR button on the remote control.

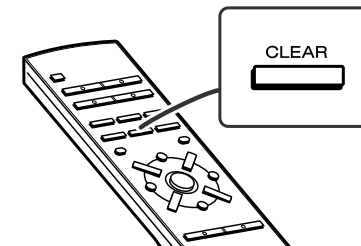

Timer and Sleep Operation

This may be operated only with the remote control.

Timer playback:

The unit turns on and plays the desired source (CD, tuner) at the preset time.

Sleep operation:

The radio and compact disc can all be turned off automatically.

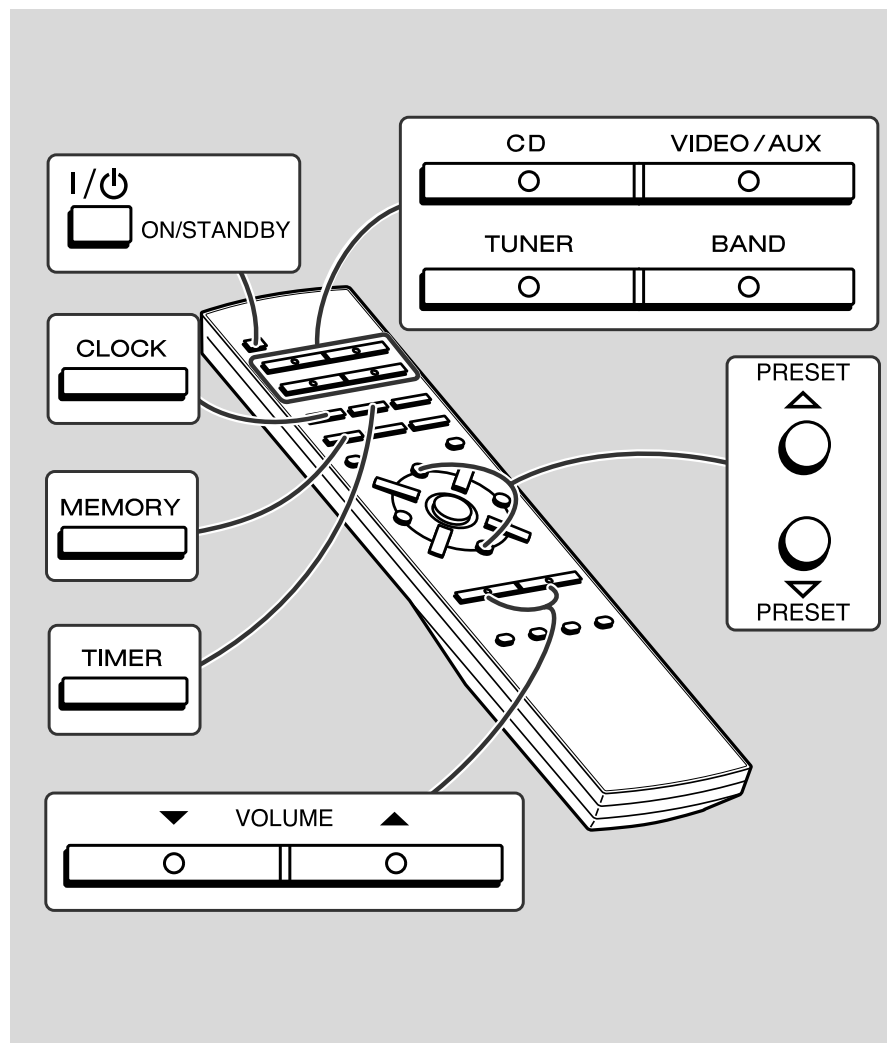

■ Timer playback

Before setting timer:

- 1 Press the CLOCK button to check that the clock is on time.



- 2 Load a disc to be played.



- 1 Press the ON/STANDBY button to turn the power on.

- 2 Press the CD or TUNER button to select the desired function.
When you selected the TUNER, tune in to the desired station.

- 3 Adjust the volume using the VOLUME buttons.
Do not turn the volume up too high.

- 4 Press the TIMER button and within 6 seconds, press the MEMORY button.

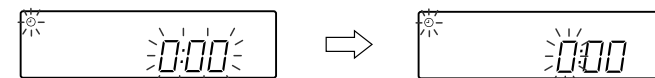

- 5 Within 1 minute, press the PRESET (▽ or △) button to specify the hour to start, then press the MEMORY button.

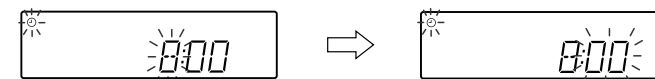

6 Within 1 minute, press the PRESET (▽ or △) button to specify the minutes to start, then press the MEMORY button.

- The timer playback starting time, function, and volume will be displayed, and then the unit will enter the stand-by mode automatically.
- "Ⓞ" will appear and the current time will be displayed.

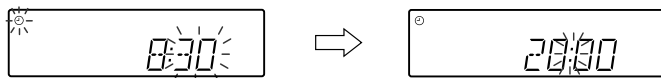

To cancel the timer playback:

Press the ON/STANDBY button to turn the power on.

7 When the preset time is reached, playback will start.

The volume will increase gradually until it reaches the volume you were listening at before your system enters the timer stand-by mode.

8 If you select CD, the unit will enter the stand-by mode after the playback. If you select TUNER, it will enter the stand-by mode one hour after the timer playback starts.

To reset or change the timer setting:

Perform "Timer playback" from the beginning.

Notes:

- Once the time is set, the setting will be retained until a new time is entered.
- When performing timer playback using another unit connected to the VIDEO/AUX IN sockets, select "VIDEO/AUX" in step 2. At this time, only this unit will be turned on or enter the power stand-by mode automatically. It will enter the power stand-by mode 1 hour after the timer playback starts. (Another unit will not be turned on or off.)

■ Sleep operation

1 Play back the desired sound source.

2 Press the SLEEP button.

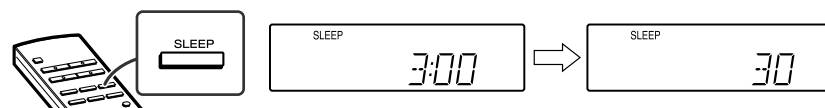

To change the sleep time:

Press the SLEEP button repeatedly to select the desired sleep time. The time will decrease as follows.

The amount of sleep time can also be changed whilst in the sleep mode.

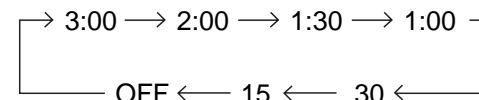

3 Your system will enter the power stand-by mode automatically after the preset time has elapsed.

The volume will be turned down 1 minute before the sleep operation finishes.

To cancel the sleep operation:

Press the ON/STANDBY button whilst the sleep timer is set.

To confirm the remaining sleep time:

Press the SLEEP button once whilst the sleep timer is set. The remaining sleep time is displayed for about 3 seconds.

■ To use timer and sleep operation together

Example: To fall asleep and wake to the same radio station
You can play back the same source only (the function cannot be switched).

1 Set the sleep time (see above, steps 1 - 2).

2 Whilst the sleep timer is set, set the desired playback time (steps 4 - 6, pages 22 - 23).

Enhancing Your System

The connection lead is not included. Purchase a commercially available lead as shown below.

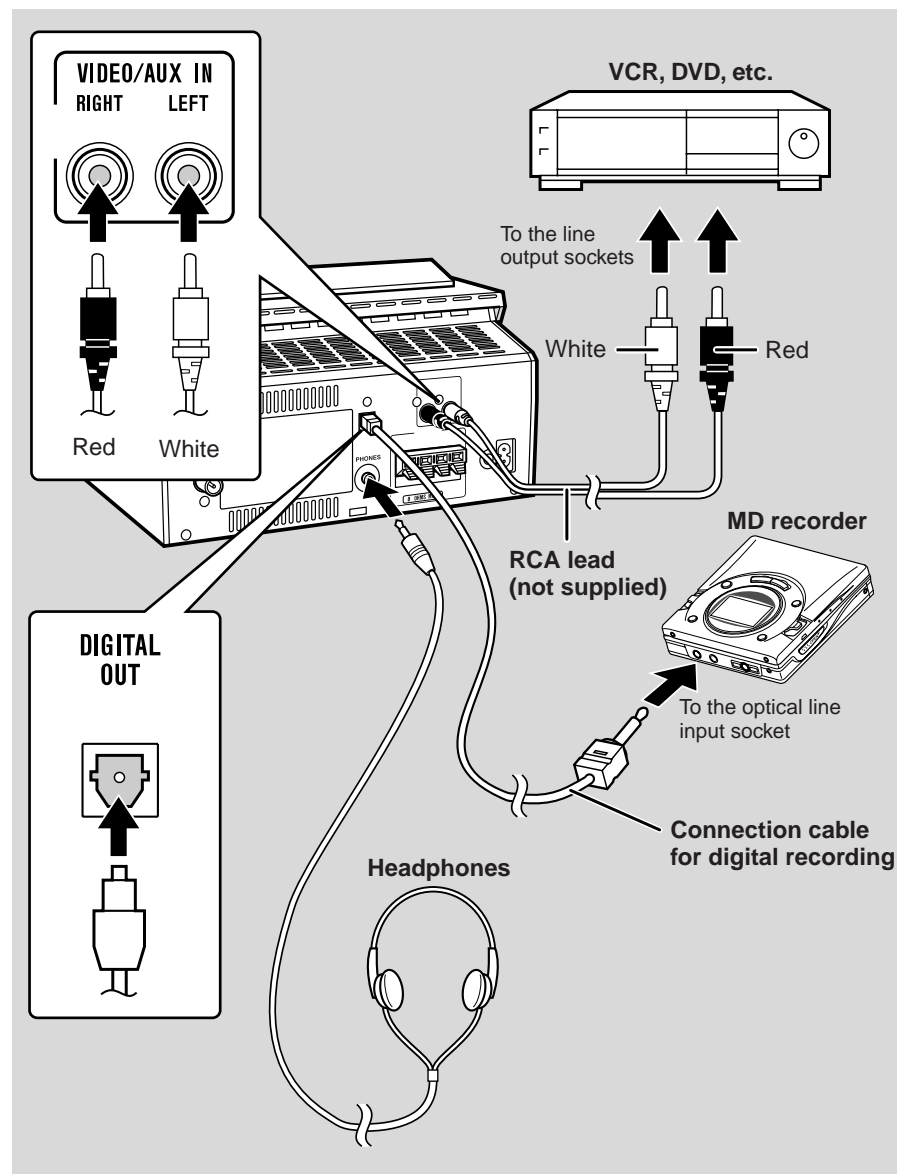

■ Listening to the playback sounds from VCR, DVD, etc.

- 1 Use a connection lead to connect the VCR, DVD, etc. to the VIDEO/AUX IN sockets.**

When using video equipment, connect the audio output to this unit and the video output to a television.

- 2 Press the ON/STANDBY button to turn the power on.**

- 3 Press the FUNCTION button until "AUX" appears on the display.**

When operating with the remote control, press the VIDEO/AUX button.

- 4 Play the VCR, DVD, etc.**

Note:

To prevent hum interference, place this unit away from a television.

■ To record CD signals on MDs

The digital signal from this unit can be recorded by MiniDisc recorders, etc.

- 1 Remove the DIGITAL OUT socket cover.**

- 2 Use a connection cable for digital recording to connect the unit to the OPTICAL IN socket of a MiniDisc recorder, etc.**

- 3 Press the ON/STANDBY button to turn the power on.**

- 4 Put the MiniDisc recorder, etc. in the recording mode.**

- 5 Play a CD on this unit.**

Note:

Only CD signals can be output.

■ Headphones

- Before plugging in or unplugging the headphones, reduce the volume.
- Be sure your headphones have a 3.5 mm (1/8") diameter plug and are between 16 ohms and 50 ohms impedance. The recommended impedance is 32 ohms.
- Plugging in the headphones disconnects the speakers automatically. Adjust the volume using the VOLUME buttons.

Troubleshooting Chart

Many potential "problems" can be resolved by the owner without calling a service technician.

If something is wrong with this product, check the following before calling your authorised KENWOOD dealer or service centre.

■ General

Symptom	Possible cause
<ul style="list-style-type: none"> The clock is not on time. 	<ul style="list-style-type: none"> Did a power failure occur? Reset the clock. (Refer to page 15.)
<ul style="list-style-type: none"> When a button is pressed, the unit does not respond. 	<ul style="list-style-type: none"> Set this unit to the power stand-by mode and then turn it back on. If the unit still malfunctions, reset it. (Refer to step 3 under "If trouble occurs" on page 26.)
<ul style="list-style-type: none"> No sound is heard. 	<ul style="list-style-type: none"> Is the volume level set to "0"? Are the headphones connected? Are the speaker wires disconnected?

■ CD player

Symptom	Possible cause
<ul style="list-style-type: none"> Playback does not start. 	<ul style="list-style-type: none"> Is the disc loaded upside-down?
<ul style="list-style-type: none"> Playback stops in the middle or is not performed properly. 	<ul style="list-style-type: none"> Does the disc satisfy the standards? Is the disc distorted or scratched?
<ul style="list-style-type: none"> Playback sounds are skipped, or stopped in the middle of a track. 	<ul style="list-style-type: none"> Is the unit located near excessive vibrations? Is the disc very dirty? Has condensation formed inside the unit?

■ Tuner

Symptom	Possible cause
<ul style="list-style-type: none"> Radio makes unusual noise consecutively. 	<ul style="list-style-type: none"> Is the unit placed near the TV or computer? Is the FM/AM loop aerial placed properly? Move the AC power lead away from the aerial if located near.

■ Remote control

Symptom	Possible cause
<ul style="list-style-type: none"> The remote control does not operate. 	<ul style="list-style-type: none"> Is the AC power lead of the unit plugged in? Is the battery polarity respected? Are the batteries dead? Is the distance or angle incorrect? Does the remote control sensor receive strong light?

■ Condensation

Sudden temperature changes, storage or operation in an extremely humid environment may cause condensation inside the cabinet (CD pickup, etc.) or on the transmitter on the remote control.

Condensation can cause the unit to malfunction. If this happens, leave the power on with no disc in the unit until normal playback is possible (about 1 hour). Wipe off any condensation on the transmitter with a soft cloth before operating the unit.

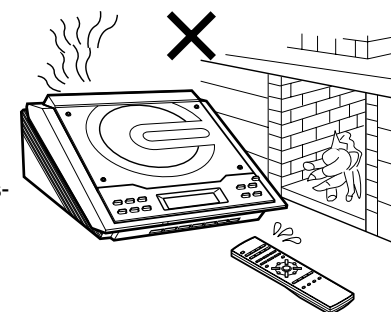

Troubleshooting Chart (continued)

■ If trouble occurs

When this product is subjected to strong external interference (mechanical shock, excessive static electricity, abnormal supply voltage due to lightning, etc.) or if it is operated incorrectly, it may malfunction.

If such a problem occurs, do the following:

- 1 Set the unit to the stand-by mode and turn the power on again.
- 2 If the unit is not restored in step 1, unplug and plug in the unit, and then turn the power on.
- 3 If neither step 1 nor 2 restores the unit, do the following:
 - ① Press the ON/STANDBY button to enter the power stand-by mode.
 - ② Unplug the AC power lead from the AC INPUT socket on the unit.
 - ③ Whilst pressing down the MEMORY/SET button and the ► / || button, plug the AC power lead into the AC INPUT socket on the unit.

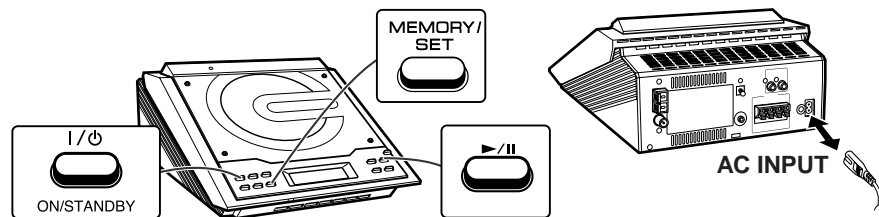

Caution:

This operation will erase all data stored in memory including clock, timer settings, tuner preset, and CD programme.

Maintenance

■ Cleaning the CD pickup lens

Do not touch the laser pickup lens. If fingerprints or dust accumulate on the pickup, clean it gently with a dry cotton swab.

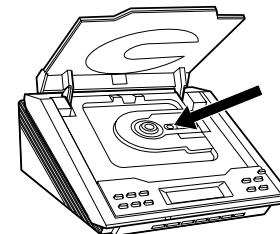

■ Cleaning the cabinet

Periodically wipe the cabinet with a soft cloth and a diluted soap solution, then with a dry cloth.

Caution:

- Do not use chemicals for cleaning (petrol, paint thinner, etc.). It may damage the cabinet finish.
- Do not apply oil to the inside of the unit. It may cause malfunctions.

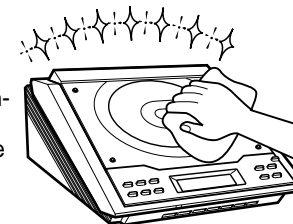

Specifications

As part of our policy of continuous improvement, KENWOOD reserves the right to make design and specification changes for product improvement without prior notice. The performance specification figures indicated are nominal values of production units. There may be some deviations from these values in individual units.

■ General

Power source	AC 230 V, 50 Hz
Power consumption	Power on: 30 W Power stand-by: 0.6 W
Dimensions	Width: 230 mm (9-1/16") Height: 128 mm (5-1/16") Depth: 293 mm (11-9/16")
Weight	2.7 kg (5.9 lbs.)

■ Amplifier

Output power	RMS: 20 W (10 W + 10 W) (10 % T.H.D.)
Output terminals	Speakers: 8 ohms Headphones: 16 - 50 ohms (recommended: 32 ohms) CD digital output (optical)
Input terminals	Video/Auxiliary (audio signal): 500 mV/47 kohms

■ CD player

Type	Compact disc player
Signal readout	Non-contact, 3-beam semiconductor laser pickup
D/A converter	1-bit D/A converter
Frequency response	20 - 20,000 Hz
Dynamic range	90 dB (1 kHz)

■ Tuner

Frequency range	FM: 87.5 - 108 MHz AM: 522 - 1,620 kHz
------------------------	---

■ Speaker

Type	2-way type speaker system 5 cm (2") Tweeter 10 cm (4") Woofer
Maximum input power	10 W
Rated input power	5 W
Impedance	8 ohms
Dimensions	Width: 124 mm (4-7/8") Height: 250 mm (9-13/16") Depth: 238 mm (9-3/8")
Weight	1.7 kg (3.7 lbs./each)

KENWOOD

For your records

Record the serial number, found on the bottom of the unit, in the spaces designated on the warranty card, and in the space provided below. Refer to the model and serial numbers whenever you call upon your dealer for information or service on this product.

Model _____ Serial Number _____