

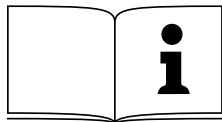









Power 260



	Betriebsanleitung	3
	Operating Instruction	7
	Instructions d'utilisation	11
	Handleiding	16
	Manuale d'istruzioni	21
	Manual de uso	26
	Betjeningsvejledning	31
	Bruksanvisning	35
	Käyttökäsikirja	39

D DEUTSCH**KONFORMITÄTSERKLÄRUNG**

Wir erklären in alleiniger Verantwortlichkeit, dass dieses Produkt mit den folgenden Normen übereinstimmt* gemäß den Bestimmungen der Richtlinien**

F FRANÇAIS**DECLARATION DE CONFORMITE**

Nous déclarons, sous notre seule responsabilité, que ce produit est en conformité avec les normes ou documents normatifs suivants* en vertu des dispositions des directives **

IT ITALIANO**DICHIARAZIONE DI CONFORMITÀ**

Noi dichiariamo sotto la nostra esclusiva responsabilità che il presente prodotto è conforme alle seguenti norme* in conformità con le disposizioni delle normative **

PT PORTUGUÊS**DECLARAÇÃO DE CONFORMIDADE**

Declaramos sob nossa responsabilidade que este produto está de acordo com as seguintes normas* de acordo com as directrizes dos regulamentos **

FIN SUOMI**VAATIMUKSEN MUKAISUUSVAKUUTUS**

Vakuutamme, että tämä tuote vastaa seuraavia normeja* on direktiivien määräysten mukainen**

DA DANSK**OVERENSSTEMMELSESATTEST**

Hermed erklærer vi på eget ansvar, at dette produkt stemmer overens med følgende standarder* iht bestemmelserne i direktiverne**

EL ΕΛΛΗΝΙΚΑ**ΔΗΛΩΣΗ ΑΝΤΙΣΤΟΙΧΕΙΑΣ**

Δηλώνουμε με ιδία ευθύνη ότι το προϊόν αυτό αντιστοιχεί στις ακόλουθες προδιαγραφές* σύμφωνα με τις διατάξεις των οδηγιών**

ENG ENGLISH**DECLARATION OF CONFORMITY**

We herewith declare in our sole responsibility that this product complies with the following standards* in accordance with the regulations of the undermentioned

NL NEDERLANDS**CONFORMITEITSVERKLARING**

Wij verklaren als enige verantwoordelijke, dat dit product in overeenstemming is met de volgende normen* conform de bepalingen van de richtlijnen**

ES ESPAÑOL**DECLARACION DE CONFORMIDAD**

Declaramos bajo nuestra exclusiva responsabilidad, que el presente producto cumple con las siguientes normas* de acuerdo a lo dispuesto en las directrices** Homologación de

SV SVENSKA**FÖRSÄKRAN OM ÖVERENSSTÄMMELSE**

Vi försäkrar på eget ansvar att denna produkt överensstämmer med följande standarder* enligt bestämmelserna i direktiven**

NO NORGE**SAMSVARSERKLÆRING**

Vi erklærer under eget ansvar at dette produkt samsvarer med følgende normer* henhold til bestemmelsene i direktiv**

POL POLSKI**OŚWIADCZENIE O ZGODNOŚCI**

Oświadczamy z pełną odpowiedzialnością, że niniejszy produkt odpowiada wymogom następujących norm* według ustaleń wytycznych **

HU MAGYAR**MEGEGYZŐSÉGI NYILATKOZAT**

Kizárólagos felelősségünk tudatában ezennel igazoljuk, hogy ez a termék kielégíti az alábbi szabványokban lefektetett követelményeket* megfelel az alábbi irányelvek előírásainak**

POWER 260

* EN 60204-1, EN 60335-1, EN 1012-1

** 98/37/EG - 93/68/EWG - 89/336/EWG - 73/23/EWG - 87/404/EWG - 2000/14/EG

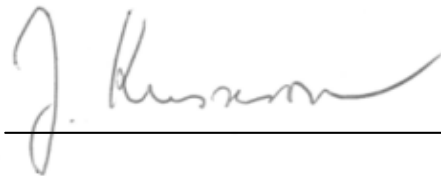

Jürgen Kusserow
Vorstand



ELEKTRA BECKUM AG – Daimlerstraße 1 – 49716 Meppen

1001038/ 01

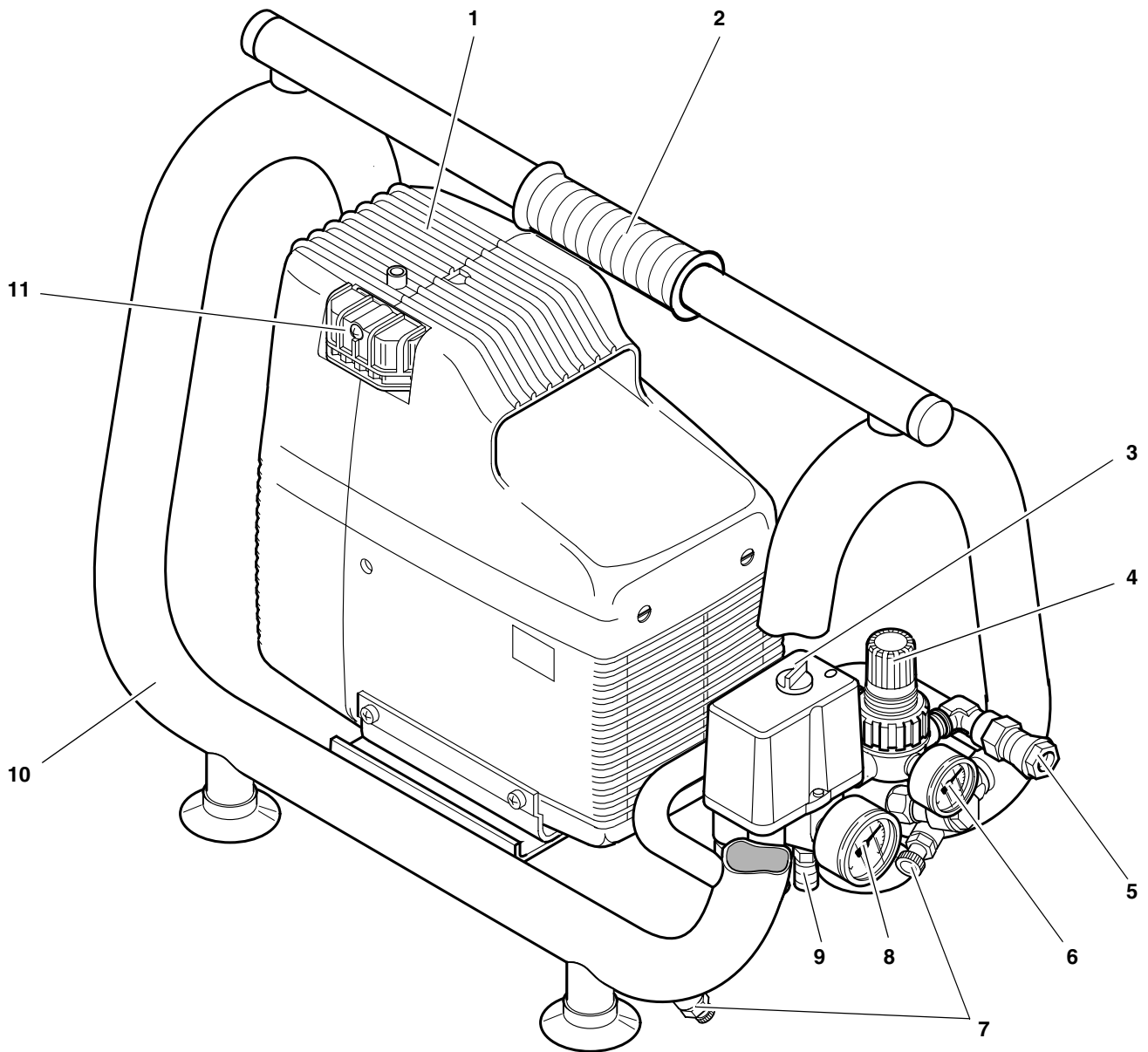
1. Device overview

- 1 Compressor pump
- 2 Carrying handle
- 3 On/Off switch
- 4 Pressure regulator
- 5 Compressed air outlet
(quick coupler)
- 6 Outlet pressure gauge
- 7 Condensate drain screws
- 8 Tank pressure gauge
- 9 Safety valve
- 10 Pressure vessel
- 11 Air intake filter housing

Table of Contents

1. **Device overview**7
 2. **Please Read First!**8
 3. **Safety**8
 3.1 Specified conditions of use8
 3.2 General safety information8
 3.3 Safety devices9
 4. **Operation**9
 4.1 Mains connection9
 4.2 Generating compressed air9
 5. **Care and Maintenance**9
 5.1 Periodic maintenance9
 5.2 Device storage9
 6. **Trouble Shooting**9
 7. **Repairs**10
 8. **Environmental Protection**10
 9. **Technical Specifications**10

2. Please Read First!

- Read these instructions before use. Pay special attention to the safety information.
- If you notice transport damage while unpacking, notify your supplier immediately. **Do not** operate the device!
- Dispose of the packing in an environmentally friendly manner. Take to a proper collecting point.
- Keep these instructions for reference on any issues you may be uncertain about.
- If you lend or sell this device be sure to have the instructions to go with it.

3. Safety

3.1 Specified conditions of use

This device is intended to generate compressed air required for the operation of air tools.

Any use for medical purposes, food processing as well as filling of oxygen cylinders for breathing equipment is not permitted.

Explosive, combustible gases or gases detrimental to health may not be compressed. Operation in hazardous locations is not permitted.

Any other use is not as specified. Use not as specified, alteration of the device or use of parts that are not approved by the equipment manufacturer, can cause unforeseeable damage!

Children, juveniles and persons not having been instructed in its usage are not permitted to operate this device and any air tools connected to it.

3.2 General safety information

When using this electric tool observe the following safety instructions, to exclude the risk of personal injury or material damage.

Please also observe the special safety instructions in the respective chapters; Keep all documents, supplied with the device, for future reference.

Observe the statutory accident insurance institution regulations and regulations for the prevention of accidents pertaining to the operation of air compressors and air tools, where applicable.

 **General hazard!**

Keep your work area tidy – a messy work area invites accidents.

Be alert. Know what you are doing. Set out to work with reason. Do not operate electric tool while under the influence of drugs, alcohol or medication. Consider environmental conditions.

Keep work area well lighted.

Prevent adverse body positions. Ensure firm footing and keep your balance at all times.

Do not operate electric tool near inflammable liquids or gases.

Keep bystanders, particularly children, out of the work area. Do not permit other persons to touch the tool or power cable while the electric tool is running.

Do not overload electric tool – use it only within the performance range it was designed for (see Technical specifications).

 **Danger! Risk of electric shock!**

Do not expose electric tool to rain.

Do not operate electric tool in damp or wet environment.

Prevent body contact with earthed objects such as radiators, pipes, cooking stoves or refrigerators when operating this electric tool.

Do not use the power cable for any purpose it is not intended for.

 **Risk of personal injury by escaping compressed air and parts hurled about by escaping air!**

Never direct compressed air against persons or animals!

Ensure all air tools and accessories used are designed for the working pressure or are supplied via a pressure regulator.

Please note that, when disconnecting the quick coupler, the compressed air contained in the pressure hose will escape all of a sudden. You should therefore firmly hold the air hose when disconnecting it.

Ensure all screwed connections are fully tightened at all times.

Do not attempt to repair the device your-

self! Only trained specialists are permitted to service or repair compressors, pressure vessels and air tools.

 **Hazard generated by oil-saturated compressed air!**

Use oil saturated compressed air only for air tools requiring such supply. Do not use an air hose used to supply compressed air containing oil to supply air tools not designed for operation on compressed air containing oil. Do not fill tires with compressed air containing oil.

 **Risk of burns from the surfaces of parts carrying compressed air!**

Let device cool off before servicing.

 **Risk of personal injury and crushing by moving parts!**

Do not operate the device without installed guards.

Please note that the device will start automatically when the pressure falls off to minimum! – Disconnect from power supply prior to any servicing.

Ensure that when switching on (e.g. after servicing) no tools or loose parts are in the electric tool.

 **Hazard generated by insufficient personal protection gear!**

Wear hearing protection.

Wear safety glasses.

Wear mask respirator when work generates dust or mist detrimental to health.

Wear suitable work clothes When working outdoors wearing of non-slip shoes is recommended.

 **Hazard generated by electric tool defects!**

Keep electric tool and accessories in good repair. Observe the maintenance instructions.

Prior to any use check the electric tool for possible damage: before using the electric tool carefully check safety devices, protection devices or slightly damaged parts for proper function as specified. Check to see that all moving parts work properly and do not jam. All parts must be correctly installed and meet all conditions necessary for the proper operation of the electric tool.

Damaged protection devices or parts must be repaired or replaced by a qualified specialist. Have damaged switches replaced by a service centre. Do not operate electric tool if the switch can not be turned ON or OFF.

Keep handles free of oil and grease.

3.3 Safety devices

Safety valve

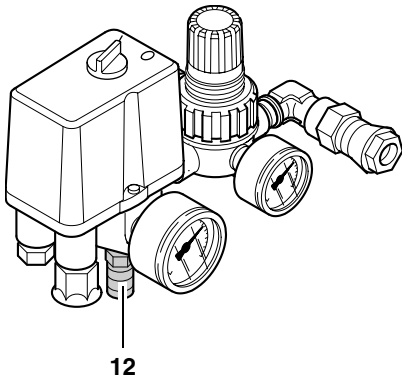

The spring safety valve (12) is incorporated into the pressure switch unit. The safety valve opens if the max. permissible pressure is exceeded.

4. Operation

4.1 Mains connection



Danger! High voltage

Operate device in dry environment only.

Operate device only on a power source complying with the following requirements:

- outlets properly installed, earthed and tested;
- fuse protection in accordance with the Technical Specifications.

Position power cable so it does not interfere with the work and is not damaged.

Always check to see that the device is switched OFF before plugging in.

Protect power cable from heat, aggressive liquids and sharp edges.

Use only extension cables with sufficient lead cross section (see "Technical Specifications").

Do not stop the compressor by unplugging, but switch OFF using the switch.

Unplug after use.

4.2 Generating compressed air

1. Start device (13) and wait until the max. tank pressure is reached (compressor shuts off). The tank pressure is indicated by the tank pressure gauge (14).

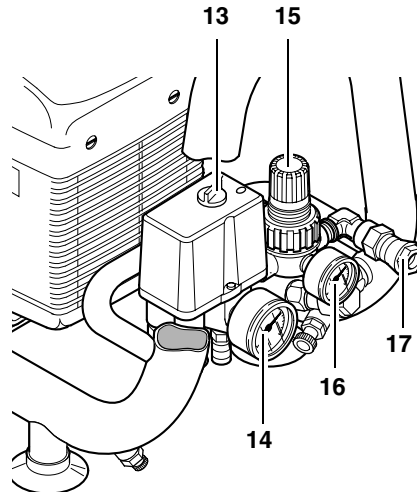

2. Set pressure regulator (15) to required working pressure. The current working pressure is indicated by the regulated pressure gauge (16).



Caution!

The regulated pressure may not be set higher than the max. working pressure of the connected air tools!

3. Connect air hose to compressed air outlet (17).
4. Connect air tool. You are now ready to work with the air tool.
5. Switch the device OFF, if you do not continue working immediately afterwards. Unplug after switching OFF.

5. Care and Maintenance



Danger!

Prior to all servicing:

- Switch Off.
- Unplug.
- Wait until the device has come to a complete stop.
- Ensure the device and all air tools and accessories connected to it are relieved from pressure.
- Let the device and all air tools and accessories used cool off.

After all servicing:

- Check to see that all safety devices are operational.
- Make sure that no tools or other parts remain on or in the device.

Repair and maintenance work other than described in this section must only be carried out by qualified specialists.

5.1 Periodic maintenance

Prior to each use

- Check air hoses for damage, replace if necessary.

- Check all screwed connections for tightness, tighten if necessary.
- Check power supply cable for damage, if necessary have replaced by a qualified electrician.

Every 50 operating hours

- Check air intake filter (18), clean if necessary.

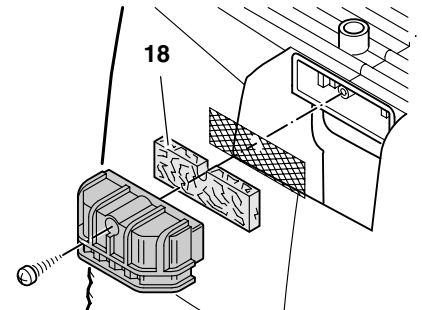

- Drain condensate (19).

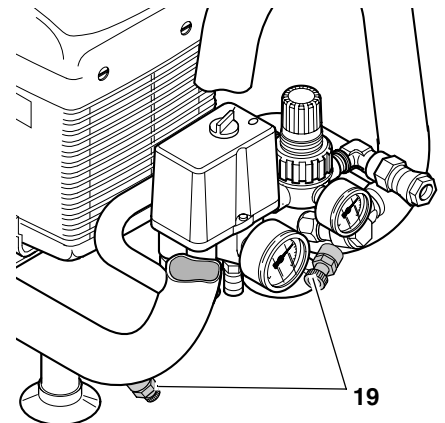

Every 250 operating hours

- Replace air filter element.

5.2 Device storage

1. Switch unit OFF and unplug.
2. Release pressure from tank and all connected air tools.
3. Store device in such way that it cannot be started by unauthorized persons.



Caution!

Do not store device unprotected outdoors or in damp environment. Do not lay device on its side for transportation or storing.

6. Trouble Shooting



Danger!

Prior to all servicing:

- Switch Off.
- Unplug.
- Wait until the device has come to a complete stop.
- Ensure the device and all air tools and accessories connected to it are relieved from pressure.
- Let the device and all air tools and accessories used cool off.

After all servicing:

- Check to see that all safety devices are operational.
- Make sure that no tools or other parts remain on or in the device.

Compressor does not run:

- No mains voltage.
 - Check cables, plug, outlet and mains fuse.
- Mains voltage too low.
 - Use only extension cables with sufficient lead cross section (see "Technical Specifications"). Avoid using extension cable with cold device.
- Compressor was stopped by unplugging.
 - Switch compressor OFF at the On/Off switch, then ON again.
- Motor has overheated, caused by insufficient cooling (cooling fins covered).

- Remove cause for overheating and allow to cool down for approx. 10 minutes, then start again.

Compressor runs but does not build up sufficient pressure.

- Condensate drain of pressure vessel leaky.
 - Check gasket of drain screw(s); replace if necessary.
 - Tighten drain screw(s) fingertight.
- Check valve leaky.
 - Have check valve serviced by qualified service centre.

Air tool is not supplied with sufficient pressure.

- Pressure regulator not opened wide enough.
 - Open pressure regulator more.
- Hose connection between compressor and air tool leaky.
 - Check air hoses, replace defective parts if necessary.

7. Repairs



Danger!

Repairs to power tools must be carried out by qualified electricians only!

Electric tools in need of repair can be sent to the service centre in your country. See spare parts list for address.

Please attach a description of the fault to the power tool.

8. Environmental Protection

The device's packaging can be 100 % recycled.

Worn out devices and accessories contain considerable amounts of valuable raw and plastic materials, which can be recycled.

These instructions are printed on chlorine-free bleached paper.

9. Technical Specifications

Suction capacity	l/min	235
Free air delivery (volume flow rate)	l/min	110
Filling rate	l/min	120
Max. working pressure	bar	8
Pressure vessel volume	l	4
Pump model		F 245
No. of cylinders		1
Motor speed	min ⁻¹	2850
Motor capacity	kW	1.5
Supply voltage (50 Hz)	V	230
Rated current	A	6.8
Fuse protection min.	A	10 (time-lag)
Degree of protection		IP 20
Maximum overall length when using extension cables with:		
- 3 x 1.0 mm ² lead cross-section	m	10
- 3 x 1.5 mm ² lead cross-section	m	25
- 3 x 2.5 mm ² lead cross-section	m	25
Dimensions: length x width x height	mm	600 x 310 x 405
Weight	kg	18
Sound pressure level at 1 m max.	dB (A)	87 ± 3