

JVC

CD RECEIVER

KD-S100

ENGLISH

RECEPTOR CON CD

KD-S100

ESPAÑOL

RÉCEPTEUR CD

KD-S100

FRANÇAIS



BONGIOVI ACOUSTICS

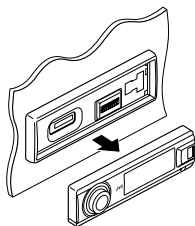
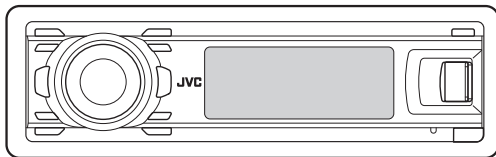

MP3
WMA



INSTRUCTIONS

MANUAL DE INSTRUCCIONES
MANUEL D'INSTRUCTIONS

For customer Use:

Enter below the Model No.
and Serial No. which are
located on the top or bottom
of the cabinet. Retain this
information for future
reference.

Model No. _____

Serial No. _____

GET0395-001A

[J]

INFORMATION (For U.S.A.)

This equipment has been tested and found to comply with the limits for a Class B digital device, pursuant to Part 15 of the FCC Rules. These limits are designed to provide reasonable protection against harmful interference in a residential installation. This equipment generates, uses, and can radiate radio frequency energy and, if not installed and used in accordance with the instructions, may cause harmful interference to radio communications. However, there is no guarantee that interference will not occur in a particular installation. If this equipment does cause harmful interference to radio or television reception, which can be determined by turning the equipment off and on, the user is encouraged to try to correct the interference by one or more of the following measures:

- Reorient or relocate the receiving antenna.
- Increase the separation between the equipment and receiver.
- Connect the equipment into an outlet on a circuit different from that to which the receiver is connected.
- Consult the dealer or an experienced radio/TV technician for help.

Caution:

Changes or modifications not approved by JVC could void the user's authority to operate the equipment.

IMPORTANT FOR LASER PRODUCTS

1. CLASS 1 LASER PRODUCT
2. **CAUTION:** Do not open the top cover. There are no user serviceable parts inside the unit; leave all servicing to qualified service personnel.
3. **CAUTION:** (For U.S.A.) Visible and/or invisible class II laser radiation when open. Do not stare into beam.
(For Canada) Visible and/or invisible class 1M laser radiation when open. Do not view directly with optical instruments.
4. REPRODUCTION OF LABEL: CAUTION LABEL, PLACED OUTSIDE THE UNIT.

CAUTION	ATTENTION	AVISO	VARNING	注意	CAUTION
VISIBLE AND/OR INVISIBLE CLASS 1M LASER RADIATION WHEN OPEN. DO NOT VIEW DIRECTLY WITH OPTICAL INSTRUMENTS. IEC90025-1:2001 (ENG)	RAYONNEMENT LASER VISIBLE ET/OU INVISIBLE DE CLASSE 1M UNE FOIS OUVERT. NE PAS REGARDER DIRECTEMENT AVEC DES INSTRUMENTS OPTIQUES. (FRA)	RADIACIÓN LASER DE CLASE 1M VISIBLE Y/O INVISIBLE CUANDO ESTA ABIERTO. NO MIRAR DIRECTAMENTE CON INSTRUMENTAL OPTICO. (ESP)	SYNLIG OCH/ELLER OSYNLIG LASERSTRÅLNING, KLASS 1M, NÄR DENNA DEL ÄR ÖPPNAD. BETRÄKTA EJ STRÅLEN MED OPTISKA INSTRUMENT. (SWE)	ここを覗くと有害な 放射があなたに有害な のクラス1M レーザー放射が 出ます。 光学機器で直接 覗かないでください。 (JPN)	VISIBLE AND/OR INVISIBLE CLASS II LASER RADIATION WHEN OPEN. DO NOT STARE INTO BEAM. FEDERAL COMMUNICATIONS COMMISSION (FCC) PART 15 CH 1130. (USA) FDA 21 CFR (ENG) LV44803-003A



[European Union only]

Notice:

The display window built in this unit has been produced with high precision, but it may have some ineffective dots. This is inevitable and is not malfunction.

Warning:





If you need to operate the unit while driving, be sure to look ahead carefully or you may be involved in a traffic accident.

Caution on volume setting:

Discs produce very little noise compared with other sources. Lower the volume before playing a disc to avoid damaging the speakers by the sudden increase of the output level.

Thank you for purchasing a JVC product.
Please read all instructions carefully before operation,
to ensure your complete understanding and to obtain
the best possible performance from the unit.

The following marks are used to indicate...

-  : Built-in CD player operations.
-  : External CD changer operations.
-  : SD player operations.
-  : External USB memory operations.

How to reset your unit

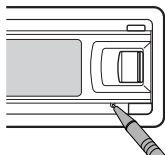

- Your preset adjustments will also be erased.

How to forcibly eject a disc

- If an SD card is inserted, eject the SD card first (see page 10).

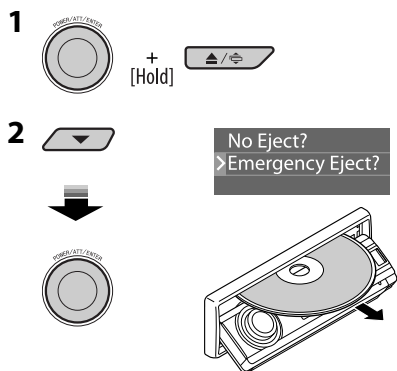

- If this does not work, reset your unit.
- Be careful not to drop the disc when it ejects.

CONTENTS

Control panel	5
Remote controller — RM-RK300	5
Getting started	7
Basic operations	7
Radio operations	8
Disc/SD card/USB memory operations	10
Playing a disc in the unit	10
Playing discs in the CD changer	10
Playing from an SD card	10
Playing from a USB memory	11
Sound adjustments	14
Activating the Biongiuvi Acoustics Digital Power Station™	14
Setting the sound modes—SEL	14
General settings — PSM	15
Title assignment	19
Satellite radio operations	20
iPod®/D. player operations	23
Other external component operations ...	25
Maintenance	26
More about this unit	27
Troubleshooting	30
Specifications	34

For safety...

- Do not raise the volume level too much, as this will block outside sounds, making driving dangerous.
- Stop the car before performing any complicated operations.

Temperature inside the car...

If you have parked the car for a long time in hot or cold weather, wait until the temperature in the car becomes normal before operating the unit.

■ Detaching the control panel

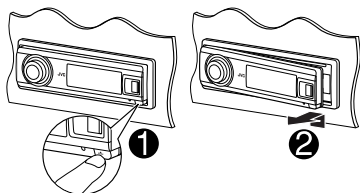

■ Attaching the control panel

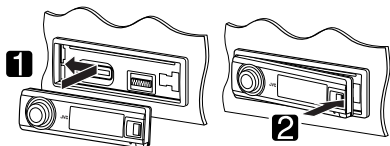

■ Changing the control panel angle

1 [Hold]

2 → Angle 1 → Angle 2
← Angle 4 ← Angle 3 ←

When using the remote controller



Caution:

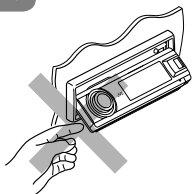

The unit is equipped with the steering wheel remote control function.

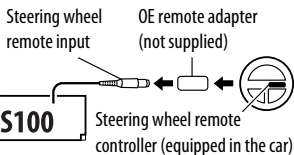

■ Entering the various menus

The main menu contains four menus (MODE, PSM, SEL, TITLE).

- If no operation is done for about 15 seconds, menu screen is canceled.

1

2 Select a menu you want.

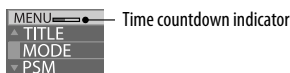

3 Enter the selected menu.



- To go back to the previous screen or exit the MENU screen, press BACK repeatedly.

4 Operate as instructed on the screen.

- To go back to the MENU screen, press MENU.

■ Changing the display information and patterns

Ex.: When tuner is selected as the source

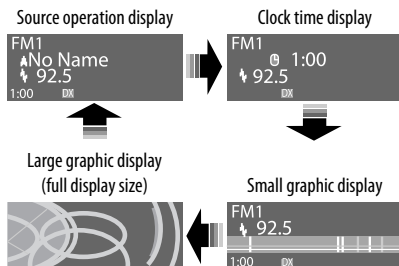

Control panel

Parts identification

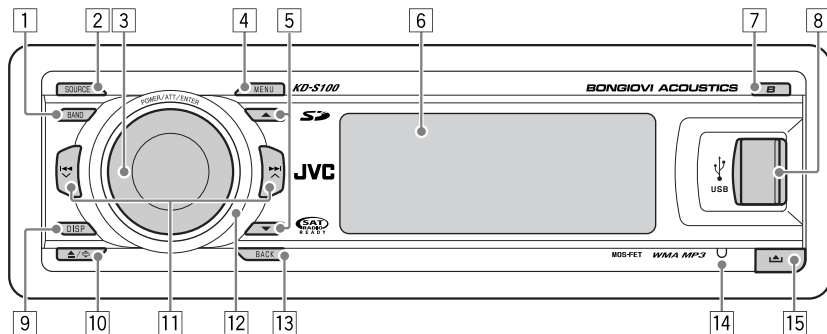

- 1 BAND button
- 2 SOURCE button
- 3 Control dial
 - POWER/ATT (attenuator)/ENTER button
- 4 MENU button
- 5 ▲ (up) / ▼ (down) buttons
- 6 Display window
- 7 B (Bongiovi Acoustics Digital Power Station™) button
- 8 USB (Universal Serial Bus) input terminal
- 9 DISP (display) button
- 10 ▲ (eject) / ⚙ (angle) button
- 11 ◀◀ ▶▶ ▶▶ ▲ buttons
- 12 Remote sensor
 - DO NOT expose the remote sensor to strong light (direct sunlight or artificial lighting).*
- 13 BACK button
- 14 Reset button
- 15 📴 (control panel release) button

Remote controller — RM-RK300

Installing the lithium coin battery (CR2025)

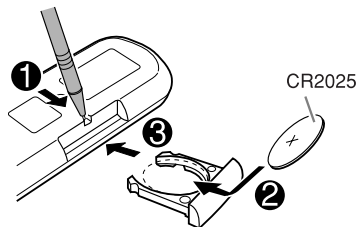

For USA-California Only:

This product contains a CR Coin Cell Lithium Battery which contains Perchlorate Material—special handling may apply.

See www.dtsc.ca.gov/hazardouswaste/perchlorate

Aim the remote controller directly at the remote sensor on the unit. Make sure there is no obstacle in between.

Continued on the next page

Warning:

- Do not install any battery other than CR2025 or its equivalent; otherwise, it may explode.
- Do not leave the remote controller in a place (such as dashboards) exposed to direct sunlight for a long time; otherwise, it may explode.
- Store the battery in a place where children cannot reach to avoid risk of accident.
- To prevent the battery from over-heating, cracking, or starting a fire:
 - Do not recharge, short, disassemble, heat the battery, or dispose of it in a fire.
 - Do not leave the battery with other metallic materials.
 - Do not poke the battery with tweezers or similar tools.
 - Wrap the battery with tape and insulate when throwing away or saving it.

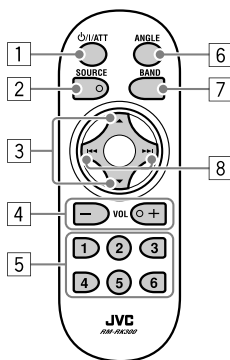
Main elements and features

- 1 **⏻/ATT (standby/on/attenuator) button**
- Turns the power on if pressed briefly or attenuates the sound when the power is on.
 - Turns the power off if pressed and held.
- 2 **SOURCE button**
- Selects the source.

- 3 **▲ (up) / ▼ (down) buttons**
- **For FM/AM:** Changes the preset stations.
 - **For SIRIUS®/XM:** Changes the categories.
 - **For MP3/WMA/SD/USB:** Changes the folders.
 - **While listening to an Apple iPod or a JVC D. player:**
 - Pauses/stops or resumes playback with ▼.
 - Enters the main menu with ▲.
 (Now ▲/▼/⏪/⏩ work as the menu selecting buttons.)*
- 4 **VOL (volume) + / - buttons**
- Adjusts the volume level.
- 5 **Number buttons**
- **For FM/AM:** Selects the preset station if pressed, or store a station if pressed and held.
 - **For SIRIUS®/XM:** Selects the preset channels if pressed, or store a channel if pressed and held.
 - **For CD/CD Text:** Selects the tracks.
 - **For MP3/WMA/SD/USB:** Selects the folders.
 - **For CD changer:** Selects the discs.
- 6 **ANGLE button**
- Adjusts the control panel angle.
- 7 **BAND button**
- Selects the band.
- 8 **⏪ / ⏩ buttons**
- **For FM/AM:** Searches for stations if pressed, or skips frequencies after pressed and held.
 - **For SIRIUS®/XM:** Changes the channels if pressed briefly, or changes the channels rapidly if pressed and held.
 - **For CD/CD Text/MP3/WMA/SD/USB:** Changes the tracks if pressed, or fast-forwards or reverses the track if pressed and held.
 - **While listening to an iPod or a D. player (in menu selecting mode):**
 - Selects an item if pressed briefly. (Then, press ▼ to confirm the selection.)
 - Skips 10 items at a time if pressed and held.

* ▲ : Returns to the previous menu.

▼ : Confirms the selection.

Getting started

Basic operations

1 Turn on the power.



2

SOURCE

FM/AM → SIRIUS*/XM* → CD* →
SD* → USB* → CD-CH*/iPod*/D. player*
(or EXT-IN) → LINE-IN → (back to the
beginning)

* You cannot select these sources if they are not
ready or not connected.

3

BAND

For FM/AM tuner



For SIRIUS radio

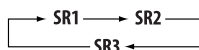

For XM tuner

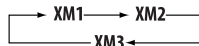

4 Adjust the volume.



5 Adjust the sound as you want. (See pages 14 and 15.)

To drop the volume in a
moment (ATT)

To restore the sound, press it
again.



To turn off the power



Setting the clock

- See also “General settings — PSM” on pages
15 – 17.

1 Enter the PSM menu (see page 4).

2 Set the clock.

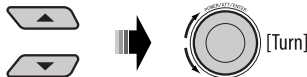

- 1 Select “Clock H” (hour), then adjust the hour.
- 2 Select “Clock M” (minute), then adjust the
minute.
- 3 Select “24H/12H,” then “24Hours” or
“12Hours.”

3 Finish the procedure.



**To check the current clock time while the
power is turned off**

DISP

Radio operations

- 1 SOURCE → FM/AM →
- 2 BAND → FM1 → FM2 → FM3
AM ←

3 Start searching for a station.



Selected band appears.



When a station is received, searching stops.
To stop searching, press the same button again.

To tune in to a station manually

In step 3 above...



2 Select a desired station frequency.



When an FM stereo broadcast is hard to receive

1 Enter the MODE menu (see page 4).



- 4 MO indicator lights up. Reception improves, but stereo effect will be lost.

To restore the stereo effect, repeat the same procedure and select "Off" in step 3. The MO indicator goes off.

Tuning in to FM stations with strong signals only—LO (local)/DX (Distance-Extreme)

1 Enter the MODE menu (see page 4).

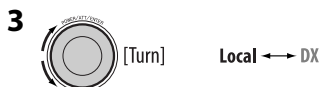

- 4 DX indicator goes off and LO indicator lights up. Only stations with sufficient signal strength will be detected.

To tune in to all receivable stations, repeat the same procedure and select "DX" in step 3. The LO indicator goes off and DX indicator lights up.

Storing stations in memory

You can preset six stations for each band.

FM station automatic presetting—SSM (Strong-station Sequential Memory)

1 Select the FM band (FM1 – FM3) you want to store into.

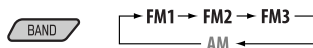

2 Enter the MODE menu (see page 4).

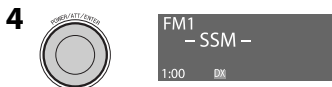

Local FM stations with the strongest signals are searched and stored automatically in the FM band.

Manual presetting

Ex.: Storing FM station of 92.5 MHz into preset number 4 of the FM1 band.



3 Enter the MODE menu (see page 4).

- If you hold down ▲/▼, the Preset Station List appears (go to step 6).



6 Select a preset number.



- You can move to the lists of the other FM bands by turning the control dial.

7 Store the station.



When using the remote controller

After tuning in to a station you want to preset...

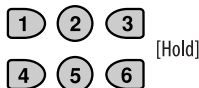

Listening to a preset station



When using the remote controller

Directly select the preset number.

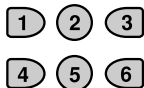

Disc/SD card/USB memory operations

Playing a disc in the unit

All tracks will be played repeatedly until you change the source or eject the disc.

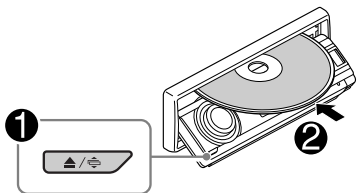

To stop play and eject the disc



Note:

If a USB memory is attached to the unit, you cannot eject the disc. "Please Eject USB" flashes on the display. If this happens, detach the USB memory, then, press / button again.

Playing discs in the CD changer

All discs in the magazine will be played repeatedly until you change the source.

- Ejecting the magazine will also stop playback.



* If you have changed the external input setting to "Ext In" (see page 17), you cannot select the CD changer.

Playing from an SD card

Before detaching the control panel, turn off the power.

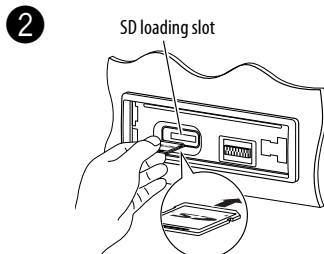
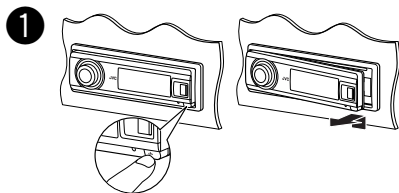

SD loading slot

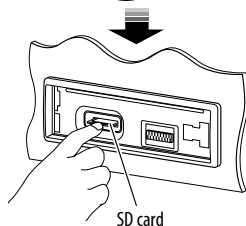

SD card

Press in the SD card until you hear a clicking sound.

To eject the SD card, press the SD card again.

- Press the SD card softly (do not release your finger quickly); otherwise, the SD card may pop out from the unit.

3 Attach the control panel.

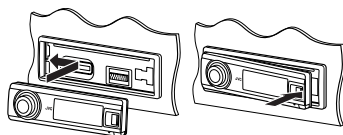

4



The control panel goes back to the previous position.

Playback starts automatically if tracks are recorded.

Playing from a USB memory

This unit can play MP3/WMA tracks stored in a USB memory.

All tracks in the USB memory will be played repeatedly until you change the source.

- Removing the USB memory will also stop playback.

1

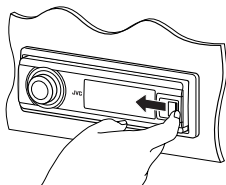

2

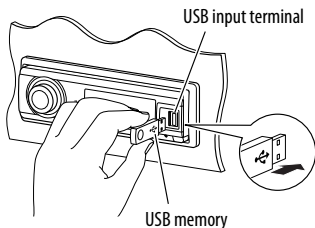

To detach the USB memory, straightly pull it out from the unit.

Cautions:

- Avoid using the SD card/USB memory when it might hinder your safety driving.
- Make sure all important data have been backed up to avoid losing the data.

If an SD card or USB memory has been attached...

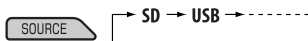

Playback starts from where it has been stopped previously.

- If a different SD card or USB memory is currently attached, playback starts from the beginning.

About MP3 and WMA tracks

MP3 and WMA "tracks" (words "file" and "track" are used interchangeably) are recorded in "folders."

About the CD changer

It is recommended to use a JVC MP3-compatible CD changer with your unit.

- You can also connect MP3-incompatible CD changers. However, these units are not compatible with MP3 discs.
- You cannot use the CH-X99, CH-X100, and KD-MK series CD changers with this unit.
- You cannot play any WMA disc in the CD changer.
- Disc text information recorded in the CD Text can be displayed when a JVC CD Text compatible CD changer is connected.

To fast-forward or reverse the track

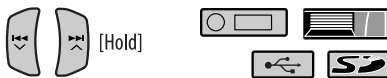

To go to the next or previous tracks

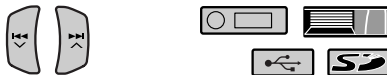





To go to the next or previous folders (only for MP3/WMA/SD/USB)

For MP3 tracks:



For WMA tracks:



- Holding the buttons can display the Disc List () and Folder List ( /  / ) , see the following.

Other main functions

Selecting a disc/folder/track on the list



- This function is not available for an audio CD or a CD Text when the source is "CD."

1 Enter the MODE menu (see page 4).

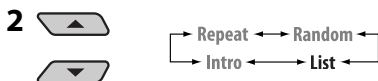

3 Select a list type.



*1 Selectable only when the source is "CD-CH."

*2 Appears only for MP3/WMA/SD/USB.

4 Confirm the selection.



The selected list appears on the display.

- You can move to the other list by turning the control dial.

5 Select a disc/folder/file from the list.



Current folder



Ex.: When "Folder" is selected in step 3





Only for MP3/WMA/SD/USB:

If you select the current disc/folder (highlighted on the screen), its Folder/File List appears.

6 Starts playback.



When using the remote controller

- To directly select a disc ()
- To directly select a track of an audio CD or a CD Text ()
- To directly select an MP3/WMA folder ( /  / )

To select a number from 1 – 6:



To select a number from 7 (1) – 12 (6):



[Hold]

For MP3/WMA folders:

It is required that folders are assigned with 2-digit numbers at the beginning of their folder names—01, 02, 03, and so on.

Prohibiting disc ejection



You can lock a disc in the loading slot.

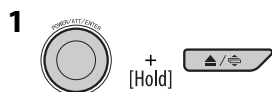

2 After making sure "No Eject?" is selected...

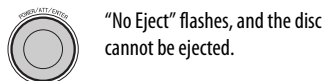

"No Eject" flashes, and the disc cannot be ejected.

To cancel the prohibition, repeat the same procedure after making sure "Eject OK?" is selected.

- "Eject OK" flashes on the display.

Selecting the playback modes

You can use only one of the following playback modes at a time.

1 Enter the MODE menu (see page 4).

2 Select one of the playback modes.



3 Select one of the items (see the following table).



4 Finish the procedure.



Intro Plays the beginning 15 seconds of...

Track : All tracks of the current playback media. []

Folder*1 : First track of all folders of the current playback media. []

Disc*2 : First track of all the inserted discs. []

Off : Cancels.

Repeat Plays repeatedly

Track : The current track. []

Folder*1 : All tracks of the current folder. []

Disc*2 : All tracks of the inserted discs. []

Off : Cancels.

Random Plays at random

Folder*1 : All tracks of the current folder, then tracks of the next folder and so on. []

Disc : All tracks of the current disc. []

All*3 : All tracks of the inserted discs/media. []

Off : Cancels.

*1 Only while playing a media (MP3/WMA/SD/USB).

*2 Only when the source is CD-CH.

*3 Only when the source is CD-CH, SD, or USB.

Sound adjustments

Activating the Bongiovi Acoustics Digital Power Station™

The Bongiovi Acoustics Digital Power Station™ is a digital processing method that maximizes the frequency response of the speakers, the capability of the amplifier, and the acoustic properties of your vehicle's passenger compartment.

All vehicles have unique acoustic properties such as speaker placement and passenger compartment design. Your car has been custom tuned by Bongiovi Acoustics engineers to provide the optimum listening experience. The Bongiovi Acoustics Digital Power Station processing power produces rich, full sound, and also compensates for any inherent volume differences that may exist between audio source or program material.

Studio Quality Digital Sound

Optimum speaker frequency response
+
Optimum power distribution from amplifier
+
Custom tuned listening environment

To enjoy the Bongiovi Acoustics Digital Power Station's Studio Quality Digital Sound that has been custom tuned for your vehicle:



To deactivate the Bongiovi Acoustics Digital Power Station™, press the button again.

Setting the sound modes—SEL ■

You can adjust the sound characteristics to your preference.

1 Enter the SEL menu (see page 4).

2 Select a setting item.



When selecting "Fad/Bal," "Bass/Tre," or "S.woofer," press POWER/ATT/ENTER to enter its submenu.

3 Adjust the selected setting item. (See the following for details.)

- To adjust other SEL settings, press BACK. Then repeat steps **2** and **3**.

4 Finish the procedure.



■ To adjust fader and balance—Fad/Bal

• Fad (fader)

Adjust the front and rear speaker balance.



• Bal (balance)

Adjust the left and right speaker balance.

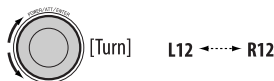

To adjust bass and treble—Bass/Tre

- 1 Select "Bass" or "Treble."



- 2 Adjust the bass or treble.

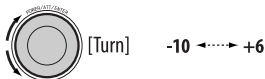

To adjust subwoofer output— S.woofer

- 1 Adjust the output level.

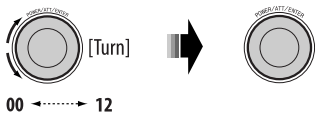

- 2 Select a cut-off frequency according to the connected subwoofer.



- 3 Adjust the continuity of the sound among speakers (slope).



-18 ↔ -12 ↔ -06



To adjust the input level of each source—Vol Adj

This setting is required for each source except for FM. Once an adjustment is made, it will be memorized. When you change the source, the volume level will automatically increase or decrease according to the adjusted level.

- 1 Select a source before entering the SEL menu.

- 2 Adjust to match the input level to the FM sound level.

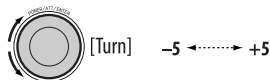

General settings — PSM

You can change PSM (Preferred Setting Mode) items (except "Sirius ID") listed in the table that follows.

- 1 Enter the PSM menu (see page 4).

- 2 Select a PSM item.



- 3 Select or adjust the selected PSM item.



- 4 Repeat steps 2 and 3 to adjust the other PSM items if necessary.

- 5 Finish the procedure.



Continued on the next page

Indications	Items (__: Initial)	Settings, [reference page]
Anime Animation	<ul style="list-style-type: none"> • On • Off 	<ul style="list-style-type: none"> : An animation screen appears when you turn on or off the power, change the source, and when you select MENU. : Cancels.
Clock H Hour adjustment	1 – 12 (0 – 23) [Initial: 1 (1:00AM)]	: See also page 7 for setting.
Clock M Minute adjustment	00 – 59 [Initial: 00 (1:00AM)]	: See also page 7 for setting.
24H/12H Time display mode	<ul style="list-style-type: none"> • 12Hours • 24Hours 	: See also page 7 for setting.
Clock Adj *1 Time display mode	<ul style="list-style-type: none"> • Auto • Off 	<ul style="list-style-type: none"> : The built-in clock is automatically adjusted using the clock data provided via the satellite radio channel. : Cancels.
Time Zone *1, *2	<ul style="list-style-type: none"> • Eastern • Atlantic • Newfndlnd • Alaska • Pacific • Mountain • Central 	: Select your residential area from one of the following time zones for clock adjustment.
DST *1 Daylight savings time	<ul style="list-style-type: none"> • On • Off 	<ul style="list-style-type: none"> : Activates daylight savings time if your residential area is subject to DST. : Cancels.
Sirius ID *3	—	: Your SIRIUS identification number appears on the display, [20].
Scroll *4	<ul style="list-style-type: none"> • Once • Auto • Off 	<ul style="list-style-type: none"> : Scrolls the track information once. : Repeats scrolling (at 5-second intervals). : Cancels. • Pressing DISP for more than one second can scroll the display regardless of the setting.
Dimmer	<ul style="list-style-type: none"> • Auto • Time Set • Off • On 	<ul style="list-style-type: none"> : Dims the display when you turn on the headlights. : Sets the timer for dimmer, see page 18 for setting. From: Any hour; To: Any hour : Cancels. : Activates dimmer. (Does not work if "Bright" is set to "1.")
Bright Display brightness	1 – 10 [Initial: 8]	: Adjust the display contrast to make the display indications clear and legible. (If Dimmer is set to "On", selecting "1" to "4" takes no effect.)

Indications	Items (__: Initial)	Settings, [reference page]
ID3 Tag Tag display	<ul style="list-style-type: none"> • On • Off 	: Shows the Tag information while playing MP3/WMA tracks. : Cancels.
Theme Display theme	<ul style="list-style-type: none"> • Large (1 [Initial] or 2) • Small (1 [Initial] or 2) 	: Select the display theme for large graphic display, [4]. See page 18 for setting. : Select the display theme for small graphic display, [4]. See page 18 for setting.
IF Band Intermediate frequency band	<ul style="list-style-type: none"> • Auto • Wide 	: Increases the tuner selectivity to reduce interference noises between close stations. (Stereo effect may be lost.) : Subject to interference noises from adjacent stations, but sound quality will not be degraded and the stereo effect will remain.
Area Tuner channel interval	<ul style="list-style-type: none"> • US • SA • EU 	: When using in North/Central/South America. AM/FM intervals are set to 10 kHz/200 kHz. : When using in South American countries where FM interval is 100 kHz. AM interval is set to 10 kHz. : When using in any other areas. AM/FM intervals are set to 9 kHz/50 kHz (100 kHz during auto search).
Beep Key-touch tone	<ul style="list-style-type: none"> • On • Off 	: Activates the key-touch tone. : Deactivates the key-touch tone.
Ext In ^{*5} External input	<ul style="list-style-type: none"> • Changer • Ext In 	: To use a JVC CD changer, [10], a JVC compatible satellite (SIRIUS/XM) tuner, [20], or an Apple iPod or a JVC D. player, [23]. : To use any other external component than the above, [25].
Tel Telephone muting	<ul style="list-style-type: none"> • Muting 1/ Muting 2 • Off 	: Select either one which mutes the sounds while using a cellular phone. • If CD/CD-CH/SD/USB/iPod/D. player has been selected as the source, playback pauses during telephone muting. : Cancels.
Amp Gain Amplifier gain control	<ul style="list-style-type: none"> • High PWR • Low PWR • Off 	: Volume 00 – Volume 50 : Volume 00 – Volume 30 (Select this if the maximum power of the speaker is less than 50 W to avoid damaging the speakers.) : Deactivates the built-in amplifier.

*1 Displayed only when SIRIUS Satellite radio or XM Satellite radio is connected.

*2 Displayed only when "Clock Adj" is set to "Auto."

*3 Displayed only when SIRIUS Satellite radio is connected.

*4 Some characters or symbols will not be shown correctly (or will be blanked) on the display.

*5 Displayed only when one of the following sources is selected—FM, AM, CD, SD, USB, or LINE-IN.

Selecting timer for the dimmer

You can dim the display at night or as you set the timer.

1 Select "Dimmer" from the PSM menu.

2 Select "Time Set."



3 Adjust the dimmer time.

1 Set the dimmer start time.

24Hours: [0 – 23]

12Hours: [1A (1AM) – 12A (12AM);

1P (1PM) – 12P (12PM)]



2 Set the dimmer end time.

24Hours: [0 – 23]

12Hours: [1A (1AM) – 12A (12AM);

1P (1PM) – 12P (12PM)]

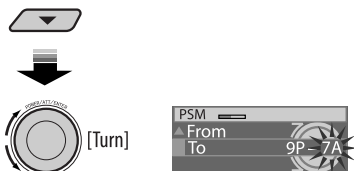

4 Finish the procedure.



Selecting the graphic theme

You can select the graphic theme for large and small display sizes (see also page 4).

1 Select "Theme" from the PSM menu.

2 Select the size of the display.



3 Select the theme.



4 Repeat steps 2 and 3 to select the other display size and theme.

5 Finish the procedure.



To show the selected display theme, press DISP repeatedly while playing a source.

Title assignment

You can assign titles to station frequencies, CDs (both in this unit and in the CD changer) and the external components (LINE-IN and EXT-IN).

Sources	Maximum number of characters
Station frequencies	Up to 16 characters (up to 30 station frequencies including both FM and AM)
CDs/CD-CH*	Up to 32 characters (up to 30 discs)
External component	Up to 16 characters

* You cannot assign names to any discs other than conventional CDs.

1 Select the sources.

- For FM/AM tuner: Select a station.
- For CDs in this unit: Insert a CD.
- For CDs in the CD changer: Select "CD-CH," then select a disc number.
- For external component: Select "LINE-IN" or "EXT-IN."

2 Enter the TITLE menu (see page 4).

3 Assign a title.

- 1 Select a character set.

DISP

A (A – Z: upper case) → a (a – z: lower case)
 → 0 (numbers and symbols) → Á (Accented letters: upper case) → á (Accented letters: lower case) → (back to the beginning)

- 2 Select a character.



- 3 Move to the next (or previous) character position.



- 4 Repeat steps 1 to 3 until you finish entering the title.

4 Finish the procedure.



- To cancel the title entry without registration, press MENU.

Available characters

In addition to the Roman alphabets (A – Z, a – z), the following characters will be used.

Accented letters: upper case

Á	À	Ã	Ä	Å	Æ	Ç	Ć	Č	É	È	Ê
Ë	Ĝ	Ĭ	Ī	Ĵ	Ń	Ň	Ō	Ó	Ô	Õ	Ř
Ś	Š	Ş	Ú	Û	Ü	Ý	Ž	Ẓ	Ẕ	ẖ	Ɔ
Ɔ	Ɔ	Ɔ	Ɔ	Ɔ	Ɔ	Ɔ	Ɔ	Ɔ	Ɔ	Ɔ	Ɔ

Accented letters: lower case

á	à	ã	ä	å	æ	ç	ć	č	é	è	ê
ë	ĝ	ĭ	ī	ĵ	ń	ň	ó	ô	õ	ř	
ś	š	ş	ú	û	ü	ý	ž	ẓ	ẕ	ẘ	
Ɔ	Ɔ	Ɔ	Ɔ	Ɔ	Ɔ	Ɔ	Ɔ	Ɔ	Ɔ	Ɔ	Ɔ

Numbers and symbols

0	1	2	3	4	5	6	7	8	9	!	"	#	\$
%	&	'	()	*	+	,	-	.	/	:	;	<
=	>	?	@	_	`	i	¿	£	€	α	space		

To erase the entire title

In step 3...



Satellite radio operations

This unit is satellite (SAT) Radio Ready—compatible with both SIRIUS Satellite radio and XM Satellite radio.

Before operating your satellite radio, refer also to the Instructions supplied with your SIRIUS Satellite radio or XM Satellite radio.

- “SIRIUS” and the SIRIUS dog logo are registered trademarks of SIRIUS Satellite Radio Inc.
- XM and its corresponding logos are registered trademarks of XM Satellite Radio Inc.
- “SAT Radio,” the SAT Radio logo and all related marks are trademarks of SIRIUS Satellite Radio Inc., and XM Satellite Radio, Inc.

Listening to the satellite radio

Connect either one of the following (separately purchased) to the CD changer jack on the rear of this unit.

- **JVC SIRIUS radio DLP**—Down Link Processor, for listening to the SIRIUS Satellite radio.
- **XMDirect™ Universal Tuner Box**—Using a JVC Smart Digital Adapter (XMDJVC100: not supplied), for listening to the XM Satellite radio.

GCI (Global Control Information) update:

- If channels are updated after subscription, updating starts automatically.

The following appears and no sound can be heard.

- For SIRIUS Satellite radio: “Channels Updating XX%* Completed”
- For XM Satellite radio: “UPDATING”
- Update takes a few minutes to complete.
- During update, you cannot operate your satellite radio.

* Changes every 20% of update is completion, (ex. 20%, 40%, 60%).

Activate your SIRIUS subscription after connection:

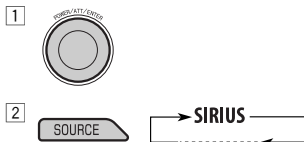

JVC DLP starts updating all the SIRIUS channels. Once completed, JVC DLP tunes in to the preset channel, CH184.

- 3 **Check your SIRIUS ID, see page 16.**
- 4 **Contact SIRIUS on the internet at <<http://activate.siriusradio.com/>> to activate your subscription, or you can call SIRIUS toll-free at 1-888-539-SIRIUS (7474).** “Subscription Updated Press Any Key to Continue” appears on the display once subscription has been completed.

Activate your XM subscription after connection:

- Only Channel 0, 1, and 247 are available before activation.

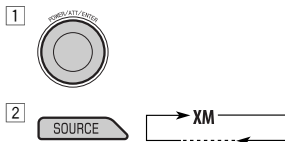



XMDirect™ Universal Tuner Box starts updating all the XM channels. “Channel 1” is tuned in automatically.

- 3 **Check your XM Satellite radio ID labelled on the casing of the XMDirect™ Universal Tuner Box, or tune in to “Channel 0” (see page 22).**

- 4 Contact XM Satellite radio on the internet at <http://xmradio.com/activation/> to activate your subscription, or you can call 1-800-XM-RADIO (1-800-967-2346). Once completed, the unit tunes in to one of the available channels (Channel 4 or higher).

Listening to the SIRIUS Satellite radio

- 1  → SIRIUS
- 2  → SR1 → SR2 → SR3

3 Select a category.



You can tune in to all the channels of every category by selecting "ALL."

Selecting a particular category (SPORTS, ENTERTAINMENT, etc.) allows you to enjoy only the channels from the selected category.



- Holding either of the buttons can display the category list (see page 22).

4 Select a channel for listening.



- Holding the button changes the channels rapidly.
- When changing the category or channel, invalid and unsubscribed channels are skipped.

Listening to the XM Satellite radio

- 1  → XM
- 2  → XM1 → XM2 → XM3

3 Select a channel for listening.



- Holding the button changes the channels rapidly.

Searching for category/channel

You can search for programs by category (Category Search) or channel number (Channel Search).

- **In Category Search**, you can tune in to the channels of the selected category. Category Search begins from the currently selected channel.
- **In Channel Search**, you can tune in to all channels (including non-categorised channels).

1 Select a category (Category Search).



- For Channel Search, skip this step.

2 Select a channel for listening.



If no operation is done for about 15 seconds, Category Search is canceled.

In Channel Search, channel name and channel number appear on the display during search.

- While searching, invalid and unsubscribed channels are skipped.

Checking the XM Satellite radio ID

While selecting "XM1," "XM2," or "XM3," select "Channel 0."



The display alternately shows "RADIO ID" and the 8-digit (alphanumeric) ID number.

To cancel the ID number display, select any channel other than "Channel 0."

Storing user channels in memory

You can preset six channels for each band.

Ex.: Storing a SIRIUS channel into preset number 4 of the SR1 band.

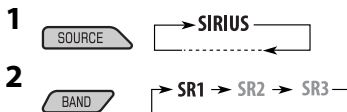

• Holding the button displays the User Preset Channel List (see step 6 on the right column).

3 Enter the MODE menu (see page 4).

4 Select "Preset."

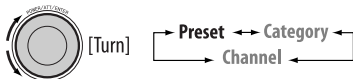

5



6 Select a user preset number.



• You can move to the lists of the other SIRIUS bands by turning the control dial.

7 Store the channel.



Listening to a user preset channel

1

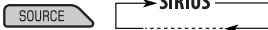

2



• Holding this button displays the User Preset Channel List (see step 6 above).

3 Perform steps 3 to 6 (on the left column) to select a user preset channel.

4 Finish the procedure.



Selecting a category/channel on the list

Selecting a category from the list

1 Enter the MODE menu (see page 4).

2 Select "Category."





4 Select a category you want.



- You can move to the other lists by turning the control dial.

5 Finish the procedure.



The first channel of the selected category is tuned in.

- If you select the current category (highlighted on the display), its channel list appears.

Holding ▲/▼ also shows the Category List while listening to a channel.

■ Selecting a channel from the list

1 Enter the MODE menu (see page 4).

2 Select "Channel."

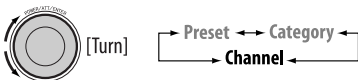

4 Select a channel you want.



- You can move to the other lists by turning the control dial.

5 Finish the procedure.



To change the display information while listening to a channel



Category name and channel name → Artist/composer* name and song/program name → Clock → Small graphic display → Large graphic display → (back to the beginning)

* Only for SIRIUS Satellite radio.

iPod®/D. player operations

This unit is ready for operating an Apple iPod or a JVC D. player from the control panel.

Before operating your iPod or D. player:

- Connect either one of the following (separately purchased) to the CD changer jack on the rear of this unit.
 - **Interface adapter for iPod®**, KS-PD100, for controlling an iPod.
 - **D. player interface adapter**, KS-PD500, for controlling a D. player.
- Refer also to the manual supplied with the interface adapter for details.

Caution:

Make sure to turn off this unit or turn off the vehicle's ignition switch before connecting or disconnecting the iPod or D. player.

Continued on the next page

Preparations:

Make sure "Changer" is selected for the external input setting, see page 17.

1**2**

Playback starts automatically from where it has been paused*¹ or stopped*² previously.

3

Adjust the volume.

**4**

Adjust the sound as you want. (See pages 14 and 15.)

- Make sure the equalizer on the iPod or D. player is deactivated.

<p>To pause*¹ or stop*² playback</p> <p>To resume playback, press it again.</p>	
<p>To fast-forward or reverse the track</p>	
<p>To go to the next or previous tracks</p>	

*¹ For iPod

*² For D. player

Selecting a track from the menu**1 Enter the main menu.**

Now the ▲/▼/◀/▶/⏪/⏩/⏮/⏭ buttons work as the menu selecting buttons*.

* The menu selecting mode will be canceled:

- If no operations are done for about 5 seconds.
- When you confirm the selection of a track.

2 Select the desired menu.

For iPod:

Playlists ↔ Artists ↔ Albums ↔ Songs
 ↔ Genres ↔ Composers ↔ (back to the beginning)

For D. player:

Playlist ↔ Artist ↔ Album ↔ Genre ↔
 Track ↔ (back to the beginning)

3 Confirm the selection.

- To move back to the previous menu, press ▲.

- If a track is selected, playback starts automatically.
- If the selected item has another layer, you will enter the layer. Repeat steps 2 and 3 until the desired track is played.
- Holding ◀◀ ▶▶ ▶▶ ▶▶ ▲ can skip 10 items at a time.

Selecting the playback modes

1 Enter the MODE menu (see page 4).

2 Select one of the playback modes.



Repeat ↔ Random



3 Select an item (see table below).



4 Finish the procedure.



Repeat play

One : Functions the same as “Repeat One” of the iPod or “Repeat Mode → One” for the D. player.

All : Functions the same as “Repeat All” of the iPod or “Repeat Mode → All” for the D. player.

Off : Cancels.

Random play

Album* : Functions the same as “Shuffle Albums” of the iPod.

Song/On : Functions the same as “Shuffle Songs” of the iPod or “Random Play → On” of the D. player.

Off : Cancels.

* For iPod: Only if you select “All” in “Albums” of the main “MENU.”

Other external component operations

You can connect an external component to the LINE IN plugs on the rear or to the CD changer jack on the rear using the Line Input Adapter—KS-U57 (not supplied) or AUX Input Adapter—KS-U58 (not supplied).

- For listening to the SD card/USB memory, see pages 10 – 13; for iPod, or D.player, see pages 23 – 25.

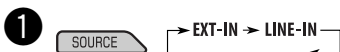

LINE-IN : For selecting the external component connected to the LINE IN plugs.

EXT-IN : For selecting the external component connected to the CD changer jack.

If “EXT-IN” does not appear, see page 17 and select the external input (“Ext In”).

2 Turn on the connected component and start playing the source.

3 Adjust the volume.



4 Adjust the sound as you want. (See pages 14 and 15.)

Maintenance

How to clean the connectors

Frequent detachment will deteriorate the connectors. To minimize this possibility, periodically wipe the connectors with a cotton swab or cloth moistened with alcohol, being careful not to damage the connectors.

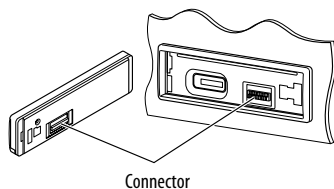

Moisture condensation

Moisture may condense on the lens inside the unit in the following cases:

- After starting the heater in the car.
- If it becomes very humid inside the car.

Should this occur, the unit may malfunction. In this case, eject the disc and leave the unit turned on for a few hours until the moisture evaporates.

How to handle discs

When removing a disc from its case, press down the center holder of the case and lift the disc out, holding it by the edges.



- Always hold the disc by the edges. Do not touch its recording surface.

When storing a disc into its case, gently insert the disc around the center holder (with the printed surface facing up).

- Make sure to store discs into the cases after use.

To keep discs clean

A dirty disc may not play correctly. If a disc does become dirty, wipe it with a soft cloth in a straight line from center to edge.



- Do not use any solvent (for example, conventional record cleaner, spray, thinner, benzine, etc.) to clean discs.

To play new discs

New discs may have some rough spots around the inner and outer edges. If such a disc is used, this unit may reject the disc.



To remove these rough spots, rub the edges with a pencil or ball-point pen, etc.

How to handle SD card

SD cards are precision products. DO NOT impact, bend, drop, or wet them.

Do not use the following discs:

Warped disc 

Sticker  Sticker residue

 Stick-on label

More about this unit

Basic operations

Turning on the power

- By pressing SOURCE on the unit, you can also turn on the power. If the source is ready, playback also starts.

Turning off the power

- If you turn off the power while listening to a disc, disc play will start from where playback has been stopped previously, next time you turn on the power.

Tuner operations

Storing stations in memory

- During SSM search...
 - All previously stored stations are erased and stations are stored newly.
 - Received stations are preset in No. 1 (lowest frequency) to No. 6 (highest frequency).
 - When SSM is over, the station stored in No. 1 will be automatically tuned in.
- When storing a station manually, the previously preset station is erased when a new station is stored in the same preset number.

Disc/SD card/USB memory operations

Caution for DualDisc playback

- The Non-DVD side of a “DualDisc” does not comply with the “Compact Disc Digital Audio” standard. Therefore, the use of Non-DVD side of a DualDisc on this product may not be recommended.

General

- This unit has been designed to reproduce CDs/CD Texts, and CD-Rs (Recordable)/CD-RWs (Rewritable) in audio CD (CD-DA) and MP3/WMA format; MP3/WMA files recorded in an SD card or a USB memory.
- While playing an audio CD: If a title has been assigned to the audio CD (see page 19), it will be shown on the display.
- While fast-forwarding or reversing an MP3/WMA track, you can only hear intermittent sounds.

Inserting a disc

- When a disc is inserted upside down, the control panel moves down, and the disc automatically ejects from the loading slot.
- If you keep the control panel open for about 1 minute, (beeps sound when the “Beep” setting is turned “On”—see page 17) the control panel returns to its previous position.
- Do not insert 8 cm discs (single CD) and unusual shape discs (heart, flower, etc.) into the loading slot.

Playing a CD-R or CD-RW

- Use only “finalized” CD-Rs or CD-RWs.
- This unit can play back only files of the same type which are first detected if a disc includes both audio CD (CD-DA) files and MP3/WMA files.
- This unit can play back multi-session discs; however, unclosed sessions will be skipped while playing.
- Some CD-Rs or CD-RWs may not play back on this unit because of their disc characteristics, or for the following reasons:
 - Discs are dirty or scratched.
 - Moisture condensation occurs on the lens inside the unit.
 - The pickup lens inside the unit is dirty.
 - CD-R/CD-RW on which the files are written with “Packet Write” method.
 - There are improper recording conditions (missing data, etc.) or media conditions (stained, scratched, warped, etc.).
- CD-RWs may require a longer readout time since the reflectance of CD-RWs is lower than that of regular CDs.
- Do not use the following CD-Rs or CD-RWs:
 - Discs with stickers, labels, or protective seal stuck to the surface.
 - Discs on which labels can be directly printed by an ink jet printer.
 Using these discs under high temperatures or high humidities may cause malfunctions or damage to the unit.

Continued on the next page

Playing an MP3/WMA discs

- This unit can play back MP3/WMA files with the extension code <.mp3> or <.wma> (regardless of the letter case—upper/lower).
- This unit can show the names of albums, artists (performer), and Tag (Version 1.0, 1.1, 2.2, 2.3, or 2.4) for MP3/WMA files.
- This unit can display only one-byte characters. No other characters can be correctly displayed.
- This unit can play back MP3/WMA files compliant to ISO 9660 Level 1/Level 2, Romeo, Joliet, Windows long file name.
- The maximum number of characters for file/folder names vary among the disc format used (includes 4 extension characters—<.mp3> or <.wma>).
 - ISO 9660 Level 1: up to 12 characters
 - ISO 9660 Level 2: up to 31 characters
 - Romeo*: up to 128 (72) characters
 - Joliet*: up to 64 (36) characters
 - Windows long file name*: up to 128 (72) characters
- * *The parenthetic figure is the maximum number of characters for file/folder names in case the total number of files and folders is 313 or more.*
- This unit can play back the files recorded in VBR (variable bit rate).
Files recorded in VBR have a discrepancy in elapsed time display, and do not show the actual elapsed time. Especially, after performing the search function, this difference becomes noticeable.
- This unit can recognize a total of 512 files, of 200 folders, and of 8 hierarchies.
- This unit cannot play back the following files:
 - MP3 files encoded with MP3i and MP3 PRO format.
 - MP3 files encoded in an inappropriate format.
 - MP3 files encoded with Layer 1/2.
 - WMA files encoded with lossless, professional, and voice format.
 - WMA files which are not based upon Windows Media® Audio.
 - WMA files copy-protected with DRM.
 - Files which have the data such as WAVE, ATRAC3, etc.
- The search function works but search speed is not constant.

Playing MP3/WMA tracks from an SD card or a USB memory

- While playing from an SD card or a USB memory, the playback order may differ from other players.
- This unit may be unable to play back some SD cards or USB memories due to their characteristics or recording conditions.
- Depending on the shape of the USB memories and connection ports, some USB memories may not be attached properly or the connection might be loose.
- It is not recommended to use a USB memory wider than 20 mm as it will block you from pressing some buttons on the control panel.
- If the connected USB memory does not have the correct files, “No Files” appears and the unit returns to the previous source.
- This unit can show Tag (Version 1.0, 1.1, 2.2, 2.3, or 2.4) for MP3/WMA files.
- This unit can play back MP3 files recorded in VBR (variable bit rate).
- For SD card: The maximum number of characters for folder name is 8 characters; file names is 12 characters. This unit cannot recognize folder with period (.) on the folder name.
For USB memory: The maximum number of characters for folder and file names is 25 characters; 128 characters for MP3/WMA tag information.
- For SD card: This unit can recognize a total of 255 files and 63 folders.
For USB memory: This unit can recognize a total of 2 500 files and 250 folders (999 files per folder).
- This unit cannot play back the following files:
 - MP3 files encoded with MP3i and MP3 PRO format.
 - MP3 files encoded in an inappropriate format.
 - MP3 files encoded with Layer 1/2.
 - WMA files encoded with lossless, professional, and voice format.
 - WMA files which are not based upon Windows Media® Audio.
 - WMA files copy-protected with DRM.
 - Files which have the data such as WAVE, ATRAC3, etc.
- The search function works but search speed is not constant.

Changing the source

- If you change the source, playback also stops. Next time you select the same source again, playback starts from where it has been stopped previously.

Ejecting a disc

- If the ejected disc is not removed within 15 seconds, the disc is automatically inserted again into the loading slot to protect it from dust. (Disc will not play this time.)

Sound adjustments

Setting the sound modes—SEL

- If you are using a two-speaker system, set the fader level to the center.
- Subwoofer out setting takes effect only when a subwoofer is connected.
- You cannot change the input level—“VolAdjust” of the FM stations. If the source is FM, “Fix” will appear when you try to adjust it.

General settings — PSM

- “Auto Dimmer” may not work correctly on some vehicles, particularly on those having a control dial for dimming. In this case, change the “Dimmer” setting to any one other than “Auto.”
- If you change the “Amp Gain” setting from “High PWR” to “Low PWR” while the volume level is set higher than “Volume 30,” the unit automatically changes the volume level to “Volume 30.”

Title assignment

- If you try to assign titles to more than 30 station frequencies or 30 discs, “Name Full” appears. Delete unwanted titles before assignment.
- Titles assigned to discs in the CD changer can also be shown if you play back the disc in the unit and vice versa.

Satellite radio operations

- You can also connect the JVC SIRIUS radio PnP (Plug and Play), using the JVC SIRIUS radio adapter, KS-U100K (not supplied) to the CD changer jack on the rear. By turning on/off the power of the unit, you can turn on/off the JVC PnP. However, you cannot control it from this unit.
- To know more about SIRIUS Satellite radio or to sign up, visit <<http://www.sirius.com>>.
- For the latest channel listings and programming information, or to sign up for XM Satellite radio, visit <<http://www.xmradio.com>>.

iPod or D. player operations

- When you turn on this unit, the iPod or D. player is charged through this unit.
- While the iPod or D. player is connected, all operations from the iPod or D. player are disabled. Perform all operations from this unit.
- The text information may not be displayed correctly.
 - Some characters such as accented letters cannot be shown correctly on the display.
 - Depends on the condition of communication between the iPod or D. player and the unit.
- If the text information includes more than 16 characters, it scrolls on the display (see also page 16). This unit can display up to 40 characters.

Notice:

When operating an iPod or a D. player, some operations may not be performed correctly or as intended. In this case, visit the following JVC web site:

For iPod users: <<http://www.jvc.co.jp/english/car/support/ks-pd100/index.html>>

For D. player users: <<http://www.jvc.co.jp/english/car/support/ks-pd500/index.html>>

Troubleshooting

What appears to be trouble is not always serious. Check the following points before calling a service center.

	Symptoms	Remedies/Causes
General	• Sound cannot be heard from the speakers.	• Adjust the volume to the optimum level. • Check the cords and connections.
	• The unit does not work at all.	Reset the unit (see page 3).
	• "Connect Error" appears on the display.	Remove the control panel, wipe the connector, then attach it again (see pages 4 and 26).
	• "Push Reset" appears on the display and the control panel movement is frozen.	Reset the unit (see page 3). If this does not work, check the installation.
FM/AM	• SSM automatic presetting does not work.	Store stations manually.
	• Static noise while listening to the radio.	Connect the antenna firmly.
Disc playback	• Disc cannot be played back.	Insert the disc correctly.
	• CD-R/CD-RW cannot be played back.	• Insert a finalized CD-R/CD-RW.
	• Tracks on the CD-R/CD-RW cannot be skipped.	• Finalize the CD-R/CD-RW with the component which you used for recording.
	• Disc can be neither played back nor ejected.	• Unlock the disc (see page 13). • Eject the disc forcibly (see page 3).
	• Disc cannot be recognized ("No Disc," "Loading Error," or "Eject Error" appears).	Eject the disc forcibly (see page 3).
	• Disc sound is sometimes interrupted.	• Stop playback while driving on rough roads. • Change the disc. • Check the cords and connections.
MP3/WMA playback	• Disc cannot be played back.	• Use a disc with MP3/WMA tracks recorded in the format compliant with ISO 9660 Level 1, Level 2, Romeo, or Joliet. • Add the extension code <.mp3> or <.wma> to the file names.
	• Noise is generated.	Skip to another track or change the disc. (Do not add the extension code <.mp3> or <.wma> to non-MP3 or WMA tracks.)
	• A longer readout time is required ("File Check" keeps flashing on the display).	Do not use too many hierarchies and folders.

	Symptoms	Remedies/Causes
MP3/WMA playback	<ul style="list-style-type: none"> Tracks do not play back in the order you have intended them to play. 	Playback order is determined when the files are recorded.
	<ul style="list-style-type: none"> Elapsed playing time is not correct. 	This sometimes occurs while playing. This is caused by how the tracks are recorded on the disc.
	<ul style="list-style-type: none"> "No Files" appears on the display. 	Insert a disc that contains MP3/WMA tracks.
	<ul style="list-style-type: none"> "Not Support" appears on the display and track skips. 	Skip to the next track encoded in an appropriate format or to the next non-copy-protected WMA track.
	<ul style="list-style-type: none"> "No Music" appears on the display. 	Change the disc that contains MP3/WMA tracks.
	<ul style="list-style-type: none"> Correct characters are not displayed (e.g. album name). 	This unit can only display letters (capital: A – Z, small: a – z), numbers, and a limited number of symbols and special characters (see page 19).
SD card/USB memory playback	<ul style="list-style-type: none"> Noise is generated. 	The track played back is not an MP3/WMA track. Skip to another file. (Do not add the extension code <.mp3> or <.wma> to non-MP3 or WMA tracks.)
	<ul style="list-style-type: none"> "File Check" keeps flashing on the display. 	<ul style="list-style-type: none"> Readout time varies depending on the device. Do not use too many hierarchy and folders. Turn off the power then on again.
	<ul style="list-style-type: none"> "No Files" appears on the display. 	Play a device that contains tracks encoded in an appropriate format.
	<ul style="list-style-type: none"> "Not Support" appears on the display and track skips. 	The track is unplayable.
	<ul style="list-style-type: none"> "Read Failed" appears on the display, then returns to the previous source. 	<ul style="list-style-type: none"> The device may be malfunctioning, or may not have been formatted correctly. The files included in the device are corrupted. Do not pull out or attach the USB memory repeatedly while "File Check" appears on the display.
	<ul style="list-style-type: none"> "SD Loading Error" appears on the display while playing tracks from an SD card. 	Detach the control panel and reinsert the SD card. The control panel goes back to initial position (Angle 1).
	<ul style="list-style-type: none"> While playing a track, sound is sometimes interrupted. 	MP3/WMA tracks have not been properly copied into the device. Copy MP3/WMA tracks again into the device, and try again.
<ul style="list-style-type: none"> Correct characters are not displayed (e.g. album name). 	This unit can only display letters (capital: A – Z, small: a – z), numbers, and a limited number of symbols and special characters (see page 19).	

Continued on the next page

	Symptoms	Remedies/Causes
CD changer	• “No Disc” appears on the display.	Insert a disc into the magazine.
	• “No Magazine” appears on the display.	Insert the magazine.
	• “Reset 8” appears on the display.	Connect this unit and the CD changer correctly and press the reset button of the CD changer.
	• “Reset 1” – “Reset 7” appears on the display.	Press the reset button of the CD changer.
	• The CD changer does not work at all.	Reset the unit (see page 3).
Satellite radio	• “CALL 1-888-539-SIRIUS TO SUBSCRIBE” scrolls on the display while listening to the SIRIUS Satellite radio.	Starts subscribing SIRIUS Satellite radio (see page 20).
	• No sound can be heard. “Channel Updating XX%* Completed” appears on the display.	The unit is updating the channel information and it takes a few minutes to complete.
	• Either “No Signal” or “NO SIGNAL” appears on the display.	Move to an area where signals are stronger.
	• Either “No Antenna” or “CHECK ANTENNA” appears on the display.	Connect the antenna firmly.
	• “Invalid Channel” appears on the display for about 5 seconds, then returns to the previous display while listening to the SIRIUS Satellite radio.	No broadcast on the selected channel. Select another channel or continue listening to the previous channel.
	• “No Name” appears or scrolls on the display while listening to the SIRIUS Satellite radio.	No text information for the selected channel.
	• “----” appears on the display while listening to the XM Satellite radio.	
	• “----” appears on the display for about 2 seconds, then returns to the previous channel while listening to the XM Satellite radio.	Selected channel is no longer available or is unauthorized. Select another channel or continue listening to the previous channel.
	• “OFF AIR” appears on the display while listening to the XM Satellite radio.	Selected channel is not broadcasting at this time.
	• “LOADING” appears on the display while listening to the XM Satellite radio.	Select another channel or continue listening to the previous channel.
• “Reset 08” appears on the display.	The unit is loading the channel information and audio. Text information are temporarily unavailable.	
• Satellite radio does not work at all.	Reconnect this unit and the satellite radio correctly and reset this unit.	

* Changes every 20% of update is completion, (ex. 20%, 40%, 60%).

	Symptoms	Remedies/Causes
iPod/D. player playback	<ul style="list-style-type: none"> The iPod or D. player does not turn on or does not work. 	<ul style="list-style-type: none"> Check the connecting cable and its connection. Update the firmware version. Charge the battery.
	<ul style="list-style-type: none"> Buttons do not work as intended. 	The functions of the buttons have been changed. Press POWER/ATT/ENTER before performing the operation.
	<ul style="list-style-type: none"> The sound is distorted. 	Deactivate the equalizer either on the unit or the iPod/D. player.
	<ul style="list-style-type: none"> “Disconnect” appears on the display. 	Check the connecting cable and its connection.
	<ul style="list-style-type: none"> Playback stops. 	The headphones are disconnected during playback. Restart the playback operation using the control panel (see page 24).
	<ul style="list-style-type: none"> No sound can be heard when connecting an iPod nano. 	Disconnect the headphones from the iPod nano.
	<ul style="list-style-type: none"> No sound can be heard. “ERROR 01” appears on the display when connecting a D. player. 	Disconnect the adapter from the D. player. Then, connect it again.
	<ul style="list-style-type: none"> “No Files” or “No Track” appears on the display. 	No tracks are stored. Import tracks to the iPod or D. player.
	<ul style="list-style-type: none"> “Reset 1” – “Reset 7” appears on the display. 	Disconnect the adapter from both the unit and iPod/D. player. Then, connect it again.
	<ul style="list-style-type: none"> “Reset 8” appears on the display. The iPod’s or D. player’s controls do not work after disconnecting from this unit. 	Check the connection between the adapter and this unit. Reset the iPod or D. player.

- Microsoft and Windows Media are either registered trademarks or trademarks of Microsoft Corporation in the United States and/or other countries.
- SD logo is a trademark.
- iPod is a trademark of Apple Computer, Inc., registered in the U.S. and other countries.

Specifications

AUDIO AMPLIFIER SECTION	Power Output:	20 W RMS \times 4 Channels at 4 Ω and \leq 1% THD+N		
	Signal to Noise Ratio:	80 dBA (reference: 1 W into 4 Ω)		
	Load Impedance:	4 Ω (4 Ω to 8 Ω allowance)		
	Tone Control Range:	Bass:	+6 dB/-10 dB at 30 Hz	
		Tre:	+6 dB/-10 dB at 12 kHz	
	Frequency Response:	40 Hz to 20 000 Hz		
	Level/Impedance:	Line-In:	1.5 V/20 k Ω load (full scale)	
		Line-Out:	5.0 V/20 k Ω load (full scale)	
	Output Impedance:	1 k Ω		
	Subwoofer-Out Level/Impedance:	2.0 V/20 k Ω load (full scale)		
Other Terminals:	LINE IN, CD changer, Steering wheel remote input			
TUNER SECTION	Frequency Range:	FM:	87.5 MHz to 107.9 MHz (with channel interval set to 200 kHz) 87.5 MHz to 108.0 MHz (with channel interval set to 50 kHz)	
		AM:	530 kHz to 1 710 kHz (with channel interval set to 10 kHz) 531 kHz to 1 602 kHz (with channel interval set to 9 kHz)	
	FM Tuner	Usable Sensitivity:	11.3 dBf (1.0 μ V/75 Ω)	
		50 dB Quietening Sensitivity:	16.3 dBf (1.8 μ V/75 Ω)	
		Alternate Channel Selectivity (400 kHz):	65 dB	
		Frequency Response:	40 Hz to 15 000 Hz	
		Stereo Separation:	35 dB	
AM Tuner	Sensitivity/Selectivity:	20 μ V/65 dB		
CD PLAYER SECTION	Type:	Compact disc player		
	Signal Detection System:	Non-contact optical pickup (semiconductor laser)		
	Number of Channels:	2 channels (stereo)		
	Frequency Response:	5 Hz to 20 000 Hz		
	Wow and Flutter:	Less than measurable limit		
	MP3:	Bit Rate:	32 kbps – 320 kbps	
		Sampling Frequency:	MPEG-1:	48 kHz, 44.1 kHz, 33 kHz
			MPEG-2:	24 kHz, 22.05 kHz, 16 kHz
	WMA:	Bit Rate:	8 kbps – 320 kbps	
Sampling Frequency:		48 kHz, 44.1 kHz, 32 kHz		

SD CARD	Format:		FAT 12/16
	Storage:		8 MB – 512 MB
	Playable Audio Format:		MP3/WMA
	MP3:	Bit Rate:	8 kbps – 320 kbps
		Sampling Frequency:	MPEG-1: 48 kHz, 44.1 kHz, 33 kHz MPEG-2: 24 kHz, 22.05 kHz, 16 kHz
	WMA:	Bit Rate:	8 kbps – 192 kbps
Sampling Frequency:		48 kHz, 44.1 kHz, 32 kHz	
USB MEMORY	Format:		FAT 12/16/32
	Storage:		Less than 4 GB (1 partition type)
	Playable Audio Format:		MP3/WMA
	Max. Current:		Less than 500 mA
	MP3:	Bit Rate:	32 kbps – 320 kbps
		Sampling Frequency:	MPEG-1: 48 kHz, 44.1 kHz, 32 kHz MPEG-2: 24 kHz, 22.05 kHz, 16 kHz MPEG-2.5: 12 kHz, 11.025 kHz, 8 kHz
			WMA:
	Sampling Frequency:	8 kHz – 48 kHz	
GENERAL	Power Requirement:	Operating Voltage:	DC 14.4 V (11 V to 16 V allowance)
	Grounding System:		Negative ground
	Allowable Operating Temperature:		0°C to +40°C (32°F to 104°F)
	Dimensions (W × H × D):	Installation Size (approx.):	182 mm × 52 mm × 162 mm (7-3/16" × 2-1/16" × 6-7/16")
		Panel Size (approx.):	188 mm × 58 mm × 11 mm (7-7/16" × 2-5/16" × 7/16")
	Mass (approx.):		1.7 kg (3.8 lbs) (excluding accessories)

Design and specifications are subject to change without notice.

If a kit is necessary for your car, consult your telephone directory for the nearest car audio speciality shop.

Having TROUBLE with operation?

Please reset your unit

Refer to page of How to reset your unit

Still having trouble??

USA ONLY

Call 1-800-252-5722

<http://www.jvc.com>

We can help you!

JVC



EN, SP, FR

© 2006 Victor Company of Japan, Limited

0906DTSMDTJEIN