

SAMSUNG

**Clothes Dryers
Owner's Instructions**

**DV5008J
DV5006
DV5004J
DV5002**



Table of Contents

Safety Instructions	3,4
Installation Instructions	
Ducting Installation instructions	5
Duct length calculations	6
Exhaust directions	6
Special accessory	6
Special installation requirements	7
Electrical power supply	7
Operating Instructions, Tips	
Control panel(DV5008J)	8
Control panel(DV5006)	9
Control panel(DV5004J)	10
Control panel(DV5002)	11
Loading clothes	12
Polyester Knits & Permanent Press Drying Tips	12
Program selecting guide	13
Program chart	14
Drying times	14
Care and Cleaning	
Cleaning the filter	15
Dryer Exterior	15
Dryer Vent	16
Inside the dryer cabinet	16
Problem Solver	
Questions? Use this problem solver	17
Specification	17

Safety Instructions

Read all instructions before using this appliance



Warning - It is extremely important that you read and adhere to the following instructions. Failure to do so could result in bodily injuries and/or property damage due to fire.

• **Use this appliance only for its intended purpose** as described in this

Owner's Manual. This dryer must be:

- Properly installed and located in accordance with the Installation Instructions before it is used.
- Properly grounded to conform with Local Codes. Follow details in Installation Instructions.
- Located where the temperature is above 50°F(10°C) for satisfactory operation of the dryer control system. Do not install or store the dryer where it will be exposed to the weather.
- Connected to a properly rated, protected and sized power supply circuit to avoid electrical overload.
- Vented to the outside to prevent large amounts of moisture and lint from being blown into the room.

Carefully follow the venting details in the Installation Instructions.

Do not repair or replace any part of the appliance or attempt any servicing unless specifically recommended in this Owner's Manual.

When disconnecting this appliance pull by the plug rather than the cord to avoid damage to the cord or junction of cord and plug. Make sure that the cord is located so that it will not be stepped on, tripped over or otherwise subjected to damage or stress.

To Minimize the Possibility of a Fire Hazard

- Do not use heat to dry articles containing rubber, plastic, or similar materials (such as padded bras, tennis shoes, galoshes, bath mats, rugs, bibs, pillows, baby pants, plastic bags, etc.) as these materials may melt or burn. Also, some rubber materials, when heated, can under certain circumstances produce fire by spontaneous combustion.
- Do not store items that may burn or melt (such as clothing, paper material, plastics or plastic containers, etc.) on top of the dryer during operation.
- Garments labeled "Dry Away from Heat" must not be put in your dryer.
- Do not wash or dry articles that have been cleaned in, washed in, soaked in, or spotted with combustible or explosive substances (such as wax, paint, gasoline degreasers, dry-cleaning solvents, kerosene, etc.) which may ignite or explode.
Do not add these substances to the wash water. Do not use these substances around your washer and/or dryer during operation.
- Any article on which you have used a cleaning solvent, or which contains flammable materials (such as cleaning cloths, mops, towels used in beauty salons, restaurants or barber shops, etc.) must not be placed in or near the dryer until all traces of these flammable liquids or solids and their fumes have been removed.
There are many highly flammable items used in homes such as: acetone, de-natured alcohol, gasoline, kerosene, some household cleaners, some spot removers, turpentine, waxes, wax removers and products containing petroleum distillates.

Safety Instructions

- Clean the lint filter before each load to prevent lint accumulation inside the dryer or in the room. **DO NOT OPERATE THE DRYER WITHOUT LINTFILTER IN PLACE.**
- Keep the area around the exhaust opening, and around and underneath your appliances free from the accumulation of combustible materials, such as lint, paper, rags, chemicals, etc.
- Regularly inspect the vent duct to ensure it has not been crushed or otherwise restricted.
- The interior of the dryer cabinet and the exhaust duct connection inside the dryer should be cleaned every 2 to 3 years, or more often if needed, by a qualified service person.

To Minimize the Possibility of Injury

- Never reach into the dryer while the drum is moving. Before loading, unloading or adding clothes, wait until the drum has completely stopped.
- Do not dry fiberglass articles in your dryer. Skin irritation could result from the remaining glass particles that may be picked up by clothing during subsequent dryer uses.
- The laundry process can reduce the flame retardance of some fabrics. To avoid such a result, the garment manufacturer's care instructions should be followed very carefully.
- Close supervision is necessary if this appliance is used in reach of or near children. Do not allow children to play inside, on, or with this appliance or any discarded appliance. Dispose of discarded appliances and shipping or packing materials properly. Before discarding a dryer, or removing from service, remove the door of the dryer compartment.
- Keep all laundry aids (such as detergents, bleaches, fabric softeners, etc.) out of the reach of children, preferably in a locked cabinet. Observe all warnings on container labels to avoid personal injury.
- Keep the floor around your appliances clean and dry to reduce the possibility of slipping.
- To minimize the possibility of electric shock, unplug this appliance from the power supply before attempting any maintenance or cleaning (except the removal and cleaning of the lint filter).
- Do not tamper with the controls.
- Do not operate this appliance if it is damaged, malfunctioning, partially disassembled, or has missing or broken parts, including a damaged cord or plug.
- Never climb on or stand on the dryer.
- **DO NOT** place items exposed to cooking oils in your dryer. Items contaminated with cooking oils may contribute to a chemical reaction that could cause a clothes load to catch fire.

SAVE THESE INSTRUCTIONS

Installation Instructions

DUCTING INSTALLATION INSTRUCTIONS



Installation and service must be performed by a qualified installer or service agency. **IMPORTANT:** Have your dryer installed properly.

NOTE: The **WARNING** and **IMPORTANT** instructions appearing in this manual are not meant to cover all possible conditions and situations that may occur. It must be understood that common sense, caution, and carefulness are factors that **CAN-NOT** be built into the dryer. These factors **MUST BE** supplied by the person(s) installing, maintaining, or operating the dryer.

Failure to install, maintain, and/or operate this machine according to the manufacturer's instructions may result in conditions which can result in bodily injury and/or damage to property.

This dryer comes ready for rear venting.

WARNINGS

- Never use flexible duct inside the dryer.
- Do not terminate ducting in a chimney, range hood, gas vent, floor or attic space. The combination of lint and grease could create a fire hazard or cause damage.
- Provide an access for inspection and cleaning the exhaust system at least once a year.

EXHAUST LENGTH

The **MAXIMUM ALLOWABLE** length of the ducting depends upon the type of duct, number of turns, the type of external venting point, and all conditions noted below. The maximum allowable length for both rigid and flexible metal ducting is shown in table 1 (next page). More than four 90° turns is not recommended.

VENTING CHECK LIST - HOOD or WALL CAP

- Terminate ducting in a manner to prevent back drafts, entry of birds or other wildlife.
- Termination should present minimal resistance to the exhaust air flow and should require little or no maintenance to prevent clogging.
- Wall caps must be installed at least 300 mm (12") above ground level or any other obstruction with the opening pointed down.
- If roof vents or louvered plenums are used, they must be equivalent to a 100 mm (4") wall cap with damper, in regard to resistance to air flow, prevention of back drafts and maintenance required to prevent clogging.

SEPARATION OF TURNS

Separate all turns by at least 1m(3ft.) of straight duct, including distance between last turn and dampered wall cap. If two turns must be closer than 1 m (3 ft.) deduct 3 m (10 ft.) from the maximum lengths shown in the table for each occurrence.

TURNS OTHER THAN 90°

- One turn of 45° or less may be ignored.
- Two 45° turns should be treated as one 90°.
- Each turn over 45° should be treated as one 90°.

SEALING OF JOINTS

- All joints should be tight to avoid leaks. The male end of each section of duct must point away from the dryer.
- Do not assemble the duct work with fasteners that extend into the duct. They will serve as a collection point for lint.
- Duct joints can be made air and moisture-tight by wrapping the overlapped joints with duct tape.

INSULATION

- Duct work which runs through an unheated area or is near an air conditioning duct, should be insulated to reduce condensation and lint build up and be sloped down toward outdoors.



NOTE: Never install screen inside exhaust duct.

WARNING: THE DRYER MUST VENT TO THE OUTDOORS. TO PREVENT LARGE AMOUNTS OF LINT AND MOISTURE FROM ACCUMULATING AND TO MAINTAIN DRYING EFFICIENCY, THIS MACHINE MUST BE VENTED OUTDOORS.

Installation Instructions

DUCT LENGTH CALCULATION

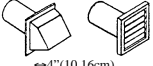
Table 1: RECOMMENDED MAXIMUM LENGTH

ELECTRIC DRYERS				
Weather Hood Type				
Recommended			Use only for short run installations	
 ↔4" (10.16cm)			 ↔2 1/2" (6.35cm)	
No. of 90° elbows	Rigid	Metallic Flexible*	Rigid	Metallic Flexible*
0	14m(46ft.)	9m(30ft.)	11m(37ft.)	7m(24ft.)
1	11m(38ft.)	7.5m(25ft.)	9m(30ft.)	6m(20ft.)
2	9m(31ft.)	6m(20ft.)	6.5m(22ft.)	4m(14ft.)
3	7m(24ft.)	5m(16ft.)	4.5m(15ft.)	3m(10ft.)

* Do not use non metallic flexible duct.



SPECIAL ACCESSORY

Stacking kit(Model no:SK-2)

You can obtain the stacking kit from your retailer.

With this kit you can combine your dryer with a Samsung automatic washing machine to create a washing/drying column.

The appliances are stacked in a space-economizing manner in this arrangement, the washing machine at the bottom and the dryer at the top!

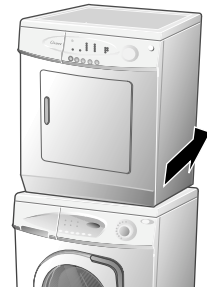

Installation Instructions

SPECIAL INSTALLATION REQUIREMENTS

ALCOVE OR CLOSET INSTALLATION

- **WARNING:** To reduce the risk of fire, this dryer **MUST BE VENTED TO THE OUTDOORS**. See the **VENTING INFORMATION** section.
- The minimum clearances between dryer cabinet and adjacent walls or other surfaces are : 0" either side 1" front and rear
- The minimum vertical space from floor to overhead cabinets, ceilings, etc. is 52"(132cm).
- The closet door must be louvered or otherwise ventilated and must contain a minimum of 60 sq. in. of open area equally distributed. If this closet contains both a washer and a dryer, doors must contain a minimum of 120 sq. in. of open area equally distributed.

MINIMUM CLEARANCES OTHER THAN ALCOVE OR CLOSET INSTALLATIONS.

- Minimum clearances to combustible surfaces: 0 clearance both sides and 25 mm (1") rear.

NOTE: CONSIDERATION MUST BE GIVEN TO INSTALLING AND SERVICING THE APPLIANCE.

ELECTRICAL POWER SUPPLY

CAUTION: NEVER USE AN EXTENSION CORD WITH THIS APPLIANCE.

- This dryer must be connected to an individual circuit identical to the one specified on the rating plate of the loading port, protected by fuses or circuit breaker conforming to local codes. **THIS APPLIANCE MUST BE PROPERLY GROUNDED.**

GROUNDING INSTRUCTIONS

- This appliance must be grounded. In the event of malfunction or breakdown, grounding will reduce the risk of electric shock by providing a path of least resistance for electric current. The plug must be plugged into an appropriate outlet that is properly installed and grounded in accordance with all local codes and ordinances.

WARNING:

- Improper connection of the equipment grounding conductor can result in a risk of electric shock. Check with a qualified electrician or serviceman if you are in doubt as to whether the appliance is properly grounded.
- Do not modify the plug provided with the appliance - if it will not fit the outlet, have a proper outlet installed by a qualified electrician.

Operating Instructions, Tips

Control panel (DV5008J)

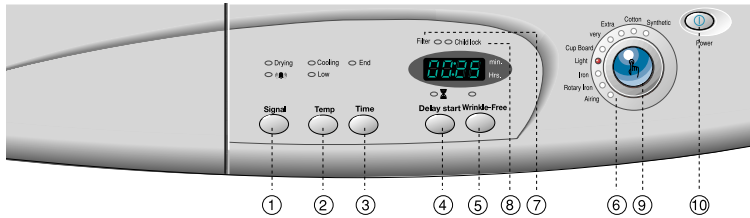

1. The SIGNAL button

Set to OFF at the factory. When switched on, a buzzer sounds when the current program has finished. Push the SIGNAL button once to turn on and again to turn off. The indicator labelled with a bell symbol will light when this feature is switched on.

2. The TEMPERATURE button

Set to OFF at the factory. Used to switch the drying temperature from high to low. Push the button once to set to low and again to set back to high. The LOW lamp will illuminate when switched on.

3. The TIME button

When pressed, the timer displays 90(1:30) minutes. By pressing the button, you can reduce the setting by 10 minutes with each press to a minimum of 20 minutes when the time returns to 90 mins. (1:30 → 1:20 → 1:10 → 1:0030 → 20 → 1:30)

4. The DELAYSTART button (and on/off indicator)

This allows you to delay the start of the selected dryer program in increments of 1 hour for each press. (1 hour → 2 hours → 3 hours → 24 hours → Cancel.)

5. The Wrinkle-Free button (and on/off indicator)

Pushing the Wrinkle-Free button, ends the drying program and switches the machine to the COOL DOWN program. This reduces the drying temperature over 10 minutes and then runs for 10 mins at air temperature.

6. Pre-programmed drying times selection

This allows the user to select from a number of pre-set commonly used drying programs. Rotate the selector knob to illuminate the lamp next to the required program insuring that the Synthetic or Cotton lamp is also lit, depending on the type of fabric to be dryer. Please refer to the Program Chart on page 14 of this details manual for more on Loads, temperature and drying times for each program.

7. The FILTER indicator

At switch on, the filter indicator will flash 3 times. When a drying cycle is finished, this indicator will light to remind you that you should clean the filter after each use. Please refer to the Filter cleaning instruction.

8. The CHILD LOCK indicator

With this feature switched on, all the function buttons on the front panel are disabled. To enable, you have to press the WRINKLE-FREE and DELAY START buttons in order. To indicate the CHILD LOCK is set, the indicator will light. To switch it off again, push the DELAY START button and WRINKLE-FREE buttons in order, the indicator will be extinguished when disabled.

9. The START/PAUSE button

Pressing the blue button in the centre of the program selection knob starts and pauses the dryer. If you open the door the machine is paused and you must press this button to continue the program.

10. The POWER button

This button is used to switch the unit on and off. If the dryer is left on for more than 10 minutes without any key-presses or programs running, it will automatically power the unit down.

Operating Instructions, Tips

Control panel (DV5006)

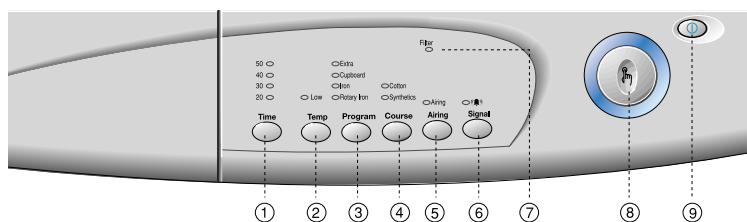

1. The TIME button

When pressed, indicators light up to indicate the running time. Initially the 50 indicator is lit up, then with each press time reduces by 10 mins and the indicators light (eg: 50 minutes → 40 minutes → 30 minutes → 20 minutes → 50 minutes.)

2. The TEMPERATURE button

Set to OFF at the factory. Used to switch the drying temperature from high to low. Push the button once to set to low and again to set back to high. The LOW lamp will illuminate when switched on.

3. The PROGRAM button

This allows the user to select from a number of pre-set commonly used drying programs. When first pressed, the CUPBOARD setting is selected, pushing the PROGRAM button change the selection as follows: Cupboard → Iron → Rotary Iron → Extra → Cupboard

4. The COURSE button

When first switched on, the COTTON setting is selected. Pushing the button toggles the setting as follows: Cotton → Synthetic → Cotton

5. The AIRING button

When pressed, not only is the airing feature enabled but the 50 minute time light is illuminated. This is because the feature runs the dryer in cool mode (no heat) for 50 minutes. The running time can be altered by pressing the time button. Each press changes the time setting as follows: 50 minutes → 40 minutes → 30 minutes → 20 minutes → 50 minutes

6. The SIGNAL button

Set to OFF at the factory. When switched on, a buzzer sounds when the current program has finished. Push the SIGNAL button once to turn on and again to turn off. The indicator labelled with a bell symbol will light when this feature is switched on.

7. FILTER lamp

At switch on, the filter indicator will flash 3 times. When a drying cycle is finished, this indicator will light to remind you that you should clean the filter after each use. Please refer to the Filter cleaning instruction.

8. START/PAUSE button

Pressing the blue button in the centre of the program selection knob starts and pauses the dryer. If you open the door the machine is paused and you must press this button to continue the program.

9. POWER button

This button is used to switch the unit on and off. If the dryer is left on for more than 10 minutes without any key-presses or programs running, it will automatically power the unit down.

Operating Instructions, Tips

Control panel (DV5004J)

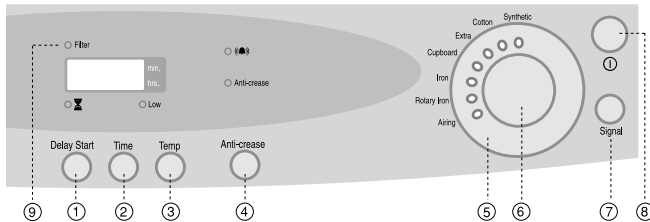

1. The DELAY START button (and on/off indicator)

This allows you to delay the start of the selected dryer program in increments of 1 hour for each press. (1 hour→2→hours →3 hours ... →24 hours →Cancel.)

2. The TIME button

When pressed, the timer displays 50 minutes. By pressing the button, you can reduce the setting to a minimum of 20 minutes when the time jumps to 100(1:40) mins and steps down to 50 mins.

3. The TEMPERATURE button

Set to OFF at the factory. Used to switch the drying temperature from high to low. Push the button once to set to low and again to set back to high. The LOW lamp will illuminate when switched on.

4. The ANTI-CREASE button

Pushing the ANTI-CREASE button, ends the drying program and switches the machine to the COOL DOWN program. This reduces the drying temperature over 15 minutes and then runs for 10 mins at air temperature.

5. Pre-programmed drying times selection

This allows the user to select from a number of pre-set commonly used drying programs. Rotate the selector knob to illuminate the lamp next to the required program insuring that the Synthetic or Cotton lamp is also lit, depending on the type of fabric to be dryer. Please refer to the Program Chart on page 14 of this manual for more details on Loads, temperature and drying times for each program.

6. The START/PAUSE button

Pressing the blue button in the centre of the program selection knob starts and pauses the dryer. If you open the door the machine is paused and you must press this button to continue the program.

7. The SIGNAL button

Set to OFF at the factory. When switched on, a buzzer sounds when the current program has finished. Push the SIGNAL button once to turn on and again to turn off. The indicator labelled with a bell symbol will light when this feature is switched on.

8. The Power button

This button is used to switch the unit on and off. If the dryer is left on for more than 10 minutes without any key-presses or programs running, it will automatically power the unit down.

9. The FILTER indicator

At switch on, the filter indicator will flash 3 times. When a drying cycle is finished, this indicator will light to remind you that you should clean the filter after each use. Please refer to the Filter cleaning instruction.

Operating Instructions, Tips

Control panel (DV5002)

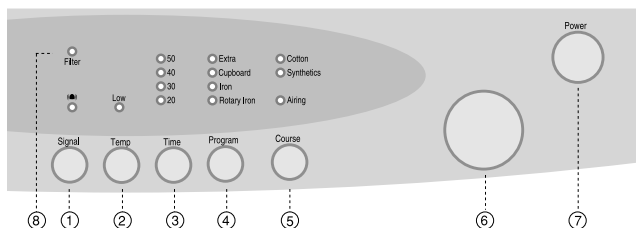

1.The SIGNALbutton

Set to OFF at the factory. When switched on, a buzzer sounds when the current program has finished. Push the SIGNAL button once to turn on and again to turn off. The indicator labelled with a bell symbol will light when this feature is switched on.

2.The TEMPERATURE button

Set to OFF at the factory. Used to switch the drying temperature from high to low. Push the button once to set to low and again to set back to high. The LOW lamp will illuminate when switched on.

3.TIME button

When pressed, indicators light up to indicate the running time. Initially the 50 indicator is lit up, then with each press the time reduces by 10 mins and the corresponding indicators light (eg: 50 minutes → 40 minutes → 30 minutes → 20 minutes → Cancelled → 50 minutes.)

4.PROGRAM button

This allows the user to select from a number of pre-set commonly used drying programs. When first pressed, the EXTRA setting is selected, pushing the PROGRAM button change the selection as follows: (EXTRA → CUPBOARD → IRON → ROTARYIRON)

5.COURSE button

When first switched on, the COTTON setting is selected. Pushing the button toggles the setting as follows: (COTTON → SYNTHETIC → AIRING) The COURSE button is used in conjunction with the PROGRAM button to select the required pre-set drying program. With AIRING selected, the 50 minute time light is illuminated. This is because the feature runs the dryer in cool mode (no heat) for 50 minutes. The running time can be altered by pressing the time button. Each press changes the time setting as follows: (50 minutes → 40 minutes → 30 minutes → 20 minutes)

6.Start/Pause button

Pressing the blue button in the centre of the program selection knob starts and pauses the dryer. If you open the door the machine is paused and you must press this button to continue the program.

7. Power button

This button is used to switch the unit on and off. If the dryer is left on for more than 10 minutes without any key-presses or programs running, it will automatically power the unit down.

8.FILTER lamp

FILTER lamp turns ON to display cleaning of the filter. Open door or turn the system OFF to turn FILTER lamp OFF.

Operating Instructions, Tips

LOADING CLOTHES

- **Preparing Laundry**

Check that all fastenings are closed and that pockets are empty.
Place laundry loosely in the drum to make sure that they don't get tangled.

- **Sort laundry as follows (Examples)**

As a general rule, sort clothes by surface texture, fabric, color and weight, as you would for your washer.

By care symbols

- Suitable for tumble drying
- Tumble drying at low temperature only
- Do not tumble dry

By amount and weight

Lightweight fabrics dry faster than heavyweight fabrics. If mixed loads are dried together (such as sheets and towels), remove the lighter weight fabrics to prevent over drying and wrinkling.

Whenever the load is bigger than the dryer capacity, separate laundry according to weight. (ex, towels from thin underwear)

By type of fabrics

Cotton/Linen : Made of cotton or linen

Synthetics : Made of polyester or polyamide as well as for cotton/synthetic mixes.

Delicates : Sensitive fabrics

By drying level

Extra dry, cupboard dry, iron dry, etc.

- **Do not tumble dry the following items :**

woolens, silk, delicate fabrics, nylon stocking, delicate embroidery, fiberglass items, rubber-coated items, plastics, items with plastic trim, foam-filled items, items with metallic decorations and bulky items such as sleeping bags, etc
- Clothing with metallic components may damage the drum interior during drying.

- **Do not overload.**

Excessive loads don't dry efficiently and cause wrinkling.

- **Do not add fabric softener sheets once the load has become warm.**

Polyester Knits & Permanent Press Drying Tips

- **DO NOT OVERLOAD-** Garments being dried or de-wrinkled should tumble freely.
- **REMOVE CLOTHES PROMPTLY-** To help prevent wrinkling, remove clothes from the dryer promptly at the end of the drying cycles.
- **PLACE ON HANGERS-** Permanent press and polyester knit garments look best if placed on hangers after drying.

PROGRAM SELECTING GUIDE

Operating Instructions, Tips

Programs		Max. Load	Laundry Type	Example for
Cotton	Extra	5kg	Heavy weight or mult-layered fabrics	Track suits, Towelling materials, bath robes
	Very		Fabrics of medium weight, articles not made up of mult-layers	Jeans, Towel laundry, hand towels
	Cupboard		Normal cotton and linen articles	Sheets, and pillowcase, tablecloths, cotton trousers
	Light		lightweight materials	Cotton shirt and underwear
	Iron		Cotton and linen articles to be ironed.	Tablecloths and shirts
	Rotary Iron		For leaving items partially damp	Cotton underwear
Synthetic	Extra	2.5kg	Heavyweight or mult_layered fabrics	Sweatshirts, bed linen and table linen
	Very		Fabrics of medium weight	Easycare fabric shirts, baby clothes and wool
	Cupboard		Normal synthetic fabrics	Delicate dresses, skirts, shirts
	Light		Lightweight materials	Blouses, dress shirts
	Iron		Very delicate fabrics	Easy care fabric and blouses
	Rotary Iron		For leaving items partially damp	Delicate underwear

Operating Instructions, Tips

PROGRAM CHART

Programs		Max. Load	Low Temp Select	Delay Start	Heating Control (Heater Turn Off)	Estimated Time(3.6kg)	Remark
Cotton	Extra	5kg	High/Low	o	50 ± 5°C	1 : 50	
	Very			o	48 ± 5°C	1 : 45	DV5008J
	Cupboard			o	47 ± 5°C	1 : 40	
	Light			o	45 ± 5°C	1 : 35	DV5008J
	Iron			o	43 ± 5°C	1 : 10	
	Rotary Iron			o	39 ± 5°C	1 : 00	
Synthetic	Extra	2.5kg	Low	o	47 ± 5°C	1 : 20	
	Very			o	46 ± 5°C	1 : 15	DV5008J
	Cupboard			o	41 ± 5°C	1 : 10	
	Light			o	40 ± 5°C	1 : 05	DV5008J
	Iron			o	49 ± 5°C	1 : 00	
	Rotary Iron			o	38 ± 5°C	50	
Wrinkle-Free		2.5kg	x	x	35 ± 5°C	20	
Time Dry		5kg	High/Low	x	50 ± 5°C	1: 30 ~ 20	DV5008J
		5kg				50 ~ 20	DV5006
Aring		5kg	x	x	No Heating	50 ~ 20	

Drying Times

It is impossible to give exact drying times. Conditions from home to home vary and directly affect drying times. The length of time it takes to dry loads will depend on several things.

- Load Size
- Type of fabric, washer, and spin speed will determine moisture in the fabric.
- Heat and moisture in the room. Damp air coming into the dryer will increase drying time.
- Installation (Length of exhaust duct, etc)
- Electric voltage.

If you select an automatic cycle, the machine will determine the time needed for drying. During the DRYcycle, the remaining time may be increased or decreased in order to optimize dryness.

Care and Cleaning

Cleaning the filter

Clean the filter before every use

Slide the grid out as shown

Clean the lint filter.

Put your moistened fingers at one corner of the filter and wipe in a sideways motion all the way across to the other corner.

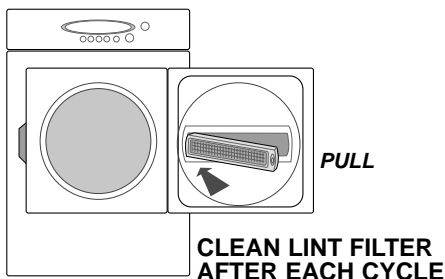

Do not operate the dryer without the grid in place.

Do not operate the dryer without the filter in place.

Periodically, remove the lint filter (it snaps in and out) and insert the suction hose adapter from your vacuum cleaner into the opening.

Do the same through the rectangular opening at top or bottom of the door and at the louvers on the cabinet front.

Dryer Exterior

Wipe off any spills or washing compounds. Wipe or dust with a damp cloth. Try not to strike the surface with sharp objects.

Dryer control panel and finishes may be damaged by some laundry pre-treatment soil and stain removing products. If such products are sprayed on or have direct contact with the dryer, wipe the surface with a damp cloth.

Apply these pre-treatment products away from the dryer. The fabric may then be washed and dried normally. Damage to your dryer caused by pre-treatment products is not covered by your warranty.

Care and Cleaning

DRYER Vent

MAXIMIZE YOUR DRYER EFFICIENCY BY KEEPING THE DUCTING CLEAN.

1. Disconnect or Turn off the electrical power.
2. Disconnect the ducting from the dryer.
3. Clean the ducting from the end where the dryer is connected using:
 - the hose attachment of your vacuum cleaner
 - a duster attached to a pole (for straight stretches) or to a drain cleaning wire (for less accessible areas).
4. Inspect the wall vent and check that there is sufficient possible air flow. Check that:
 - the flap can move freely (use a mirror if difficult to see)
 - the flap is fully open when the dryer is running
 - no wildlife (birds, insects,...) have nested inside the ducting.

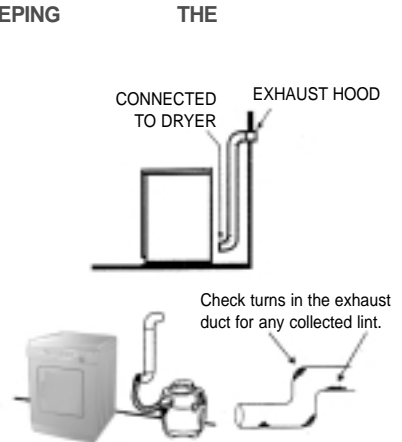

INSIDE THE DRYER CABINET

CLEANING LINT FROM YOUR DRYER

Combustible lint may collect on the inside of the dryer cabinet.

CLEAN EVERY 2 TO 3 YEARS OR MORE OFTEN DEPENDING ON USAGE.

Cleaning should only be undertaken by a qualified service person.

ALWAYS VERIFY PROPER OPERATION AFTER SERVICING

PROBLEM SOLVER

PROBLEM	POSSIBLE CAUSE
DRYER WON'T START	<ul style="list-style-type: none"> • Dryer unplugged. Make sure power cord is plugged in. • No power to dryer. Check fuses and circuit breakers to make sure dryer is getting current. Most electric dryers have two fuses so make sure you check both. • Controls improperly set. Make sure the controls are set correctly and that the Start button is pressed. Opening the door during operation stops the dryer. To restart, close the door and push the Start button. • Dryer door is open. Close door securely - dryer will not run with the door open. • Circuit is overloaded. Do not operate other appliances on the same electrical outlet or circuit while the dryer is in use.
CLOTHES TAKE TOO LONG TO DRY	<ul style="list-style-type: none"> • Controls improperly set. Check all controls to make sure they are correctly set for the load you want to dry. See the How to Operate Your Dryer section, as well as the Care and Cleaning section. • Clogged lint filter. Clean the filter before every load. Periodically remove lint filter and clean area under it with vacuum cleaner. • Improper ducting. Make sure dryer is ducted in accordance with the Installation Instructions. • Obstruction in exhaust ducting. Make sure ducting is clean and free of obstruction; make sure that the flap on the outside wall operates easily. If flexible ducting is used, be sure it is not kinked and is properly installed according to the Installation Instructions. • Blown fuses or tripped circuit breakers. Check household fuses or circuit breakers. Most electric dryers have two fuses. It is possible for one to be blown or tripped and the dryer still tumbles but with no heat. • Mixed loads. Do not mix heavy or hard-to-dry items with lightweight articles. • Large loads of moisture-holding fabrics, such as beach towels, can take a long time to dry. • Too many items in dryer. Dry only one washer load at a time. Do not combine loads. • Too few items in dryer. If drying only one article, add two more similar articles, even if dry, to ensure proper tumbling.
SHRINKAGE, GENERAL	<ul style="list-style-type: none"> • Some fabrics will shrink whether machine washed and tumble dried or washed by hand and drip dried; others may be safely washed but will shrink in a dryer. Follow Garment Manufacturers' Care Labels exactly. If in doubt, do not machine wash or tumble dry.
WRINKLING	<ul style="list-style-type: none"> • Leaving clothes in dryer after tumbling stops. Remove clothes promptly and hang them immediately. • Improper loads. Avoid laundering heavy Permanent Press items, such as work clothes, with lighter Permanent Press items, such as shirts or blouses. Do not wash or dry Permanent Press with regular laundry. • Failure to use fabric softener. Proper use of fabric softener will minimize wrinkling.
TO REMOVE WRINKLES	<p>Try one or more of these suggestions</p> <ul style="list-style-type: none"> • If unsuccessful, re-tumble on high heat for 10-12 minutes and hang immediately • Iron carefully • Send to dry cleaners for pressing • Some wrinkles may remain which cannot be removed.*

IF DRYER STILL DOES NOT OPERATE, call for Service. GIVE THE MODEL AND SERIAL NUMBERS AND DESCRIBE THE SYMPTOMS OF THE DRYER.

SPECIFICATION

Type	Tumble Dryer (Vented Dryer)	
Dimension	W598 x D550 x H844 mm	
Weight	35kg	
Heater Rating	2000W (240V)	
Power Consumption	220V~240V(50Hz)	1900W~2200W

IN CASE THE NEED FOR
SERVICING ARISES

-Don't hesitate to call any AS center nearby with your name, address and telephone number when anything wrong with your product occurs.

