



# User's Guide

## Series 1860

- Safety
- Assembly
- Operation
- Storage
- Maintenance
- Troubleshooting

Thanks for buying a BISSELL Steam 'n Clean™ Hand Held Steam Cleaner.

We're glad you purchased a BISSELL Steam 'n Clean. Everything we know about home care went into the design and construction of this handy, high-tech home cleaning and sanitizing system.

Your Steam 'n Clean is well made, and we back it with a full one-year warranty. We also stand behind it with a knowledgeable, dedicated Consumer Service department, so, should you ever have a problem, you'll receive fast, considerate assistance.

My great-grandfather invented the floor sweeper in 1876. Today, BISSELL is a global leader in the design, manufacture, and service of high quality homecare products like your Steam 'n Clean.

Thanks again, from all of us at BISSELL.

*Mark J. Bissell*

Mark J. Bissell  
President and Chief Executive Officer



## IMPORTANT SAFETY INSTRUCTIONS

**When using an electrical appliance, basic precautions should be observed, including the following:**

**READ ALL INSTRUCTIONS BEFORE USING YOUR STEAM 'N CLEAN.**

**⚠ WARNING:** To reduce the risk of fire, electric shock, or injury:

- Do not direct steam at people, animals, or at electrical outlets
- Do not expose to rain
- Store indoors
- Use only extension cords UL-rated at 15 amperes
- Unplug from outlet when not in use and before conducting maintenance or troubleshooting
- Do not leave steam cleaner unattended
- Do not leave the steam cleaner connected to an electrical outlet when not in use
- Do not switch the steam cleaner on or attempt to use without water in the tank
- Do not service steam cleaner when it is plugged in
- Do not use with damaged cord or plug
- Do not use steam cleaner if it has been dropped, damaged, left outdoors or dropped into water
- Do not handle steam cleaner with wet hands
- Do not pull or carry by cord, use cord as a handle, close door on cord, pull cord around sharp corners or edges, or expose cord to heated surfaces
- Do not unplug by pulling on cord
- Do not put any object into appliance openings, use with blocked opening, or restrict air flow
- Do not use appliance in an enclosed space filled with vapors given off by oil base paint, paint thinner, some moth proofing substances, flammable dust, or other explosive or toxic vapors
- Do not allow to be used as a toy
- Do not use on leather, wax polished furniture or floors, synthetic fabrics, velvet or other delicate, steam-sensitive materials

- Do not use for any purpose other than described in this User's Guide
- Use only manufacturer's recommended attachments - use of attachments not provided or sold by BISSELL may cause fire, electric shock or injury
- Fill with cool water only — do not add anything except cool water or you will cause damage to the heating element and void your warranty
- Turn off before unplugging
- Unplug by grasping the plug, not the cord
- Pay close attention when working around children

**SAVE THESE INSTRUCTIONS.**

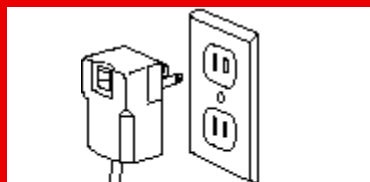

To reduce the risk of electric shock, this appliance has a polarized plug (one blade is wider than the other). This plug will fit in a polarized outlet only one way. If the plug does not fit fully in the outlet, reverse the plug. If it still does not fit, contact a qualified electrician to install a proper outlet. Do not change the plug in any way.

### INSTRUCTIONS FOR CIRCUIT INTERRUPTING DEVICE

This appliance is equipped with a Circuit Interrupting Device (C.I.D.) The C.I.D. shuts off the unit in potentially hazardous situations. The C.I.D. has Test (Yellow) and Reset (Red) buttons which should be operated each time the unit is plugged in.

**⚠ WARNING:** No plug adapter should be used with this appliance.

**This model is for household use only.**

**⚠ CAUTION:** To reduce risk of injury from steam, never point product at people, animals or electrical outlets.

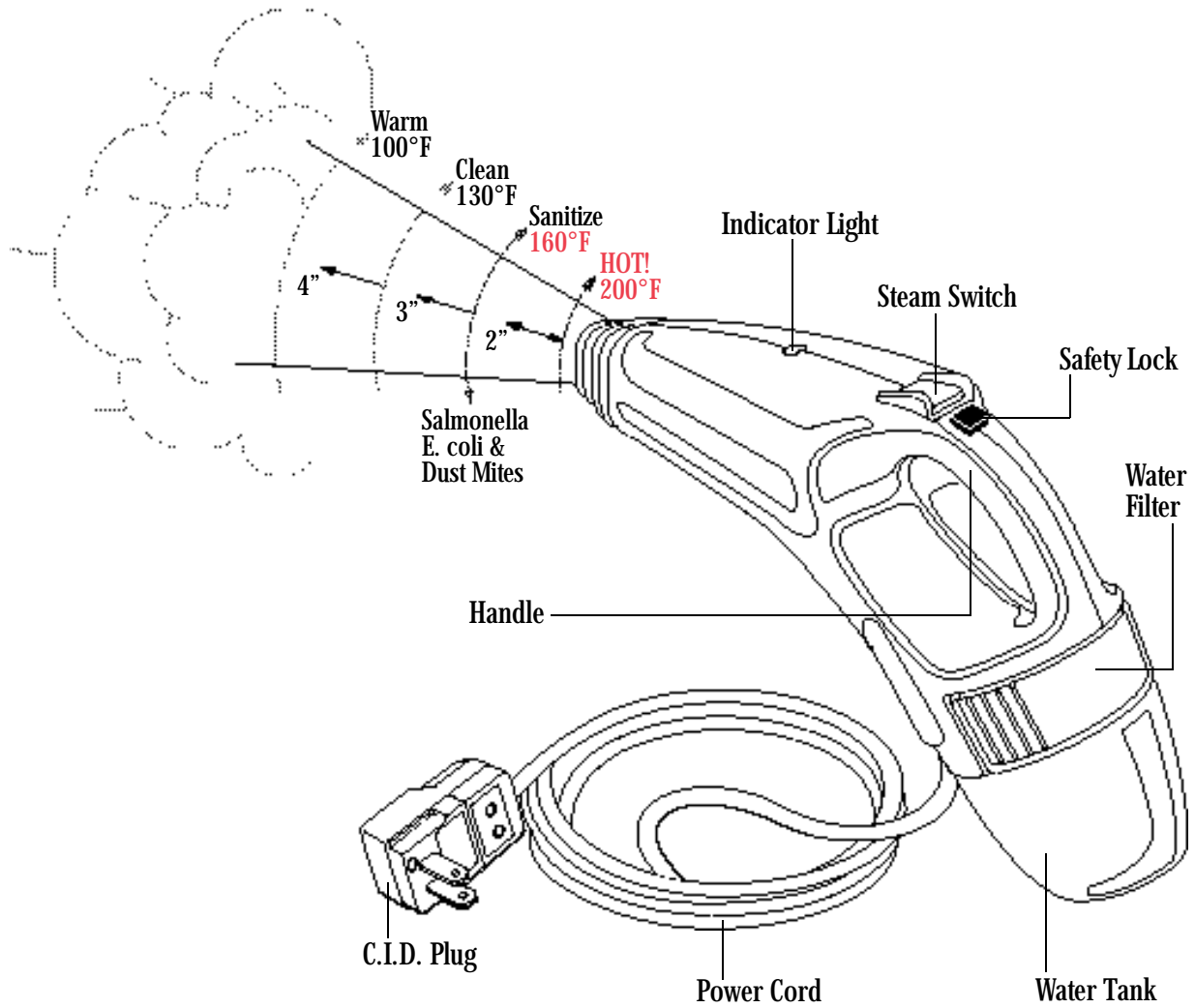

**⚠ CAUTION:** Do not add anything except cool water or you will cause damage to the heating element and void your warranty.

## How to use this guide

This User's Guide has been designed to help you get the utmost satisfaction from your Steam 'n Clean hand-held steam cleaner. You'll find assembly instructions for all cleaning tasks, safety precautions, pre-cleaning tips, maintenance and troubleshooting instructions. Please read this Guide thoroughly

before using your steam cleaner. Pay particular attention to the parts diagram, assembly instructions, and part names. Familiarize yourself with the tools and how they're used. Following the Guide will greatly enhance your ability to get the best performance from your Steam 'n Clean for many years.

Your Steam 'n Clean comes assembled and ready to use. The drawing on page 3 and part names may come in handy should you need to order a part.

## How to fill prior to sanitizing

### Water Tank

The Water Tank is the translucent tank at the end of the Steam 'n Clean.

1. Remove the Tank by unscrewing it from the handle in a counter clockwise motion.
2. Remove the Water Fill Cap by unscrewing it from the Water Tank in a counter clockwise motion.
3. Remove the Cap and the attached water tube and siphon.
4. Fill Water Tank completely with cool tap water,\* insert water tube/siphon, and replace Water Fill Cap, turning in a clockwise motion until snug.
5. Reattach Water Tank by turning in a clockwise motion until snug.

\*NOTE: You may substitute distilled or demineralized water for tap water. Doing so may reduce the need to change the Water Filter to just once a year.

**Do not add anything except cool water or you will cause damage to the heating element and void your warranty.**

### Water Filter

This filter removes minerals and other impurities from tap water, preventing water deposits from damaging your Steam 'n Clean. It should be replaced when the bright green grains turn dark blue in the whole filter except the last strip.

### Power Cord

Unwrap Power Cord [with C.I.D. plug] completely before operating unit.

### Indicator Light

This will glow to indicate when tap water has been converted to steam, and machine is ready to use.

### Safety Lock

Slide forward to lock the Steam Switch OFF when the Steam 'n Clean is plugged in but not in immediate use. When ready to use, slide back to activate the Steam Switch.

### Steam Switch

Push to release steam. To lock steam on, hold steam switch down while sliding safety lock forward to locking position.

### Safety Valve

Your steam cleaner is equipped with a **safety valve** which will open if the steam nozzle is blocked. When the safety valve opens, water will be released from the small outlet hole at the bottom of the unit (below the handle). If release continues, turn off your steam cleaner, empty the Water Tank and call

**BISSELL Consumer Services**  
**1-800-237-7691**

for repair/return instructions.



## CAUTION:

Before disconnecting a tool from the steam cleaner, make certain that steam is no longer coming from the nozzle. Use an oven mitt to remove tools, or wait until they cool before removing.

All tools attach the same way. Align the two tabs on the tool you choose with the two notches in the nozzle. Insert tabs into notches completely, then turn the tool a half rotation clockwise until it locks. Always check to make certain the tool is fitted firmly before using.

## Tools your Steam 'n Clean is equipped with:

**A 2-position Steam Applicator** — this tool has two positions. Use the compressed or 'short' position for concentrated steam and the extended or 'long' position for diffused steam.



**A Curved Steam Jet** — concentrates steam to clean and sanitize small, hard to reach areas, or for intense steam cleaning of stubborn soil.



**Steam Brushes** — attach to the end of the Steam Concentrator for scrubbing stubborn soil. Color-coded for your specific use.



**A Glass Cleaning Scrubber/Squeegee** — for cleaning windows and other large glass surfaces.

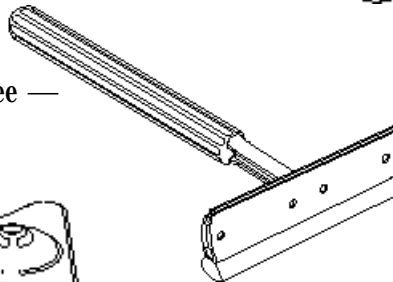

**A Triangle Steam Brush**

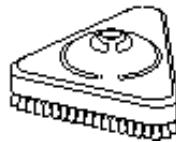

## Index

Safety instructions . . . . .	2
Product view . . . . .	3
How to fill prior to sanitizing . . . . .	4
Index . . . . .	5
Tools . . . . .	5
Steam cleaning hard surfaces . . . . .	6
Killing dust mites . . . . .	7
Steam sanitizing hard surfaces . . . . .	7
Steaming/freshening clothes . . . . .	7
When you're done . . . . .	8
Maintenance . . . . .	8
Troubleshooting . . . . .	9
Replacement parts . . . . .	9
Warranty . . . . .	10
Consumer services . . . . .	10

## Sanitizing and cleaning throughout your home

Your BISSELL Steam 'n Clean steam cleaner can help make your home a cleaner, safer place to live. The high temperature "dry" steam destroys germs, mold and mildew on hard surfaces in every living area of your home. Proper application of steam kills germs like E. coli, and Salmonella choleraesuis.



**CAUTION:** Keep face and all exposed skin away from steam. Failure to do so may result in personal injury.

# Steam cleaning hard surfaces

## All living areas

Stubborn soil that resists traditional hot water, cleaning solutions and vigorous scrubbing can often be effectively removed with high temperature steam. Baked-on-grease on the stovetop, dried fruit juice in the refrigerator, mildew or stubborn soap scum on sliding shower doors, gum on countertops — steam makes all these far easier to clean. Use your Steam 'n Clean to soften and remove stubborn dirt, grime, dry, hardened food, and other household soil from hard surfaces. You can also use your steam cleaner to clean and sanitize pet cages.\*

\*NOTE: Always remove pets before cleaning.

1. Fill the Water Tank with cool tap water or distilled/demineralized water.
2. Connect the C.I.D. plug to an appropriate outlet.
3. Attach tool. For large surface sanitizing, such as countertops, basins and sinks, use the 2-Position Steam Applicator. For smaller areas, use the Steam Jet with/without the Steam Brush.
4. When green indicator light glows, slide Safety Lock back and press Steam Switch to release steam. Steam continues to come out of the tool while switch is pressed.
5. Wipe surface with a clean, dry cloth.

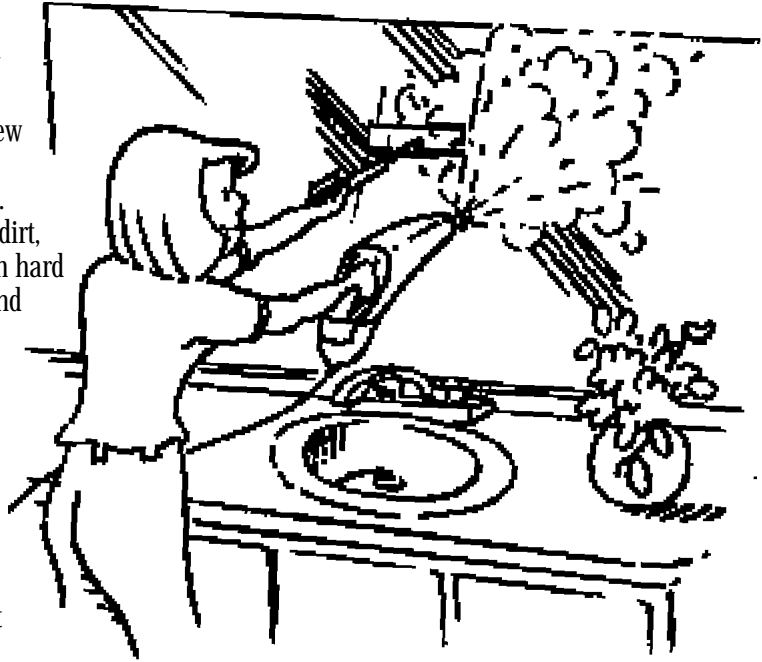

## CAUTION:

Thermal shock can shatter glass. Before cleaning cold glass surfaces, carefully warm the surface by directing the steam jet on the glass from a distance of no less than 4 - 6".

## Cleaning glass surfaces

Steam 'n Clean leaves windows and mirrors sparkling clean. Although glass appears to be a hard, smooth surface, it actually has an uneven surface which traps and holds dirt. Chemical glass cleaners can leave a residue which attracts airborne grease and grime to make windows look dirty faster. Steam 'n Clean dissolves deep down dirt and leaves no residue.

1. Fill the Water Tank with cool tap water or distilled/demineralized water.
2. Connect the C.I.D. plug to an appropriate outlet.
3. When green indicator light glows, slide Safety Lock back to activate Steam Switch. Press switch to release steam. Steam continues to come out of the tool while switch is pressed.
4. Spread steam evenly over glass.
5. Clean with scrubber side of glass tool.
6. Wipe surface with squeegee side of tool, then finish with a clean, dry cloth.

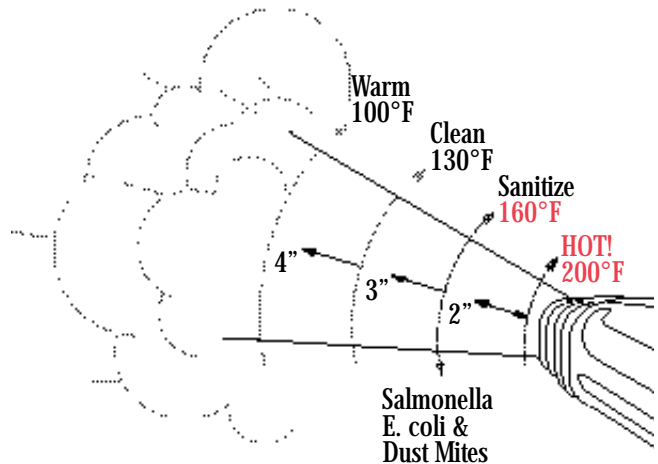

## Killing dust mites

### Mattresses and pillows

Dust mites are microscopic creatures, too small to be seen by the naked eye. Yet the average mattress may hold over two million dust mites, a major cause of many indoor allergies. Use your Steam 'n Clean to kill dust mites on the surface of your mattresses and pillows.

1. Fill the Water Tank with cool tap water or distilled/demineralized water.
2. Connect the C.I.D. plug to an appropriate outlet.
3. Attach the 2-Position Steam Applicator, set to the extended or 'long' position for diffused steam.
4. When green indicator light glows, slide Safety Lock back to activate Steam Switch. Press switch to release steam. Steam continues to come out of the tool while switch is pressed.
5. **To kill dust mites treat surfaces with steam for 20 seconds, holding the applicator no more than 2 inches from the surface.**
6. Make sure the surface is completely dry, then vacuum thoroughly.

## Steam sanitizing hard surfaces

### Kitchen/Bathroom/Nursery

The kitchen, bathroom and nursery are the three areas of your home most likely to harbor harmful fungus, bacteria and viruses. Routinely sanitizing the hard surfaces in these areas, particularly the areas you use frequently, can significantly reduce bacteria and odors. Use your Steam 'n Clean regularly to sanitize sinks, countertops, toilet bowls, changing tables, diaper pails and other hard, non-porous surfaces.

1. Fill the Water Tank with cool tap water or distilled/demineralized water.
2. Connect the C.I.D. plug to an appropriate outlet.
3. Attach a sanitizing tool. For large surface sanitizing, such as countertops, basins, toilets, bidets, crib surfaces, changing tables or diaper pails, use the 2-Position Steam Applicator. For smaller areas, use the Steam Jet with or without the Steam Brush.
4. When green indicator light glows, slide Safety Lock back to activate Steam Switch. Press switch to release steam. Steam continues to come out of the tool while switch is pressed.
5. **To sanitize, treat surfaces with steam for 20 seconds, holding the applicator no more than 2 inches from the surface.**
6. Wipe surface with a clean dry cloth.

NOTE: Steam will not remove stains from fabric or other porous surfaces.

## Steaming/freshening clothes

Use your Steam 'n Clean to remove wrinkles from clothes, and "freshen" clothing that has been stored.

1. Hang clothing from a shower rod or clothes hook using a sturdy clothes hanger.
2. Fill the Water Tank with cool tap water or distilled/demineralized water.
3. Connect the C.I.D. plug to an appropriate outlet.
4. Attach the 2-Position Steam Applicator, set to the extended or 'long' position for diffused steam.
5. When green indicator light glows, slide Safety Lock back to activate Steam Switch. Press switch to release steam. Steam continues to come out of the tool while switch is pressed.
6. Treat clothing until wrinkles loosen. Use a clothes brush as you steam.

 **CAUTION:** Never attempt this procedure while wearing clothing. Severe burns could result.

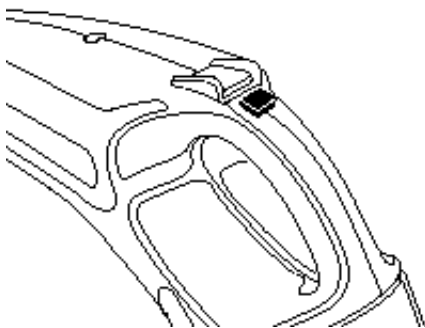

## Other uses

Your Steam 'n Clean is a very versatile tool. Use it to:

Give your houseplants a refreshing cool cloud mist by using the steam selector at 12" or more away from plants.

Soften gum or adhesives for easier removal.

Soften glazing putty on windows for easier removal.

Clean and sanitize coolers.

Clean and sanitize sink garbage disposals.

Clean exhaust fan reusable filters. (Always remove from fixture before cleaning.)



## When you're done

1. Engage Safety Lock by sliding forward.
2. Unplug C.I.D. plug from outlet.
3. Remove Water Tank, empty, then replace.
4. Store the steam cleaner in a clean, dry area.

NOTE: You do not need to empty the Water Tank if you plan to use the steam cleaner within a matter of hours. For longer storage, always empty the tank.

## Maintenance

### Replacing the Water Filter

If you fill your steam cleaner with normal tap water, it is essential to check the water filter and replace it when it is no longer effective. Change the filter when the bright green grains turn dark blue. If the filter is not changed at the appropriate time, calcium deposits will accumulate on the heating element, causing damage or reduced performance.

If you fill your steam cleaner with distilled or demineralized water, you may only need to change your filter once a year.

To replace your filter:

Unscrew (counterclockwise) the Water Tank from the steam cleaner.

Remove the used filter by lifting it straight from the steam cleaner.

Insert new filter by aligning water inlet and outlet plugs with holes in steam cleaner body. Press filter down until it clicks firmly into place.

Replace Water Tank.

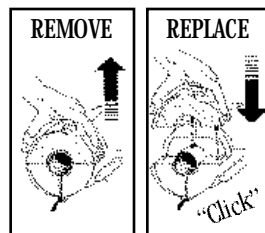
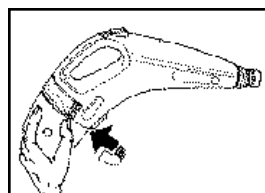

### Replacement Filters

Use only BISSELL Water filters in your BISSELL Steam 'n Clean steam cleaner. You may purchase filters by using the order form in this User's Guide.

To locate a retailer near you, or to place an order, call

#### **BISSELL Consumer Services**

**1-800-237-7691**

Monday - Friday 8 a.m. — 7 p.m. EST

Saturday 9 a.m. — 1 p.m. EST

Or visit our Website @ <http://www.bissell.com>

**CAUTION:** Do not add anything except cool water or you will cause damage to the heating element and void your warranty.



# Troubleshooting

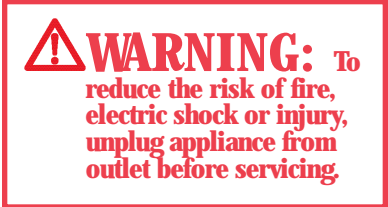

## Water release from safety valve.

Possible Causes	Remedies
Blocked Steam Nozzle	Turn off steam cleaner, empty Water Tank and Call BISSELL Consumer Services

## Reduced steam or no steam.

Possible Causes	Remedies
Water Tank empty	Fill tank
Depleted Water Filter	Replace filter
Damage to Heating Element	Call BISSELL Consumer Services

If suggested solutions for this or any function of your steam cleaner do not correct the problem, call:

**BISSELL Consumer Services**  
**1-800-237-7691**

Monday - Friday 8 a.m. — 7 p.m. EST

Saturday 9 a.m. — 1 p.m. EST

Or visit our Website @ <http://www.bissell.com>

# Part Numbers and Descriptions

Item	Part No.	Part Name
1	010-3504	Water Filter
2	010-0009	2-position Steam Applicator
3	010-6104	Curved Steam Jet
4	010-1166	Steam Brushes (3)
5	010-8441	Glass Cleaning Scrubber/Squeegee
6	010-1167	Triangle Steam Brush
7	010-9102	Water Tank
8	010-1642	Water Fill Cap with Siphon Tube

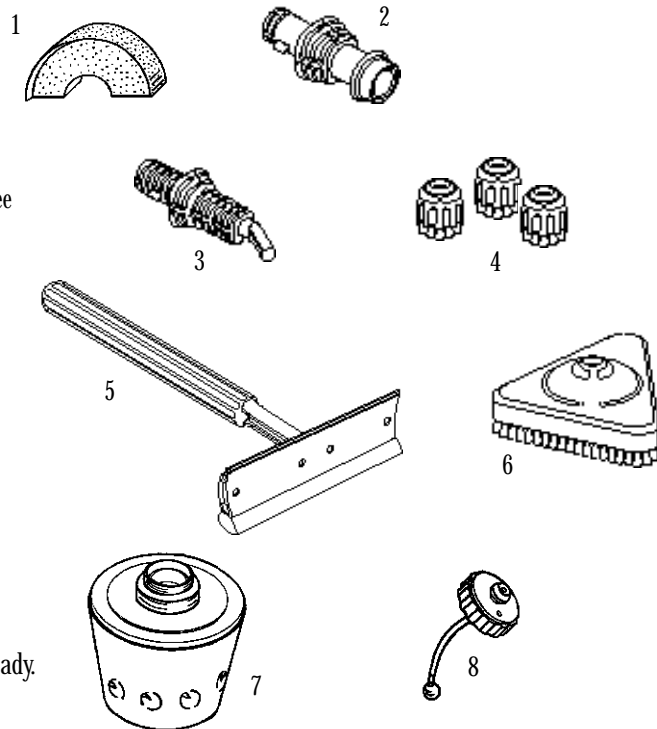

NOTE: Not all attachments pictured are included with every model, but they are available. To order replacement parts or additional attachments call:

**BISSELL Consumer Services**  
**1-800-237-7691**

Monday - Friday 8 a.m. — 7 p.m. EST

Saturday 9 a.m. — 1 p.m. EST

Or visit our Website @ <http://www.bissell.com>

Please have your model and part numbers of unit ready.

## About your warranty

This warranty gives you specific legal rights, and you may also have other rights which may vary from state to state. If you need additional instruction regarding this warranty or have questions regarding what it may cover, call BISSELL Consumer Services.

### One Year Warranty

BISSELL Inc., upon receipt of the product, will repair or replace, free of charge, any part which is defective or malfunctioning within one year of the purchase date, provided that it is used for personal and not commercial or rental service. If the unit cannot be repaired, BISSELL Inc. will replace or refund the full price, at your option. **Use of anything other than cool water in this unit will cause damage to the heating element and void your warranty.**

If your BISSELL product should require service:

1. Call **BISSELL Consumer Services at 1-800-237-7691** and we will give you the name and address of an authorized **BISSELL Service Center in your area.**
2. **If there is not an authorized BISSELL Service Center in your area, a BISSELL Consumer Services Representative will issue you a Return Authorization Number and a pre-paid mailing label to return the unit to BISSELL.**
  - **The machine should be returned with a photocopy of your proof of purchase. (Your dated sales receipt is your warranty - do not send original.)**
  - **Insure the machine when shipping for your protection from loss.**

## BISSELL Consumer Services

If you need information about repairs or replacement parts, or questions about your warranty, call:

**BISSELL Consumer Services**  
**1-800-237-7691**

Monday - Friday 8 a.m. — 7 p.m. EST

Saturday 9 a.m. — 1 p.m. EST

Or write:

BISSELL INC  
PO Box 3606  
Grand Rapids MI 49501  
ATTN: Consumer Services

When contacting BISSELL, have model number of unit available.

Please record your Model Number: \_\_\_\_\_

Please record your Purchase Date: \_\_\_\_\_

**NOTE: Please keep your original sales receipt. It is your warranty.  
Tape or staple here for easy reference.**



Life's messy. Clean it up.®

©1997 BISSELL Inc  
Grand Rapids, Michigan  
All rights reserved. Printed in USA  
Part Number 010-5739

Visit our web site at:  
<http://www.bissell.com>