

**STE™/Room-to-Grow**  
*series*

**Century**

DEDICATED TO QUALITY

# Instruction Manual

44164, 44339



[www.centuryproducts.com](http://www.centuryproducts.com)

445-5-02

4450502

**Avoid injury or death -  
Read and understand this manual!**

# TABLE OF CONTENTS

Instruction manual is for:

- 1000 STE™ 5-Point Newborn/Toddler Car Seat
- Room-to-Grow Overhead Shield Newborn/Toddler Car Seat

Instructions for these models *are the same* unless otherwise noted.

## W Before You Begin

Important Information.....	<b>1</b>
<b>Warnings</b> .....	<b>2</b>
Basic Information.....	<b>4</b>
What is <i>LATCH</i> ?.....	<b>5</b>
<i>LATCH</i> System.....	<b>6</b>

## W Use

Height & Weight Limits.....	<b>7</b>
Rear-facing Installation with Vehicle Seat Belts.....	<b>8</b>
Forward-facing Installation with Vehicle Seat Belts.....	<b>10</b>
Rear-facing Installation with <i>LATCH</i> .....	<b>12</b>
Forward-facing Installation with <i>LATCH</i> .....	<b>14</b>
Placing Child in Car Seat.....	<b>16</b>

Operations and Adjustments.....	<b>18</b>
---------------------------------	-----------

- Harness Straps
- Harness Tie
- Buckle
- Recline / Upright Positions
- 5-Point Crotch Strap Adjustment
- Changing Harness Strap Slots
- Overhead Shield Adjustment
- *LATCH* belt routing
- Removing *LATCH* from Vehicle Anchor Points
- *LATCH* Storage

## W Special Information

Vehicle Seat Belts.....	<b>25</b>
• Locking Clip.....	<b>30</b>
Additional Information .....	<b>31</b>
• Tether Storage	
• Care and Cleaning	
• Aircraft Use	
• Second Hand Car Seat	
Replacement Parts.....	<b>36</b>
Storage.....	<b>Back Cover</b>
• Locking Clip	
• Instruction Manual	
Help Information.....	<b>Back Cover</b>

# IMPORTANT INFORMATION

*No car seat can guarantee protection from injury in every situation, but proper use helps reduce the risk of serious injury or death.*

**READ THIS MANUAL CAREFULLY.**

## W Registration Information

Child restraints (car seats) could be recalled for safety reasons. You must register this restraint to be reached in a recall. Fill out the registration card attached to car seat and mail today or send your name, address, and the restraint's model number and manufacturing date to:

Century Products  
P.O. Box 551  
Elverson, PA 19520-9973  
or call 1-888-224-6549  
[www.centuryproducts.com](http://www.centuryproducts.com)

For recall information:

- Call the U.S. Government's Auto Safety Hotline at 1-800-424-9393 (202-366-0123 in D.C. area)
- [www.nhtsa.dot.gov](http://www.nhtsa.dot.gov)
- Call Century Products at 1-800-837-4044  
[www.centuryproducts.com](http://www.centuryproducts.com)

## W Safety First Check List

- ( Read and understand instruction manual and car seat labels.
- ( Infants less than 20 lbs. (9.1 kg) **must** use car seat **rear-facing**.
- ( Do not use car seat **rear-facing** in vehicle seat with air bag.
- ( Secure children in vehicle back seat whenever possible.
- ( Never leave child unattended.
- ( Install car seat securely with vehicle seat belt or **LATCH** belt.
- ( Do not use after date shown on back of car seat.
- ( Do not allow anyone (babysitter, relatives, etc.) to use car seat without first understanding all instructions.

## W LATCH

This car seat may be installed in a vehicle using either the vehicle seat belt or the **LATCH** system (for vehicles equipped with **LATCH**).

## **WARNINGS** - *Prevent serious injury or death:*

Failure to follow these instructions and car seat labels can result in child striking the vehicle's interior during a sudden stop or crash. Secure car seat with a vehicle seat belt or **LATCH** that is properly routed as shown in this manual.

Select a suitable location for the car seat in your vehicle.

Choose the correct mode of use for the car seat depending on your child's size. Infants less than 20 lbs. (9.1 kg) must use this car seat **rear-facing**. Serious crippling injury or death can result if infant faces front of vehicle. The American Academy of Pediatrics recommends that children should be at least one year of age before being positioned forward facing.

Vehicle seat belt system **MUST** hold car seat securely. Not all vehicle seat belts can be used with a car seat. If vehicle seat belt does not hold car seat securely, read "Vehicle Seat Belts" section.

**DO NOT** use **rear-facing** child restraint in a vehicle seating position equipped with an air bag. Child's head and neck may be seriously injured when an inflating air bag hits back of child restraint.

Never put a car seat in a front vehicle seat unless recommended by vehicle owner's manual. National Highway Traffic Safety Administration (NHTSA) alerts vehicle owners that according to accident statistics, children up to age 12 are safer in the back seat. For vehicles with air bags, refer to vehicle owner's manual for car seat installation information.

## **WARNINGS** - Prevent serious injury or death (continued):

If car seat is in a crash, it must be replaced. **DO NOT use it again!** A crash can cause unseen damage and using it again could result in serious injury or death.

**DO NOT** use car seat if it is damaged or missing parts.

**DO NOT** use accessories or parts other than those provided by Century or Graco. Their use could alter the performance of the car seat.

**Rear-facing** car seat must be properly leveled:

- Too reclined can result in injury or ejection.
- Too upright can result in breathing difficulties.

Insert the harness straps in the proper slots for your child. Never leave child unattended, even when sleeping. Child may become tangled in harness straps and suffocate or strangle.

**DO NOT** remove **LATCH** system from child restraint. If using vehicle seat belt to secure child restraint, **LATCH** connectors must be stored. (see section "**LATCH** storage")

Never attach two **LATCH** connectors to one vehicle lower anchor point unless specifically allowed by the vehicle manufacturer.

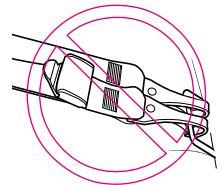

# BASIC INFORMATION

## **WARNING**

**DO NOT** use rear-facing car seat in a vehicle seating position equipped with an air bag.



## **Dangerous Vehicle Seats**

Do not use car seat on rear-facing or side-facing vehicle seats.

## **Car Seat Useful Life**

**STOP** using car seat and throw it away after the date **molded** into the underside of the infant restraint.

**Look for: Do not use this car seat after December Year**

## **Certification**

This car seat meets or exceeds all applicable requirements of Federal Motor Vehicle Safety Standard 213 for use in motor vehicles and aircraft.

## **Unoccupied Car Seat**

Always secure car seat with **LATCH** or a vehicle seat belt, even when unoccupied. An unsecured car seat can injure passengers.

## **Vehicle Seat Protection**

Protect vehicle seat. Use a car seat mat, towel or thin blanket under and behind car seat.

## **Warm Weather**

Car seat parts can get very hot in the sun or warm weather.

**To avoid burns, always check before putting child in car seat.**

# WHAT IS LATCH?

United States Federal Motor Vehicle Safety Standards have defined a new system for installing car seats in vehicles. The system is called **LATCH**. **LATCH** stands for:

**L**ower **A**nchorage and **T**ether for **C**hildren.

## LATCH System for Vehicles:

**LATCH** in the vehicle consists of a top tether anchor point and two lower anchor points.

Some vehicle owner manuals use the term **ISOFIX** to identify the new car seat anchorage system. **LATCH** can also be used in vehicle seating positions equipped with **ISOFIX**.

Newer vehicles may have one or more seating positions equipped with **LATCH** anchor points.

If vehicle is equipped with **LATCH**, the vehicle lower anchor points may be visible at the vehicle seat crease. If not visible, they may be marked with a symbol (Fig. a) or a colored dot. See your vehicle owner's manual for exact locations, anchor identification, and requirements for use with a car seat.

Check vehicle owner's manual for vehicle top tether anchor locations. They may be identified using one of the anchor symbols (Fig. b or Fig. c).

Typical seat in a passenger vehicle. Other vehicle types may have different **LATCH** locations.

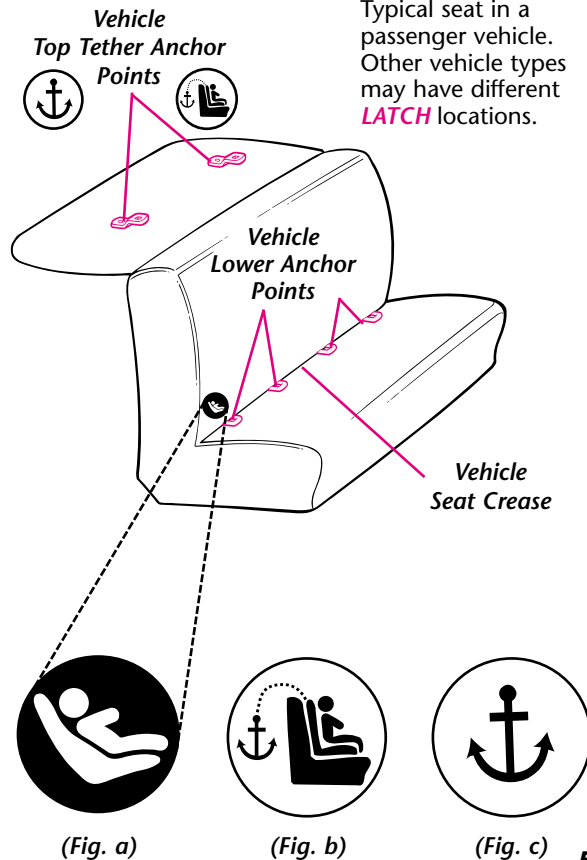

# LATCH SYSTEM

## LATCH System:

LATCH consists of a permanently attached lower anchorage belt and a top tether strap (Fig. a).

ONLY use LATCH in a seating position recommended by vehicle manufacturer.

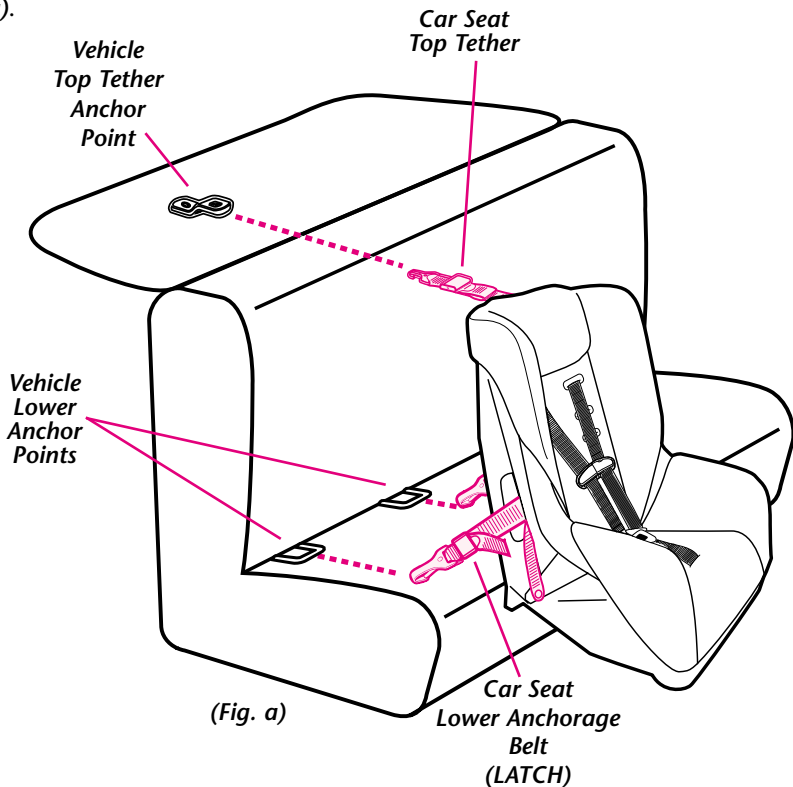



# HEIGHT & WEIGHT LIMITS

## Rear-facing: 5 to 22 lbs. (2.3-10 kg)

- Infants from 5 to 20 lbs. (2.3 to 9 kg) **MUST** be *rear-facing*.
- Infants or toddlers 20 to 22 lbs. (9 to 10 kg) may be *rear-facing*.

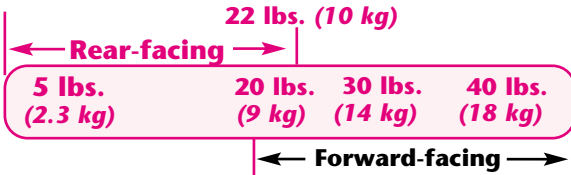

## Forward-facing: 20 to 40 lbs. (9 to 18 kg)

- Toddlers 20 to 22 lbs. (9 to 10 kg) who are capable of sitting upright unassisted may be forward-facing ✱. If unable to sit unassisted, use *rear-facing*.
  - Toddlers 22 to 40 lbs. (10 to 18 kg) and up to 40 inches (102 cm) tall **MUST** be forward-facing.
- ✱The American Academy of Pediatrics recommends that children should be at least one year of age before being positioned forward facing.

## Preterm or Low Birth Weight Infants

A preterm infant or low birth weight infant may be at special risk in a vehicle or aircraft.

According to the American Academy of Pediatrics, these infants may suffer breathing difficulties if improperly reclined in a car seat.

Century advises that you have your physician or hospital staff evaluate your infant and recommend the proper car seat or car bed **before** you and your infant leave the hospital.

## Outgrowing Car Seat

### **WARNING**

**Prevent serious injury or death:**

- **Top of child's ears must be below top edge of car seat.**
- **Child's shoulders MUST not be above top harness slots.**

# REAR-FACING INSTALLATION WITH VEHICLE SEAT BELTS



## WARNING

**LATCH belt MUST be stored when using vehicle seat belt to install car seat.**

- 1 Store **LATCH** belt by attaching to openings in top of car seat. (see page 24 *fig. m*).
  - Hook connectors into storage openings on each side of seat. (*fig. a, page 9*).
  - Adjust **LATCH** belt to remove excess slack by pulling adjustment belt.
- 2 Adjust car seat to **recline** position (see pages 18 and 19, *fig. c*) and place **rear-facing** on vehicle seat.
- 3 Thread vehicle seat belt through openings and buckle belt.
- 4 Press down firmly in center of car seat to compress vehicle seat cushion while tightening vehicle seat belt (*fig. b*).

- 5 Pull front to back and left to right to check for secure installation (*fig. c*). Vehicle lap belt **MUST** stay tight.

If not secure, see “Vehicle Seat Belts” page 25.

- 6 Check level indicator on car seat.

Vehicle **must** be on level ground and child in car seat when checking level indicator.

Ball **MUST** be entirely in green zone (*fig. d*). If necessary, place rolled towels under car seat, at vehicle seat crease, until entire ball is in green zone. Then re-check level indicator.

**DO NOT** use tether **rear-facing**. Tether **must** be stored (see “Tether Storage” page 31).

Periodically check that car seat is securely installed and properly leveled; adjust if necessary.

# REAR-FACING INSTALLATION WITH VEHICLE SEAT BELTS

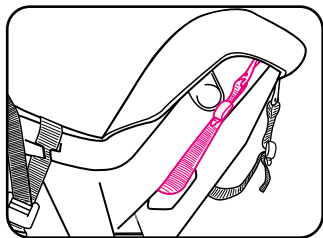
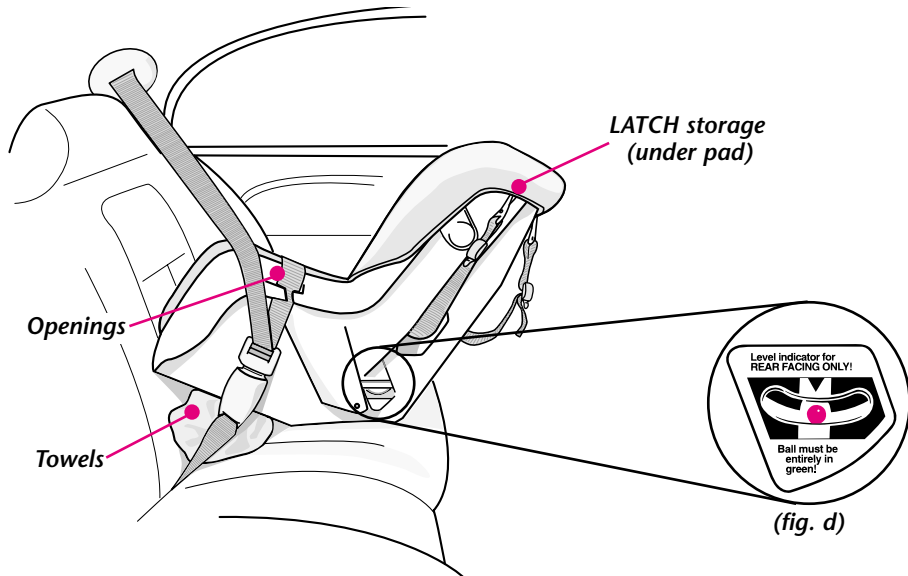

(fig. a)

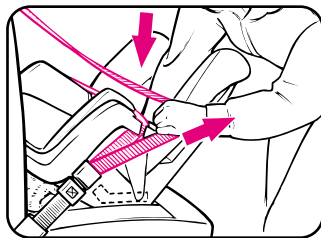

(fig. b)

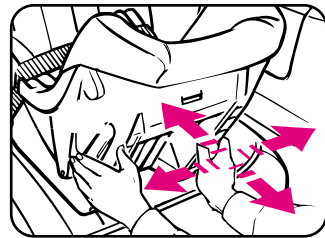

(fig. c)

# FORWARD-FACING INSTALLATION WITH VEHICLE SEAT BELTS

## **WARNING**

**LATCH** belt **MUST** be stored when using vehicle seat belt to install car seat.

- 1** Store **LATCH** belt by attaching to openings in top of car seat. (see page 24 *fig. m*).
  - Hook connectors into storage openings on each side of seat. (*fig. a*).
  - Adjust **LATCH** belt to remove excess slack by adjustment belt.
- 2** Adjust car seat to **upright** position (see pages 18 and 19 *Fig. c*) and place **forward-facing** on vehicle seat.
- 3** Thread vehicle seat belt through openings. Buckle belt (*fig. b*).
- 4** Press down firmly in center of car seat to compress vehicle seat cushion while tightening vehicle seat belt.  
Use your knee to press down in center of car seat (*fig. c*).

**5** Pull front to back and left to right to check for secure installation (*fig. d*). Vehicle lap belt **MUST** stay tight.

If not secure, see “Vehicle Seat Belts” page 25.

**6** Attach tether strap hook (**A**) to anchor hardware (**B**) and tighten strap to remove any slack (*fig. e*). If vehicle does not have anchor points to attach tether hook, tether hook should be stored, see “Tether Storage”, page 31.

Periodically check that car seat is securely installed; adjust if necessary.

# FORWARD-FACING INSTALLATION WITH VEHICLE SEAT BELTS

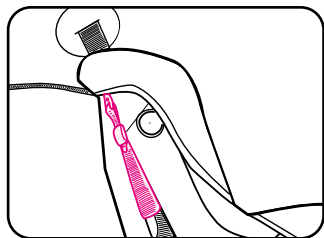
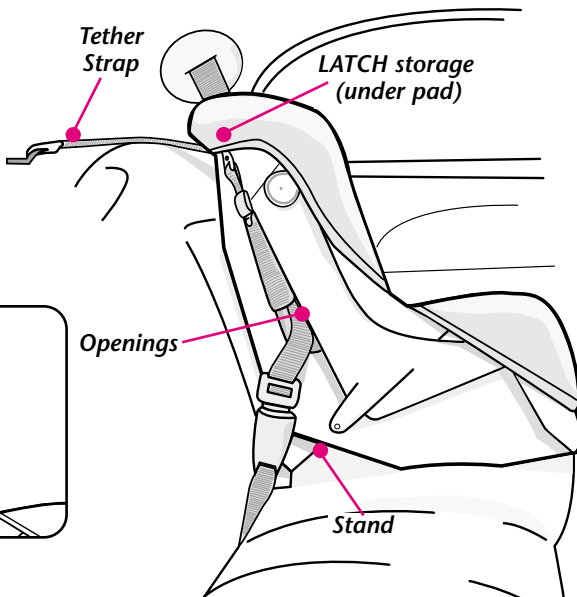

(fig. a)

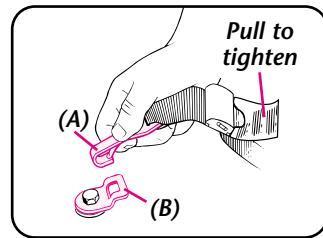

(fig. e)

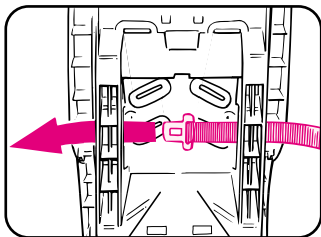

(fig. b)

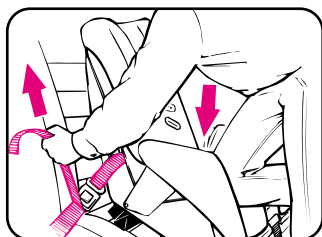

(fig. c)

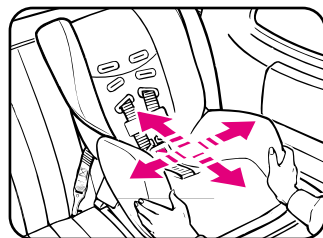

(fig. d)

# REAR-FACING INSTALLATION WITH LATCH

---

- 1** **LATCH** belt must be routed through opening in car seat for **rear-facing** mode. (see page 22, *fig. h*)

Belt must lay flat and not be twisted.

- 2** Adjust car seat to **recline** position (see pages 18 and 19, *fig. c*) and place **rear-facing** on vehicle seat equipped with **LATCH** anchors.

- 3** For ease of installation, extend **LATCH** belt to its maximum length.

- 4** Hook connectors to vehicle lower anchors (*fig. a*). Pull connectors to be sure they are securely attached anchor points. (*fig. b*).

- 5** Press down firmly in center of car seat to compress vehicle seat cushion while tightening **LATCH** belt by pulling adjustment belt (*fig. c*).

- 6** Pull front to back and left to right to check for secure installation (*fig. d*).

Check that the lower anchorage belt stays tight and does not slip from the tightened position. If it does not stay tight, try another seating position or contact Customer Service (see back cover).

- 7** Check level indicator on car seat. Vehicle **must** be on level ground and child in car seat when checking level indicator.

Ball **MUST** be entirely in green zone (*fig. e*). If necessary, place rolled towels under car seat, at vehicle seat crease, until entire ball is in green zone. Then re-check level indicator.

**DO NOT** use tether **rear-facing**. Tether **must** be stored (see “Tether Storage” page 31).

Periodically check that car seat is securely installed and properly leveled; adjust if necessary.

# REAR-FACING INSTALLATION WITH LATCH

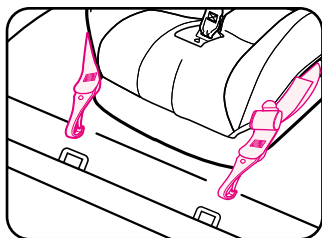
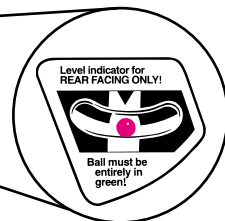
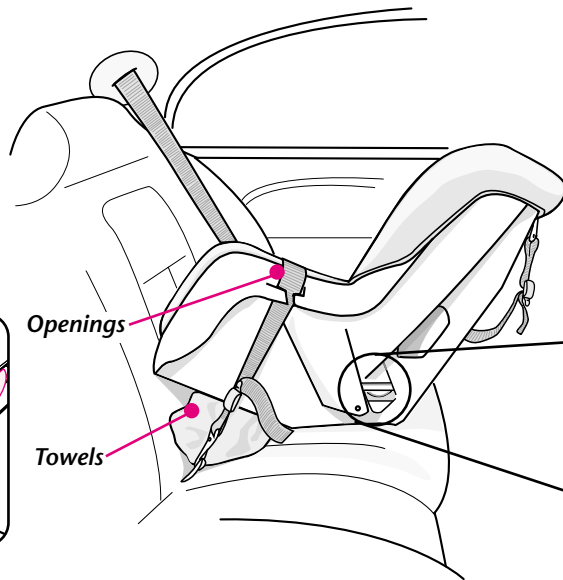

(fig. a)

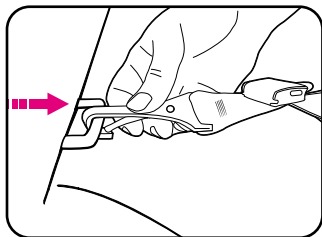

(fig. b)

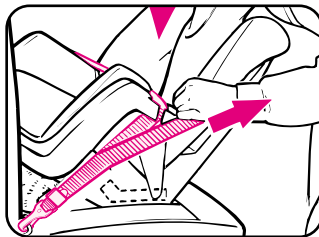

(fig. c)

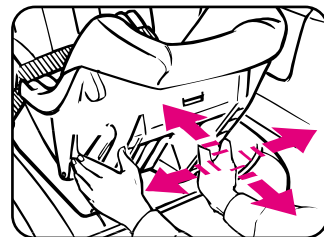

(fig. d)

# FORWARD-FACING INSTALLATION WITH LATCH

---

- 1** **LATCH** belt must be routed through opening in car seat for **forward-facing** (see page 22, *fig. i*).  
  
Belt must lay flat and not be twisted.
- 2** Adjust car seat to **upright** position (see page 19, *Fig. c*) and place **forward-facing** on vehicle seat equipped with **LATCH** anchors.

- 3** For ease of installation, extend **LATCH** belt to its maximum length.

- 4** Hook connectors to vehicle lower anchors (*fig. a*). Pull connectors to be sure they are securely attached (*fig. b*).

- 5** Press down firmly in center of car seat to compress vehicle seat cushion while tightening **LATCH** belt by pulling adjustment belt (*fig. c*).

Use your knee to press down in center of car seat (*fig. c*).

- 6** Pull front to back and left to right to check for secure installation (*fig. d*).

Check that the lower anchorage belt stays tight and does not slip from the tightened position. If it does not stay tight, try another seating position or contact Customer Service (see back cover).

- 7** Attach tether strap hook (**A**) to anchor hardware (**B**) and tighten strap to remove any slack (*fig. e*).

Periodically check that car seat is securely installed; adjust if necessary.



# FORWARD-FACING INSTALLATION WITH LATCH

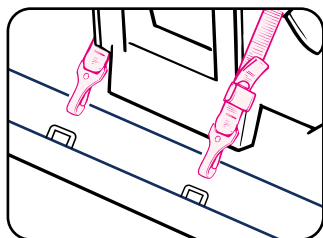
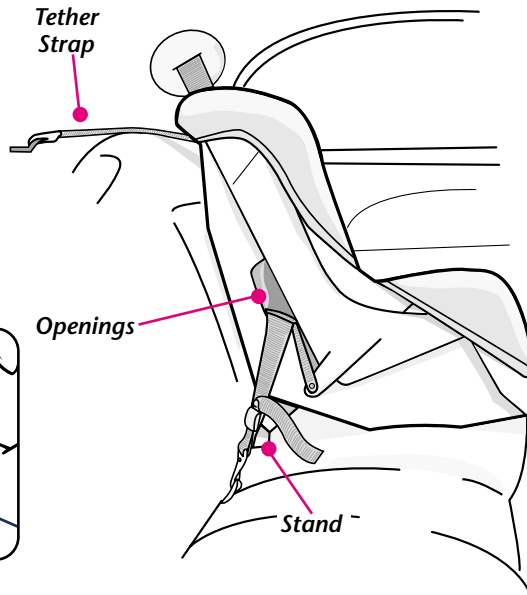

(fig. a)

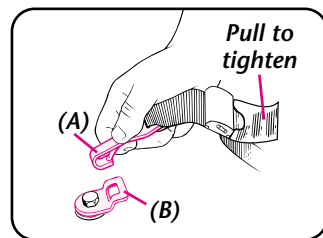

(fig. e)

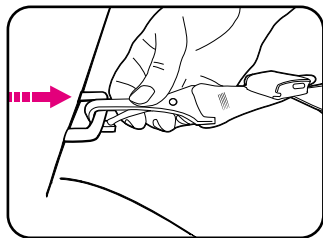

(fig. b)

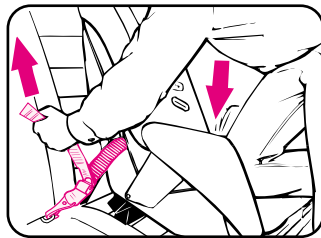

(fig. c)

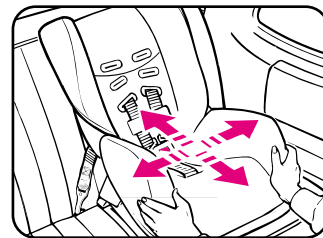

(fig. d)

# PLACING CHILD IN CAR SEAT



## WARNING

To prevent serious injury or death:

- **Keep harness straps snug and positioned on shoulders.**
- **Do not use strap covers, blankets, cushions, or padding under harness straps or child unless provided by Century or Graco.**
- **Child must be dressed in clothing that will not interfere with buckling harness.**

### Check harness system:

- **Rear-facing** - Harness straps must be through bottom or middle slots **at** or **below** shoulders.
- **Forward-facing** - Harness straps must be through middle or top slots.

### 5-Point Models Only:

- Crotch strap **must** be in opening closest to but not under child.

### Overhead Shield Models Only:

- Harness tongue **must** be in opening closest to but not under child.

- 1 Place child in car seat with child's back flat against back of car seat.
- 2 Place harness straps over child's shoulders and insert tongue(s) into buckle.  
Pull up on tongue(s) to be sure they are locked.
- 3 Close harness tie:  
Position harness tie at arm pit level.
- 4 Adjust harness straps to be snug with just enough room to insert one finger between child's chest and harness straps (*fig. a*).  
For 5-Point models, check that harness straps on **chest** and **thighs** are snug.
- 5 A rolled towel can be used on each side to support small children (*fig. b*). Be sure towels do not interfere with harness system.

# PLACING CHILD IN CAR SEAT (continued)

5-Point Models

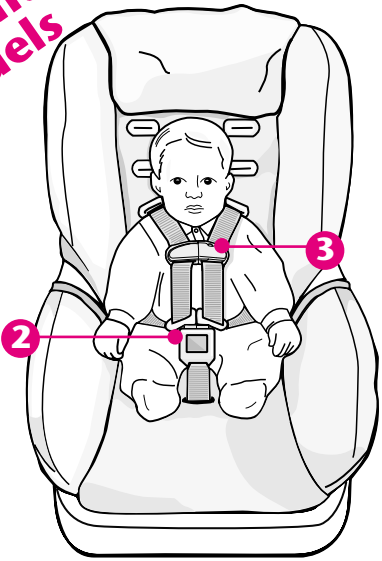

Overhead Shield Models

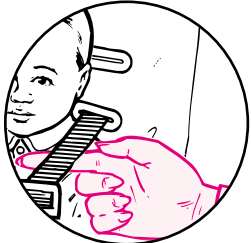
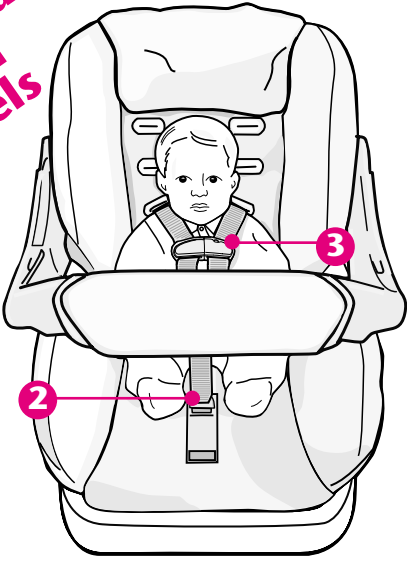

(fig. a)

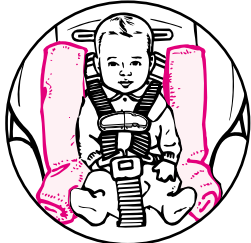

(fig. b)

# OPERATIONS and ADJUSTMENTS

## 1 Harness Straps (fig. a):

- To tighten: Slide harness lock **open** to lift adjuster bar. Pull harness straps down until all slack is removed. (page 21, fig. a-e)
- To loosen: Slide harness lock **closed** to remove straps from harness plate and adjuster bar. (page 21, fig. a-e)

## Harness Tie (fig. b):

- To open: Unhook harness tie as shown.
- To close: Fasten harness clip. Position harness clip at middle of child's chest, level with armpits.

## 2 Buckle:

### 5-Point Models

- To buckle: Insert both tongues into buckle. Pull up on tongues to be sure they are locked.
- To unbuckle: Press red button and pull tongues out of buckle.

## 3 Overhead Shield Models

**MUST be in opening closest to but not under child.**

- To buckle: Push tongue into opening. Pull up on tongue to be sure it is locked.
- To unbuckle: Press red button, pull tongue out of opening and lift shield over top of car seat.

## 4 Recline / Upright Positions (fig. c):

**Rear-facing** - **MUST use Recline position.**

**Forward-facing** - **MUST use Upright position**

- Upright Position: Rotate stand out and push into car seat.
- Recline Position: Pull stand out and rotate into car seat.

## 5 5-Point Crotch Strap Adjustment (fig. d):

**MUST be in opening closest to but not under child.**

- From bottom of car seat, pull crotch strap clip out and remove clip from crotch strap loop.
- From top of car seat, pull crotch strap out and thread through desired slot. Make sure red button is facing away from child.
- From bottom of car seat, re-attach clip to crotch strap loop exactly as shown.

# OPERATIONS and ADJUSTMENTS (continued)

**5-Point Models**

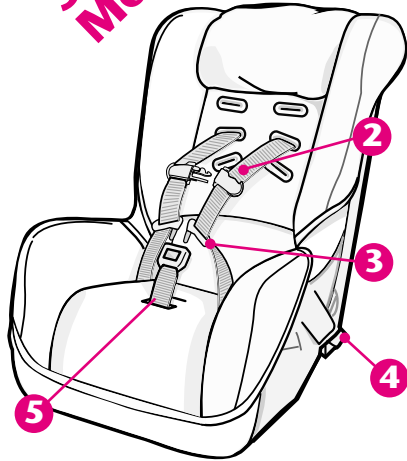

**Overhead Shield Models**



**Harness Lock**

**Adjuster Bar**

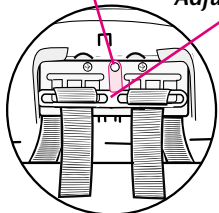

(fig. a)

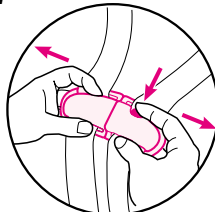

(fig. b)

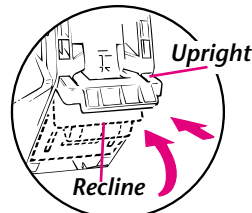

(fig. c)

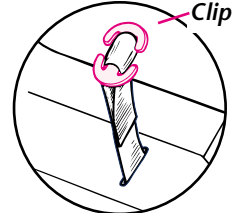

(fig. d)

# OPERATIONS and ADJUSTMENTS (continued)

---

## 6 Changing Harness Strap Slots:

*The harness straps must go into the slots even with or just above the shoulders.*

### **A** To adjust harness straps:

Remove straps from harness plate and adjuster bar (*fig. a*).

**B** Pull strap ends through slots and reinsert them in the correct slots (*fig. b*).

**C** Reassemble straps onto adjuster bar exactly as shown (*fig. c*).

**D** Push adjuster bar down (*fig. d*).

**E** Rotate lock down (*fig. e*).

### NOTE:

- Make sure both harness straps are securely attached within Harness Plate and Adjuster bar and locked into place with Harness Lock.
- Make sure straps are *NOT* twisted.

## 7 Overhead Shield Adjustment (*fig. f*):

- To adjust: Press both buttons down and move shield to desired position closest to child. Release buttons to lock shield into place. Check by pulling out on shield.

**NOTE:** Shield does not need to contact child when in closest position; harness system restrains child.

# OPERATIONS and ADJUSTMENTS (continued)

**All Models**

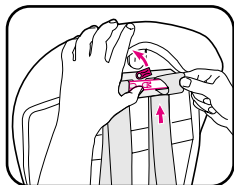
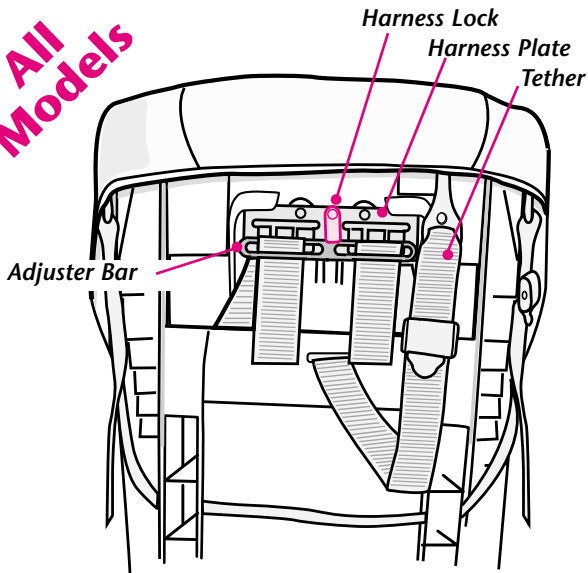

(fig. a)

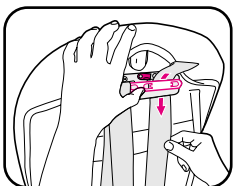

(fig. b)

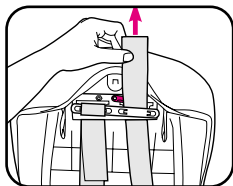

(fig. c)

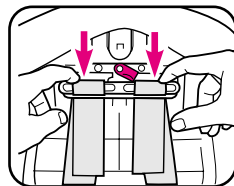

(fig. d)

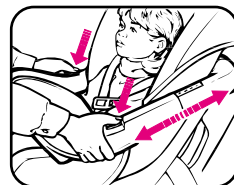

(fig. f)

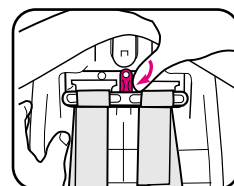

(fig. e)

# OPERATIONS and ADJUSTMENTS (continued)

## 8 **LATCH Belt Routing:**

**LATCH** belt **MUST** be routed through the proper openings depending on direction of car seat use.

**A** Route **LATCH** belt through **Rear-facing** openings for:

- **LATCH Rear-facing** use.

**B** Route **LATCH** belt through **Forward-facing** openings for:

- **LATCH Forward-facing** use.

Rotate **LATCH** belt so that the belt routes through the proper openings (**fig. h** and **fig. i**). Belts must remain flat and not twisted.

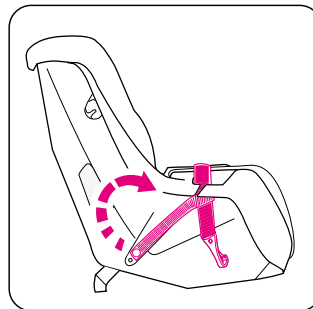

**Rear-facing opening**  
(fig. h)

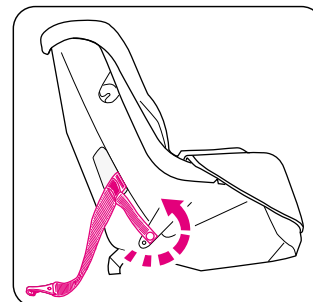

**Forward-facing opening**  
(fig. i)



# OPERATIONS and ADJUSTMENTS (continued)

## 9 Removing **LATCH** from Vehicle Anchor Points:

**A** Tilt metal tab of adjuster to release tension (*fig. j*).

**HINT:** Press down on car seat compressing vehicle seat cushion to reduce tension on lower anchorage belt.

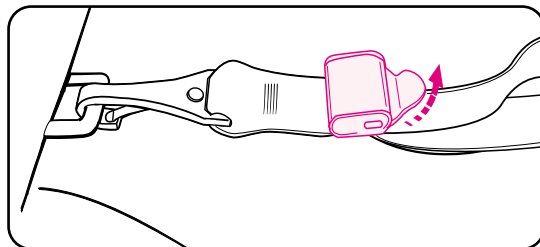

(fig. j)

**B** Press and hold **LATCH** release hinge. (lower hinge) (*fig. k*).

**C** Push connector in, lift connector up and pull out (away from anchor point) (*fig. l*).

Repeat step A, B and C for other connector.

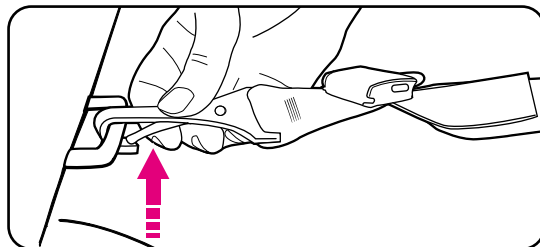

(fig. k)

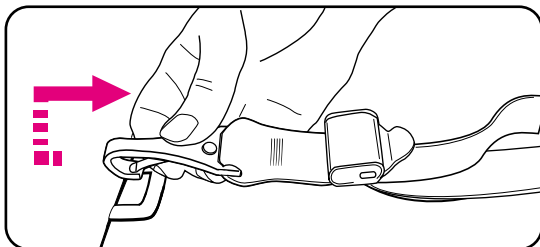

(fig. l)

# OPERATIONS and ADJUSTMENTS (continued)

## 10 **LATCH** storage:

- Locate **LATCH** storage openings on top of infant restraint (*fig. m*).
  - Fasten **LATCH** into storage opening as shown. (*fig. n*)
  - Reinstall seat pad over top of carseat.
- Repeat for other connector.

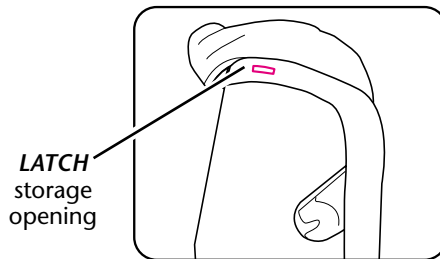

(*fig. m*)

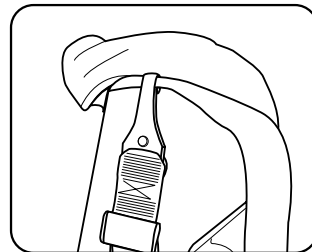

(*fig. n*)

# VEHICLE SEAT BELTS

---



## WARNING

**Not all vehicle seat belts can be used with a car seat. The car seat must be held securely at all times by a lap belt (or lap belt portion of a lap/shoulder belt) that will not change length while driving.**

To provide the most secure installation of the car seat:

- Read the vehicle owner's manual regarding car seat installation and seat belt use with car seat.
- Follow all instruction labels on vehicle seat belt and car seat.

If car seat is not held securely after following instructions in this manual, vehicle seat belt labels, and vehicle owner's manual:

- Move car seat to another seating location and try again, or
- Contact vehicle dealer for possible seat belt modification parts.

# VEHICLE SEAT BELTS (continued)

## W Belts Forward of Seat Crease

Vehicle seat belts located forward of seat crease may not securely hold car seat. Check vehicle owner's manual or see vehicle dealer for car seat installation requirements.

- *If approved for use with car seat, install car seat and check for secure installation by pulling car seat front to back. If car seat slides forward, DO NOT use these seat belts.*

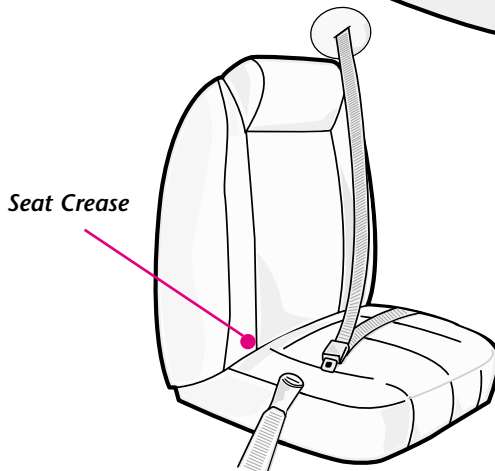
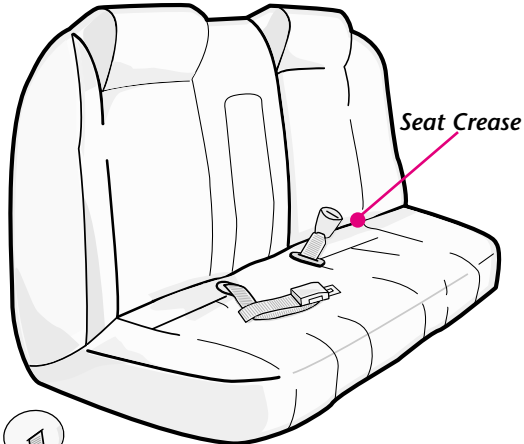

# VEHICLE SEAT BELTS (continued)

## Lap Belts - Manually Adjustable

The locking latch plate on some seat belts may slip and loosen after being buckled on car seat if positioned at a certain angle. If this happens, flip latch plate over (*fig. a*) and re-buckle. Test installation again to see if this works. If not, move car seat to another seating position.

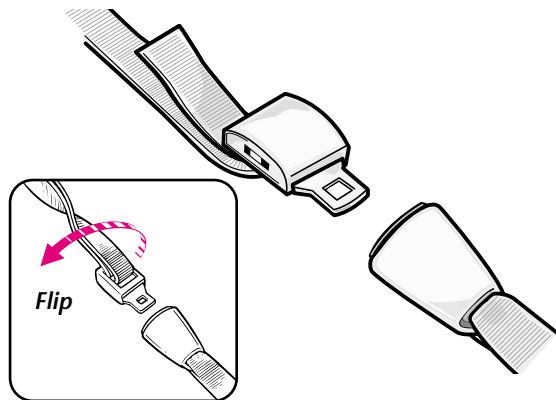

(*fig. a*)

## Lap Belts - With Retractor

Lap belts with retractors may or may not hold a car seat securely.

Follow these steps to determine if you have a retractor system that will hold car seat securely:

- Pull belt all the way out.*
- Allow belt to retract about 6 inches (15 cm).*
- Pull out on belt again.*

If belt is locked and you **cannot** pull the belt out any further, you have an Automatic Locking Retractor which may be used with a car seat. Remember, when installing a car seat, pull belt all the way out, buckle belt, and then tighten.

If you **can** pull the belt out again (Step c above), you have an Emergency Locking Retractor which **MUST NOT** be used with a car seat.

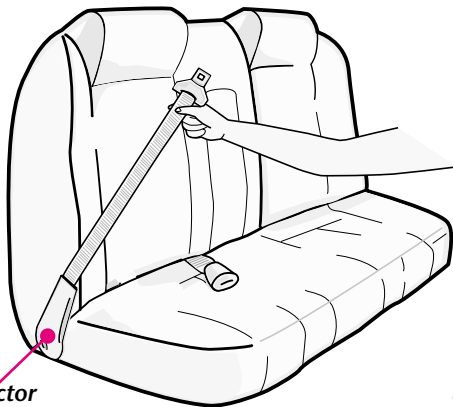

## VEHICLE SEAT BELTS (continued)

### W Passive Restraint - Lap Belt with Motorized Shoulder Belt

*DO NOT* use with any car seat.

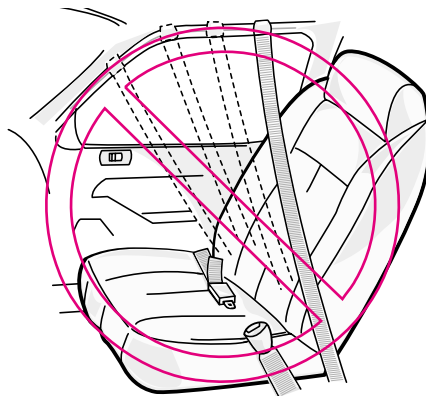

### W Passive Restraint - Lap or Shoulder Belt Mounted on Door

*DO NOT* use with any car seat. Belts will not stay tight while driving.

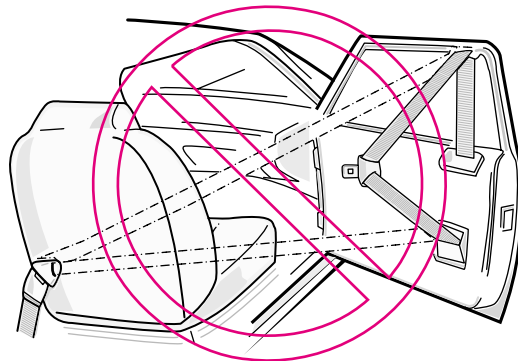

# VEHICLE SEAT BELTS (continued)

## W/Combination Lap/Shoulder Belt with Sliding Latch Plate

Pull on latch plate (*fig. a*). If belt slides freely through latch plate, a locking clip **MUST** be used (see Pg. 30 “Locking Clip” section).

Some combination lap/shoulder belts with sliding latch plates may be converted into an “**automatic locking mode**” that will allow use without a locking clip. See vehicle owner’s manual and label on vehicle belts for instructions.

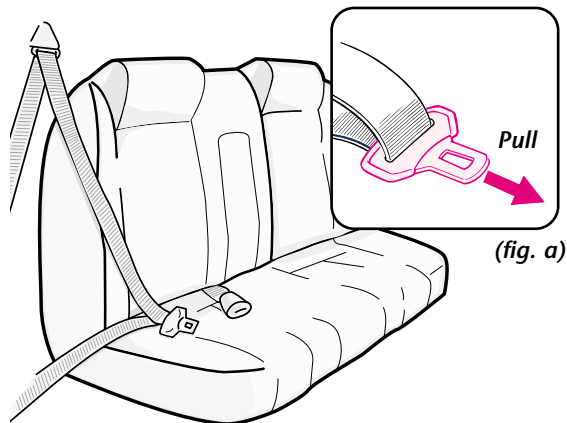

## W/Combination Lap/Shoulder Belt with Locking Latch Plate

The locking latch plate on some seat belts may slip and loosen after being buckled on car seat if positioned at a certain angle. If this happens, flip the latch plate over (*fig. b*) and re-buckle. Test installation again to see if this works. If not, move car seat to another seating position.

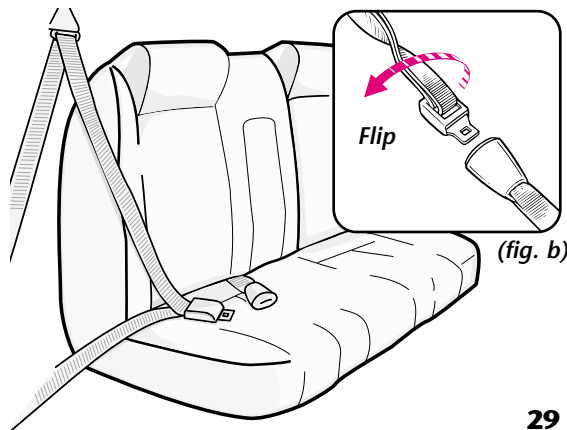

# VEHICLE SEAT BELTS (continued)

## W Locking Clip

### WARNING

**Avoid serious injury or death:**

- **Failure to use locking clip where required will result in car seat not being securely held in place.**
- **Remove locking clip from seat belts when not being used with car seat.**
- **DO NOT use locking clip as a vehicle seat belt shortener.**

You **MUST** use locking clip provided with car seat with a vehicle seat belt that slides freely through the latch plate or the lap belt cannot be tightly secured.

- 1 Install car seat and tighten vehicle seat belt.
- 2 Hold seat belts together at latch plate (*fig. a*) then unbuckle.
- 3 Slide locking clip on seat belts approximately 1/2 inch (1 cm) away from latch plate.
- 4 Re-buckle seat belt.

- 5 Test installation to see if car seat is secure. If not secure, additional belt tightening may be required:
  - Unbuckle vehicle seat belt.
  - Hold belts together and remove locking clip.
  - Shorten length of lap belt portion slightly by pulling belt through latch plate.
  - Re-attach locking clip.
  - Buckle vehicle seat belt.

Press car seat further down into vehicle seat cushion to help buckle vehicle seat belt.

Test installation to see if car seat is secure. If not secure, repeat above step until secure.

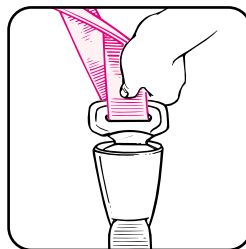

(*fig. a*)

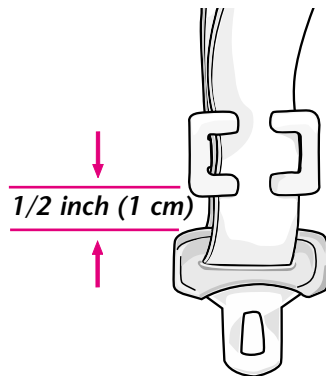



# ADDITIONAL INFORMATION

## W/Tether Storage

**DO NOT** anchor tether strap to the vehicle when using car seat *rear-facing*.

**Tether hook** must be attached to car seat for *rear-facing* use or if vehicle is not equipped with tether anchors.

### *For storage of tether hook:*

- Attach tether hook to back of car seat as shown.
- Pull loose end of strap to remove any slack.
- Roll loose end of strap up and secure with a rubber band.

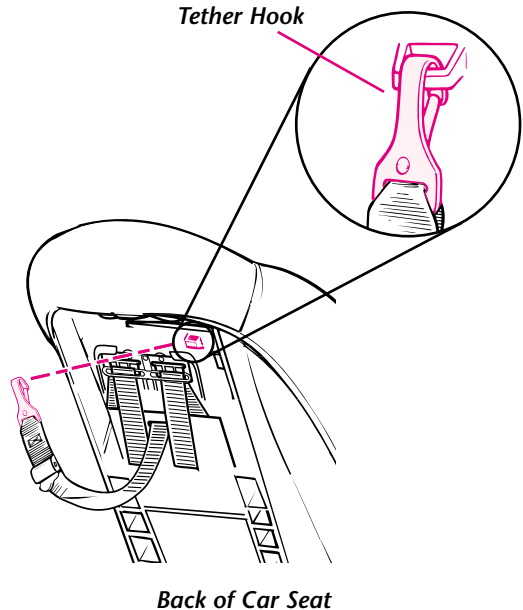

# ADDITIONAL INFORMATION (continued)

## Care & Cleaning

- 1 Unhook "J" hooks from car seat shell.
- 2 Remove harness straps from Harness plate.
- 3 Pull harness straps out of harness slots.
- 4 Press red button to release tongue(s).
- 5 For 5-Point harness system:
  - Unhook harness tie and remove from harness straps.
  - Pull seat pad up over harness straps leaving harness straps in car seat.

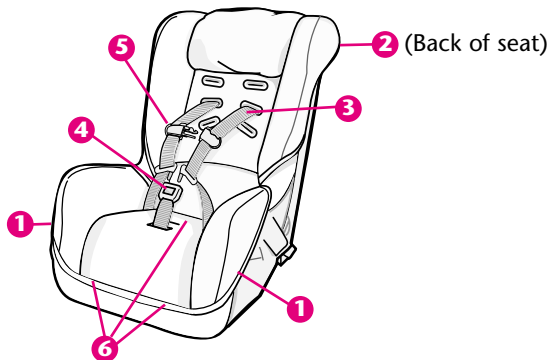

- 6 Pull the (3)- 2 button clips out of shield and remove pad

For Overhead shield model:

- Pull seat pad off.

### Removing Overhead Shield Pad:

- 7 Pull 2 button clips out of shield and remove pad (*fig. a*).

Reverse above steps for replacing pads.

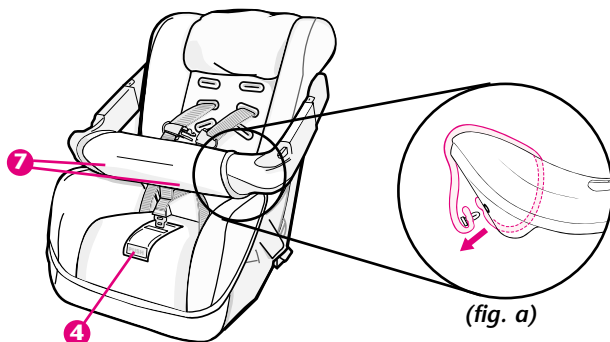

## ADDITIONAL INFORMATION (continued)

---

### *Seat Pad and Overhead Shield Pad:*

Machine-wash separately on gentle cycle and drip dry.

### *Harness Straps*

Surface wash only with mild soap and damp cloth.

If harness straps are frayed or heavily soiled, they **MUST** be replaced.

### *Shell:*

Wipe with mild solution of soap and water. Avoid wetting labels.

Never use “household detergents”, they can weaken plastic.

### *Buckle:*

Clean with a damp cloth. **DO NOT** use household detergents. Never lubricate buckle.



## **WARNING**

**Prevent serious injury or death:**

- **Buckle must be properly latched.**
- **Periodically inspect and clean buckle to remove objects or debris that could prevent latching.**

## ADDITIONAL INFORMATION (continued)

---

### W Aircraft Use

This car seat is certified for use on aircraft (see label on car seat). Contact airline about their policy.

Use this car seat only on **forward-facing** aircraft seats.

Install car seat on an aircraft the same way it is installed in a vehicle.

### W Second Hand Car Seat

Century advises against loaning or passing along car seat.

# NOTES

---

# PARTS LIST

---

## How to Order:

Complete the form on the reverse side of this page. Your infant restraint model and serial numbers **MUST** be included on the form to ensure proper replacement parts. Your model number can be found on a sticker on the underside of your car seat. **Payment must accompany your order.**

Parts may also be ordered from Century's web site at [www.centuryproducts.com](http://www.centuryproducts.com).

- Fabric Seat Pad (*All Models*) .....\$35.00
- Fabric Shield Pad (*Overhead Shield*) .....\$10.00
- Harness Strap (*5-Point*) .....\$5.00
- Harness Strap (*Overhead Shield*).....\$5.00
- Buckle, Crotch Strap and Tongues (*5-Point*).....\$10.00
- 1-Piece Harness Tie (*All models*) .....\$5.00
- Locking Clip (*All models*) .....\$5.00
- LATCH Belt .....\$20.00
- Tether System .....\$10.00
- Overhead Shield 2-Button Retainer Clip .....FREE
- Seat Pad 2-Button Retainer Clip (*All models*) .....FREE
- Headrest Foam & Push-In Buttons (*All models*) .....FREE
- Instruction Manual (*All models*) .....FREE

**NOTE:** *Prices subject to change.*

**Model No.**

*(Both Numbers Required)*

**Serial No.**

**SHIP TO:**

Name

Address

City, State, Zip Code

Telephone (including Area Code)

Check or money order enclosed  
(payable to Century Products)

Charge to credit card

Visa    MasterCard    Discover

Account #

Expiration date

Signature

- Fabric Seat Pad *(All Models)* .....\$35.00
- Fabric Shield Pad *(Overhead Shield)* .....\$10.00
- Harness Strap *(5-Point)* .....\$5.00
- Harness Strap *(Overhead Shield)*.....\$5.00
- Buckle, Crotch Strap and Tongues *(5-Point)*.....\$10.00
- 1-Piece Harness Tie *(All models)* .....\$5.00
- Locking Clip *(All models)* .....\$5.00
- LATCH Belt .....\$20.00
- Tether System .....\$10.00
- Overhead Shield 2-Button Retainer Clip .....**FREE**
- Seat Pad 2-Button Retainer Clip *(All models)* .....**FREE**
- Headrest Foam & Push-In Buttons *(All models)* .....**FREE**
- Instruction Manual *(All models)* .....**FREE**

Subtotal:

Shipping & handling\*: \$5.00

Sales tax\*\*:

Total:

\* \$15.00 outside the continental U.S.

\*\*CA 7.25%, IL 6.25%, IN 5%, NY 8.25%, OH 5.75%, PA 6%, SC 5%

**MAIL ORDER TO:**

**CENTURY PRODUCTS**

P.O. BOX 100

ELVERSON, PA 19520-9974

ATTN: CUSTOMER SERVICE DEPARTMENT

**OR FAX ORDER TO:**

(610) 286-4555



If a part is damaged, missing, or you need help or replacement parts, **DO NOT** return car seat to the store.

## **CALL US FIRST**

Call toll-free 1-800-837-4044 from anywhere in the U.S. or Canada or fax at 1-610-286-4555.

## **or write us at:**

Century Products  
P.O.Box 100  
Elverson, PA 19520-9974

Attention: Customer Service  
Department

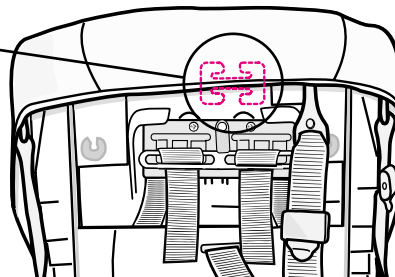
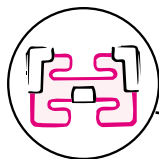

**Store locking clip  
as indicated above.**

**Store instruction manual behind  
these tabs on underside of seat.**

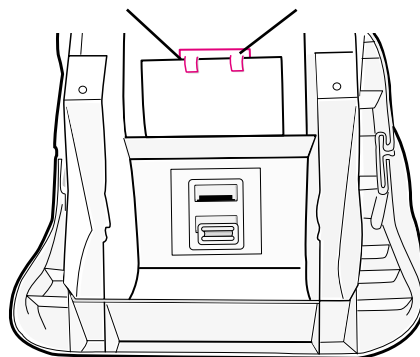

Century Products  
Graco Children's Products Inc.  
A Division of Newell Rubbermaid  
Macedonia, Ohio 44056-2096