



IMPORTANT!

You must ensure that you follow these instructions carefully and correctly. If this seat is not fitted securely and your child is not strapped in correctly, your child and other passengers are at serious risk of injury in the event of an accident

Please read this User Guide carefully BEFORE trying to install your child car seat

The Hampshire Trading Standards Authority and Britax advise that child car seats should not be bought or sold second-hand. Please dispose of your child seat safely. Do not sell or pass it on.

After an accident, the child seat and your car seat belts should be replaced. Although they may look undamaged, if you were to have another accident the child seat and your car seat belts may not be able to protect your child as well as they should.

No child seat is escape proof

Belt restraint systems cannot be designed to be completely "child proof" and yet comply with the legal requirements of European Standard ECE R44.

Looking after your child seat

Food and drink may find their way inside the buckle of the harness. This can stop it from working properly – it will not click. Wash in warm water until clean (dia A).

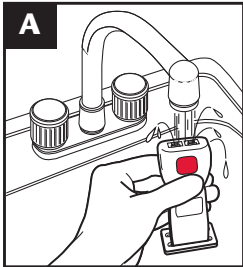

The child seat and its cover have been carefully designed, manufactured and tested to high safety standards.

Cleaning the cover

Please read the labels on the cover for washing instructions.

DO NOT tumble dry the cover – short spin and drip dry only. The sun canopy is hand wash only.

Cleaning the harness and seat shell

Sponge clean **ONLY** using hand soap and warm water.

DO NOT take apart, or attempt to take apart, any part of the harness or seat when cleaning.

DO NOT use solvents, detergents or washing-up liquid as these may weaken the harness and the seat.

DO NOT lubricate or oil any part of the seat.

IMPORTANT – The cover is a safety feature.

NEVER use the child seat without it. Don't put your child's safety at risk by using other makes of replacement cover, they could stop the child seat from protecting your child as well as it should.

A replacement cover is available from your Britax stockist or contact Britax Customer Service Department on **01264 386034**.

Removing the cover

Follow the instructions for removing the harness (see overleaf). Then unfasten the elastics on each side of the cover (if applicable slide the shoulder pads off the harness and remove the head support, and remove the comfort pad).

Gently pull the cover off from the top of the seat, easing the harness buckle and adjuster strap through the slots in the cover.

Guarantee

All Britax products are carefully designed, manufactured and tested. However, should this product prove faulty within 12 months of purchase due to a materials or manufacturing fault please return it to the original place of purchase. We will then, at our discretion, either repair it free of charge or replace it with the same or a similar product.

For guarantee purposes proof of purchase will be required. We recommend that you retain your receipt and attach it to this user guide. They should be kept in a safe place.

Britax does not accept liability for damage arising from abuse, misuse or negligence. This guarantee is not transferable and therefore does not apply to second-hand products.

Your statutory rights are not affected by this guarantee.

If in doubt

Not all car seats fit all cars. For advice as to the suitability of this restraint for your car please use **Fit-finder**® on our website at www.britax.co.uk, call our Customer Service Helpline on **01264 386034** or email helpline@uk.britaxeurope.com.

WARNING

DO NOT use the child seat on a passenger seat fitted with an active front airbag unless your vehicle manufacturer confirms that it is safe.



DO NOT use the child seat on side or rearward facing vehicle seats.

DO NOT use anything, such as a cushion or coat, to raise the child seat off the passenger seat. In an accident the child seat and your car seat belts would not be able to protect your child as well as they should.

DO NOT use the child seat in the home. It has not been designed for home use and should only be used in your car.

DO NOT attempt to dismantle, modify or add to any part of the child seat or change the way its harness or your car seat belts are made or used.

DO NOT leave children alone in your car, even for a short time.

DO NOT leave loose objects, such as luggage or books, in the back of your car. They must be properly secured.

DO NOT leave folding passenger seats unlatched. If you have to stop your car suddenly a loose seat back could injure your child.

DO NOT allow children to play with or adjust the child seat.

DO NOT place the child seat on a table or work-top.

DO keep this user guide safe for future reference.

DO cover the child seat if your car is left in direct sunlight. Fittings can become hot to touch in sunny weather and the cover may become faded.

DO make sure that the child seat does not become trapped by a folding passenger seat or in the door of your car.

DO make sure that you adjust the harness to fit the clothes your child is wearing before each journey – a fitting for winter clothes may be too slack for a child wearing summer clothes.

DO store the child seat in a safe place when it is not being used. Avoid placing heavy objects on top of it and do not store near direct heat sources.

DO always keep the child seat secure, even if it is not being used by your child.

DO make sure that all occupants in the vehicle are correctly restrained.

DO Watch over your baby when using the rocking feature. At all other times make sure the handle is in the stable position to prevent rocking.

DO make sure when using the child seat with a travel system, that it is securely attached to the travel system chassis before setting off.

DO use the safety harness provided with the child seat at all times.

DO make sure the handle is upright and latched properly before carrying your baby in the child seat.

Britax Excelsior Limited

1 Churchill Way West
Andover
Hampshire SP10 3UW
United Kingdom

A Britax Childcare company

Customer Service Helpline: 01264 386034
Email: helpline@uk.britaxeurope.com
Switchboard: 01264 333343
Fax: 01264 334146

www.britax.co.uk

WARNING Britax, whilst taking into account child car seat contact with vehicle seats throughout the development of new products, cannot accept responsibility for damage occurring to vehicle seats or seat belts.

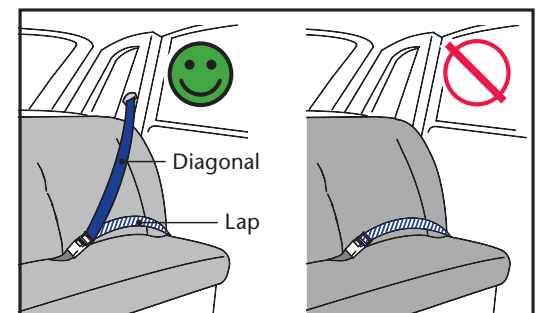

IMPORTANT – The child seat **MUST** only be used with a lap and diagonal seat belt (approved to UN/ECE Regulation no. 16 or other equivalent standards).

Introducing your new child car seat

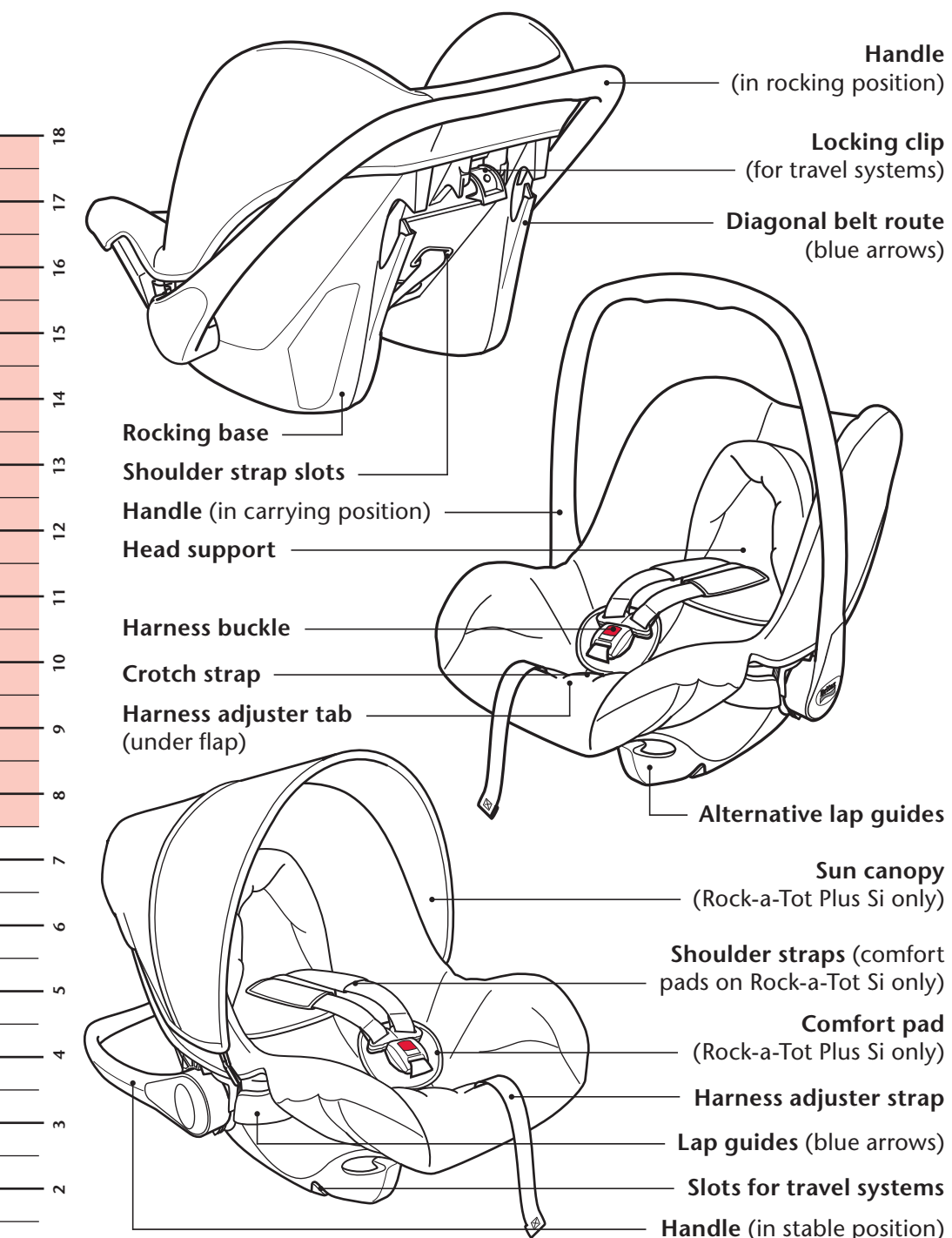

Rock-a-Tot Si
Rock-a-Tot Plus Si



Children weighing up to 13kg (birth to approx 9-12 months)

1 Preparing to install the child seat in a car

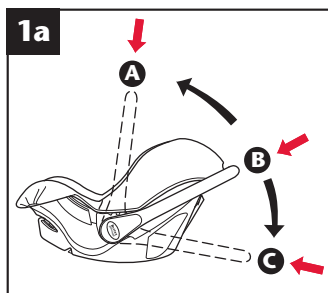

Handle – carrying, rocking and stable position

To move the handle, push firmly in towards the shell to release lock and then move it to the desired position (**dia 1a**):

- A** – Carrying position
- B** – Rocking position
- C** – Stable position

IMPORTANT – Always check the handle is upright and latched properly before carrying.

Harness adjustment

IMPORTANT – You must adjust the shoulder straps of the harness to the correct

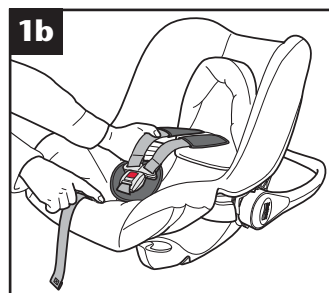

position for your child **BEFORE** installing the child seat as it cannot be adjusted in the car.

Carefully place the child seat on the floor. Move the handle to the stable position, **C** (**dia 1a**). With one hand lift the fabric flap and press the harness adjuster tab. With your other hand pull the shoulder straps forward as far as possible to loosen the harness (**dia 1b**).

Unfasten the harness by pressing the red harness buckle button. Lay the shoulder straps over the sides of the seat (**dia 1c**).

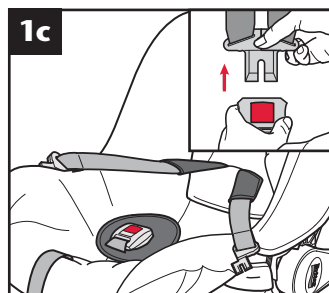

Place your child in the child seat and check that the shoulder strap slots are level with, or just below, your child's shoulders and that the head is comfortably positioned in the head support when used (**dia 1d**).

To adjust the height of the shoulder straps, first remove your child from the seat. Remove the shoulder pads (if applicable) by sliding them off the shoulder straps.

Next, pull one strap through from the front and re-thread it through the correct slot in the

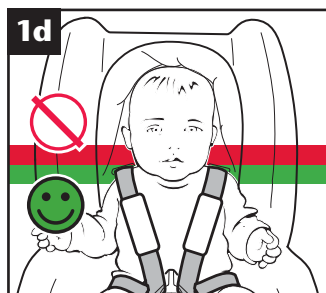

shell, cover and head support (**dia 1e**). Repeat with the other strap making sure the straps are not twisted.

IMPORTANT – The safety harness provided with the child seat must be used at all times.

Adjusting the crotch strap

IMPORTANT – You must adjust the crotch strap to the correct length for your child **BEFORE** installing the child seat as it cannot be adjusted in the car.

IMPORTANT –

a. The crotch strap should only be extended when normal

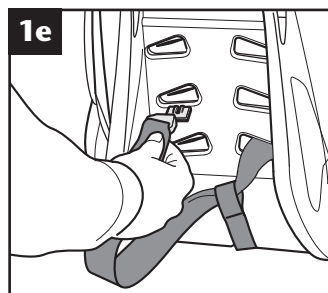

harness adjustment is not enough, i.e. shoulder straps are at full extension.

b. Always return the crotch strap to its original, shorter length when using the seat with a smaller baby.

c. The buckle should always be positioned low down on your child's body.

d. **DO NOT** attempt to remove the crotch strap from the adjuster. Adjustment is made by feeding the crotch strap through the adjuster (**dia 1f**).

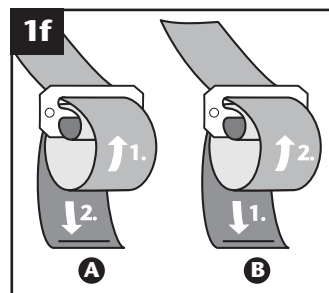

The adjuster at the end of the crotch strap is found under the front edge of the child seat.

To change the length of the crotch strap, thread it through the adjuster in the direction of the arrows shown (**dia 1f**).

- A** – Shortening
- B** – Lengthening

Using the sun canopy

(Rock-a-Tot Plus Si only)

To fit the canopy place it over the back of the child seat. Then fasten the hooks on either side of the sun canopy to the cover elastics.

2 Fitting your child in the child seat

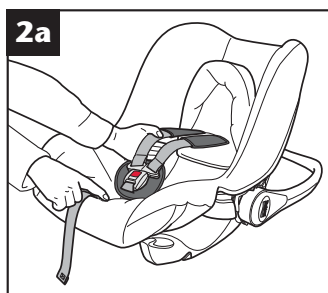

Everyday use of the harness

Move the handle to the stable position, see "Handle – carrying, rocking and stable position" (**dia 1a**).

Place your child in the child seat and fit the harness loosely around them. Re-fasten the harness buckle by fitting the two tongues together and

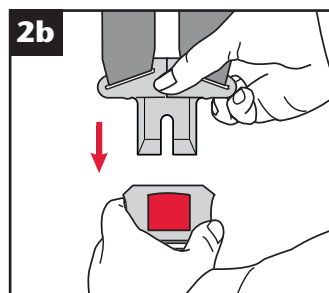

pushing them firmly until you hear a click (**dia 2b**). Make sure the harness is not twisted.

Tighten the harness by pulling the adjuster strap forward making sure the harness is a comfortable but **FIRM** fit around your child (**dia 2c**).

IMPORTANT – The lap section of the harness should rest as

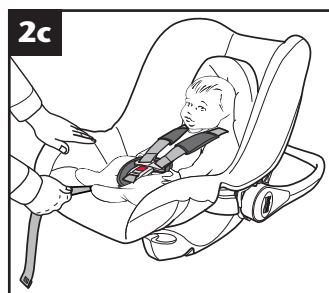

forward and as low as possible over your child's pelvis. (if not see 'Adjusting the crotch strap').

To remove your child from the child seat first loosen the harness by lifting the fabric flap between your baby's legs and press the adjuster button down as you pull the shoulder straps forward (**dia 2d**). Then release

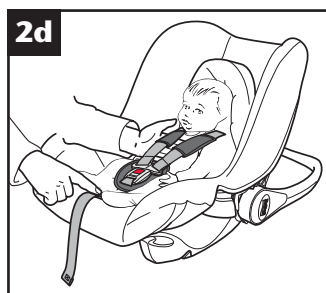

the harness by pressing the red button on the buckle.

IMPORTANT – Your baby should not stay in the child seat or any infant carrier for periods exceeding 2 hours at a time.

Laying the shoulder straps over the side of the seat when removing your child helps prevent harness twisting.



Using as a low chair

With the handle in the carrying or rocking position, see "Handle – carrying, rocking and stable position", the child seat will rock gently as your baby moves (**dia 2e**).

With the handle in the stable position, the child seat becomes a steady seat for feeding or sleeping.



IMPORTANT – The safety harness provided with the child seat **MUST** be used at all times.

When using the child seat to feed your baby, protect the harness buckle with a cloth. A dirty buckle may not close securely.

Carrying the child seat with your child in it

Always check the handle is upright and latched properly before carrying (**dia 2f**).

3 Installing the child seat in a car

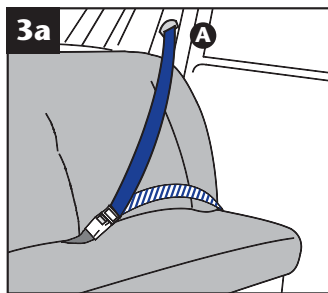

IMPORTANT – Have you adjusted the harness to the correct position for your child?

IMPORTANT – The safety harness provided with the child seat must be used at all times.

IMPORTANT – The child seat must only be fitted rearward-facing, that is with your baby facing the back of the car, using a lap and diagonal seat belt and **NOT** a lap-belt only.

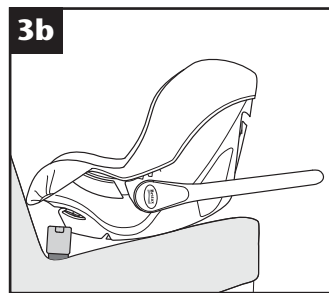

Installing with a lap and diagonal seat belt

To gain adequate length from your seat belt it may be necessary to slide the vehicle seat as far back as it will go (as you would for a tall person), and lower the height of the seat belt at **A** if this is adjustable (**dia 3a**).

Place the child seat on a car seat with your baby facing the

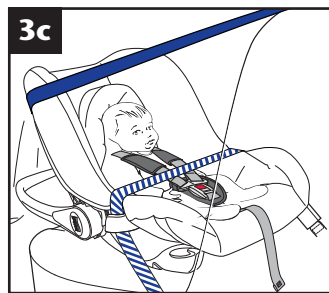

back of the car and move the handle to the stable position as shown, making sure it is latched properly (**dia 3b**).

Fasten the seat belt across the child seat. Pass the lap section of the seat belt through the lap guides on both sides as indicated by the blue arrows on the child seat. Pull the diagonal section of the seat belt around the back of the child seat (**dia 3c**).

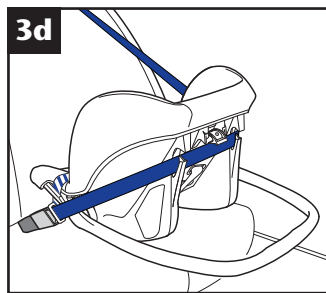

Feed the diagonal belt through both diagonal belt guides indicated by the blue arrows at the back of the seat (**dia 3d**).

Tighten the seat belt by first pulling at **1** and then **2** and **3** to remove any slack (**dia 3e**). Check that the child seat feels secure and that the seat belt is not twisted.

IMPORTANT – If your car seat belt is not long enough, see "Alternative installation".

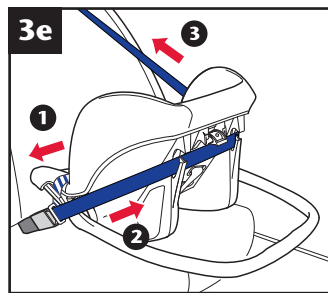

ENSURE THAT:

a. The lap section of the vehicle's seat belt **A** runs through both belt guides **B** on the child seat (**dia 3f**).

b. The diagonal section **C** runs through the diagonal belt guide on the back of the seat.

c. The car seat belt buckle is not positioned in or in front of the belt guides **B**.

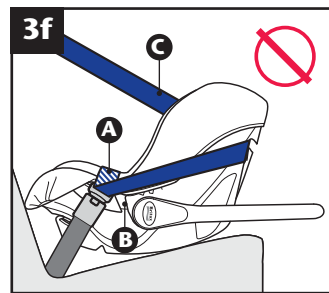

IMPORTANT – **FOR YOUR CHILD'S SAFETY** it is essential that the diagonal part of the seat belt goes round the back of the seat.

Removing the child seat from the car

First take the seat belt out of all four guide slots, then undo the seat belt.

Take care to keep the moving seat belt away from your baby.

4 Alternative installation

Not all car seat belts meet the latest European recommendations and you may encounter some installation problems. The most common will be short seat belts. The child seat has been designed with this in mind and an alternative routing for the lap section of the seat belt is provided.

IMPORTANT – This method is not suitable in all cars so you **MUST**, before use, check the buckle and anchorage details.

Buckle Position

The adult seat belt buckle must be below and rearwards of the lap guide as indicated (**dia 4a & 4b**).

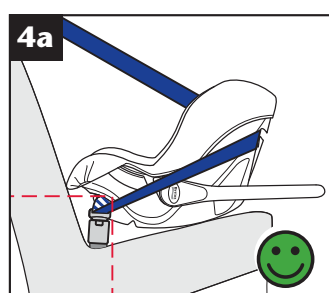

Anchorage

Using the ruler guide printed on the front of this user guide, check that your lower anchorage is within the white area as shown. If it is in the red area then your

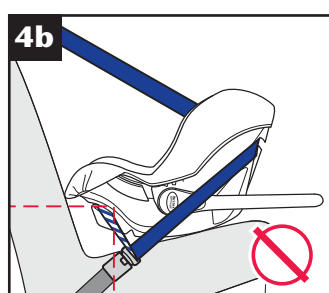

vehicle is not suitable for use with the alternative routing (**dia 4c**).

The lap section of the seat belt should pass through both belt guides underneath the foot end of the seat.

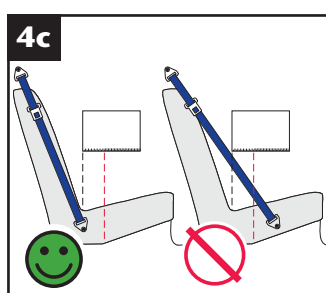

Pull the diagonal section of the seat belt around the back of the child seat (**dia 4d**).

Feed the diagonal belt through both diagonal belt guides

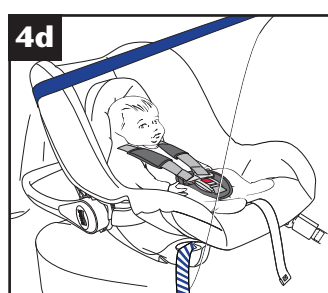

indicated by the blue arrows at the back of the seat.

Tighten the seat belt by first pulling here **1** and then here **2** and **3** to remove any slack

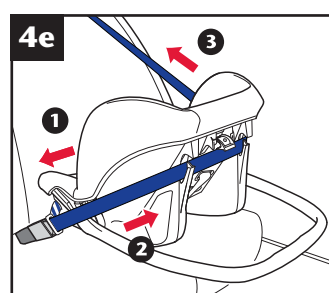

(**dia 4e**). Check that the child seat feels secure and that the seat belt is not twisted.

If you are in any doubt please contact Customer Services on 01264 386034.