

Combi®

Instruction Manual

Everest™ Booster Car Seat

*33 to 100 lbs.
(15 to 45 kg)*



Everest™ 8400 Series

⚠ WARNING ⚠

Correct installation and use can be a matter of Life or Death! Read and understand these instructions before using this car seat.

- Certified for use in motor vehicles.
- Meets or exceeds all applicable requirements of Federal Motor Vehicle Safety Standard 213.

Para instrucciones en Español,
llamar al: 1-800-992-6624.

Section 1 - Warnings



WARNING

DEATH or SERIOUS INJURY can occur

- Failure to follow these instructions and car seat labels can result in injury or death to a child from striking the vehicle's interior during a sudden stop or crash.
- Use only with children who weigh between 33 and 100 lbs. (15 and 45 kg) and whose height is between 33 and 57 inches (84 and 145 cm).
- Snugly adjust the lap and shoulder belt around child according to the instructions in the vehicle owner's manual.
 - Vehicle lap belt **MUST** be positioned low on the hips contacting the thighs.
 - Shoulder belt must be properly positioned over shoulder (NOT touching child's neck and NOT off shoulder).
 - Never use shoulder belt loose, positioned under child's arms, or behind child.
 - A snug belt should not allow any slack. It lies in a relatively straight line without sagging. It does not press on the child's flesh or push the child's body into an unnatural position.
- Use only the vehicle's lap and shoulder belt system when restraining the child in this Booster Car Seat. Lap belt **MUST** be under armrests.
- Never use Booster Car Seat with only a vehicle lap belt across front of child. Use with only a lap belt could result in serious injury or death to a child.
- Not all vehicle seat belts can be used with this Booster Car Seat. Read vehicle owner's manual and "Vehicle Seat Belt Systems" section in this manual.
- Never use this Booster Car Seat with the vehicle's LATCH System.
- Never use Booster Car Seat in a front vehicle seat location unless recommended by vehicle owner's manual.

- To avoid injury, this restraint should be installed and adjusted by an adult. NEVER allow child to buckle themselves in this Booster Car Seat.
- Discontinue use of the Booster Car Seat when the top of the child's ears are above top of the vehicle seat back or headrest. Severe head or neck injuries could result without proper head support.
- Do not allow child to slide down in Booster Car Seat which could position vehicle lap belt across child's abdomen and shoulder belt over neck or face.
- Vehicle belts MUST lay flat against child and MUST not be twisted.
- If child will not keep vehicle shoulder belt properly positioned, DO NOT use this Booster Car Seat. Use a different child restraint system.
- Secure this child restraint to the vehicle, even when not occupied. Unsecured items may injure other occupants in a crash.
- DO NOT use accessories or parts other than those provided by Strolee or Combi USA. Use of accessories or parts from other manufacturers could alter the performance of the car seat.
- DO NOT use Booster Car Seat if it has been in a crash, it must be replaced. A crash can cause unseen damage and continued use could result in serious injury or death.
- DO NOT use Booster Car Seat if it is damaged, missing instructions, or missing parts.
- Register your child restraint with the manufacturer.

Proper Use Is Required:

No car seat can guarantee protection from injury in every situation, but proper use helps reduce the risk of serious injury or death.

Section 2 - Table of Contents

Section 1. Warnings.....	1
Section 2. Table of Contents.....	3
Section 3. Proper Use Check List.....	4
Section 4. Everest™ Booster Car Seat Parts.....	5
Section 5. Use Recommendations.....	6
Section 6. Selecting A Vehicle Seating Location.....	7
• Vehicle Seat Belt Systems.....	8
Section 7. Booster Car Seat Use.....	9
Section 8. Additional Information	
• Certification.....	11
• Aircraft Use.....	11
• Warm Weather.....	11
• Vehicle Seat Protection.....	11
• Instruction Manual Storage.....	11
• Car Seat Useful Life.....	11
Section 9. Registration Information.....	12
Section 10. Care and Cleaning.....	13

Keep this instruction manual for future use.
Store under seat pad.

Section 3 - Proper Use Check List

- Proper use is required. Read and understand instructions and car seat labels.
- Secure child in this child restraint with a vehicle lap and shoulder belt as specified in this instruction manual.
- Snugly adjust vehicle lap and shoulder belt around child. Lap belt **MUST** be under armrests.
- A vehicle combination lap and shoulder belt **MUST** be used when using Booster Car Seat.
- Do not use only a vehicle lap belt with this Booster Car Seat.
- Secure children in back seat whenever possible.
- Never leave child unattended.
- Do not allow anyone (babysitter, relatives, etc.) to use Booster Car Seat without first reading and understanding all instructions.

Need help installing your Booster Car Seat?

Contact one of the following sources:

- Your vehicle dealer to locate a child safety seat inspection station in your area.
- Call 1-866-SEAT CHECK (1-866-732-8243).
- Visit www.nhtsa.dot.gov and select "Child Seat Inspections".
- Visit www.seatcheck.org.
- Contact a certified child passenger safety technician in your area. To locate a certified "Child Passenger Safety" Technician in your area visit www.nhtsa.dot.gov and select "Child Passenger Safety" and then select "Technician Contact Locator".

Section 4 - Everest™ Booster Car Seat Parts

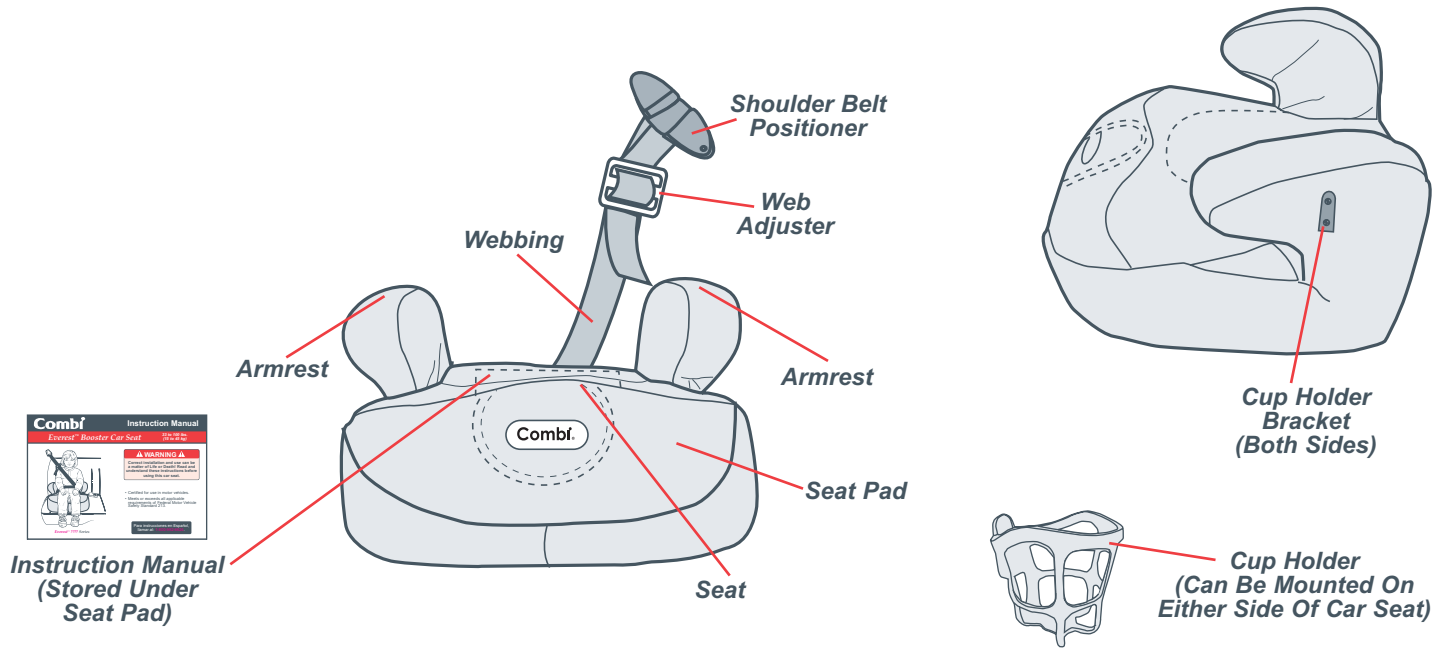

Section 5 - Use Recommendations

Height and Weight Limits:

This child restraint is designed for use only by children who weigh between 33 and 100 pounds (15 and 45 kg) and whose height is between 33 and 57 inches (84 and 145 cm).

Child *MUST* meet all of the following requirements:

- Child's weight is between 33 and 100 pounds (15 and 45 kg) and
- Child's height is between 33 and 57 inches (84 and 145 cm) and
- Top of child's ears are below top edge of vehicle seat back or headrest.

⚠ WARNING ⚠ DEATH or SERIOUS INJURY can occur

- **Discontinue use of the Booster Car Seat if top of child's ears are above the top edge of vehicle seat back or headrest. Severe head or neck injuries could result without the proper head support.**

Section 6 - Selecting A Vehicle Seating Location

- 1** National Highway Traffic Safety Administration (NHTSA) alerts vehicle owners that according to accident statistics, children up to age 12 are safer when properly restrained in the rear seating positions rather than the front seating positions.
- 2** Refer to vehicle owner's manual for car seat installation instructions for your vehicle.
 - Use car seat in a rear vehicle seat location whenever possible.
 - Never put a car seat in a front seat location unless recommended by vehicle owner's manual.
 - For vehicles with air bags, always follow child restraint installation information provided in vehicle owner's manual.

If a vehicle front seat location with an air bag must be used, follow the vehicle manufacturer's instructions for child restraint use and move the vehicle seat back as far as possible.

DO NOT place rear-facing child seat on front seat with air bag. DEATH OR SERIOUS INJURY can occur. The back seat is the safest place for children 12 and under.



NO coloque el asiento infantil para el automóvil orientado hacia atrás en el asiento delantero del vehículo que tenga una bolsa neumática de seguridad. El niño podría MORIR O SUFRIR LESIONES GRAVES. El asiento trasero es el lugar más seguro para los niños de 12 años o menores.

- 3** DO NOT use this Booster Car Seat with the vehicle's Child Restraint Anchorage System or LATCH System.

- 4** Vehicle seats:

DO NOT use this Booster Car Seat on the following types of vehicle seats:



***Seats Which Face
Sides Of Vehicle***

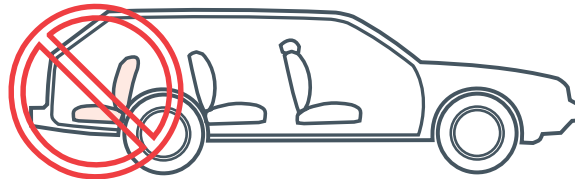

***Seats Which Face
Rear Of Vehicle***

Vehicle Seat Belt Systems

Design and operation of vehicle seat belt systems vary from vehicle to vehicle and from seating location to seating location in the same vehicle. Not all vehicle seat belts can be used with a child restraint. Refer to this section for information on the various types of vehicle seat belt systems.

! WARNING ! DEATH or SERIOUS INJURY can occur

- Use only the vehicle's lap and shoulder belt system when restraining the child in this Booster Car Seat.
- Never use the Booster Car Seat with only a vehicle lap belt.
- Do not allow child to slide down in Booster Car Seat which could position vehicle lap belt across child's abdomen and shoulder belt over neck or face.

DO NOT use this Booster Car Seat with the following types of vehicle seat belts:

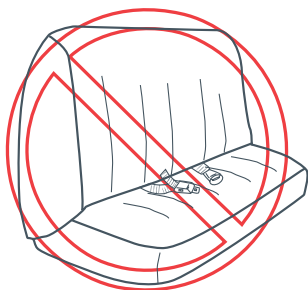

Lap Belt Only

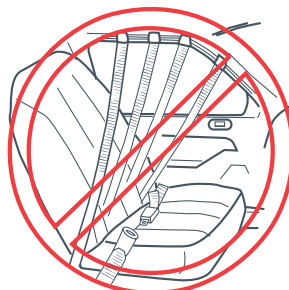

**Passive Restraints
Motorized Shoulder Belt**

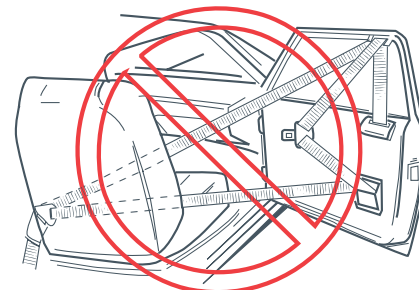

**Passive Restraints
Lap Or Shoulder Belt
Mounted On Front Door**

Section 7 - Booster Car Seat Use

For use with children who weigh between 33 and 100 lbs. (15 and 45 kg) and whose height is between 33 and 57 inches (84 and 145 cm).

Securing Child With Lap And Shoulder Belt:

- 1** Select a vehicle seat position which has a lap and shoulder belt.
- 2** If adjustable, position vehicle seat back in the upright position.
- 3** Place Booster Car Seat **forward-facing** on vehicle seat and contacting vehicle seat back (**fig. a**).
DO NOT place the Booster Car Seat in a seating position that has only a vehicle lap belt (**fig. b**).
- 4** Position child in Booster Car Seat with child's back flat against vehicle seat back (**fig. c**).
- 5** Pull the vehicle lap and shoulder belt across front of child and buckle seat belt. Position vehicle lap belt under both armrests **①** and snugly adjust lap belt. Place the vehicle shoulder belt over child's chest onto shoulder **②** (**fig. c**).
- 6** Snugly adjust the lap and shoulder belt according to the instructions in the vehicle owner's manual.
 - Lap belt **MUST** stay under both armrests.
 - **DO NOT** place shoulder belt under child's arm (**fig. d**) or behind child.

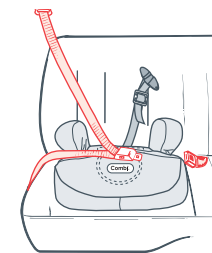

(fig. a)

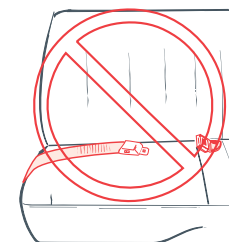

(fig. b)

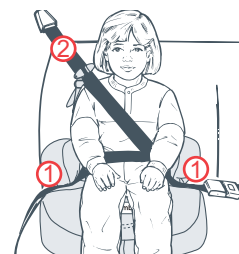

(fig. c)



(fig. d)

7 Check fit of vehicle belts:

- The lap belt **MUST** be low on the hips contacting the thighs.
- The shoulder belt **MUST** contact the chest and be centered on the shoulder.

If the vehicle shoulder belt contacts the child's neck or face or is off child's shoulder, use vehicle shoulder belt adjuster to reposition shoulder belt.

If a vehicle shoulder belt adjuster is not available or does not properly position shoulder belt, use shoulder belt positioner provided with this Booster Car Seat ①.

NOTE: Some active children may pull belt out or change position of belts.

- * Do not allow child to slide down under lap belt moving lap belt onto stomach or abdomen.
- * Do not allow child to place shoulder belt under arm or behind back.

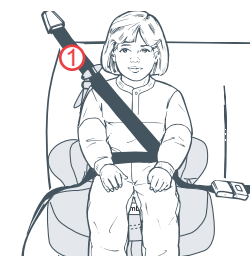

(fig. e)

8 Use and adjustment of shoulder belt positioner.

- To place shoulder belt into shoulder belt positioner:
Pinch sides of vehicle shoulder belt together and insert shoulder belt into shoulder belt positioner as shown (fig. f).

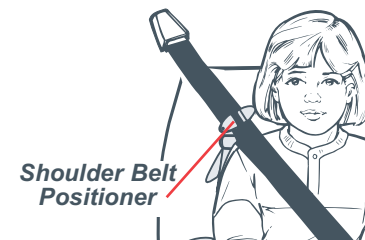

(fig. f)

- To adjust height:

Adjust the height of the shoulder belt positioner to center the vehicle shoulder belt over the child's shoulder (fig. g). To adjust, pull the webbing up or down through the web adjuster (fig. g).

NOTE: Some shoulder belts with emergency locking retractors allow child to pull belt out and change position of belt. Use of shoulder belt positioner helps maintain proper position of shoulder belt.

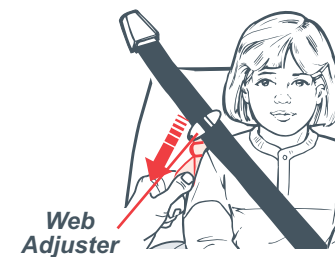

(fig. g)

Section 8 - Additional Information

Certification

This child restraint system conforms to all applicable Federal Motor Vehicle Safety Standards for use in motor vehicles.

Aircraft Use

This restraint (Booster Car Seat) is **NOT** certified for aircraft use (see label on car seat).

An aircraft does not have lap and shoulder belt systems required to use with Booster Car Seats.

Warm Weather

Car seat parts can get very hot in the sun or warm weather.

To avoid burns, always check before putting child in car seat.

Vehicle Seat Protection

Protect vehicle seat. Use a thin car seat mat, thin towel, or thin blanket under and behind car seat.

Instruction Manual Storage

Store instruction manual under seat pad.

Car Seat Useful Life

DO NOT use after 7 years from date of manufacture on label.

Section 9 - Registration Information

Child restraints (car seats) could be recalled for safety reasons. You must register this restraint to be reached in a recall. Fill out the registration card attached to car seat and mail today or send your name, address, and the restraint's model number and manufacturing date to:

Combi USA
1962 Hwy 160 West, #100
Fort Mill, SC 29708

or call 1-800-992-6624

or fax 1-803-548-3663

or log onto www.combi-intl.com

For recall information:

- Call the U.S Government's Auto Safety Hotline at 1-800-424-9393 (202-366-0123 in D.C. area)
- Log onto the National Highway Traffic Safety Administration recall website at:
<http://www-odi.nhtsa.dot.gov/cars/problems/recalls/childseat.cfm>
- Contact Combi USA (see contact information above)

Section 10 - Care and Cleaning

Removing Seat Pad:

- Carefully slide pad up off of seat and then pull off of armrests.
- Reverse above step for replacing pad.

Cleaning Seat Pad:

- Hand wash in cool water and mild soap. Roll in towel to remove excess water and lay flat to dry.

Cleaning Shell:

- Wipe with mild solution of soap and water. Avoid wetting labels.
- Rinse with clean water.
- Never use "household" detergents or solvents.

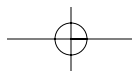
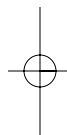
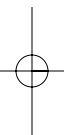
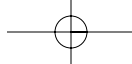

Combi®

Keep this instruction manual for future use.
Store under seat pad.

© 2004 Combi USA

8400-04/04 (EN)

**Combi USA • 1962 Hwy 160 West, #100 • Fort Mill, SC 29708 •
Customer Service Telephone 1-800-992-6624 • Se Habla Español 1-803-548-6633 •
Fax 1-803-548-3663 • www.combi-intl.com •
10:00 a.m. - 5:00 p.m. Eastern Time • Monday - Friday**