

Fisher-Price®

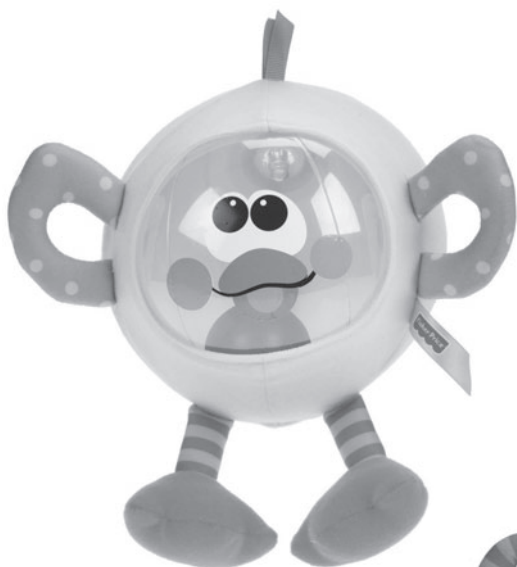

T5127



T5126

Please keep this instruction sheet for future reference,
at it contains important information.

Adult assembly required.

No tools required for assembly.

Each sold separately and subject to availability.

www.fisher-price.com

Setup

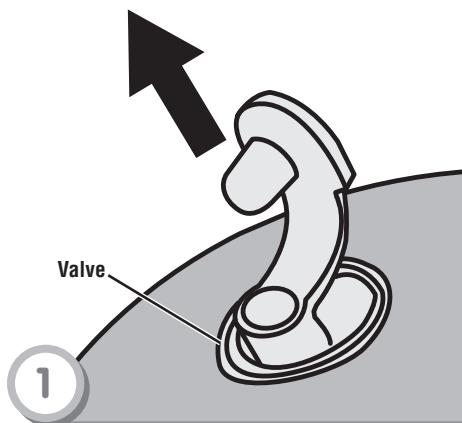

- Locate the valve on the ball and pull it out. Lift the valve cover.

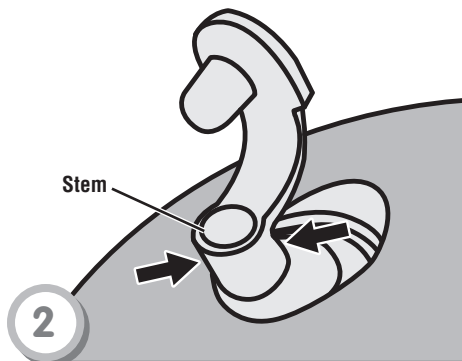

- Squeeze the stem on the valve to inflate the toy. Do not over-inflate.

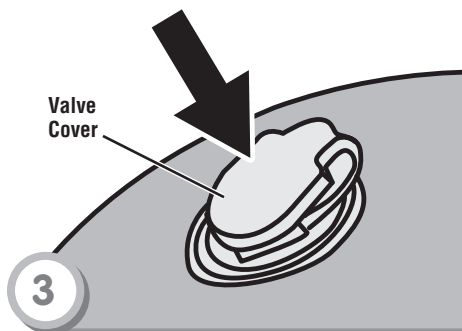

- Close the valve cover once inflated and push the valve back inside the toy.

Consumer Information



CONSUMER ASSISTANCE

1-800-432-5437 (US & Canada)
1300 135 312 (Australia)

service.fisher-price.com

Fisher-Price, Inc., 636 Girard Avenue, East Aurora, NY 14052.
Hearing-impaired consumers: 1-800-382-7470.

Outside the United States:

Canada: Mattel Canada Inc., 6155 Freemont Blvd.,
Mississauga, Ontario L5R 3W2; www.service.mattel.com.

Great Britain: Mattel UK Ltd, Vanwall Business Park,
Maidenhead SL6 4UB. Helpline: 01628 500303.
www.service.mattel.com/uk

Mattel Europa, B.V., Gondel 1, 1186 MJ Amstelveen, Nederland.

Australia: Mattel Australia Pty. Ltd., 658 Church Street,
Locked Bag #870, Richmond, Victoria 3121 Australia.

New Zealand: 16-18 William Pickering Drive,
Albany 1331, Auckland.

Care

- **ONLY the cover** can be machine washed in cold water on the gentle cycle. Do not use bleach. Tumble dry on low heat. The ball is surface wash only with a damp cloth.
- To remove the cover, pull the valve out.
- Open the valve cover and squeeze the ball to deflate it. Remove the cover.
- After washing, replace the cover and follow the setup instructions to reinflate the ball.