

Clarion®

Owner's manual
Mode d'emploi
Manual de instrucciones

■ Contents

English

1. PRECAUTIONS	2
2. CONTROLS	3
3. BUTTON TERMINOLOGY	4
4. FEATURES	5
5. HANDLING COMPACT DISCS	6
6. DCP (Detachable Control Panel)	7
7. REMOTE CONTROL (DB335 only)	8
8. OPERATION	10
9. TROUBLESHOOTING	14
10. ERROR DISPLAYS	15
11. SPECIFICATIONS	16

■ Table des matières

Français

1. PRÉCAUTIONS	17
2. COMMANDES	3
3. NOMENCLATURE DES TOUCHES	18
4. CARACTÉRISTIQUES	19
5. MANIPULATION DES DISQUES COMPACTS	20
6. CLAVIER DE COMMANDE AMOVIBLE (DCP)	21
7. TÉLÉCOMMANDE (DB335 uniquement)	22
8. FONCTIONNEMENT	24
9. DÉPISTAGE DES PANNES	28
10. AFFICHAGE DES ERREURS	29
11. SPÉCIFICATIONS	30

■ Índice

Español

1. PRECAUCIONES	31
2. CONTROLES	3
3. NOMENCLATURA DE LOS BOTONES	32
4. CARACTERÍSTICAS	33
5. MANEJO DE LOS DISCOS COMPACTOS	34
6. PANEL DE CONTROL DESMONTABLE (DCP)	35
7. CONTROLADOR REMOTO (DB335 solamente)	36
8. OPERACIÓN	38
9. SOLUCIÓN DE PROBLEMAS	42
10. INDICACIONES DE ERROR	43
11. ESPECIFICACIONES	44

COMPACT
disc
DIGITAL AUDIO

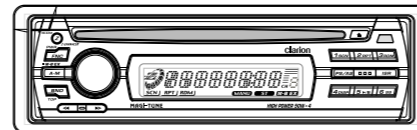

DB335 DB235

AM/FM CD PLAYER

RADIO AM/FM-LECTEUR CD

RADIO AM/FM Y REPRODUCTOR CD

1. PRECAUTIONS

- When the inside of the car is very cold and the player is used soon after switching on the heater, moisture may form on the disc or the optical parts of the player and proper playback may not be possible. If moisture forms on the disc, wipe it off with a soft cloth. If moisture forms on the optical parts of the player, do not use the player for about one hour and the condensation will disappear naturally to allow normal operation.
- Driving on extremely bumpy roads which cause severe vibration may cause the sound to skip.
- This unit uses a precision mechanism. Even in the event that trouble arises, never open the case, disassemble the unit, or lubricate the rotating parts.

This equipment has been tested and found to comply with the limits for a Class B digital device, pursuant to Part 15 of the FCC Rules. These limits are designed to provide reasonable protection against harmful interference in a residential installation. This equipment generates, uses, and can radiate radio frequency energy and, if not installed and used in accordance with the instructions, may cause harmful interference to radio communications. However, there is no guarantee that interference will not occur in a particular installation. If this equipment does cause harmful interference to radio or television reception, which can be determined by turning the equipment off and on, the user is encouraged to consult the dealer or an experienced radio/TV technician for help.

⚠ CAUTION

USE OF CONTROLS, ADJUSTMENTS, OR PERFORMANCE OF PROCEDURES OTHER THAN THOSE SPECIFIED HEREIN, MAY RESULT IN HAZARDOUS RADIATION EXPOSURE. THE COMPACT DISC PLAYER SHOULD NOT BE ADJUSTED OR REPAIRED BY ANYONE EXCEPT PROPERLY QUALIFIED SERVICE PERSONNEL.

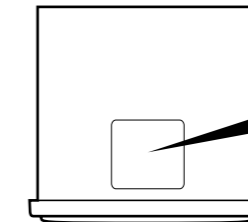

Bottom View of Source Unit

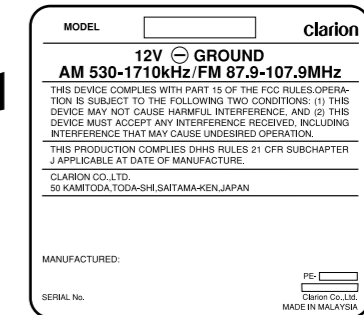

INFORMATION FOR USERS:

CHANGES OR MODIFICATIONS TO THIS PRODUCT WILL VOID THE WARRANTY AND WILL VIOLATE FCC APPROVAL.

Be sure to unfold and read the next page.
Veuillez déployer et vous référer à la page suivante.
Cerciórese de desplegar y de leer la página siguiente.

Clarion Co., Ltd.

All Rights Reserved. Copyright © 2002: Clarion Co., Ltd.
Printed in Malaysia / Imprimé à Malaisie / Impreso en Malasia

PE-2582B
PE-2585B
280-7881-00

2. CONTROLS / COMMANDES / CONTROLES

Note: Be sure to unfold this page and refer to the front diagrams as you read each chapter.

Remarque: Veuillez déployer cette page et vous référer aux schémas quand vous lisez chaque chapitre.

Nota: Cuando lea los capítulos, despliegue esta página y consulte los diagramas.

SOURCE UNIT / APPAREIL PILOTE / UNIDAD FUENTE

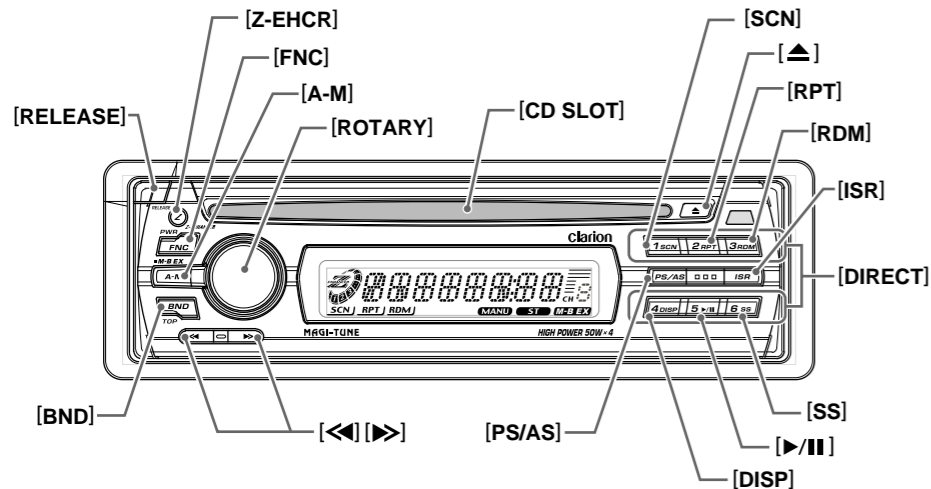

DISPLAY AFFICHEUR VISUALIZADOR



Note: The above illustration shows the front panel of the model DB335/DB235.

Remarque: L'illustration ci-dessous montre le panneau avant du modèle DB335/DB235.

Nota: La ilustración de arriba muestra el panel frontal del modelo DB335/DB235.

3. BUTTON TERMINOLOGY

Note:

• Be sure to read this chapter referring to the front diagrams of chapter 2. CONTROLS on page 3 (unfold).

Names of the Buttons and their Functions

[RELEASE] button

- Press the [RELEASE] button to unlock the DCP.

[Z-EHCR] button

- Use the button to select one of the three types of sound characteristics already stored in memory. (Z-Enhancer)

[FNC] button

- Press the button to turn on the power. Press and hold the button for 1 second or longer to turn off the power.
- Switches the operation mode among the radio mode, etc.

[A-M] button

- Press and hold the button for 1 second or longer to switch the MAGNA BASS EX on/off.
- Use the button to switch to the audio mode (bass/treble, balance/fader)

[ROTARY] knob

- Adjust the volume by turning the knob clockwise or counterclockwise.
- Use the knob to perform various settings.

[CD SLOT]

- CD insertion slot.

[SCN] button

- Performs scan play for 10 seconds for each track while in the CD mode.

[▲] button

- Ejects a CD when it is loaded into the unit.

[RPT] button

- Plays repeatedly while in the CD mode.

[RDM] button

- Performs random play while in the CD mode.

[ISR] button

- Recalls ISR radio station in memory.
- Press and hold for 2 seconds or longer: Stores current station into ISR memory (radio mode only).

[DIRECT] button

- Stores a station into memory or recall it directly while in the radio mode.

[SS] button

- Press the [SS] button while keeping the [BND] button pressed, to turn the screen saver function on or off.

[▶/||] button

- Plays or pauses a CD while in the CD mode.

[DISP] button

- Press the [DISP] button while keeping the [BND] button pressed, to switch the display indication (Main display, clock display).

[PS/AS] button

- Performs preset scan while in the radio mode. When the button is pressed and held, auto store is performed.

[◀▶] button

- Selects a station while in the radio mode or selects a track when listening to a CD.
- Press and hold the button for 1 second or longer to switches the fast-forward/fast-backward.

[BND] button

- Switches the band, or seek tuning or manual tuning while in the radio mode.
- Plays a first track while in the CD mode.

4. FEATURES

- Rotary Encoder Volume Control
- Z-Enhancer with 3 Mode Sound Selector
- MAGNA BASS EX
- **MAGI-TUNE**® FM Reception System
- Seek / Manual Up / Down Tuning
- 8-Times Oversampling Digital Filter and Dual 1-Bit D/A Converters
- Preset Station Scan (PS), Automatic Store (AS)
- 2-Channel RCA Line Level Output
- AM 1 band, FM 3 bands each 6 channels total 24 channels, Preset Memory Function
- Repeat/Random Play/Intro Music Scan
- 200W (50 W × 4) Maximum Power Output

English

5. HANDLING COMPACT DISCS

This unit has been designed specifically for playback of compact discs bearing the  mark. No other discs can be played.

To remove the compact disc from its storage case, press down on the center of the case and lift the disc out, holding it carefully by the edges.

Removing the disc

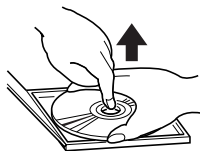

Proper way to hold the compact disc

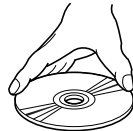

English

Always handle the compact disc by the edges. Never touch the surface.

To remove fingermarks and dust, use a soft cloth, and wipe in a straight line from the center of the compact disc to the circumference.

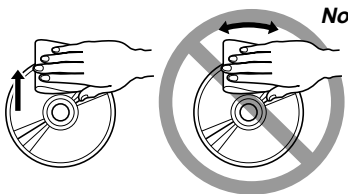

New discs may have some roughness around the edges. The unit may not work or the sound may skip if such discs are used. Use a ball-point pen, etc. to remove roughness from the edge of the disc.

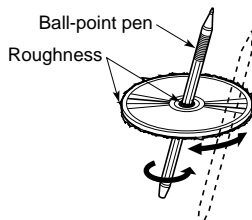

Note on Compact Discs

Never stick labels on the surface of the compact disc or mark the surface with a pencil or pen.

No

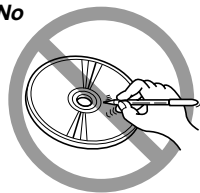

Do not use any solvents such as commercially available cleaners, anti-static spray, or thinner to clean compact discs.

No

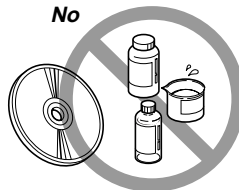

Do not use compact discs that have large scratches, are misshapen, or cracked, etc. Use of such discs will cause misoperation or damage.

No

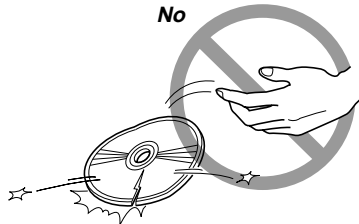

Do not expose compact discs to direct sunlight or any heat source.

No

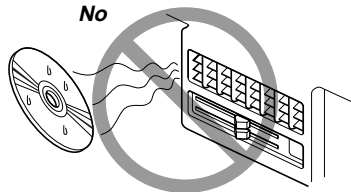

Note:

- Do not use commercially available CD protection sheets or discs equipped with stabilizers, etc. These may get caught in the internal mechanism and damage the disc.

6. DCP (Detachable Control Panel)

The control panel can be detached to prevent theft. When detaching the control panel, store it in the DCP (DETACHABLE CONTROL PANEL) case to prevent scratches.

We recommend taking the DCP with you when leaving the car.

Removing the DCP

1. Press the [FNC] button for 1 second or longer to switch off the power.
2. Press in the [RELEASE] button.

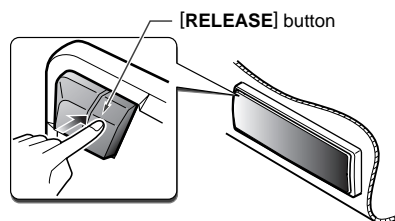

* The DCP is unlocked

3. Remove the DCP.

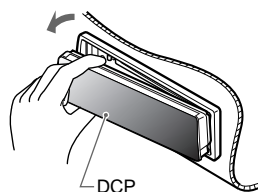

Attaching the DCP

1. Insert the right side of the DCP into the main unit.
2. Insert the left side of the DCP into the main unit.

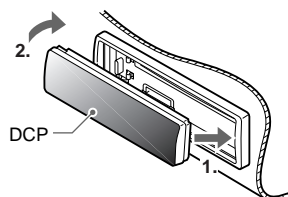

Storing the DCP in the DCP Case

Hold the DCP, in the orientation as shown in the figure below, and put it into the supplied DCP case. (Ensure the DCP is in the correct orientation.)

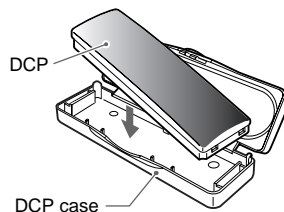

CAUTION

- The DCP can easily be damaged by shocks. After removing it, place it in a protective case and be careful not to drop it or subject it to strong shocks.
- When the release button is pressed and the DCP is unlocked, the car's vibrations may cause it to fall. To prevent damage to the DCP, always store it in a protective case after detaching it.
- The rear connector that connects the source unit and the DCP is an extremely important part. Be careful not to damage it by pressing on it with fingernails, pens, screwdrivers, etc.

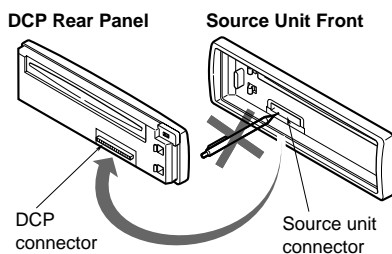

Note:

- If the DCP is dirty, wipe off with a soft, dry cloth only.

English

7. REMOTE CONTROL (DB335 only)

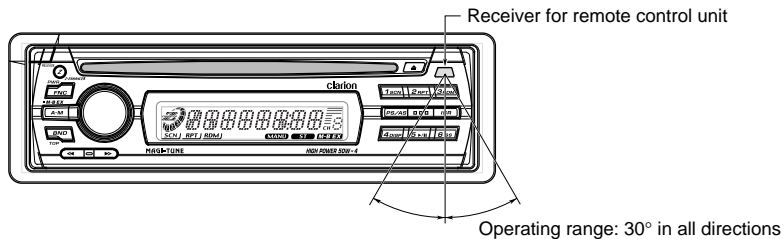

English

Remote Control Unit

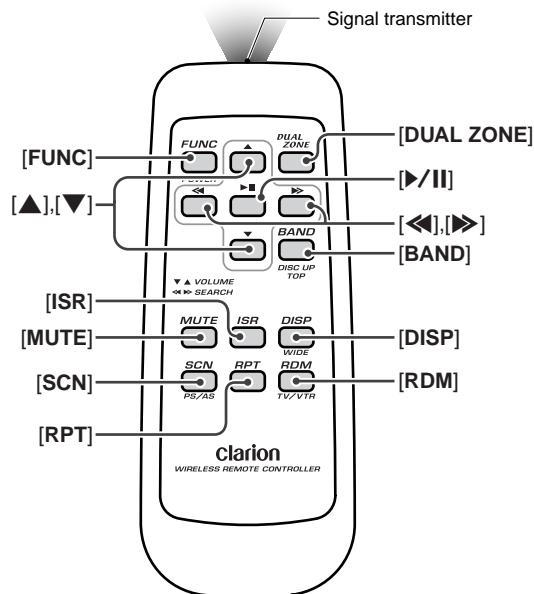

Inserting the Batteries

1. Turn the remote control unit over, then slide the rear cover in the direction of the arrow.
2. Insert the AA (SUM-3, IECR-6/1.5V) batteries that came with the remote control unit facing in the directions shown in the figure, then close the rear cover.

Notes:

Using batteries improperly can cause them to explode. Take note of the following points:

- When replacing batteries, replace both batteries with new ones.
- Do not short-circuit, disassemble or heat batteries.
- Do not dispose of batteries into fire or flames.
- Dispose of spent batteries properly.

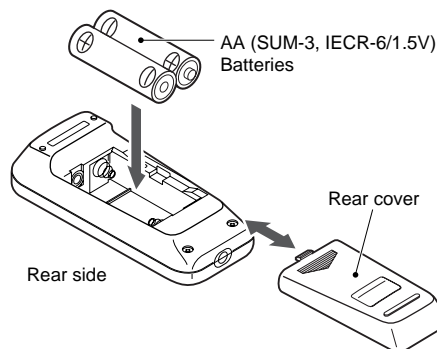

Functions of Remote Control Unit Buttons

Mode Button	Radio	CD
[FUNC]	Turns power on and off. When pressed and held for 1 second: Turns power off. Switches between radio and CD.	
[BAND]	Switches reception band.	Plays the first track. Top play.
[▲], [▼]	Increases and decreases volume (in all modes).	
[◀], [▶]	Moves preset channels up and down.	Moves tracks up and down. When pressed and held for 1 second: Fast-forward/fast-backward.
[▶/II]	Turns mute on and off.	Switches between playback and pause.
[MUTE]	Turns mute on and off.	Switches between playback and pause.
[ISR]	Recalls ISR radio station in memory. Press and hold for 2 seconds or longer: Stores current station into ISR memory (radio mode only).	
[DISP]	Switches among main display, clock display.	
[SCN]	Preset scan. When pressed and held for 2 seconds: Auto store.	Scan play.
[RPT]	No function.	Repeat play.
[RDM]	No function.	Random play.

- * Some of the corresponding buttons on the main unit and remote control unit have different functions.
- * DUAL ZONE button is not available.

English

8. OPERATION

Note:

- Be sure to read this chapter referring to the front diagrams of chapter 2. CONTROLS on page 3 (unfold).

Basic Operations

⚠ CAUTION

When this unit is turned on, starting and stopping the engine of a car with its volume raised to the maximum level may harm your hearing. Be careful about adjusting the volume.

Turning ON the Power and Adjusting the Volume

- 1) Press the [FNC] button.
 - * To turn off the power, press the [FNC] button for 1 second or longer.
- 2) Press the [FNC] button and select another operation mode. Every time the [FNC] button is pressed, the display changes the operation mode as:
Radio → CD → Radio

Notes:

- The operation mode not connected to the unit will not be selected.
 - If the CD mode is selected when no disc is inserted, the display flashes "NO DISC".
- 3) Turning the [ROTARY] knob clockwise increases the volume; turning it counterclockwise decreases the volume.
 - * The volume level is from 0 (minimum) to 33 (maximum).

Audio Mode Adjustments

Press the [A-M] button to select the adjustment mode. The mode switches as follows each time the [A-M] button is pressed:

BASS → TREB → BAL → FAD → Previous mode

MAGNA BASS EX on and off

- 1) Press and hold the [A-M] button for 2 seconds or longer, then the Bass will extra boost.

Note:

- MAGNA BASS EX effect depend on volume level.

Adjusting the Bass

- 1) Press [A-M] button and select "BASS".
- 2) Turning the [ROTARY] knob clockwise emphasizes the bass; turning it counterclockwise attenuates the bass.
 - * The factory default setting is "0". (Adjustment range: -7 to +7)
- 3) When the adjustment is complete, press [A-M] button several times until the function mode is reached.

Adjusting the Treble

- 1) Press [A-M] button and select "TREB".
- 2) Turning the [ROTARY] knob clockwise emphasizes the treble; turning it counterclockwise attenuates the treble.
 - * The factory default setting is "0". (Adjustment range: -7 to +7)
- 3) When the adjustment is complete, press [A-M] button several times until the function mode is reached.

Adjusting the Balance

- 1) Press [A-M] button and select "BAL".
- 2) Turning the [ROTARY] knob clockwise emphasizes the sound from the right speaker; turning it counterclockwise emphasizes the sound from the left speaker.
 - * The factory default setting is "0". (Adjustment range: L13 to R13)
- 3) When the adjustment is complete, press [A-M] button several times until the function mode is reached.

Adjusting the Fader

- 1) Press [A-M] button and select "FAD".
- 2) Turning the [ROTARY] knob clockwise emphasizes the sound from the front speakers; turning it counterclockwise emphasizes the sound from the rear speakers.
 - * The factory default setting is "0". (Adjustment range: F12 to R12)
- 3) When the adjustment is complete, press [A-M] button several times until the function mode is reached.

Setting the Z-enhancer

This unit comes with three types of sound tone effects stored in memory. Select the one you prefer.

* The factory default setting is "Z-EHCR OFF".

Each time you press [Z-EHCR] button, the tone effect changes in the following order.

"Z-ENHANCER 1" → "Z-ENHANCER 2" →

"Z-ENHANCER 3" → "Z-EHCR OFF" →

"Z-ENHANCER 1"...

- Z-ENHANCER 1: bass emphasized
- Z-ENHANCER 2: treble emphasized
- Z-ENHANCER 3: bass and treble emphasized
- Z-EHCR OFF: no sound effect

Switching the Clock Display

Press and hold the [BND] button, and then press the [DISP] button to switch between the operation mode and the clock display.

Setting the Clock

- 1) Press and hold the [BND] button, and then press the [DISP] button to display the clock display.
- 2) Press and hold the [BND] button, and then press the [DISP] button for 2 seconds or longer.
- 3) Press the [▶▶] button, then set the current minute.
- 4) Press the [◀◀] button, then set the current hour.
- 5) Press the [BND] button, then the clock is set.

Notes:

- If you select another operation mode while you are setting the clock, the clock setting operation will be canceled.
- If you remove the vehicle's battery for a check or repair, the clock will be reset, so you must set it again.

Screen Saver mode

- 1) Press and hold the [BND] button, and then press the [SS] button to switch on, and off Screen saver mode

* The factory default setting is "SS On".

Radio Mode Operations

FM Reception

For enhanced FM performance the **MAGI-TUNE®** tuner includes signal actuated stereo control and Multipath noise reduction circuits.

Listening to the Radio

- 1) Press the [FNC] button to select the radio mode, then the radio will be on.
- 2) To select a preset band, press the [BND] button, then select one of the preset bands such as FM1, FM2, FM3, or AM. Every time the [BND] button is pressed, the display will change as:
FM1 → FM2 → FM3 → AM → FM1
- 3) Press the [◀◀][▶▶] button, then the station at which there is a broadcast will be selected (Seek selection).

Manual Tuning

- 1) Press the [BND] button, then select FM1, FM2, FM3 or AM.
- 2) Press and hold the [BND] button for 1 second or longer, then the display will show "MANU", which means that a manual selection function is on.
- 3) Press the [◀◀][▶▶] button and select the right station.

Seek Tuning

- 1) Press the [BND] button, then select FM1, FM2, FM3 or AM.
- 2) If the "MANU" on the display is on, press and hold the [BND] button for 1 second or longer. When the "MANU" display is off, the seek selection function is on.
- 3) Press the [◀◀][▶▶] button, then when it selects the station in which there is a broadcast, it automatically stops.

Preset Memory Function

Preset Memory Function can store up to 24 stations: six stations for each of FM1, FM2, FM3 and AM.

Note:

- When the preset memory function is used, all the content of the memory will be erased.

Manual memory function

- 1) Press the **[BND]** button, and select the band you want to store in the memory.
- 2) Press the **[◀][▶]** button then select the station you want to store in the memory.
- 3) Press and hold the **[DIRECT]** button for 2 seconds or longer, then the station will be stored in the memory.

Auto store function (Automatic Station Store)

- 1) Press the **[BND]** button, then select the band you want to store in the memory.
- 2) Press and hold the **[PS/AS]** button for 2 seconds or longer, then the station at which the reception is the strongest will be automatically stored in the memory.

Note:

- When the number of stations stored is less than six, the previous content of the memory for each direct button will be retained.

Preset Scanning (Preset Station Scan)

When the **[PS/AS]** button is pressed, the "SCN" will indicated preset memory numbers and the stations are tuned in for 7 seconds each in the order in which they were stored. Press the **[PS/AS]** button again to cancel the preset scanning mode.

Instant Station Recall (ISR)

With this function, a specific radio station can be recalled from any mode.

ISR memory

- 1) Press the **[FNC]** button, then select the radio mode.
- 2) Select the radio station which you want to store in the memory.
- 3) Press and hold the **[ISR]** button for 2 seconds or longer.

Recalling ISR

Press the **[ISR]** button then the display will show "ISR", then the radio station previously memorized will be selected. Press the **[ISR]** button again to disengage the unit from the Recalling ISR function.

Area Change

Use this function when you are using the car stereo anywhere outside the U.S.

Switchable frequency spacing

This car stereo is initially set to tune in frequency intervals of 10 kHz for AM and 200 kHz for FM, the standard calibrations in the U.S. When using the unit outside the U.S., use the following procedure to switch the frequency range.

The table below lists the frequency specifications for the U.S. and other countries.

		Initial Setting (U.S. standard)	New Setting (outside U.S.)
AM	Frequency spacing	10 kHz	9 kHz
	Frequency range	530 to 1,710 kHz	531 to 1,602 kHz
FM	Frequency spacing	200 kHz	50 kHz
	Frequency range	87.9 to 107.9 MHz	87.0 to 108 MHz

Switching the area change Outside U.S. (New Setting)

While pressing the **[A-M]** button, press the **[RPT]** button, then "outside U.S." will be selected.

Inside U.S. standard (Initial Setting)

While pressing the **[A-M]** button, press the **[SCN]** button, then the "U.S. standard" will be selected.

CD Mode Operations

Loading a Disc

Insert the disc into the CD insertion slot with its label side up, then the CD will start playing.

For 5-inch (12 cm) CD For 3-inch (8 cm) single CD

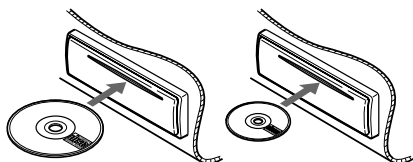

* When inserting a single CD (3" (8 cm)), insert it from the center of the slot.

* When inserting a single CD (3" (8 cm)), do not connect an adapter.

Notes:

- Some CDs recorded in CD-R/CD-RW mode may not be usable.

Listening to the Disc already Inserted

Press the [FNC] button to select the CD mode, the CD will start playing.

Stopping (pausing) Playback

Press the [▶/II] button.

Press the [▶/II] button again to resume playback.

Ejecting the CD

Press the [▲] button, then the CD will be ejected.

Note:

- If the ejected CD is left as it is, it will be reloaded after 15 seconds. However, single CDs will not be reloaded, so make sure to remove them.

Top Function

Press the [BND] button, then the CD will start playing from the first song (track number 1).

Selecting Tracks (songs)

Press the [◀|▶] button.

▶: Playback will start from the next track.

◀: Playback will start from the beginning of the track currently playing. When this button is pressed again, the CD will play from the previous track.

Fast-Forward and Fast-Backward

Press and hold the [◀|▶] button.

▶: To fast-forward

◀: To fast-backward

* Pressing the [◀|▶] button for 1 second or longer will move forward or backward 3 times faster than normal play, and pressing it for 3 seconds or longer will do the operation 30 times faster.

Scan Play (Intro Music Scan)

Press the [SCN] button, then the display shows "SCN", then the CD will play the first 10 seconds of each track of the whole disc. Press the [SCN] button again to disengage the unit from scan play.

* A scan play will start from the track following the one currently playing.

Repeat Play

Press the [RPT] button, then the display shows "RPT", then the track currently playing will be played repeatedly. Press the [RPT] button again to disengage the unit from repeat play.

Random Play

Press the [RDM] button, then the display will show "RDM", then the entire tracks on the disc will be played at random. Press the [RDM] button again to disengage the unit from random play.

English

9. TROUBLESHOOTING

Problem	Cause	Solution
Power does not turn on. (No sound is produced.)	Fuse is blown.	Replace with a fuse of the same amperage. If the fuse blows again, consult your store of purchase.
	Incorrect wiring.	Consult your store of purchase.
Compact disc cannot be loaded.	Another compact disc is already loaded.	Eject the compact disc before loading the new one.
Sound skips or is noisy.	Compact disc is dirty.	Clean the compact disc with a soft cloth.
	Compact disc is heavily scratched or warped.	Replace with a compact disc with no scratches.
Sound is bad directly after power is turned on.	Water droplets may form on the internal lens when the car is parked in a humid place.	Let dry for about 1 hour with the power on.

English

10. ERROR DISPLAYS

- To protect the system, this unit has been equipped with self diagnostic functions. If a fault arises, a warning is issued by various error displays. Follow the corrective measures and remove the fault.

Error Display	Corrective Measure
ER2	This error display indicates that a fault has arisen in the mechanism of the source unit (for example, the disc cannot be ejected). → Check the source unit.
ER3	This error display indicates that the pickup focus is off because of a scratched disc or some other factor during source unit play. → Check the compact disc.
ER6	This indicates that the CD's TOC (table of contents) cannot be read, for example because the selected disc is upside-down.

English

11. SPECIFICATIONS

FM Tuner

Frequency Range: 87.9 MHz to 107.9 MHz
 Usable Sensitivity: 11 dBf
 50 dB Quieting Sensitivity: 17 dBf
 Alternate Channel Selectivity: 75 dB
 Stereo Separation (1 kHz): 35 dB
 Frequency Response (± 3 dB): 30 Hz to 15 kHz

AM Tuner

Frequency Range: 530 kHz to 1,710 kHz
 Usable Sensitivity: 25 μ V

CD Player

System: Compact disc audio system
 Usable Discs: Compact disc
 Frequency Response: 10 Hz to 20 kHz (± 1 dB)
 Signal-to-Noise Ratio: 100 dB (1 kHz) IHF-A
 Dynamic Range: 95 dB (1 kHz)
 Harmonic Distortion: 0.01%

Audio

Maximum Power Output:
 200 W (50 W \times 4 ch)
 Continuous Average Power Output:
 17 W \times 4, into 4 Ω , 20 Hz to 20 kHz, 1% THD
 Bass Control Action (30 Hz): ± 14 dB
 Treble Control Action (10 kHz): ± 14 dB
 Line Output (with A/C 1 kHz, 10 k Ω): 1.7 V

General

Power Supply Voltage: 14.4 V DC (10.8 V to 15.6 V allowable), negative ground
 Current Consumption: Less than 15 A
 Speaker Impedance: 4 Ω (4 Ω to 8 Ω allowable)
 Weight: 2.42 lb. (1.1 kg)
 Dimensions:
 7" (178 mm) Width \times 2" (50 mm) Height \times
 6" (152 mm) Depth

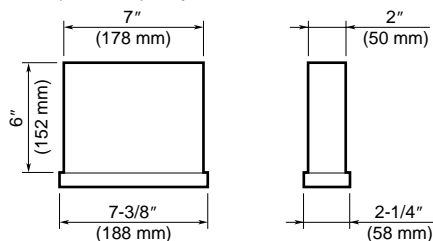

Notes:

- Specifications comply with EIA Standards.
- Specifications and design are subject to change without notice for further improvement.
- Please make sure when connecting external power amplifier, that you properly, to the car chassis, ground the amplifier.
- If this is not done, severe damage to the source unit may happen.