

Fisher-Price®

K5520



[www.fisher-price.com](http://www.fisher-price.com)

## Consumer Information

### **WARNING**

To prevent strangulation, never place product in a crib or playpen where baby could become entangled. **NEVER** add strings or ties to the product.

- Please keep this instruction sheet for future reference, as it contains important information.
- Requires five “AA” (LR6) alkaline batteries (not included).
- Battery installation and set-up should be done by an adult.
- Tool required for battery installation: Phillips Screwdriver (not included).
- If you will not use this product for an extended period of time, we recommend turning power completely off. Simply slide the power/volume control switch on the back of the dashboard to off . Be sure to follow the set-up instructions, and turn power back on for future use.
- If sounds or lights from this toy become faint or stop, it's time for an adult to replace the batteries!

#### Visit us on line at [www.service.fisher-price.com](http://www.service.fisher-price.com)

Call Fisher-Price® Consumer Relations, toll-free at **1-800-432-5437**, 9 AM – 7 PM (EST) Monday through Friday and 11 AM – 7 PM (EST) Saturday. Hearing-impaired consumers using TTY/TDD equipment, please call **1-800-382-7470**. Write to us at: Fisher-Price® pt Consumer Relations, 636 Girard Avenue, East Aurora, New York 14052.

#### For countries outside the United States:

**CANADA: Questions? 1-800-432-5437.** Mattel Canada Inc., 6155 Freemont Blvd., Mississauga, Ontario L5R 3W2; [www.service.mattel.com](http://www.service.mattel.com).

**GREAT BRITAIN:** [Mattel UK Ltd, Vanwall Business Park, Maidenhead SL6 4UB](http://Mattel UK Ltd, Vanwall Business Park, Maidenhead SL6 4UB). Helpline: 01628 500303. [www.service.mattel.com/uk](http://www.service.mattel.com/uk)

**AUSTRALIA:** Mattel Australia Pty. Ltd., 658 Church Street, Locked Bag #870, Richmond, Victoria 3121 Australia. Consumer Advisory Service 1300 135 312.

**NEW ZEALAND:** 16-18 William Pickering Drive, Albany 1331, Auckland.

**ASIA:** Mattel East Asia Ltd, Room 1106, South Tower, World Finance Centre, Harbour City, Tsimshatsui, HK, China.

## FCC Statement

### (United States Only)

This equipment has been tested and found to comply with the limits for a Class B digital device, pursuant to Part 15 of the FCC Rules. These limits are designed to provide reasonable protection against harmful interference in a residential installation.

This equipment generates, uses and can radiate radio frequency energy and, if not installed and used in accordance with the instructions, may cause harmful interference to radio communications. However, there is no guarantee that interference will not occur in a particular installation. If this equipment does cause harmful interference to radio or television reception, which can be determined by turning the equipment off and on, the user is encouraged to try to correct the interference by one or more of the following measures:

- Reorient or relocate the receiving antenna.
- Increase the separation between the equipment and receiver.
- Consult the dealer or an experienced radio/TV technician for help.

Note: Changes or modifications not expressly approved by the manufacturer responsible for compliance could void the user's authority to operate the equipment.

## Battery Installation

**Hint:** We recommend alkaline batteries for longer battery life.

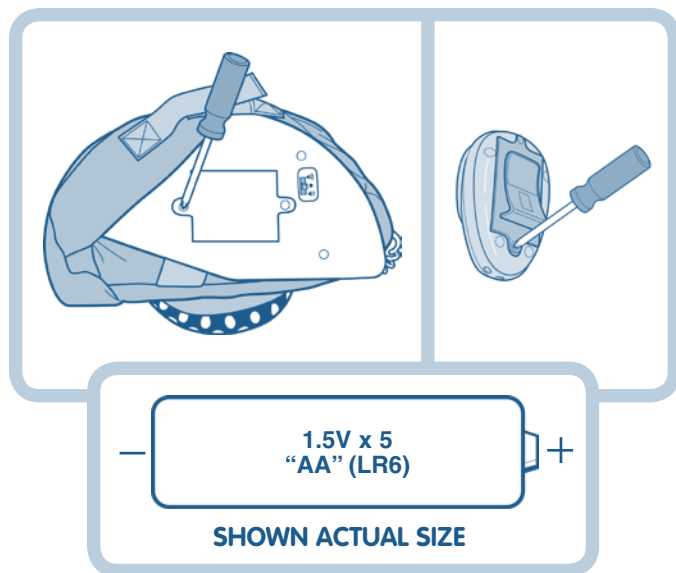

### Dashboard

- Turn the dashboard face down. Open the fasteners on the cover to locate the battery compartment on the dashboard.
- Loosen the screws in the battery compartment door with a Phillips screwdriver. Remove the battery compartment door.
- Insert three "AA" (LR6) **alkaline** batteries.
- Close the battery compartment door and tighten the screws with a Phillips screwdriver. Do not over-tighten.

### Remote Control

- Loosen the screws in the battery compartment door with a Phillips screwdriver. Remove the battery compartment door.
- Insert two "AA" (LR6) **alkaline** batteries.
- Close the battery compartment door and tighten the screws with a Phillips screwdriver. Do not over-tighten.



- Protect the environment by not disposing of this product with household waste (2002/96/EC). Check your local authority for recycling advice and facilities (Europe only).

## Battery Safety Information

In exceptional circumstances, batteries may leak fluids that can cause a chemical burn injury or ruin your product. To avoid battery leakage:

- Do not mix old and new batteries or batteries of different types: alkaline, standard (carbon-zinc) or rechargeable (nickel-cadmium).
- Insert batteries as indicated inside the battery compartment.
- Remove batteries during long periods of non-use. Always remove exhausted batteries from the product. Dispose of batteries safely. Do not dispose of this product in a fire. The batteries inside may explode or leak.
- Never short-circuit the battery terminals.
- Use only batteries of the same or equivalent type, as recommended.
- Do not charge non-rechargeable batteries.
- Remove rechargeable batteries from the product before charging.
- If removable, rechargeable batteries are used, they are only to be charged under adult supervision.

## Setup

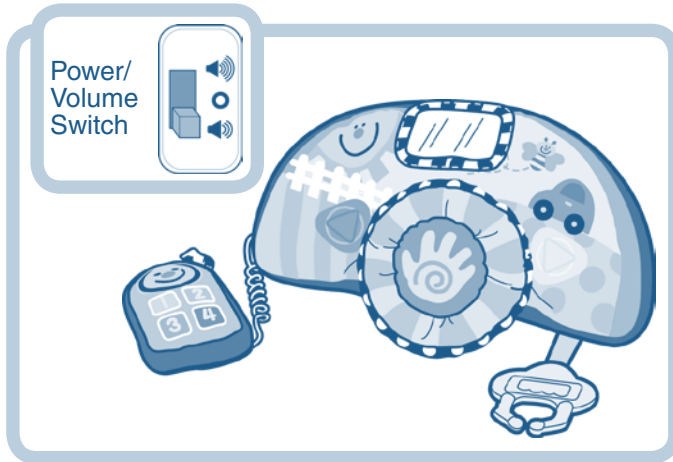

- Slide the power/volume switch on with low volume . The system is now active for approximately two hours.
- Press the “steering wheel” to hear a short song. Adjust the volume to a comfortable listening level for your child by either:
  - keep the switch on low volume .
  - slide the switch to high volume .
- Close the fasteners on the cover.

**Hint:** If the toy is not used for more than two hours, it turns off automatically. To reactivate the toy, simply press the “steering wheel”.

## Attaching the Dashboard to a Car Seat

**IMPORTANT!** This product is designed to attach to **most car seats**. If, after attaching this product to your car seat, you find that you cannot properly tighten your car seat’s restraint system (as described in the car seat manufacturer’s instructions), **DO NOT** use this product on the car seat.

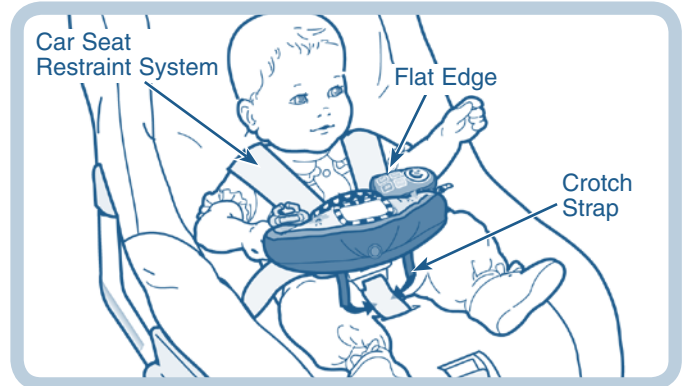

**IMPORTANT! Before attaching the dashboard** to your car seat’s restraint system, **check to be sure the car seat restraint system is securing your child properly! Check all restraint system belts (shoulder, lap, crotch, etc.) by pulling on them. The straps should not pull more than one inch (two fingers) away from your child.**

- Position the dashboard with the flat edge towards baby.
- Wrap the dashboard straps around the crotch strap (of the car seat restraint system) and fasten.

**Hint:** This toy does **not** fit tightly to your car seat restraint system, so it does not interfere with securing your child in the car seat.

## Attach the Remote Control to a Vehicle Visor

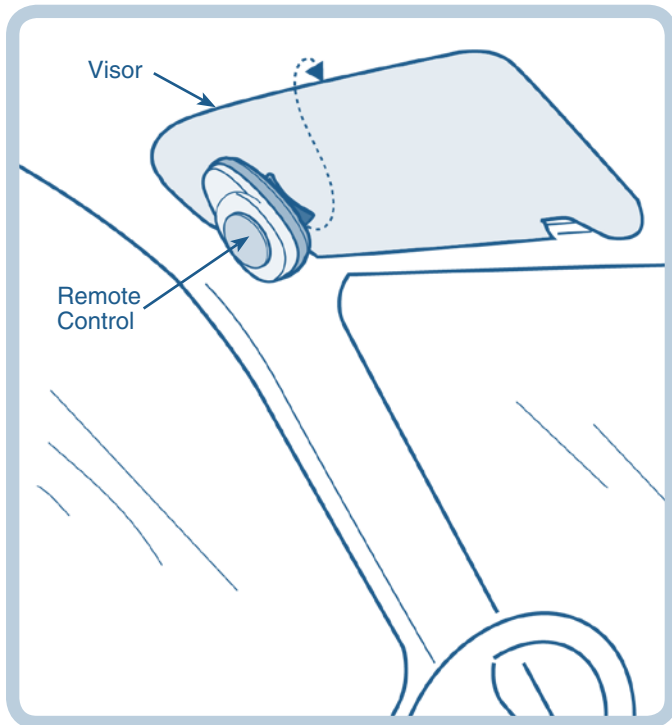

- Attach the remote control clip to the top of the vehicle visor.  
**Hint:** The remote control does not need to be in direct line with dashboard.

## Activating Sound and Lights



**The dashboard can be used in two ways: Adult activated by remote control or child activated by pressing on the steering wheel.**

- Slide the power/volume control switch to high or low volume to activate the system.
- Press the remote control button to start or stop lights and music.
- Baby can also press the “steering wheel” for a sound effect and a short tune along with twinkling lights.

## Care

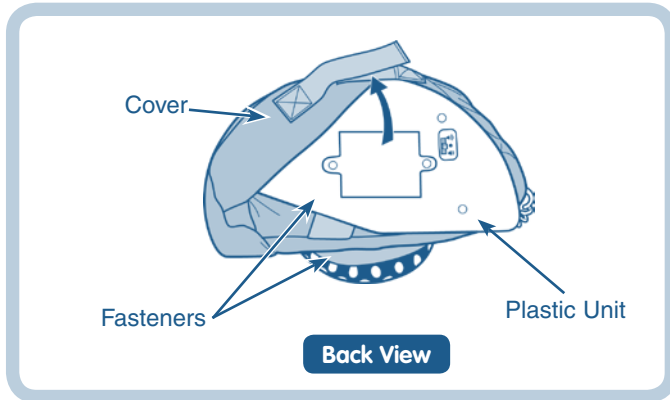

### Remove the Plastic Unit for Washing

- Remove the plastic unit before washing the fabric dashboard cover.
  - Unfasten the fasteners on the back of the cover and remove the plastic unit from the cover.
- Open the fasteners on the cover before washing. The cover is machine washable. Wash the cover separately in cold water on the gentle cycle. Do not use bleach. Tumble dry on low heat.
- Do not immerse the plastic unit.

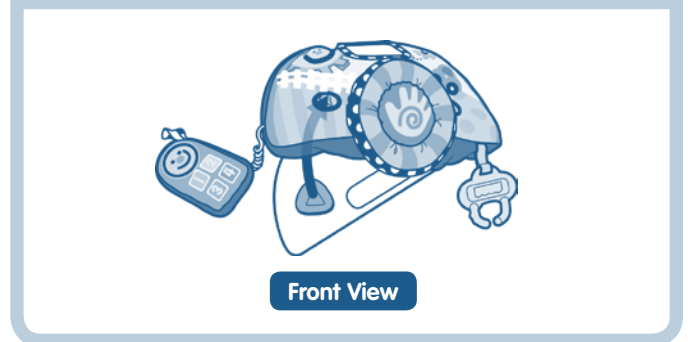
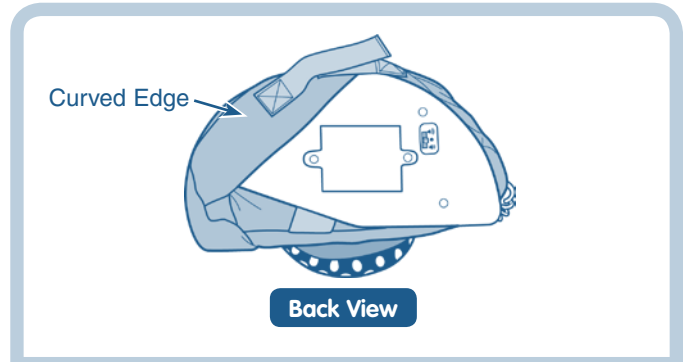

### Replace the Plastic Unit for Use

- Once cleaned and dried, open the fasteners on the back of the cover.
- Position the plastic unit so that the curved edge matches the curved edge of the cover.
- Fit the plastic unit into the cover. Close the fasteners.
- Turn the dashboard upright. Fit the two lenses and the remote sensor on the plastic unit through the three holes in the cover.