

■ Contents

English

1. PRECAUTIONS.....	2
2. CONTROLS.....	3
3. BUTTON TERMINOLOGY.....	4
4. FEATURES.....	5
5. HANDLING COMPACT DISCS.....	6
6. OPERATION.....	7
7. TROUBLESHOOTING.....	11
8. ERROR DISPLAYS.....	12
9. SPECIFICATIONS.....	13

■ Table des matières

Français

1. PRÉCAUTIONS.....	15
2. COMMANDES.....	3
3. NOMENCLATURE DES TOUCHES.....	16
4. CARACTÉRISTIQUES.....	17
5. MANIPULATION DES DISQUES COMPACTS.....	18
6. FONCTIONNEMENT.....	19
7. DÉPISTAGE DES PANNES.....	23
8. AFFICHAGE DES ERREURS.....	24
9. SPÉCIFICATIONS.....	25

■ Índice

Español

1. PRECAUCIONES.....	27
2. CONTROLES.....	3
3. NOMENCLATURA DE LOS BOTONES.....	28
4. CARACTERÍSTICAS.....	29
5. MANEJO DE LOS DISCOS COMPACTOS.....	30
6. OPERACIÓN.....	31
7. SOLUCIÓN DE PROBLEMAS.....	35
8. INDICACIONES DE ERROR.....	36
9. ESPECIFICACIONES.....	37

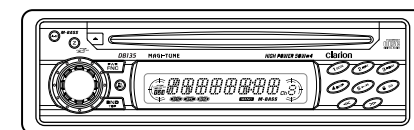

DB135

AM/FM CD PLAYER

RADIO AM/FM-LECTEUR CD

RADIO AM/FM Y REPRODUCTOR CD

1. PRECAUTIONS

- When the inside of the car is very cold and the player is used soon after switching on the heater, moisture may form on the disc or the optical parts of the player and proper playback may not be possible. If moisture forms on the disc, wipe it off with a soft cloth. If moisture forms on the optical parts of the player, do not use the player for about one hour and the condensation will disappear naturally to allow normal operation.
- Driving on extremely bumpy roads which cause severe vibration may cause the sound to skip.
- This unit uses a precision mechanism. Even in the event that trouble arises, never open the case, disassemble the unit, or lubricate the rotating parts.

This equipment has been tested and found to comply with the limits for a Class B digital device, pursuant to Part 15 of the FCC Rules. These limits are designed to provide reasonable protection against harmful interference in a residential installation. This equipment generates, uses, and can radiate radio frequency energy and, if not installed and used in accordance with the instructions, may cause harmful interference to radio communications. However, there is no guarantee that interference will not occur in a particular installation. If this equipment does cause harmful interference to radio or television reception, which can be determined by turning the equipment off and on, the user is encouraged to consult the dealer or an experienced radio/TV technician for help.

⚠ CAUTION

USE OF CONTROLS, ADJUSTMENTS, OR PERFORMANCE OF PROCEDURES OTHER THAN THOSE SPECIFIED HEREIN, MAY RESULT IN HAZARDOUS RADIATION EXPOSURE. THE COMPACT DISC PLAYER SHOULD NOT BE ADJUSTED OR REPAIRED BY ANYONE EXCEPT PROPERLY QUALIFIED SERVICE PERSONNEL.

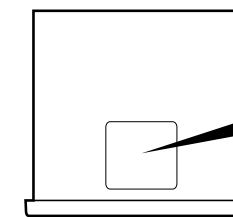

Bottom View of Source Unit

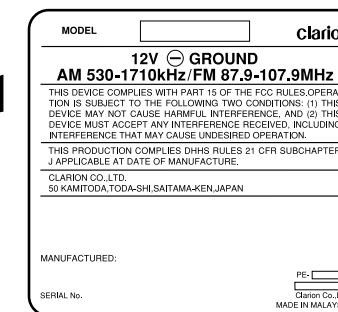

INFORMATION FOR USERS:

CHANGES OR MODIFICATIONS TO THIS PRODUCT WILL VOID THE WARRANTY AND WILL VIOLATE FCC APPROVAL.

Be sure to unfold and read the next page.
Veuillez déployer et vous référer à la page suivante.
Cerciórese de desplegar y de leer la página siguiente.

Clarion Co., Ltd.

All Rights Reserved. Copyright © 2002: Clarion Co., Ltd.
Printed in Malaysia / Imprimé à Malaisie / Impreso en Malasia

PE-2504B
280-7920-00

2. CONTROLS / COMMANDES / CONTROLES

Note: Be sure to unfold this page and refer to the front diagrams as you read each chapter.

Remarque: Veuillez déployer cette page et vous référer aux schémas quand vous lisez chaque chapitre.

Nota: Cuando lea los capítulos, despliegue esta página y consulte los diagramas.

SOURCE UNIT / APPAREIL PILOTE / UNIDAD FUENTE

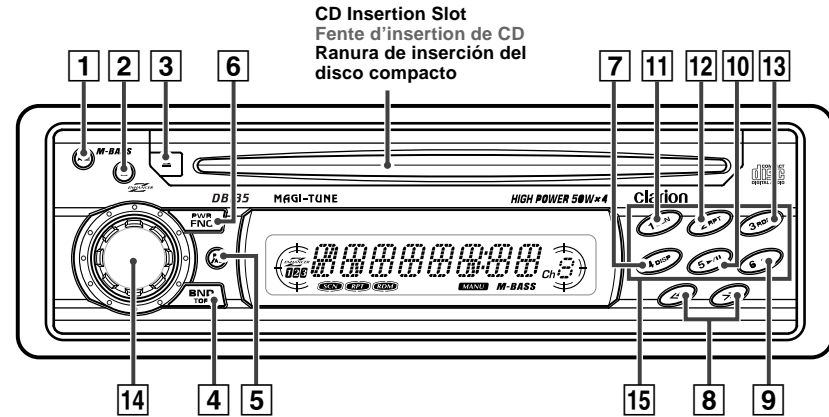

DISPLAY AFFICHEUR VISUALIZADOR



Note: The above illustration shows the front panel of the model DB135.

Remarque: L'illustration ci-dessous montre le panneau avant du modèle DB135.

Nota: La ilustración de arriba muestra el panel frontal del modelo DB135.

3. BUTTON TERMINOLOGY

Note:

• Be sure to read this chapter referring to the front diagrams of chapter 2. CONTROLS on page 3 (unfold).

- 1 A-M (Audio Mode)/M-BASS Button
- 2 Z-EHCR (Z-enhancer) Button
- 3 Eject (▲) Button
- 4 BND (Band)/TOP Button
- 5 PS (Preset Scan)/AS (Auto Store) Button
- 6 POWER/FNC (Function) Button
- 7 DISP (Display) Button
- 8 SRCH (Search) Up and Down (↗ and ↘) Buttons
- 9 SS (SCREEN Saver) Button
- 10 Play/Pause (▶/||) Button
- 11 SCN (Scan) Button
- 12 RPT (Repeat) Button
- 13 RDM (Random) Button
- 14 Rotary knob/Volume Knob
- 15 Preset Buttons (1 to 6)

English

9. ESPECIFICACIONES

Sintonizador de FM

Game de frecuencias: 87,9 MHz a 107,9 MHz
Sensibilidad útil: 11 dBf
Sensibilidad a 50 dB de silenciamiento: 17 dBf
Selectividad de canal alternativo: 75 dB
Separación estéreo (1 kHz): 35 dB
Respuesta en frecuencia (±3 dB): 30 Hz a 15 kHz

Sintonizador de AM

Respuesta en frecuencia: 530 kHz a 1.710 kHz
Sensibilidad útil: 25 µV

Reproductor de discos compactos

Sistema: Sistema de audio de discos compactos
Discos utilizables: Discos compactos
Respuesta en frecuencia: 10 Hz a 20 kHz (±1dB)
Relación señal-ruido: 100 dB (1 kHz) IHF-A
Gama dinámica: 95 dB (1 kHz)
Distorsión armónica: 0,01%

Audio

Salida de potencia máxima:
200 W (50 W X 4 ch)
Salida de potencia media continua:
17 W X 4, con 4 Ω, 20 Hz a 20 kHz, 1% de distorsión armónica total
Acción de control de graves (30 Hz): ±13 dB
Acción de control de agudos (10 kHz): ±12 dB
Salida de línea (con CA, 1 kHz, 10 kΩ): 1,7 V

Generales

Tensión de alimentación: 14,4 V CC (permisible de 10,8 V a 15,6 V), negativo a masa
Consumo de corriente: Menos de 15 A
Impedancia de los altavoces: 4 Ω (permisible de 4 Ω a 8 Ω)
Peso: 2,2 lb. (1,0 kg)
Dimensiones:

7" (178 mm) de anchura X 2" (50 mm) de altura X 6" (152 mm) de fondo

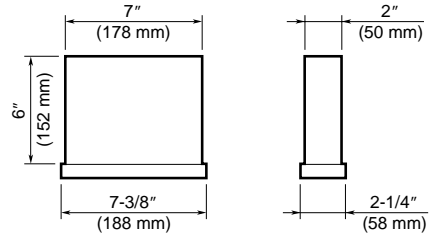

Notas:

- Las especificaciones están de acuerdo con las normas de la EIA.
- Las especificaciones y el diseño están sujetos a cambio sin previo aviso por motivo de mejoras.
- Cuando haya conectado un amplificador de potencia externo, cerciórese de conectar adecuadamente la masa del mismo al chasis del automóvil.
- Si no hiciese esto, la unidad podría sufrir daños serios.

4. FEATURES

- Rotary Encoder Volume Control
- Z-Enhancer with 3 Mode Sound Selector
- MAGNA Bass with EXTRA BASS
- **MAGI-TUNE**® FM Reception System
- Seek / Manual Up / Down Tuning
- 8-Times Oversampling Digital Filter and Dual 1-Bit D/A Converters
- Preset Station Scan (PS), Automatic Store (AS)
- 2-Channel RCA Line Level Output
- AM 1 band, FM 3 bands each 6 channels total 24 channels, Preset Memory Function
- Repeat/Random Play/Intro Music Scan
- 200W (50 W × 4) Maximum Power Output

5. HANDLING COMPACT DISCS

This unit has been designed specifically for playback of compact discs bearing the  mark. No other discs can be played.

To remove the compact disc from its storage case, press down on the center of the case and lift the disc out, holding it carefully by the edges.

Removing the disc

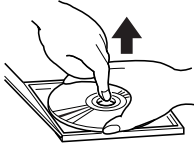

Proper way to hold the compact disc



Always handle the compact disc by the edges. Never touch the surface.

To remove fingermarks and dust, use a soft cloth, and wipe in a straight line from the center of the compact disc to the circumference.

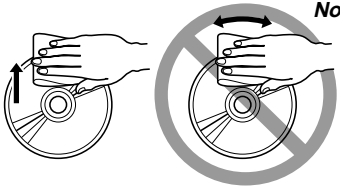

New discs may have some roughness around the edges. The unit may not work or the sound may skip if such discs are used. Use a ball-point pen, etc. to remove roughness from the edge of the disc.

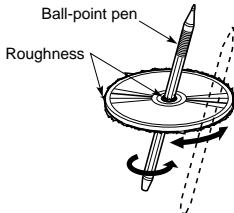

Note on Compact Discs

Never stick labels on the surface of the compact disc or mark the surface with a pencil or pen.

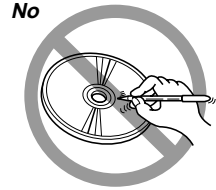

Do not use any solvents such as commercially available cleaners, anti-static spray, or thinner to clean compact discs.

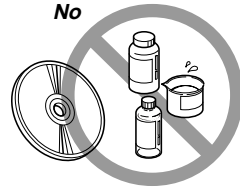

Do not use compact discs that have large scratches, are misshapen, or cracked, etc. Use of such discs will cause misoperation or damage.

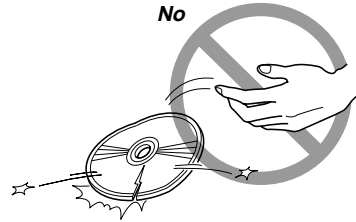

Do not expose compact discs to direct sunlight or any heat source.

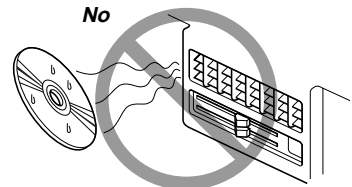

Note:

- Do not use commercially available CD protection sheets or discs equipped with stabilizers, etc. These may get caught in the internal mechanism and damage the disc.

6. OPERATION

Note:

- Be sure to read this chapter referring to the front diagrams of chapter 2. CONTROLS on page 3 (unfold).

Basic Operations

⚠ CAUTION

When this unit is turned on, starting and stopping the engine of a car with its volume raised to the maximum level may harm your hearing. Be careful about adjusting the volume.

Turning ON the Power and Adjusting the Volume

- 1) Press the POWER button [6].
 - * To turn off the power, press the POWER button [6] for 1 second or longer.
- 2) Press the FNC button [6] and select another operation mode. Every time the FNC button [6] is pressed, the display changes the operation mode as:
Radio → CD → Radio

Note:

- If the CD mode is selected when no disc is inserted, the display shows "no DISC".
- 3) Turning the Rotary knob [14] clockwise increases the volume; turning it counterclockwise decreases the volume.
 - * The volume level is from 0 (minimum) to 33 (maximum).

Audio Mode Adjustments

Press the A-M button [1] to select the adjustment mode. The mode switches as follows each time the A-M button is pressed:

BASS → TREB → BAL → FAD → Previous mode

Magna Bass on and off

- 1) Press and hold the A-M button [1] for 2 seconds or longer, then the Bass will extra boost.

Note:

- M-Bass function will impact you more in low frequency and boost quickly but some distorted sound may happened at the high volume. So please use it at the proper volume.

Adjusting the Bass

- 1) Press A-M button [1] and select "BASS".
- 2) Turning the Rotary knob [14] clockwise empha-

sizes the bass; turning it counterclockwise attenuates the bass.

- * The factory default setting is "0". (Adjustment range: -7 to +7)
- 3) When the adjustment is complete, press A-M button [1] several times until the function mode is reached.

Adjusting the Treble

- 1) Press A-M button [1] and select "TREB".
- 2) Turning the Rotary knob [14] clockwise emphasizes the treble; turning it counterclockwise attenuates the treble.
 - * The factory default setting is "0". (Adjustment range: -7 to +7)
- 3) When the adjustment is complete, press A-M button [1] several times until the function mode is reached.

Adjusting the Balance

- 1) Press A-M button [1] and select "BAL".
- 2) Turning the Rotary knob [14] clockwise emphasizes the sound from the right speaker; turning it counterclockwise emphasizes the sound from the left speaker.
 - * The factory default setting is "0". (Adjustment range: L13 to R13)
- 3) When the adjustment is complete, press A-M button [1] several times until the function mode is reached.

Adjusting the Fader

- 1) Press A-M button [1] and select "FAD".
- 2) Turning the Rotary knob [14] clockwise emphasizes the sound from the front speakers; turning it counterclockwise emphasizes the sound from the rear speakers.
 - * The factory default setting is "0". (Adjustment range: F12 to R12)
- 3) When the adjustment is complete, press A-M button [1] several times until the function mode is reached.

Note:

- Bass and Treble can only be adjusted when the "Z-enhancer" is OFF.

Setting the Z-enhancer

This unit comes with three types of sound tone effects stored in memory. Select the one you prefer.

* The factory default setting is "Z-EHCR OFF".

Each time you press Z-EHCR button [2], the tone effect changes in the following order.

"Z-ENHANCER 1" → "Z-ENHANCER 2" →

"Z-ENHANCER 3" → "Z-EHCR OFF" →

"Z-ENHANCER 1"...

- Z-ENHANCER 1: bass emphasized
- Z-ENHANCER 2: treble emphasized
- Z-ENHANCER 3: bass and treble emphasized
- Z-EHCR OFF: no sound effect

Switching the Clock Display

Press and hold the BND button [4], and then press the DISP button [7] to switch between the operation mode and the clock display.

Setting the Clock

- 1) Press and hold the BND button [4], and then press the DISP button [7] to display the clock display.
- 2) Press and hold the BND button [4], and then press the DISP button [7] for 2 seconds or longer.
- 3) Press the SRCH Up button [8], then set the current minute.
- 4) Press the SRCH Down button [8], then set the current hour.
- 5) Press the BND button [4], then the clock is set.

Notes:

- If you select another operation mode while you are setting the clock, the clock setting operation will be canceled.
- If you remove the vehicle's battery for a check or repair, the clock will be reset, so you must set it again.

Screen Saver mode

- 1) Press and hold the Band button [4], and then press the SS button [9] to switch on, and off Screen save mode

* The factory default setting is "SS On".

Radio Mode Operations

FM Reception

For enhanced FM performance the **MAGI-TUNE**® tuner includes signal actuated stereo control and Multipath noise reduction circuits.

Listening to the Radio

- 1) Press the FNC button [6] to select the radio mode, then the radio will be on.
- 2) To select a preset band, press the BND button [4], then select one of the preset bands such as FM1, FM2, FM3 or AM. Every time the BND button [4] is pressed, the display will change as:

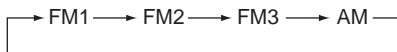

- 3) Press the SRCH Up/Down button [8], then the station at which there is a broadcast will be selected (Seek selection).

Manual Tuning

- 1) Press the BND button [4], then select FM1, FM2, FM3 or AM.
- 2) Press and hold the BND button [4] for 2 seconds or longer, then the display will show "MANU", which means that a manual selection function is on.
- 3) Press the SRCH Up/Down button [8] and select the right station.

Seek Tuning

- 1) Press the BND button [4], then select FM1, FM2, FM3 or AM.
- 2) If the "MANU" on the display is on, press and hold the BND button [4] for 2 seconds or longer. When the "MANU" display is off, the Seek Selection function is on.
- 3) Press the SRCH Up/Down button [8], then when it selects the station in which there is a broadcast, it automatically stops.

Preset Memory Function

Preset Memory Function can store up to 24 stations: 6 stations for each of FM1, FM2, FM3 and AM.

Note:

- When the present memory function is used, all the content of the memory will be erased.

Manual memory function

- 1) Press the BND button [4], and select the band you want to store in the memory.
- 2) Press the SRCH Up/Down button [8] then select the station you want to store in the memory.
- 3) Press and hold the Preset button [15] for 2 seconds or longer, then the station will be stored in the memory.

Auto store function (Automatic Station Store)

- 1) Press the BND button [4], then select the band you want to store in the memory.
- 2) Press and hold the AS button [5] for 2 seconds or longer, then the station at which the reception is the strongest will be automatically stored in the memory.

Note:

- When the number of stations stored is less than 6, the previous content of the memory for each direct button will be retained.

Preset Scanning (Preset Station Scan)

When the PS button [5] is preset, the "SCN" will indicated preset memory numbers and the stations are tuned in for 7 seconds each in the order in which they were stored. Press the PS button again to cancel the preset scanning mode.

CD Mode Operations

Loading a Disc

Insert a CD into the centre CD insertion slot with the labeled side facing up, "LOAD" appears in the display, the CD enters into the slot and start playing.

Notes:

- Do not put your hand, fingers, or foreign objects into the CD insertion slot.
- If a CD has already been loaded, another CD cannot be inserted. Do not insert another one forcefully.
- Discs not bearing the  mark cannot be played with the unit. CD-ROMs cannot be played.
- Some CDs recorded in CD-R/CD-RW mode may not be usable.

Listening to the Disc already Inserted

Press the FNC button [6] to select the CD mode, the CD will start playing.

Stopping (pausing) Playback

While the CD playing, pressing the Play/Pause button [10] will stop the CD and "PAUSE" indicate. Press the Play/Pause button [10] again to resume playback.

Ejecting the CD

Press the Eject button [3], then the CD will be ejected.

Note:

- If the ejected CD is left as it is, it will be reloaded after 15 seconds.

Top Function

Press the TOP button [4], then the CD will start playing from the first song (track number 1).

Selecting Tracks (songs)

Press the SRCH Up/Down button [8].

- : Playback will start from the next track.
- ⏮ : Playback will start from the beginning of the track currently playing. When this button is pressed again, the CD will play from the previous track.

Fast-Forward and Fast-Backward

Press and hold the SRCH Up/Down button **[8]**.

➤ : To fast-forward

⏮ : To fast-backward

* Pressing the SRCH Up/Down button for 1 second or longer will move forward or backward 5 times faster than normal play, and pressing it for 3 seconds or longer will do the operation 30 times faster.

Scan Play (Intro Music Scan)

Press the SCN button **[11]**, then the display shows “**SCN**”, then the CD will play the first 10 seconds of each track of the whole disc. Press the SCN button **[11]** again to disengage the unit from scan play.

* A scan play will start from the track following the one currently.

Repeat Play

Press the RPT button **[12]**, then the display shows “**RPT**”, then the track currently playing will be played repeatedly. Press the RPT button **[12]** again to disengage the unit from repeat play.

Random Play

Press the RDM button **[13]**, then the display will show “**RDM**”, then the entire tracks on the disc will be played at random. Press the RDM button **[13]** again to disengage the unit from random play.

7. TROUBLESHOOTING

Problem	Cause	Solution
Power does not turn on. (No sound is produced.)	Fuse is blown.	Replace with a fuse of the same amperage. If the fuse blows again, consult your store of purchase.
	Incorrect wiring.	Consult your store of purchase.
Compact disc cannot be loaded.	Another compact disc is already loaded.	Eject the compact disc before loading the new one.
Sound skips or is noisy.	Compact disc is dirty.	Clean the compact disc with a soft cloth.
	Compact disc is heavily scratched or warped.	Replace with a compact disc with no scratches.
Sound is bad directly after power is turned on.	Water droplets may form on the internal lens when the car is parked in a humid place.	Let dry for about 1 hour with the power on.

8. ERROR DISPLAYS

■ To protect the system, this unit has been equipped with self diagnostic functions. If a fault arises, a warning is issued by various error displays. Follow the corrective measures and remove the fault.

Error Display	Corrective Measure
ER 2	This error display indicates that a fault has arisen in the mechanism of the source unit (for example, the disc cannot be ejected). → Check the source unit.
ER 3	This error display indicates that the pickup focus is off because of a scratched disc or some other factor during source unit play. → Check the compact disc.
ER 6	This indicates that the CD's TOC (table of contents) cannot be read, for example because the selected disc is upside-down.

9. SPECIFICATIONS

FM Tuner

Frequency Range: 87.9 MHz to 107.9 MHz
Usable Sensitivity: 11 dBf
50 dB Quieting Sensitivity: 17 dBf
Alternate Channel Selectivity: 75 dB
Stereo Separation (1 kHz): 35 dB
Frequency Response (± 3 dB): 30 Hz to 15 kHz

AM Tuner

Frequency Range: 530 kHz to 1,710 kHz
Usable Sensitivity: 25 μ V

CD Player

System: Compact disc audio system
Usable Discs: Compact disc
Frequency Response: 10 Hz to 20 kHz (± 1 dB)
Signal-to-Noise Ratio: 100 dB (1 kHz) IHF-A
Dynamic Range: 95 dB (1 kHz)
Harmonic Distortion: 0.01%

Audio

Maximum Power Output:
200 W (50 W \times 4 ch)
Continuous Average Power Output:
17 W \times 4, into 4 Ω , 20 Hz to 20 kHz, 1%THD
Bass Control Action (30 Hz): ± 13 dB
Treble Control Action (10 kHz): ± 12 dB
Line Output (with A/C 1 kHz, 10 k Ω): 1.7 V

General

Power Supply Voltage: 14.4 V DC (10.8 V to 15.6 V allowable), negative ground
Current Consumption: Less than 15 A
Speaker Impedance: 4 Ω (4 Ω to 8 Ω allowable)
Weight: 2.2 lb. (1.0 kg)
Dimensions:
7" (178 mm) Width \times 2" (50 mm) Height \times 6" (152 mm) Depth

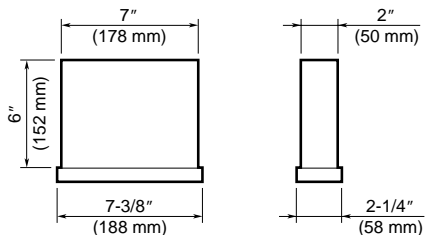

Notes:

- Specifications comply with EIA Standards.
- Specifications and design are subject to change without notice for further improvement.
- Please make sure when connecting external power amplifier, that you properly, to the car chassis, ground the amplifier.
- If this is not done, severe damage to the source unit may happen.

