



H8910

Please keep this instruction sheet  
for future reference, as it contains  
important information.

Adult assembly is required.

No tools needed for assembly.



# IMPORTANT!



## Assembly

- Please make sure your child does not follow you using this toy while you are operating a real lawn mower. Your child should play in a separate area **away from the area where you mow.**
- Use only bubble solution in this toy.
- Make sure your child understands that bubble solution is not for drinking and that it should be kept away from the eyes.
- While filling or cleaning this toy, try to avoid spilling bubble solution on the floor. It may create slippery floor conditions.
- Bubble solution used in this product may stain or stick to some surfaces.
- Water toys sometimes get messy. Protect play surfaces before use.
- Overfilling of resevoir may cause leakage.



- Insert and **"snap"** the handle into the mower, as shown.



# Bubblin' Fun

**Note:** Before use, remove the cap and seal from the bubble solution and throw it away.

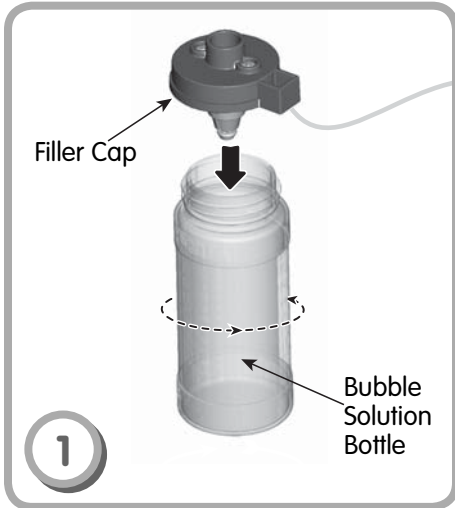

- Locate the filler cap on the front of the mower.
- Attach the filler cap to the top of the bubble solution bottle.
- Then, twist the bubble solution bottle to secure the cap.

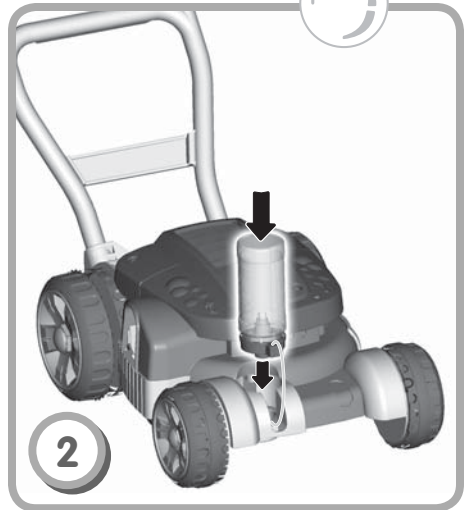

- Insert the bottle, cap side down, into the opening near the front of the mower.

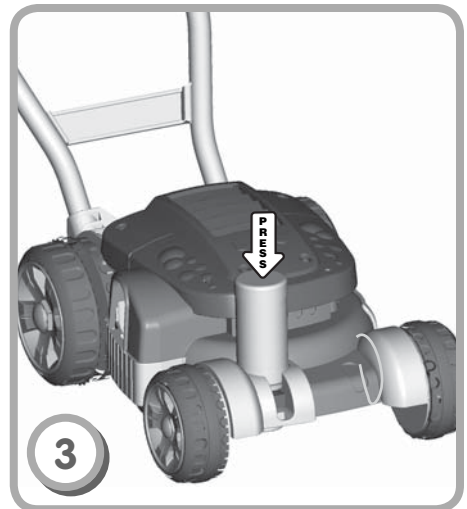

- Press down on the bottle for about 15 seconds to fill the mower.



# Bubblin' Fun

**Note:** We do not recommend the use of silicones or oily lubricants on this toy. As with any bubble producing toy, when even a very small amount of silicone or oily lubricants are put into or used near the bubble chambers, bubbles will not form.



- Push the bubble mower so **all four wheels** contact the ground.
- Bubbles begin flowing after the mower has been pushed about 15-20 walking steps. As long as the mower is being pushed, bubbles continue to flow.
- When bubbles stop, press down on the bubble bottle again for 15 seconds to refill.

# Let's Clean Up

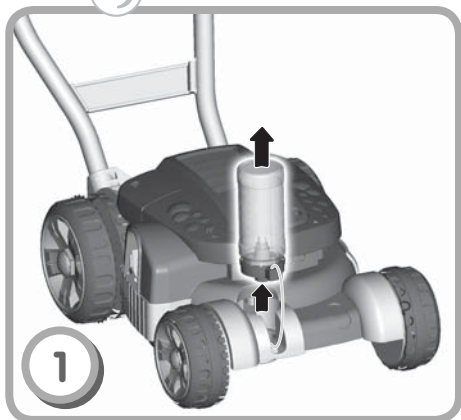

- Lift to remove the bubble solution bottle from the mower.
- Turn the bubble solution bottle upright and twist to remove the filler cap.

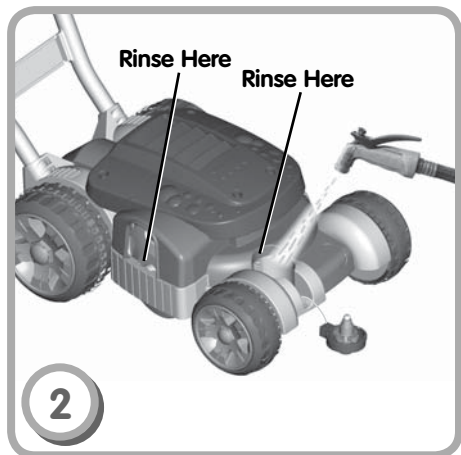

- Thoroughly rinse the bubble chamber on the side of the mower and the filler opening near the front of the mower with clean water from a garden hose or faucet.



- Tip the mower forward to empty all the water.



- Replace the filler cap on the bubble solution bottle and place the bottle in the filler opening **cap end up**.

**Note:** Keep the bubble solution bottle with your toy and refill as needed. Do not discard the bubble solution bottle.



# Problems and Solutions

Problem	Cause	Solution
No bubbles	Not enough bubble solution in bubble chamber	Press down on bubble solution bottle for 15 seconds to refill.
	Bubble chamber is clogged and dirty	Follow instructions in "Let's Clean Up" section to clean bubble chamber thoroughly.
	You have not walked far enough to produce bubbles	The bubble mower needs to be pushed a minimum of 15-20 walking steps before bubbles begin to flow.
	You are walking too quickly	Walk at a slow, steady pace.
	The rear wheels do not contact the ground	Push the mower so that the rear wheels always contact the ground.
	Silicone or oily lubricants got into the bubble chamber	Never use silicone or oily lubricants on this product (the wheels). Bubbles will not form if even a very small amount of these substances get into the bubble chamber.
Bubble solution is leaking from the mower	Bubble chamber over-filled	Fill only by using the filler cap which will dispense the correct amount of solution.
	The mower is used on an inclined surface	Use the mower only on flat, level ground.
Bubble solution is foaming	Bubble chamber is clogged	Follow instructions in "Let's Clean Up" section to clean bubble chamber thoroughly.



## CONSUMER ASSISTANCE

1-800-432-5437 (US & Canada)  
1300 135 312 (Australia)



**service.fisher-price.com**

Fisher-Price, Inc., 636 Girard Avenue, East Aurora, NY 14052.  
Hearing-impaired consumers: 1-800-382-7470.

Outside the United States:

Canada: Mattel Canada Inc., 6155 Freemont Blvd.,  
Mississauga, Ontario L5R 3W2; [www.service.mattel.com](http://www.service.mattel.com).

Great Britain: Mattel UK Ltd, Vanwall Business Park,  
Maidenhead SL6 4UB. Helpline: 01628 500303,  
[www.service.mattel.com/uk](http://www.service.mattel.com/uk)

Australia: Mattel Australia Pty. Ltd., 658 Church Street,  
Locked Bag #870, Richmond, Victoria 3121 Australia.

New Zealand: 16-18 William Pickering Drive,  
Albany 1331, Auckland.