

PHILIPS

CD601/CD602 Compact Disc Player

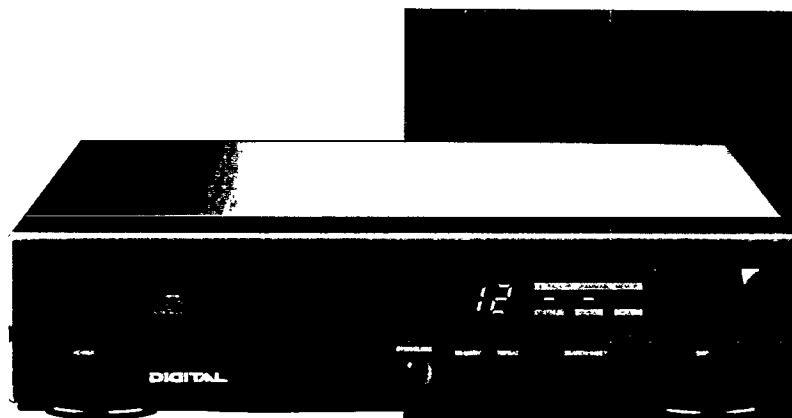

(AUS) Australia
 Guarantee page 52

(NZ) New Zealand
 Guarantee page 52

(MEX) Mexico **NOM**



NOM

Es necesario que lea cuidadosamente su instructivo de manejo.
 Garantía y seguridad página 53

(DK) Danmark
 Typeskiltet findes på undersiden af apparaten.
 Dette produkt overholder kravene til radiointerferens af Europæisk Fælleskab
Bemærk: Netafbryderen er sekundært indkoblet og afbryder ikke strømmen fra nettet. Den indbyggede netdel er derfor tilsluttet til lysnettet så længe netstikket sidder i stikkontakten.
Advarsel: Usynlig laserudstråling ved åbning når sikkerhedsafbrydere er ude af funktion. Undgå udsættelse for stråling.

(N) Norge
 Typeskilt finnes på apparatens underside.
Observer: Nettbryteren er sekundært innkoplet.
 Den innebygde nettdelen er derfor ikke frakoplet nettet så lenge apparatet er tilsluttet nettkontakten.

(GB) English page 4
 Illustrations page 3 English

(F) Français page 10
 Illustrations page 3 Français

(D) Deutsch Seite 16
 Abbildungen Seite 3 Deutsch

(NL) Nederlands pagina 22
 Afbældingen pagina 3 Nederlands

(E) Español página 28
 Ilustraciones página 3 Español

(I) Italiano pagina 34
 Illustrazioni pagina 3 Italiano

(S) Svenska sida 40
 Figurer sida 3 Svenska

(SF) Suomi sivu 46
 Kuvat sivu 3 Suomi

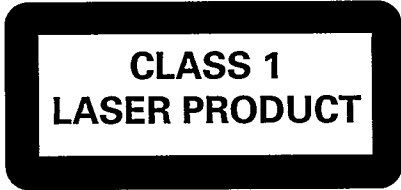

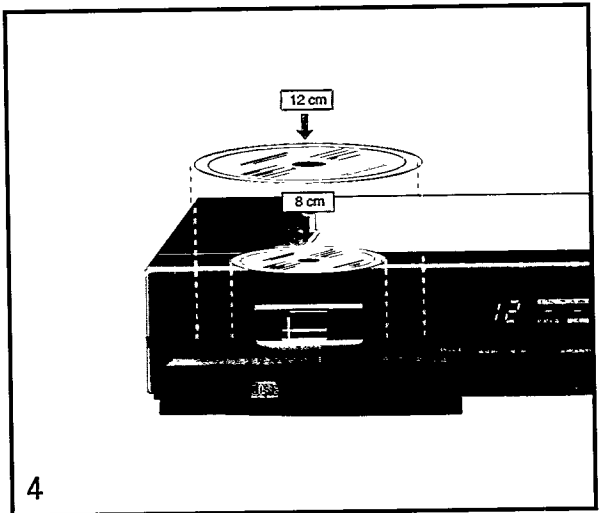
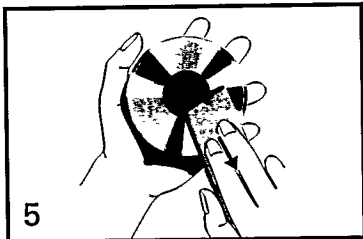
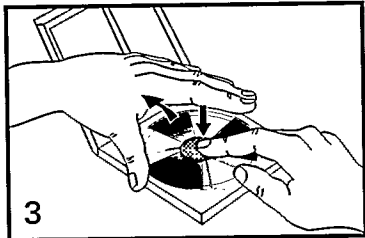
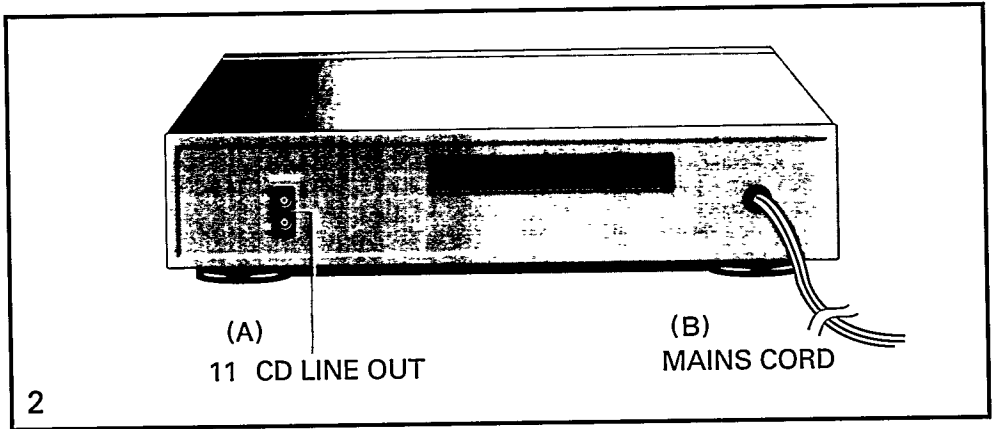
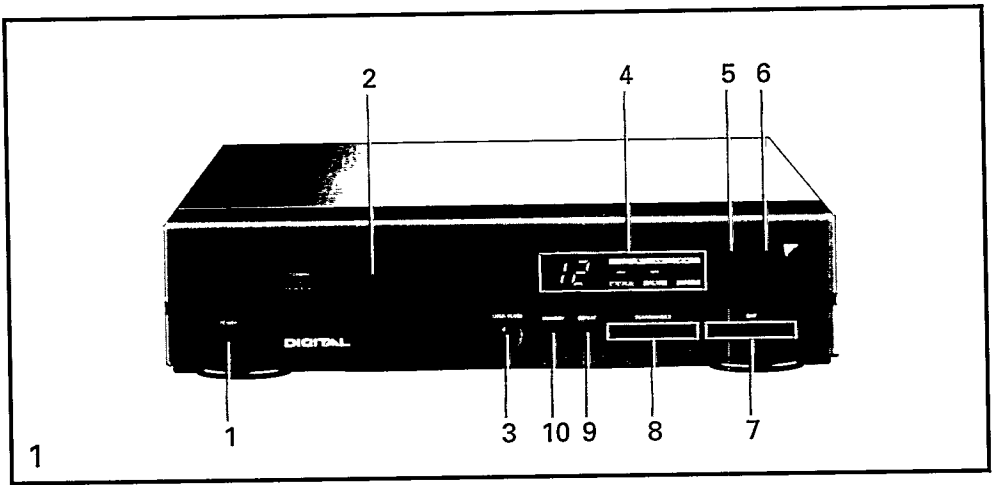

Installation

INSTALLATION

- Unpack all parts and remove protective material.
- Do not connect the unit to the mains before checking the mains voltage and before all other connections have been made.
- Do not cover any vents and make sure that there is a space of several centimetres around the unit for ventilation.

SUPPLY

- Check that the mains voltage as shown on the type plate corresponds to your local mains supply. If it does not, consult your dealer or service organisation.
- Insert the mains plug into the wall socket. The mains supply is now connected.
- To disconnect the set from the mains, withdraw the mains plug from the wall socket.

CONNECTIONS (Fig. 2)

- A) Connect the CD LINE OUT sockets ① of the CD player to the CD/LINE IN sockets of your amplifier or receiver.
- B) Power cord. **Do not** connect the unit to the power without having checked whether the voltage given on the type plate corresponds with the local AC outlet voltage.

Important notes for users in the U.K.:

Mains Plug

This apparatus is fitted with an approved moulded 13 Amp plug
To change a fuse in this type of plug proceed as follows

- Remove fuse cover and fuse
- Fix new fuse which should be a BS1362 5 A, A.S.T.A. or BSI approved type
- Refit the fuse cover

If the fitted plug is not suitable for your socket outlets, it should be cut off and an appropriate plug fitted in its place

If the mains plug contains a fuse, this should have a value of 5 A. If a plug without a fuse is used, the fuse at the distribution board should not be greater than 5 A.

Note:

The severed plug must be destroyed to avoid a possible shock hazard should it be inserted into a 13 A socket elsewhere

How to connect a plug

The wires in the mains lead are coloured with the following code: blue = neutral (N), brown = live (L)

As these colours may not correspond with the colour markings identifying the terminals in your plug, proceed as follows

- Connect the blue wire to the terminal marked N or coloured black
- Connect the brown wire to the terminal marked L or coloured red
- Do not connect either wire to the earth terminal in the plug, marked E (or \perp) or coloured green (or green and yellow)

Before replacing the plug cover, make certain that the cord grip is clamped over the sheath of the lead – not simply over the two wires

Copyright:

Recording and playback of material may require consent. See Copyright Act 1956 and The Performer's Protection Acts 1958 to 1972

CONTROLS

ON THE UNIT (Fig. 1)

- ① **POWER**
To switch the CD player on and off.
- ② **COMPACT DISC** tray
For 8cm and 12 cm compact discs.
- ③ **OPEN/CLOSE**
To open and close the CD tray
- ④ **DISPLAY**
To indicate what function the unit is performing:
 - **TRACK/INDEX**, the total number of tracks in the disc and the index numbers.
 - **MEMORY** indicator, indicating a program is played
 - **REPEAT** indicator, indicating that the REPEAT function is activated.
 - **▶ PLAY** indicator, indicating the disc is played (when the indicator is flashing, the **PAUSE** function is activated.)
 - **□**, indicating that there is an error
- ⑤ **PLAY/PAUSE ▶||** – To start and interrupt playback
- ⑥ **STOP ■** – To stop playback
- ⑦ **◀◀ SKIP ▶▶**: to return to the start of a track or to select the next track.
- ⑧ **◀◀ SEARCH/INDEX ▶▶**: to search for a passage during playback or the desired index within a track.
- ⑨ **REPEAT** – To repeat a track of a CD, all the tracks in a disc
- ⑩ **MEMORY** – To program the track numbers.

COMPACT DISCS (CD)

Use compact discs bearing the symbol below. In addition to the conventional 12 cm CDs, 8 cm CDs can be used without an adaptor.



Bear in mind the following points, since any dirt, scratches or warping of the disc can cause broken or intermittent sound and also noise.

- To remove the disc from its case lift it out by holding the disc's centre with your forefinger and the outside of the disc with your thumb.(Fig. 3)
- When holding the discs, take care not to touch the playing surface.
- Store the discs in their cases. Return them to their cases with the label surface facing up and push down lightly on the label surface.
- Do not place discs in the following locations:
 - near a heating device or a place where the temperature is high;
 - on a seat or on the dashboard of a vehicle which is exposed to direct sunlight, since these areas can become very hot;
 - in damp or dusty areas.
- Do not write on the label surface using a ballpoint pen or hard pencil and do not stick labels on this surface.
- Wipe away any fingerprints or dust on the playing surface of a disc using a soft cloth. Bear in mind the following points:
 - always wipe from the inside toward the outside of the disc; (See Fig. 5)
 - do not use conventional record cleaners, anti-static agents, benzene, thinner or other solvents.

English

Français

Deutsch

Nederlands

Español

Italiano

Operation

FUNCTIONS AND OPERATION

Inserting the disc

- Press **POWER** button to switch the unit on.
- Press **OPEN/CLOSE** to open the CD tray.
 - "DP" flashes on the display.
- Insert the CD, *printed side up*, in the tray (See Fig. 4).
- Press **OPEN/CLOSE** again to close the CD tray.

The CD-player starts and scans the contents list of the CD. After 3 seconds, the total number of tracks appear on the display followed by "1".

Playing the entire disc

- Press **PLAY/PAUSE ►II** on the unit.
 - Playback starts with the first track.
 - The ► **PLAY** indicator lights up and the display shows the current track number.
 - When all the tracks have been played, the CD player stops and track 1 is shown on the display.
- To stop playback, press **STOP ■** on the unit.
- Press **POWER** button to switch the unit off.

Interrupting play

- Press **PLAY/PAUSE ►II**.
 - The ► **PLAY** indicator flashes on the display.
- Press **PLAY/PAUSE ►II** again if you want to resume playback.
 - The ► **PLAY** indicator stops flashing.

Stopping play

- Press **STOP ■** if you wish to stop playback.
 - The ► **PLAY** indicator goes off.
 - Track 1 will now appear in the display.
- Press **OPEN/CLOSE** to remove the CD.

Playing in a desired order (Program) (Only possible in STOP mode)

By programming the player, you can play up to 16 tracks in any desired order. If you exceed the maximum of 16 tracks, the last track number entered will not be changed in the display.

- Press ◀◀ or ▶▶ briefly (less than 0.5 second) to locate a particular track.
- When you have found the correct track number, press **MEMORY** to store it in the memory.
 - The **MEMORY** indicator lights up.
- Press ◀◀ or ▶▶ briefly to locate the next track to be programmed.
 - The track number flashes on the display.
 - Press **MEMORY** again to store it.
- Repeat this procedure to select other tracks that you wish to programme into the memory.

Notes:

- If the **MEMORY** button is pressed during the **STOP** mode before any track is entered, track number 1 will be entered as the first track in the program.

Playing a program

- Press **PLAY/PAUSE ►II**.
 - Playback starts with the first track of the program.
 - When all tracks have been played, the display shows the last track of the program.

Reviewing the program

(Only possible in the STOP mode)

- To review the tracks which you have programmed, press **MEMORY** once.
 - The programmed tracks will be displayed in running sequence.

Erasing a program

- To clear all programmed tracks, press **STOP ■** twice.

Note:

- Opening and closing the CD tray and switching the unit off will also cancel the programme.

Operation

Repeat Play

If at any time you wish to listen to a disc or programme over and over again, the REPEAT function will allow you to do so.

The whole disc

- Press REPEAT on the unit.
 - The REPEAT indicator lights up.
- Press PLAY/PAUSE ►II.
 - The ► PLAY indicator lights up.
 - The contents of the disc or program will be replayed after the last track of the disc.
- Press REPEAT to cancel the repeat function.
 - The REPEAT indicator light goes out.
 - Play continues as normal.

A particular track

- Press STOP ■.
- Press REPEAT on the unit.
 - The REPEAT indicator lights up.
- Press ◀◀ or ▶▶ briefly (less than 0.5 second) to locate a desired track.
- When you have found the correct track number, press MEMORY to store it in the memory.
 - The "MEMORY" indicator lights up..
- Press PLAY/PAUSE ►II.
 - The ► PLAY indicator lights up.
 - The chosen track will be played continuously.
- Press REPEAT to cancel the repeat function.
 - The REPEAT indicator light goes out.
 - Play continues as normal.

The whole programme

- Press REPEAT on the unit.
 - The REPEAT indicator lights up.
- Program the tracks to be played as described under Programming.
- Press PLAY/PAUSE ►II.
 - The ► PLAY indicator lights up.
 - The contents of the disc or program will be replayed after the last track of the programme.
- Press REPEAT to cancel the repeat function.
 - The REPEAT indicator light goes out.
 - Play continues as normal.

Starting playback from an index within a track at STOP mode (*Applicable only for compact discs with index-encoded tracks*)

- Press ◀◀ or ▶▶ briefly (less than 0.5 second) to locate a desired track.
- When you have found the correct track number, press ◀◀ or ▶▶ to search for the desired index number.
 - The chosen index number flashes on the display.
- Press PLAY/PAUSE ►II.
 - Playback starts with the beginning of the index number.
 - The index number disappear and the display shows the chosen track number.

Selecting a different track during playback or programmed play

- Press ◀◀ or ▶▶ briefly (less than 0.5 second) until the required track number appears in the display.
 - Shortly after this, the chosen track will start playing.

Starting again with the track that is currently playing

- Press ◀◀ briefly (less than 0.5 second).
 - The track will be started again from the beginning.

Searching for a passage during playback or programmed play

- Hold ◀◀ or ▶▶ pressed down to search for the required passage. If you release the button, play will continue.
- When ◀◀ or ▶▶ is pressed down, the display will show the elapsed playing time (either "59" to "0" or "0" to "59") in seconds only.

Note:

This is an "AUDIBLE SEARCH". The volume will automatically be reduced to a low level during search operation and will return to its normal level when the search button is released.

Maintenance

MAINTENANCE

THE SYSTEM

- A chamois leather slightly moistened with water is sufficient for cleaning the housing of the unit and the enclosures.
- Do not use cleaning agents containing alcohol, spirits, ammonia or abrasives.

THE CD PLAYER

- Keep the CD tray free of dust using a clean cloth.

THE CDs

- Never write on the printed side of a CD.
- Do not attach any stickers to a CD.
- Keep the shiny surface of a CD clean. Use a soft lint-free cloth and always wipe the CD in a straight line from centre to edge. (Fig. 5)
- Never use cleaning agents for conventional records and grease solvents or abrasives to clean CDs.

FAULTS AND THEIR LIKELY CAUSES

- If a fault occurs, first check the points listed below before sending the unit for repair. If the remedies fail to help, consult your dealer.

Problems with the CD player

- The CD is not inserted properly with the printed side facing up.
- The CD is dirty, badly scratched or warped.
- Because of large temperature differences, condensation has formed on the lens of the laser. This will disappear after some time.

PROBLEMS WITH THE WHOLE SYSTEM

Electrostatic charge may cause unexpected symptoms. See whether these symptoms disappear if you unplug the AC cord and plug it in again after a short period.

CAUTION:
INVISIBLE LASER RADIATION WHEN OPEN AND INTERLOCKS DEFEATED. AVOID EXPOSURE TO BEAM.

This product complies with the radio interference requirements of the European Community.

Troubleshooting Guide

The following checks will assist in the correction of most problems which you may encounter with your system. Before going through the check list below, first check the following points.

- ✎ ***The power cord must be connected firmly.***
- ✎ ***The speaker connection must also be firm.***

Should any problem persist after you have made these checks, consult your nearest dealer.

Symptom	Cause (and Remedy)
Unit not working	Check that the power cord is connected firmly.
The PLAY ► does not function when pressed	The disc is not inserted correctly. The disc is inserted upside down. The player is in PAUSE II mode. Moisture condensation.
No sound output	Check that the output cable is connected properly. Check that the amplifier or receiver is connected properly. The headphones are connected in the amplifier, disconnect them.
Track in the CD skips "0" is displayed	Dirty disc or scratched disc. The disc is inserted upside down. The CD is dirty, badly scratched or warped.
Programmed play does not start	The player is in normal play mode. Press STOP and program the tracks.
Severe hum or noise	Loose cable connections. Check that all the audio cables are connected firmly The TV or VTR is too close to the stereo system. Separate the stereo system from the TV or VTR.

GUARANTEE AND SERVICE VALID FOR AUSTRALIA

The benefits given to the purchaser by this warranty are in addition to all other rights and remedies, which, under the Trade Practices Act or other Commonwealth or State law, the purchaser or owner has in respect of the product.

The Philips product carries the following warranties: C-series HiFi-systems: 12 months. Compact Disc Players: 12 months. Home Audio Systems: 6 months. Clock radios, portable radios, cassette recorders, cassette players and radio recorders: 90 days.

Any defect in materials or workmanship occurring within the specified period from the date of delivery, will be rectified free of charge by the retailer from whom this product was purchased.

Note: Please retain your purchase docket to assist prompt service.

Conditions of this warranty

1. All claims for warranty service must be made to the retailer from whom this product was purchased. All transport charges incurred in connection with warranty service or replacement will be paid by the purchaser.
2. These warranties do not cover batteries and extend only to defects in materials or workmanship occurring under normal use of the product where operated in accordance with our instructions.

**Philips Consumer Products Division,
Technology Park
Figtree Drive, Australia Centre
Homebush 2140, New South Wales**

GUARANTEE AND SERVICE FOR NEW ZEALAND

Thank-you for purchasing this quality Philips product. The document you are now reading is your guarantee card.

Guarantee

Philips New Zealand Ltd guarantees this product against defective components and faulty workmanship for a period of 12 months. Any defect in materials or workmanship occurring within 12 months from the date of purchase subject to the following conditions will be rectified free of charge by the retailer from whom this product was purchased.

Conditions.

1. The product must have been purchased in New Zealand, and this guarantee card completed at time of purchase (this is your proof of the date of purchase).
2. The guarantee applies only to faults caused by defective components, or faulty workmanship on the part of the manufacturer.
3. The guarantee does not cover failures caused by misuse, neglect, normal wear and tear, accidental breakage, use on the incorrect voltage, use contrary to operating instructions, or unauthorised modification to the product or repair by an unauthorised technician.
4. Reasonable evidence (in the form of a sales docket or completed guarantee card) must be supplied to indicate that the product was purchased no more than 12 months prior to the date of your claim.
5. In the event of a failure, Philips shall be under no liability for any injury, or any loss or damage caused to property or products other than the product under guarantee.

This guarantee does not prejudice your rights under common law and statute, and is in addition to the normal responsibilities of the retailer and Philips

How to claim.

Should your Philips product fail within the guarantee period, please return it to the retailer from whom it was purchased. In most cases the retailer will be able to satisfactorily repair or replace the product.

However, should the retailer not be able to conclude the matter satisfactorily, or if you have other difficulties claiming under this guarantee, please contact

**The Guarantee Controller,
Philips New Zealand Ltd.**

✉ P.O. Box 41.021

Auckland

☎ (09) 84 44 160

GARANTIA PARA MEXICO

Este aparato está fabricado con materiales de alta calidad y ha sido cuidadosamente verificado. Philips, por lo tanto, da a usted una garantía de 12 meses a partir de su fecha de compra.

La garantía ampara la reposición de las piezas defectuosas debidas a fallas en su montaje o en los materiales, incluyendo la mano de obra necesaria para su reemplazo en nuestras Sucursales o talleres autorizados.

En caso de fallas en su aparato le rogamos se sirva poner en contacto con su distribuidor.

Esta garantía no cubrirá las averías que resulten como consecuencia de una instalación incorrecta del aparato, manifiesto maltrato o uso inadecuado del mismo.

Philips se obliga a reparar y devolver a usted su aparato en un plazo no mayor de 30 días hábiles contados a partir de la fecha de haber ingresado su aparato a uno de nuestros talleres.

Para que esta garantía sea válida, es necesario que el certificado que figura en la parte posterior de este instructivo haya sido debidamente llenado en el momento de la compra del aparato.

En caso de extravío del certificado con la presentación de la factura o remisión de su aparato podrá hacer efectiva la garantía correspondiente.

Si usted tiene alguna duda o pregunta que no le pueda solucionar su distribuidor, por favor ponerse en contacto con

**Oficinas Centrales de Servicio,
Av. Coyoacán No. 1051, Col. del Valle,
03100 MÉXICO, D.F.
☎ 5-75-20-22 o 5-75-01-00**

CD 601
CD 602

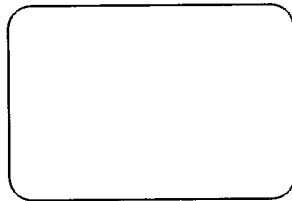

Printed In Hong Kong