

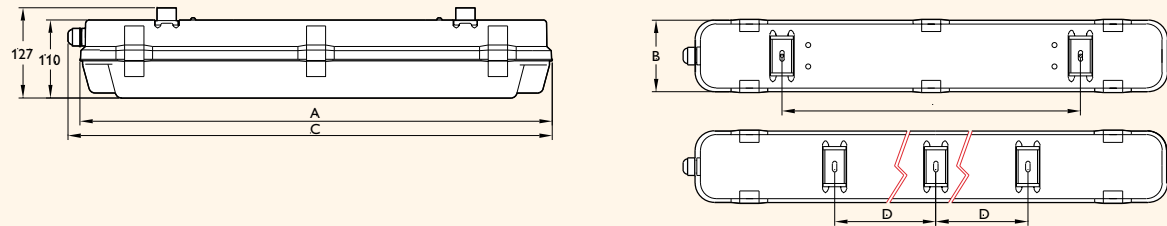

Product dimensions



| TCW097 | 1xTL'D 18W | 1xTL'D 36W | 1xTL'D 58W |
|--------|------------|------------|------------|
| | 1xTL'S 14W | 1xTL'S 28W | 1xTL'S 35W |
| A | 660 | 1270 | 1570 |
| B | 100 | 100 | 100 |
| C | 676 | 1276 | 1586 |
| D | 417 | 880 | 590 |

| TCW097 | 2xTL'D 18W | 2xTL'D 36W | 2xTL'D 58W |
|--------|------------|------------|------------|
| | 2xTL'S 14W | 2xTL'S 28W | 2xTL'S 35W |
| A | 660 | 1270 | 1570 |
| B | 150 | 150 | 150 |
| C | 676 | 1276 | 1586 |
| D | 417 | 880 | 590 |

Measurements in mm

Ordering data

| For TL'D Lamps | Lamp | Gross weight (kg) | Packing dimensions (mm) | Quantity per box | Ordering number |
|-----------------------|--------------|-------------------|-------------------------|------------------|-----------------|
| TCW097 1XTL-D18W HFE | 1 x TL'D 18W | 2 | 664 x 108 x 99 | 1 | 9104 019 83680 |
| TCW097 1XTL-D18W I | 1 x TL'D 18W | 2.1 | 664 x 108 x 99 | 1 | 9104 019 83880 |
| TCW097 1XTL-D18W IC | 1 x TL'D 18W | 2.1 | 664 x 108 x 99 | 1 | 9104 019 84080 |
| TCW097 1XTL-D36W HFE | 1 x TL'D 36W | 2.8 | 1274 x 108 x 99 | 1 | 9104 019 84680 |
| TCW097 1XTL-D36W I | 1 x TL'D 36W | 2.9 | 1274 x 108 x 99 | 1 | 9104 019 84880 |
| TCW097 1XTL-D36W IC | 1 x TL'D 36W | 2.9 | 1274 x 108 x 99 | 1 | 9104 033 20080 |
| TCW097 1XTL-D58W HFE | 1 x TL'D 58W | 4.8 | 1574 x 108 x 99 | 1 | 9104 033 20280 |
| TCW097 1XTL-D58W I | 1 x TL'D 58W | 4.9 | 1574 x 108 x 99 | 1 | 9104 033 20480 |
| TCW097 1XTL-D58W IC | 1 x TL'D 58W | 4.9 | 1574 x 108 x 99 | 1 | 9104 033 20680 |
| TCW097 2XTL-D18W HFE | 2 x TL'D 18W | 2.4 | 664 x 158 x 99 | 1 | 9104 033 21080 |
| TCW097 2XTL-D18W I | 2 x TL'D 18W | 2.6 | 664 x 158 x 99 | 1 | 9104 033 21280 |
| TCW097 2XTL-D18W IC | 2 x TL'D 18W | 2.6 | 664 x 158 x 99 | 1 | 9104 033 21480 |
| TCW097 2XTL-D36W HFE | 2 x TL'D 36W | 4.6 | 1274 x 158 x 99 | 1 | 9104 033 22080 |
| TCW097 2XTL-D36W I | 2 x TL'D 36W | 4.8 | 1274 x 158 x 99 | 1 | 9104 033 22380 |
| TCW097 2XTL-D36W IC | 2 x TL'D 36W | 4.8 | 1274 x 158 x 99 | 1 | 9104 033 22480 |
| TCW097 2XTL-D58W HFE | 2 x TL'D 58W | 6 | 1574 x 158 x 99 | 1 | 9104 033 22680 |
| TCW097 2XTL-D58W I | 2 x TL'D 58W | 6.2 | 1574 x 158 x 99 | 1 | 9104 033 22880 |
| TCW097 2XTL-D58W IC | 2 x TL'D 58W | 6.2 | 1574 x 158 x 99 | 1 | 9104 033 23080 |
| For TL'S Lamps | | | | | |
| TCW097 1XTLS-14W HFA | 1 x TL'S 14W | 2 | 664 x 108 x 99 | 1 | 9104 019 83480 |
| TCW097 1XTLS-28W HFA | 1 x TL'S 28W | 2.8 | 1274 x 108 x 99 | 1 | 9104 019 84280 |
| TCW097 1XTLS-35W HFA | 1 x TL'S 35W | 4.8 | 1574 x 108 x 99 | 1 | 9104 019 84480 |
| TCW097 2XTLS-14W HFA | 2 x TL'S 14W | 2.4 | 664 x 158 x 99 | 1 | 9104 033 20880 |
| TCW097 2XTLS-28W HFA | 2 x TL'S 28W | 4.6 | 1274 x 158 x 99 | 1 | 9104 033 21680 |
| TCW097 2XTLS-35W HFA | 2 x TL'S 35W | 6 | 1574 x 158 x 99 | 1 | 9104 033 21880 |

Note I = electromagnetic ballast IC = electromagnetic ballast + capacitor HFE = electronic ballast (EB-S) for TL'D lamps HFA = electronic ballast for TL'S lamps
Standard products with electromagnetic ballast are for 220V 50Hz system (Specification subject to change without prior notice)

32 1-B27 3 002-01

www.lighting.philips.com/apr

© Koninklijke Philips Electronics N.V. 2003
All rights reserved, reproduction in whole or in part without permission is prohibited.

PHILIPS



TCW097 Pacific II

waterproof luminaires



- Excellent water and dust protection
- Impact-resistant
- Optimum light distribution and performance
- Easy installation and maintenance

lighting solutions that really last

waterproof luminaires

The demands placed on lighting in wet and dusty conditions in terms of flexibility, efficiency and ease of maintenance are vital for many industrial environments. Luminaires should be protected against the ingress of foreign bodies and be easy to clean while delivering the best possible light.

Philips is proud to introduce the new TCW097 waterproof luminaires. Specially designed to withstand dusty and humid conditions, the high

performance TCW097 meets the stringent IP66 classification for greater resistance against moisture and dust. Besides being easy to install and maintain, TCW097 comes available with either TL'D lamps or the slim and efficient TL'S lamps.



TCW097 for wet and dusty environments
In humid and dirty industrial conditions, luminaires offering protection against the ingress of water and dust are crucial. Effective lighting in such environments not only maximizes productivity but also helps minimize accidents and promote the comfort and well being of the worker. TCW097 waterproof luminaires are especially designed for use in industrial environments such as the food and beverage industry, power plants, sawmills, cement plants, slaughterhouses and other industries where the level of dust and humidity is abnormally high. Its IP66 classification as well as a robust structure and design delivers optimal light output necessary to maintain good working conditions.



TCW097 for general interiors
Uniform lighting is essential for large areas with a high density of human and traffic, such as car parks, passageways and warehouses. Fluorescent luminaires are the best solution to illuminate these areas to enhance safety and security. TCW097 comes with a choice of either TL'D or TL'S lamps which combines a pleasant light color with natural color rendering, high efficacy and a long life. Its sturdy polycarbonate framework delivers durability and makes this luminaire impact-resistant. Moreover, only basic tools are needed to install TCW097 making installation quick and easy.

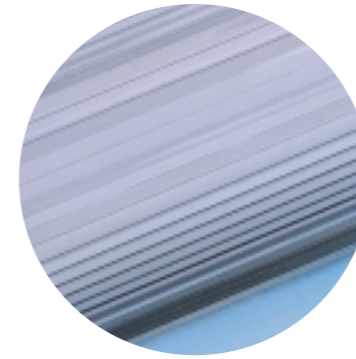

Optimum light distribution and performance

Designing TCW097 with quality materials helps deliver good light output necessary for many industrial conditions. Its excellent light distribution requires fewer luminaires to be installed, thus saving energy and electrical costs.



Excellent water and dust protection

TCW097's specially designed gasket and stainless steel toggles attain an IP66 classification guaranteeing resistance against ingress of water and dust. It delivers the best possible light even in extremely humid and dusty conditions.

Easy installation and maintenance

TCW097's polycarbonate structure ensures durability. Installation and maintenance are made easy with only the use of basic tools, saving on installation time and cost.

Application guide

Top view arrangement

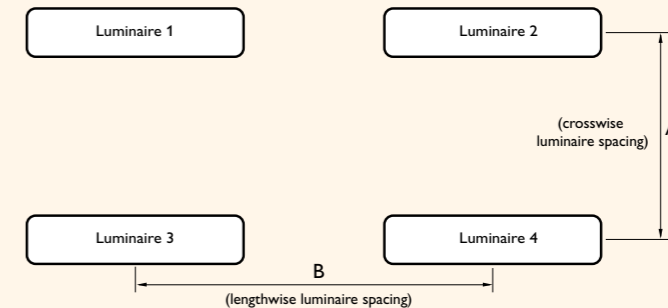

Car park (20-50 lux)

| Spacing | | A | B |
|-----------------|------|------|------|
| Mounting height | 2.5m | 6.0m | 6.0m |
| | 3.5m | 5.5m | 5.5m |
| | 4.5m | 5.0m | 5.0m |

Note: Lighting level ≥ 20 lux with 1x18W, ≥ 50 lux with 1x36W

General industrial area (150-300 lux)

| Spacing | | A | B |
|-----------------|------|------|------|
| Mounting height | 3.0m | 4.5m | 4.5m |
| | 5.0m | 4.2m | 4.2m |
| | 7.0m | 3.7m | 3.7m |

Note: Lighting level ≥ 150 lux with 2x28W and 2x36W, ≥ 200 lux with 2x35W and 2x58W