



**Deluxe Weather Forecaster with
Wireless UV Sensor**

Model: BAR609HGA

USER MANUAL



ZEN

Deluxe Weather Forecaster with Wireless UV Sensor

BAR609HGA

USER MANUAL

CONTENTS

Introduction	2
Product Overview	3
Front View	3
Back View	4
Thermo-Hygro Sensor (THGR122NX)	5
Front View (UVN128)	6
Back View (UVN128)	6
Getting Started	7
Batteries	7
Access Front Button Panel	7
Change Settings	7
Table Stand or Wall Mount	7
Thermo-Hygro Sensor (THGR122NX)	7
Setup Sensor	8
Data Transmission	9
Search for Sensor	9
Clock	9
Turn Atomic Clock ON / OFF	10

1

Set Clock	10
Switch Clock Display	10
Alarm	10
View Alarm Settings	11
Set Alarm	11
Activate Alarm	11
Silence Alarm	11
Barometer	11
Barometric Trend	11
Set Unit and Altitude	11
Weather Forecast	12
Temperature and Humidity	12
Select Temperature Unit	12
Select Channel Number	12
Minimum / Maximum Records	13
Ice Warning	13
Heat Index	13
UV Sensor (UVN128)	14
Setup Sensor	14
UV Index Readings	15
Moon Phase	15
Backlight	15
Reset System	15
Safety and Care	16





EN

Warnings	16
Troubleshooting	17
Specifications	17
Main Unit Dimensions	17
Thermo-Hygro Sensor Dimensions	17
UV Sensor Dimensions	17
Temperature	17
Relative Humidity	18
Barometer	18
Thermo-Hygro Sensor (THGR122NX)	18
Clock	18
Power	18
UV Sensor (UVN128)	18
About Oregon Scientific	19
FCC Statement	19
Declaration of Conformity	20

INTRODUCTION

Thank you for selecting the Oregon Scientific™ Deluxe Weather Forecaster with Wireless UV Sensor (BAR609HGA). This device bundles precise time keeping, UV measurement, weather forecast, barometric trend with altitude adjustment, and indoor and outdoor temperature and humidity monitoring features into a single tool you can use from the convenience of your home.

In this box, you will find:

- Main unit
- Thermo-Hygro sensor (THGR122NX)
- UV sensor (UVN128)

Keep this manual handy as you use your new product. It contains practical step-by-step instructions, as well as technical specifications and warnings you should know.

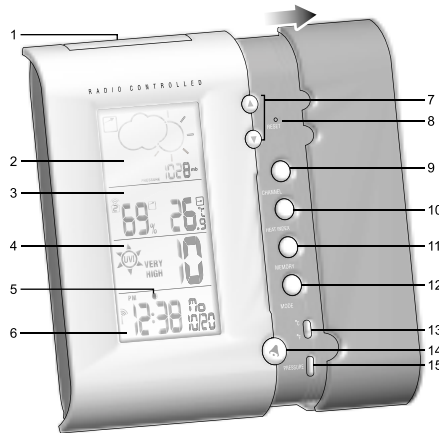

**PRODUCT OVERVIEW****FRONT VIEW**

1. **SNOOZE / LIGHT** button
2. Weather Forecast & Barometric Area
3. Indoor / Outdoor Temperature & Humidity Area
4. UV Index (UVI) Area
5. Moon Phase
6. Clock / Alarm Area
7. ▲ and ▼ : increase or decrease setting / activate or deactivate Atomic Clock
8. **RESET** hole
9. **CHANNEL**: switch remote sensor
10. **HEAT INDEX**: switch between heat index, indoor / outdoor temperature and humidity displays
11. **MEMORY**: view current, max and min temperature, humidity and UVI
12. **MODE**: change clock display / settings
13. °C / °F switch
14. 🔔 : display / change alarm time, enable / disable alarm
15. **PRESSURE**: change altitude measurement unit (mb or inHg) and altitude compensation value



EN

BACK VIEW



1. Wall mount
2. Battery compartment
3. Table stand



THERMO-HYGRO SENSOR (THGR122NX)

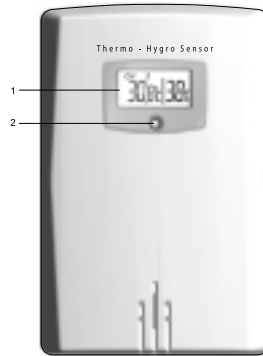

1. LCD display
2. LED status indicator

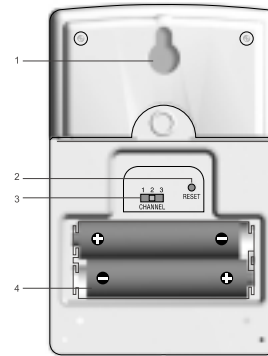

1. Wall mount hole
2. RESET
3. Channel number (1 - 3)
4. Battery compartment
(Battery compartment cover not shown)



EN

FRONT VIEW (UVN128)

BACK VIEW (UVN128)

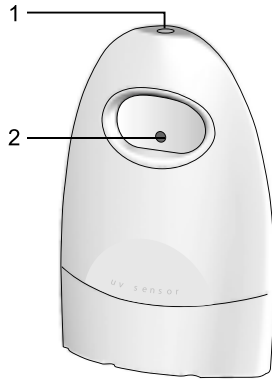

- 1. Sensor
- 2. LED indicator

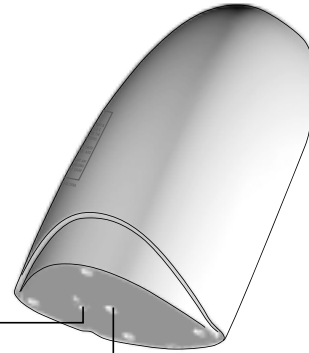

- 1. RESET hole
- 2. Connector for stake apparatus



GETTING STARTED

BATTERIES

Batteries are not supplied with this product. You will need to purchase the following alkaline batteries:

- Main unit 3 x UM-3 / AA 1.5V
- Remote sensor 2 x UM-4 / AAA 1.5V
- UV sensor 2 x UM-3 / AA 1.5V

Insert batteries before first use, matching the polarity as shown in the battery compartment. For best results, install batteries in the sensors before the main unit. Press **RESET** after each battery change.

NOTE Do not use rechargeable batteries.

 shows when batteries are low.

UNIT	 LOCATION
Main Unit & Remote Sensor	Temperature / Humidity Area
UV Sensor	UV Index Area

ACCESS FRONT BUTTON PANEL

The front button panel is located inside the right portion of the main unit. Slide it right to access the buttons.

CHANGE SETTINGS

1. Press and hold **MODE** for 2 seconds to enter setting mode.
2. Press **▲** or **▼** to change settings.
3. Press **MODE** to confirm.

TABLE STAND OR WALL MOUNT

Use the stand on the back of the product, or mount it on a wall with a nail.

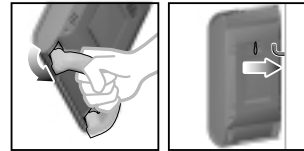

THERMO-HYGRO SENSOR (THGR122NX)

This product is shipped with a THGR122NX Thermo/Hygro Sensor that collects Temperature and Humidity data. Data can be collected from up to 3 sensors. Additional sensors sold separately.



SETUP SENSOR

1. Open the sensor battery compartment with a small Phillips screwdriver.
2. Insert the batteries, matching the polarity as shown in the battery compartment.

SWITCH	OPTION
Channel	Channel 1 - 3. If you are using more than one sensor, select a different channel for each sensor.

3. Set the channel. The switch is located in the battery compartment.
4. Place the sensor near the main unit. Press **RESET** on the sensor. Then, press and hold **MEMORY** and **CHANNEL** on the main unit to initiate signal sending between the sensor and the main unit. The reception icon on the main unit will blink for approximately 3 minutes while it is searching for the sensor. (Refer to the Data Transmission section for more information.)
5. Close the remote sensor battery compartment.
6. Secure the sensor in the desired location using the wall mount or table stand.



For best results:

- Insert the batteries and select the channel before you mount the sensor.
- Place the sensor out of direct sunlight and moisture.
- Do not place the sensor more than 98 feet (30 meters) from the main (indoor) unit.
- Position the sensor so that it faces the main (indoor) unit, minimizing obstructions such as doors, walls, and furniture.
- Place the sensor in a location with a clear view to the sky, away from metallic or electronic objects.
- Position the sensor close to the main unit during cold winter months as below-freezing temperatures may affect battery performance and signal transmission.

You may need to experiment with various locations to get the best results.

Standard Alkaline batteries contain significant amounts of water. Because of this they will freeze in low temperatures of approximately 10°F. Disposable Lithium batteries have a much lower threshold for temperature with an estimated freezing range of below -40°F. The Liquid Crystal Display in outdoor thermometers will remain operational to -20°F with adequate power.



Wireless ranges can be impacted by a variety of factors such as extremely cold temperatures. Extreme cold may temporarily reduce the effective range between the sensor and the base station.

If the unit's performance fails due to low temperature, the unit will resume proper functioning as the temperature rises to within the normal temperature range (i.e no permanent damage will occur to the unit due to low temperatures).

DATA TRANSMISSION

Data is sent from the sensor(s) every 40 seconds. The reception icon shown in the Temperature and Humidity Area shows the status.

ICON	DESCRIPTION
	Main unit is searching for sensors.
	At least 1 channel has been found.
	Channel 1 is selected (number will change depending on the sensor you select)
--- shows in Outdoor Temp / Humidity Area	The selected sensor cannot be found. Search for the sensor or check batteries.

SEARCH FOR SENSOR

To search for a sensor, press and hold **MEMORY** and **CHANNEL** for 2 seconds.



NOTE If the sensor is still not found, check the batteries, obstructions, and remote unit location.

NOTE Signals from household devices such as doorbells, electronic garage doors, and home security systems may cause temporary reception failure. This is normal and does not affect general product performance. The reception will resume once the interference ends.

CLOCK

This product shows the current time, and day of week in English, French, German, Italian, or Spanish. The US Atomic Clock in Boulder, Colorado automatically updates this information unless you disable the feature. The signals are collected by the main unit when it is within 932 miles (1500 km) of a signal.

Initial reception takes 2 - 10 minutes, and is initiated when you first setup the unit, and whenever you press **RESET**. Once complete, the reception icon will stop blinking. The icon is shown in the Clock Area.

STRONG SIGNAL	WEAK SIGNAL	NO SIGNAL
		

To force a manual search for Atomic Clock signals, press and hold ▲ for 2 seconds. If no signal is found, check the batteries.

NOTE If the Atomic Clock signal is received and the hour is incorrect, use the "time zone offset" feature to adjust it to the appropriate time zone. Please see "Set Clock section" for instructions.

TURN ATOMIC CLOCK ON / OFF

Perform this step if you cannot receive Atomic Clock signals. Press and hold ▼ for 2 seconds. Then, manually set the clock following the Set Clock section for instructions.

 The signal icon indicates that the Atomic Clock feature is ON. No icon means that it is OFF.

SET CLOCK

You only need to do this if you cannot receive the Atomic Clock signal, or you wish to adjust the appropriate time zone.

1. Press and hold **MODE** for 2 seconds. The Clock Area will blink.
2. Select the time zone, hour, minute, year, month, day, and language. Press ▲ or ▼ to change the setting. Press **MODE** to confirm.

NOTE The language options are (E) English, (F) French, (D) German, (I) Italian, and (S) Spanish.

NOTE The time zone options are (PA) Pacific, (CE) Central, (MO) Mountain, and (EA) Eastern.

SWITCH CLOCK DISPLAY

Press **MODE** to toggle between Clock with Seconds and Clock with Weekday display.

ALARM

This product is equipped with a 2-minute crescendo alarm.



25

VIEW ALARM SETTINGS

Press . The alarm time and status will show in the Clock Area.

SET ALARM

1. Press to switch to alarm display.
2. Press and hold again for 2 seconds. The alarm settings will blink.
3. Select the hour and minute. Press or to change settings. Press to confirm.

ACTIVATE ALARM

Press to activate or deactivate the alarm. shows in the Clock / Alarm Area when the alarm is activated.

SILENCE ALARM

When the alarm time is reached, the crescendo alarm will sound for 2 minutes. Press **SNOOZE / LIGHT** to silence it for 8 minutes. Or, press to turn it off until the next day.

If no button is pressed, the alarm will automatically silence after 2 minutes. It will then sound again after 8 minutes.

BAROMETER

This product tracks barometric pressure changes over the past 24 hours to provide the weather forecast and a trend line showing the direction of barometric change. Barometric changes are measured by the main (indoor) unit.

BAROMETRIC TREND

TREND	DESCRIPTION
	Rising
	Steady
	Falling





SET UNIT AND ALTITUDE

You can set the unit of measurement (mb or inHg) and altitude. Doing this allows the product to take more accurate barometric measurements.

1. Press **PRESSURE** to select the unit of measurement: mb or inHg.
2. Press and hold **PRESSURE** for 2 seconds.
3. Select the altitude (-328 feet to 8203 feet in increments of approximately 33). Press ▲ or ▼ to change the setting. Press **PRESSURE** to confirm.

WEATHER FORECAST

This product forecasts the next 12 to 24 hours of weather within a 30 to 50 mile (19 - 31 km) radius with 70 to 75 percent accuracy. The weather forecast is always displayed.

CLEAR	PARTLY CLOUDY	CLOUDY	RAINY
			

TEMPERATURE, HUMIDITY AND HEAT INDEX

This product can display current, minimum, and maximum temperature, humidity percentage and heat index information collected by the remote sensors and main (indoor) unit.

Outdoor data is collected and displayed every 40 seconds. Indoor data is collected and displayed every 10 seconds.





SELECT TEMPERATURE UNIT

Slide the °C / °F switch into the desired location. The switch is located on the front button panel. The setting for the main unit overrides the Thermo-Hygro sensor setting.

SELECT CHANNEL NUMBER

Press **CHANNEL** to switch between sensors 1-3.

The icon shows the selected sensor.

KINETIC-WAVE ICON				
DESIGNATED DISPLAY	Indoor Display	Remote Display Channel 1	Remote Display Channel 2	Remote Display Channel 3

To auto-scan between sensors, press and hold **CHANNEL** for 2 seconds. Each sensor's data will be displayed for 3 seconds. To end auto-scan, press **CHANNEL** or **MEMORY**.

NOTE If you use a sensor that collects only temperature data, humidity will not be shown.



MINIMUM / MAXIMUM RECORDS

To view temperature, humidity or **UV** Index current, maximum (**MAX**) and minimum (**MIN**) records:

1. Press **CHANNEL** to select channel 1-3 or indoor.
2. Press **MEMORY** to view the selected channel's records.

Press **MEMORY** to toggle between current, maximum (**MAX**) and minimum (**MIN**) records. To clear the records, press and hold **MEMORY** for 2 seconds. A beep will sound to confirm that the memory has been cleared.

ICE WARNING

The temperature range at which water begins to freeze and turns to ice is approx. 37°F (3°C) to 28°F (-2°C). It is during this period that ice becomes most slippery, creating hazardous surface conditions dangerous for travelling.

The BAR609HGA's Ice Warning feature gives out temperature readings to warn you when the temperature is approaching freezing. If Channel 1 sensor falls between 37°F to 28°F (3°C to -2°C), the freeze alert icon ❄️ will flash on the main unit display.

HEAT INDEX

Heat index is the temperature the body feels when heat and humidity are combined. The temperature you feel does not always correspond to the actual air temperature

and relative humidity. The heat index (apparent temperature) is how hot the heat-humidity combination makes you feel.

The BAR609HGA's heat index feature advises 4 levels of warning if the temperature is high.

WARNING	HEAT INDEX		MEANING
	°F	°C	
Extreme danger	130 or above	54.5 or above	Strong possibility of heat stroke
Danger	105-129	40.5-53.9	Heat exhaustion likely
Extreme caution	90-104	32.2-40	Possibility of heat dehydration
Caution	80-89	26.6-31.7	Possibility of heat exhaustion

- To display the heat index, press **HEAT INDEX**.
- To toggle between current / maximum / minimum readings, press **HEAT INDEX**, then press **CHANNEL** to select channel 1-3 or indoor, followed by **MEMORY**.
- To toggle between temperature / humidity and heat index display, press and hold **HEAT INDEX** for 2 seconds. Press **HEAT INDEX** again to stop this feature.

NOTE If the heat index is below 80°F / 26°C, or the desired channel is not working, the heat index will display "NA".

UV SENSOR (UVN128)

The UV sensor measures the UV Index. It transmits data to the main unit every 73 seconds and has a maximum transmission range of 328 feet (100 meters).

SETUP SENSOR

1. Insert the batteries as shown.

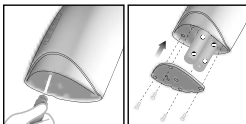

2. Close the battery door and press **RESET** to turn the sensor on.

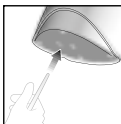

3. Press and hold **CHANNEL** and **MEMORY** on the main unit to initiate a signal search. The UVI sensor icon  on the main unit will flash to show it is searching for the sensor. It will stop flashing when it has found the sensor. If the main unit cannot find the sensor, "- -" will appear on the LCD.

4. You can place the sensor in the ground. To do this, fix the stake into the base of the sensor.

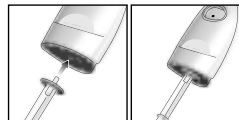

Then place the stake into the ground up to the insertion level indicator (see point 1 below) at your desired location.

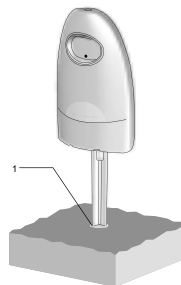



NOTE To get the most accurate readings, place the sensor in a position that has minimum obstructions (i.e. walls and doors) between it and the main unit. The sensor should be placed in an upright position, away from any shade or shadows that may affect how accurate the sensor provides readings.

UV INDEX READINGS

To interpret the UV readings on the LCD display, see the table below.

UV MESSAGE	UV INDEX	PRECAUTION
Low	1-2	Apply sunscreen
Med	3-5	Wear protective clothing
High	6-7	Wear sunglasses and protective clothing
Very high	8-10	Avoid the sun between 10am and 4pm
Extreme	11-25	Very strong rays stay indoors

MOON PHASE

The Calendar must be set for this feature to work. see set clock section:

- Press ▲ or ▼ to view the moon phase for the next or previous day.
- Press and hold ▲ or ▼ to scan quickly through the years (2001 to 2099).

	New Moon
	Waxing Crescent
	First Quarter
	Waxing Gibbous
	Full Moon
	Waning Gibbous
	Last Quarter
	Waning Crescent

BACKLIGHT

Press **SNOOZE / LIGHT** to activate the backlight for 8 seconds.

RESET SYSTEM

The **RESET** button is located behind the front button panel for the main unit. Press **RESET** when you change the batteries and whenever performance is not behaving

EN

as expected (for example, unable to establish radio frequency link with sensor or Atomic Clock).

NOTE When you press **RESET**, all settings will return to default value, and you will lose all stored information.

SAFETY AND CARE

Clean the product with a slightly damp cloth and alcohol-free, mild detergent. Avoid dropping the product or placing it in a high-traffic location.

WARNINGS

This product is designed to give you years of service if handled properly. Observe the following guidelines:

- Never immerse the product in water. This can cause electrical shock and damage the product.
- Do not subject the main unit to extreme force, shock, or fluctuations in temperature or humidity.
- Do not tamper with the internal components.
- Do not mix new and old batteries or batteries of different types.
- Do not use rechargeable batteries with this product.
- Remove the batteries if storing this product for a long period of time.
- Do not scratch the LCD display.

**TROUBLESHOOTING**

Check here before contacting our customer service department.

Problem	Symptom	Remedy
Calendar	Strange date / month	Change language
Clock	Cannot adjust clock	Disable Atomic Clock
	Cannot auto-synch	1. Adjust batteries 2. Press RESET 3. Manually activate Atomic Clock feature
Temp	Shows "LLL" or "HHH"	Temperature is out-of-range
Sensor	Cannot locate remote sensor	Check batteries
		Check location
Sensor	Cannot change channel	Check sensors. Only one sensor is working
	Data does not match main unit	Initiate a manual sensor search

SPECIFICATIONS**MAIN UNIT DIMENSIONS**

L x W x H	5.5 x 2.5 x 6.2 inches (142 x 63 x 158 mm)
Weight	12.96 ounces (366 g) with battery

THERMO-HYGRO SENSOR DIMENSIONS

L x W x H	3.6 x 2.4 x 0.79 inches (92 x 60 x 20 mm)
Weight	2.22 ounces (63 g) without battery

UV SENSOR DIMENSIONS

W X H X L	2.7 x 4 x 1.9 inches (67.7 x 102.5 x 47 mm)
Weight	2.89 ounces (82 g) without battery

TEMPERATURE

Unit	°F or °C
Indoor Range	-23°F to 122°F (-5°C to 50°C)
Outdoor Range	-22°F to 140°F (-30°C to 60°C)
Resolution	0.2°F (0.1°C)



N

RELATIVE HUMIDITY

Range	25% to 95%
Resolution	1%
Memory	Minimum / maximum

BAROMETER

Unit	mb or inHg
Range	700 to 1050 mb (20.67 to 30.01 inHg)
Resolution	1 mb (0.03 inHg)
Altitude	-328 to 8203 feet
Display	Rainy, cloudy, partly cloudy, sunny

THERMO-HYGRO SENSOR (THGR122NX)

RF frequency	433 MHz
Range	98 feet (30 meters) with no obstructions
Transmission	Every 40 seconds
Channel No.	1-3

CLOCK

Atomic Clock	Auto or manual (disabled)
Clock display	HH:MM:SS
Hour format	12hr AM/PM
Time zone	PA (Pacific), MO (Mountain), CE (Central) or EA (Eastern)
Calendar	MM/DD; weekday in 5 languages (E, D, F, I, S)
Alarm	Single alarm with 2- minute crescendo and 8-minute Snooze

POWER

Main unit batteries	3 x UM-3 (AA) 1.5V alkaline
Thermo-Hygro batteries	2 x UM-4 (AAA) 1.5V alkaline
UV Sensor	2xUM-3 (AA) 1.5V alkaline

UV SENSOR (UVN128)

UV Range	328 feet (100 meters)
Transmission	Every 73 seconds



ABOUT OREGON SCIENTIFIC

Visit our website (www.oregonscientific.com) to learn more about Oregon Scientific products such as digital cameras; MP3 players; children's electronic learning products and games; projection clocks; health and fitness gear; weather stations; and digital and conference phones. The website also includes contact information for our customer care department in case you need to reach us, as well as frequently asked questions and customer downloads.

We hope you will find all the information you need on our website, however if you're in the US and would like to contact the Oregon Scientific Customer Care department directly, please visit: www2.oregonscientific.com/service/support OR Call 949-608-2848.

For international enquiries, please visit: www2.oregonscientific.com/about/international/default.asp

FCC STATEMENT

This device complies with Part 15 of the FCC Rules. Operation is subject to the following two conditions: (1) This device may not cause harmful interference, and (2) This device must accept any interference received, including interference that may cause undesired operation.

WARNING Changes or modifications to this unit not expressly approved by the party responsible for compliance could void the user's authority to operate the equipment.

NOTE This equipment has been tested and found to comply with the limits for a Class B digital device, pursuant to Part 15 of the FCC Rules. These limits are designed to provide reasonable protection against harmful interference in a residential installation.

This equipment generates, uses and can radiate radio frequency energy and, if not installed and used in accordance with the instructions, may cause harmful interference to radio communications. However, there is no guarantee that interference will not occur in a particular installation. If this equipment does cause harmful interference to radio or television reception, which can be determined by turning the equipment off and on, the user is encouraged to try to correct the interference by one or more of the following measures:

- Reorient or relocate the receiving antenna.



EN

- Increase the separation between the equipment and receiver.
- Connect the equipment into an outlet on a circuit different from that to which the receiver is connected.
- Consult the dealer or an experienced radio / TV technician for help.

DECLARATION OF CONFORMITY

The following information is not to be used as contact for support or sales. Please call our customer service number (listed on our website at www.oregonscientific.com), or on the warranty card for this product) for all inquiries instead.

We

Name: Oregon Scientific, Inc.
Address: 19861 SW 95th Place, Tualatin, Oregon
97062 USA
Telephone No.: 1-800-853-8883
Fax No.: 1-503-684-3332

declare that the product

Product No.: BAR609HGA
Product Name: Wireless Weather Station
Manufacturer: IDT Technology Limited
Address: Block C, 9/F, Kaiser Estate, Phase 1,
41 Man Yue St., Hung Hom, Kowloon,
Hong Kong

is in conformity with Part 15 of the FCC Rules. Operation is subject to the following two conditions: 1) This device may not cause harmful interference. 2) This device must accept any interference received, including interference that may cause undesired operation.

© 2005 Oregon Scientific. All rights reserved.

086-003767-011