

# BOSCH

Use and Care Manual

For Household Use Only

Notice d'utilisation et d'entretien

Usage domestique uniquement

Manual de instrucciones y cuidado

sólo para uso doméstico

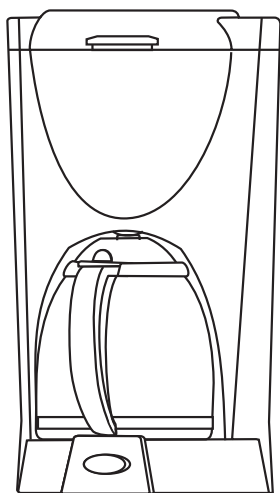

TKA 280. UC  
TKA 283. UC  
Coffeemaker

---

Use and Care Manual .....	3
Notice d'utilisation et d'entretien .....	??
Manual de instrucciones y cuidado .....	??

---

---

# IMPORTANT SAFEGUARDS

When using electrical appliances, basic safety precautions should always be followed to reduce the risk of fire, electric shock and injury to persons, including the following:

- Read all instructions before using the coffeemaker.
- Do not touch hot surfaces. Use handles.
- This appliance should not be used by children and care should be taken when used near children.
- Unplug from outlet when not in use and before cleaning.
- Allow to cool before putting on or taking off parts, and before cleaning the coffee-maker.
- To disconnect, switch off, then remove plug from power supply.
- Do not operate a damaged coffeemaker. Do not operate with a damaged cord or plug or after the coffeemaker malfunctions, or has been dropped or damaged in any manner. Return coffeemaker to the nearest authorized service facility for examination, repair or mechanical adjustment.
- Do not put cord, plug or body of the coffeemaker in or under water or other liquid. See instructions for cleaning.
- Use attachments only if recommended by us.
- Do not use outdoors or in damp areas.
- Do not use the coffeemaker for other than its intended use.
- Do not let cord hang over edge of table or counter or touch hot surfaces.
- The carafe is designed for use with this appliance. It must never be used on a range top.
- Do not set a hot carafe on a wet or cold surface.
- Do not use a cracked carafe or a carafe having a loose or weakened handle.
- **WARNING:** do not remove bottom cover. No user serviceable parts inside. Repair must be done by authorized service personnel only.

**SAVE THESE INSTRUCTIONS**  
**HOUSEHOLD USE ONLY**

---

## Before using the coffeemaker for the first time

- ❑ First run water through the coffeemaker without coffee. Fill water tank with 9 cups of water and turn the coffeemaker on.
- ❑ If the coffeemaker smells “new”, run 2 cups of vinegar diluted with 6 cups of water through the coffeemaker, then follow this up twice with 9 cups of clean water.

---

## Important information concerning the use of this coffeemaker

**TKA 280.**

**TKA 283.**

These operating instructions refer to two models:  
TKA 280. = tank with a capacity of approx. 10 cups.  
TKA 283. = tank with a capacity of approx. 12 cups.

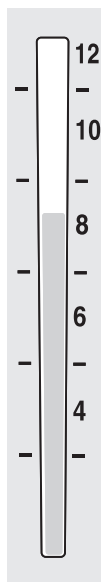
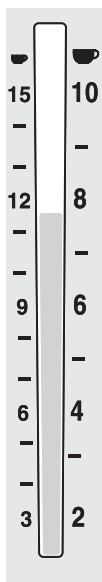

Do not fill the tank with less than 3 cups, otherwise the coffee will not reach the required temperature or strength.

To remove or re-attach the lid on the water tank, swivel it open so that it is pointing straight up.

Fill the tank with cold water only. Any other liquid will damage the coffeemaker.

Make sure the carafe has been properly inserted into the coffeemaker before turning it on.

# How to use the coffeemaker



1. Pull out the carafe.

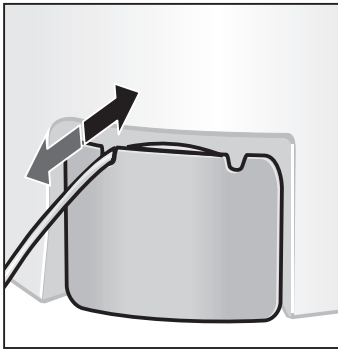

2. Pull the required length of cord out of the storage compartment.

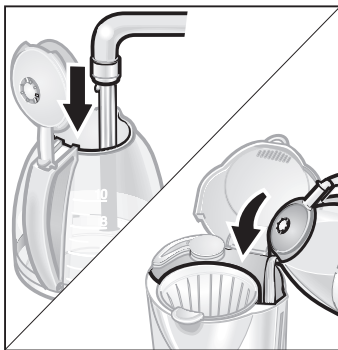

3. Pour in the required amount of water.



4. Close the lid and place the carafe under the filter holder.

---

## Adding ground coffee



5. Put a no. 4 paper filter into the holder and add the required amount of medium to finely ground coffee. Adjust the amount of coffee to your personal taste. **Do NOT use instant coffee.**

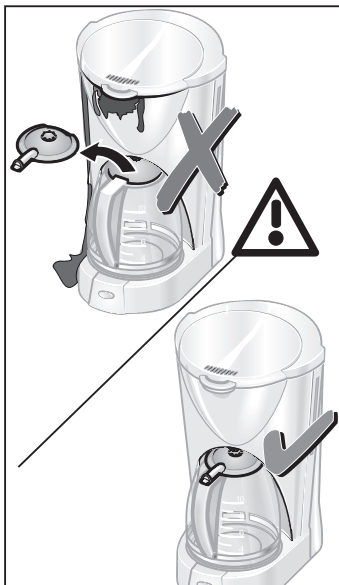

6. Close the lid correctly, or the filter holder will overflow.



7. Press the button ON.

The button of TKA 283. range returns automatically to the middle position.

**TKA 280.**



**TKA 283.**

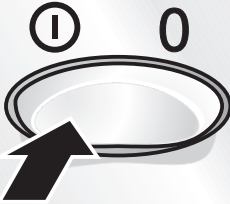

8. When all the water has passed through, switch the coffeemaker off by pressing the button OFF.

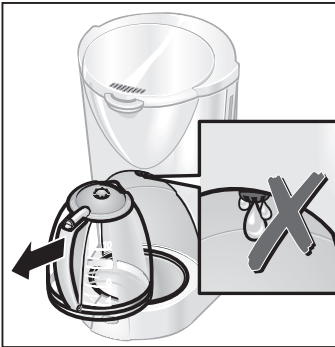

The drip stop prevents any more coffee dripping from the base of the filter.

### **CAUTION**

The coffeemaker must be left to cool down for approx. 5 minutes before you add more water.

Make sure the carafe is completely empty before brewing another pot or the carafe will overflow.



---

## Coffee Tips

Ground coffee should be stored in a cool place so that it stays fresh for a longer period. It can be kept in a refrigerator for approx. 4 days or in a freezer for approx. 3 weeks without losing its aroma or flavor. Coffee beans will keep for up to 2 years in their original packaging.

Once a package of coffee has been opened, it should be kept as tightly sealed as possible in order to retain the aroma.

The degree to which coffee beans have been roasted affects the flavor and aroma:

dark-roasted = more aroma, stronger flavor

light-roasted = sharper, acidic

---

## How to make tea

1. Pour water into the tank and put tea leaves or tea bag(s) into the paper filter.
2. Switch on the coffeemaker and allow the water to run through.

### **CAUTION**

**Do not put a metal tea infuser into the carafe or you risk breaking the glass!**

**Do NOT use instant tea.**

---

# How to clean your coffeemaker

## **WARNING**

Unplug the coffeemaker before cleaning.

## **CAUTION**

All detachable parts are dishwasher-proof but they should not be placed directly over the heating element.

1. Remove stubborn coffee or tea stains with vinegar diluted with hot water and then rinse the affected parts thoroughly with clean water.

## **CAUTION**

Do not use a sharp object or abrasive substance to clean the coffeemaker.

2. When the coffeemaker has cooled down, wipe the outside with a damp cloth.

## **RISK OF ELECTRIC SHOCK!**

Do not immerse the coffeemaker in water or put it in a dishwasher.

## **CAUTION**

Broken glass is not covered by the warranty.

---

# When and how to descale your coffeemaker

On average, you should descale every three months, depending on the hardness of your water, or when the following conditions occur:

- the time required to make the coffee becomes longer
  - an excessive amount of steam is generated
  - the coffeemaker becomes noisier
  - the coffeemaker switches off prematurely
- 1.** Pour descaler into the water tank in accordance with the descaling product manufacturer's instructions.
  - 2.** Press the button ON and after 1 minute press the button OFF. Leave the solution to react for 10 minutes. Repeat this procedure at least three times (depending upon the amount of scale that has formed).
  - 3.** Switch the coffeemaker on again and let the remaining solution run through.
  - 4.** Run 9 cups of clean water through the coffeemaker twice.
  - 5.** Finally, unplug the coffeemaker, clean it and thoroughly rinse all detachable parts.

---

# BOSCH Small Appliance Warranty

BSH Home Appliances ("BOSCH") warrants all new small appliances to be free from original defects in design, materials and workmanship for one (1) year after the sale to the original owner.

Within the stated warranty period, BOSCH will repair or replace, at its sole option, any small appliance or parts thereof which prove defective under conditions of normal use and service at no charge to you. It is the owner's responsibility to return the appliance for repair. Repaired and replacement small appliances and parts shall be the same or as close in appearance as possible to the original for the purposes of this warranty.

Should you require service of your BOSCH small appliance, please contact customer service at 1-866-44-BOSCH. Repair of BOSCH appliances should only be performed by qualified technicians.

This warranty is limited to the original consumer purchase and is not transferable. Specifically excluded from this warranty are failures caused by accident, misuse, neglect, abuse, including tampering, use on a frequency or voltage other than marked on the product, and use for commercial purposes.

To the extent allowed by law, this warranty sets out your exclusive remedies, whether for negligence or otherwise. BOSCH will not be liable for any consequential or incidental damages, losses or expenses. THIS WARRANTY IS IN LIEU OF ALL OTHER EXPRESSED WARRANTIES. ANY WARRANTY IMPLIED BY LAW, WHETHER FOR MERCHANTABILITY OR FITNESS FOR A PARTICULAR PURPOSE OR OTHERWISE, SHALL BE EFFECTIVE ONLY FOR THE PERIOD THAT THIS EXPRESSED WARRANTY IS EFFECTIVE. BOSCH DOES NOT ASSUME ANY RESPONSIBILITY FOR INCIDENTAL OR CONSEQUENTIAL DAMAGES.

No attempt to alter, modify or amend this warranty shall be effective unless authorized in writing by an officer of BOSCH. Some states do not allow limitations on how long implied warranties last or the exclusion or limitation of incidental or consequential damages, so the foregoing limitations and exclusions may not apply to you. This warranty gives you specific legal rights and you may also have other rights which vary from state to state.

BSH Home Appliances Corporation  
5551 McFadden Avenue  
Huntington Beach, CA 92649  
USA

Web site: [www.boschappliances.com](http://www.boschappliances.com)

Customer Service (toll free): 1-866-44BOSCH (1-866-442-6724)